

AUTOMATIC SLIDING DOOR OPERATOR



DUALCORE, the new operator for sliding doors suits any type of installation, even the heaviest one, it stands out for modular design, mechanic and electronic features that create a flexible, functional and compact sliding door system, easy to install and provided with most advanced technological solutions present in the market.

Available models: LH100 with payload 2 X 100 Kg. LH140 with payload 2 X 140 Kg and RD100, with technology suitable for escape routes.

- Structure in aluminum with removable cover, provided by a system that keeps it open during maintenance and cleaning operations
- New carriage with two rollers, increased diameter, adjustable heights
- Parameters setting directly on board by using display with push buttons. Programming Main Key for firmware upgrade and custom made solutions

- Expansion board for additional features like LAN connection with IP address or connection to smartphone and tablet in Bluetooth mode

- Option to connect wireless logic selectors

- Latest generation of control board, with integrated switching, that grants energy saving reduced weight and size, more accelerations compared to classic toroidal transformer.

- **DUALCORE** technology with double microprocessor, first one upgradable and customizable, used to manage logic parameters; second one used as safety processor with “sealed” firmware, all protected from a double self-extinguishing plastic cover

- Bluetooth technology is already available within the operator and will be programmable from Bluetooth devices shortly.

Development, testing and production of **DUALCORE**, as for all SESAMO products, according international standards ISO 9001.

DUALCORE AUTOMATIC SLIDE DOOR OPERATOR

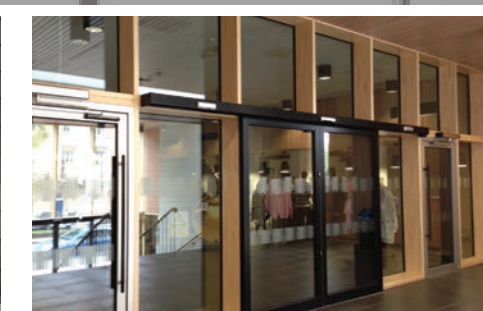
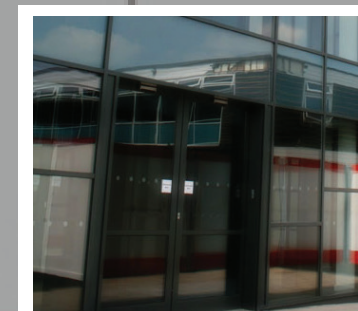

Prosale Limited
Unit 30 The Glenmore Centre
Marconi Drive
Waterwells Business Park
Quedegley, Glos.
GL2 2AP
Tel: 0845 0945 636
www.prosaletdoors.co.uk

PRODUCT RANGE

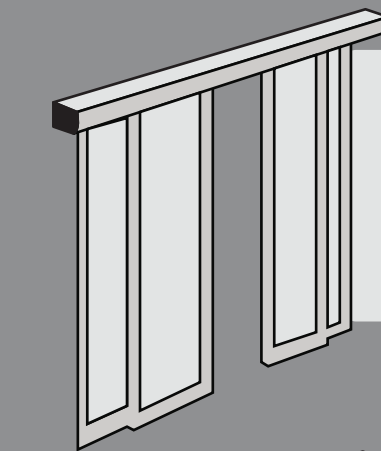

LH100 DUALCORE

At 115mm tall the LH100 Dualcore still keeps with our design ethos of keeping things small, but practical. The LH100 Dualcore can cope with door weights of 100kgs each as a bi parter and 140kgs for a single.

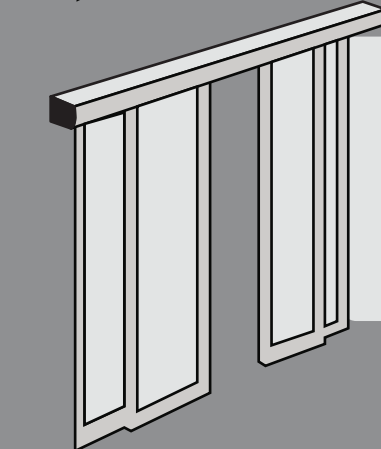

LH140 DUALCORE

Still keeping with 115mm tall theLH140 Dualcore can cope with door weights of 140kgs each as a bi parter and 160kgs for a single. This mighty capacity is based on an upgraded motor and keeping with the profiles of the standard Dualcore.

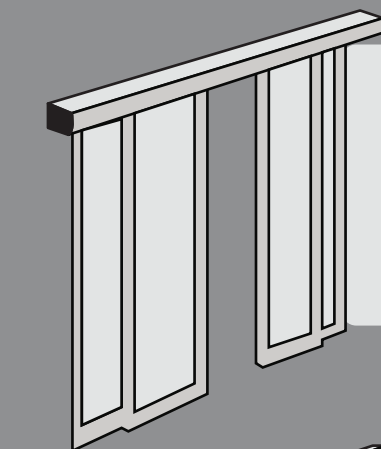

RD100 DUALCORE

In line with the Dualcore identity this operator is manufactured to comply with the EN16005 Fire Exit regulations. The RD100 Dualcore has a complete backup device mirroring the normal operation (redundant system)

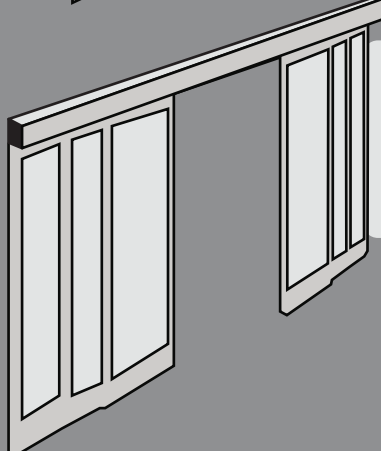

TELESOPICA

At 186mm high; The Telescopica will easily cope with weights of 120kgs for two leafs moving in one direction or 80kgs each for a four leafed, bi-parting entrance.

TECHNICAL SPECIFICATIONS

| MODEL | WINGS | MAX. WEIGHT | CLEAR PASSAGE WIDTH | POWER CONSUMPTION | SERVICE |
|----------------|-------|-------------|---------------------|-------------------|------------|
| LH100 DUALCORE | 1 | 140 Kg | 700÷3000 mm | 150 W | Continuous |
| LH100 DUALCORE | 2 | 2 X 100 Kg | 800÷3000 mm | 150 W | Continuous |
| LH140 DUALCORE | 1 | 160 Kg | 700÷3000 mm | 180 W | Continuous |
| LH140 DUALCORE | 2 | 2 X 140 Kg | 800÷3000 mm | 180 W | Continuous |
| RD100 DUALCORE | 1 | 100 Kg | 800÷3000 mm | 180 W | Continuous |
| RD100 DUALCORE | 2 | 2 X 100 Kg | 900÷3000 mm | 180 W | Continuous |
| TELESOPICA | 2 | 2 X 120 Kg | 450÷3000 mm | 180 W | Continuous |
| TELESOPICA | 4 | 4 X 80 Kg | 450÷3000 mm | 180 W | Continuous |

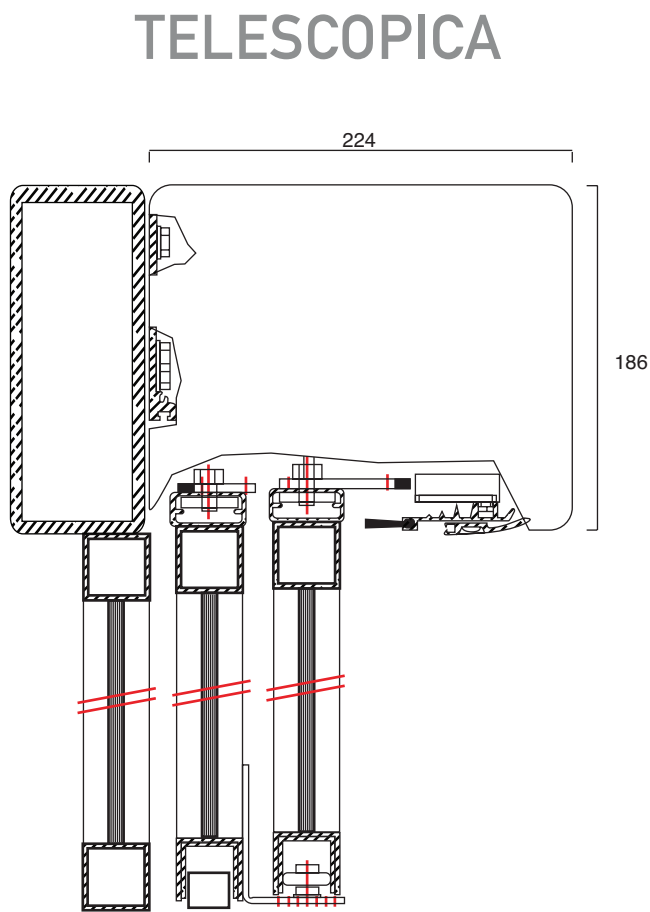
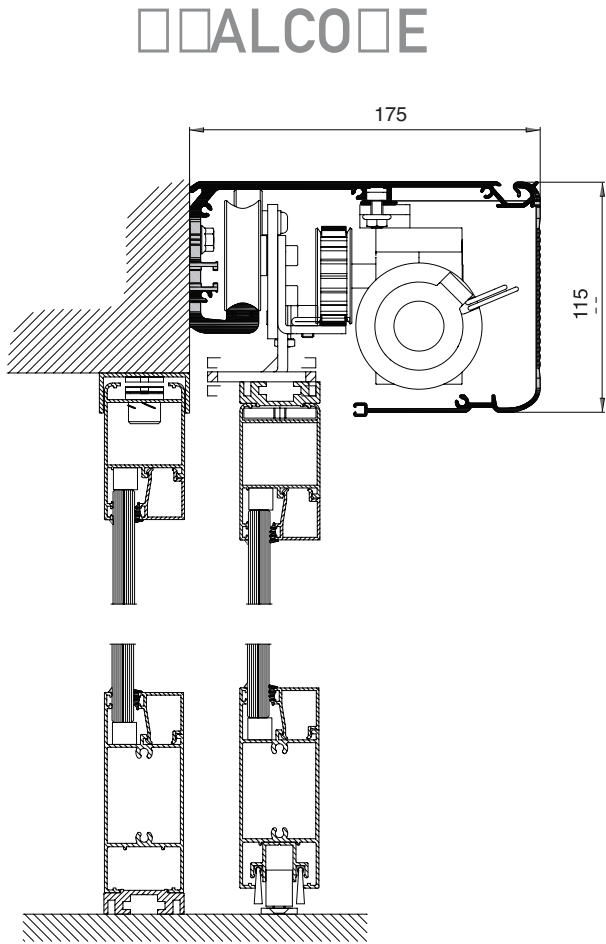

ACCESSORIES

SELECTORS



SENSORS



TRIGGER DEVICES

