

**INVISIBLE**  
by TLJ





## in the door

electronic lock set

Invisible by TLJ is a very unique access control lock set, where the essentials are housed within the lock case itself. Traditionally, the electronic circuit board and batteries are typically part of the handle escutcheon located on front/back face of the door. The Invisible by TLJ however sets out to be different, targetting higher specification, modern schemes from a range of sectors such as Residential & Hospitality.

the vogue of  
access control

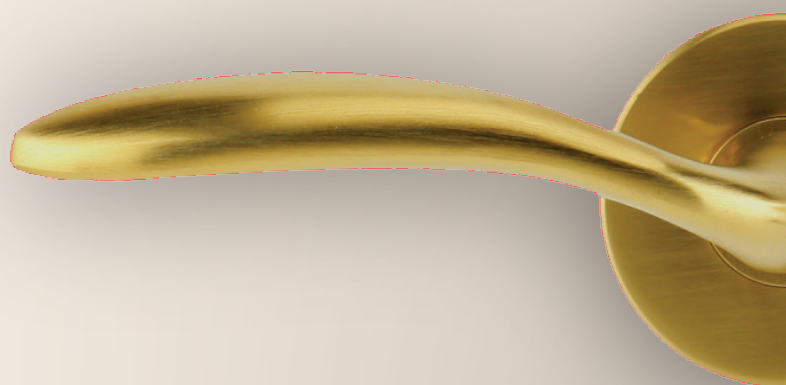





# make it yours

any style, any colour

A specifiers dream - unlike many typical access control handle sets, Invisible by TLJ can be used with any lever on rose you like. Allowing levers to be suited/matching across bedrooms, bathrooms, cupboards, flat entrances etc. Get creative with style & colour finish, access control no longer restricts choice.

Bolt through fixings are recommended for a secure and long lasting solution.

*the indicator*

*lever handle*

*escutcheon*

*euro cylinder*

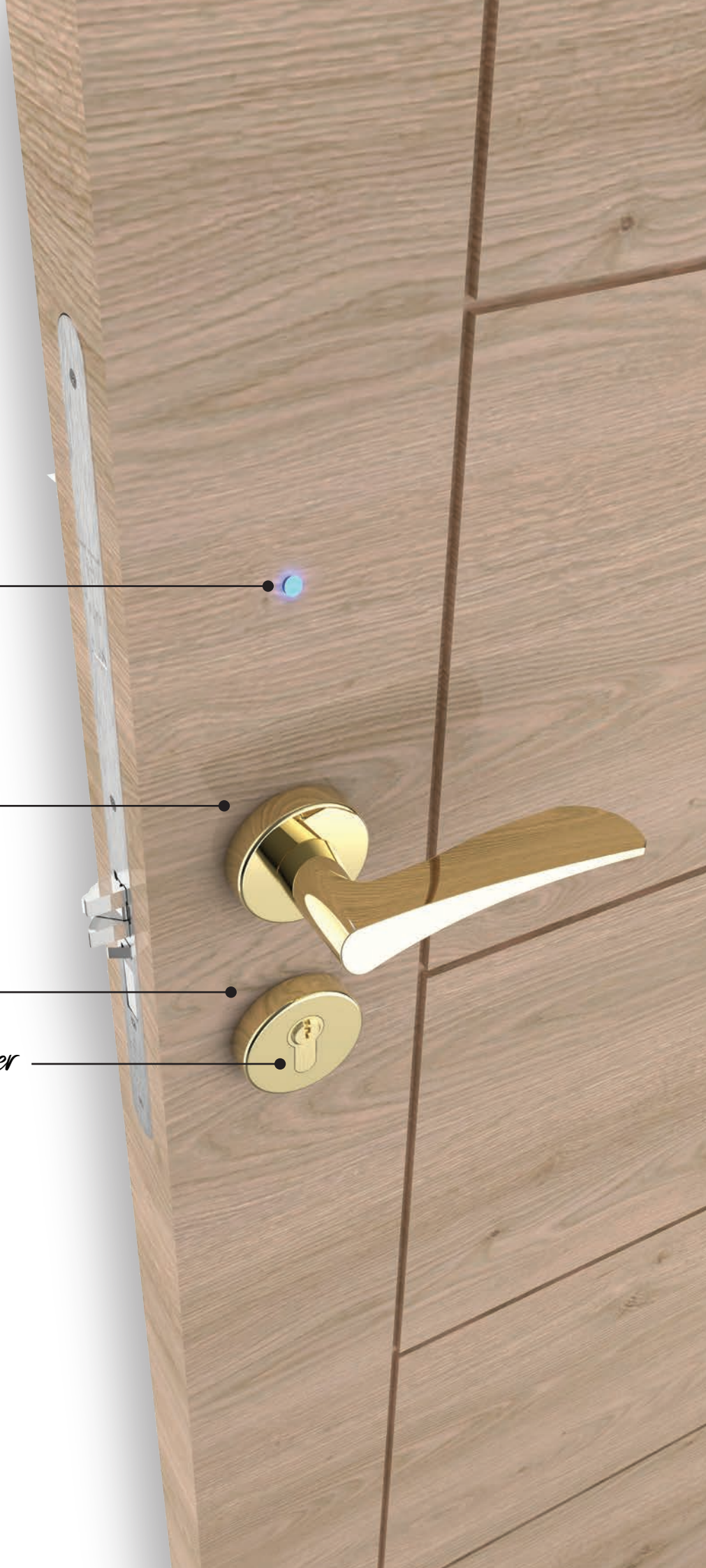



# Certifications

that have your back

EN 14846:2008 - Electromechanically operated locks  
EN 50371:2012 - RT&TTE, Low-power human RF exposure  
& european EMC, LVD directive



EN 1634-1:2014 - Fire resistance & smoke control for a  
minimum of 30/60 minutes



Secured by Design - police approved to improve  
the security within a building



Certifire - 3rd party certification body gives  
assurance as to the performance of the products



PAS24:2016 - Physical security attack test, including  
mechanical load testing BS6375-2 and cycle testing  
of 50,000 cycles EN 1191



SKG\*\* - Mandatory security and cycle testing for  
Dutch laws, including company processes audit



ISO 9001 - Quality management systems for internal  
company processes, internationally recognised.



ISO 14001 - Environmental management systems for  
internal company processes, internationally recognised.



# Dimensions

& exploded diagram

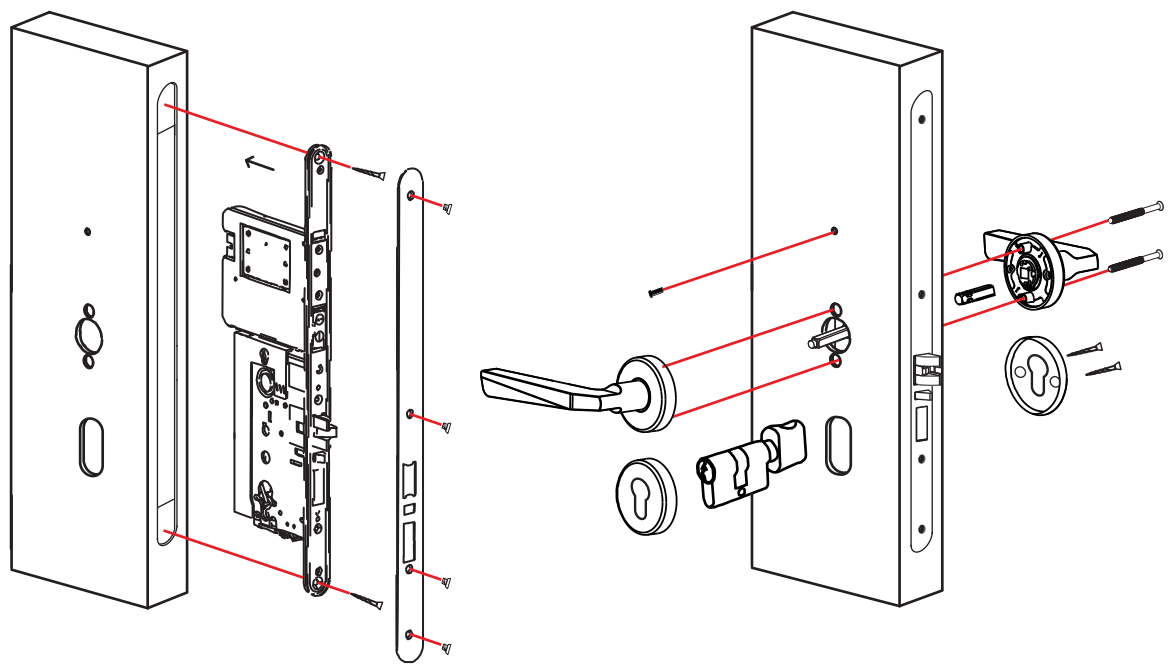
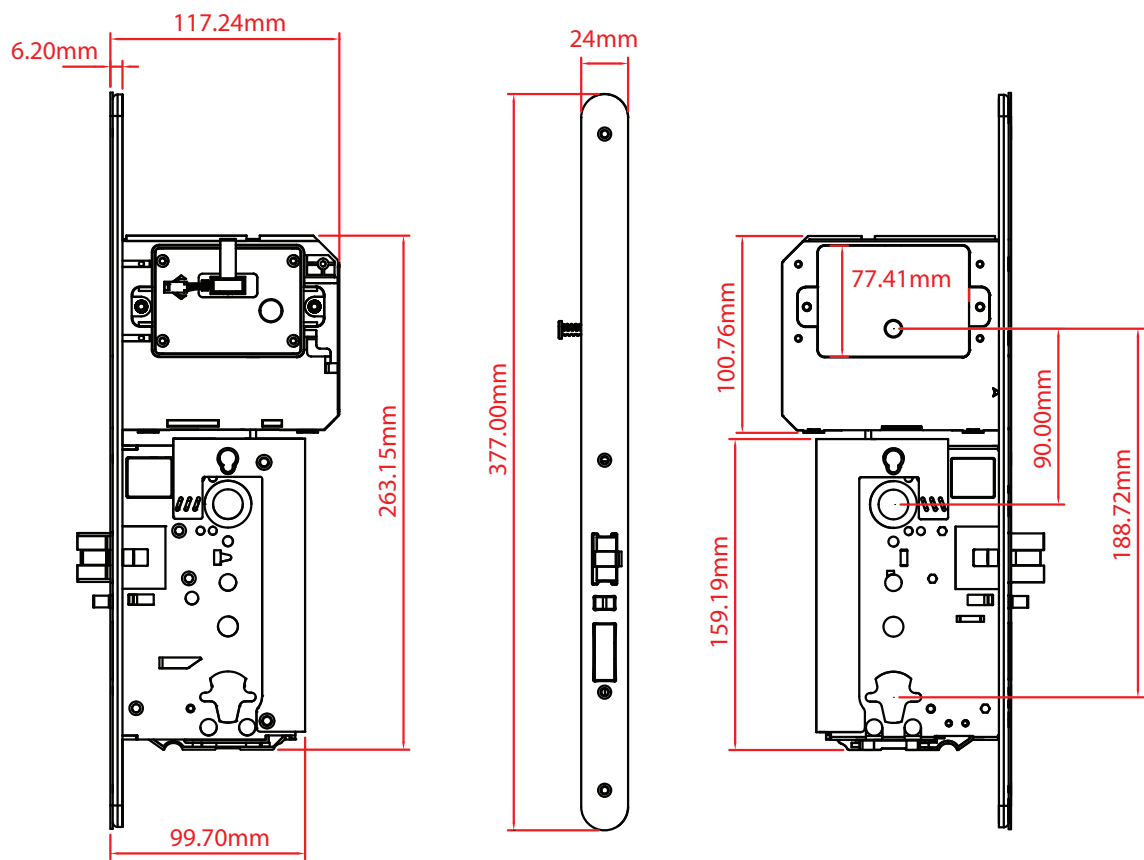

## Offline (Data-on-card)

A simpler standalone operation, with 'at the desk' issuing of credentials. Audit logs stored within the lock set's internal memory and can be retrieved by management. Access can be revoked but requires presenting a 'Report Lost' card directly to the lock itself. Replacement credentials can kill previous credentials without the need to visit the lock.



## TLJ Connect (writeback technology)

A 'hybrid' of an online & offline access control system, where the credential is used to carry information from and to the offline lock as it passes through online hotspot readers\* located on public doors, such as the front door or the elevator..



This part of the memory stores the access rights, and any time & date constraints, such as an expiry date.

This part of the memory stores the TLJ Connect data which is a combination of both:

- Writeback data from battery locks
- Access updates data from PC

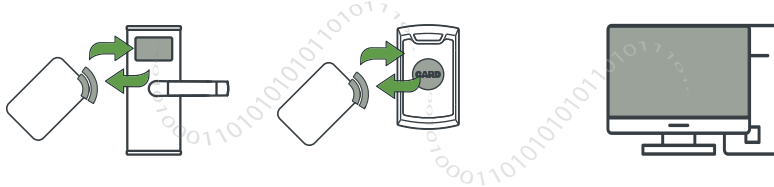
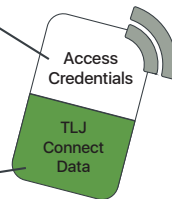

Writeback data **FROM** the battery lock includes:

- Audit Logs/Open Records
- Low Battery Alerts

Access updates **FROM** the PC include:

- Changes (additions or removal of access rights)
- Cancelled/Blocked credentials (Black List)

\* Hotspot readers must be connected to the same LAN as the management PC running TLJ ALMS Software platform

## Bluetooth Smart (App based)



Smartphones are used as the credential, as opposed to the more traditional key card or key fob. The user would use the TLJ app to firstly retrieve any assigned Bluetooth keys and then unlock doors, lift barriers, operate elevators/parcel drop systems etc.

Smartphones can be used in parallel with typical RFID credentials, i.e. where some users prefer a key card and others a smartphone Bluetooth key.

Benefits:

- Reduction in KeyCard loss overhead
- Less time wasted re-issuing lost cards & letting people in rooms
- Stay ahead of the curve
- Check in efficiency drastically improved
- Truly contactless user interaction
- Semi-online platform using the smartphones connection to report audit logs/open records and low battery alerts from offline locks



TLJ Access Control

68/78 Leads Road, Hull, East Yorkshire, HU7 0BY, UK

[www.TLJlimited.com](http://www.TLJlimited.com) 0044 (0)1482 830334

