

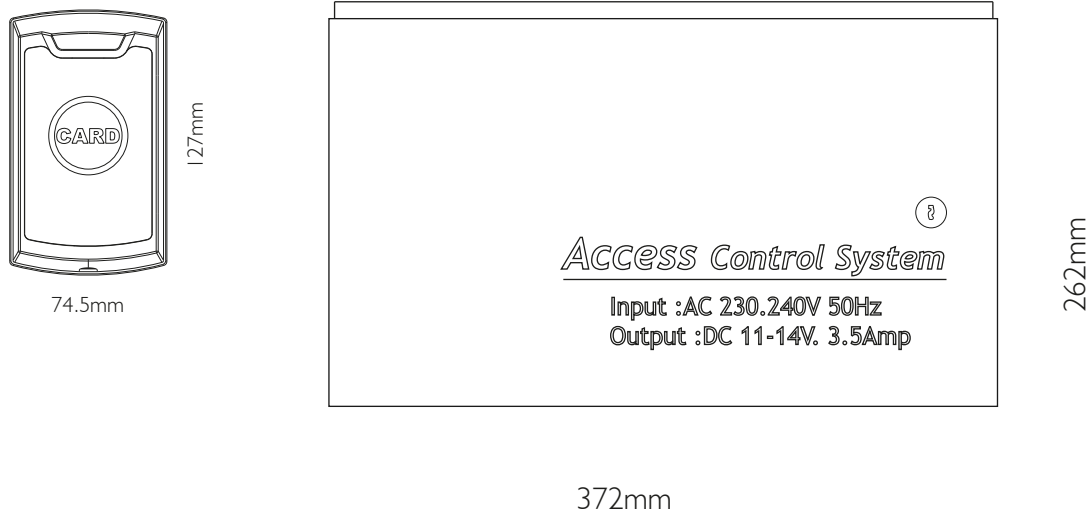

# TLJ Online Access Reader

The TLJ Online Access Reader is a hard wired, mains powered unit, often installed on higher traffic public doors, such as the front main entrance. The reader communicates to a controller located on the secure side of the door, in turn the controller co-ordinates the door lock, exit button, emergency break glass, fire alarm interface & mains power supply.



## Specification

Input Voltage: 230 - 240V 50Hz

Output: DC 11-14V 3.5Amp

Controller construction: Metal, powder coated

Backup Battery charge: 12V 1 Amp

Mains Failure LED: Yes

12V Output Failure LED: Yes

Lockable controller: Yes

Operating Temp: 0 - 45 Degrees C

Moisture Resistant: No (IP enclosure required for external installation)

## Compatible Platforms

- Offline (Data-on-card)
- Online
- TLJ Connect (writeback)
- Smartphone App (BLE)

## Other common reader installations:

- Car park barrier
- Shutter door
- Lift elevator
- Pedestrian gate
- Automated door
- Parcel drop collection unit



## Platform Options

### Offline (Data-on-card)

A simpler standalone operation, with 'at the desk' issuing of credentials. Audit logs stored within the lock set's internal memory and can be retrieved by management. Access can be revoked but requires presenting a 'Report Lost' card directly to the lock itself. Replacement credentials can kill previous credentials without the need to visit the lock.



### Online with TLJ Connect (writeback technology)

A 'hybrid' of an online & offline access control system, where the credential is used to carry information from and to the offline battery locks as it passes through online hotspot readers\* located on public doors, such as the front door or the elevator..



This part of the memory stores the access rights, and any time & date constraints, such as an expiry date.

This part of the memory stores the TLJ Connect data which is a combination of both:

- Writeback data from battery locks
- Access updates data from PC

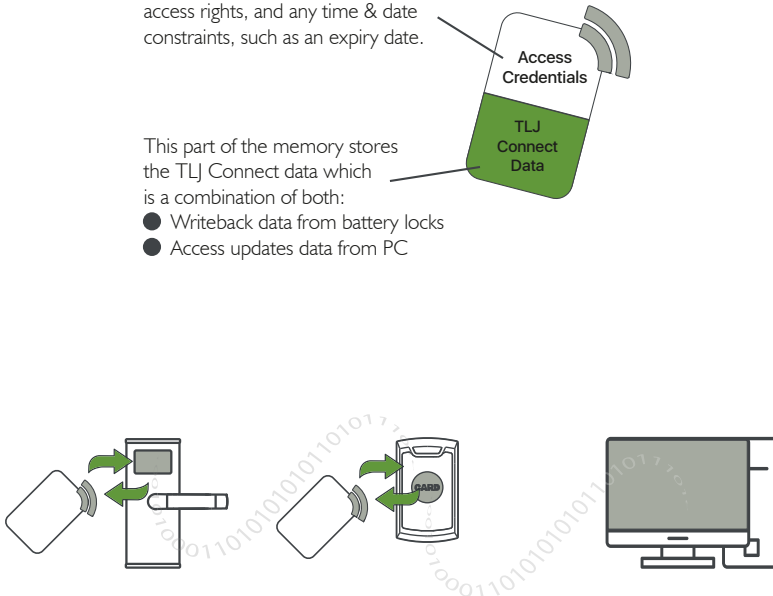

Writeback data **FROM** the battery lock includes:

- Audit Logs/Open Records
- Low Battery Alerts

Access updates **FROM** the PC include:

- Changes (additions or removal of access rights)
- Cancelled/Blocked credentials (Black List)

\* Hotspot readers must be connected to the same LAN as the management PC running TLJ ALMS Software platform

## Bluetooth Smart (App based)



Smartphones are used as the credential, as opposed to the more traditional key card or key fob. The user would use the TLJ app to firstly retrieve any assigned Bluetooth keys and then unlock doors, lift barriers, operate elevators/parcel drop systems etc.

Smartphones can be used in parallel with typical RFID credentials, i.e. where some users prefer a key card and others a smartphone Bluetooth key. Where a mixture of RFID and Smartphone Keys is to be used, then TLJ Connect could still be utilised to assist with management of RFID access.

Benefits:

- Reduction in KeyCard loss overhead
- Less time wasted re-issuing lost cards & letting people in rooms
- Stay ahead of the curve
- Check in efficiency drastically improved
- Truly contactless user interaction
- Semi-online platform using the smartphones connection to report audit logs/open records and low battery alerts from offline locks

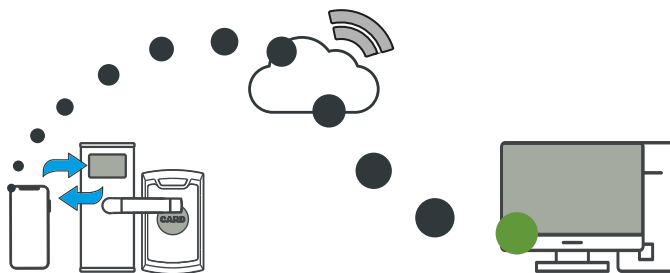

TLJ Access Control

68/78 Leads Road, Hull, East Yorkshire, HU7 0BY, UK  
www.TLJlimited.com 0044 (0)1482 830334



# Access control

## Associated Accessories

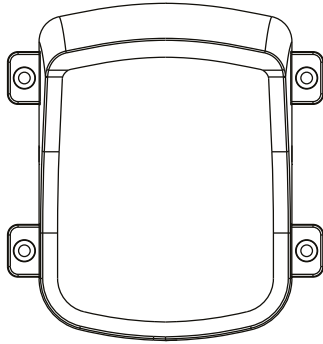

External weather  
protective  
cover shield



Emergency Green break  
glass unit for instant door unlocking



Press to Exit push  
button, for everyday  
door unlocking from  
secure side (inside)



Electronic strike release,  
mounted in frame, used  
in conjunction with  
mortise lock



Electro-magnetical lock,  
mounted at the head of the door.  
Requires Z&L bracket for inward  
opening doors

TLJ Access Control

68/78 Leads Road, Hull, East Yorkshire, HU7 0BY, UK  
[www.TLJlimited.com](http://www.TLJlimited.com) 0044 (0)1482 830334

