

Spectrum MR16 LV Pro Spotlights



Spectrum MR16 LV Pro display spotlights from Display Lighting are reliable contemporary luminaires constructed from solid brass to ensure a high quality hard wearing finishes.

The design ensures that the spotlights are as unobtrusive as possible so that your products are illuminated to their full potential without obstruction.

- Accept MR16 LED lamps.
- Specialised focused lighting for retail and exhibition showcases.
- Low heat illumination.
- No ultraviolet light so does not fade materials.
- Unobtrusive.
- Bespoke product manufactured to specification.
- Reduces heat emissions and heat build-up in store.
- Reduces energy bills by up to 80%.
- Choice of finishes & fixings.

Technical Specifications

Height:	<1000mm (<i>visible height</i>)
Material/s:	Aluminium/Brass
Electrical Connection:	Plug & Play Hard Wired (<i>1000mm tails as standard, length can be specified</i>)
Lamp:	MR16 LED
Colour Temperature/s:	WW (2800K) CW (4000K) DW (5700K)
Watts:	7.5W (<i>max</i>)
Fixings:	9 fixing options available (<i>see pages 3 & 4</i>)
CRI Rating:	See LED lamp data
Class:	III
IP Rating:	IP20
Finishes:	01 - White 02 - Black 03 - Chrome 04 - Polished Brass (<i>Lacquered</i>) 05 - Brushed Chrome 06 - Antique Brass (<i>Lacquered</i>) 07 - Polished Nickel 08 - Brushed Nickel 15 - Brushed Brass (<i>Lacquered</i>) 16 - Rose Gold (<i>Lacquered</i>) XXX - RAL Colours
Tube Support Diameter:	6.50mm
Input Voltage:	12V AC/DC
Beam Angles:	38 Degrees
Warranty:	5 Years
Dimming:	See LED lamp data
Ordering:	6 step order code (<i>see page 3</i>)

Spectrum MR11 LV Pro Spotlights



S121 Cowled Lamp

Diameter: 50mm
Adjustment: 90 Degrees (*Upwards Facing*)
Tilt: 350 Degrees
Material: Brass
Mounting: Vertical or Horizontal
Cap: GU5.3



S122

Diameter: 25mm
Adjustment: 90 Degrees (*Upwards Facing*)
Tilt: 350 Degrees
Material: Brass
Mounting: Vertical or Horizontal
Cap: GU5.3



S123 Cowled Lamp

Diameter: 50mm
Adjustment: 90 Degrees (*Downwards Facing*)
Tilt: 350 Degrees
Material: Brass
Mounting: Vertical or Horizontal
Cap: GU5.3



S124

Diameter: 25mm
Adjustment: 90 Degrees (*Downwards Facing*)
Tilt: 350 Degrees
Material: Brass
Mounting: Vertical or Horizontal
Cap: GU5.3

Spectrum MR16 LV Pro Spotlights

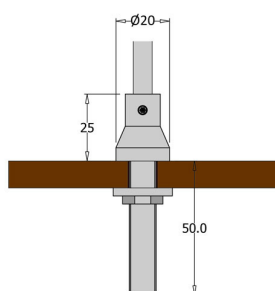
**RF** Rear Fixing

- Diameter:** 20mm
Height: 25mm
Fixing: M10 x 50mm Metric Fine Thread with Nut & Washer
Cutout Diameter: 11mm
Material: Brass
Mounting: Vertical or Horizontal

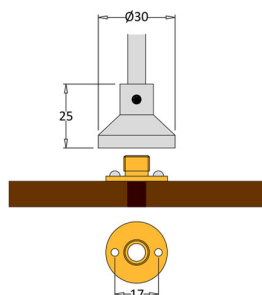
**FF** Face Fixing (*Hidden Bezel*)

- Diameter:** 30mm
Height: 25mm
Fixing: Screw Fix (*fixing screws not included*)
Cutout Diameter: 7mm
Material: Brass
Mounting: Vertical or Horizontal

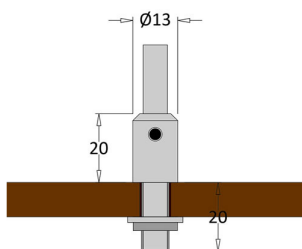
**RFS** Small Rear Fixing

- Diameter:** 20mm
Height: 25mm
Fixing: M8 x 20mm Metric Fine Thread with Nut & Washer
Cutout Diameter: 9mm
Material: Brass
Mounting: Vertical or Horizontal

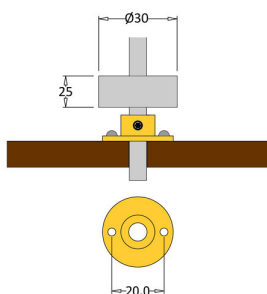
**HF** Hidden Fixing (*Floating Cover*)

- Diameter:** 30mm
Height: 25mm
Fixing: Screw Fix (*fixing screws not included*)
Cutout Diameter: 7mm
Material: Brass
Mounting: Vertical

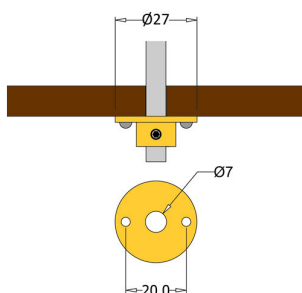
**HFB** Hidden Fixing Bezel

- Diameter:** 27mm
Height: 12mm
Fixing: Screw Fix (*fixing screws not included*)
Cutout Diameter: 7mm
Material: Brass
Mounting: Vertical or Horizontal

Spectrum MR16 LV Pro Spotlights

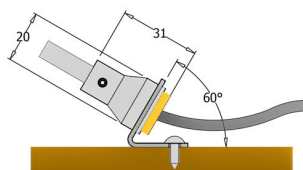

SM 60 Degree Surface Mount Bracket

Width: 25mm
Height: 26mm
Fixing: Screw Fix (*fixing screws not included*)
Cutout Diameter: N/A
Material: 1.5mm Steel
Mounting: Vertical or Horizontal

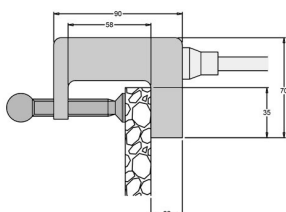

DC Display Clamp (*Fits panels 5mm - 45mm*)

Width: 37mm
Height: 70mm
Fixing: Clamp (*with Thumb Screw*)
Cutout: N/A
Material: Polycarbonate/Brass
Mounting: Vertical or Horizontal

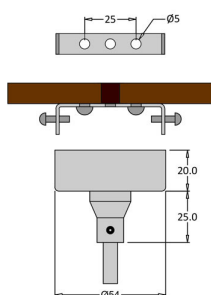

CP Ceiling Rose

Diameter: 54mm
Height: 45mm
Fixing: Screw Fix Bracket (*fixing screws not included*)
Cutout Diameter: 7mm
Material: Steel/Brass
Mounting: Vertical or Horizontal

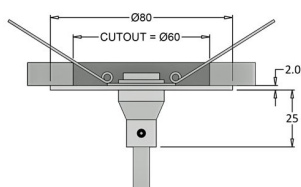

DP Downlight Cover Plate

Diameter: 80mm
Height: 27mm
Fixing: 3 Arm Spring Clips
Cutout Diameter: 50mm - 70mm
Material: Steel/Brass
Mounting: Vertical

Spectrum MR16 LV Pro Spotlights

POWER OPTIONS

P&P Plug & Play - Standard On/Off Driver (2m mains lead & UK plug)

X: Driver or Dimmer not required (*not recommended*)

SIX STEP ORDERING

	1	2	3	4	5	6
MODEL	OVERALL HEIGHT	FIXING	FINISH	LED LAMP CCT	SPOTS PER SET	POWER
S121	< 1000mm	RF	01	WW	X1	P&P X
S122		FF	02	CW	X2	
S123		RFS	03	DW	X3	
S124		HF	04		X4	
		HFB	05		X5	
		SM	06		X6	
		DC	07		X7	
		CP	08		X8	
		DP	15		X9	
			16		X10	
		XXX (RAL)				

Example Order Code: S124.350.HF.03.DW.X4.**P&P**

NOTES:

