



## Data Sheets



## Network Touch Introduction

Network Touch is the new system designed by Specialist Alarm Services. The system has been designed with feedback from customers and years of experience working within mental health and secure environments. The new system has been developed using the latest technology in order to produce a more reliable and robust product. The touch sensitive room units and display panels are specifically designed so that in the most challenging environments service users can't damage buttons and key switches. Another benefit of having no buttons or key switches is that staff members can clean the units more thoroughly and reducing risk of infections in a secure environment. A clean feature has been incorporated on both room and display panels which isolates the units for 10 seconds so that staff members can clean the units without triggering calls on the system.

Another new feature of the Network Touch system is the remote isolation of patient call points. The feature was designed to stop the nuisance calls from service users. To isolate the room unit a member staff will use a specially programmed Curo (staff transmitter). When the call point is isolated the LED in the centre of the unit will turn blue. To view all isolate call points the new display panel has a view isolate touch sensitive pad which shows which room units are currently isolated.

Network Touch is compatible with both the Network II and Red Alert system so the new product can be incorporated onto existing systems and schemes.

DESIGN • MANUFACTURE • INSTALLATION • AFTERCARE

nurse call & staff attack alarms  
**0191 2722222**





## SPECIALIST ALARM SERVICES LTD

Hinde House, Elswick East Terrace, Newcastle upon Tyne, NE4 7LJ  
Telephone 0191-272 2222 Fax 0191-272 5010  
www.sasuk.com

### **DATA SHEET – Touch-Hub**

Please note that specifications may change without notification

#### **Overview**

The HUB is the central control of the Touch system and has the ultimate capacity of 254 addressable call points and 26 LCD indicator panels. The cabinet has a lockable hinged door and houses the main control PCB (HUB), the power supply unit and has space for battery backup, if required. It should be installed centrally in the system layout, normally in a secure location and requires a 240 mains supply from an un-switched fused spur. An input from a day night volume control switch is available to adjust the volume of the LCD indicator panels; alternatively this can be set to automatically change at a certain time of day. A voltage free set of contacts is provided to trigger external devices in the event of a call, an alarm call or an attack call. These contacts can be used to trigger tone pagers or additional voltage sounder or strobe lights etc.

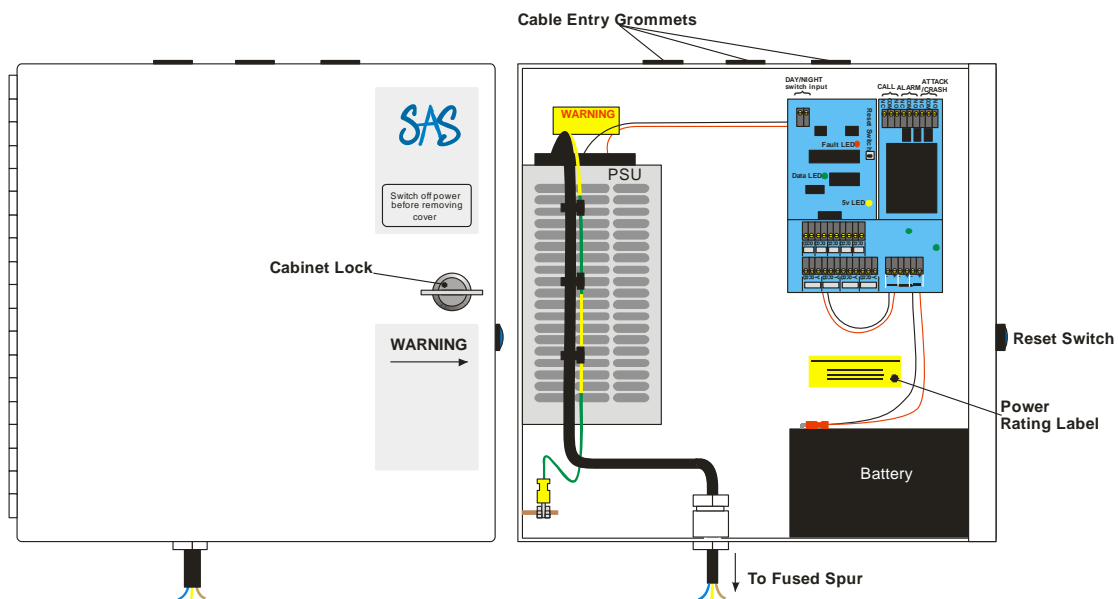

#### **Requirements**

Mains (240Vac / 50-60Hz) connection to the power supply should be made via an un-switched fused spur with 3A fuse.

Design, manufacture, installation and servicing of nurse call, personal attack and other security related products.

Reg. No. 1550516 (England)

### Hub positioning

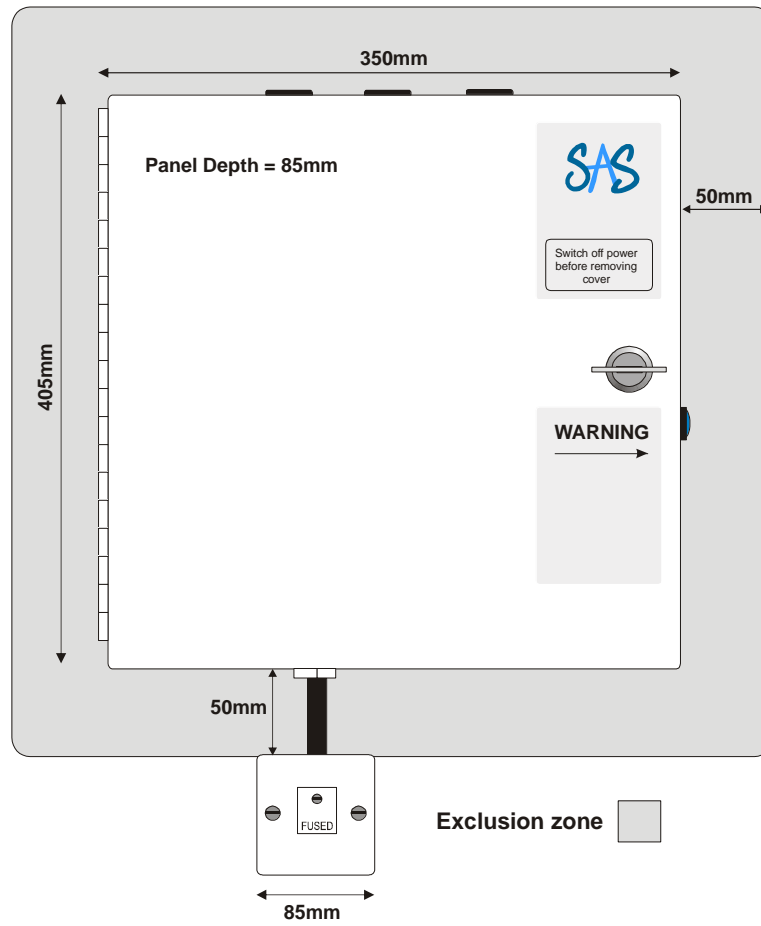

### Specification

Dimensions	W350 x H405 x D85mm
Weight	5.2kg
Finish	Steel powder coated
Current consumption	65mA hub circuit only
Temp range	0-50°C

Design, manufacture, installation and servicing of nurse call, personal attack and other security related products.

## Network Touch - Vandal Resistant Display and Sounder



### Overview

Designed for challenging environments. The display/sounder unit, manufactured from 4mm Makrolon polycarbonate is low profile and vandal resistant. The display clearly shows the exact location of an incident whilst drawing their attention audibly with a grille less speaker. Each call level has its own unique sound and if multiple calls are on the system the scroll buttons can be used to navigate through the list. The display unit features touch buttons only, with a function to disable the buttons for ten seconds for cleaning. The back box is 30mm deep and employs a shock absorbing spring loaded caddy that allows 8mm of play to assist with installation and shocks to the device. Included 4x torx M3.5 x 25mm security screws.

### Button Function

Details	Touch to see ID, call level and time call was activated
View isolated	Touch and hold to see a list of isolated room units
Accept	Touch to accept a 'call' (patient reassurance)
Mute	Touch to mute sound (programmable up to 4.5 minutes)
Scroll up/down	Touch to scroll call list and setup menus
Clean	Touch accept and mute together to disable buttons for 10 secs
Soft buttons	In menu system button function shown on display

### Specification

Material	Polycarbonate (Makrolon)
Fascia	216mm x 138mm x 4mm
Back box	200mm x 120mm x 31mm
Display window	145mm x 35mm
Character height	12mm
Weight (with back box)	400g (230g)
Supply current	20mA inactive, 160mA active
Speaker volume	60db
Network	R, B and Y
Temperature	0-50°C

DESIGN • MANUFACTURE • INSTALLATION • AFTERCARE

nurse call & staff attack alarms  
**0191 2722222**



## Network Touch - Vandal Resistant Room Unit



### Overview

Designed for challenging environments. The room unit, manufactured from injection moulded Tritan Tx (more resilient than Polycarbonate) is low profile and vandal resistant. The unit is touch button actuated and any of the above configuration of active buttons can be achieved. The patient touches the area denoted by the orange paddle to activate a patient call. The hidden LED in the centre of the call point illuminates red when the call is active. The buttons in the frame 'staff only' can be used, by the nurse to either escalate or reset the call depending on the situation at hand. The room unit is addressable and its 20-character name is programmed by infrared only. There are auxiliary connectors on the rear of the device for connecting to en-suite bathroom devices at install time. Included 2x torx M3.5 x 25mm security screws.

### LED Function

Red	Active alarm
Green	Staff function e.g. visit, reset
Blue	Isolated – patient call button disabled within room

### Button Function

Reset	Touch to reset, if active, visit if inactive
Crash	Touch to call for urgent help (crash team)
Alarm	Touch to call for emergency (nurse to nurse)
Nurse paddle	Touch to call for help (patient to nurse)
Clean	Touch RESET and CRASH together to disable buttons for 10 secs

### Specification

Fascia	95mm x 95mm x 5.4mm
Back box	Single gang depth $\geq$ 25mm, recommended
LED	RGB
Weight (with back box)	78g (250g)
Supply current	3mA inactive, 12mA active
Network	R, B (and Y optional)
Temperature	0-50°C

DESIGN • MANUFACTURE • INSTALLATION • AFTERCARE

nurse call & staff attack alarms  
**0191 2722222**



## Network Touch - Vandal Resistant Over-door Light



### Overview

Designed for challenging environments. The over-door light unit, manufactured from injection molded Tritan Tx (more resilient than Polycarbonate) is low profile and vandal resistant. The over door light is situated outside the patient's room, above the door and is paired to the room unit within. The ODL is designed to attract the attention of a member of staff looking down a corridor as it mimics the lights of the room unit it is paired with. LEDs are fitted on the front, left, right and down so can be seen from all available angles. Available with an optional buzzer if greater audibility is needed. There is an optional relay too and auxiliary connectors on the rear of the device to facilitate connection. Included 2x torx M3.5 x 25mm security screws.

### LED Function

Red	Active alarm
Green	Staff function e.g. visit, reset
Blue	Isolated – patient call button disabled within room

### Specification

Fascia	95mm x 95mm x 5.4mm
Back box	Single gang depth $\geq$ 25mm, recommended
LED	RGB
Weight (with back box)	78g (250g)
Supply current	7mA inactive, 85mA active
Network	R, B and Y
Temperature	0-50°C

DESIGN • MANUFACTURE • INSTALLATION • AFTERCARE

nurse call & staff attack alarms  
**0191 2722222**



## Network Touch – Vandal Resistant IR Ceiling Receiver

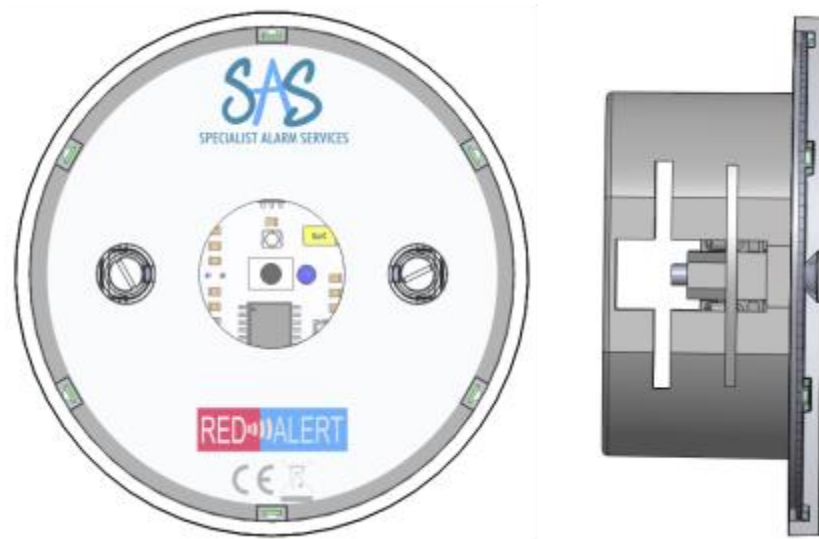

### Overview

Designed for challenging environments. The ceiling mounted alarm receiver unit, manufactured from injection molded Tritan Tx (more resilient than Polycarbonate) is low profile and vandal resistant. The IR ceiling receiver is addressable, and its 20-character name is programmed by infrared only. Included 2x torx M4 x 25mm security screws.

### LED Function

Red	Active alarm
Green	Staff function e.g. visit, reset
Blue	Isolated – patient call button disabled within room

### Specification

Fascia	88mm x 5.4mm
Back box	Circular (Besa style) depth $\geq$ 25mm, recommended
LED	RGB
Weight (with back box)	58g (250g)
Supply current	2mA inactive, 7mA active
Network	R, B (and Y optional)
Temperature	0-50°C

DESIGN • MANUFACTURE • INSTALLATION • AFTERCARE

nurse call & staff attack alarms  
**0191 2722222**





## Network Touch – Vandal Resistant “Slave” IR Ceiling Receiver

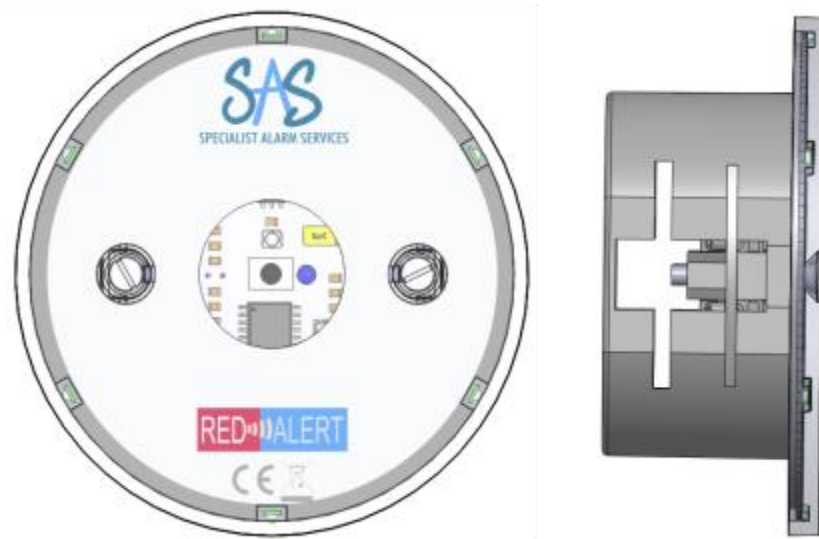

### Overview

Designed for challenging environments. The “slave” ceiling mounted alarm receiver unit, manufactured from injection molded Tritan Tx (more resilient than Polycarbonate) is low profile and vandal resistant. The repeat IR ceiling receiver is largely to aid coverage in longer or awkward areas e.g. corridors to allow just one location to be activated. The receiver has just a Red LED that responds to active alarms and the test signal. Included 2x torx M4 x 25mm security screws.

### LED Function

Red	Active alarm
-----	--------------

### Specification

Fascia	88mm x 5.4mm
Back box	Circular (Besa style) depth $\geq$ 25mm, recommended
LED	Red
Weight (with back box)	56g (250g)
Supply current	0.5mA inactive, 1mA active
Network	0v, 5v, IR, L+ and L-
Temperature	0-50°C

DESIGN • MANUFACTURE • INSTALLATION • AFTERCARE

nurse call & staff attack alarms  
**0191 2722222**



## Network Touch – Vandal Resistant Staff Reset Unit - Bed

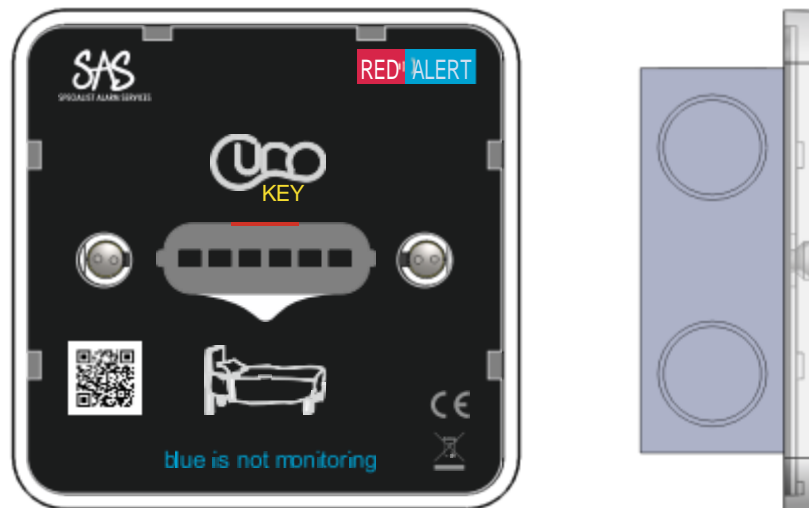

### Overview

Designed for challenging environments. The staff reset unit, manufactured from injection molded Tritan Tx (more resilient than Polycarbonate) is low profile and vandal resistant. The staff reset unit is situated outside the patient's room, at hip height and is paired to the movement detector within. Under normal operation if movement is detected the SRU triggers an elevated call (ALARM), it is then reset by the Curo at very close range. Touching the Curo on the depicted graphic will reset the alarm. The SRU can be dis-armed to ignore the motion detector by manually touching the Curo on the graphic, this mode is commonly used throughout the day. The LED will acknowledge with a brief white colour followed by a blue flash. To return the SRU to normal operation touch the Curo on the graphic, there will be a white acknowledge followed by a red flash. The staff reset unit is addressable and its 20-character name is programmed by infrared only. Available with an optional buzzer if greater audibility is needed. There is an optional relay too and auxiliary connectors on the rear of the device to facilitate connection. Included 2x torx M3.5 x 25mm security screws.

Note: **Curo** refers to the staff alarm fob (personal alarm transmitter)

### LED Function

Red	Active alarm
Green	Staff function e.g. visit, reset
Blue	Isolated – Motion detection disabled within room

### Specification

Fascia	95mm x 95mm x 5.4mm
Back box	Single gang depth $\geq$ 25mm, recommended
LED	RGB
Weight (with back box)	78g (250g)
Supply current	6mA inactive, 70mA active
Network	R, B and Y
Temperature	0-50°C

DESIGN • MANUFACTURE • INSTALLATION • AFTERCARE

nurse call & staff attack alarms  
**0191 2722222**



## Network Touch – Vandal Resistant Staff Reset Unit - Door

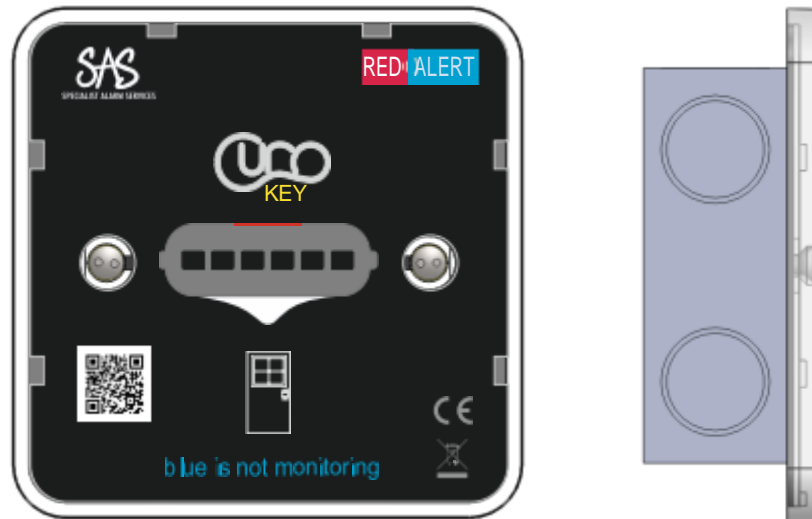

### Overview

Designed for challenging environments. The staff reset unit, manufactured from injection molded Tritan Tx (more resilient than Polycarbonate) is low profile and vandal resistant. The staff reset unit is situated near a monitored door, at hip height and. Under normal operation if the door is opened the SRU triggers an elevated call (ALARM), it is then reset by the Curo at very close range. Touching the Curo on the depicted graphic will reset the alarm. The SRU can be dis-armed to ignore the door state by manually touching the Curo on the graphic, this mode is commonly used through the day. The LED will acknowledge with a brief white colour followed by a blue flash. To return the SRU to normal operation touch the Curo on the graphic, there will be a white acknowledge followed by a red flash. Whenever the SRU is set there will be a brief period where the door state will be ignored, this is engineer adjustable and if set to zero there will be no delay to ARMED. During the delay to arm a relay output closes which could be used as an electronic lock release. Note there is no means to reset device by emergency services so a break-glass unit must be used. The staff reset unit is addressable and its 20-character name is programmed by infrared only. Available with an optional buzzer if greater audibility is needed. Included 2x torx M3.5 x 25mm security screws.

Note: **Curo** refers to the staff alarm fob (personal alarm transmitter)

### LED Function

Red	Active alarm
Green	Staff function e.g. visit, reset
Blue	Isolated – ignore door state

### Specification

Fascia	95mm x 95mm x 5.4mm
Back box	Single gang depth $\geq$ 25mm, recommended
LED	RGB
Weight (with back box)	78g (250g)
Supply current	6mA inactive, 70mA active
Network	R, B and Y
Temperature	0-50°C

DESIGN • MANUFACTURE • INSTALLATION • AFTERCARE

nurse call & staff attack alarms  
**0191 2722222**



## Network Touch – Vandal Resistant Staff Reset Unit - Room

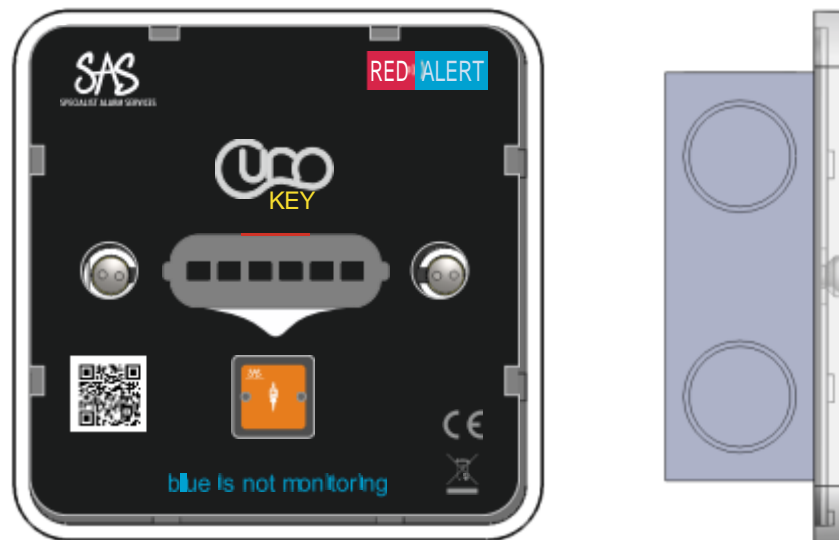

### Overview

Designed for challenging environments. The staff reset unit, manufactured from injection molded Tritan Tx (more resilient than Polycarbonate) is low profile and vandal resistant. The staff reset unit is situated outside the patient's room, at hip height and is paired to the bedroom call point(s) within. Touching the Curo on the depicted graphic will reset the call point alarm. The SRU can be isolated to ignore the bedroom call point(s) by manually touching the Curo on the graphic, this mode is commonly used in the event of "nuisance pressing". The LED will acknowledge with a brief white colour followed by a blue flash. To return the SRU to normal operation touch the Curo on the graphic, there will be a white acknowledge followed by a red flash. The staff reset unit is addressable and its 20-character name is programmed by infrared only. Available with an optional buzzer if greater audibility is needed. There is an optional relay too and auxiliary connectors on the rear of the device to facilitate connection. Included 2x torx eye M3.5 x 25mm security screws.

Note: **Curo** refers to the staff alarm fob (personal alarm transmitter)

### LED Function

Red	Active CALL alarm
Green	Staff function e.g. visit, reset
Blue	Isolated – slave call point(s) disabled within room

### Specification

Fascia	95mm x 95mm x 5.4mm
Back box	Single gang depth >= 25mm, recommended
LED	RGB
Weight (with back box)	78g (250g)
Supply current	6mA inactive, 70mA active
Network	R, B and Y
Temperature	0-50°C

DESIGN • MANUFACTURE • INSTALLATION • AFTERCARE

nurse call & staff attack alarms  
**0191 2722222**



## Network Touch – Vandal Resistant Wireless IR Call Point



### Overview

Designed for challenging environments. The room unit, manufactured from injection molded Tritan Tx (more resilient than Polycarbonate) is low profile and vandal resistant. The unit is touch button actuated and any of the above configuration of active buttons can be achieved. The patient touches the area denoted by the orange paddle to activate a patient call. The hidden LED in the centre of the call point illuminates red when the buttons are touched. A low battery warning will sound when the battery is low. Upon detection of a low battery a CALL signal is sent out, this will not be sent again until the battery has been changed. Staff should be made aware of this. The buttons in the frame 'staff only' can be used, by the nurse to reset the call. Included 2x torx M3.5 x 25mm security screws, 3 x AAA batteries, surface back box (optional)

### LED Function

Green	Battery good
Yellow	Battery should be changed
Red	Change battery now

### Button Function

Reset	Touch to reset, if active, visit if inactive
Crash	Touch to call for urgent help
Alarm	Touch to call for emergency
Nurse paddle	Touch to call for help
Clean	Touch RESET and RESET together to disable buttons for 10 secs
SAS	Touch SAS to send test signal and display battery strength through LED

### Specification

Fascia	95mm x 95mm x 5.4mm
Back box	Single gang depth >= 25mm, recommended
LED	RGB
Weight (with back box)	200g (250g)
Battery Type	AAA x 3
Temperature	0-50°C

DESIGN • MANUFACTURE • INSTALLATION • AFTERCARE

nurse call & staff attack alarms  
**0191 2722222**

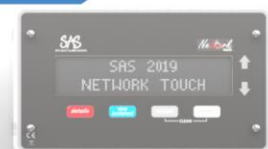



SPECIALIST ALARM SERVICES LTD

Hinde House, Elswick East Terrace, Newcastle upon Tyne, NE4 7LJ  
Telephone 0191-272 2222 Fax 0191-272 5010  
www.sasuk.com

## **DATA SHEET – RED255AL External Infrared Receiver**

Please note that specifications may change without notification

### **Overview**

This is a RED205 sensor mounted in a weather resistant IP65 rated enclosure. It is designed for use when personal attack coverage is required in external areas, for example gardens and patios. It has a range of approximately 10 metres and the alarm transmitters must be aimed towards the sensor and for this reason it has a bright fluorescent orange label. An optional stainless steel collar can be used to minimise ligature risk in vulnerable areas.

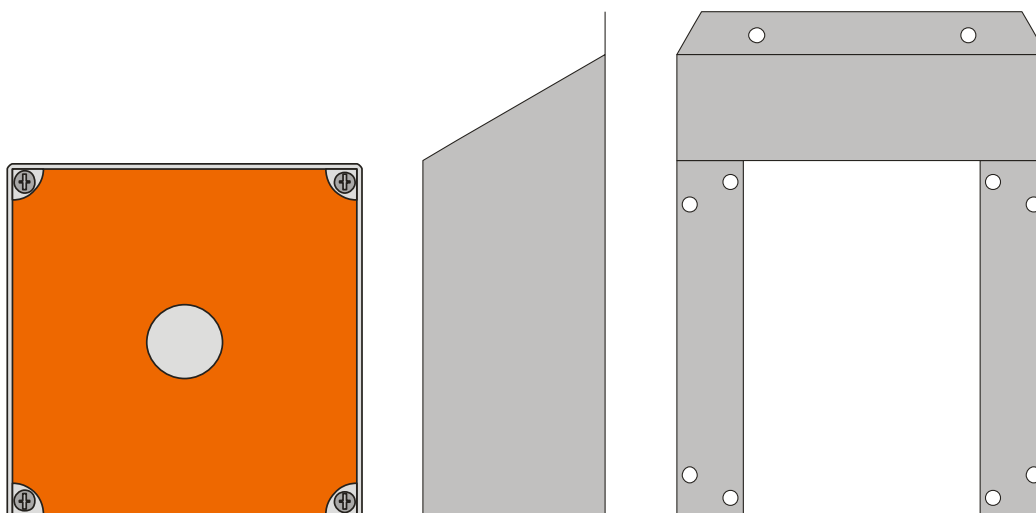

### **Specification**

Enclosure Dimensions	W120 x H120 x D60mm
Enclosure Weight	313g
Enclosure Finish	Grey IP65 ABS enclosure with clear lid
Surround Dimensions	W124 x H170 x D60mm
Surround Finish	Stainless steel
Surround Weight	292g
Max voltage	15.0v
Current consumption	
Inactive (active)	4mA (20mA)
Current limit on L+	20mA
Temp range	0-50°C

Design, manufacture, installation and servicing of nurse call, personal attack and other security related products.

Reg. No. 1550516 (England)



## Network Touch – Vandal Resistant Ceiling Sounder



### Overview

Designed for challenging environment. The ceiling mounted unit, manufactured polycarbonate is low profile and vandal resistant. The grille conveniently adds additional volume to a system in places away from the display sounder unit. The ceiling sounder is adjustable on installation, its volume for day and night is set internally by a rotary switch and push buttons. Included 4 x torx M4 x 25mm security screws.

### Specification

Fascia	88mm x 5.4mm
Back box	None required
Weight (with back box)	
Supply current	7mA inactive, 120mA active
Network	R, B and Y

DESIGN • MANUFACTURE • INSTALLATION • AFTERCARE

nurse call & staff attack alarms  
**0191 2722222**



## Network Touch – Vandal Resistant Slave Call Point



### Overview

Designed for challenging environments. The room unit, manufactured from injection molded Tritan Tx (more resilient than Polycarbonate) is low profile and vandal resistant. The unit is touch actuated. The staff can touch any of the area denoted by the red square to activate a emergency level, in this case ATTACK. The hidden LED in the centre of the device illuminates red when the call is active. The device is addressable as standard. Included 2x torx M3.5 x 25mm security screws.

### LED Function

Red                      Active ATTACK

### User Function

Reset	Use blue rest transmitter as standard
Crash	N/A
Nurse paddle	Touch paddle for emergency ATTACK level
Clean	Should be in isolate mode to clean without activation

### Specification

Fascia	95mm x 95mm x 5.4mm
Back box	Single gang depth $\geq$ 35mm, recommended
LED	Red
Weight (with back box)	76g (250g)
Supply current	1mA inactive, 8mA active
Temperature	0-50°C

DESIGN • MANUFACTURE • INSTALLATION • AFTERCARE

nurse call & staff attack alarms  
**0191 2722222**





## Network Touch – Vandal Resistant Slave Call Point



### Overview

Designed for challenging environments. The room unit, manufactured from injection molded Tritan Tx (more resilient than Polycarbonate) is low profile and vandal resistant. The unit is touch actuated. The patient can touch any of the area denoted by the orange square to activate a patient call. The hidden LED in the centre of the call point illuminates red when the call is active. The room unit is wired directly to an addressable device e.g. SRU at install time. Included 2x torx M3.5 x 25mm security screws.

### LED Function

Red	Active CALL alarm
-----	-------------------

### User Function

Reset	Staff key swipe to reset, if active, visit if inactive (magnetic)
Crash	Staff key swipe to call for urgent help (magnetic)
Nurse paddle	Touch paddle for help CALL
Clean	SRU should be in isolate mode to clean without activation

### Specification

Fascia	95mm x 95mm x 5.4mm
Back box	Single gang depth $\geq$ 25mm, recommended
LED	Red
Weight (with back box)	76g (250g)
Supply current	1mA inactive, 8mA active
Temperature	0-50°C

DESIGN • MANUFACTURE • INSTALLATION • AFTERCARE

nurse call & staff attack alarms  
**0191 2722222**





SPECIALIST ALARM SERVICES LTD

Hinde House, Elswick East Terrace, Newcastle upon Tyne, NE4 7LJ  
Telephone 0191-272 2222 Fax 0191-272 5010  
www.sasuk.com

## DATA SHEET – RED208/6 and RED209/6 Rechargeable Infrared Transmitter

Please note that specifications may change without notification

### Overview

The RED208/6 alarm transmitter is carried by staff in establishments where they may feel at risk of an attack or might need to call for urgent assistance. This is our latest design of infra-red transmitter and it is powered a rechargeable battery. A full charge will last for months rather than weeks and a quick 2 hours is all it takes to get it back to a fully charged state. The transmitter incorporates a red alarm button and a unique emergency call pull activation that keeps the transmitter attached to your person. A pair of side buttons is provided to give a double action switch. A green button is pressed to check the battery condition, indicated by an LED, furthermore the nearest infra-red receivers' reassurance light will flash to confirm a healthy signal. This is a confidence inspiring feature for the user who can quickly test the transmitter and receivers' function when dealing with a potentially serious situation. As further backup a bleep will be heard from the transmitter when a battery requires a quick charge.

The RED209/6 reset transmitter has the same features as the alarm transmitter but has a blue button that is used to cancel alarm calls at their origin. This important feature means that calls have to be dealt with by visiting the area of activation.

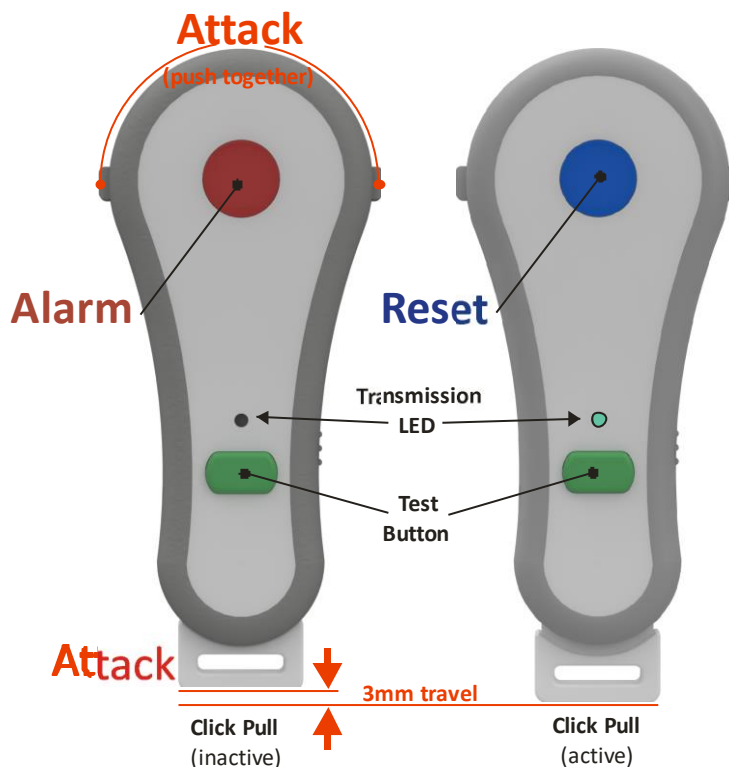

Design, manufacture, installation and servicing of nurse call, personal attack and other security related products.

Reg. No. 1550516 (England)

**Specification**

Dimensions	W45 x H102 x D17mm
Weight	28g
Finish	PC-ABS and rubber
Temp range	0-50°C



SPECIALIST ALARM SERVICES LTD

---

Hinde House, Elswick East Terrace, Newcastle upon Tyne, NE4  
7LJ Telephone 0191-272 2222 Fax 0191-272 5010 [www.sasuk.com](http://www.sasuk.com)

## **DATA SHEET –Touch-ST**

### **Lockable Storage Cabinet for CURO Transmitters**

Please note that specifications may change without notification



#### **Overview**

This is a lockable storage cabinet for the CURO transmitters. The cabinet can hold up to 30 CURO transmitters and has some storage space for additional keys.



#### **Specification**

Panel Dimensions

H370mm x W280mm x D 80mm

Design, manufacture, installation and servicing of nurse call, personal attack and other security related products.

Reg. No. 1550516 (England)

---



SPECIALIST ALARM SERVICES LTD

Hinde House, Elswick East Terrace, Newcastle upon Tyne, NE4 7LJ  
Telephone 0191-272 2222 Fax 0191-272 5010  
www.sasuk.com

## **DATA SHEET – Touch-Pull-AL Anti-Ligature Ceiling Mounted Pull Switch**

Please note that specifications may change without notification

### **Overview**

These switches are commonly used in bathrooms and toilets etc. The ceiling switch provides a means of activating an alarm; it interfaces seamlessly with all Touch call points. The switching action is momentary and provides a LED for reassurance. They are fitted with a wipe clean, an anti-shatter plastic wand 2.25 metres long for ease of use. **Please note this switch has been modified to take the weight of the wand.**

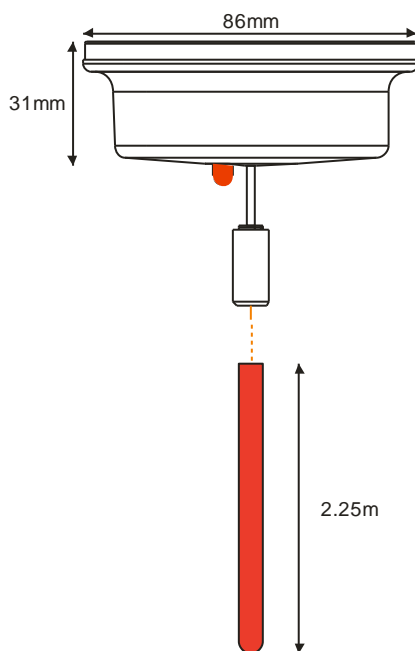

### **Specification**

Switch Dimensions	W86 x H31mm
Wand Dimensions	W8.4mm x L2250mm
Back box requirements	Flush "Besa" circular conduit box (M4 fixing)
Weight - Ceiling switch	64g
Weight - Wand	108g
Material	ABS & Nylon
Current consumption	
Inactive (active)	0.5mA (20mA)
Temp range	0-50°C

Design, manufacture, installation and servicing of nurse call, personal attack and other security related products.

Reg. No. 1550516 (England)



© 2020

DESIGN • MANUFACTURE • INSTALLATION • AFTERCARE

nurse call & staff attack alarms  
**0191 2722222**

