

# WRIGHTFIELD

BETTER BY DESIGN



**YOUR CUSTOM  
ENGINEERING PARTNER**



**MEAT, POULTRY  
AND SEAFOOD**



**FRUIT, SALADS  
AND VEGETABLES**



**CONVENIENCE &  
READY MEALS**



**CONFECTIONARY  
AND BAKERY**



**PET FOODS**

- ✓ Design & Integrations
- ✓ Processing Conveyors
- ✓ Machinery & Equipment
- ✓ Structural Steelwork
- ✓ Bead Blasting / Finishing
- ✓ Servicing and Spares



**SPARES, SERVICING AND MAINTENANCE**



**STRUCTURAL EN1090**



**FINISHING**

**WRIGHTFIELD**  
BETTER BY DESIGN



Progress Way, Mid Suffolk Business Park, Eye, Suffolk, UK, IP23 7HU



+44 (0) 1379 872800



sales@wrightfield.co.uk



www.@wrightfield.co.uk



# WHY CHOOSE WRIGHTFIELD?

Wrightfield brings over 30 years of expertise in providing comprehensive custom engineering solutions. Our services cover every stage of the process, from initial design and precision fabrication to seamless assembly and expert finishing. With advanced on-site manufacturing capabilities, we deliver high-quality craftsmanship tailored to meet the unique needs of our clients across various industries.



Whether you require food-grade conveyor systems, structural steelwork, or bespoke engineering projects, Wrightfield ensures innovative solutions with exceptional attention to detail and reliability.

At Wrightfield, we have the ability to respond quickly to client needs and changes, ensuring precision and high standards throughout every stage of production.



# WHO WE ARE AND WHO WE WORK WITH

Wrightfield are based in Eye, Suffolk. With over 40,000 Sq Ft of office and development space, we are well served to offer our customers the best possible design and build services.



Whether you're a large-scale processor in need of comprehensive custom-made systems, or a small company looking for specialised support, we have the expertise and capabilities to meet your exact requirements. Contact us for a discussion or site visit.





# PROCESSING CONVEYORS

At Wrightfield, we are experts in designing and manufacturing bespoke processing conveyors to enhance efficiency, reliability, and performance across a wide range of industries and sectors.

## SOME OF THE SECTORS WE WORK IN



## INCLUDING THESE CONVEYORS

### TYPE

- Modular Belt
- PU
- Roller
- Wire
- Slat

### CONFIGURATION

- Horizontal
- Incline/Decline
- Radius
- Shuttle
- Bi-Directional

### APPLICATION

- De-Boning
- Trimming
- Packing
- Grading
- Inspection

Do you have a bespoke requirement? Please contact us...

# DESIGN & INTEGRATIONS

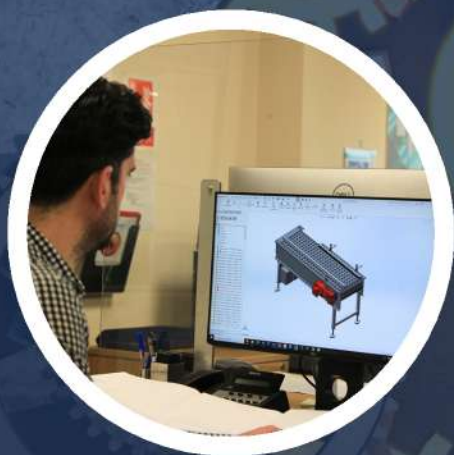

At Wrightfield, our team of specialist engineers are proud to provide planning, design, and consultative solutions for your conveyor, machinery, equipment and structural engineering projects.

## OUR EXPERTISE INCLUDES:

- **Site Surveys:** Conducting thorough site surveys to assess your facility's unique requirements.
- **Design Consulting:** Offering guidance to transform your ideas into workable solutions.
- **System Integration:** Connecting processes for enhanced performance.
- **Project Planning:** Ensuring successful project execution from start to finish.



Do you have a bespoke requirement? Please contact us...



# S SHAPE CONVEYOR

Maximise efficiency and hygiene with the S-Conveyor, designed to gently lift delicate, sticky products with minimal waste. Liftvrac's unique belt ensures seamless transport, zero material loss, and easy cleaning for food safety.

## Why Choose the S Conveyor?

- ✓ No crushing, breaking, or sticking
- ✓ Fully washable, no retention zones
- ✓ Raises product up to 8.5 metres high
- ✓ Zero product loss
- ✓ Gentle belt adapts to product shape
- ✓ Reliable operation with fewer parts
- ✓ No need for a flighted conveyor belt

See how the Liftvrac system can transform your process.

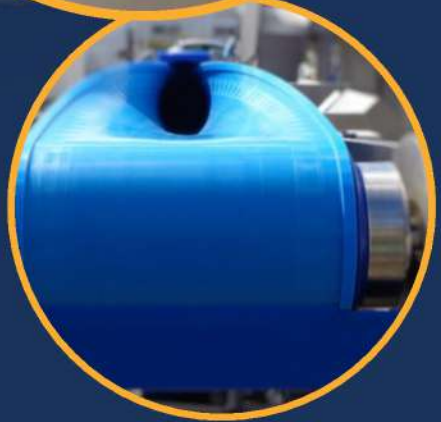

# C SHAPE CONVEYOR

Liftvrac's space-saving C-shaped conveyor gently transports fragile foods by forming a protective tube around the product, eliminating the need for flights and reducing damage while ensuring efficient handling.

## Efficient & Hygienic

Easy to clean, low maintenance, zero material loss.

## Fast ROI

Cost-effective & minimal upkeep.

## Space-Saving

Ideal for crowded production sites.

## High Lift

Raises products up to 7m for smooth processing.

Lower costs, maximise yields and eliminate food waste.

See how the Liftvrac system can transform your process.





# EN-1090 STRUCTURAL ACCREDITATION



Wrightfield offers design, subcontract and steelwork services for all your structural metal engineering needs. The EN 1090 certification ensures your mild steel, stainless steel or aluminum structures meet strict European safety and quality standards.

## TRUST WRIGHTFIELD...BETTER BY DESIGN

---

- ✓ Mezzanine Floors
- ✓ Balustrades
- ✓ Handrails
- ✓ Staircases
- ✓ Fire Escapes
- ✓ Walkways & Platforms
- ✓ Canopies
- ✓ Facade Supports

Do you have a bespoke requirement? Please contact us...





# INNOVATIVE POULTRY TRANSPORT SOLUTIONS

Wrightfield is a trusted leader in poultry processing and offers industry-leading transport drawers and steel modules.

## CHICKEN TRANSPORT DRAWERS - 220 MM / 250 MM DEPTH

A strong, durable poultry transport drawer system in 220 mm or 250 mm depths. They are designed with animal welfare in mind and with less risk of protrusion, they reduce stress and potential injury.

They are compatible with our standard steel transport modules, and are built for demanding operations.



Designed for secure containment, our steel transport modules are designed to house 220 mm or 250 mm transport drawers. Their robust construction supports operational efficiency and animal welfare.

Would you like further information? Please contact us...

# LIVE BIRD HANDLING & STUNNING SYSTEMS

*A closer look at the LAPS® and Pro-Load Systems*

The LAPS® (Low Atmosphere Pressure Stunning™) represents a novel approach to humane poultry stunning. The LAPS® system is approved by EFSA, is legal to use in Europe and is now included in Annex I and II of Council Regulation (EC) No. 1099/2009.



- Humane Stunning
- Stress Reduction
- Lowest Hazard Ranking
- Improved Welfare
- Durable Design
- No Gas Cost

Working seamlessly with the LAPS® stunning system, the Pro-Load system is designed to streamline the live bird handling process by providing gentle, stress-free handling of birds during unloading.

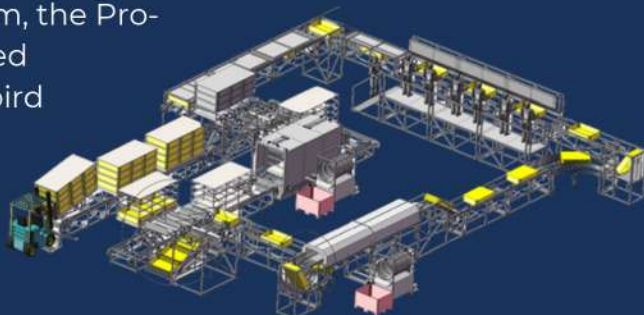

Together, Pro-Load and LAPS® create a fully integrated solution that prioritises welfare, operational efficiency, and regulatory compliance. **LAPS is developed by TechnoCatch, LLC, with Wrightfield as its sales and manufacturing partner.**

Find out how these systems can work for you today.

**WRIGHTFIELD**

BETTER BY DESIGN



01379 872800



[www.wrightfield.co.uk](http://www.wrightfield.co.uk)



# EQUIPMENT & MACHINERY



Wrightfield specialises in designing and manufacturing equipment and machinery tailored to the needs of the food industry. With decades of engineering expertise, we deliver innovative, reliable and efficient solutions for food processors.

Our in-house team works closely with clients to develop custom manufacturing solutions, addressing specific operational challenges and optimising production processes.

We also hold exclusive manufacturing agreements for industry-leading products, including food dicers for FAM Stumabo and agricultural machinery for Tramspeed. These partnerships showcase our engineering excellence and positions us as a trusted provider of specialised equipment across various sectors.



Do you have a bespoke requirement? Please contact us...



# SPARES & SERVICING



**Spares**



**PPM Servicing**



**Equipment Surveys**



**On Call and  
Emergency Cover**



**Service Contracts**



**Remote Support**



**Shift Cover**

Comprehensive Servicing,  
Spares, and Maintenance  
Solutions for Optimal  
Performance.

***“We’ll take care  
of your assets  
while you take  
care of other  
business.”***



We can keep your operations running smoothly with high quality spares, expert servicing, and reliable maintenance support. Ensure minimal downtime and maximum efficiency by speaking with one of our dedicated team.

Do you have a bespoke requirement? Please contact us...

