



RWM 60HD Baling Press

Product Specification

 Heavy Duty Waste Baler

 **Riverside**

wastemachinery.co.uk

RWM 60HD Baling Press

Powerful Compaction in a Compact Design

The robust RWM 60 HD may be compact, but it's built to handle tough recyclables like paint tins, drinks cans, catering cans, and plastic bottles with ease. This heavy-duty baler helps reduce waste volume, free up site space, improve environmental efficiency, and even generate revenue from recyclables—all in a neat, space-saving design.

Basic Specification

- ✓ 12 month warranty
- ✓ Fitted retaining claws to prevent material spring back
- ✓ Compact design – ideal for even the most space-constrained locations
- ✓ Convenient top-loaded feed aperture to prevent material fall out
- ✓ Produces bales of up to 25kg – up to 1500 drinks cans
- ✓ Produces bales of up to 32kg – up to 1500 drinks bottles
- ✓ Multi-strapping tying system for a secure bale
- ✓ 16amp single phase electrics
- ✓ 13 Tonne press force
- ✓ Automatic bale ejection
- ✓ Can be sited outdoors

Features

- ✓ Top loading baler
- ✓ PET plastic bottle bale weight up to 40 kg
- ✓ Aluminium Can bale weight up to 25kg
- ✓ Cross strapping tying system to hold difficult material in place
- ✓ Retainers to prevent material spring back
- ✓ Bale ejection.



Technical Specifications

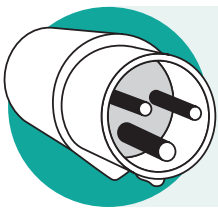
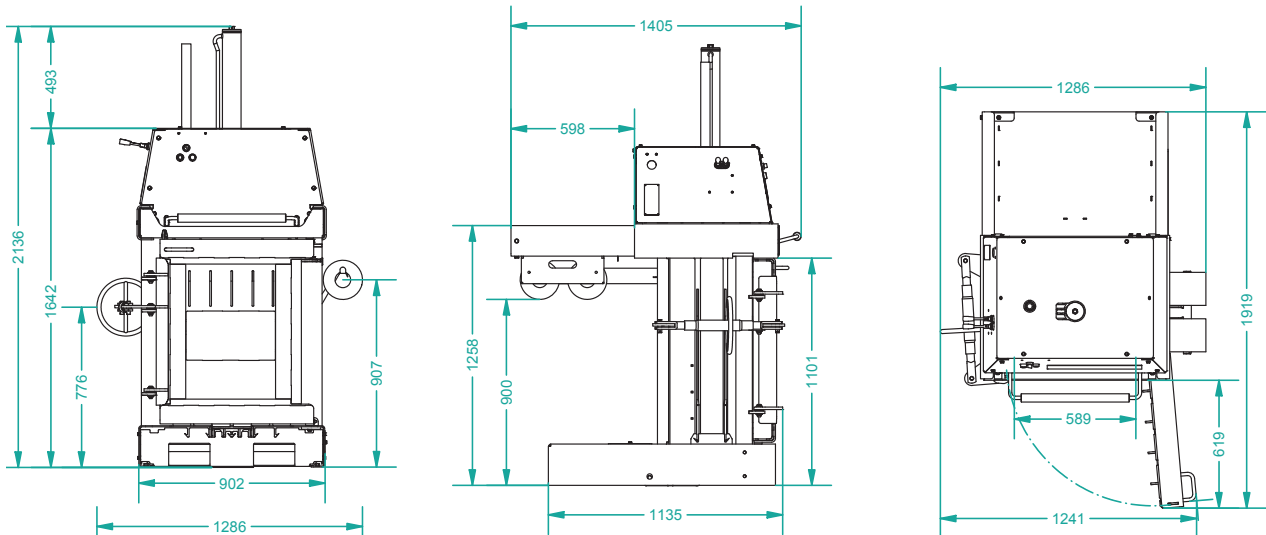

- Operating Voltage: 220–240V
- Frequency: 50Hz
- Connector Plug: 16A, single-phase, standard 3-pin (BS 1363) plug
- MCB (Miniature Circuit Breaker): Type D

Press Force	13 tonnes
Loading Aperture (H x W x D)	600 x 400mm
Bale Weight	25 - 60kg depending on material
Bale Dimensions (H x W x D)	650 x 600 x 400mm
Cycle Time	25 seconds
Noise	68 decibels
Machine Weight	706kg
Power Supply (kW-V-Hz)	16amp single phase 2.2kW 220-240V-50Hz
Overall Dimensions (H x W x D)	2144 x 1267 x 1328mm

Optional Extras

Customise your machine with the optional extras listed below – designed to help you get the most from your equipment, and to suit your specific requirements, operational needs, or site layout.



Galvanised finish
Corrosion-resistant coating for outdoor or harsh, wet environments.



Available in 16amp 3 phase
Supplied in 16amp 3 phase to suit your preferred or existing power supply.