



# RWM Bag Press

Product Specification

# RWM Bag Press

## Effortlessly Manage Loose Waste

A Riverside bag press is the ideal solution for compacting both wet and dry waste, including organics. With simple colour-coded controls, it transforms messy waste into neat, sealed bags, improving hygiene and site organisation. Offering a compaction ratio of up to 10:1, it saves space, reduces handling time, and lowers disposal costs for a cleaner, more efficient waste management process.

## Basic Specification

- ✓ 12 months warranty
- ✓ Can be sited outside
- ✓ Low operating height
- ✓ 13amp single phase electrics
- ✓ 3 tonne press force
- ✓ Simple operator controls

## Features

- ✓ Suitable for wet and dry kitchen waste
- ✓ Compaction ratio of 10:1 (depending on material used)
- ✓ Fully enclosed for safe operation
- ✓ Split chamber for quick and simple bag removal
- ✓ Top loaded



# Technical Specifications

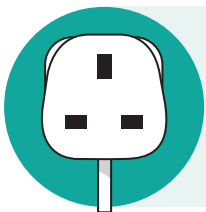
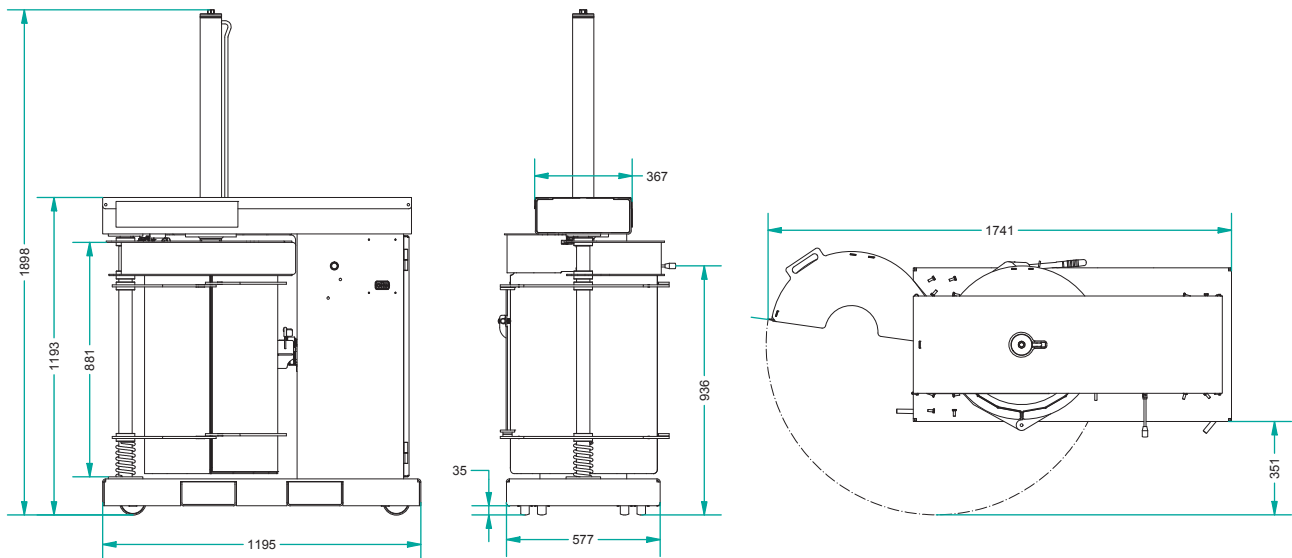

- Operating Voltage: 220–240V
- Frequency: 50Hz
- Connector Plug: 13A, single-phase, standard 3-pin (BS 1363) plug
- MCB (Miniature Circuit Breaker): Type C or above

Press Force	3 tonnes
Compaction Ratio	10:1 depending on material
Cycle Time	20 seconds
Noise	68 decibels
Machine Weight	325kg
Power Supply	13amp single phase 1.5kW 220-240V - 50Hz
Overall Dimensions	1861 × 1200 × 630mm

# Optional Extras

Customise your machine with the optional extras listed below – designed to help you get the most from your equipment, and to suit your specific requirements, operational needs, or site layout.



**Galvanised finish**  
Corrosion-resistant coating for outdoor or harsh, wet environments.



**Auto PLC control panel**  
Includes automatic compaction cycle, E-stop, and key-lock control.



**Available in 16amp 3 phase**  
Supplied in 16amp 3 phase to suit your preferred or existing power supply.