



RWM SC2500 Static Compactor

Product Specification

 Compact Waste Baler

 **Riverside**

wastemachinery.co.uk

RWM SC2500

Static Compactor

Effortlessly Manage High-Volume Waste

Riverside static compactors are powerful, space-saving solutions for businesses generating large volumes of waste or recyclables. Designed for maximum efficiency, they significantly reduce waste volume, cutting collection costs and improving site cleanliness. Highly configurable to suit individual needs, these compact yet robust machines offer hassle-free operation, making waste management simpler, cleaner, and more cost-effective.

Basic Specification

- ✓ Open top hopper for easy hand loading or mechanical loading
- ✓ Built in power pack with all controls enclosed
- ✓ PLC controlled system
- ✓ Push blade packing mechanism
- ✓ Galvanised hooks and container ratchets
- ✓ Robust design and heavy duty construction
- ✓ Built to CHEM specification
- ✓ Designed and manufactured to EU machinery directives and certified CE compliant



Benefits

- ✓ Reduced waste collection costs
- ✓ Designed with maximum operator safety in mind
- ✓ Low running costs with Riverside low energy power pack systems
- ✓ Low energy carbon footprint
- ✓ Easy to operate and load
- ✓ Reduced manual handling and risk to staff
- ✓ Streamlined operations
- ✓ Maximum payload on each lift
- ✓ Maximum performance and life long reliability
- ✓ Available in 2 power pack options – 26T and 38T

Optional extras



Open top hopper for bulk loading



Through wall chute loading



GSM modules with performance monitoring and notification system



Bin tipper for 120 to 1100 litre wheel carts



Enclosed hopper with interlocked access door



Off-line power pack cooling systems



Conveyor interfaced hoppers



Text & email GSM notification system



Rear loading bin lifting option



Guide rail and in-floor plates



Auto starting systems



Off dock loading

RWM SC2500 - with STD open hopper

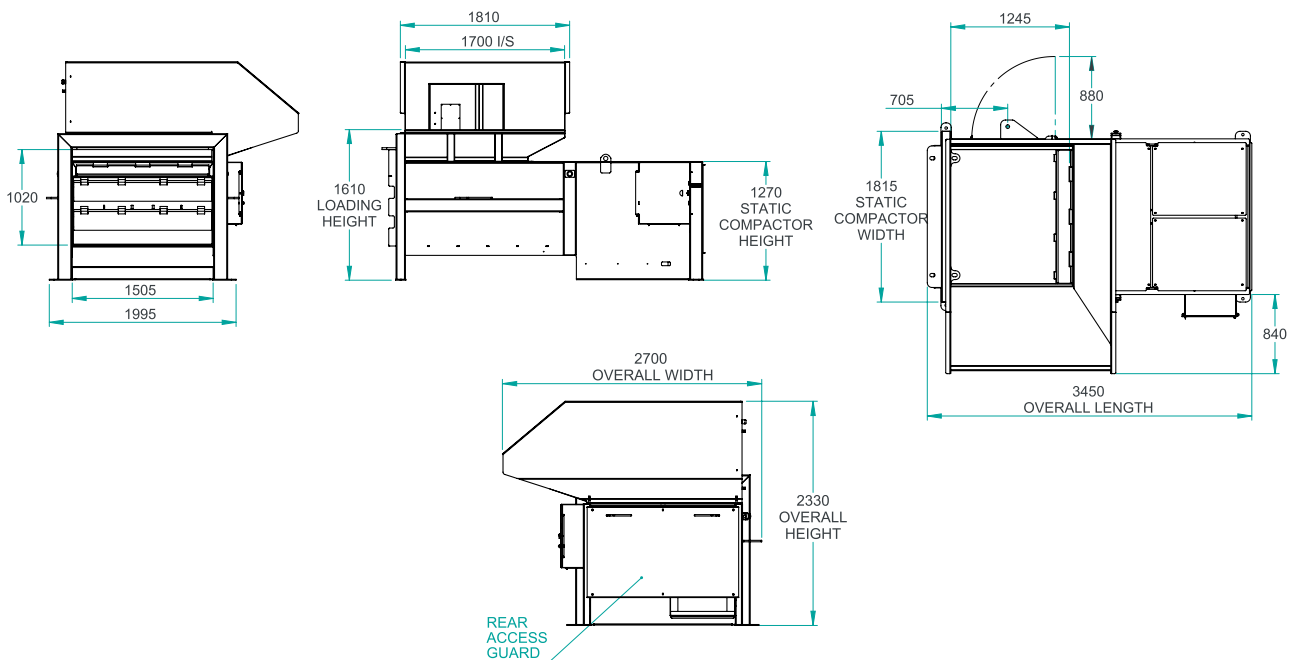
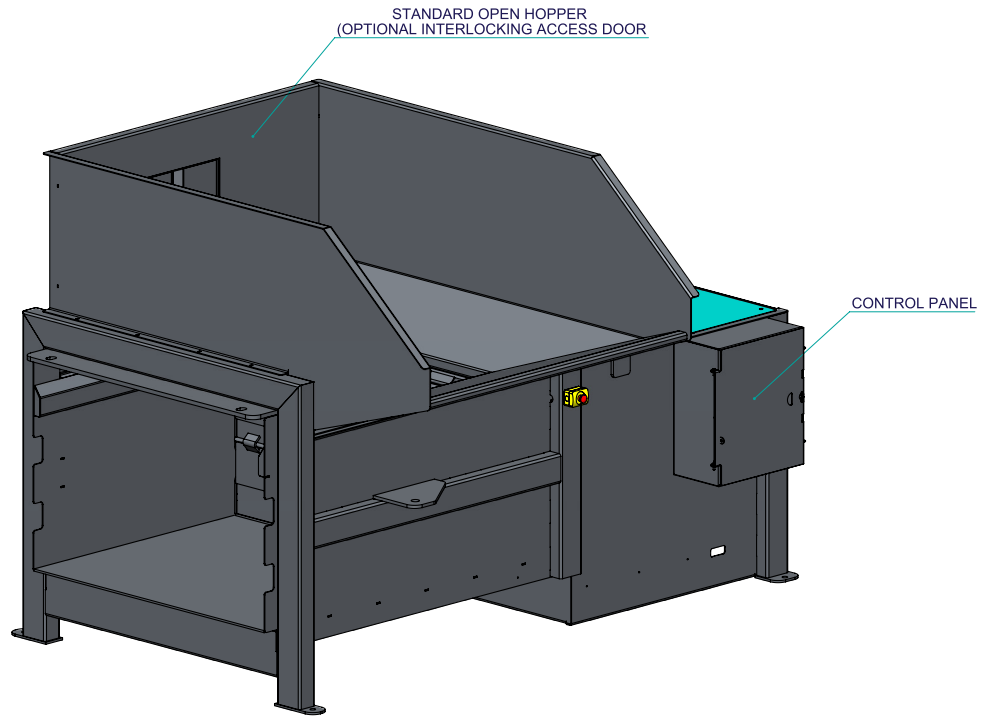

RWM SC2500 - with open hopper & bin lifter

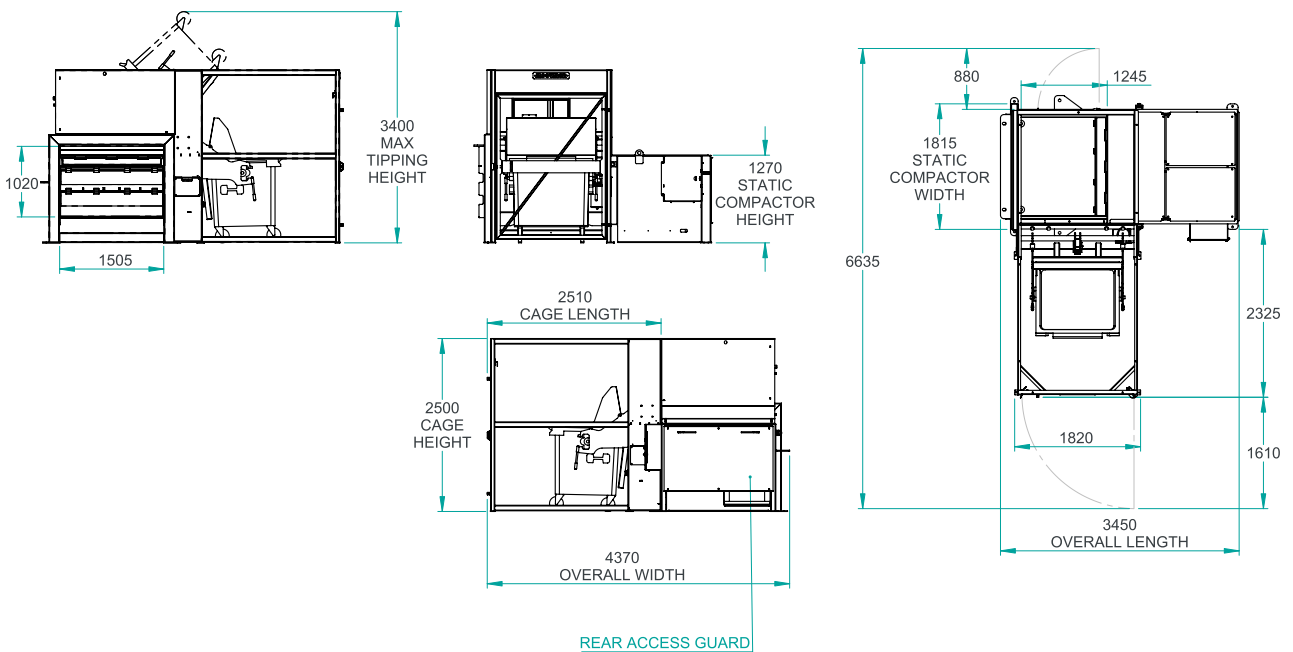
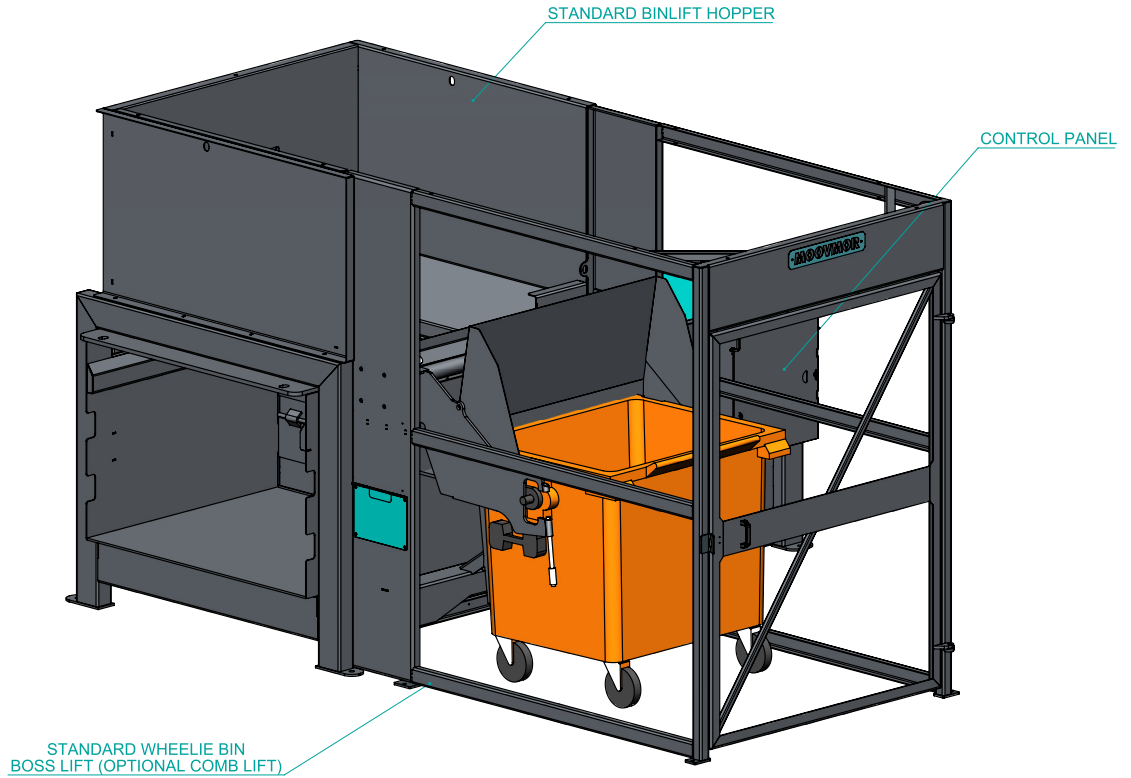

Technical Specifications

Specification	SC2500-26T	SC2500-38T
Compaction force @ 200 bar (tonnes)	26	38
Motor power (kw)	5.5 kW, 16A	5.5 kW, 16A
Power supply	3 PH + E + N, 400V, 50HZ	3 PH + E + N, 400V, 50HZ
Std factory set cycle time (secs)	47	56
Fast cycle options (secs)	37	34
Additional power pack options	11 - 15kw	11 - 15kw
Charge box volume (m ³)	1.77	1.77
Compactor length (mm)	3450	3450
Compactor width (including clamps - mm)	2700	2700
Compactor height	2330	2330
Charge box loading height (mm)	1610	1610
Chamber width	1505	1505
Chamber length	1250	1250
Chamber height	1020	1020
Compactor weight	2500	2500

Due to company policy of continued product development design and specifications are subject to change without notice.