

Fig. 1 - Left Hand - Open In

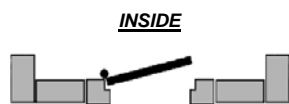

Fig. 2 - Right Hand - Open In

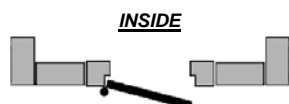

Fig. 3 - Left Hand - Open Out

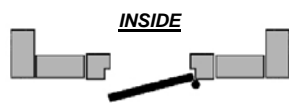

Fig. 4 - Right Hand - Open Out

European style reversible lockcase range to suit euro profile & oval profile cylinders. Dimensions to DIN 18251, class 3.

DE6102/17/1LH

anti-panic lockcase - 60mm backset - split follower - fig. 1 - sqfe sat. stainless steel

DE6102/5/1LH/SB

anti-panic lockcase - 60mm backset - split follower - fig. 1 - sqfe sat. brass

DE6102/6/1LH/PB

anti-panic lockcase - 60mm backset - split follower - fig. 1 - sqfe pol. brass

DE6102/17/2RH

anti-panic lockcase - 60mm backset - split follower - fig. 2 - sqfe sat. stainless steel

DE6102/5/2RH/SB

anti-panic lockcase - 60mm backset - split follower - fig. 2 - sqfe sat. brass

DE6102/6/2RH/PB

anti-panic lockcase - 60mm backset - split follower - fig. 2 - sqfe pol. brass

DE6102/17/3LH

anti-panic lockcase - 60mm backset - split follower - fig. 3 - sqfe sat. stainless steel

DE6102/5/3LH/SB

anti-panic lockcase - 60mm backset - split follower - fig. 3 - sqfe sat. brass

DE6102/6/3LH/PB

anti-panic lockcase - 60mm backset - split follower - fig. 3 - sqfe pol. brass

DE6102/17/4RH

anti-panic lockcase - 60mm backset - split follower - fig. 4 - sqfe sat. stainless steel

DE6102/5/4RH/SB

anti-panic lockcase - 60mm backset - split follower - fig. 4 - sqfe sat. brass

DE6102/6/4RH/PB

anti-panic lockcase - 60mm backset - split follower - fig. 4 - sqfe pol. brass

DE6102/17/1PCE/LH

anti-panic lockcase - 60mm backset - split follower - fig 1/3 - sqfe sat. stainless steel

# D&E 6100 series lockcases - extra heavy duty

CI/SfB		
	31/59	Xt 7
September 2007		

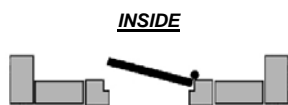

Fig. 1 - Left Hand - Open In

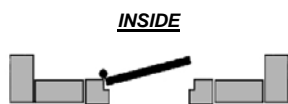

Fig. 2 - Right Hand - Open In

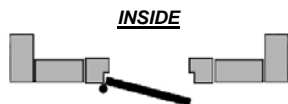

Fig. 3 - Left Hand - Open Out

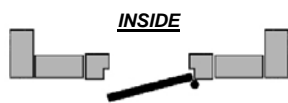

Fig. 4 - Right Hand - Open Out

DE6102/17/1PCE/RH

DE6102/5/1PCE/LH

DE6102/5/1PCE/RH

DE6102/6/1PCE/LH

DE6102/6/1PCE/RH

anti-panic lockcase - 60mm backset -  
through follower - fig 2/4 - sqfe sat. stainless steel  
anti-panic lockcase - 60mm backset -  
through follower - fig 1/3 - sqfe sat. brass  
anti-panic lockcase - 60mm backset -  
through follower - fig 2/4 - sqfe sat brass  
anti-panic lockcase - 60mm backset -  
through follower - fig 1/3 - sqfe pol. brass  
anti-panic lockcase - 60mm backset -  
through follower - fig 2/4 - sqfe pol. brass

Operation:

lever operation retracts the latchbolt and deadbolt from the relevant handed side at all times - see handings below

Handings:

Fig 1: open in anti-clockwise close  
Fig 2: open in clockwise close  
Fig 3: open out anti-clockwise close  
Fig 4: open out clockwise close

DE6104/17

DE6104/5/SB

DE6104/6/PB

DE6105/17

DE6105/5/SB

DE6105/6/PB

DE6106/17

DE6106/5/SB

DE6106/5/PB

DE6107/17

DE6107/5/SB

DE6107/6/PB

DE6108/17

DE6108/5/SB

DE6108/6/PB

DE6109/17

DE6109/5/SB

DE6109/6/PB

bathroom lock (8/8mm followers) -  
60mm backset - sqfe sat. stainless steel  
bathroom lock (8/8mm followers) -  
60mm backset - sqfe sat. brass  
bathroom lock (8/8mm followers) -  
60mm backset - sqfe pol. brass  
latch - 60mm backset - sqfe sat. stainless steel  
latch - 60mm backset - sqfe sat. brass  
latch - 60mm backset - sqfe pol. brass  
nightlatch with holdback function -  
60mm backset - sqfe sat. stainless steel  
nightlatch with holdback function -  
60mm backset - sqfe sat. brass  
nightlatch with holdback function -  
60mm backset - sqfe pol. brass  
nightlatch - 60mm backset - sqfe sat. stainless steel  
nightlatch - 60mm backset - sqfe sat. brass  
nightlatch - 60mm backset - sqfe pol. brass  
deadlock - 60mm backset - sqfe sat. stainless steel  
deadlock - 60mm backset - sqfe sat. brass  
deadlock - 60mm backset - sqfe sat. brass  
sashlock - 60mm backset - sqfe sat. stainless steel  
sashlock - 60mm backset - sqfe sat. brass  
sashlock - 60mm backset - sqfe pol. brass

Case:

zinc plated white lacquered

Centres:

profile cylinder: 72mm  
wc: 78mm

Deadbolt:

20mm double throw, die cast - nickel plated

Follower:

8mm, brass with spring grip, heavy sprung to suit unsprung door furniture - through follower unless otherwise stated

Latchbolt:

reversible, die cast - nickel plated.

Supplied complete with fixings and strike plate.

NOTE:- 13mm & 25mm rebate sets are available to order

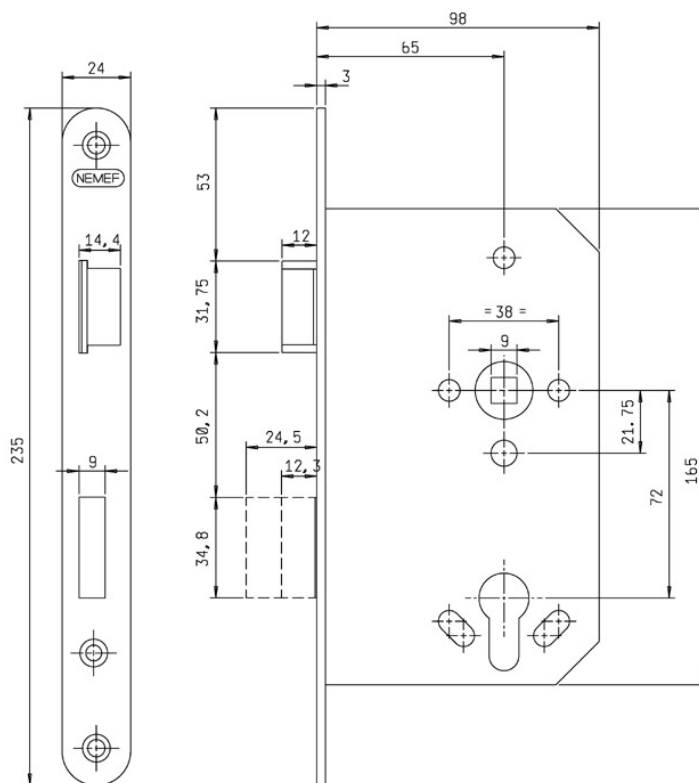

European style anti-panic lockcase to suit euro profile cylinders.  
Tested to DIN 18250.

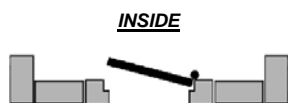

Fig. 1 - Left Hand - Open In

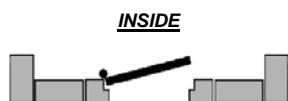

Fig. 2 - Right Hand - Open In

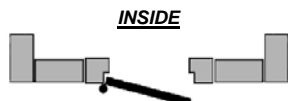

Fig. 3 - Left Hand - Open Out

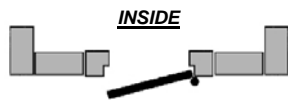

Fig. 4 - Right Hand - Open Out

DE1769/77/1LH

DE1769/77/2RH

DE1769/56/3LH

DE1769/56/4RH

DE1769/35/1PCE/LH

DE1769/35/1PCE/RH

anti-panic lockcase - 65mm backset -  
split follower - rfe sat. stainless steel  
anti-panic lockcase - 65mm backset -  
split follower - rfe sat. stainless steel  
anti-panic lockcase - 65mm backset -  
split follower - rfe sat. stainless steel  
anti-panic lockcase - 65mm backset -  
split follower - rfe sat. stainless steel  
anti-panic lockcase - 65mm backset -  
through follower - rfe sat. stainless steel  
anti-panic lockcase - 65mm backset -  
through follower - rfe sat. stainless steel

Case:

galvanised

Centres:

profile cylinder: 72mm

Deadbolt:

24.5mm, cast steel - zinc plated.

Follower:

9mm heavy sprung to suit unsprung door furniture.

Latchbolt:

handed, cast steel - chrome plated.

Operation:

lever operation from the inside retracts the latchbolt and deadbolt at all times. External key operation retracts the deadbolt only, lever handle operation retracts the latchbolt.

Handings:

See diagram and / or overleaf

# D&E 1769 series anti-panic lockcase

CI/SfB		
	31/59	Xt 7
September 2007		

Handings:

Fig 1: open in anti-clockwise close

Fig 2: open in clockwise close

Fig 3: open out anti-clockwise close

Fig 4: open out clockwise close

*Strike plates or box strikes available to order.*



INSIDE



Fig. 1 - Left Hand - Open In

INSIDE



Fig. 2 - Right Hand - Open In

INSIDE



Fig. 3 - Left Hand - Open Out

INSIDE



Fig. 4 - Right Hand - Open Out

Sales: 01733 896123



J-1004

Fax: 01733 894466

E&OE

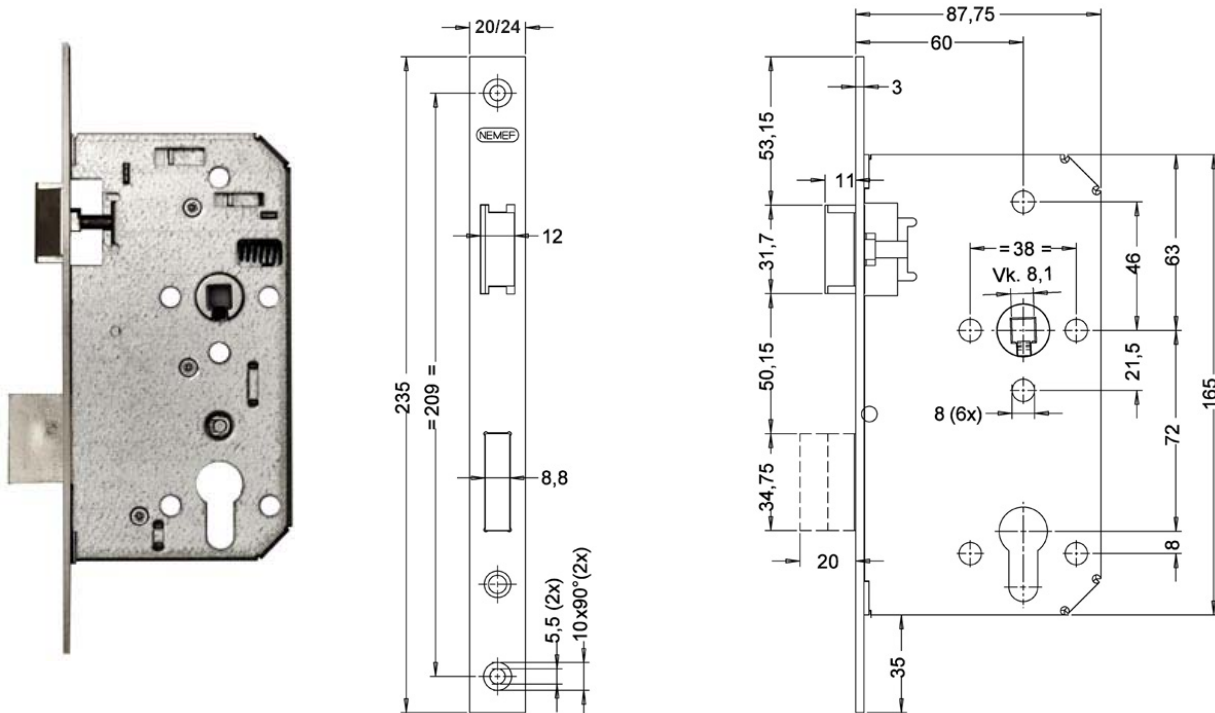

European style reversible lockcase range to suit euro profile cylinders.  
Dimensions to DIN 18251, class 3.

DE6602/60/32	sashlock - 60mm backset - 20mm sqfe	sat. stainless steel
DE6602/60/36	sashlock - 60mm backset - 24mm sqfe	sat. stainless steel
DE6622/60/32	deadlock - 60mm backset - 20mm sqfe	sat. stainless steel
DE6622/60/36	deadlock - 60mm backset - 24mm sqfe	sat. stainless steel
DE6632/60/32	latch lock - 60mm backset - 20mm sqfe	sat. stainless steel
DE6632/60/36	latch lock - 60mm backset - 24mm sqfe	sat. stainless steel
DE6642/60/32	bathroom lock (8/8mm followers) - 60mm backset - 20mm sqfe	sat. stainless steel
DE6642/60/36	bathroom lock (8/8mm followers) - 60mm backset - 20mm sqfe	sat. stainless steel

Case: galvanised.

Centres: profile cylinder: 72mm  
wc: 78mm

Deadbolt: 20mm double throw, die cast - nickel plated.

Follower: 8mm, brass with spring grip, heavy sprung to suit unsprung door furniture.

Latchbolt: reversible, die cast - nickel plated.

Supplied complete with fixings and strike plate.

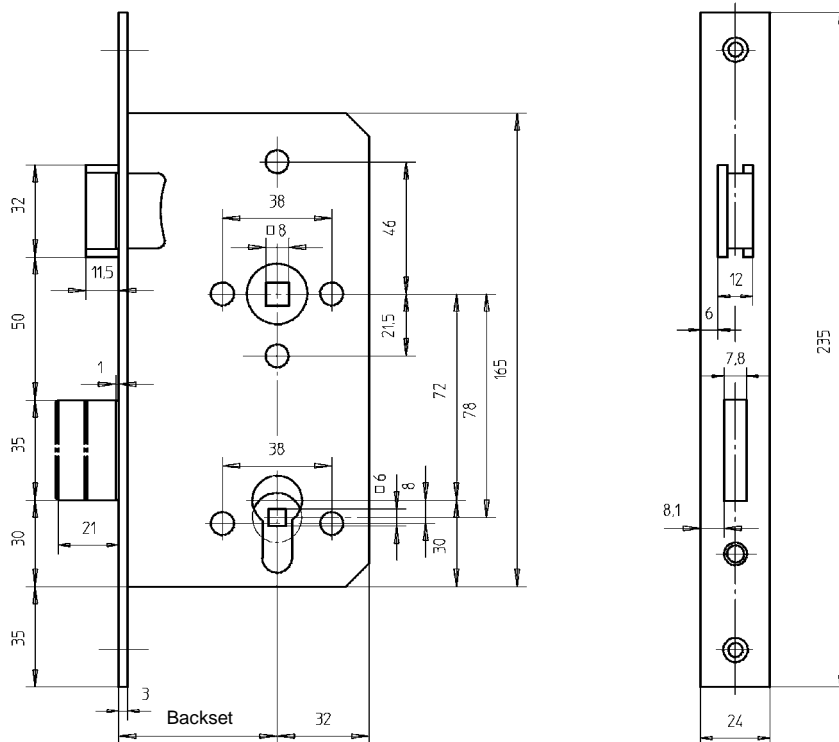

European style reversible lockcase range to suit both profile cylinders.  
Tested to DIN 18251, class 3.

DE17688FW/55/216	nightlatch - 55mm backset - sqfe	sat. stainless steel
DE17688FW/55/216R	nightlatch - 55mm backset - rfe	sat. stainless steel
DE17688WO/55/216	sashlock - 55mm backset - sqfe	sat. stainless steel
DE17688WO/55/216R	sashlock - 55mm backset - rqfe	sat. stainless steel
DE17688RO/55/216	deadlock - 55mm backset - sqfe	sat. stainless steel
DE17688RO/55/216R	deadlock - 55mm backset - rfe	sat. stainless steel
DE14288OO/55/216	bathroom lock - 8 / 8mm - 55mm backset - sqfe	sat. stainless steel
DE14288OO/55/216R	bathroom lock - 8 / 8mm - 55mm backset - rfe	sat. stainless steel

DE17688FW/65/216	nightlatch - 65mm backset - sqfe	sat. stainless steel
DE17688FW/65/216R	nightlatch - 65mm backset - rfe	sat. stainless steel
DE17688WO/65/216	sashlock - 65mm backset - sqfe	sat. stainless steel
DE17688WO/65/216R	sashlock - 65mm backset - rqfe	sat. stainless steel
DE17688RO/65/216	deadlock - 65mm backset - sqfe	sat. stainless steel
DE17688RO/65/216R	deadlock - 65mm backset - rfe	sat. stainless steel
DE14288OO/65/216	bathroom lock - 8 / 8mm - 65mm backset - sqfe	sat. stainless steel
DE14288OO/65/216R	bathroom lock - 8 / 8mm - 65mm backset - rfe	sat. stainless steel

Case: galvanised.

Backset: **55 / 60 / 65 / 70 & 80mm**  
Other backsets are available - please contact the sales team for details  
(backsets shown in bold are standard stock lines)

## D&E 17688 series lockcases - heavy duty

CI/SfB			
	31/59	Xt 7	
September 2007			



Centres:                      profile cylinder:                      72mm  
   wc:    78mm

Deadbolt:                      20mm double throw, cast steel - nickel plated.

Follower:                      8mm, brass with pinch grip in bearings, heavy sprung  
   to suit unsprung door furniture.

Latchbolt:                      reversible, cast steel - nickel plated.

Supplied complete with fixings and strike plate.

*NOTE:-                      13mm & 25mm rebate sets are available to order*

CI/SfB	31/59	Xt 7	
September 2007			

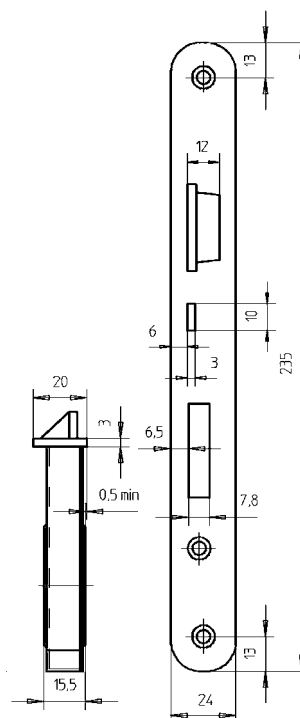

*Right hand*      *Left hand*

*( Din Standard )*

## D&E 17570 series anti-thrust lockcases

CI/SfB			
	31/59	Xt 7	
September 2007			



Latchbolt: handed, cast mazak.

Supplied complete with fixings and strike plate.

*Special Option:* Whisper comfort - silent latch operation available to order.

*NOTE:- 13mm & 25mm rebate sets are available to order*

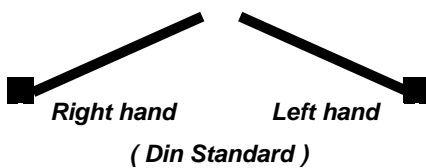

Sales: 01733 896123



J-1009

Fax: 01733 894466

E&OE

# D&E 17588 series lockcases - medium duty

CI/SfB

31/59

Xt 7

September 2007

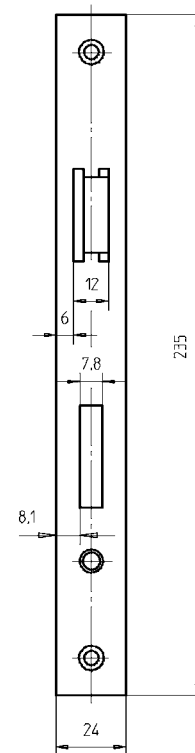
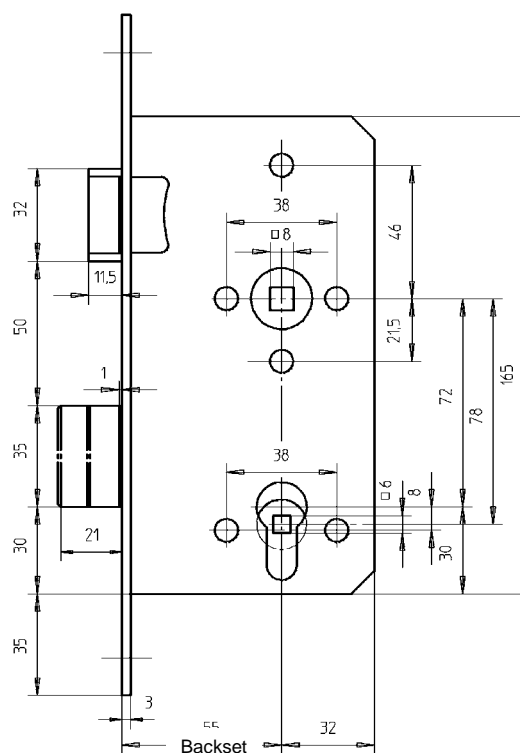

European style reversible lockcase range to suit profile cylinders.  
Tested to DIN 18251, class 3.

DE17588FW55/216

nightlatch - 55mm backset - sqfe

sat. stainless steel

DE17588WO/55/216

sashlock - 55mm backset - sqfe

sat. stainless steel

DE17588RO/55/216

deadlock - 55mm backset - sqfe

sat. stainless steel

DE14188OO/55/216

bathroom lock - 8 / 8mm - 55mm

backset - sqfe

sat. stainless steel

Case: galvanised.

Centres: profile cylinder: 72mm  
wc: 78mm

Deadbolt: 20mm double throw, cast steel - nickel plated.

Follower: 8mm with steel inserts, heavy sprung to suit unsprung door furniture.

Latchbolt: reversible, cast mazak.

Supplied complete with fixings and strike plate.

NOTE:- 13mm & 25mm rebate sets are available to order

Sales: 01733 896123



J-1010

Fax: 01733 894466

E&OE

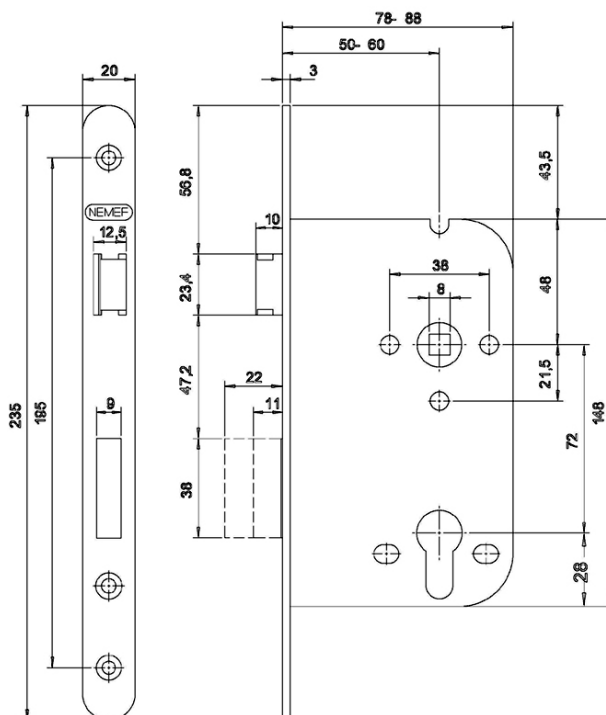

European style reversible lockcase range to suit euro profile cylinders.  
Dimensions to DIN 18251, class 1.

DE344/SS	bathroom lock (8/8mm followers) - 60mm backset - rfe	sat. stainless steel
DE345/SS	latch - 60mm backset - rfe	sat. stainless steel
DE348/SS	deadlock - 60mm backset - rfe	sat. stainless steel
DE349/SS	sashlock - 60mm backset - rfe	sat. stainless steel

Case: steel, grey lacquered.

Centres: profile cylinder: 72mm  
wc: 78mm

Deadbolt: 20mm double throw, die cast - nickel plated.

Follower: 8mm, die-cast zinc plated.

Latchbolt: reversible, die cast - nickel plated.

Supplied complete with fixings and strike plate.



## D&E contractors cylinder plug

The D&E cylinder plug is available in ten (10) differs. It is designed so that the contractor can limit access to, or secure a room until the cylinders arrive. Installation / removal is achieved in the same manner as a euro profile cylinder.

DE7460/401/1	key series 1
DE7460/401/2	key series 2
DE7460/401/3	key series 3
DE7460/401/4	key series 4
DE7460/401/5	key series 5
DE7460/401/6	key series 6
DE7460/401/7	key series 7
DE7460/401/8	key series 8
DE7460/401/9	key series 9
DE7460/401/10	key series 10

Operation: the key acts as a cylinder cam and operates the lock as a normal profile cylinder does.

*Also available is a conversion plug to convert a euro profile lockcase to a wc function - 6mm follower incorporated - DE57100*

*This contractors cylinder insert is to be used as a temporary cylinder and should not be used in lieu of a permanent cylinder*

## D&E hook spindle - DESP5001/65



For use on applications where a lever is installed on one side of the door only. The hook is secured by tightening the grub screw located down the centre of the spindle.

DESP5001/65 hook spindle - 65mm

Door thickness: 50 - 55mm  
Diameter: 8mm

Supplied complete with allen key.

*Suitable for use with any D&E lockcase with an 8mm through follower.*

CI/SfB			
	31/59	Xt 7	
September 2007			

## ***D&E half spindle - PVCu handles***



For use with PVCu handles with a bolt through fixing - lever / offset lever or pad.

*DESP5011/55* half spindle - 55mm

*DESP5011/65* half spindle - 65mm

*DESP5011/75* half spindle - 75mm

Diameter: 8mm

Supplied complete with allen key.

*Suitable for use with any D&E lockcase with an 8mm through follower.*

## ***D&E split spindle***



For use on applications where anti-panic locks with a 8mm split follower are installed.

*DESP5002/100* 8mm split spindle - 50 / 50mm

*DESP5003/100* 9mm split spindle - 50 / 50mm

Door thickness: 54mm

CI/SfB			
	31/59	Xt 7	
September 2007			



## ***D&E split spindle - PVCu handles***

For use with PVCu handles with a bolt through fixing - lever / lever or pad.

Primarily for use on nightlatch multi-point locks.

*DESP5004/120*      8mm split spindle - 55 / 65mm



## ***D&E Pitts mortice spindle***

For use on applications where a set of levers or knob furniture is used which rely on the rose or backplate fixings to secure them to the door.

This spindle is highly recommended for use on handles for PVCu and Aluminium applications.

*DESP5005/150*      5mm pitts mortice spindle - 150mm

*DESP5007/150*      7mm pitts mortice spindle - 150mm

*DESP5008/150*      8mm pitts mortice spindle - 150mm

All above D&E Pitts mortice spindles will suit a door thickness of 90mm

***D&E spindle sleeve range.***

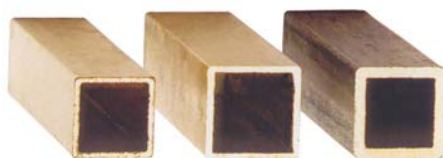

<i>DERBSL58</i>	spindle sleeve 5mm up to 8mm
<i>DERBSL67</i>	spindle sleeve 6mm up to 7mm
<i>DERBSL68</i>	spindle sleeve 6mm up to 8mm
<i>DERBSL78</i>	spindle sleeve 7mm up to 8mm
<i>DERBSL89</i>	spindle sleeve 8mm up to 9mm

Dimensions: 15mm standard length

Packaging: each

<i>DERBSL67/1</i>	spindle sleeve 6mm up to 7mm
<i>DERBSL68/1</i>	spindle sleeve 6mm up to 8mm
<i>DERBSL78/1</i>	spindle sleeve 7mm up to 8mm

Dimensions: 1 metre length

Packaging: each

## Notes

CI/SfB			
	31/59	Xt 7	
September 2007			

This image shows a single sheet of white paper with horizontal ruling lines. The lines are evenly spaced and run across the width of the page. There are no margins, text, or other markings on the paper.

Sales: 01733 896123



**J-1016**

Fax: 01733 894466

E&OE