

KWS door buffers protect your walls and fittings. For instance, they stop the balcony door hitting the kitchen shelf for the umpteenth time or the lever handle making its mark on the wall yet again. We supply door buffers for an extremely wide range of uses, made from four different materials: aluminium, stainless steel, steel and brass. The following pages tell you all you need to know about types of door buffers, applications and correct installation.

Protected against impact.

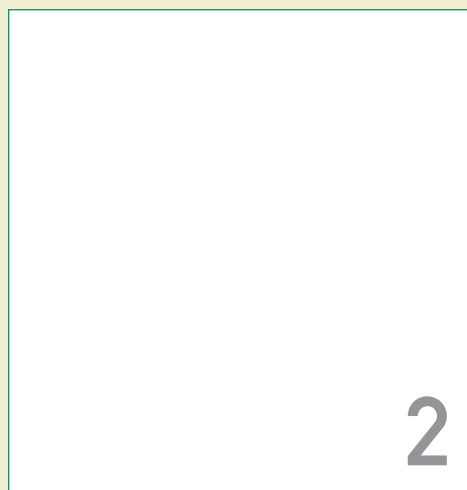



2

Door buffers | 100

Different applications and operating methods of door buffers

Door buffers are needed for all types of doors and KWS produces a suitably wide range. While flat and compact door buffers are more popular indoors, in outdoor areas door buffers are used which absorb the impact of a heavy door thanks to a spring mechanism. Robust door buffers should be chosen for heavily used doors in public build-

ings. Door buffers are also classified according to whether they are installed on the ground or the wall.

The following examples should assist you in making your choice:

2

Light to medium weight inside doors:



2001..

Ground



2003..

Ground



2095..

Ground



2110..

Ground (spring - loaded)



2007..

Wall



2076..

Wall

Medium weight to heavy inside and outside doors:



2024..

Ground (spring - loaded)



2051..

Wall (spring - loaded)

Heavy doors and gates:



2019..

Ground (spring - loaded)



2120..

Wall (spring - loaded)

Please note when installing door buffers:

As the forces between door and buffer must not be underestimated, the buffer should not be allowed to make contact with the lever or door handle. The buffer should make contact with the door panel as far out as possible, at right angles. Our range includes heavy wall buffers for instance, with adjustable angles (e.g. 2051).

A ground buffer should be trip-proof and should therefore be placed as close to the wall as possible. Flat buffers such as the well-known 2001 or the 2003 are basically relatively trip-proof.

Clean installation and insertion of pegs to prevent distortion are all-important. KWS buffers either include these pegs or a multiple-point fixing. Outdoors a built-in variant (e.g. model 2023 or 2019) is recommended.

Please also note product-related recommendations.

Overview

2



Page 100



Page 101



Page 102



Page 103



Page 104



Page 104



Page 105



Page 105



Page 106



Page 107



Page 108



Page 108



Page 109



Page 109



Page 110



Page 110



Page 111



Page 112



Page 113



Page 114



Page 114



Page 115



Page 116



Page 117



Page 118



Page 119



Page 120



Page 121



Page 122



Page 123

Door buffers

2

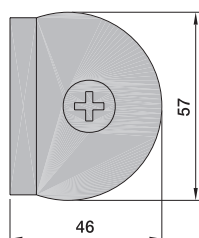
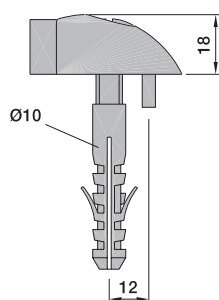

2001.. with fixings
2002.. without fixings

- 1) Made of cast aluminium, buffer made of rubber, black, screw made of stainless steel
- 2) Made of pressed brass, buffer made of plastic, black, screw made of brass
- 3) Made of stainless steel, buffer made of plastic, black, screw made of stainless steel
- 4) Made of plastic, buffer made of rubber, black, screw made of brass

On request the article is also available with buffer, white

Application

Door weight up to 50 kg

Standard finish

- a) Aluminium, E5 treated
 - .31 KWS 1 silver anodised
 - .32 KWS 2 nickel silver anodised
 - .33 KWS 3 brass-coloured anodised
 - .37 KWS 5 dark brown anodised
- b) Brass
 - .62 dull brushed and colourless coated
 - .63 nickelized
 - .66 polished and colourless coated
- c) Aluminium
 - .70 plastic coated
- d) Stainless steel
 - .82 dull brushed
 - .83 polished

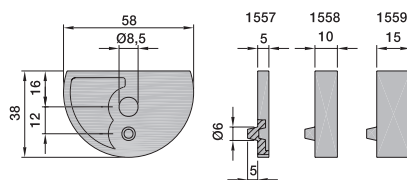

Packing Unit

20 pieces

Weight per piece

Aluminium	0.065 kg
Brass	0.075 kg
Stainless steel	0.075 kg
Plastic	0.045 kg

Mounting

The door buffer should be fitted to the floor at the maximum possible distance from the hinged edge of the door. The pin, embedded in the floor, prevents the buffer from turning.

For adjustment in height we recommend using pad no. 1557.. (5 mm) or no. 1558.. (10 mm) or 1559.. (15 mm).

Order example

Piece	Item No.	Finish
...piece	2001	31

1557.. Pad 5 mm high
1558.. Pad 10 mm high
1559.. Pad 15 mm high

Standard finish see 2001.. and 2002..

2003.. with fixings
2004.. without fixings

Made of aluminium, brass or stainless steel, screw made of stainless steel

Buffer made of rubber, black

On request the article is also available with buffer, white

Application

Door weight up to 40 kg

Standard finish

- a) Aluminium, E5 treated
 - .31 KWS 1 silver anodised
 - .32 KWS 2 nickel silver anodised
 - .33 KWS 3 brass-coloured anodised
 - .37 KWS 5 dark brown anodised
- b) Brass
 - .62 dull brushed and colourless coated
 - .66 polished and colourless coated
- c) Aluminium
 - .70 plastic coated
- d) Stainless steel
 - .82 dull brushed
 - .83 polished



Packing Unit

20 pieces

Weight per piece

Aluminium	0.060 kg
Brass	0.075 kg
Stainless steel	0.070 kg

Mounting

The door buffer should be fitted to the floor at the maximum possible distance from the hinged edge of the door. The pin, embedded in the floor, prevents the buffer from turning.

For adjustment in height we recommend using pad no. 2559.. (15 mm).

2559.. Pad 15 mm high

Standard finish

- a) Aluminium
 - .70 plastic coated

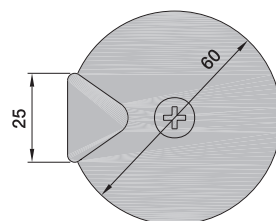
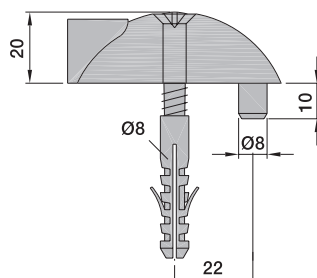

2

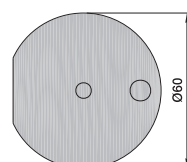
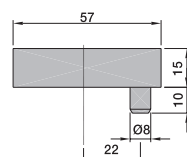

Order example

Piece	Item No.	Finish
...piece	2003	31

Door buffers

2



- 2090.. with fixings and pin
- 2091.. without fixings, with pin
- 2092.. with 2 fixings

1) Made of aluminium or stainless steel with screws of stainless steel

2) Made of brass with screws of brass

Buffer made of rubber, black

Application

Door weight up to 80 kg

Standard finish

- a) Aluminium, E5 treated
 - .31 KWS 1 silver anodised
 - .32 KWS 2 nickel silver anodised
 - .33 KWS 3 brass-coloured anodised
 - .37 KWS 5 dark brown anodised
- b) Brass
 - .62 dull brushed and colourless coated
 - .66 polished and colourless coated
- c) Aluminium
 - .70 plastic coated
- d) Stainless steel
 - .82 dull brushed
 - .83 polished

Packing Unit

10 pieces

Weight per piece	(2090..)
Aluminium	0.160 kg
Brass	0.210 kg
Stainless steel	0.190 kg

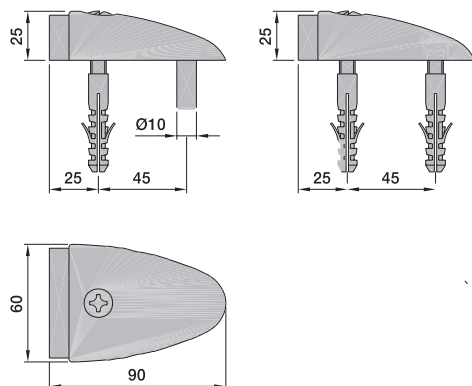

Mounting

The door buffer should be fitted to the floor at the maximum possible distance from the hinged edge of the door. The pin (2090../2091..), or screw (2092..), embedded in the floor, prevents the buffer from turning.

For adjustment in height we recommend using pad no. 2590.. (15 mm).

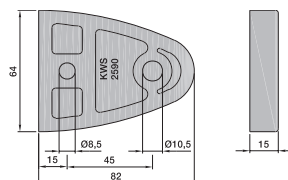

2590.. 15 mm high

Standard finish

- a) Aluminium
 - .70 plastic coated

Order example

Piece	Item No.	Finish
...piece	2090	31

- 2080.. projection height 3 mm,
with fixings
- 2081.. projection height 3 mm,
without fixings
- 2082.. projection height 10 mm,
with fixings
- 2083.. projection height 10 mm,
without fixings
- 2084.. projection height 15 mm,
with fixings
- 2085.. projection height 15 mm,
without fixings
- 2086.. projection height 20 mm,
with fixings
- 2087.. projection height 20 mm,
without fixings
- 2088.. projection height 27 mm,
with fixings
- 2089.. projection height 27 mm,
without fixings

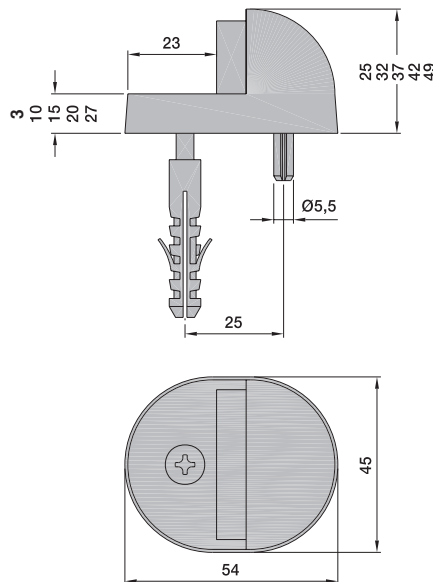

2

Made of aluminium or brass (only art.nos. 2080../2081..)
 Buffer made of rubber, black

Application

Door weight up to 30 kg

Standard finish

- a) Aluminium, E5 treated
 - .31 KWS 1 silver anodised
 - .32 KWS 2 nickel silver anodised
 - .33 KWS 3 brass-coloured anodised
 - .37 KWS 5 dark brown anodised
- b) Brass
 - .62 dull brushed and colourless coated
 - .66 polished and colourless coated
- c) Aluminium
 - .70 plastic coated

Packing Unit

10 pieces

Weight per piece (2080..)

Aluminium 0.045 kg
 Brass 0.090 kg

Mounting

The door buffer should be fitted to the floor at the maximum possible distance from the hinged edge of the door.
 The pin, embedded in the floor, prevents the buffer from turning.

Order example

Piece	Item No.	Finish
...piece	2080	31

Door buffers

2

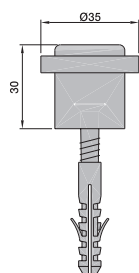

2097.. Ø 35 mm, with fixings
2098.. Ø 35 mm, without fixings

Made of aluminium, brass or stainless steel
with ring of rubber, black

Application

Door weight up to 30 kg

Standard finish

- a) Aluminium, E5 treated
 - .31 KWS 1 silver anodised
 - .32 KWS 2 nickel silver anodised
 - .33 KWS 3 brass-coloured anodised
 - .37 KWS 5 dark brown anodised
- b) Brass
 - .62 dull brushed and colourless coated
 - .66 polished and colourless coated
- c) Aluminium
 - .70 plastic coated
- d) Stainless steel
 - .82 dull brushed
 - .83 polished



Packing Unit

10 pieces

Weight per piece

Aluminium	0.045 kg
Brass	0.115 kg
Stainless steel	0.110 kg

Mounting

The housing should be removed, the door buffer fitted to the floor at the maximum possible distance to the hinged edge of the door. The housing should be replaced and secured by an attachment screw.

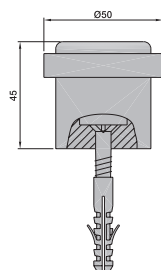

2095.. Ø 50 mm, with fixings
2096.. Ø 50 mm, without fixings

Made of aluminium, brass or stainless steel
with ring of rubber, black

Application

Door weight up to 80 kg

Standard finish

- a) Aluminium, E5 treated
 - .31 KWS 1 silver anodised
 - .32 KWS 2 nickel silver anodised
 - .33 KWS 3 brass-coloured anodised
 - .37 KWS 5 dark brown anodised
- b) Brass
 - .62 dull brushed and colourless coated
 - .66 polished and colourless coated
- c) Aluminium
 - .70 plastic coated
- d) Stainless steel
 - .82 dull brushed
 - .83 polished



Packing Unit

5 pieces

Weight per piece

Aluminium	0.145 kg
Brass	0.400 kg
Stainless steel	0.370 kg

Mounting

The housing should be removed, the door buffer fitted to the floor at the maximum possible distance to the hinged edge of the door. The housing should be replaced and secured by an attachment screw.

Order example

Piece	Item No.	Finish
...piece	2097	31

2093.. Ø 50 mm, with fixings
2094.. Ø 50 mm, without fixings

Made of aluminium, brass or stainless steel
with ring of rubber, black
with M8 inside thread for screwing on

Application

Door weight up to 45 kg

Standard finish

- a) Aluminium, E5 treated
 - .31 KWS 1 silver anodised
 - .32 KWS 2 nickel silver anodised
 - .33 KWS 3 brass-coloured anodised
 - .37 KWS 5 dark brown anodised
- b) Brass
 - .62 dull brushed and colourless coated
 - .66 polished and colourless coated
- d) Stainless steel
 - .82 dull brushed
 - .83 polished



2015.. Ø 40 mm, with fixings
2017.. Ø 40 mm, without fixings
2508.. Ø 40 mm, buffer cap

Buffer cap pressed

- 1) Made of steel stove-enamelled or electrogalvanised
With buffer made of rubber, grey
- 2) Made of steel plastic-coated, aluminium,
brass or stainless steel

With buffer made of rubber, white

Application

Door weight up to 25 kg

Standard finish

- a) Steel
 - .02 silver stove-enamelled
 - .03 black stove-enamelled
 - .06 electrogalvanised
 - .10 dark brown stove-enamelled
 - .70 plastic coated
- b) Aluminium, E5 treated
 - .31 KWS 1 silver anodised
 - .32 KWS 2 nickel silver anodised
 - .33 KWS 3 brass-coloured anodised
 - .37 KWS 5 dark brown anodised



Packing Unit

5 pieces

Weight per piece

Aluminium	0.100 kg
Brass	0.280 kg
Stainless steel	0.260 kg

Mounting

The door buffer should be fitted to the floor at the maximum possible distance to the hinged edge of the door by plug and hanger bolt.

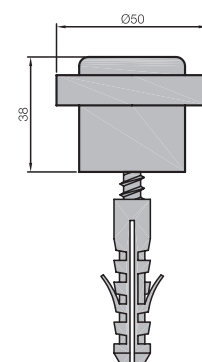

c) Brass

- .62 dull brushed and colourless coated
- .66 polished and colourless coated

d) Stainless steel



- .82 dull brushed
- .83 polished

Packing Unit

20 pieces

Weight per piece (2015..)

Steel	0.095 kg
Aluminium	0.075 kg
Brass	0.100 kg
Stainless steel	0.095 kg

Mounting

The door buffer should be fitted to the floor at the maximum possible distance from the hinged edge of the door. Placing a second screw through the buffer cap prevents the door buffer from turning.

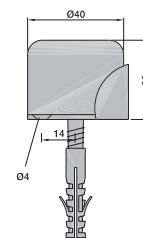

Order example

Piece ...piece	Item No. 2093	Finish 31
-------------------	------------------	--------------

Door buffers

2

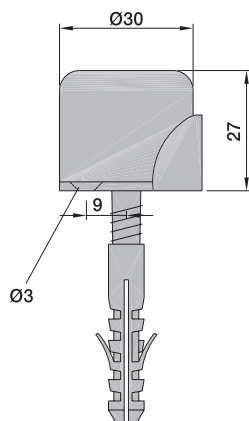

- 2016.. Ø 30 mm, with fixings
- 2018.. Ø 30 mm, without fixings
- 2509.. Ø 30 mm, buffer cap

Buffer cap pressed

- 1) Made of steel stove-enamelled or electrogalvanised with buffer made of rubber, grey
- 2) Made of steel plastic-coated, aluminium, brass or stainless steel, with buffer made of rubber, white

Application

Door weight up to 25 kg

Standard finish

- a) Steel
 - .02 silver stove-enamelled
 - .03 black stove-enamelled
 - .06 electrogalvanised
 - .10 dark brown stove-enamelled
 - .70 plastic coated
- b) Aluminium, E5 treated
 - .31 KWS 1 silver anodised
 - .32 KWS 2 nickel silver anodised
 - .33 KWS 3 brass-coloured anodised
 - .37 KWS 5 dark brown anodised
- c) Brass
 - .62 dull brushed and colourless coated
 - .66 polished and colourless coated
- d) Stainless steel
 - .82 dull brushed
 - .83 polished



Packing Unit

20 pieces

Weight per piece (2016..)

Steel	0.055 kg
Aluminium	0.045 kg
Brass	0.060 kg
Stainless steel	0.055 kg

Mounting

The door buffer should be fitted to the floor at the maximum possible distance from the hinged edge of the door. Placing a second screw through the buffer cap prevents the door buffer from turning.

Order example

Piece	Item No.	Finish
...piece	2016	02

- 2013.. Ø 40 mm, with fixings
 2513.. Ø 40 mm, without fixings
 2517.. Ø 40 mm, buffer cap

Buffer cap made of cast aluminium
 With buffer made of rubber, white

Application

Door weight up to 25 kg

Standard finish

- a) Aluminium, E5 treated
 - .31 KWS 1 silver anodised
 - .32 KWS 2 nickel silver anodised
 - .33 KWS 3 brass-coloured anodised
 - .37 KWS 5 dark brown anodised
- b) Aluminium
 - .70 plastic coated

Packing Unit

10 pieces

Weight per piece (2013..)

Aluminium 0.090 kg

Mounting

The door buffer should be fitted to the floor at the maximum possible distance from the hinged edge of the door. The pin, embedded in the floor, prevents the buffer from turning.

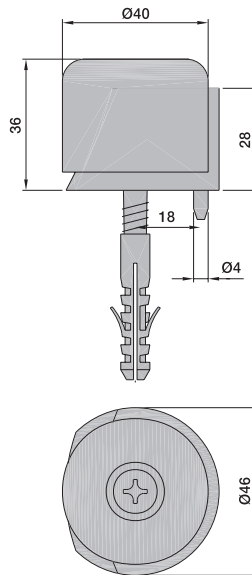

2



Order example

Piece ...piece	Item No. 2013	Finish 31
-------------------	------------------	--------------

Door buffers

2

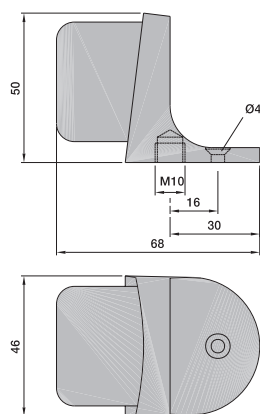

2022.. for building in

- 1) Made of aluminium stove-enamelled with buffer made of rubber, grey
- 2) Made of aluminium anodised, plastic coated or brass with buffer made of rubber, white

Application

Door weight up to 40 kg

Standard finish

- a) Aluminium
 - .02 silver stove-enamelled
 - .03 black stove-enamelled
 - .10 dark brown stove-enamelled
 - .70 plastic coated
- b) Aluminium, E5 treated
 - .31 KWS 1 silver anodised
 - .32 KWS 2 nickel silver anodised
 - .33 KWS 3 brass-coloured anodised
 - .37 KWS 5 dark brown anodised
- c) Brass
 - .62 dull brushed and colourless coated
 - .66 polished and colourless coated

Packing Unit

10 pieces

Weight per piece

Aluminium 0.150 kg
Brass 0.250 kg

Mounting

The door buffer should be fitted to the floor at the maximum possible distance from the hinged edge of the door. Placing a screw through the buffer cap prevents the door buffer from turning.

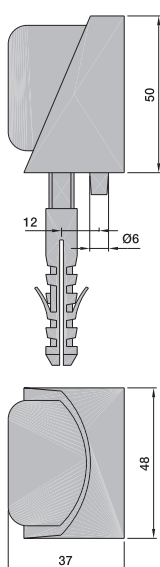

2028.. with fixings

2528.. without fixings

- 1) Made of aluminium stove-enamelled with buffer made of rubber, grey
- 2) Made of aluminium anodised, plastic-coated or brass with buffer made of rubber, white

Application

Door weight up to 30 kg

Standard finish

- a) Aluminium
 - .02 silver stove-enamelled
 - .03 black stove-enamelled
 - .10 dark brown stove-enamelled
 - .70 plastic coated
- b) Aluminium, E5 treated
 - .31 KWS 1 silver anodised
 - .32 KWS 2 nickel silver anodised
 - .33 KWS 3 brass-coloured anodised
 - .37 KWS 5 dark brown anodised

Weight per piece

Aluminium 0.160 kg

Mounting

The door buffer should be fitted to the floor at the maximum possible distance from the hinged edge of the door. The pin, embedded in the floor, prevents the buffer from turning.

Order example

Piece	Item No.	Finish
...piece	2022	02

Packing Unit

10 pieces

2029.. with fixings
2529.. without fixings

- 1) Made of aluminium stove-enamelled with buffer made of rubber, grey
- 2) Made of aluminium anodised, plastic coated or brass with buffer made of rubber, white

Application

Door weight up to 30 kg

Standard finish

- a) Aluminium
 - .02 silver stove-enamelled
 - .03 black stove-enamelled
 - .10 dark brown stove-enamelled
 - .70 plastic coated
- b) Aluminium, E5 treated
 - .31 KWS 1 silver anodised
 - .32 KWS 2 nickel silver anodised
 - .33 KWS 3 brass-coloured anodised
 - .37 KWS 5 dark brown anodised

Packing Unit

10 pieces

Weight per piece

Aluminium 0.140 kg

Mounting

The buffer body is to be fitted to the wall in the corner between floor and wall at the maximum possible distance from the hinged edge of the door and the buffer is to be screwed in.

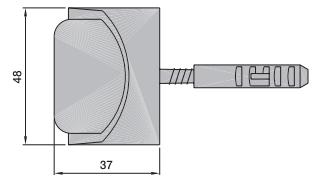
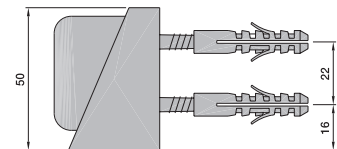

2031.. with fixings
2032.. without fixings

Made of aluminium
Buffer made of rubber, white

Application

Door weight up to 40 kg

Standard finish

- a) Aluminium, E5 treated
 - .31 KWS 1 silver anodised
 - .32 KWS 2 nickel silver anodised
 - .33 KWS 3 brass-coloured anodised
 - .37 KWS 5 dark brown anodised
- b) Aluminium
 - .70 plastic coated

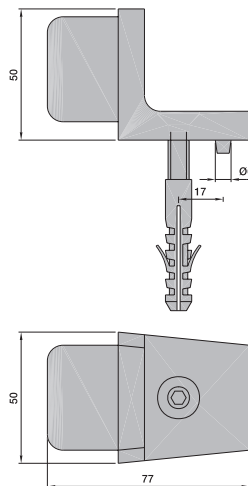

Packing Unit

10 pieces

Weight per piece

Aluminium 0.150 kg

Mounting

The door buffer should be fitted to the floor at the maximum possible distance from the hinged edge of the door. The pin, embedded in the floor, prevents the buffer from turning.

Order example

Piece ...piece	Item No. 2029	Finish 02

Door buffers

2

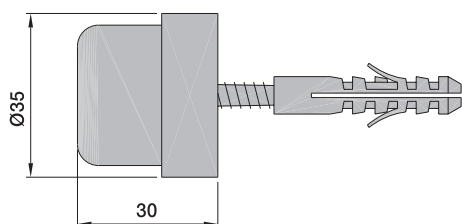

2006.. 30 mm, with fixings
2506.. 30 mm, without fixings

Made of aluminium or brass
 with buffer made of rubber, white

Application

Door weight up to 80 kg

Standard finish

- a) Aluminium, E5 treated
 - .31 KWS 1 silver anodised
 - .32 KWS 2 nickel silver anodised
 - .33 KWS 3 brass-coloured anodised
 - .37 KWS 5 dark brown anodised
- b) Brass
 - .62 dull brushed and colourless coated
 - .66 polished and colourless coated
- c) Aluminium
 - .70 plastic coated

Packing Unit

20 pieces

Weight per piece

Aluminium 0.055 kg
 Brass 0.085 kg

Mounting

The door buffer should be screwed on the wall directly through buffer and body.

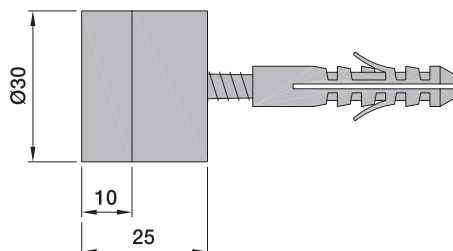

2008.. 25 mm, with fixings
2408.. 25 mm, without fixings

Made of aluminium, brass or stainless steel
 with buffer made of rubber, black

On request the article is also available with buffer, white

Application

Door weight up to 80 kg

Standard finish

- a) Aluminium, E5 treated
 - .31 KWS 1 silver anodised
 - .32 KWS 2 nickel silver anodised
 - .33 KWS 3 brass-coloured anodised
 - .37 KWS 5 dark brown anodised
- b) Brass
 - .62 dull brushed and colourless coated
 - .66 polished and colourless coated
- c) Aluminium
 - .70 plastic coated
- d) Stainless steel
 - .82 dull brushed
 - .83 polished

Packing Unit

20 pieces

Weight per piece

Aluminium 0.035 kg
 Brass 0.070 kg
 Stainless steel 0.060 kg

Mounting

The buffer body should be fitted to the wall and the buffer put in.

Order example

Piece	Item No.	Finish
...piece	2006	31

2007.. 28 mm, with fixings
2407.. 28 mm, without fixings

On removable wall rose Ø 50 mm
Made of aluminium, brass or stainless steel
With buffer made of rubber, black

On request the item is also available with buffer, white

Application

Door weight up to 80 kg

Standard finish

- a) Aluminium, E5 treated
 - .31 KWS 1 silver anodised
 - .32 KWS 2 nickel silver anodised
 - .33 KWS 3 brass-coloured anodised
 - .37 KWS 5 dark brown anodised
- b) Brass
 - .62 dull brushed and colourless coated
 - .66 polished and colourless coated
- c) Aluminium
 - .70 plastic coated
- d) Stainless steel
 - .82 dull brushed
 - .83 polished

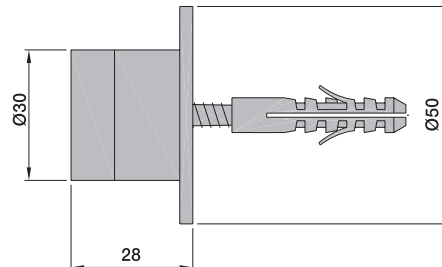

2

Packing Unit

20 pieces

Weight per piece

Aluminium	0.050 kg
Brass	0.115 kg
Stainless steel	0.100 kg

Mounting

The buffer body should be fitted to the wall and the buffer put in.

Order example

Piece	Item No.	Finish
...piece	2007	31

Door buffers

2

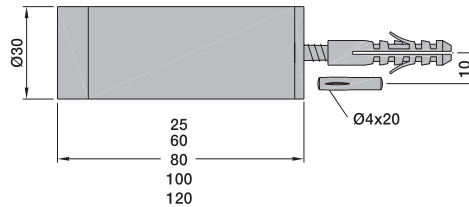

2068..	25 mm, with fixings
2568..	25 mm, without fixings
2070..	60 mm, with fixings
2570..	60 mm, without fixings
2071..	80 mm, with fixings
2571..	80 mm, without fixings
2072..	100 mm, with fixings
2572..	100 mm, without fixings
2073..	120 mm, with fixings
2573..	120 mm, without fixings

Made of aluminium, brass or stainless steel
With fixed buffer made of rubber, black

On request the article is also available with buffer, white.

Application

Door weight up to 40 kg

Standard finish

- a) Aluminium, E5 treated
 - .31 KWS 1 silver anodised
 - .32 KWS 2 nickel silver anodised
 - .33 KWS 3 brass-coloured anodised
 - .37 KWS 5 dark brown anodised
- b) Brass
 - .62 dull brushed and colourless coated
 - .66 polished and colourless coated
- c) Aluminium
 - .70 plastic coated
- d) Stainless steel
 - .82 dull brushed
 - .83 polished

Packing Unit

10 pieces

Weight per piece (2068..)

Aluminium	0.040 kg
Brass	0.060 kg
Stainless steel	0.060 kg

Mounting

The fastening element should be fitted to the wall, the buffer tube with the fixed buffer put on and fastened by an attachment screw.

This door buffer is also available in overlength.

Order example

Piece	Item No.	Finish
...piece	2068	31

2069..	28 mm, with fixings
2569..	28 mm, without fixings
2074..	60 mm, with fixings
2574..	60 mm, without fixings
2075..	80 mm, with fixings
2575..	80 mm, without fixings
2076..	100 mm, with fixings
2576..	100 mm, without fixings
2077..	120 mm, with fixings
2577..	120 mm, without fixings

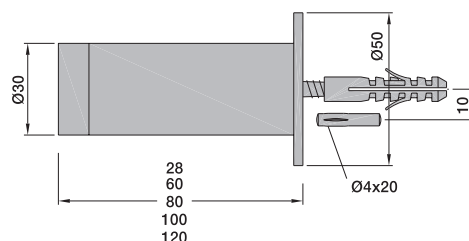

2

With wall rose Ø 50 mm

Made of aluminium, brass or stainless steel

With fixed buffer made of rubber, black

On request the article is also available with buffer, white.

Application

Door weight up to 40 kg

Standard finish

a) Aluminium, E5 treated

- .31 KWS 1 silver anodised
- .32 KWS 2 nickel silver anodised
- .33 KWS 3 brass-coloured anodised
- .37 KWS 5 dark brown anodised

b) Brass

- .62 dull brushed and colourless coated
- .66 polished and colourless coated

c) Aluminium

- .70 plastic coated

d) Stainless steel



- .82 dull brushed
- .83 polished

Packing Unit

10 pieces

Weight per piece (2069..)

Aluminium	0.045 kg
Brass	0.085 kg
Stainless steel	0.085 kg

Mounting

The fastening element should be fitted to the wall, the buffer tube with the fixed buffer put on and fastened by an attachment screw.

This door buffer is also available in overlength.

Order example

Piece	Item No.	Finish
...piece	2069	31

Door buffers

2

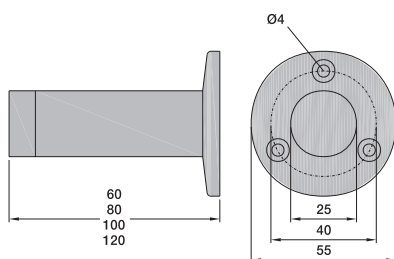
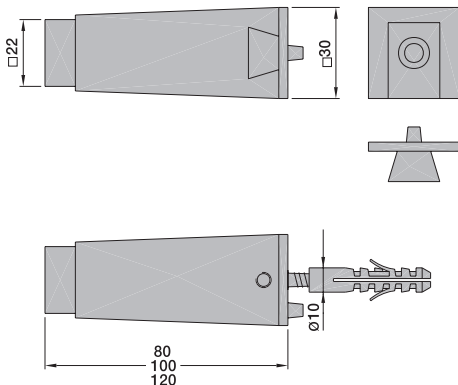
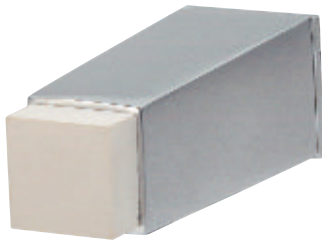

2033..	80 mm, with fixings
2034..	80 mm, without fixings
2035..	100 mm, with fixings
2036..	100 mm, without fixings
2037..	120 mm, with fixings
2038..	120 mm, without fixings

Made of aluminium,
Buffer made of rubber, white

Application

Door weight up to 40 kg

Standard finish

- a) Aluminium
 - .02 silver stove-enamelled
 - .03 black stove-enamelled
 - .10 dark brown stove-enamelled
 - .70 plastic coated

- b) Aluminium, E5 treated
 - .31 KWS 1 silver anodised
 - .32 KWS 2 nickel silver anodised
 - .33 KWS 3 brass-coloured anodised
 - .37 KWS 5 dark brown anodised

Packing Unit

10 pieces

Weight per piece (2033..)

Aluminium 0.100 kg

Mounting

The fastening element should be fitted to the wall at the maximum possible distance from the hinged edge of the door, the housing is to be put on and secured by an attachment screw. The pin, embedded in the wall, prevents the buffer from turning.

2009..	60 mm
2010..	80 mm
2011..	100 mm
2012..	120 mm

Made of steel, brass or stainless steel
With buffer made of rubber, grey

Application

Door weight up to 25 kg

Standard finish

- a) Steel
 - .02 silver stove-enamelled
 - .03 black stove-enamelled
 - .10 dark brown stove-enamelled
 - .70 plastic coated
- b) Brass
 - .62 dull brushed and colourless coated
 - .66 polished and colourless coated
- c) Stainless steel
 - .82 dull brushed
 - .83 polished

Packing Unit

6 pieces

Weight per piece (2009..)

Steel	0.085 kg
Brass	0.100 kg
Stainless steel	0.085 kg

Mounting

The door buffer should be fitted to the wall at the maximum possible distance from the hinged edge of the door using three screws.

This door buffer is also available in overlength.

Order example

Piece	Item No.	Finish
...piece	2033	02

2014..

Made of aluminium
Piston made of brass, spring-loaded
Buffer made of rubber, grey

Application

Door weight up to 30 kg

Standard finish

- a) Aluminium, E5 treated
 - .31 KWS 1 silver anodised
 - .32 KWS 2 nickel silver anodised
 - .33 KWS 3 brass-coloured anodised
 - .37 KWS 5 dark brown anodised
- b) Aluminium
 - .70 plastic coated

Packing Unit

2 pieces

Weight per piece

Aluminium 0.210 kg

Mounting

The door buffer should be fitted to the door frame at the maximum possible distance from the hinged edge of the door using 2 screws. The spring resistance can be adjusted by a screw.

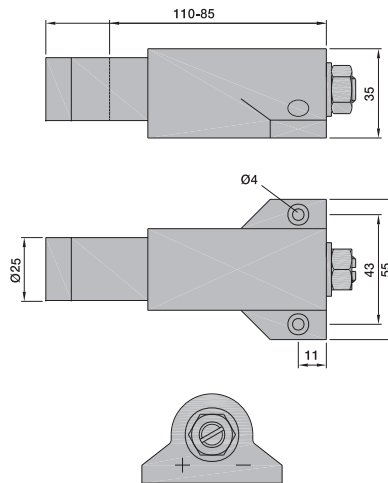

2

Order example

Piece	Item No.	Finish
...piece	2014	31

Door buffers

2

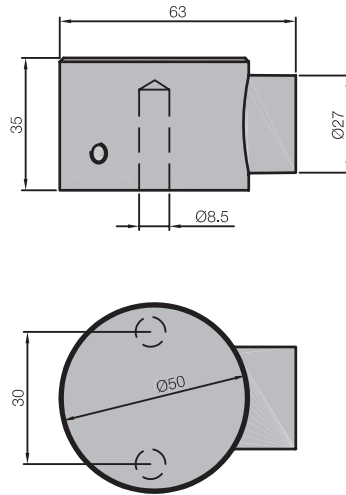

2110.. Ø 50 mm, with fixings

2111.. Ø 50 mm, without fixings

Made of aluminium, brass and stainless steel,

with spring-loaded buffer, black

Application

Door weight up to 75 kg

Standard finish

- a) Aluminium, E5 treated
 - .31 KWS 1 silver anodised
 - .32 KWS 2 nickel silver anodised
 - .33 KWS 3 brass-coloured anodised
 - .37 KWS 5 dark brown anodised
- b) Brass
 - .62 dull brushed and colourless coated
 - .66 polished and colourless coated
- c) Aluminium
 - .70 plastic coated
- d) Stainless steel
 - .82 dull brushed
 - .83 polished

Packing Unit

10 pieces

Weight per piece

Aluminium	0.200 kg
Brass	0.550 kg
Stainless steel	0.500 kg

Mounting

Screw the door buffer on the floor at the maximum possible distance from the hinged edge of the door.

Order example

Piece	Item No.	Finish
...piece	2110	31

2124.. with mounting plate

Made of aluminium

with spring-loaded buffer, black
Buffer seat / bolt of stainless steel

Application

Door weight up to 120 kg

Standard finish

- a) Aluminium
 - .02 silver stove-enamelled
 - .03 black stove-enamelled
 - .10 dark brown stove-enamelled
 - .70 plastic coated
- b) Aluminium, E5 treated
 - .31 KWS 1 silver anodised
 - .32 KWS 2 nickel silver anodised
 - .33 KWS 3 brass-coloured anodised
 - .35 stainless steel effect anodised
 - .37 KWS 5 dark brown anodised

Packing Unit

10 pieces

Weight per piece

Aluminium 0.400 kg

Mounting

Screw the mounting plate of the door holder on the floor by 2 screws and embedded plugs in the desired position at the maximum possible distance from the hinged edge of the door. Then mount the holder and fix it to the mounting plate by the two screws on the side.

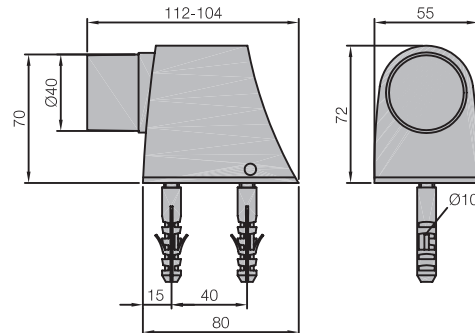

2

Order example

Piece	Item No.	Finish
...piece	2124	02

Door buffers

2



2023.. for building in
2024.. for face fixing

Made of aluminium, brass or stainless steel

Buffer made of rubber, black, spring-loaded
Buffer seat and bolt made of stainless steel
Anchor plate (art. no. 2023..) made of steel,
hot galvanised or stainless steel

Application

Door weight up to 100 kg

Standard finish

- a) Aluminium
 - .02 silver stove-enamelled
 - .03 black stove-enamelled
 - .10 dark brown stove-enamelled
 - .70 plastic coated
- b) Aluminium, E5 treated
 - .31 KWS 1 silver anodised
 - .32 KWS 2 nickel silver anodised
 - .33 KWS 3 brass-coloured anodised
 - .37 KWS 5 dark brown anodised
- c) Brass
 - .62 dull brushed and colourless coated
 - .63 nickelized
 - .66 polished and colourless coated
- d) Stainless steel
 - .82 dull brushed
 - .83 polished

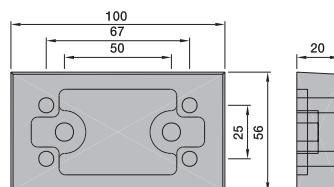
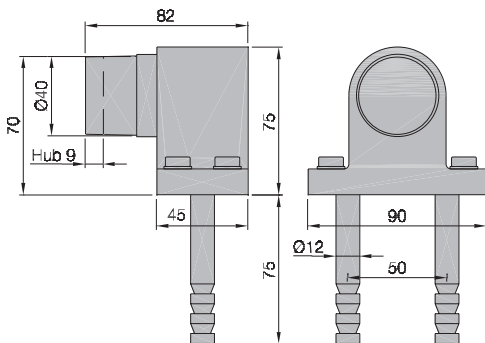

Packing Unit

1 piece

Weight per piece	2023..	2024..
Aluminium	0.670 kg	0.380 kg
Brass	0.940 kg	0.650 kg
Stainless steel	0.910 kg	0.680 kg

Mounting

For building in:

The anchor plate should be embedded in the floor in the proposed position at the maximum possible distance from the hinged edge of the door. Once the grout has hardened, the door buffer can be screwed on.

For face fixing:

The holder should be mounted on the floor by 4 plugs and screws in the proposed position at the maximum possible distance from the hinged edge of the door.

For adjustment in height we recommend using pad no. 1610.. (20 mm).

1610.. Pad 20 mm high

Standard finish

- a) Aluminium
 - .70 plastic coated

Packing Unit

1 piece

Weight per piece

Aluminium 0.300 kg

Order example

Piece	Item No.	Finish
...piece	2023	02

2049.. with fixings
2050.. without fixings

Made of aluminium or brass

Buffer made of rubber, black, spring-loaded
Buffer insert and bolt made of stainless steel

Application

Door weight up to 100 kg

Standard finish

- a) Aluminium
 - .02 silver stove-enamelled
 - .03 black stove-enamelled
 - .10 dark brown stove-enamelled
 - .70 plastic coated
- b) Aluminium, E5 treated
 - .31 KWS 1 silver anodised
 - .32 KWS 2 nickel silver anodised
 - .33 KWS 3 brass-coloured anodised
 - .37 KWS 5 dark brown anodised

Packing Unit

1 piece

Weight per piece

Aluminium 0.520 kg
Brass 0.940 kg

Mounting

The fastening strap should be screwed on the wall in the proposed position at the maximum possible distance from the hinged edge of the door.

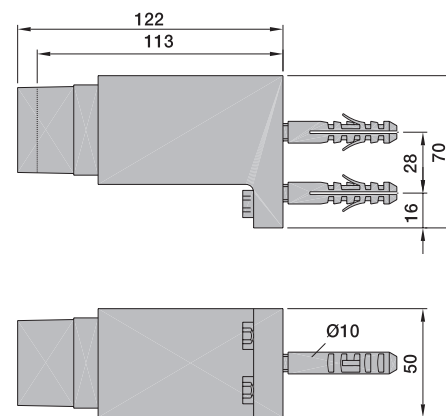
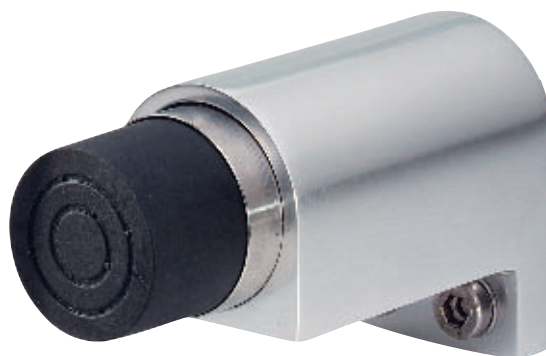

Order example

Piece	Item No.	Finish
...piece	2049	02

Door buffers

2

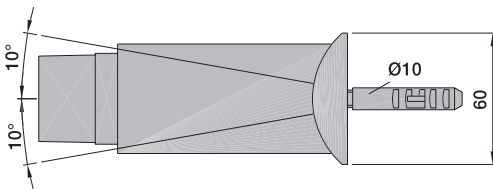
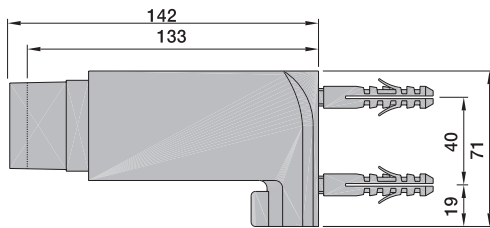

2051.. with fixings

2052.. without fixings

Tilting (up to 10° to the right and left)

Made of aluminium, buffer made of rubber, black, spring-loaded
Buffer seat and bolt made of stainless steel

Application

Door weight up to 100 kg

Standard finish

- a) Aluminium
 - .02 silver stove-enamelled
 - .03 black stove-enamelled
 - .10 dark brown stove-enamelled
 - .70 plastic coated
- b) Aluminium, E5 treated
 - .31 KWS 1 silver anodised
 - .32 KWS 2 nickel silver anodised
 - .33 KWS 3 brass-coloured anodised
 - .37 KWS 5 dark brown anodised

Packing Unit

1 piece

Weight per piece

Aluminium 0.570 kg

Mounting

The fastening strap with fixture should be screwed on the wall in the proposed position at the maximum possible distance from the hinged edge of the door. The buffer element should be put on, set at the required angle (when opening the door it should hit the buffer at an angle of 90°) and secured by a screw.

Order example

Piece	Item No.	Finish
...piece	2051	02

2019.. for anchor fixing

Made of steel, with spring-loaded buffer
Buffer made of rubber, black

Application

Door weight up to 200 kg

Standard finish

a) Steel

- .02 silver stove-enamelled
- .03 black stove-enamelled
- .06 electrogalvanised
- .10 dark brown stove-enamelled
- .70 plastic coated

Packing Unit

1 piece

Weight per piece

Steel 1.800 kg

Mounting

The door buffer should be embedded in the floor at the maximum possible distance from the hinged edge of the door (to be embedded by at least 100 mm).

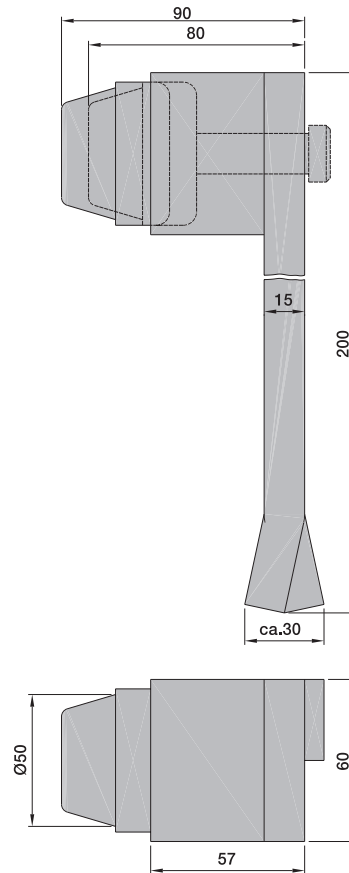

2

Order example

Piece	Item No.	Finish
...piece	2019	02

Door buffers

2

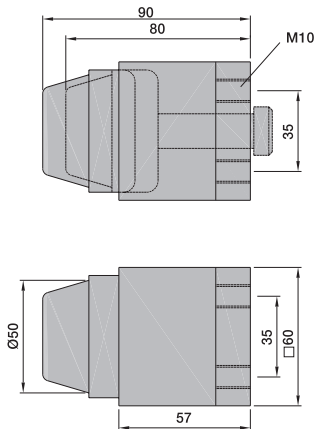

2020.. with 4 threaded blind holes for fixing from the back

Made of steel, with spring-loaded buffer
Buffer made of rubber, black

Application
Door weight up to 200 kg

Standard finish
a) Steel
.02 silver stove-enamelled
.03 black stove-enamelled
.06 electrogalvanised
.10 dark brown stove-enamelled
.70 plastic coated

Packing Unit
1 piece

Weight per piece Steel 0.800 kg

Mounting
The door buffer should be fixed from the back side using four screws M 10 or, if possible, welded in position. Be careful when mounting because the buffer bolt comes out at the back by 10 mm (spring system).

Order example

Piece	Item No.	Finish
...piece	2020	02

2120.. for concealed fixing

Made of steel or stainless steel, with spring-loaded buffer
Buffer made of rubber, black

Application

Door weight up to 200 kg

Standard finish

a) Steel

- .02 silver stove-enamelled
- .03 black stove-enamelled
- .06 electrogalvanised
- .10 dark brown stove-enamelled
- .70 plastic coated

b) Stainless steel



- .82 dull brushed
- .83 polished

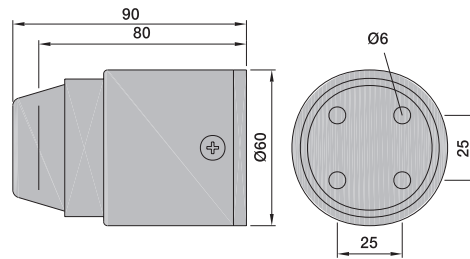

2

Packing Unit

1 piece

Weight per piece Steel 0.620 kg

Mounting

The fastening element should be fitted on, the housing put on and secured by two screws.

In contrast to item. no. 2020.. the 10 mm buffer way is integrated in the housing so that the buffer bolt does not come out in the back.

Order example

Piece ...piece	Item No. 2120	Finish 02
-------------------	------------------	--------------