

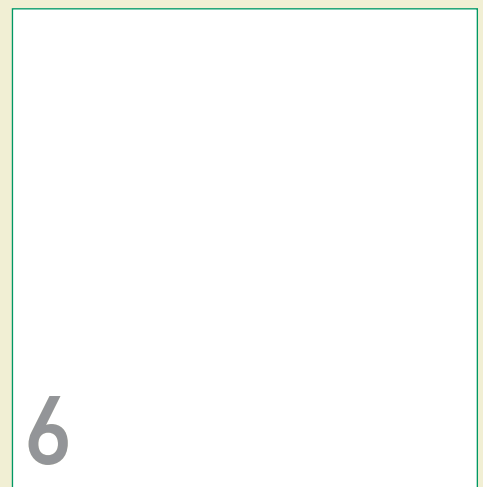

Temporarily locked.

With KWS locking handles you can open and close cellar, ship, refrigerator and many special types of doors. Having proved themselves over the years, their design remains unchanged. Our locking handles are available in cast iron, steel and stainless steel. For closing of fire doors we supply door selectors, snap latches, and lever handles serie RKF (group 3), which are MPA approved [Materials Testing Institute] and subjected to multiple tests. More technical details on the following pages.

Locking handles | 236
Door selectors | 240
Snap latches | 241



6

Overview



Page 236



Page 237



Page 238



Page 238

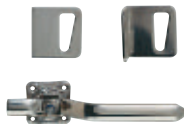

Page 239

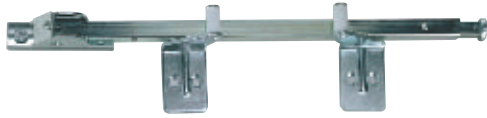

Page 240



Page 241



Page 242



Page 242



Page 243



Page 244



Page 244

Locking handles

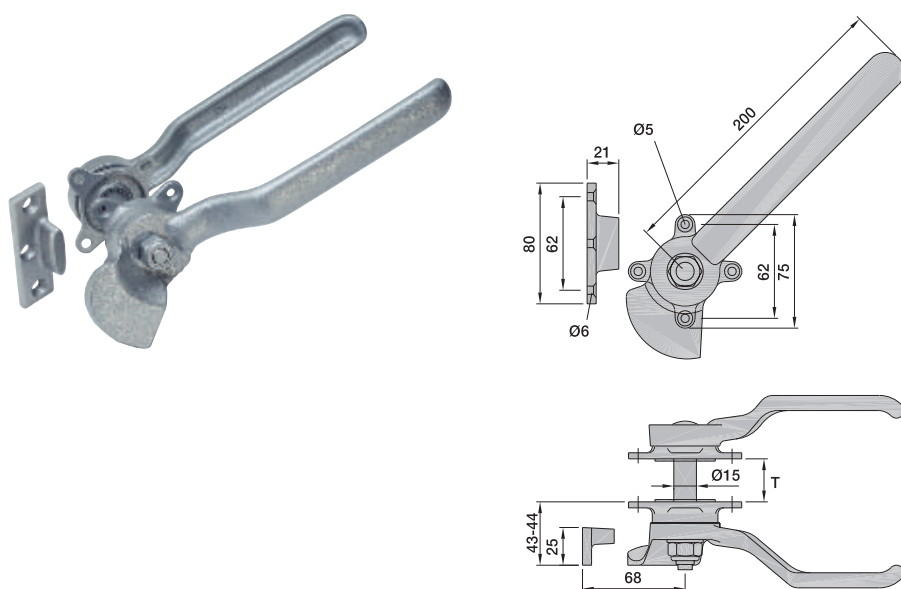

- 6001.. for (T) 25 - 30 mm door thickness
- 6002.. for (T) 30 - 35 mm door thickness
- 6003.. for (T) 35 - 40 mm door thickness
- 6004.. for (T) 40 - 45 mm door thickness
- 6005.. for (T) 45 - 50 mm door thickness
- 6006.. for (T) 50 - 55 mm door thickness
- 6007.. for (T) 55 - 60 mm door thickness
- 6008.. for (T) 60 - 65 mm door thickness
- 6009.. for (T) 65 - 70 mm door thickness

For double handed operation

Made of malleable cast iron with spindle of steel with wedge plate, compression spring, felt washers

Other door thicknesses on request

Standard finish

- a) Malleable cast iron
 - .02 silver stove-enamelled
 - .07 hot galvanised

Weight per piece (6001..)

Malleable cast iron 1.340 kg

Mounting

A 16 mm diameter hole is required for the spindle. The mounting roses should be installed with the screws lining up horizontally and vertically as shown, with the felt washers in place. Insert the spindle through the hole ensuring that the compression spring is in place, and fit the locking handle with the locknut.

The wedge plate should be fitted to the door in the appropriate position.

The operating angle of the lever is 45°. The locking handle should be fitted in such a way that the lever handles point 45° upwards in unlocked position.

Note

When ordering right hand or left hand door should be indicated (drawing shows locking handle for lh door).

Order example

Piece	Item No.	Finish	rh/lh	Door thickness (T)
...piece	6001	02	lh	25 - 30 mm

- 6101.. for (T) 25 - 30 mm door thickness
- 6102.. for (T) 30 - 35 mm door thickness
- 6103.. for (T) 35 - 40 mm door thickness
- 6104.. for (T) 40 - 45 mm door thickness
- 6105.. for (T) 45 - 50 mm door thickness
- 6106.. for (T) 50 - 55 mm door thickness
- 6107.. for (T) 55 - 60 mm door thickness
- 6108.. for (T) 60 - 65 mm door thickness
- 6109.. for (T) 65 - 70 mm door thickness

For double handed operation

Made of steel or stainless steel

With locking plate, compression spring, felt washers

Suitable for rh and lh doors

Other door thicknesses on request

Standard finish

- a) Steel
 - .06 electrogalvanised
- b) Stainless steel
 - .82 dull brushed
 - .83 polished



Weight per piece

Steel 1.230 kg
Stainless Steel 1.180 kg

Mounting

A 16 mm diameter hole is required for the spindle.
The mounting roses should be installed with the screws lining up diagonally as shown, with the felt washers in place. Insert the spindle through the hole ensuring that the compression spring is in place, and fit the locking handle with the locknut.

The locking plate should be fitted to the door in the appropriate position.

The operating angle of the lever is 90°. The locking handle should be fitted in such a way that the lever handles point upwards in unlocked position.

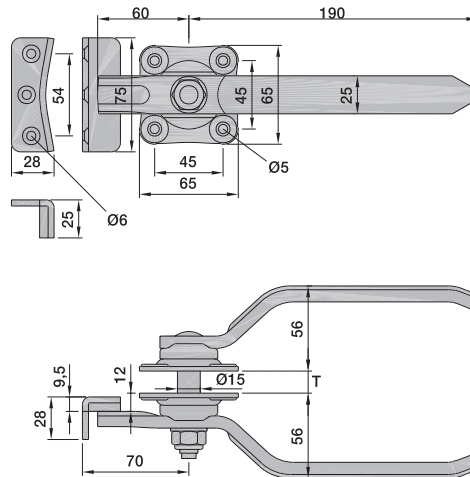

Order example

Piece	Item No.	Finish	Door thickness (T)
...piece	6101	06	25 - 30 mm

Locking handles

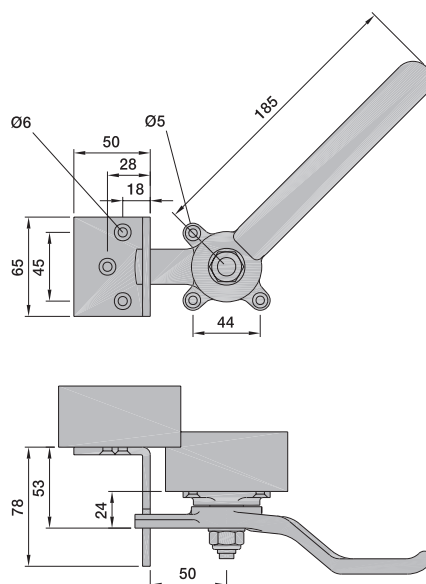

6028.. with angular locking plate

For one handed operation

Made of malleable cast iron Angular locking plate made of steel

Standard finish

- a) Malleable cast iron
- .02 silver stove-enamelled
- .07 hot galvanised

Weight per piece

Malleable cast iron 0.810 kg

Mounting

The locking handle should be mounted to the door, the locking plate fitted to the door in the appropriate position. The operating angle of the lever is 45°. The locking handle should be fitted in such a way that the lever handle points horizontally in unlocked position.

Note

When ordering right hand or left hand door is to be indicated (drawing shows locking handle for rh door).

6

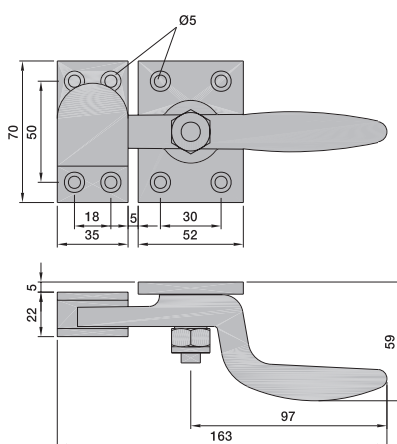
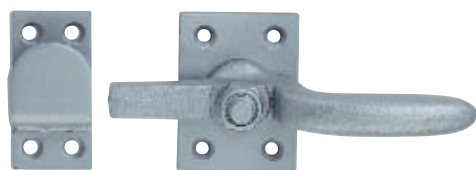

6029..

Locking lever made of malleable cast iron fixed on the base plate of steel Hook plate made of steel

Standard finish

- a) Malleable cast iron
- .02 silver stove-enamelled
- .07 hot galvanised

Packing Unit

5 pieces

Weight per piece

Malleable cast iron 0.610 kg

Order example

Piece	Item No.	Finish	rh/lh
...piece	6028	02	rh

6128.. with locking plate for welding on

6129.. with angular locking plate for face fixing

For one handed operation

Made of steel or stainless steel

Standard finish

a) Steel

.06 electrogalvanised

b) Stainless steel



.82 dull brushed

.83 polished

Weight per piece

	6128..	6129..
Steel	0.700 kg	0.770 kg
Stainless Steel	0.680 kg	0.750 kg

Mounting

The locking handle should be mounted to the door, the locking plate fitted to the door in the appropriate position. The operating angle of the lever is 90°. The locking handle should be fitted in such a way that the lever handle points downwards in unlocked position.

Note

6128... can be used for rh and lh doors

6129...: When ordering right hand or left hand door should be indicated (drawing shows locking handle for rh door).

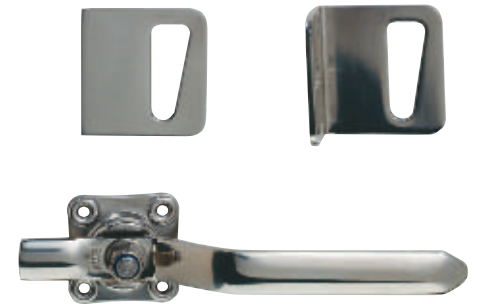
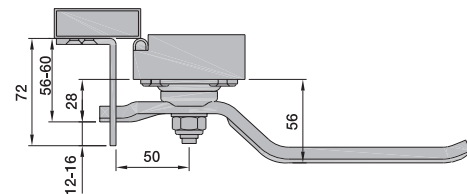
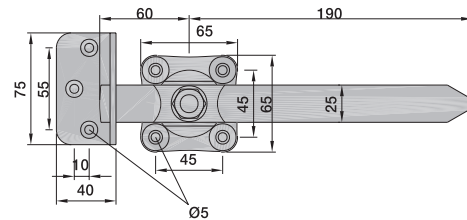
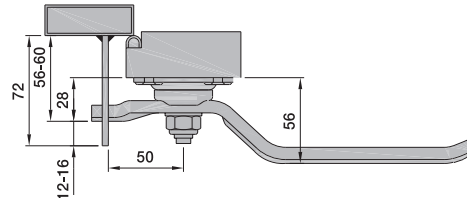
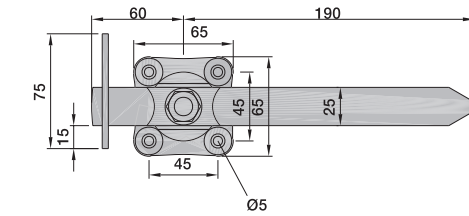

Order example

Piece	Item No.	Finish
...piece	6128	06

Door selector

6062..

For two-leaf fire proof doors
Types T 30-2 up to T 120-2

Made of steel

Installation deviations are compensated by an U-shaped adjusting plate

Usable for rh and lh operation

The following items are supplied:

- 1 door selector
- 1 U-shaped adjusting plate
- 2 stop squares, rh/lh
- 2 special washers
- 6 Allen countersunk screws M8 x 20 DIN 7991-8.8

Standard finish

- a) Steel
 - .06 electrogalvanised
 - .70 plastic coated

Packing Unit

1 piece

Weight per piece

Steel 1.510 kg

Function

The door selector ensures that when closing two-leaf fire protection doors automatically the stationary leaf closes before the locking leaf.

Mounting

The door selector should be fitted to the frame, the stop squares to the door leaves by means of Allen countersunk screws M8 x 20.

Detailed instructions are supplied with each unit.

The full-surface contact of the mounting plate with the U-shaped adjusting plate makes it a very solid mechanism which will resist deformation even in case of very heavy doors.

Note

Approved and licensed by Staatl. Materialprüfungsamt Nordrhein-Westfalen, Dortmund. A copy of the certificate is available on request.

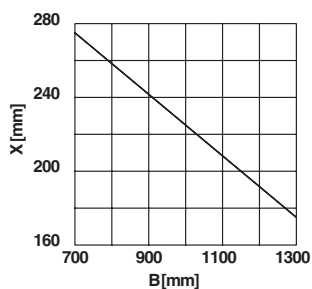
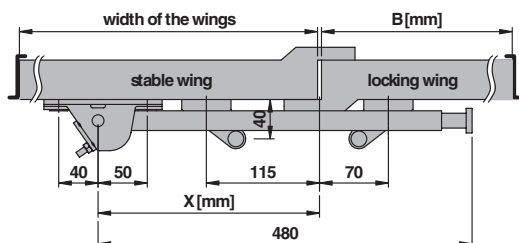
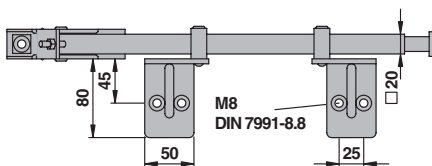

Order example

Piece	Item No.	Finish
...piece	6062	06

6

6791..	dim. L = 580 mm
6792..	dim. L up to 700 mm
6793..	dim. L up to 800 mm
6794..	dim. L up to 900 mm
6795..	dim. L up to 1000 mm
6796..	dim. L up to 1100 mm
6797..	dim. L up to 1200 mm

With lockable mechanism box

For two-leaf fire proof doors
Types T 30-2 up to T 120-2

The following items are supplied:

- 1 snap latch
- 1 mechanism box with lever handle
- 1 mounting plate for box
- 1 face plate for snap latch
- 2 flush screws M5 x 16 DIN 963-4.8
- 2 raised countersunk head screws M5 x 30, DIN 964-4.8

Standard finish

- a) Steel (complete)
 - .06 electrogalvanised
 - .70 plastic coated
- b) Aluminium, E4 treated (lever with inlay and cap)
 - inside steel electrogalvanised
 - .22 KWS 1 silver anodised
- c) Stainless steel (lever an cap /inside steel electrogalvanised)
 - 
 - .82 dull brushed
 - .83 polished

Weight per piece (6791..)

Steel	1.930 kg
Aluminium	2.030 kg
Stainless steel	2.110 kg

Mounting

The latch plate should be welded to the housing tube (installed by the door manufacturer) and the lock mounting plate according to the dimension L. The snap latch should be inserted into the tube and fixed to the upper edge of the door leaf by 2 screws.

The mechanism box, with vertically pointing lever handle should be screwed through the door leaf on the mounting plate by 2 screws. For stability reasons there are 2 pins on the backside of the mechanism box to be inserted into the door leaf. (On request we also supply without pins.)

Note

The driving pin for operating the snap latch projects 26 mm from the mechanism box and is suitable for use with doors of the T 30-2 type. All supplies are based on this standard model unless otherwise specified by the customer.

Further lengths of driving pins:

38 mm = T 60-2, 48 mm = T 90-2, 56 mm = T 120-2.

Dimension L is the length from the upper edge of the bolt plate to the turning centre of the lever handle.

This means that the total length is always 100 mm longer than dimension L.

For locking a commercial profile cylinder is required but not enclosed. The cylinder prevents the operation of the lever.

*Approved and licensed by Staatl. Materialprüfungsamt
Nordrhein-Westfalen, Dortmund. A copy of the certificate is
available on request.*

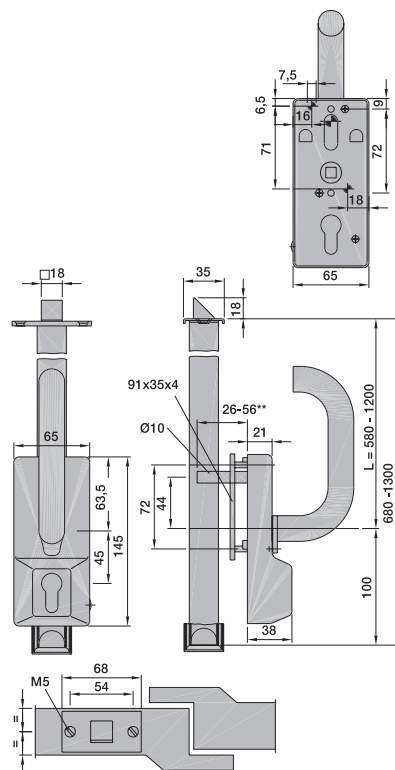

Order example

Piece	Item No.	Finish	Dimension L	For type
...piece	6791	06	—	T 30-2
...piece	6793	22	760 mm	T 30-2

Mechanism boxes / Snap latches

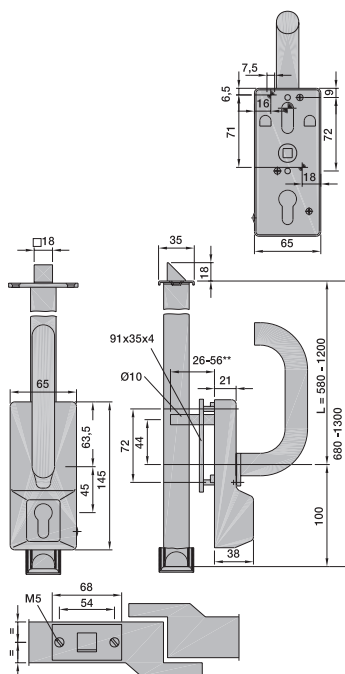

6693..

Mechanism box lockable (without snap latch) of item nos. 6791.. - 6797..

Standard finishes on previous page, item nos. 6791.. - 6797..

Weight per piece

Steel 0.810 kg

Aluminium 0.910 kg

Stainless steel 0.990 kg

Note

Approved and licensed by Staatl. Materialprüfungsamt Nordrhein-Westfalen, Dortmund. A copy of the certificate is available on request.

6591.. dim. L = 580 mm

6592.. dim. L up to 700 mm

6593.. dim. L up to 800 mm

6594.. dim. L up to 900 mm

6595.. dim. L up to 1000 mm

6596.. dim. L up to 1100 mm

6597.. dim. L up to 1200 mm

Snap latch without mechanism box of item nos. 6091.. - 6097.. and 6791.. - 6797..

Made of steel

Standard finish

a) Steel

.06 electrogalvanised

Note

Approved and licensed by Staatl. Materialprüfungsamt Nordrhein-Westfalen, Dortmund. A copy of the certificate is available on request.

6



Order example

Piece	Item No.	Finish	Dimension L	For type
...piece	6693	06	—	T 30-2
...piece	6593	06	760 mm	—

6091..	dim. L = 580 mm
6092..	dim. L up to 700 mm
6093..	dim. L up to 800 mm
6094..	dim. L up to 900 mm
6095..	dim. L up to 1000 mm
6096..	dim. L up to 1100 mm
6097..	dim. L up to 1200 mm

For two-leaf fire-proof doors
Types T 30-2 up to T 120-2

The following items are supplied:

- 1 snap latch
- 1 mechanism box with lever handle
- 1 mounting plate for box
- 1 face plate for snap latch
- 2 flush screws M5 x 16 DIN 963-4.8
- 2 raised countersunk head screws
M5 x 30, DIN 964-4.8

Standard finish

- a) Steel (complete)
 - .06 electrogalvanised
 - .70 plastic coated
- b) Aluminium, E4 treated
(lever and cap/inside steel electrogalvanised)
 - .22 KWS 1 silver anodised
- c) Stainless steel
(lever and cap/inside steel electrogalvanised)
 - .82 dull brushed
 - .83 polished

Packing Unit

1 piece

Weight per piece (6091..)

Steel 1.750 kg

Mounting

The latch plate should be welded to the housing tube (installed by the door manufacturer) and the lock mounting plate according to the dimension L. The snap latch should be inserted into the tube and fixed to the upper edge of the door leaf by 2 screws.

The mechanism box, with vertically pointing lever handle should be screwed through the door leaf on the mounting plate by 2 screws.

Note

The driving pin for operating the snap latch projects 26 mm from the mechanism box and is suitable for use with doors of the T 30-2 type. All supplies are based on this standard model unless otherwise specified by the customer.

Further lengths of driving pins:

38 mm = T 60-2, 48 mm = T 90-2, 56 mm = T 120-2.

Dimension L is the length from the upper edge of the bolt plate to the turning centre of the lever handle. This means that the total length is always 100 mm longer than dimension L.

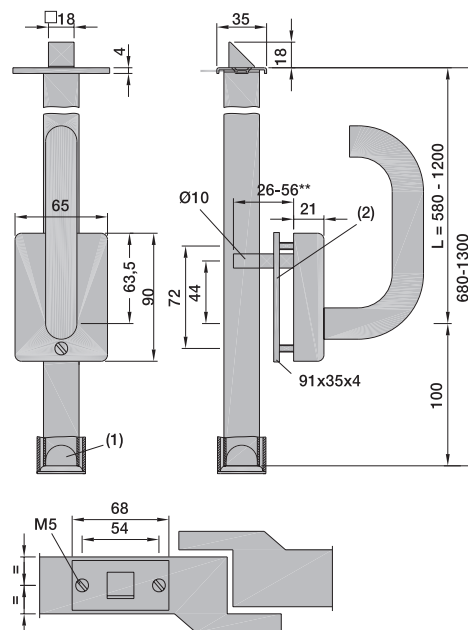

Order example

Piece	Item No.	Finish	Dimension L	For type
...piece	6091	06	—	T 30-2
...piece	6093	06	760 mm	T 30-2

Mechanism boxes / Snap latches

6691..

Mechanism box (without snap latch) of
item nos. 6091.. - 6097..

**Standard finishes on previous page,
item nos. 6091.. - 6097..**

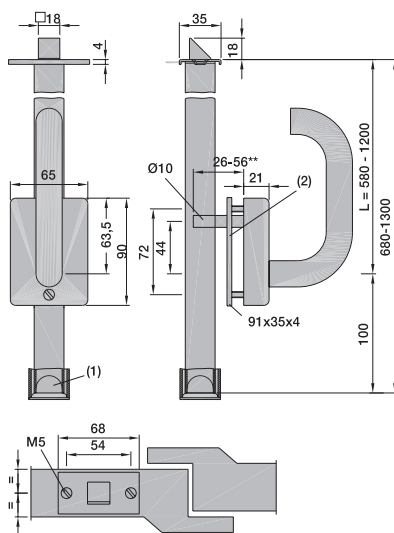

- 6591.. dim. L = 580 mm
- 6592.. dim. L up to 700 mm
- 6593.. dim. L up to 800 mm
- 6594.. dim. L up to 900 mm
- 6595.. dim. L up to 1000 mm
- 6596.. dim. L up to 1100 mm
- 6597.. dim. L up to 1200 mm

Snap latch without mechanism box of
item nos. 6091.. - 6097.. and 6791.. - 6797..

Made of steel

Approved and licensed by Staatl. Materialprüfungsamt
Nordrhein-Westfalen, Dortmund. A copy of the certificate
is available on request.

Standard finish

- a) Steel
- .06 electrogalvanised

Order example

Piece	Item No.	Finish	Dimension L	For type
...piece	6691	06	—	T 30-2
...piece	6593	06	760 mm	—

