

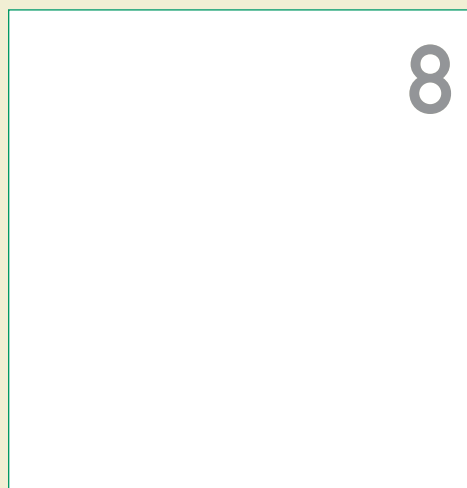

Well handled.

We treat pull handles with the utmost care (we hope you will too), because durable quality is what counts. This is why KWS handles do not only have a clean surface but above all a strong mounting system. KWS pull handles are available in anodised or coated aluminium, and in brass or stainless steel. Top of the range are our stainless steel models with brass-coloured PVD coating. On the following pages you can learn more about standard door handles, special designs and the modular system for pull handles. Please make sure that you obtain the appropriate fixing accessories.

Pull handles | 282
Modular system for pull handles | 316
Fixing kits | 328



Structural analysis of pull handles

Maximum distances

without a third fixing point

Please adhere to the following maximum distances when preparing tenders or specifications. This applies particularly to schools, hospitals and public buildings with heavily used doors. We do not guarantee for handles where distances exceed these measurements, unless a third fixing point is used.

Ø	Aluminium	Brass	Stainless steel
20 mm	1000 mm	-	1200 mm
25 mm	1400 mm	1400 mm	1600 mm
30 mm	1600 mm	1600 mm	1800 mm
35 mm	2000 mm	-	2200 mm
40 mm	2200 mm	2000 mm	2500 mm
50 mm	2400 mm	2200 mm	2500 mm

We can only supply pull handles up to a certain length, depending on the material or production method used:

anodised aluminium:	2400 mm
coated aluminium	2200 mm
brass	2200 mm
stainless steel	2500 mm

Pull handle supports

with adequate clearance

For frame doors you should check that the grip of a handle is sufficiently far away from the edge of the door to prevent fingers being trapped (at least 4 - 5 cm).



Variant B *off set support 90°*

D2	D1	Dimension B	Dimension H
Ø 20	Ø 20	75 mm	70 mm
Ø 25	Ø 25	92.5 mm	85 mm
Ø 30	Ø 25	95 mm	87.5 mm
Ø 35	Ø 25	97.5 mm	90 mm
Ø 40	Ø 30	110 mm	95 mm
Ø 50	Ø 30	115 mm	100 mm

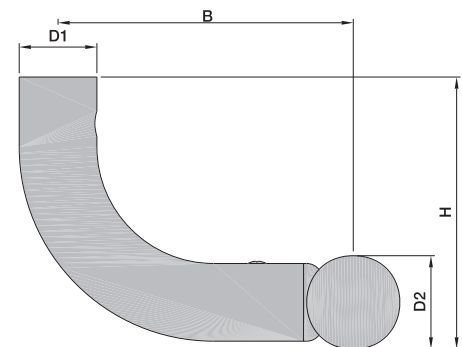

Variant C *slanting support 45°*

D2	D1	Dimension B	Dimension H
Ø 25	Ø 25	55 mm	75 mm
Ø 30	Ø 25	57.5 mm	80 mm
Ø 35	Ø 25	60 mm	85 mm
Ø 40	Ø 30	62.5 mm	90 mm
Ø 50	Ø 30	67.5 mm	100 mm

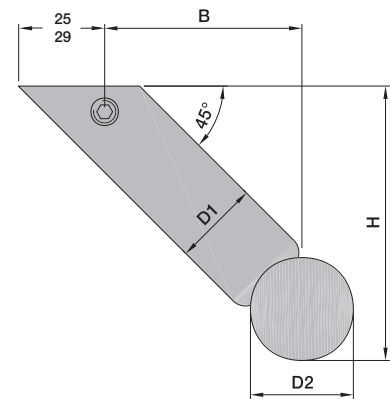

Variant G *slanting mitred support*

D2	D1	Dimension B	Dimension H
Ø 25	Ø 25	92.5 mm	75 mm
Ø 30	Ø 25	95 mm	80 mm
Ø 35	Ø 25	97.5 mm	85 mm
Ø 40	Ø 30	110 mm	90 mm
Ø 50	Ø 30	115 mm	100 mm

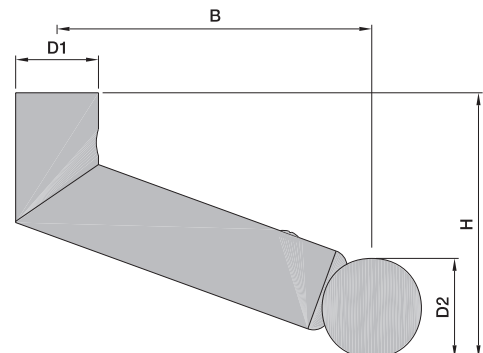

Brass- coloured PVD-coated

Brass or brass-coloured PVD-coating

Clean brass regularly

We only supply uncoated brass handles which means that over time a layer of (brownish) corrosion appears on the door handle. To prevent this, clean the pull handle regularly using brass cleaner. This will restore the shine to any brass handle.

PVD-coated door handles

As an alternative to conventional brass pull handles we supply stainless steel handles that are in brass colour using a PVD process. This attractively combines a decorative brass look with the resistance properties of a high-quality stainless steel handle. Simply wipe the handle lightly with a damp cloth to obtain a brilliant brass shine.

The following pull handles are available in .89
brass-coloured PVD-coated as part of the standard programme:

Item	Ø	Length
8918.89	30 mm	350 mm
8133.89	30 mm	300 mm
8285.89	30 mm	350 mm
8933.89	30 mm	300 mm
8936.89	30 mm	350 mm



8933.89

Pull handles in special design

KWS does not only manufacture standard pull handles but also custom-made designs. A few special models are illustrated below. The sketches of door handles show a range of regularly manufactured special models. To check production feasibility we require a dimensioned drawing

Again, if you have any queries or would like to know whether something is feasible, fax a sketch to KWS: **+49-(0)2056-930580**.

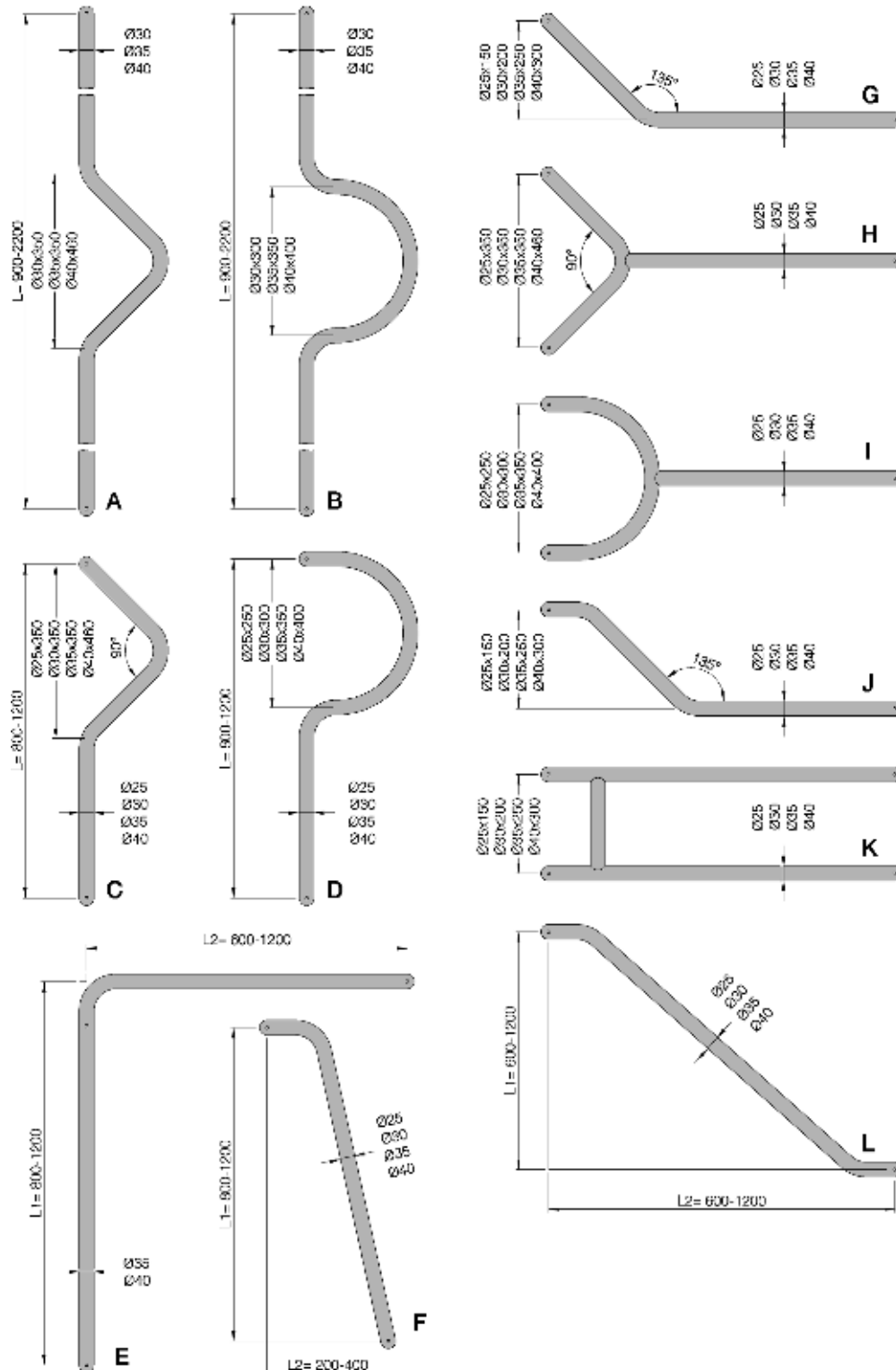

Overview



Page 282



Page 283



Page 284



Page 285



Page 286



Page 286



Page 287



Page 288



Page 289



Page 290



Page 291



Page 292



Page 293



Page 294



Page 295



Page 296



Page 297



Page 298



Page 299



Page 300



Page 301



Page 302



Page 303



Page 304



Page 305



Page 305



Page 306



Page 306



Page 307



Page 308



Page 308



Page 309

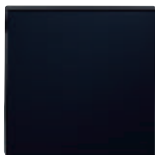

Page 309



Page 310



Page 310



Page 311



Page 311

Modular system for pull handles from Page 316 on
Fixing kits from Page 328 on

Pull handles

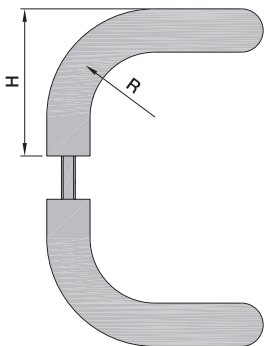
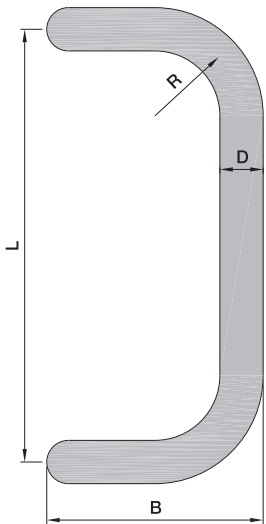

Item no.	Standard finish	Dimensions in mm				
		Ø (Dimension D)	L	B	H	R
8907	a), c), d)	20	200	100	70	40
8910	a), c), d)	20	250	100	70	40
8913	a), c), d)	20	300	100	70	40
8908	a), b), c), d)	25	200	125	85	50
8911	a), b), c), d)	25	250	125	85	50
8914	a), b), c), d)	25	300	125	85	50
8917	a), b), c), d)	25	400	125	85	50
8909	a), b), c), d)	30	200	150	90	60
8912	a), b), c), d)	30	250	150	90	60
8915	a), b), c), d)	30	300	150	90	60
8918	a), b), c), d)	30	400	150	90	60
8941	a), c), d)	35	300	175	110	70
8942	a), c), d)	35	350	175	110	70
8943	a), c), d)	35	400	175	110	70
8916	a), b), c), d)	40	300	200	130	80
8919	a), b), c), d)	40	400	200	130	80
8990	a), b), c), d)	50	400	250	150	100
8991	a), b), c), d)	50	500	250	150	100
8992	a), b), c), d)	50	600	250	150	100
8993	a), b), c), d)	50	700	250	150	100

Suitable for single sided and back-to-back (pair) installation.

For back-to-back (pair) installation please order 2 handles and one back-to-back (pair) fixing kit.

The relevant fixings are illustrated on pages 324-334 incl..

Intermediate lengths can be manufactured (dimension L). Overlengths are available on request.

Standard finish

- a) Aluminium, E4 treated
 - .22 KWS 1 silver anodised
 - .23 KWS 2 nickel-silver anodised
 - .24 KWS 3 brass-coloured anodised
 - .27 KWS 4 light brown anodised
 - .28 KWS 5 dark brown anodised
 - .29 KWS 6 black anodised
- b) Brass
 - .61 dull brushed and waxed
 - .65 polished and waxed
- c) Aluminium
 - .70 plastic coated
- d) Stainless steel



- .82 dull brushed
- .83 polished

Order example

Piece	Item No.	Finish	Dimension L	grub screw fixing	drilled/tapped fixing
...piece	8907	82	200 mm	X (LT)	X (GT)
...piece	8907	82	200 mm		

Pull handles

Item no.	Standard finish	Dimensions in mm				
		Ø (Dimension D)	L	B	H	R
8282	a), c), d)	20	200 - 1000	100	70	40
8249	a), b), c), d)	25	200 - 1200	125	85	50
8260	a), b), c), d)	30	300 - 1200	150	90	60
8296	a), c), d)	35	400 - 1200	175	110	70
8271	a), b), c), d)	40	400 - 1200	200	130	80

Suitable for single sided and back-to-back (pair) installation.

For back-to-back (pair) installation please order 2 handles and one back-to-back (pair) fixing kit.

The relevant fixings are illustrated on pages 324-334 incl..

Intermediate lengths can be manufactured (dimension L). Overlengths are available on request.

Standard finish

- a) Aluminium, E4 treated
 - .22 KWS 1 silver anodised
 - .23 KWS 2 nickel-silver anodised
 - .24 KWS 3 brass-coloured anodised
 - .27 KWS 4 light brown anodised
 - .28 KWS 5 dark brown anodised
 - .29 KWS 6 black anodised
- b) Brass
 - .61 dull brushed and waxed
 - .65 polished and waxed
- c) Aluminium
 - .70 plastic coated
- d) Stainless steel
 - .82 dull brushed
 - .83 polished

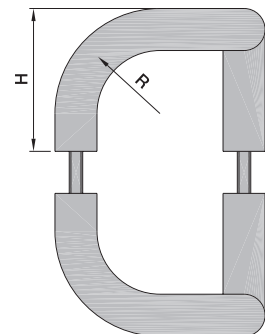
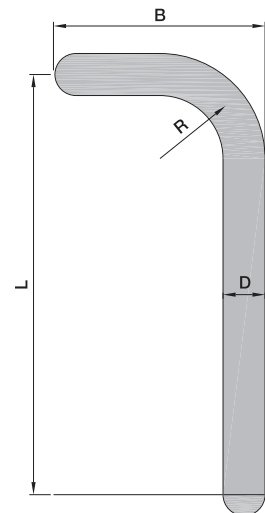

Order example

Piece	Item No.	Finish	Dimension L	grub screw fixing	drilled/tapped fixing
...piece	8282	82	350 mm	x (LT)	x (GT)
...piece	8282	82	350 mm		

Pull handles

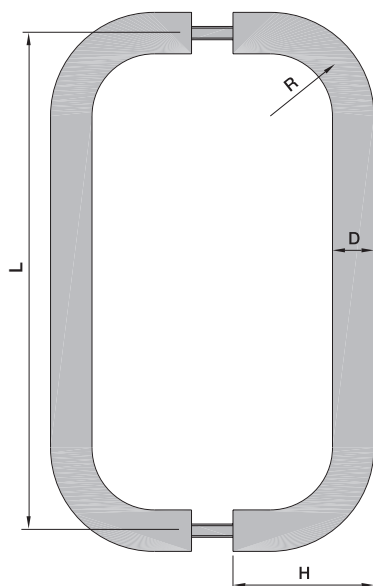

Item no.	Standard finish	Dimensions in mm			
		Ø (Dimension D)	L	H	R
8748	a), c), d)	20	200-1000	70	40
8758	a), b), c), d)	25	200-1200	85	50
8768	a), b), c), d)	30	300-1200	90	60
8797	a), c), d)	35	400-1200	110	70
8778	a), b), c), d)	40	400-1200	130	80
8788	a), b), c), d)	50	400-1200	150	100

Suitable for single sided and back-to-back (pair) installation.

For back-to-back (pair) installation please order 2 handles and one back-to-back (pair) fixing kit.

The relevant fixings are illustrated on pages 324-334 incl..

Intermediate lengths can be manufactured (dimension L). Overlengths are available on request.

Standard finish

- a) Aluminium, E4 treated**
 - .22 KWS 1 silver anodised
 - .23 KWS 2 nickel-silver anodised
 - .24 KWS 3 brass-coloured anodised
 - .27 KWS 4 light brown anodised
 - .28 KWS 5 dark brown anodised
 - .29 KWS 6 black anodised
- b) Brass**
 - .61 dull brushed and waxed
 - .65 polished and waxed
- c) Aluminium**
 - .70 plastic coated
- d) Stainless steel**
 -  .82 dull brushed
 - .83 polished

Order example

Piece	Item No.	Finish	Dimension L	grub screw fixing	drilled/tapped fixing
...piece	8748	82	350 mm	X (LT)	
...piece	8748	82	350 mm		X (GT)

Item no.	Standard finish	Dimensions in mm				
		Ø (Dimension D)	L	B	H	R
8922	a), c), d)	20	200	160	70	40
8920	a), b), c), d)	25	165	160	85	50
8923	a), b), c), d)	25	200	175	85	50
8926	a), b), c), d)	25	250	200	85	50
8932	a), b), c), d)	25	300	225	85	50
8935	a), b), c), d)	25	350	250	85	50
8938	a), b), c), d)	25	400	275	85	50
8921	a), b), c), d)	30	165	170	90	60
8924	a), b), c), d)	30	200	190	90	60
8927	a), b), c), d)	30	250	215	90	60
8933	a), b), c), d)	30	300	240	90	60
8936	a), b), c), d)	30	350	265	90	60
8939	a), b), c), d)	30	400	290	90	60
8931	a), c), d)	35	350	280	110	70
8925	a), b), c), d)	40	200	220	130	80
8937	a), b), c), d)	40	350	295	130	80
8940	a), b), c), d)	40	400	320	130	80
8962	a), b), c), d)	50	500	400	150	100

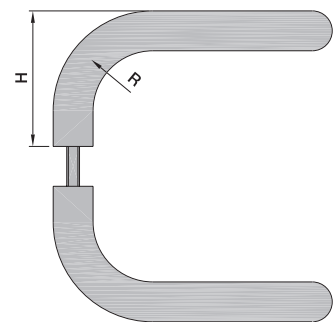
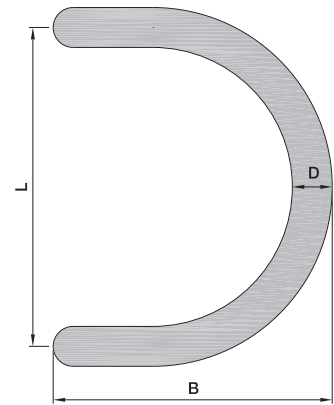

Suitable for single sided and back-to-back (pair) installation.

For back-to-back (pair) installation please order 2 handles and one back-to-back (pair) fixing kit.

The relevant fixings are illustrated on pages 324-334 incl..

Standard finish

- a) Aluminium, E4 treated
 - .22 KWS 1 silver anodised
 - .23 KWS 2 nickel-silver anodised
 - .24 KWS 3 brass-coloured anodised
 - .27 KWS 4 light brown anodised
 - .28 KWS 5 dark brown anodised
 - .29 KWS 6 black anodised

- b) Brass
 - .61 dull brushed and waxed
 - .65 polished and waxed
- c) Aluminium
 - .70 plastic coated
- d) Stainless steel
 - .82 dull brushed
 - .83 polished



Order example

Piece	Item No.	Finish	Dimension L	grub screw fixing	drilled/tapped fixing
...piece	8922	82	200 mm	x (LT)	
...piece	8922	82	200 mm		x (GT)

Pull handles

8954..

Dimensions: D = Ø 25 mm, GL=190 mm, L=100 mm, B=190 mm, H=85 mm
Suitable for single sided and back-to-back (pair) installation.
For back-to-back (pair) installation please order 2 handles and one back-to-back (pair) fixing kit. The relevant fixings are illustrated on pages 324-334 incl..

Standard finish

- a) Aluminium, E4 treated
 - .22 KWS 1 silver anodised
 - .23 KWS 2 nickel-silver anodised
 - .24 KWS 3 brass-coloured anodised
 - .27 KWS 4 light brown anodised
 - .28 KWS 5 dark brown anodised
 - .29 KWS 6 black anodised
- b) Brass
 - .61 dull brushed and waxed
 - .65 polished and waxed
- c) Aluminium
 - .70 plastic coated
- d) Stainless steel
 - 
 - .82 dull brushed
 - .83 polished

8955..

Dimensions: D = Ø 25 mm, GL=215 mm, L=100 mm, B=140 mm, H=85 mm
Suitable for single sided and back-to-back (pair) installation.
For back-to-back (pair) installation please order 2 handles and one back-to-back (pair) fixing kit. The relevant fixings are illustrated on pages 324-334 incl..

Standard finish

- a) Aluminium, E4 treated
 - .22 KWS 1 silver anodised
 - .23 KWS 2 nickel-silver anodised
 - .24 KWS 3 brass-coloured anodised
 - .27 KWS 4 light brown anodised
 - .28 KWS 5 dark brown anodised
 - .29 KWS 6 black anodised
- b) Brass
 - .61 dull brushed and waxed
 - .65 polished and waxed
- c) Aluminium
 - .70 plastic coated
- d) Stainless steel
 - 
 - .82 dull brushed
 - .83 polished

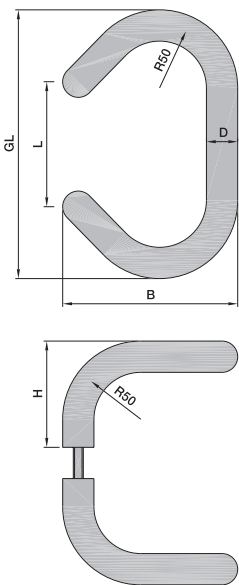
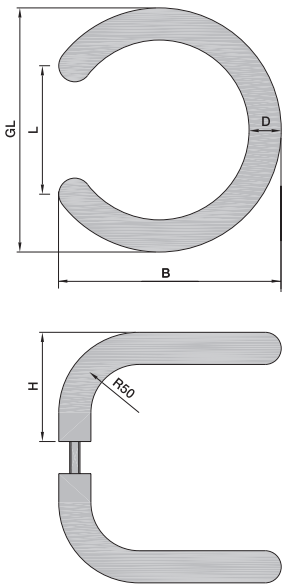

Order example

Piece	Item No.	Finish	Dimension L	grub screw fixing	drilled/tapped fixing
...piece	8954	82	100 mm	X (LT)	X (GT)
...piece	8954	82	100 mm		

Item no.	Standard finish	Dimensions in mm				
		Ø (Dimension D)	L	H		
8720	a), b), c), d)	25	165	110		
8723	a), b), c), d)	25	200	125		
8726	a), b), c), d)	25	250	150		
8732	a), b), c), d)	25	300	175		
8735	a), b), c), d)	25	350	200		
8738	a), b), c), d)	25	400	225		
8721	a), b), c), d)	30	165	115		
8724	a), b), c), d)	30	200	130		
8727	a), b), c), d)	30	250	155		
8733	a), b), c), d)	30	300	180		
8736	a), b), c), d)	30	350	205		
8739	a), b), c), d)	30	400	230		



Suitable for single sided and back-to-back (pair) installation.

For back-to-back (pair) installation please order 2 handles and one back-to-back (pair) fixing kit.

The relevant fixings are illustrated on pages 324-334 incl..

Standard finish

- a) Aluminium, E4 treated
 - .22 KWS 1 silver anodised
 - .23 KWS 2 nickel-silver anodised
 - .24 KWS 3 brass-coloured anodised
 - .27 KWS 4 light brown anodised
 - .28 KWS 5 dark brown anodised
 - .29 KWS 6 black anodised
- b) Brass
 - .61 dull brushed and waxed
 - .65 polished and waxed
- c) Aluminium
 - .70 plastic coated
- d) Stainless steel
 - .82 dull brushed
 - .83 polished

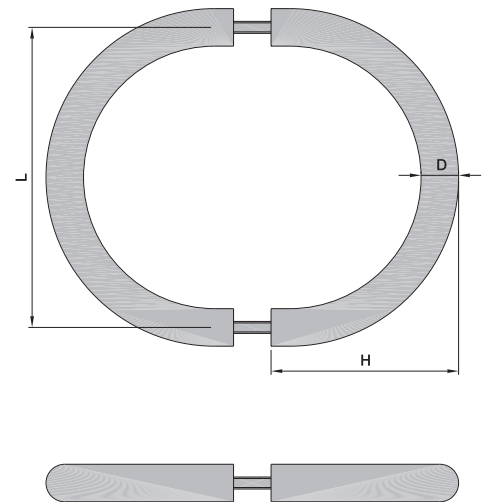

Order example

Piece	Item No.	Finish	Dimension L	grub screw fixing	drilled/tapped fixing
...piece	8720	82	165 mm	x (LT)	
...piece	8720	82	165 mm		x (GT)

Pull handles



Item no.	Standard finish	Dimensions in mm				
		Ø (Dimension D)	L	B	H	R
8951	a), b), c), d)	25	200	85	130	50
8952	a), b), c), d)	30	200	90	130	60

Suitable for single sided and back-to-back (pair) installation.

For back-to-back (pair) installation please order 2 handles and one back-to-back (pair) fixing kit.

The relevant fixings are illustrated on pages 324-334 incl..

Standard finish

- a) Aluminium, E4 treated
 - .22 KWS 1 silver anodised
 - .23 KWS 2 nickel-silver anodised
 - .24 KWS 3 brass-coloured anodised
 - .27 KWS 4 light brown anodised
 - .28 KWS 5 dark brown anodised
 - .29 KWS 6 black anodised
- b) Brass
 - .61 dull brushed and waxed
 - .65 polished and waxed
- c) Aluminium
 - .70 plastic coated
- d) Stainless steel
 - .82 dull brushed
 - .83 polished

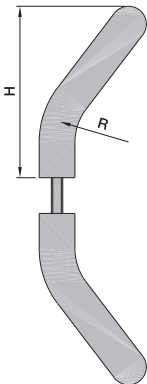
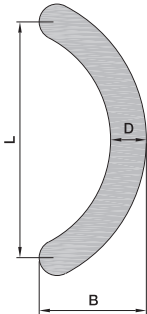

Order example

Piece	Item No.	Finish	Dimension L	grub screw fixing	drilled/tapped fixing
...piece	8951	82	200 mm	X (LT)	
...piece	8951	82	200 mm		X (GT)

Item no.	Standard finish	Dimensions in mm				
		Ø (Dimension D)	L	B	H	R
8288	a), c), d)	20	300	155	70	40
8131	a), b), c), d)	25	300	155	85	50
8284	a), b), c), d)	25	350	180	85	50
8133	a), b), c), d)	30	300	155	90	60
8285	a), b), c), d)	30	350	180	90	60
8283	a), c), d)	35	350	180	110	70
8286	a), b), c), d),	40	460	240	130	80
8287	a), b), c), d)	50	460	240	150	100



Suitable for single sided and back-to-back (pair) installation.

For back-to-back (pair) installation please order 2 handles and one back-to-back (pair) fixing kit.

The relevant fixings are illustrated on pages 324-334 incl..

Overlength are available on request.

Standard finish

- a) Aluminium, E4 treated
 - .22 KWS 1 silver anodised
 - .23 KWS 2 nickel-silver anodised
 - .24 KWS 3 brass-coloured anodised
 - .27 KWS 4 light brown anodised
 - .28 KWS 5 dark brown anodised
 - .29 KWS 6 black anodised
- b) Brass
 - .61 dull brushed and waxed
 - .65 polished and waxed
- c) Aluminium
 - .70 plastic coated
- d) Stainless steel
 - .82 dull brushed
 - .83 polished

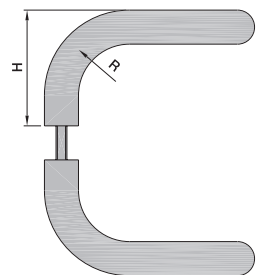
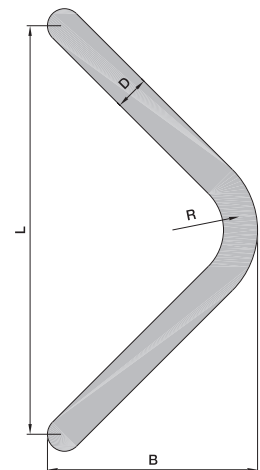

Order example

Piece	Item No.	Finish	Dimension L	grub screw fixing	drilled/tapped fixing
...piece	8288	82	300 mm	x (LT)	
...piece	8288	82	300 mm		x (GT)

Pull handles



Item no.	With centre piece of	Dimensions in mm				
		Ø (Dimension D)	L	H		
8154	acrylic glass colourless	40	400-1000	90		
8155	oak wood solid, open-pored treated	40	400-1000	90		
8156	stainless steel dull brushed	40	400-1200	90		
8157	stainless steel coloured plastic coated	40	400-1200	90		
8158	brass dull brushed and waxed	40	400-1200	90		
8159	beech wood solid, open-pored treated	40	400-1200	90		

Suitable for single sided and back-to-back (pair) installation.

For back-to-back (pair) installation please order 2 handles and one back-to-back (pair) fixing kit.

The relevant fixings are illustrated on pages 324-334 incl..

Intermediate lengths can be manufactured (dimension L). Overlengths are available on request.

Standard finish

a) Stainless steel



.82 dull brushed
.83 polished

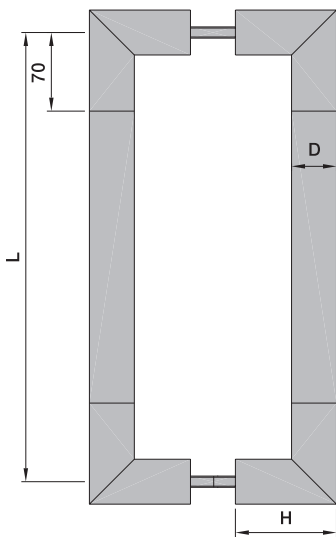

Order example

Piece	Item No.	Finish	Dimension L	grub screw fixing	drilled/tapped fixing
...piece	8154	82	400 mm	X (LT)	
...piece	8154	82	400 mm		X (GT)

Pull handles

Item no.	Standard finish	Dimensions in mm				
		Ø (Dimension D)	L	H		
8135	a)	20	200 - 1000	70		
8170	a)	25	200 - 1200	75		
8171	a)	30	200 - 1200	80		
8137	a)	35	200 - 1200	85		
8172	a)	40	200 - 1200	90		
8173	a)	50	200 - 1200	100		

Suitable for single sided and back-to-back (pair) installation.

For back-to-back (pair) installation please order 2 handles and one back-to-back (pair) fixing kit.

The relevant fixings are illustrated on pages 324-334 incl..

Intermediate lengths can be manufactured (dimension L). Overlengths are available on request.

Standard finish

a) Stainless steel



.82 dull brushed

.83 polished

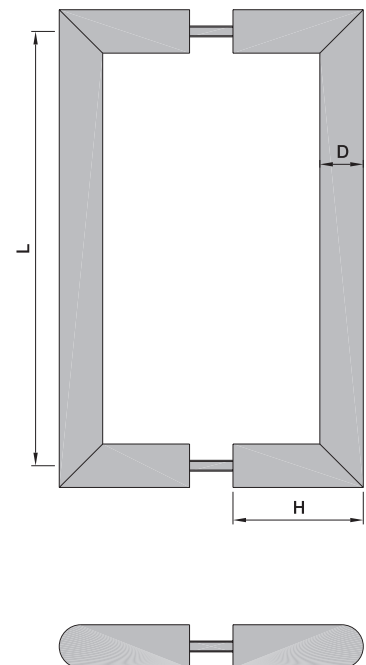

Order example

Piece	Item No.	Finish	Dimension L	grub screw fixing	drilled/tapped fixing
...piece	8135	82	400 mm	x (LT)	
...piece	8135	82	400 mm		x (GT)

Pull handles



Item no.	Standard finish	Dimensions in mm			
		Ø (Dimension D)	L	B	H
8174	a)	25	200 - 1200	55	75
8175	a)	30	200 - 1200	60	80
8141	a)	35	200 - 1200	65	85
8176	a)	40	200 - 1200	75	90
8177	a)	50	200 - 1200	90	100

Suitable for single sided and back-to-back (pair) installation.

For back-to-back (pair) installation please order 2 handles and one back-to-back (pair) fixing kit.

The relevant fixings are illustrated on pages 324-334 incl..

25° offset

Intermediate lengths can be manufactured (dimension L). Overlengths are available on request.

Standard finish

a) Stainless steel



.82 dull brushed
.83 polished

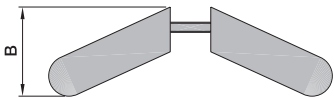
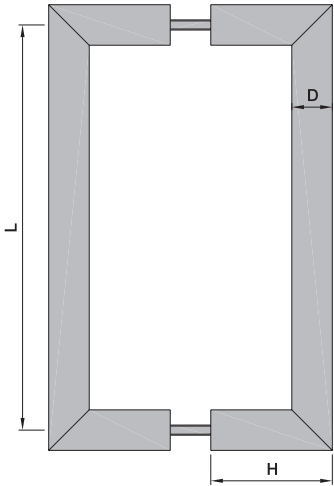

8

Order example

Piece	Item No.	Finish	Dimension L	grub screw fixing	drilled/tapped fixing
...piece	8174	82	400 mm	X (LT)	
...piece	8174	82	400 mm		X (GT)

Pull handles

Item no.	Standard finish	Dimensions in mm			Ø Fixing supports
		Ø (Dimension D)	GL	H	
8143	a), c), d)	20	200 - 1000	70	20
8178	a), b), c), d)	25	200 - 1200	75	25
8179	a), b), c), d)	30	200 - 1200	80	25
8169	a), c), d)	35	200 - 1200	85	25
8180	a), b), c), d)	40	200 - 1200	90	30
8181	a), b), c), d)	50	200 - 1200	100	30

Suitable for single sided and back-to-back (pair) installation.

For back-to-back (pair) installation please order 2 handles and one back-to-back (pair) fixing kit.

The relevant fixings are illustrated on pages 324-334 incl..

This pull handle is also available with three different offset supports (except 8143 / see photographs below, further details in the technical appendix of this product group):

Variant B - off set support 90°

Variant C - slanting support 45°

Variant G - slanting mitred support

Ends also available with round end caps.

Intermediate lengths can be manufactured (dimension L). Overlengths are available on request.

Standard finish

a) Aluminium, E4 treated

- .22 KWS 1 silver anodised
- .23 KWS 2 nickel-silver anodised
- .24 KWS 3 brass-coloured anodised
- .27 KWS 4 light brown anodised
- .28 KWS 5 dark brown anodised
- .29 KWS 6 black anodised

b) Brass

- .61 dull brushed and waxed
- .65 polished and waxed

c) Aluminium

- .70 plastic coated

d) Stainless steel

- .82 dull brushed
- .83 polished

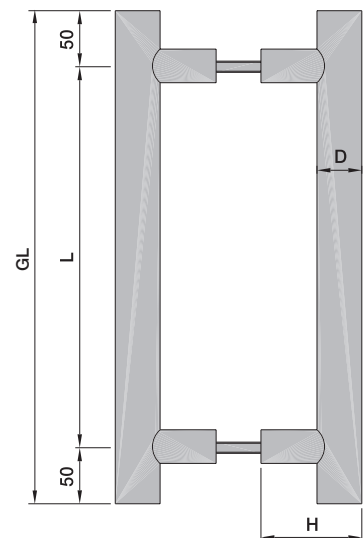

Support B



Support C



Support G

Order example

Piece	Item No.	Finish	Dimension GL	Dimension L	grub screw fixing	drilled/tapped fixing
...piece	8143	82	960 mm	860 mm	x (LT)	
...piece	8143	82	960 mm	860 mm		x (GT)

Pull handles



Item no.	Standard finish	Dimensions in mm					
		Angle	(Dimension D)	GL	L	B	H
8101	a)	120°	25	450	300	177	75
8102	a)	120°	25	495	350	191	80
8103	a)	120°	30	450	300	181	75
8104	a)	120°	30	495	350	200	80

Suitable for single sided an back-to-back (pair) installation

slanting support 45°

The relevant fixings are illustrated on pages 324-334 incl..

Standard finish

a) Stainless steel



- .82 dull brushed
- .83 polished

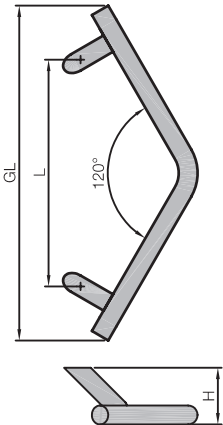

Order example

Piece	Item No.	Finish
...piece	8101	82

Item no.	Standard finish	Dimensions in mm					
		Angle	(Dimension D)	GL	L	B	H
8105	a)	160°	25	630	300	119	75
8106	a)	160°	25	685	350	123	80
8107	a)	160°	30	630	300	124	75
8108	a)	160°	30	685	350	128	80

Suitable for single sided an back-to-back (pair) installation

slanting support 45°

The relevant fixings are illustrated on pages 324-334 incl..

Standard finish

a) Stainless steel



.82 dull brushed

.83 polished

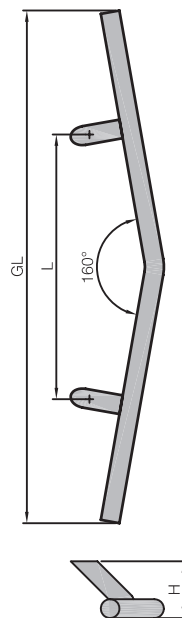

Order example

Piece ...piece	Item No. 8105	Finish 82
-------------------	------------------	--------------

Pull handles



Item no.	Standard finish	Dimensions in mm				
		Ø (Dimension D)	L	B	H	R
8145	d)	20	200 - 1000	50	85	40
8182	a), b), c), d)	25	200 - 1200	60	110	50
8183	a), b), c), d)	30	300 - 1200	70	125	60
8147	d)	35	300 - 1200	80	135	70
8184	a), b), c), d)	40	400 - 1200	90	160	80
8185	a), b), c), d)	50	500 - 1200	115	190	100

Suitable for single sided and back-to-back (pair) installation.

For back-to-back (pair) installation please order 2 handles and one back-to-back (pair) fixing kit.

The relevant fixings are illustrated on pages 324-334 incl..

Intermediate lengths can be manufactured (dimension L). Overlengths are available on request.

Standard finish

- a) Aluminium, E4 treated
 - .22 KWS 1 silver anodised
 - .23 KWS 2 nickel-silver anodised
 - .24 KWS 3 brass-coloured anodised
 - .27 KWS 4 light brown anodised
 - .28 KWS 5 dark brown anodised
 - .29 KWS 6 black anodised
- b) Brass
 - .61 dull brushed and waxed
 - .65 polished and waxed
- c) Aluminium
 - .70 plastic coated
- d) Stainless steel
 - .82 dull brushed
 - .83 polished

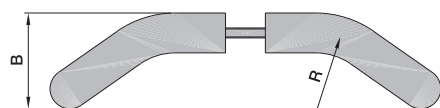
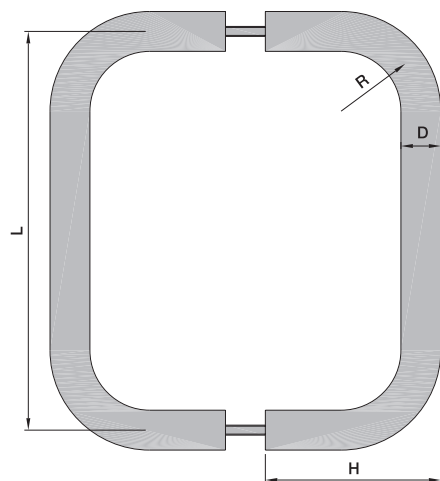

Order example

Piece	Item No.	Finish	Dimension L	grub screw fixing	drilled/tapped fixing
...piece	8145	82	400 mm	X (LT)	
...piece	8145	82	400 mm		X (GT)

Pull handles

Item no.	Standard finish	Dimensions in mm			
		Ø (Dimension D)	L	B	H
8149	a)	20	200	120	70
8186	a)	25	200	125	75
8187	a)	30	300	180	80
8191	a)	30	350	205	80
8190	a)	35	350	210	85
8188	a)	40	400	240	90
8189	a)	50	500	300	100

Suitable for single sided and back-to-back (pair) installation.

For back-to-back (pair) installation please order 2 handles and one back-to-back (pair) fixing kit.

The relevant fixings are illustrated on pages 324-334 incl..

Standard finish

a) Stainless steel



.82 dull brushed

.83 polished

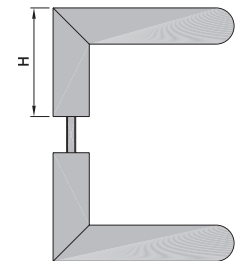
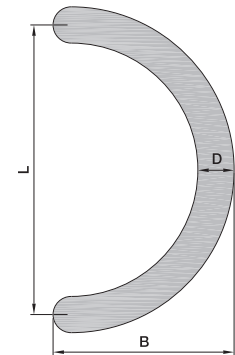

8

Order example

Piece	Item No.	Finish	Dimension L	grub screw fixing	drilled/tapped fixing
...piece	8149	82	200 mm	x (LT)	
...piece	8149	82	200 mm		x (GT)

Pull handles



Item no.	Standard finish	Dimensions in mm				Ø Fixing Supports
		Ø (Dimension D)	L	B	H	
8958	a), b), c)	30	300	180	80	25
8961	a), b), c)	30	350	205	80	25
8959	a), b), c)	35	350	210	85	25
8960	a), b), c)	40	400	240	90	30

Suitable for single sided and back-to-back (pair) installation.

For back-to-back (pair) installation please order 2 handles and one back-to-back (pair) fixing kit.

The relevant fixings are illustrated on pages 324-334 incl..

Standard finish

- a) Aluminium, E4 treated
 - .22 KWS 1 silver anodised
 - .23 KWS 2 nickel-silver anodised
 - .24 KWS 3 brass-coloured anodised
 - .27 KWS 4 light brown anodised
 - .28 KWS 5 dark brown anodised
 - .29 KWS 6 black anodised
- b) Aluminium
 - .70 plastic coated
- c) Stainless steel
 - .82 dull brushed
 - .83 polished

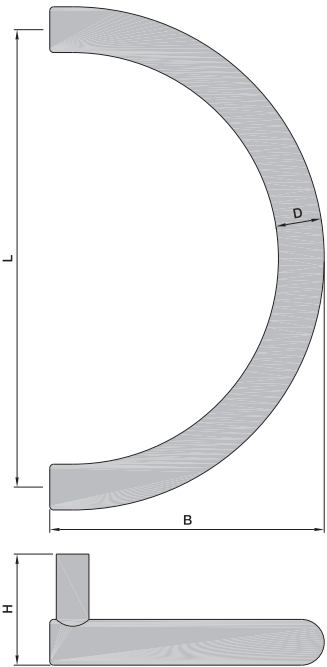

Order example

Piece	Item No.	Finish	Dimension L	grub screw fixing	drilled/tapped fixing
...piece	8958	82	300 mm	X (LT)	
...piece	8958	82	300 mm		X (GT)

Pull handles

Item no.	Standard finish	Dimensions in mm				
		Ø (Dimension D)	L	B	H	R
8956	a)	30	200	230	90	60
8957	a)	40	300	310	130	80

Suitable for single sided and back-to-back (pair) installation.

For back-to-back (pair) installation please order 2 handles and one back-to-back (pair) fixing kit.

The relevant fixings are illustrated on pages 324-334 incl..

Standard finish

a) Stainless steel



- .82 dull brushed
- .83 polished

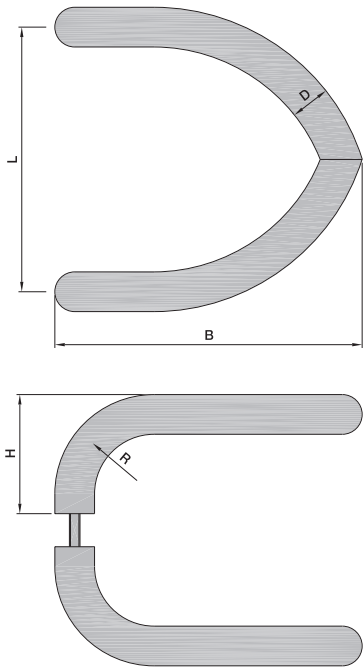

8

Order example

Piece	Item No.	Finish	Dimension L	grub screw fixing	drilled/tapped fixing
...piece	8956	82	200 mm	x (LT)	
...piece	8956	82	200 mm		x (GT)

Pull handles



Item no.	With centre piece of	Dimensions in mm			
		Ø (Dimension D)	L	H	
8160	Corian blue or black	40	400	90	

Suitable for single sided and back-to-back (pair) installation.

For back-to-back (pair) installation please order 2 handles and one back-to-back (pair) fixing kit.

The relevant fixings are illustrated on pages 324-334 incl..

With central piece of Corian, available in the following colours:
Sierra blue
Sierra black

Alternatively Ø 30 mm is available.

Standard finish

a) Stainless steel



.82 dull brushed

.83 polished

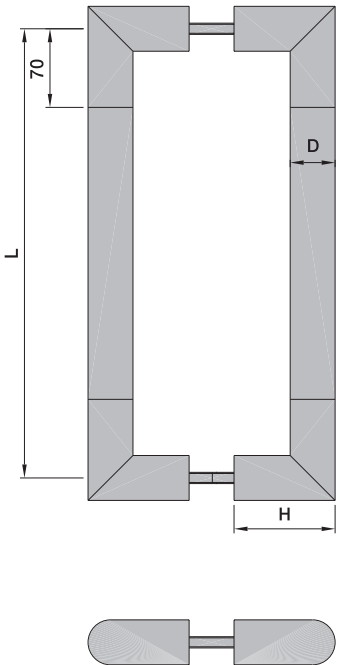

8

Order example

Piece	Item No.	Finish	Dimension L	grub screw fixing	drilled/tapped fixing
...piece	8160	82	400 mm	X (LT)	
...piece	8160	82	400 mm		X (GT)

Pull handles

Item no.	Standard finish	Dimensions in mm				
		Ø (Dimension D)	GL	B	H	L
8221	a), b), c), d)	30	200-1200	80	80	max. GL - 80

Suitable for single sided and back-to-back (pair) installation.

For back-to-back (pair) installation please order 2 handles and one back-to-back (pair) fixing kit.

The relevant fixings are illustrated on pages 324-334 incl..

The finish refers to the handle. The supports are always made of aluminium, anodised or coloured, plastic coated as requested.

Intermediate lengths can be manufactured (dimension L). Overlengths are available on request.

Standard finish

- a) Aluminium, E4 treated
 - .22 KWS 1 silver anodised
 - .23 KWS 2 nickel-silver anodised
 - .24 KWS 3 brass-coloured anodised
 - .27 KWS 4 light brown anodised
 - .28 KWS 5 dark brown anodised
 - .29 KWS 6 black anodised

b) Brass

- .61 dull brushed and waxed
- .65 polished and waxed

c) Aluminium

- .70 plastic coated

d) Stainless steel



- .82 dull brushed
- .83 polished

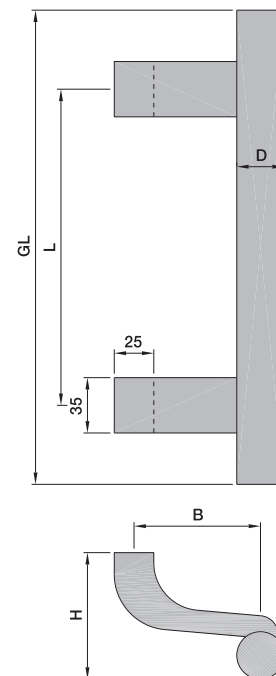

Order example

Piece	Item No.	Finish	Dimension GL	Dimension L	grub screw fixing	drilled/tapped fixing
...piece	8221	82	400 mm	200 mm	x (LT)	
...piece	8221	82	400 mm	200 mm		x (GT)

Locking pull handles



Item no.	Standard finish	Dimensions in mm			
		Ø (Dimension D)	GL	B	H
8199	a)	30	1190	80	1000

Door handle with bolt and lock for locking glass doors on one side.

For door operation from both sides available as pair, in combination with door handle 8179.82, or for operation from one side available as one piece.

The relevant fixings are illustrated on pages 324-334 incl..

Standard finish

a) Stainless steel



.82 dull brushed

.83 polished

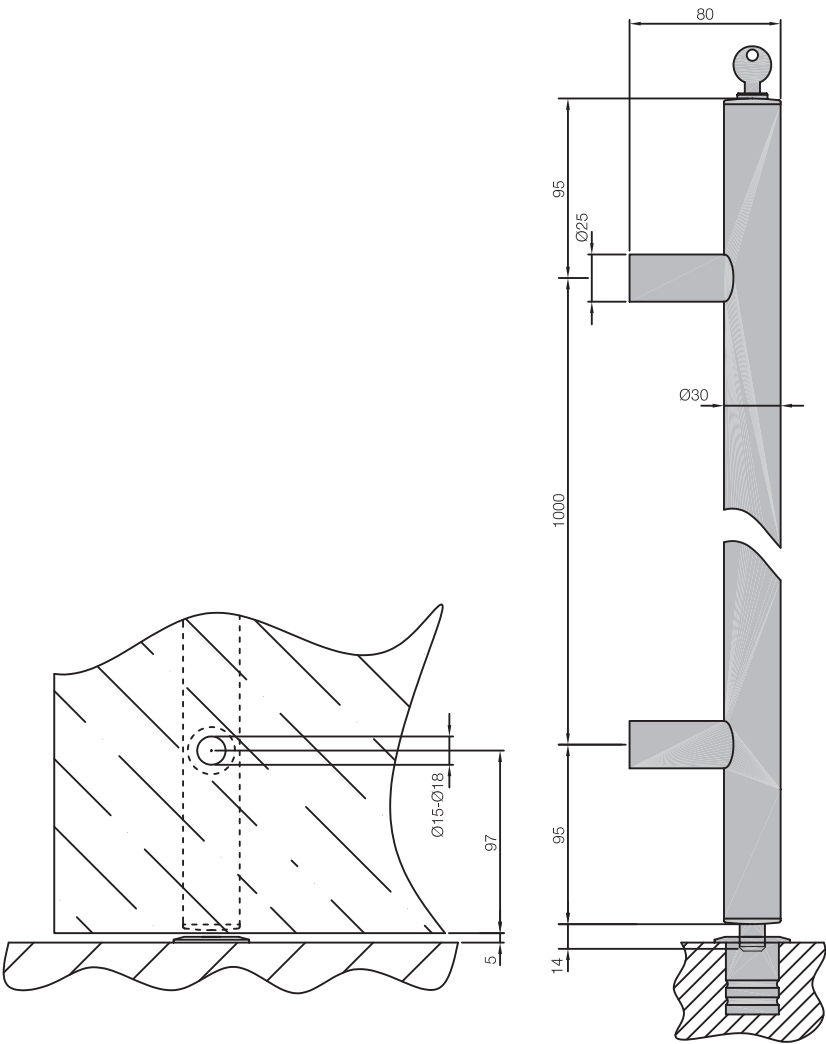

Order example

Piece ...piece	Item No.	Finish	Dimension L
	8199	82	1000 mm

Item no.	Standard finish	Dimensions in mm				
		Ø (Dimension D)	L	H	B	C
8501	a), c)	25	300	85	55	40
8502	a), c)	25	400	85	55	40
8503	a), c)	25	500	85	55	40
8504	a), c)	25	600	85	55	40
8505	a), c)	25	700	85	55	40
8506	a), c)	25	800	85	55	40
8507	a), c)	25	900	85	55	40
8508	a), c)	25	1000	85	55	40
8511	a), b), c)	30	300	90	60*/65**	44*/47,5**
8512	a), b), c)	30	400	90	60*/65**	44*/47,5**
8513	a), b), c)	30	500	90	60*/65**	44*/47,5**
8514	a), b), c)	30	600	90	60*/65**	44*/47,5**
8515	a), b), c)	30	700	90	60*/65**	44*/47,5**
8516	a), b), c)	30	800	90	60*/65**	44*/47,5**
8517	a), b), c)	30	900	90	60*/65**	44*/47,5**
8518	a), b), c)	30	1000	90	60*/65**	44*/47,5**

Intermediate lengths can be manufactured (dimension L). Overlengths are available on request.

* **Standard finish: aluminium (roses screwed on)**
 ** **Standard finish: stainless steel (roses welded on)**

Standard finish

- a) Steel
 - .03 black stove-enamelled
- b) Aluminium, E4 treated
 - .22 KWS 1 silver anodised
 - .23 KWS 2 nickel-silver anodised
 - .24 KWS 3 brass-coloured anodised
 - .27 KWS 4 light brown anodised
 - .28 KWS 5 dark brown anodised
 - .29 KWS 6 black anodised
- c) Steel
 - .70 plastic coated
- d) Stainless steel
 - .82 dull brushed
 - .83 polished

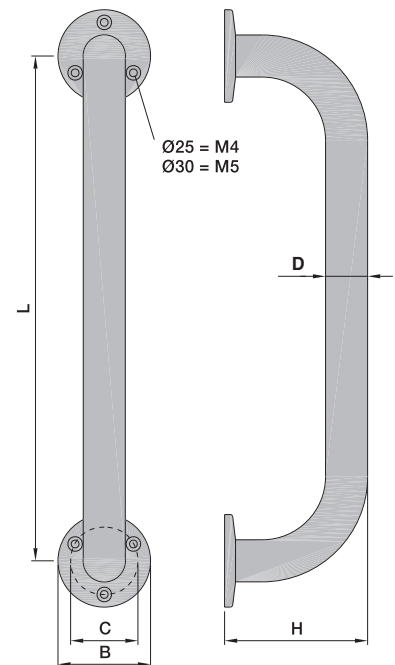

Order example

Piece	Item No.	Finish	Dimension L
...piece	8501	03	300 mm

Pull handles

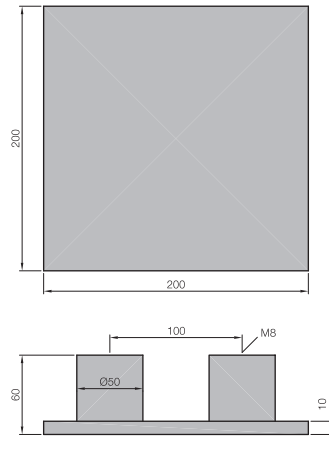

8905.. of aluminium

for concealed fixing,
Aluminium plate 200 x 200 x 10 mm, H = 60 mm with
two round supports

Suitable for single sided and back-to-back (pair)
installation.

For back-to-back (pair) installation please
order 2 handles and one back-to-back (pair) fixing kit.

The relevant fixings are illustrated
on pages 324-334 incl..

Standard finish

- a) Aluminium, E4 treated
 - .22 KWS 1 silver anodised
 - .23 KWS 2 nickel-silver anodised
 - .24 KWS 3 brass-coloured anodised
 - .27 KWS 4 light brown anodised
 - .28 KWS 5 dark brown anodised
 - .29 KWS 6 black anodised
- b) Aluminium, E6 treated
 - .41 KWS 1 silver anodised
 - .42 KWS 2 nickel-silver anodised
 - .43 KWS 3 brass-coloured anodised
 - .46 KWS 4 light brown anodised
 - .47 KWS 5 dark brown anodised
 - .48 KWS 6 black anodised
- c) Aluminium
 - .70 plastic coated

Order example

Piece	Item No.	Finish
...piece	8905	22

8203.. aluminium plate, 150x150x10 mm,
A=90 mm, B=50 mm

8205.. aluminium plate, 200x200x10 mm,
A=110 mm, B=70 mm

On aluminium profile support

Standard finish

- a) Aluminium, E4 treated
 - .22 KWS 1 silver anodised
 - .23 KWS 2 nickel-silver anodised
 - .24 KWS 3 brass-coloured anodised
 - .27 KWS 4 light brown anodised
 - .28 KWS 5 dark brown anodised
 - .29 KWS 6 black anodised
- b) Aluminium, E6 treated
 - .41 KWS 1 silver anodised
 - .42 KWS 2 nickel-silver anodised
 - .43 KWS 3 brass-coloured anodised
 - .46 KWS 4 light brown coloured
 - .47 KWS 5 dark brown coloured
 - .48 KWS 6 black coloured
- c) Aluminium
 - .70 plastic coated

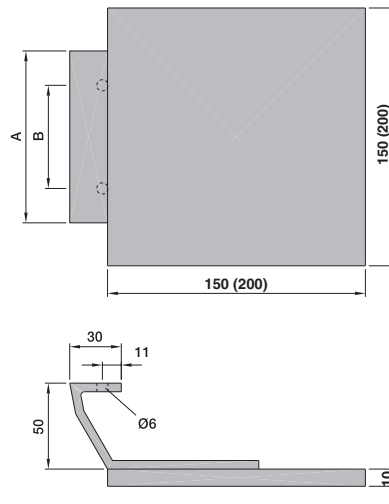

8210.. plastic plate, black, plain,
150x150x18 mm, A=90 mm,
B=50 mm

On aluminium profile support

Standard finish (profile support)

- a) Aluminium, E4 treated
 - .22 KWS 1 silver anodised
 - .23 KWS 2 nickel-silver anodised
 - .24 KWS 3 brass-coloured anodised
 - .27 KWS 4 light brown anodised
 - .28 KWS 5 dark brown anodised
- b) Aluminium, E6 treated
 - .41 KWS 1 silver anodised
 - .42 KWS 2 nickel-silver anodised
 - .43 KWS 3 brass-coloured anodised
 - .47 KWS 5 dark brown anodised
- c) Aluminium
 - .70 plastic coated

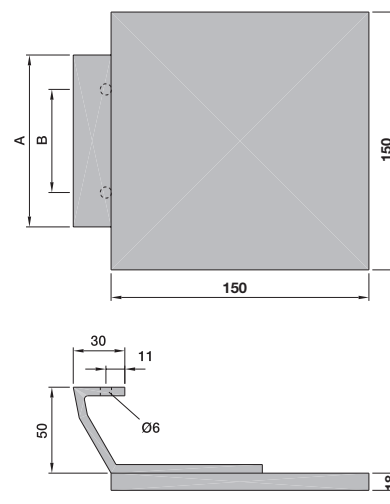

Order example

Piece	Item No.	Finish
...piece	8203	22

Pull handles

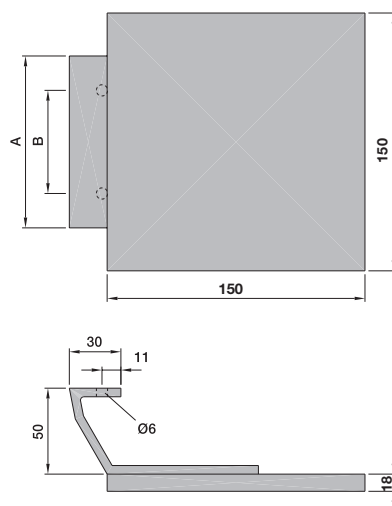

8216.. plastic plate, black, fine embossed,
150x150x18 mm,
A = 90 mm,
B = 50 mm

On aluminium profile support

Standard finish (profile support)

- a) Aluminium, E4 treated
 - .22 KWS 1 silver anodised
 - .23 KWS 2 nickel-silver anodised
 - .24 KWS 3 brass-coloured anodised
 - .27 KWS 4 light brown anodised
 - .28 KWS 5 dark brown anodised
 - .29 KWS 6 black anodised
- b) Aluminium, E6 treated
 - .41 KWS 1 silver anodised
 - .42 KWS 2 nickel-silver anodised
 - .43 KWS 3 brass-coloured anodised
 - .46 KWS 4 light brown anodised
 - .47 KWS 5 dark brown anodised
 - .48 KWS 6 black anodised
- c) Aluminium
 - .70 plastic coated

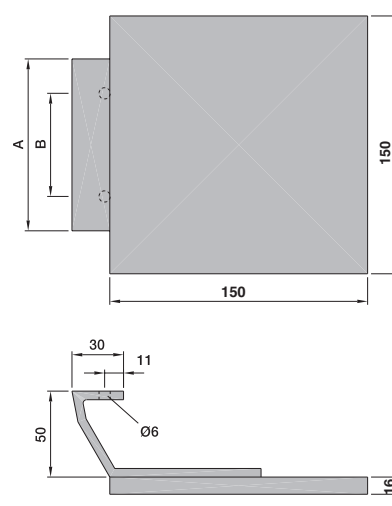
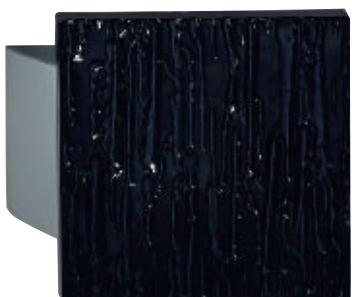

8219.. plastic plate, black, relief,
150x150x16 mm,
A = 90 mm,
B = 50 mm

On aluminium profile support

Standard finish (profile support)

- a) Aluminium, E4 treated
 - .22 KWS 1 silver anodised
 - .23 KWS 2 nickel-silver anodised
 - .24 KWS 3 brass-coloured anodised
 - .27 KWS 4 light brown anodised
 - .28 KWS 5 dark brown anodised
 - .29 KWS 6 black anodised
- b) Aluminium, E6 treated
 - .41 KWS 1 silver anodised
 - .42 KWS 2 nickel-silver anodised
 - .43 KWS 3 brass-coloured anodised
 - .46 KWS 4 light brown coloured
 - .47 KWS 5 dark brown coloured
 - .48 KWS 6 black coloured
- c) Aluminium
 - .70 plastic coated

Order example

Piece	Item No.	Finish
...piece	8216	22

Item no.	Standard finish	Dimension in mm		
		L	D	B
8312	a), b), c)	800	100	60
8313	a), b), c)	900	100	60
8314	a), b), c)	1000	100	60
8315	a), b), c)	1100	100	60
8316	a), b), c)	1200	100	60
8322	a), b), c)	800	120	80
8323	a), b), c)	900	120	80
8324	a), b), c)	1000	120	80
8325	a), b), c)	1100	120	80
8326	a), b), c)	1200	120	80
8332	a), b), c)	800	150	110
8333	a), b), c)	900	150	110
8334	a), b), c)	1000	150	110
8335	a), b), c)	1100	150	110
8336	a), b), c)	1200	150	110
8352	a), b), c)	800	200	160
8353	a), b), c)	900	200	160
8354	a), b), c)	1000	200	160
8355	a), b), c)	1100	200	160
8356	a), b), c)	1200	200	160

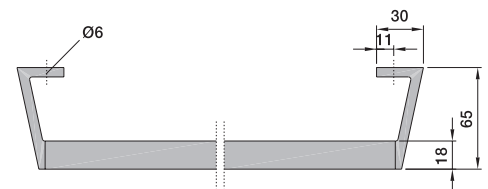
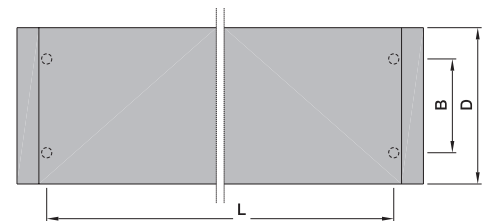

Made of aluminium rectangular tube, with inserted end supports

Intermediate lengths can be manufactured (dimension L). Overlengths are available on request.

Standard finish

- a) Aluminium, E4 treated
 - .22 KWS 1 silver anodised
 - .23 KWS 2 nickel-silver anodised
 - .24 KWS 3 brass-coloured anodised
 - .27 KWS 4 light brown anodised
 - .28 KWS 5 dark brown anodised
 - .29 KWS 6 black anodised

- b) Aluminium, E6 treated
 - .41 KWS 1 silver anodised
 - .42 KWS 2 nickel-silver anodised
 - .43 KWS 3 brass-coloured anodised
 - .46 KWS 4 light brown anodised
 - .47 KWS 5 dark brown anodised
 - .48 KWS 6 black anodised
- c) Aluminium
 - .70 plastic coated

Note

The price basis is the dimension L, intermediate lengths are rounded up to full 100 mm. Flat end supports are available for one side or both sides.

Order example

Piece	Item No.	Finish	Dimension L
...piece	8312	22	775 mm

Pull handles - rectangular tube

8837.. 100 x 18 x 2 mm

8847.. 120 x 18 x 2 mm

8857.. 150 x 18 x 2 mm

8877.. 200 x 18 x 2 mm

Rectangular tube made of aluminium.

Length approx. 5000 mm

Standard finish

- a) Aluminium, E4 treated
.20 surface untreated
- b) Aluminium, E6 treated
.41 KWS 1 silver anodised
.47 KWS 5 dark brown coloured

8835.. end support for rectangular tube
100 x 18 mm

8846.. end support for rectangular tube
120 x 18 mm

8855.. end support for rectangular tube
150 x 18 mm

8875.. end support for rectangular tube
200 x 18 mm

65 mm high, made of aluminium

Standard finish

- a) Aluminium, E4 treated
.20 surface untreated
- b) Aluminium, E6 treated
.41 KWS 1 silver anodised
.47 KWS 5 dark brown coloured

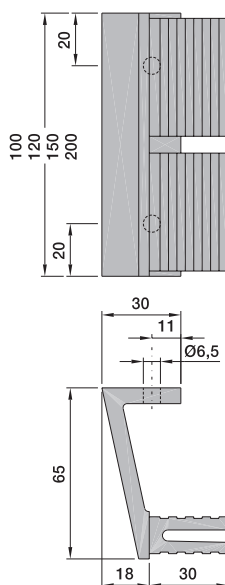

Order example

Piece	Item No.	Finish
...piece	8835	20

Pull handles - rectangular tube

- 8836.. end support for rectangular tube
100 x 18 mm
- 8846.. end support for rectangular tube
120 x 18 mm
- 8856.. end support for rectangular tube
150 x 18 mm
- 8876.. end support for rectangular tube
200 x 18 mm

25 mm high, made of aluminium

- Standard finish**
- a) Aluminium, E4 treated
.20 surface untreated
 - b) Aluminium, E6 treated
.41 KWS 1 silver anodised
.47 KWS 5 dark brown anodised

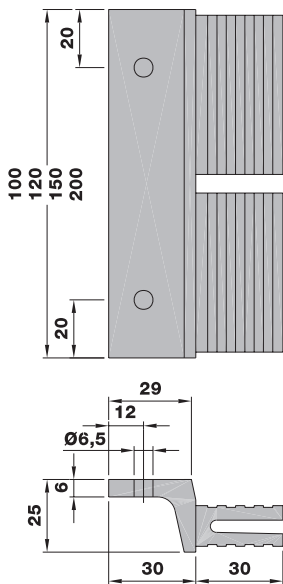

- 8881.. plastic plate, plain
- 8885.. plastic plate, fine embossed
- 8886.. plastic plate, relief

150 x 150 mm, black

- Standard finish**
- a) Plastic
.95 PVC



Order example

Piece	Item No.	Finish
...piece	8836	20

Profile supports

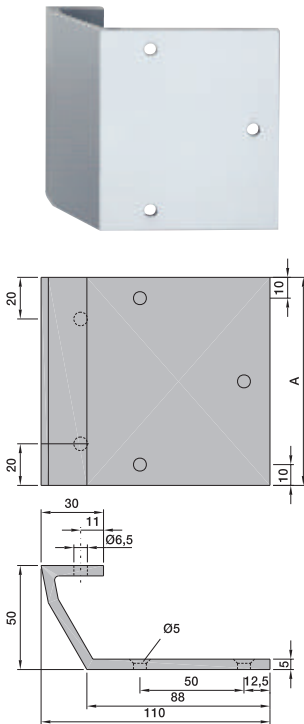

8603..	dim. A = 80 mm
8604..	dim. A = 90 mm
8605..	dim. A = 100 mm
8606..	dim. A = 110 mm
8607..	dim. A = 120 mm
8608..	dim. A = 130 mm
8609..	dim. A = 140 mm
8610..	dim. A = 150 mm
8611..	dim. A = 160 mm
8612..	dim. A = 170 mm
8613..	dim. A = 175 mm
8614..	dim. A = 190 mm
8615..	dim. A = 200 mm

Made of aluminium

Standard finish

- a) Aluminium, E4 treated
 - .22 KWS 1 silver anodised
 - .23 KWS 2 nickel-silver anodised
 - .24 KWS 3 brass-coloured anodised
 - .26 special colour anodised
 - .27 KWS 4 light brown anodised
 - .28 KWS 5 dark brown anodised
 - .29 KWS 6 black anodised
- b) Aluminium, E6 treated
 - .41 KWS 1 silver anodised
 - .42 KWS 2 nickel-silver anodised
 - .43 KWS 3 brass-coloured anodised
 - .46 KWS 4 light brown anodised
 - .47 KWS 5 dark brown anodised
 - .48 KWS 6 black anodised
- c) Aluminium
 - .70 plastic coated

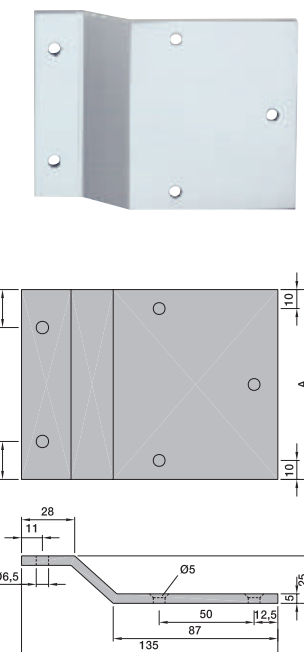

8633..	dim. A = 80 mm
8634..	dim. A = 90 mm
8635..	dim. A = 100 mm
8636..	dim. A = 110 mm
8637..	dim. A = 120 mm
8640..	dim. A = 150 mm

Made of aluminium

Standard finish

- a) Aluminium, E4 treated
 - .22 KWS 1 silver anodised
 - .23 KWS 2 nickel-silver anodised
 - .24 KWS 3 brass-coloured anodised
 - .27 KWS 4 light brown anodised
 - .28 KWS 5 dark brown anodised
 - .29 KWS 6 black anodised
- b) Aluminium, E6 treated
 - .41 KWS 1 silver anodised
 - .42 KWS 2 nickel-silver anodised
 - .43 KWS 3 brass-coloured anodised
 - .46 KWS 4 light brown anodised
 - .47 KWS 5 dark brown anodised
 - .48 KWS 6 black anodised
- c) Aluminium
 - .70 plastic coated

Order example

Piece	Item No.	Finish
...piece	8603	22

8663..	dim. A = 80 mm
8664..	dim. A = 90 mm
8665..	dim. A = 100 mm
8666..	dim. A = 110 mm
8667..	dim. A = 120 mm
8670..	dim. A = 150 mm

Made of aluminium

Standard finish

- a) Aluminium, E4 treated
 - .22 KWS 1 silver anodised
 - .23 KWS 2 nickel-silver anodised
 - .24 KWS 3 brass-coloured anodised
 - .27 KWS 4 light brown anodised
 - .28 KWS 5 dark brown anodised
 - .29 KWS 6 black anodised
- b) Aluminium, E6 treated
 - .41 KWS 1 silver anodised
 - .42 KWS 2 nickel-silver anodised
 - .43 KWS 3 brass-coloured anodised
 - .46 KWS 4 light brown anodised
 - .47 KWS 5 dark brown anodised
 - .48 KWS 6 black anodised
- c) Aluminium
 - .70 plastic coated

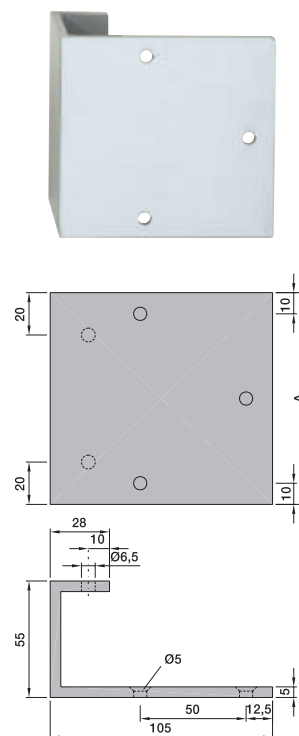

8683..	dim. A = 80 mm
8684..	dim. A = 90 mm
8685..	dim. A = 100 mm
8686..	dim. A = 110 mm
8687..	dim. A = 120 mm
8690..	dim. A = 150 mm

Made of aluminium

Standard finish

- a) Aluminium, E4 treated
 - .22 KWS 1 silver anodised
 - .23 KWS 2 nickel-silver anodised
 - .24 KWS 3 brass-coloured anodised
 - .27 KWS 4 light brown anodised
 - .28 KWS 5 dark brown anodised
 - .29 KWS 6 black anodised
- b) Aluminium, E6 treated
 - .41 KWS 1 silver anodised
 - .42 KWS 2 nickel-silver anodised
 - .43 KWS 3 brass-coloured anodised
 - .46 KWS 4 light brown anodised
 - .47 KWS 5 dark brown anodised
 - .48 KWS 6 black anodised
- c) Aluminium
 - .70 plastic coated

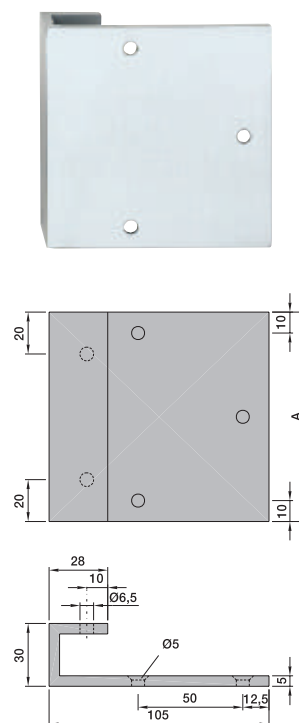

Order example

Piece	Item No.	Finish
...piece	8663	22

Modular system for pull handles

Modular system for pull handles

The idea

The KWS Modular System is designed for pull handles, handrails and other applications and is available in diameters of 30,35 and 40 mm. The tubes are supplied in lengths of 2 or 3 m. A comprehensive range of supports, fixings, mitre joints and endcaps means you can create custom-made solutions, even if your customer requirements are out of the ordinary. The supports

are available for face fixing (WS) or concealed (RS) fixing. The supports are attached to the tubes using our tried and tested clamping system. The supports cover the ends of the tubes, and provide a margin of error in cutting of up to 5 mm by concealing the cut edges.

... and what you can make out of it:

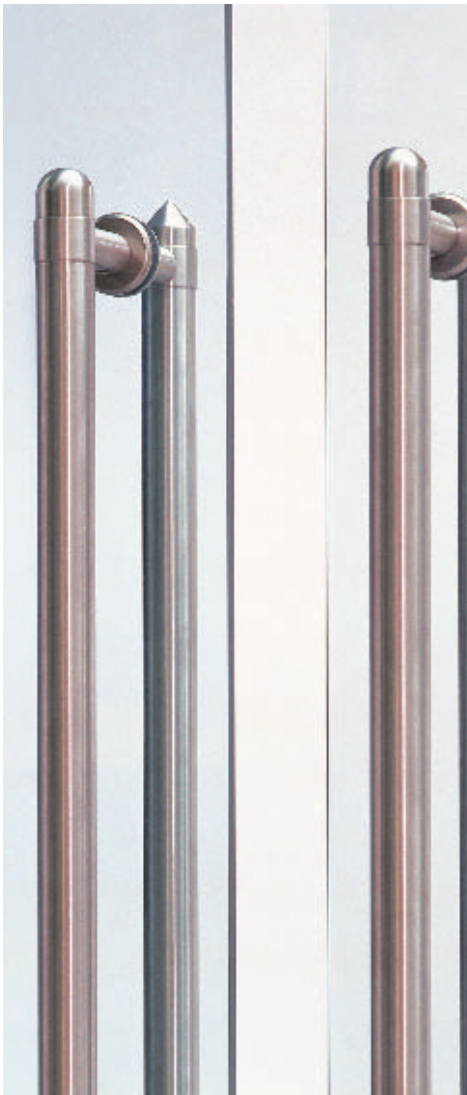

Modular system for pull handles

The Self-Assembly

The tubes are simply slotted into the supports and are fixed in position by tightening the clamping screw (in the head of the support).

The length (x) of the tube is not the same as the distance between the centres of the fixing holes (Length L). Tubes have to be cut as shown below:

To ensure stability in self-assembled components, the following maximum dimensions must not be exceeded

Maximum length L without mid-point support:

Ø 30 mm 1600 mm

Ø 35 mm 2000 mm

Ø 40 mm 2200 mm



Without mid-point support:

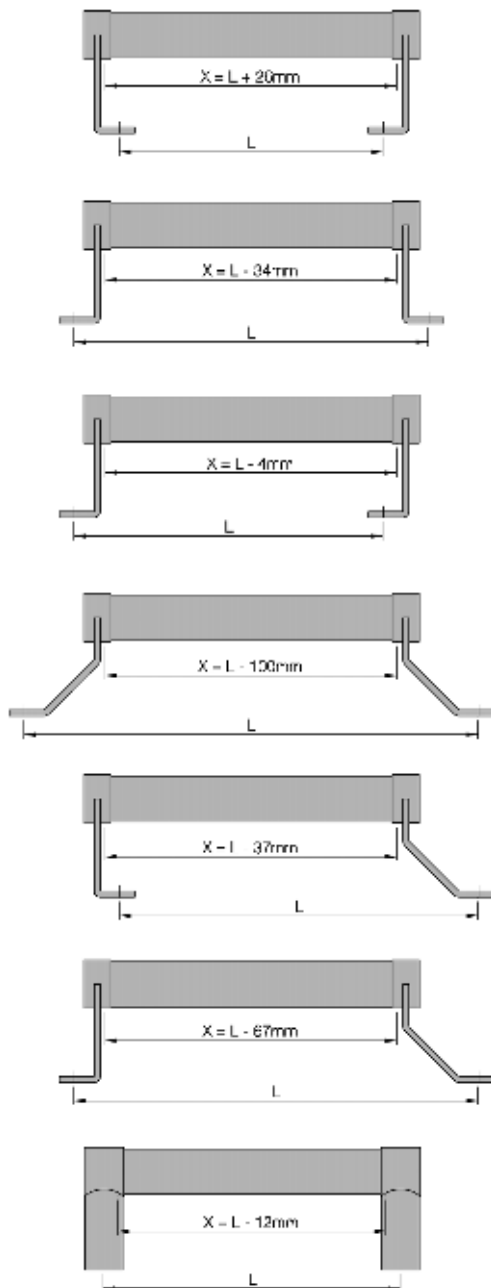

With mid-point support:

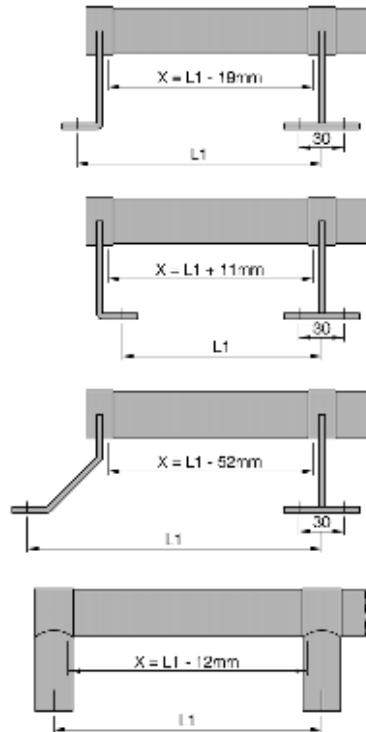

Overview | Modular system for pull handles



Page 316



Page 316



Page 317



Page 317



Page 317



Page 318



Page 318



Page 319



Page 319



Page 320



Page 320



Page 320



Page 321



Page 321



Page 321



Page 322



Page 322



Page 322



Page 323



Page 323



Page 323



Page 323

Modular system for pull handles – series WS

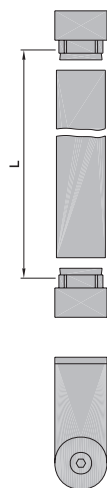

8011.. of Ø 30 x 1,5 mm stainless steel tube, dim. L = 300-1600 mm

8381.. of Ø 35 x 1,5 mm stainless steel tube, dim. L = 300-2000 mm

8161.. of Ø 40 x 2,0 mm stainless steel tube, dim. L = 300-2200 mm

With 2 straight end supports.

Suitable for single sided and back-to-back (pair) installation (fixings on pages 324-334).

Intermediate lengths can be manufactured (dimension L). Overlengths are available on request.

Standard finish

a) Stainless steel



.82 dull brushed

Note

These pull handles are also available with a mid-point support.

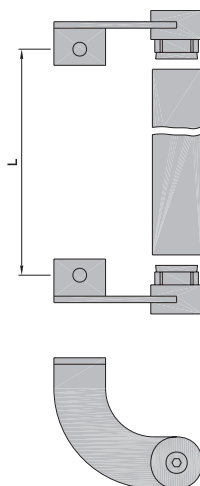

8012.. of Ø 30 x 1,5 mm stainless steel tube, dim. L = 300-1600 mm

8382.. of Ø 35 x 1,5 mm stainless steel tube, dim. L = 300-2000 mm

8162.. of Ø 40 x 2,0 mm stainless steel tube, dim. L = 300-2200 mm

With 2 offset end supports.

Suitable for single sided and back-to-back (pair) installation (fixings on pages 324-334).

Intermediate lengths can be manufactured (dimension L). Overlengths are available on request.

Standard finish

a) Stainless steel



.82 dull brushed

Note

These pull handles are also available with a mid-point support.

Order example

Piece ...piece	Item No.	Finish	Dimension L
	8012	82	1000 mm

Modular system for pull handles – series WS

- 8711.. for Ø 30 x 1,5 mm tube
 8391.. for Ø 35 x 1,5 mm tube
 8H91.. for Ø 35 mm wood
 8301.. for Ø 40 x 2,0 mm tube
 8H01.. for Ø 40 mm wood

Straight end support for face fixing
 Completely made of stainless steel

Standard finish

- a) Stainless steel



.82 dull brushed

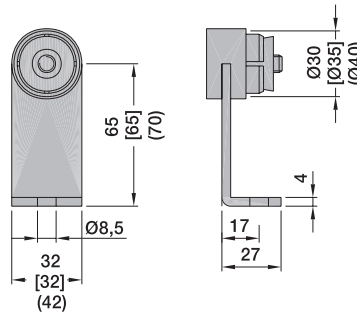

- 8712.. for Ø 30 x 1,5 mm tube
 8392.. for Ø 30 x 1,5 mm tube
 8H92.. for Ø 35 mm wood
 8302.. for Ø 35 x 1,5 mm tube
 8H02.. for Ø 40 mm wood

Off set end support for face fixing
 Completely made of stainless steel

Standard finish

- a) Stainless steel



.82 dull brushed

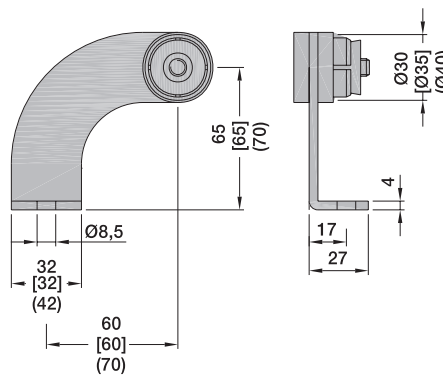

- 8716.. for Ø 30 x 1,5 mm tube
 8396.. for Ø 35 x 1,5 mm tube
 8H96.. for Ø 35 mm wood
 8306.. for Ø 40 x 2,0 mm tube
 8H06.. for Ø 40 mm wood

Cranked end support for framed doors, for face fixing
 Completely made of stainless steel

Standard finish

- a) Stainless steel



.82 dull brushed

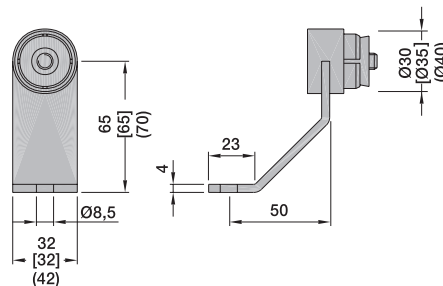

8

Order example

Piece	Item No.	Finish
...piece	8711	82

Modular system for pull handles – series WS

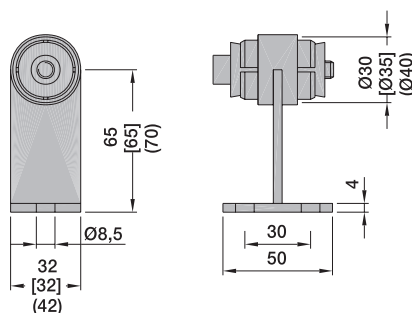

- 8713.. for Ø 30 x 1,5 mm tube
- 8393.. for Ø 35 x 1,5 mm tube
- 8H93.. for Ø 35 mm wood
- 8303.. for Ø 40 x 2,0 mm tube
- 8H03.. for Ø 40 mm wood

Straight mid-point support for face fixing
Completely made of stainless steel

Standard finish

a) Stainless steel



.82 dull brushed

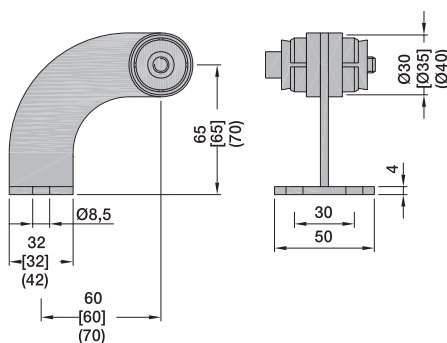

- 8714.. for Ø 30 x 1,5 mm tube
- 8394.. for Ø 35 x 1,5 mm tube
- 8H94.. for Ø 35 mm wood
- 8304.. for Ø 40 x 2,0 mm tube
- 8H04.. for Ø 40 mm wood

Off set mid-point support for face fixing
Completely made of stainless steel

Standard finish

a) Stainless steel



.82 dull brushed

Order example

Piece	Item No.	Finish
...piece	8713	82

Modular system for pull handles – series RS

8021.. of Ø 30 x 1.5 mm stainless steel – tube

8023.. of Ø 35 x 1.5 mm stainless steel – tube

8025.. of Ø 40 x 2.0 mm stainless steel – tube

With 2 straight end supports series RS

Suitable for single sided and back-to-back (pair) installation (fixings on pages 324-334).

Intermediate lengths can be manufactured (dimension L). Overlengths on request.

Standard finish

a) Stainless steel



.82 dull brushed

Note on overlengths

These pull handles are also available with mid-point support or a reinforcing profile (for Ø 35 mm).

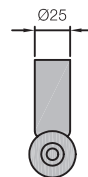
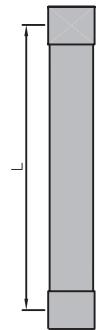

8022.. of Ø 30 x 1.5 mm stainless steel – tube

8024.. of Ø 35 x 1.5 mm stainless steel – tube

8026.. of Ø 40 x 2.0 mm stainless steel – tube

With two slanting end supports series RS

Suitable for single sided and back-to-back (pair) installation (fixings on pages 324-334).

Intermediate lengths can be manufactured (dimension L). Overlengths on request.

Standard finish

a) Stainless steel



.82 dull brushed

Note on overlengths

These pull handles are also available with mid-point support or reinforcing profile (for Ø 35 mm).

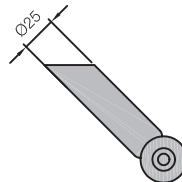
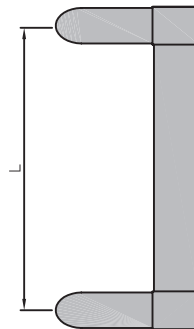

Order example

Piece ...piece	Item No. 8021	Finish 82
-------------------	------------------	--------------

Modular system for pull handles – series RS

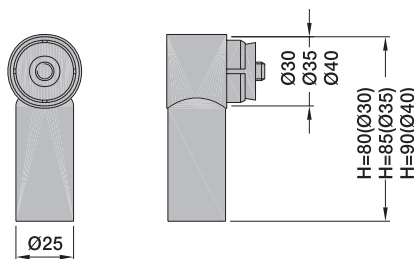

8715.. for Ø 30 x 1.5 mm tube

8361.. for Ø 35 x 1.5 mm tube

8H61.. for Ø 35 mm wood

8317.. for Ø 40 x 2.0 mm tube

8H17.. for Ø 40 mm wood

Straight end support for concealed fixing
Completely made of stainless steel

Standard finish

a) Stainless steel



.82 dull brushed

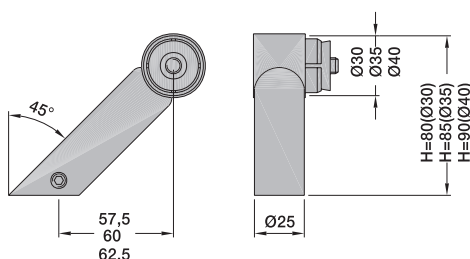

8717.. for Ø 30 x 1.5 mm tube

8362.. for Ø 35 x 1.5 mm tube

8H62.. for Ø 35 mm wood

8318.. for Ø 40 x 2.0 mm tube

8H18.. for Ø 40 mm wood

45° slanting end support for concealed fixing
Completely made of stainless steel

Standard finish

a) Stainless steel



.82 dull brushed

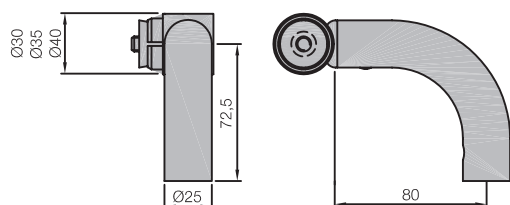

8305.. for Ø 30 x 1.5 mm tube

8309.. for Ø 35 x 1.5 mm tube

8H09.. for Ø 35 mm wood

8310.. for Ø 40 x 2.0 mm tube

8H10.. for Ø 40 mm wood

Off set 90° support for concealed fixing
Completely made of stainless steel

Standard finish

a) Stainless steel



.82 dull brushed

Order example

Piece	Item No.	Finish
...piece	8715	82

Modular system for pull handles – series RS

- 8718.. for Ø 30 x 1.5 mm tube
 8363.. for Ø 35 x 1.5 mm tube
 8H63.. for Ø 35 mm wood
 8319.. for Ø 40 x 2.0 mm tube
 8H19.. for Ø 40 mm wood

Straight mid-point support for concealed fixing
 Completely made of stainless steel

Standard finish

- a) Stainless steel



.82 dull brushed

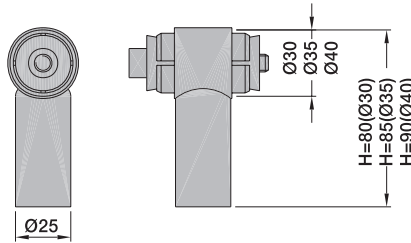

- 8719.. for Ø 30 x 1.5 mm tube
 8364.. for Ø 35 x 1.5 mm tube
 8H64.. for Ø 35 mm wood
 8320.. for Ø 40 x 2.0 mm tube
 8H20.. for Ø 40 mm wood

45° slanting mid-point support for concealed fixing
 Completely made of stainless steel

Standard finish

- a) Stainless steel



.82 dull brushed

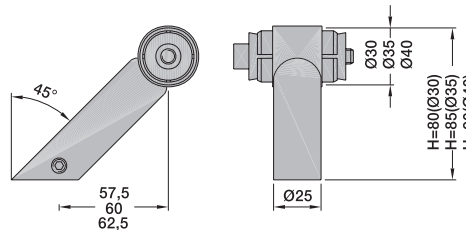

- 8340.. for Ø 30 x 1.5 mm tube
 8341.. for Ø 35 x 1.5 mm tube
 8H41.. for Ø 35 mm wood
 8342.. for Ø 40 x 2.0 mm tube
 8H42.. for Ø 40 mm wood

Off set 90° mid-point support for concealed fixing
 Completely made of stainless steel

Standard finish

- a) Stainless steel



.82 dull brushed

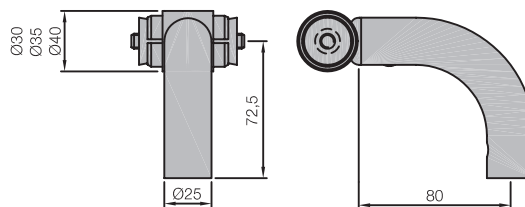

Order example

Piece ...piece	Item No. 8718	Finish 82
-------------------	------------------	--------------

Modular system for pull handles – series RS and series WS

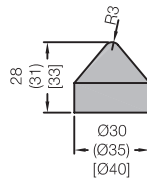

8800.. for Ø 30 mm

8801.. for Ø 35 mm

8802.. for Ø 40 mm

Decorative end cap, cone shape

For fixing with screws on end support series RS and WS,
included assembly kit
(setscrew and counter nut)

Standard finish

a) Stainless steel



.82 dull brushed

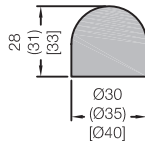

8803.. for Ø 30 mm

8804.. for Ø 35 mm

8805.. for Ø 40 mm

Decorative end cap, round shape

For fixing with screws on end support series RS and WS,
included assembly kit
(setscrew and counter nut)

Standard finish

a) Stainless steel



.82 dull brushed

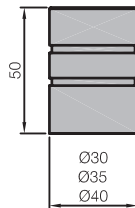

8890.. for Ø 30 mm

8891.. for Ø 35 mm

8892.. for Ø 40 mm

Decorative end cap, cylinder with 2 grooves

For fixing with screws on end support series RS and WS,
included assembly kit
(setscrew and counter nut)

Standard finish

a) Stainless steel



.82 dull brushed

Order example

Piece	Item No.	Finish
...piece	8800	82

Modular system for pull handles – series RS and series WS

8893.. for Ø 30 mm, 90 mm long

8894.. for Ø 35 mm, 90 mm long

8895.. for Ø 40 mm, 90 mm long

Decorative end, tube 90 mm closed on one end,
for mounting with mid-point supports series RS and WS

Standard finish

a) Stainless steel



.82 dull brushed

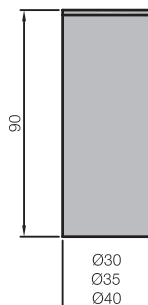

81G2.. Holder for Ø 25x1.5 mm tube,
rest for Ø 30x1.5 mm tube

mitre joint for T and cross joints
(incl. riveting nut)

81G3.. Ø 25x1.5 / Ø 35x1.5

82G2.. Ø 30x1.5 / Ø 30x1.5

82G3.. Ø 30x1.5 / Ø 35x1.5

82G4.. Ø 30x1.5 / Ø 40x2.0

83G3.. Ø 35x1.5 / Ø 35x1.5

83G4.. Ø 35x1.5 / Ø 40x2.0

84G4.. Ø 40x2.0 / Ø 40x2.0

Standard finish

a) Stainless steel



.82 dull brushed



8808.. of Ø 30 mm stainless steel,
wall 1.5 mm

8399.. of Ø 35 mm stainless steel,
wall 1.5 mm

8329.. of Ø 35 mm beech wood

8308.. of Ø 40 mm stainless steel,
wall 2.0 mm

8330.. of Ø 40 mm beech wood

Standard finish

a) Stainless steel (length: 2 m, 3 m or cut to size)



.82 dull brushed

b) Beech wood (8329../8330)
(length: 2 m or cut to size)

.98 open-pored treated



8

Order example

Piece ...piece	Item No. 8893	Finish 82
-------------------	------------------	--------------

Pull handle fixing kits

Pull handle fixing kits

for back-to-back and single fixing of pull handle

| Back to back fixing

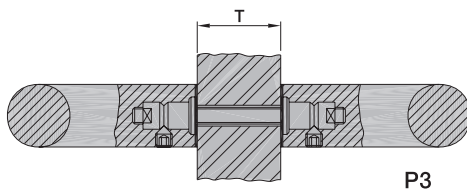

| Single handle fixing

going through fixing with cap:

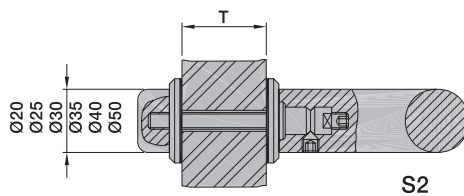

single sided with self-tapping sleeve:

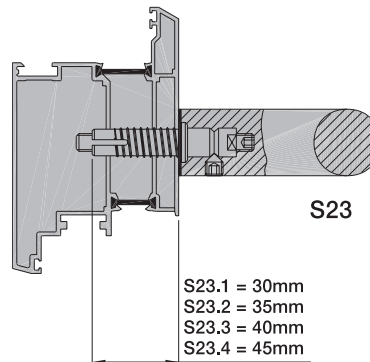

Pull handle fixing kits

KWS offers a wide range of fixing kits catering for every requirement. Fixing kits include a complete set for a pull handle with two fixing points.

Fixing kits are classified according to different types of pull handles:

- LT (with grub screw)
- GT (drilled and tapped)
- Angle-Support (face fixing)

Following system will help you to choose the right one:

| Single handle fixing:

Fixing	S 1	S 2	S 3	S 7	S 8	S 10	S 11	S 12	S 13	S 14	S 15	S 16	S 17	S 20	S 21	S 23	
Grub screw fixing (LT)	•	•	•		•		•	•	•		•		•			•	
drilled an tapped fixing (GT)				•		•											
face fixing for angular support (WS)										•		•		•	•		

| Back to back fixing

Fixing	P 1	P 2	P 3	P 4	P 10
LT/GT-pair	•	•			
LT/LT-pair			•	•	
face fixing-pair					•

| Diameter

Door handle-Ø	Fixing	Example
20 mm	M 6	8A01
25, 30, 35, 40, 50 mm	M 8	8B01

| Material

Door handle	Fixing	Example
Stainless steel	Stainless steel	.80
Brass	Stainless steel	.80
Aluminium	Steel electro-galvalised	.06

Note:

The finish of the fixing kit is adapted to the pull handle material in case of visible fixing elements (caps and roses).

Overview | Pull handle fixing kits: back to back fixing

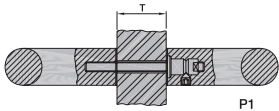

P1

Page 328

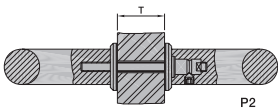

P2

Page 328

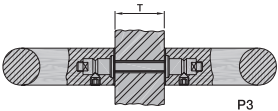

P3

Page 328

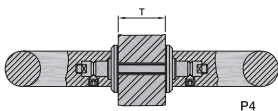

P4

Page 329

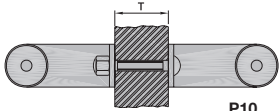

P10

Page 329

Overview | Pull handle fixing kits: single fixing

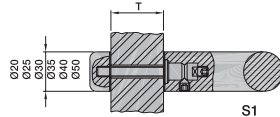

S1

Page 329

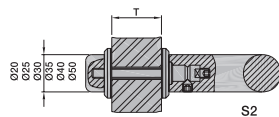

S2

Page 329

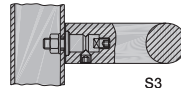

S3

Page 330

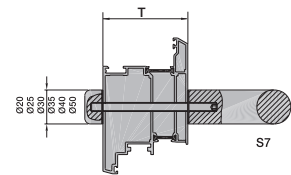

S7

Page 330

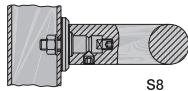

S8

Page 330

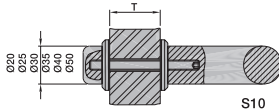

S10

Page 331

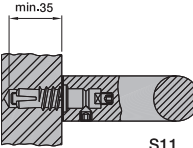

S11

Page 331

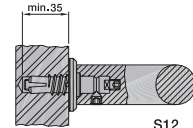

S12

Page 331

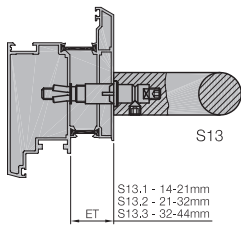

S13

Page 332

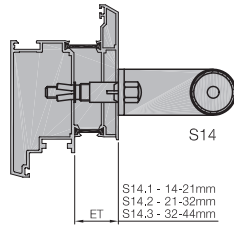

S14

Page 332

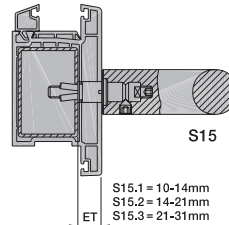

S15

Page 332

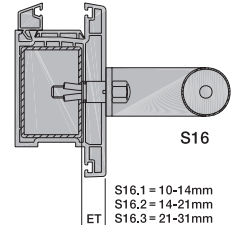

S16

Page 333

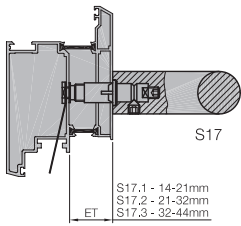

S17

Page 333

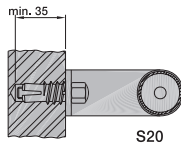

S20

Page 333

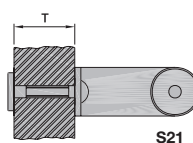

S21

Page 334

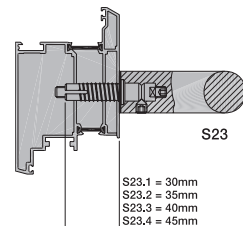

S23

Page 334

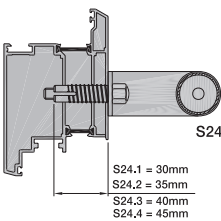

S24

Page 334

Pull handle fixing kits

8A01..

P 1 - M 6
for Ø 20 mm handle

8B01..

P 1 - M 8
for Ø 25, 30, 35, 40, 50 mm
handle/support

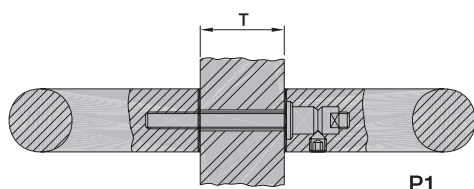

Back to back fixing kit

For grub screw fixing (LT) and
drilled and tapped fixing (GT).

Standard finish for pull handle of:

- a) Aluminium
.06 Steel electrogalvased
- b) Brass
.80 Stainless steel untreated
- c) Stainless steel
.80 Stainless steel untreated

Mounting

Pass the set screw from the inside through the door leaf into the door handle (GT), connect block and nut and fasten them using a spanner (SW 11). Fit the inside handle (LT) over the block and fasten the grub screw on the side using an Allen Key.

8A02..

P 2 - M 6
for Ø 20 mm handle

8B02..

P 2 - M 8
for Ø 25, 30, 35, 40, 50 mm
handle/support

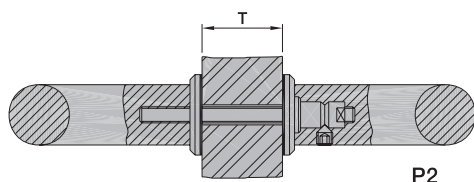

Back to back fixing kit with roses
especially for solid timber or glass doors.

For grub screw fixing (LT) and
drilled and tapped fixing (GT).

Standard finish for pull handle of:

- a) Aluminium
Inner parts steel electrogalvased and roses:
.22, .23, .24, .27, .28, .29, .70
- b) Brass
Inner parts stainless steel and roses:
.61, .65
- c) Stainless steel
Inner parts stainless steel and roses:
.82, .83

Mounting

Pass the set screw from the inside through the door leaf into the door handle (GT) using the roses, connect block and nut and fasten them using a spanner (SW 11). Fit the inside handle (LT) over the block and fasten the grub screw on the side using an Allen Key.

8A03..

P 3 - M 6
for Ø 20 mm handle

8B03..

P 3 - M 8
for Ø 25, 30, 35, 40, 50 mm
handle/support

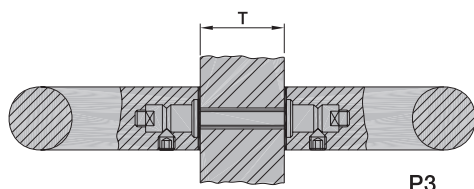

Back to back fixing kit

For 2 grub screw fixings (LT)

Standard finish for pull handle of:

- a) Aluminium
.06 Steel electrogalvased
- b) Brass
.80 Stainless steel untreated
- c) Stainless steel
.80 Stainless steel untreated

Mounting

Pass the set screw through the door leaf. Fasten a block and a nut on each side using 2 spanners (SW 11). Fit the handles (LT) over the blocks and fasten the grub screws on the side using an Allen Key (SW 4).

Order example (see page 325)

Set	Item No.	Finish	Fixing type	Door thickness (T)
...sets	8A01	80	P 1	40 mm

Pull handle fixing kits

8A04.. P 4 - M 6
for Ø 20 mm handle

8B04.. P 4 - M 8
for Ø 25, 30, 35, 40, 50 mm
handle/support

Back to back fixing kit with roses, especially for solid timber or glass doors and efficient stockkeeping.
For 2 grub screw fixings (LT).

Standard finish for pull handle of:

- a) Aluminium
Inner parts steel electrogalvased and roses:
.22, .23, .24, .27, .28, .29, .70

- b) Brass
Inner parts stainless steel and roses:
.61, .65
c) Stainless steel
Inner parts stainless steel and roses:
.82, .83

Mounting

Pass the set screw through the door leaf using the roses and a block and a nut on each side and fasten them using 2 spanners (SW 11). Fit the handles (LT) over the blocks and fix the grub screws on the side using an Allen Key (SW 4).

bore in glass pane: 15 - 18 mm

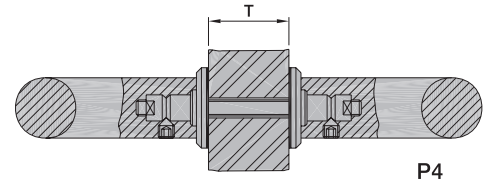

P4

8A10.. P 10 - M 6

Back to back fixing kit

especially for door handles of the modular system
(face fixing)

Standard finish

- a) Stainless steel
.82 dull brushed

Mounting

Pass the set screw through the door leaf.
Then put on the handle. Fasten the grip using an Allen Key (SW 13).

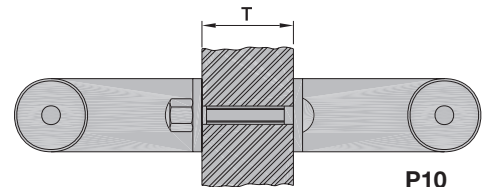

P10

8A51.. S 1 - M 6
for Ø 20 mm handle

8B51.. S 1 - M 8
for Ø 25, 30, 35, 40, 50 mm
handle/support

Single handle fixing kit with cap.
For grub screw fixing (LT).

Standard finish for pull handle of:

- a) Aluminium
Inner parts steel electrogalvased and roses:
.22, .23, .24, .27, .28, .29, .70

- b) Brass
Inner parts stainless steel and caps:
.61, .65
c) Stainless steel
Inner parts stainless steel and roses:
.82, .83

Mounting

Turn the set screw into the cap and pass it from the inside through the door leaf. Connect block and nut and fasten them using a spanner (SW 11). Fit the handle (LT) over the block and fasten the grub screw using an Allen Key (SW 4).

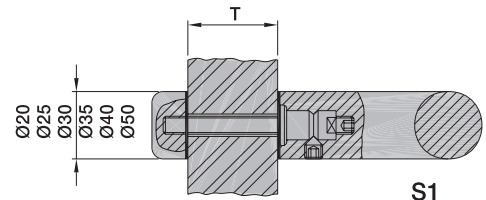

S1

8A52.. S 2 - M 6
for Ø 20 mm handle

8B52.. S 2 - M 8
for Ø 25, 30, 35, 40, 50 mm
handle/support

Single handle fixing kit with cap and roses,
especially for solid timber or glass doors.
For grub screw fixing (LT).

Standard finish for pull handle of:

- a) Aluminium
Inner parts steel electrogalvased
and caps and roses:
.22, .23, .24, .27, .28, .29, .70

- b) Brass
Inner parts stainless steel and roses:
.61, .65
c) Stainless steel
Inner parts stainless steel
and caps and roses:
.82, .83

Mounting

See S1, and use roses.

bore in glass pane: 15 - 18 mm

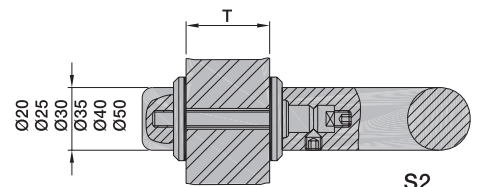

S2

Order example

(see page 325)

Set ...sets	Item No. 8A04	Finish 82	Fixing type P 4	Door thickness (T) 10 mm

Pull handle fixing kits

8A53.. S 3 - M 6
for Ø 20 mm handle

8B53.. S 3 - M 8
for Ø 25, 30, 35, 40 50 mm
handle/support

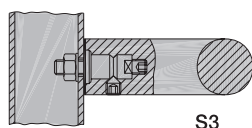

Single handle fixing kit for doors of steel or aluminium profile (if there is a possibility to insert a hexagon cap nut into the door profile from the side).

For grub screw fixing (LT).

Standard finish for pull handle of:

- a) Aluminium
.06 Steel electrogalvased
- b) Brass
.80 Stainless steel untreated
- c) Stainless steel
.80 Stainless steel untreated

Mounting

Insert the set screw with block and nut into the profile, screw on a U-disc and a hexagon nut from the side (neither is supplied with this item) and fasten them using spanners (SW 11 and SW 13). Fit the handle (LT) over the block and fasten the grub screw using an Allen Key (SW 4).

8A57.. S 7 - M 6
for Ø 20 mm pull handle

8B57.. S 7 - M 8
for Ø 25, 30, 35, 40, 50 mm
handle/support

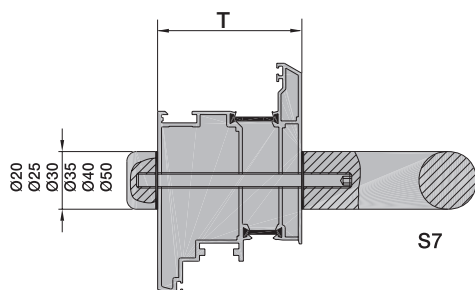

Single handle fixing kit with cap.

For drilled and tapped fixing (GT).

Standard finish for door pull of:

- a) Aluminium
Inner parts steel electrogalvased and cap:
.22, .23, .24, .27, .28, .29, .70
- b) Brass
Inner parts stainless steel and cap:
.61, .65
- c) Stainless steel
Inner parts stainless steel and cap:
.82, .83

Mounting

Turn the set screw into the cap and pass it from the inside through the door leaf and fasten it into the handle (GT) using a plastic-coated pair of gripping pliers

8A58.. S 8 - M 6
for Ø 20 mm handle

8B58.. S 8 - M 8
for Ø 25, 30, 35, 40, 50 mm
handle/support

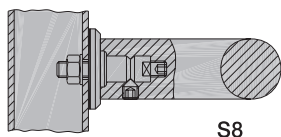

Single handle fixing kit with rose (if there is a possibility to insert a hexagon cap nut into the door profile from the side).

For grub screw fixing (LT).

Standard finish for pull handle of:

- a) Aluminium
Inner parts steel electrogalvased and rose:
.22, .23, .24, .27, .28, .29, .70
- b) Brass
Inner parts stainless steel and rose:
.61, .65
- c) Stainless steel
Inner parts stainless steel and rose:
.82, .83

Mounting

Insert the set screw with block, nut and rose into the profile, screw on a U-disc and a hexagon nut from the side (neither is supplied with this item) and fasten them using spanners (SW 11 and SW 13). Fit the handle (LT) over the block and fasten the grub screw using an Allen Key (SW 4).

Order example (see page 325)

Set ...sets	Item No.	Finish	Fixing type	Door thickness (T)
	8A57	82	S 7	40 mm

Pull handle fixing kits

8A60.. S 10 - M 6
for Ø 20 mm handle

8B60.. S 10 - M 8
for Ø 25, 30, 35, 40, 50 mm
handle/support

Single handle fixing kit with cap and roses,
especially for solid timber or glass doors,
for drilled and tapped fixing (GT).

bore in glass pane: 15 - 18 mm

Standard finish for pull handle of:

- a) Aluminium
Inner parts steel electrogalvaised and
cap and roses:
.22, .23, .24, .27, .28, .29, .70
- b) Brass
Inner parts stainless steel and cap and roses:
.61, .65
- c) Stainless steel
Inner parts stainless steel and cap and roses:
.82, .83

Mounting

Turn the set screw into the cap and pass it from the
inside through the door leaf using the roses and fasten
them into the handle (GT) using a plastic-coated pair of
gripping pliers.

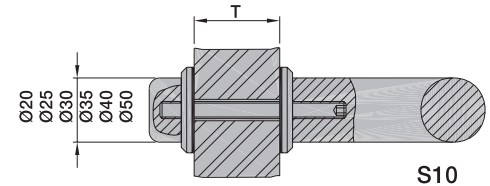

8A61.. S 11 - M 6
for Ø 20 mm handle

8B61.. S 11 - M 8
for Ø 25, 30, 35, 40, 50 mm
handle/support

Single handle fixing kit for solid timber doors.

For grub screw fixing (LT).

Standard finish for pull handle of:

- a) Aluminium
.06 Steel electrogalvaised
- b) Brass
.80 Stainless steel untreated
- c) Stainless steel
.80 Stainless steel untreated

Mounting

Bore holes in the door (Ø 12 mm, 35 mm depth) and
screw the brass dowel into the hole using a screwdriver
of 12 mm width - up to 0.5 mm deeper than the leaf
level. Insert the set screw using an Allen Key (SW 4)
until it protrudes only 35 mm. Connect block and nut and
fasten them using a spanner (SW 11). Fit the handle (LT)
over the block and fasten the grub screw using an Allen
Key (SW 4).

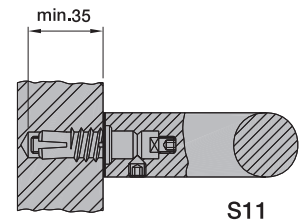

8A62.. S 12 - M 6
for Ø 20 mm handle

8B62.. S 12 - M 8
for Ø 25, 30, 35, 40, 50 mm
handle/support

Single handle fixing kit with roses for solid
timber doors.

For grub screw fixing (LT).

- c) Stainless steel
Inner parts stainless steel and roses:
.82, .83

Mounting

Bore holes in the door (Ø 12 mm, 35 mm depth) and
screw the brass dowel into the hole using a screwdriver
of 12 mm width - up to 0.5 mm deeper than the leaf
level. Insert the set screw using an Allen Key (SW 4)
until it protrudes only 35 mm. Connect block, nut and
roses and fasten them using a spanner (SW 11). Fit the
handle (LT) over the block and fasten the grub screw
using an Allen Key (SW 4).

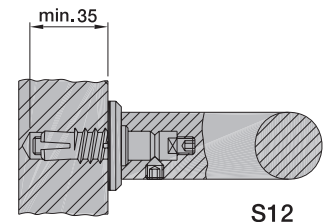

Standard finish for pull handle of:

- a) Aluminium
Inner parts steel electrogalvaised and roses:
.22, .23, .24, .27, .28, .29, .70
- b) Brass
Inner parts stainless steel and roses:
.61, .65

Order example

(see page 325)

Set ...sets	Item No. 8A60	Finish 82	Fixing type S 10	Door thickness (T) 10 mm
----------------	------------------	--------------	---------------------	-----------------------------

Pull handle fixing kits

8B63.. S 13 - M 8
for Ø 25, 30, 35, 40, 50 mm
handle/support

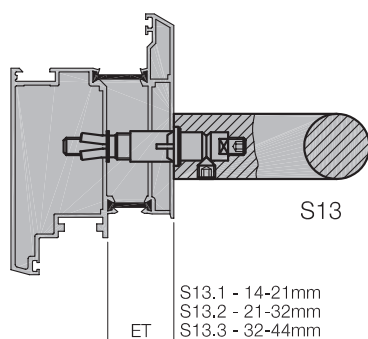

Single handle fixing kit especially for doors of aluminium profile with insulating cavity

For grub screw fixing (LT)

S 13.1 = installation depth (ET) 14 - 21 mm
S 13.2 = installation depth (ET) 21 - 32 mm
S 13.3 = installation depth (ET) 32 - 44 mm

Standard finish for pull handle of:

- a) Aluminium
.06 electrogalvaised
- b) Stainless steel
.80 surface untreated

Mounting

Bore holes on one side of the door: Ø 10 mm through the precavity into the main cavity, then the precavity should be bored to Ø 14 mm. Insert the fixing and drive it into the hole using a hammer. Turn in the set screw (DIN 913) using an Allen Key (SW 4) until it protrudes only 30 mm. Screw nut and block off, adjust the distance piece to the installation depth (ET, see drawing) of the precavity and insulating cavity using the spacer key No. 9800.06. Then, replace block and nut and fasten them using a spanner (SW 11). Fit the handle (LT) over the block and fasten the grub screw using an Allen Key (SW 4).

8B64.. S 14 - M 8

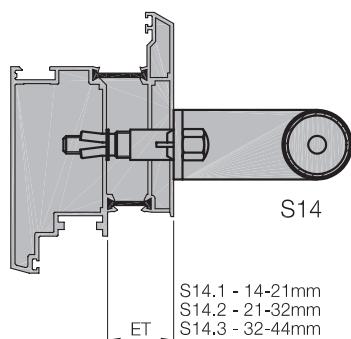

Single handle fixing kit especially for doors of aluminium profile with insulating cavity for door handles of the modular system

For face fixing

S 14.1 = installation depth (ET) 14 - 21 mm
S 14.2 = installation depth (ET) 21 - 32 mm
S 14.3 = installation depth (ET) 32 - 44 mm

Standard finish

- a) Stainless steel
.82 dull brushed

Mounting

Bore holes on one side of the door: Ø 10 mm through the precavity into the main cavity, then the precavity should be bored to Ø 14 mm. Insert the fixing and drive it into the hole using a hammer. Turn in the set screw (DIN 913) using an Allen Key (SW 4) until it protrudes only 15 mm. Screw cap and cone ring off, adjust the distance piece to the installation depth (ET, see drawing) of the precavity and insulating cavity using the spacer key No. 9800.06. Then, fit the handle on the set screw and replace cap and cone ring and fasten them using a spanner (SW 13).

8B65.. S 15 - M 8
for Ø 25, 30, 35, 40, 50 mm
handle/support

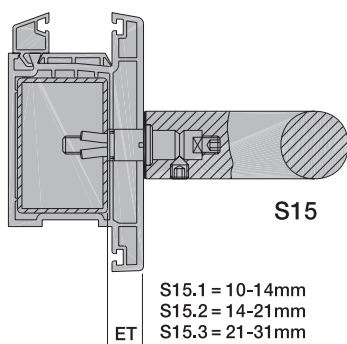

Single handle fixing kit especially for doors of PVC profile with precavity and metal stiffening in the main cavity.

For grub screw fixing (LT)

S 15.1 = installation depth (ET) 10 - 14 mm
S 15.2 = installation depth (ET) 14 - 21 mm
S 15.3 = installation depth (ET) 21 - 31 mm

Standard finish for pull handle of:

- a) Aluminium
.06 Steel electrogalvaised
- b) Brass
.80 Stainless steel untreated
- c) Stainless steel
.80 Stainless steel untreated

Mounting

Bore holes on one side of the door: Ø 10 mm through the precavity into the metal stiffening of the main cavity, then the plastic precavity should be bored to Ø 14 mm. Insert the fixing and drive it into the hole using a hammer. Turn in the set screw (DIN 913) using an Allen Key (SW 4) until it protrudes only 30 mm. Screw nut and block off, adjust the distance piece to the installation depth (ET, see drawing) of the precavity and insulating cavity using the spacer key No. 9800.06. Then, replace block and nut and fasten them using a spanner (SW 11). Fit the handle (LT) over the block and fasten the grub screw using an Allen Key (SW 4).

Order example

(see page 325)

Set	Item No.	Finish	Fixing type	Installation depth (ET)
...sets	8B63	80	S 13.2	21-32 mm

8B66.. S 16 - M 8

Single handle fixing kit especially for doors of PVC profile with precavity and metal stiffening in the main cavity, for door handles of the modular system.

For face fixing.

S 16.1 = installation depth (ET) 10 - 14 mm

S 16.2 = installation depth (ET) 14 - 21 mm

S 16.3 = installation depth (ET) 21 - 31 mm

Standard finish

- a) Stainless steel
- .82 dull brushed

Mounting

Bore holes on one side of the door:
 \varnothing 10 mm through the precavity into the metal stiffening of the main cavity, then the plastic precavity should be bored to \varnothing 14 mm. Insert the fixing and drive it into the hole using a hammer. Turn in the set screw (DIN 913) using an Allen Key (SW 4) until it protrudes only 15 mm. Screw cap and cone piece off, adjust the distance piece to the installation depth (ET, see drawing) using the spacer key No. 9800.06. Then, fit the handle on the set screw and replace cap and cone ring and fasten them using a spanner (SW 13).

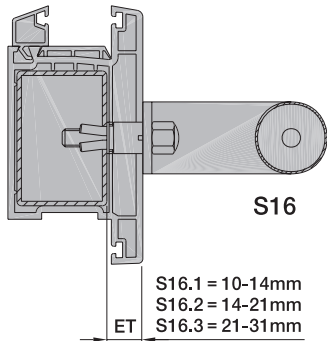

8B67.. S 17 - M 8

for \varnothing 25, 30, 35, 40, 50 mm handle/support

Single handle fixing kit especially for doors of aluminium profile with insulating cavity when one fixing point hits on the lock case of the door.

For grub screw fixing (LT)

S 17.1 = installation depth (ET) 14 - 21 mm

S 17.2 = installation depth (ET) 21 - 32 mm

S 17.3 = installation depth (ET) 32 - 44 mm

Standard finish for door handle of:

- a) Aluminium
- .06 Steel electrogalvaised
- b) Brass
- .80 Stainless steel untreated
- c) Stainless steel
- .80 Stainless steel untreated

Mounting

Fixing point 1 of S 17 fixing kit:
 is placed in the area where the lock case is mounted. Bore holes on one side of the door: \varnothing 8 mm through the precavity into the main cavity, then the precavity should be bored to \varnothing 14 mm. Insert the pan head screw by a fixture through the opening of the lock. Screw the distance bush with M8 screw using spacer key No. 8900.06. Turn the mounting aid inwards, hold the pan head screw using a spanner (SW 13) and fasten the distance bush using the spacer key. Adjust the distance piece to the installation depth (ET) using the spacer key. Fit the block and fasten the nut using a spanner (SW 11).
 Fixing point 2:
 is mounted according to the instructions of S 13.

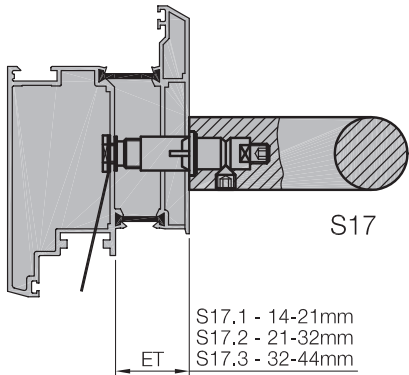

8B70.. S 20 - M 8

Single handle fixing kit especially for solid timber doors, for door handles of the modular system.
 For face fixing.

Standard finish

- a) Stainless steel
- .82 dull brushed

Mounting

Bore holes in the door (\varnothing 12 mm, 35 mm depth) and screw the brass dowel into the hole using a screwdriver of 12 mm width - up to 0.5 mm deeper than the leaf level. Insert the set screw using an Allen Key (SW 4) until it protrudes only 12 mm. Fit the door handle on the set screw and connect the hexagon cap. Fasten it using a spanner (SW 13).

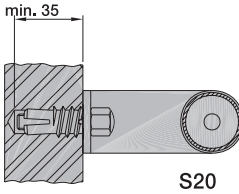

Order example

(see page 325)

Set	Item No.	Finish	Fixing type	Installation depth (ET)
...sets	8B66	82	S 16.1	10-14 mm

Pull handle fixing kits

8A71.. S 21 - M 6

Single handle fixing kit

Especially for pull handles of the modular system

Standard finish

- a) Stainless steel
- .82 dull brushed

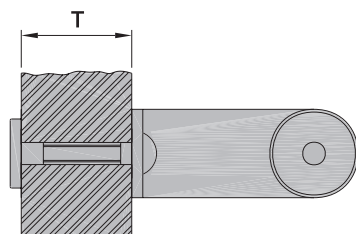

Mounting

Pass the set screw with raised head cap nut through the door leaf. Fasten the handle using the 2 hole counter nut.

8A73.. S 23 - M 6 for Ø 20 pull handle

8B73.. S 23 - M 8
for Ø 25, 30, 35, 40, 50 mm
handle/support

Single handle fixing kit with self-tapping sleeve for doors of aluminium, PVC and timber

For grub screw fixing (LT)

- S 23.1 - self-tapping sleeve 30 mm
- S 23.2 - self-tapping sleeve 35 mm
- S 23.3 - self-tapping sleeve 40 mm
- S 23.4 - self-tapping sleeve 45 mm
- S 23.5 - self-tapping sleeve 50 mm

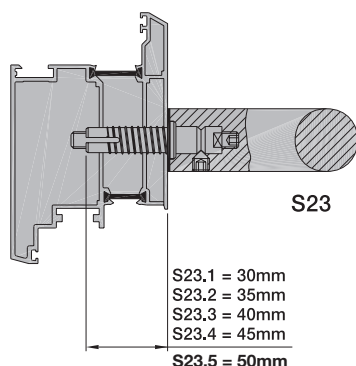

Standard finish for pull handle of:

- a) Aluminium
- .06 electrogalvalised
- b) Stainless steel
- .80 surface untreated

Mounting

Choose the right length of sleeve: - For profile doors the sleeve has to be long enough to hit the main cavity. - For solid timber doors use a 30 or 35 mm sleeve (bore 5 mm deeper).

Bore Ø 12 mm holes on one side of the door. Insert the self-tapping sleeve using an Allen Key (SW 8) until the upper edge levels with the door. Then, insert the set screw using an Allen Key (SW 4) until it protrudes 30 mm. Connect block and nut and fasten it using a spanner (SW 11). Fit the handle (LT) and fasten the grub screw using an Allen Key (SW 4).

8B74.. S 24 - M 8

Single handle fixing kit with self-tapping sleeve, for doors of aluminium and PVC profile with insulating cavity and solid timber doors

Especially for pull handles of the modular system

- S 24.1 - self-tapping sleeve 30 mm
- S 24.2 - self-tapping sleeve 35 mm
- S 24.3 - self-tapping sleeve 40 mm
- S 24.4 - self-tapping sleeve 45 mm
- S 24.5 - self-tapping sleeve 50 mm

Standard finish

- a) Stainless steel
- .80 surface untreated

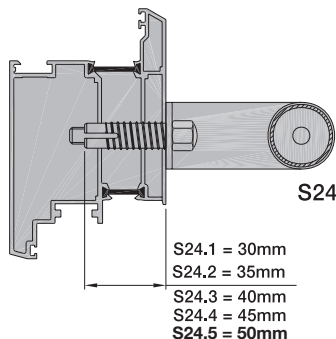

Mounting

Choose the right length of sleeve: - For profile doors the sleeve has to be long enough to hit the main cavity. - For solid timber doors use a 30 or 35 mm sleeve (bore 5 mm deeper).

Bore Ø 12 mm holes on one side of the door. Insert the self-tapping sleeve using an Allen Key (SW 8) until the upper edge levels with the door. Then, insert the set screw using an Allen Key (SW 4) until it protrudes 30 mm. Fit the handle and fasten the hexagon head using a spanner (SW 13).

Order example (see page 325)

Set	Item No.	Finish	Fixing type	Door thickness (T)
...sets	8A71	82	—	40 mm
...sets	8B73	80	S 23.2	—

