



D&E Liobex compact single action spring hinge

The D&E Liobex compact range has an enclosed body to reduce the risk of vandalism. This unique fixing method makes it suitable for environments where security and reliability are essential.

DELSA03	75mm / 3" s/a spring hinge	silver
DELSA03SS	75mm / 3" s/a spring hinge	sat. stainless steel

Door width: 650mm
 Door thickness: 20 - 25mm
 Max. door weight: 10Kgs
 Packaging: 1pr

DELSA04	100mm / 4" s/a spring hinge	silver
DELSA04SS	100mm / 4" s/a spring hinge	sat. stainless steel

Door width: 700mm
 Door thickness: 21 - 30mm
 Max. door weight: 15Kgs
 Packaging: 1pr

DELSA05	125mm / 5" s/a spring hinge	silver
DELSA05SS	125mm / 5" s/a spring hinge	sat. stainless steel

Door width: 780mm
 Door thickness: 25 - 35mm
 Max. door weight: 25Kgs
 Packaging: 1pr

DELSA06	150mm / 6" s/a spring hinge	silver
DELSA06SS	150mm / 6" s/a spring hinge	sat. stainless steel

Door width: 850mm
 Door thickness: 25 - 40mm
 Max. door weight: 35Kgs
 Packaging: 1pr

DELSA07L	175mm / 7" s/a spring hinge - LH	silver
DELSA07R	175mm / 7" s/a spring hinge - RH	silver

Door width: 920mm
 Door thickness: 33 - 50mm
 Max. door weight: 45Kgs
 Packaging: 1pr

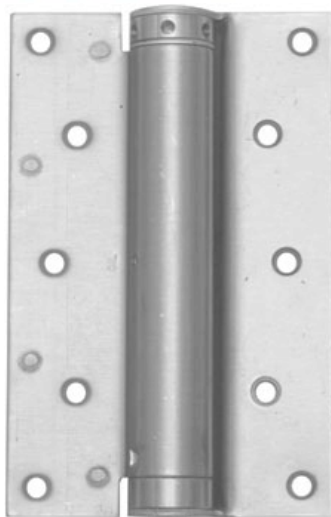

Dimensions & other technical information can be found on pages B-1005 to B-1007

The DELSA06 single action spring hinge has been tested as part of a door set for use on 30 minute fire doors - 3 hinges required per door.

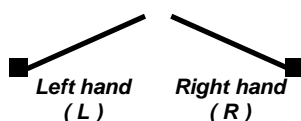

CI/SfB			
31	49		
September 2007			



D&E Liobex compact single action spring hinge

The D&E Liobex compact range has an enclosed body to reduce the risk of vandalism. This unique fixing method makes it suitable for environments where security and reliability are essential.

DELSA08L	200mm / 8" s/a spring hinge - LH	silver
DELSA08R	200mm / 8" s/a spring hinge - RH	silver

Door width:	1000mm
Door thickness:	35 - 55mm
Max. door weight:	55Kgs
Packaging:	1pr

Dimensions & other technical information can be found on pages B-1005 to B-1007

The DELSA06 single action spring hinge has been tested as part of a door set for use on 30 minute fire doors - 3 hinges required per door.

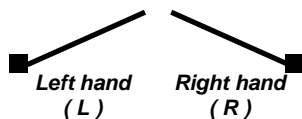
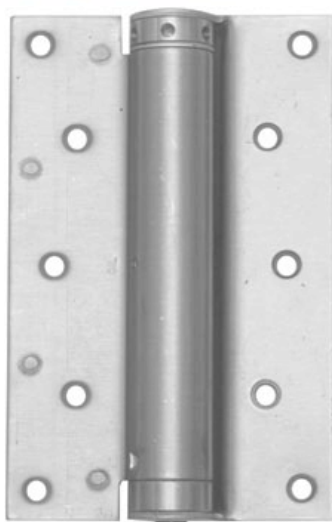



D&E Liobex 'décor' single action spring hinge

The D&E Liobex 'décor' range has decorative end caps at the top and bottom of the barrel. It is a must for applications where aesthetics and reliability are essential.

<i>DELSA03B</i>	75mm / 3" s/a spring hinge	brass plated
<i>DELSA03PC</i>	75mm / 3" s/a spring hinge	pol. chrome plated

Door width: 650mm
 Door thickness: 20 - 25mm
 Max. door weight: 12Kgs
 Packaging: 1pr

<i>DELSA04B</i>	100mm / 4" s/a spring hinge	brass plated
<i>DELSA04PC</i>	100mm / 4" s/a spring hinge	pol. chrome plated

Door width: 700mm
 Door thickness: 21 - 30mm
 Max. door weight: 20Kgs
 Packaging: 1pr



<i>DELSA05B</i>	125mm / 5" s/a spring hinge	brass plated
<i>DELSA05PC</i>	125mm / 5" s/a spring hinge	pol. chrome plated

Door width: 780mm
 Door thickness: 25 - 35mm
 Max. door weight: 30Kgs
 Packaging: 1pr

<i>DELSA06B</i>	150mm / 6" s/a spring hinge	brass plated
<i>DELSA06PC</i>	150mm / 6" s/a spring hinge	pol. chrome plated

Door width: 850mm
 Door thickness: 25 - 40mm
 Max. door weight: 40Kgs
 Packaging: 1pr

<i>DELSA07L/B</i>	175mm / 7" s/a spring hinge - LH	brass plated
<i>DELSA07R/B</i>	175mm / 7" s/a spring hinge - RH	brass plated
<i>DELSA07L/PC</i>	175mm / 7" s/a spring hinge - LH	pol. chrome plated
<i>DELSA07R/PC</i>	175mm / 7" s/a spring hinge - RH	pol. chrome plated

Door width: 920mm
 Door thickness: 25 - 40mm
 Max. door weight: 50Kgs
 Packaging: 1pr

Dimensions & other technical information can be found on pages B-1005 to B-1007

The DELSA06 single action spring hinge has been tested as part of a door set for use on 30 minute fire doors - 3 hinges required per door.

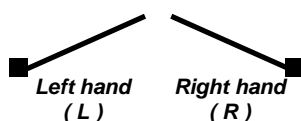

CI/SfB			
31	49		
September 2007			



D&E Liobex 'décor' single action spring hinge

The D&E Liobex 'décor' range has decorative end caps at the top and bottom of the barrel. It is a must for applications where aesthetics and reliability are essential.

DELSA08L/B	200mm / 8" s/a spring hinge - LH	brass plated
DELSA08R/B	200mm / 8" s/a spring hinge - RH	brass plated
DELSA08L/PC	200mm / 8" s/a spring hinge - LH	pol. chrome plated
DELSA08R/PC	200mm / 8" s/a spring hinge - RH	pol. chrome plated

Door width: 1000mm
 Door thickness: 35 - 55mm
 Max. door weight: 70Kgs
 Packaging: 1pr

Dimensions & other technical information can be found on pages B-1005 to B-1007

The DELSA06 single action spring hinge has been tested as part of a door set for use on 30 minute fire doors - 3 hinges required per door.

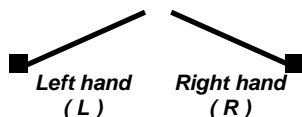
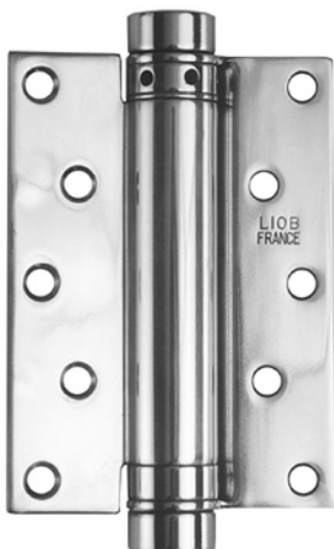

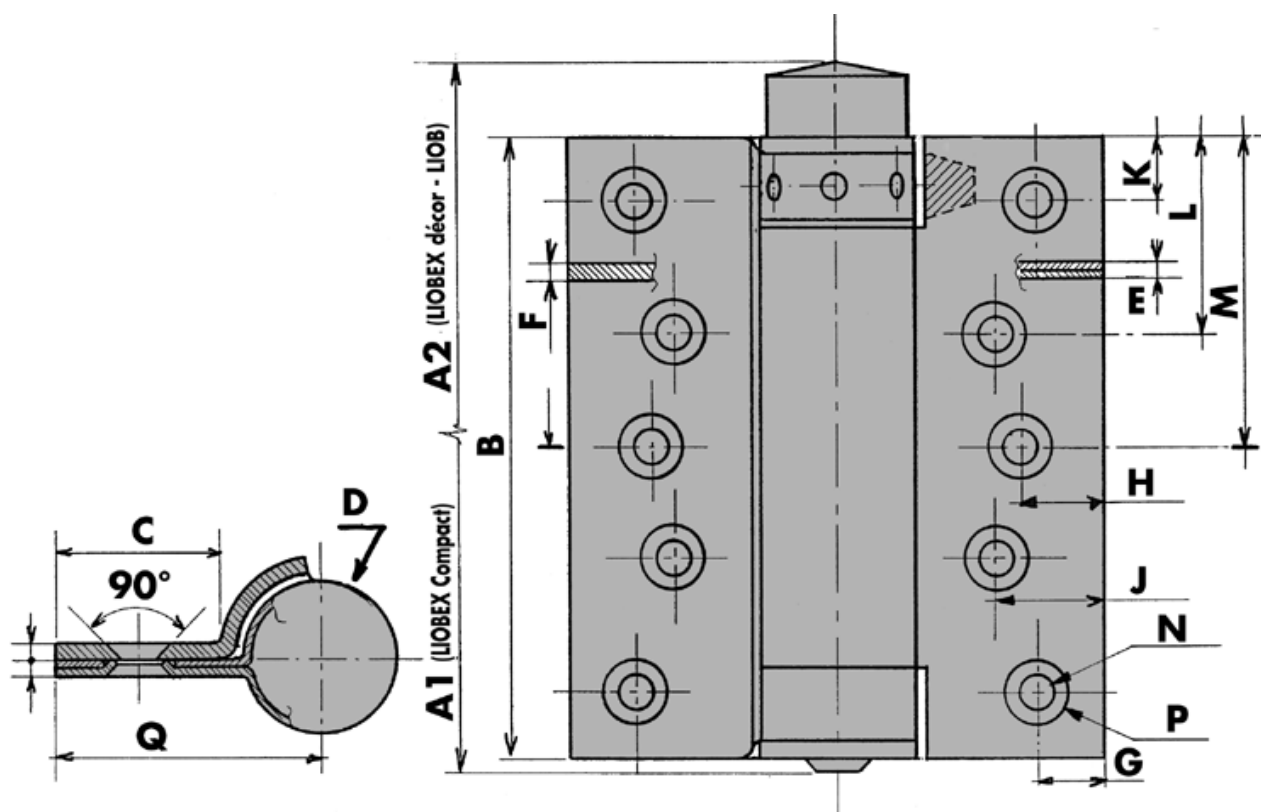

	A1	A2	B	C	D	E	F	G	H	J	K	L	M	N	P	Q
DELSA03 / 0	78	95	75	20	19	2	2	7		13	8	24		5.5	8	34.5
DELSA04 / 1	103	120	100	23	21	2	2	9		15	9.5	28		5.5	8	37.5
DELSA05 / 5	128	147	125	28	22.5	2.4	2	9		20	9.5	36	63	5.5	8	44.5
DELSA06 / 9	153	171	150	30	25	3	2.5	9	14	20	9	37	75	5.5	9	48.25
DELSA07 / 13	179	203	175	38	29	3.6	3.5	10	17	25	15	50	88	7	12	57.5
DELSA08 / 17	203	228	200	42	33	4	4	10	18	30	16	57	100	7	12	64

Other finishes (*RAL colours etc...*) are available to order - (a surcharge may apply).

The spring mechanism and tension retaining pins are manufactured from stainless steel.

Reverse springing (hold open) models are available to order.

D&E Liobex single action spring hinge

CI/SfB			
31	49		
September 2007			

Characteristics common to all the Liobex hinge models

	Model No.	LSA03	LSA04	LSA05	LSA06	LSA07	LSA08
Height of Leaf	mm	75	100	125	150	175	200
	inch	3	4	5	6	7	8
To suit door thickness	mm	20 - 25	21 - 30	25 - 35	25 - 40	33 - 50	35 - 55
To suit max door width	mm	650	700	780	850	920	1000

Characteristics specific to the Liobex Compact range

Weight of the hinge - pair	Kg	0.390	0.580	0.850	1.290	1.765	2.530
Max torque at 90° - per hinge	daN	0.250	0.350	0.500	0.700	0.850	1.200
Max weight of door - per pair	Kg	10	15	25	35	45	55
Fixing screws recommended - Countersunk Screw		4 x 20	4 x 20	4 x 25	4.5 x 25	6 x 30	6 x 30

Characteristics specific to Liobex 'décor' range - with end caps

Weight of hinge - per pair	Kg	0.625	0.870	1.390	1.970	2.675	3.840
Max torque at 90° - per hinge	daN	0.400	0.500	0.600	0.950	1.000	1.400
Max weight of door - per pair	Kg	12	20	30	40	50	70
Fixing screws recommended - Countersunk Screw		4 x 20	4 x 25	4.5 x 25	5 x 25	6 x 30	6 x 30

Installation of Liobex single action spring hinges

To install Liobex Single Action Spring Hinges it may be necessary to fix a plant down the hanging frame. The width of the plant should be sufficient to provide a bearing surface for the flanged face (C) of the hinge. The thickness of the plant should be sufficient to allow the hinge cylinder to rotate freely after the leaf has been morticed into the door, ensuring that the cylinder is free to rotate and that standard door / plant clearance is maintained.

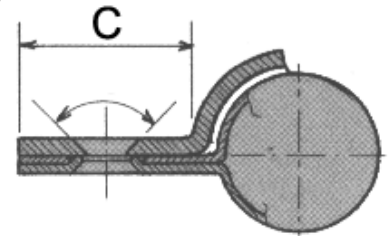

Liobex Single Action Hinges up to 6" are supplied in right hand configuration only, the capstan being at the top of the hinge. For left hand doors the capstan is set at the bottom. 7" and 8" are supplied handed and should be fitted accordingly with the capstan at the top in both instances.

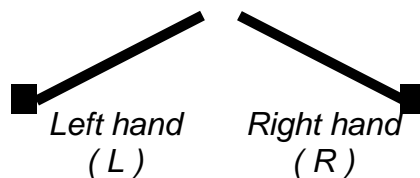

Normal installation should be 250mm from the top and bottom of the door. In the event of a door being oversize, a third hinge may be fitted 100mm below the top hinge. Care must be taken that the centre line of the hinges is in alignment.

Adjustment

Normal operation of the hinge is achieved by tightening the capstan on each hinge and inserting the pin provided.

Normally the top hinge(s) will not require more than three (3) holes, and the bottom Hinge two (2) holes.

DO NOT OVERTIGHTEN THE CAPSTANS

Maintenance

Liobex Spring Hinges are lubricated before despatch. We recommend annual lubrication to maintain trouble free operation.

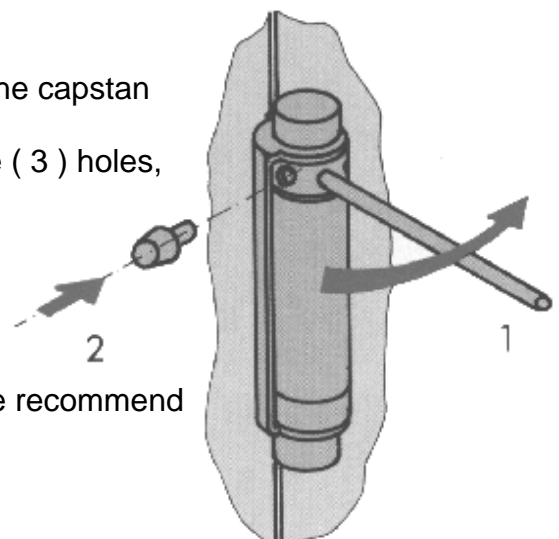

© D&E Architectural Hardware Ltd 2007



D&E Liobex compact double action spring hinge

The D&E Liobex compact range has an enclosed body to reduce the risk of vandalism. This unique fixing method makes it suitable for environments where security and reliability are essential.

<i>DELDA03</i>	75mm / 3" d/a spring hinge	silver
<i>DELDA03SS</i>	75mm / 3" d/a spring hinge	sat. stainless steel

Door width: 650mm
Door thickness: 20 - 25mm
Max. door weight: 10Kgs
Packaging: 1pr

<i>DELDA04</i>	100mm / 4" d/a spring hinge	silver
<i>DELDA04SS</i>	100mm / 4" d/a spring hinge	sat. stainless steel

Door width: 700mm
Door thickness: 21 - 30mm
Max. door weight: 15Kgs
Packaging: 1pr



<i>DELDA05</i>	125mm / 5" d/a spring hinge	silver
<i>DELDA05SS</i>	125mm / 5" d/a spring hinge	sat. stainless steel

Door width: 780mm
Door thickness: 25 - 35mm
Max. door weight: 25Kgs
Packaging: 1pr

<i>DELDA06</i>	150mm / 6" d/a spring hinge	silver
<i>DELDA06SS</i>	150mm / 6" d/a spring hinge	sat. stainless steel

Door width: 850mm
Door thickness: 25 - 40mm
Max. door weight: 35Kgs
Packaging: 1pr

<i>DELDA07</i>	175mm / 7" d/a spring hinge - RH	silver
<i>DELDA07SS</i>	175mm / 7" d/a spring hinge - RH	sat. stainless steel

Door width: 920mm
Door thickness: 33 - 50mm
Max. door weight: 45Kgs
Packaging: 1pr

Dimensions & other technical information can be found on pages B-1012 to B-1014

***DELDA04 / 100mm version is recommended by the
'Muscular Dystrophy Campaign'
through their adaptations manual, for use on internal doors.***

***DELDA06 have been tested as part of a door set for use on
30 minute fire doors - 3 hinges required per door.***

***DELDA08 have been tested as part of a door set for use on 60 minute fire
doors - 2 hinges up to 930mm wide doors & 3 hinges for doors wider than
930mm.***



CI/SfB			
31	49		
September 2007			



D&E Liobex compact double action spring hinge

The D&E Liobex compact range has an enclosed body to reduce the risk of vandalism. This unique fixing method makes it suitable for environments where security and reliability are essential.

DELDA08	200mm / 8" d/a spring hinge	silver
DELDA08SS	200mm / 8" d/a spring hinge	sat. stainless steel

Door width:	1000mm
Door thickness:	35 - 55mm
Max. door weight:	55Kgs
Packaging:	1pr

Dimensions & other technical information can be found on pages B-1012 to B-1014

***DELDA04 / 100mm version is recommended by the
'Muscular Dystrophy Campaign'
through their adaptations manual, for use on internal doors.***

***DELDA06 have been tested as part of a door set for use on
30 minute fire doors - 3 hinges required per door.***

***DELDA08 have been tested as part of a door set for use on 60 minute fire
doors - 2 hinges up to 930mm wide doors & 3 hinges for doors wider than
930mm.***

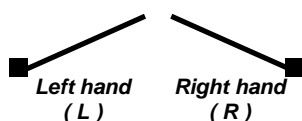

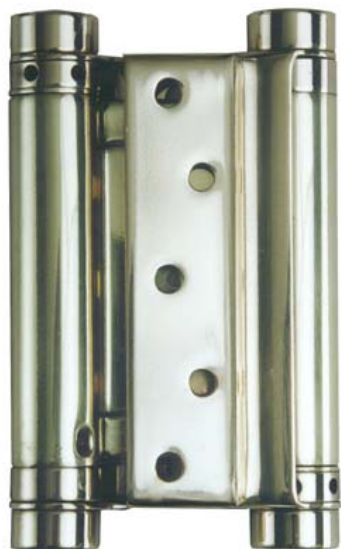

D&E Liobex 'décor' double action spring hinge

The D&E Liobex 'décor' range has decorative end caps at the top and bottom of the barrel. It is a must for applications where aesthetics and reliability are essential.

<i>DELDA03B</i>	75mm / 3" d/a spring hinge	brass plated
<i>DELDA03PC</i>	75mm / 3" d/a spring hinge	pol. chrome plated

Door width: 650mm
 Door thickness: 20 - 25mm
 Max. door weight: 12Kgs
 Packaging: 1pr

<i>DELDA04B</i>	100mm / 4" d/a spring hinge	brass plated
<i>DELDA04PC</i>	100mm / 4" d/a spring hinge	pol. chrome plated

Door width: 700mm
 Door thickness: 21 - 30mm
 Max. door weight: 20Kgs
 Packaging: 1pr



<i>DELDA05B</i>	125mm / 5" d/a spring hinge	brass plated
<i>DELDA05PC</i>	125mm / 5" d/a spring hinge	pol. chrome plated

Door width: 780mm
 Door thickness: 25 - 35mm
 Max. door weight: 30Kgs
 Packaging: 1pr

<i>DELDA06B</i>	150mm / 6" d/a spring hinge	brass plated
<i>DELDA06PC</i>	150mm / 6" d/a spring hinge	pol. chrome plated

Door width: 850mm
 Door thickness: 25 - 40mm
 Max. door weight: 40Kgs
 Packaging: 1pr

<i>DELDA07B</i>	175mm / 7" d/a spring hinge	brass plated
<i>DELDA07PC</i>	175mm / 7" d/a spring hinge	pol. chrome plated

Door width: 920mm
 Door thickness: 25 - 40mm
 Max. door weight: 50Kgs
 Packaging: 1pr

Dimensions & other technical information can be found on pages B-1012 to B-1014

***DELDA04 / 100mm version is recommended by the
 'Muscular Dystrophy Campaign'
 through their adaptations manual, for use on internal doors.***

***DELDA06 have been tested as part of a door set for use on
 30 minute fire doors - 3 hinges required per door.***

***DELDA08 have been tested as part of a door set for use on 60 minute fire
 doors - 2 hinges up to 930mm wide doors & 3 hinges for doors wider than
 930mm.***

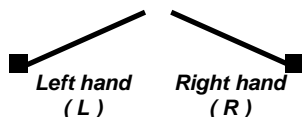

CI/SfB			
31	49		
September 2007			



D&E Liobex 'décor' double action spring hinge

The D&E Liobex 'décor' range has decorative end caps at the top and bottom of the barrel. It is a must for applications where aesthetics and reliability are essential.

<i>DELDA08B</i>	200mm / 8" d/a spring hinge	brass plated
<i>DELDA08PC</i>	200mm / 8" d/a spring hinge	pol. chrome plated

Door width:	1000mm
Door thickness:	35 - 55mm
Max. door weight:	70Kgs
Packaging:	1pr

Dimensions & other technical information can be found on pages B-1012 to B-1014

***DELDA04 / 100mm version is recommended by the
'Muscular Dystrophy Campaign'
through their adaptations manual, for use on internal doors.***

***DELDA06 have been tested as part of a door set for use on
30 minute fire doors - 3 hinges required per door.***

***DELDA08 have been tested as part of a door set for use on 60 minute fire
doors - 2 hinges up to 930mm wide doors & 3 hinges for doors wider than
930mm.***



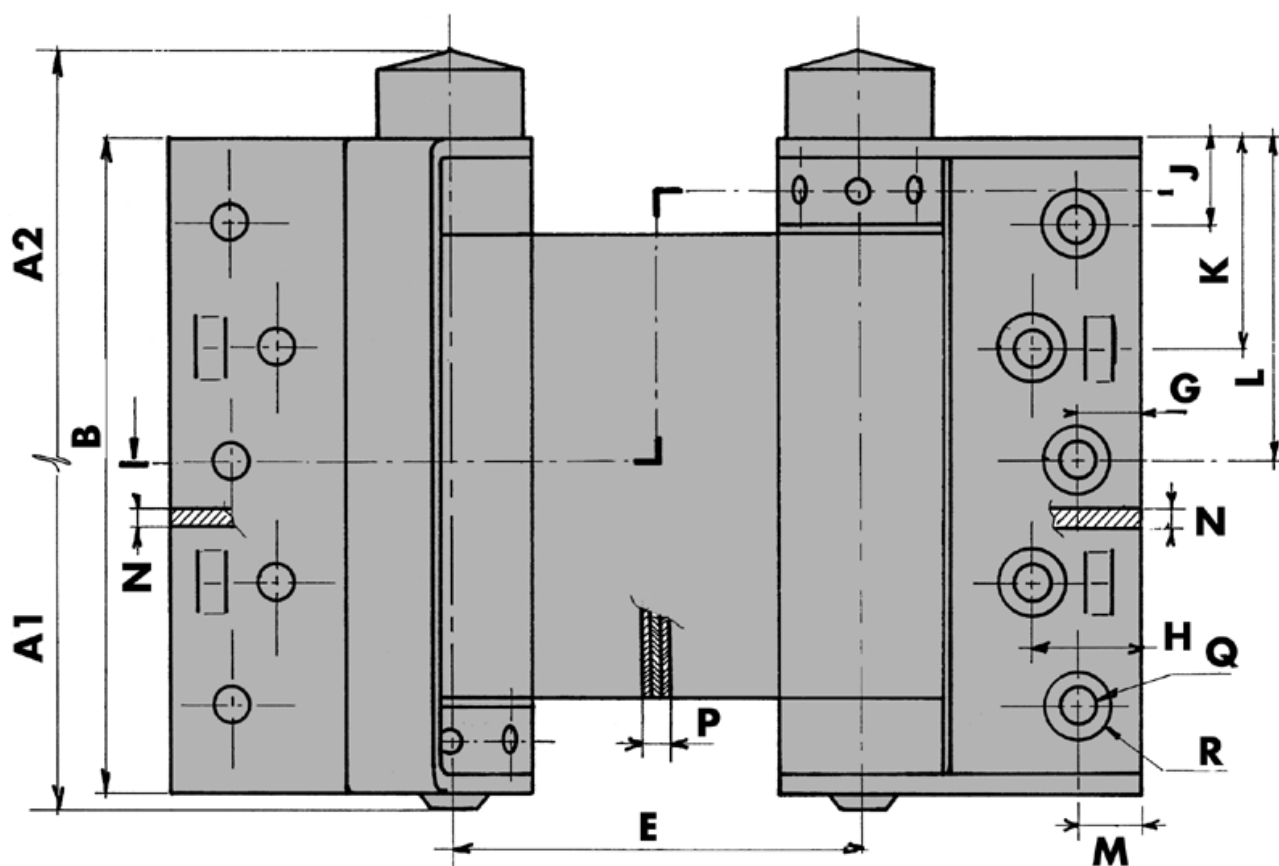

G : EXCEPT HINGES - LDA03 & LDA04

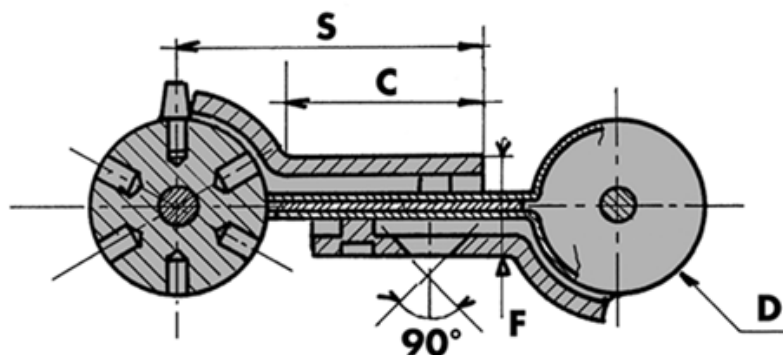

	A1	A2	B	C	D	E	F	G	H	J	K	L	M	N	P	Q	R	S
DELDA03 / 29	78	95	75	20	19	47	11	7.5	12.5	10	24			2	3	5.5	8	33
DELDA04 / 30	103	120	100	25	21	54	11	8	16	11	27			2	3	5.5	8	40
DELDA05 / 33	128	147	125	30	22.5	62.5	12.5	11	21	12	35	62.5		2	3.9	5.5	8	45
DELDA06 / 36	153	172	150	35	25	70	14.5	17	22	14	37	75	10	2.5	4.5	5.5	8	52
DELDA07 / 39	179	203	175	40	29	78	16.5	18.5	29	15	42.5	87.5	11	3	5.4	7	11	59
DELDA08 / 42	202	228	198	45	32	85	17	23.5	34	14	43	99	11	3	6	7.2	11	65.5

Characteristics common to all the Liobex hinge models							
	Model No.	LDA03	LDA04	LDA05	LDA06	LDA07	LDA08
Height of Leaf	mm	75	100	125	150	175	200
	inch	3	4	5	6	7	8
To suit door thickness	mm	20 - 25	21 - 30	25 - 35	25 - 40	33 - 50	35 - 55
To suit max door width	mm	650	700	780	850	920	1000
Characteristics specific to the Liobex Compact range							
Weight of the hinge - pair	Kg	0.75	1.120	1.620	2.510	3.670	4.850
Max torque at 90° - per hinge	daN	0.250	0.350	0.500	0.700	0.850	1.200
Max weight of door - per pair	Kg	10	15	25	35	45	55
Fixing screws recommended - Countersunk Screw		4 x 20	4 x 20	4 x 25	4.5 x 25	6 x 30	6 x 30
Characteristics specific to Liobex 'décor' range - with end caps							
Weight of the hinge - pair	Kg	1.070	1.680	2.400	3.310	4.850	6.370
Max torque at 90° - per hinge	daN	0.400	0.500	0.600	0.950	1.000	1.400
Max weight of door - per pair	Kg	12	20	30	40	50	70
Fixing screws recommended - Countersunk Screw		4 x 20	4 x 25	4.5 x 25	5 x 25	6 x 30	6 x 30

Installation of Liobex double action spring hinges

To install Liobex double action spring hinges correctly it is necessary to have or fix a plant down the hanging frame. Ideally the width of the plant should be the same dimension as the thickness of the door. The thickness of the plant should be sufficient to allow the hinge cylinders to rotate freely after the lipped face (C) has been morticed in. The other lipped face should be morticed into the door, ensuring that both cylinders are free to rotate and that standard door plant clearance is maintained.

The capstan should be fitted at the top on the plant, and at the bottom on the door. This configuration will ensure optimum efficiency and minimum wear.

Normal installation should be 250mm from the top and bottom of the door. In the event of a door being oversize, a third hinge may be fitted 100mm below the top hinge. Care must be taken to ensure that the centre line of the hinges is in alignment.

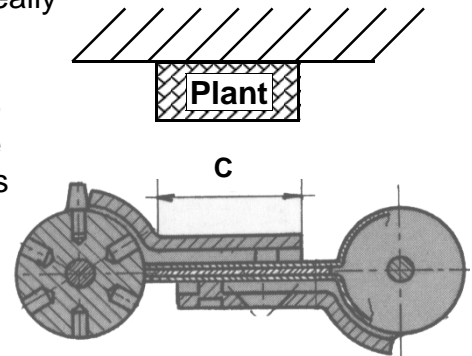

Adjustment

Normal operation of the hinge is achieved by tightening both capstans on each hinge and inserting the pins provided. Normally the top hinge (s) will not require more than three holes, and the bottom hinge two holes.

DO NOT OVERTIGHTEN THE CAPSTANS

Maintenance

Liobex Spring Hinges are lubricated before despatch. We recommend annual lubrication to maintain trouble free operation.

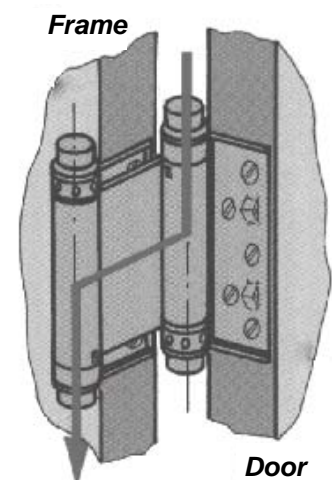

© D&E Architectural Hardware Ltd 2007



D&E contract single action spring hinge

The D&E contract range has decorative end caps at the top and bottom of the barrel.

<i>DESA03</i>	75mm / 3" s/a spring hinge	silver
<i>DESA03B</i>	75mm / 3" s/a spring hinge	brass plated
<i>DESA03N</i>	75mm / 3" s/a spring hinge	nickel plated
<i>DESA03PB</i>	75mm / 3" s/a spring hinge	pol. brass
<i>DESA03PC</i>	75mm / 3" s/a spring hinge	pol. chrome plated

Door width: 600mm
 Door thickness: 18 - 25mm
 Max. door weight: 15Kgs
 Packaging: 1pr

<i>DESA04</i>	100mm / 4" s/a spring hinge	silver
<i>DESA04B</i>	100mm / 4" s/a spring hinge	brass plated
<i>DESA04N</i>	100mm / 4" s/a spring hinge	nickel plated
<i>DESA04PB</i>	100mm / 4" s/a spring hinge	pol. brass
<i>DESA04PC</i>	100mm / 4" s/a spring hinge	pol. chrome plated
<i>DESA04SS</i>	100mm / 4" s/a spring hinge	sat. stainless steel

Door width: 700mm
 Door thickness: 25 - 30mm
 Max. door weight: 22Kgs
 Packaging: 1pr

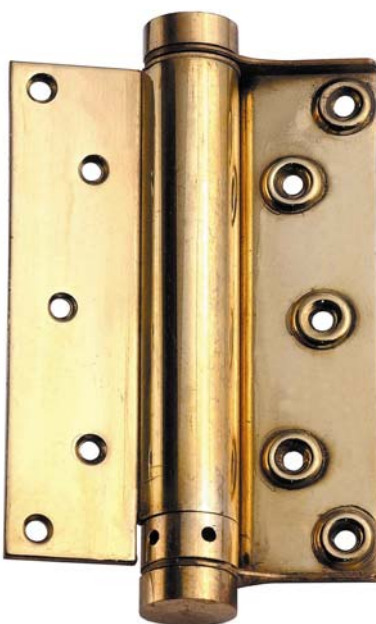

<i>DESA05</i>	125mm / 5" s/a spring hinge	silver
<i>DESA05B</i>	125mm / 5" s/a spring hinge	brass plated
<i>DESA05N</i>	125mm / 5" s/a spring hinge	nickel plated
<i>DESA05PB</i>	125mm / 5" s/a spring hinge	pol. brass
<i>DESA05PC</i>	125mm / 5" s/a spring hinge	pol. chrome plated
<i>DESA05SS</i>	125mm / 5" s/a spring hinge	sat. stainless steel

Door width: 700mm
 Door thickness: 30 - 35mm
 Max. door weight: 27Kgs
 Packaging: 1pr

<i>DESA06</i>	150mm / 6" s/a spring hinge	silver
<i>DESA06B</i>	150mm / 6" s/a spring hinge	brass plated
<i>DESA06N</i>	150mm / 6" s/a spring hinge	nickel plated
<i>DESA06PB</i>	150mm / 6" s/a spring hinge	pol. brass
<i>DESA06PC</i>	150mm / 6" s/a spring hinge	pol. chrome plated
<i>DESA06SS</i>	150mm / 6" s/a spring hinge	sat. stainless steel

Door width: 750mm
 Door thickness: 35 - 40mm
 Max. door weight: 40Kgs
 Packaging: 1pr

CI/SfB			
31	49		
September 2007			

D&E contract single action spring hinge

The D&E contract range has decorative end caps at the top and bottom of the barrel.



DESA07	175mm / 7" s/a spring hinge	silver
DESA07B	175mm / 7" s/a spring hinge	brass plated
DESA07PC	175mm / 7" s/a spring hinge	pol. chrome plated
DESA07N	175mm / 7" s/a spring hinge	nickel plated

Door width: 850mm
Door thickness: 40 - 45mm
Max. door weight: 55Kgs
Packaging: 1pr

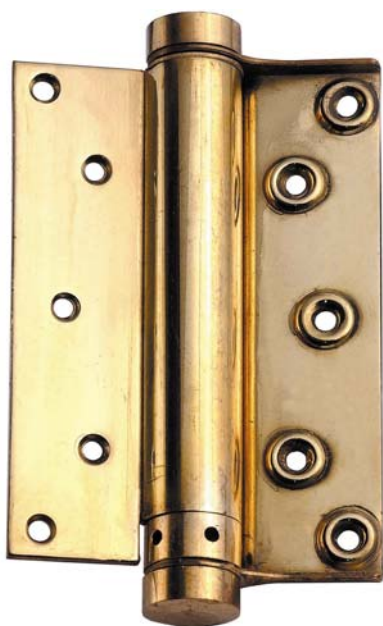



D&E contract double action spring hinge

The D&E contract range has decorative end caps at the top and bottom of the barrel.

<i>DEDA03</i>	75mm / 3" d/a spring hinge	silver
<i>DEDA03B</i>	75mm / 3" d/a spring hinge	brass plated
<i>DEDA03N</i>	75mm / 3" d/a spring hinge	nickel plated
<i>DEDA03PB</i>	75mm / 3" d/a spring hinge	pol. brass
<i>DEDA03PC</i>	75mm / 3" d/a spring hinge	pol. chrome plated
<i>DEDA03SS</i>	75mm / 3" d/a spring hinge	sat. stainless steel

Door width: 600mm
 Door thickness: 18 - 25mm
 Max. door weight: 15Kgs
 Packaging: 1pr

<i>DEDA04</i>	100mm / 4" d/a spring hinge	silver
<i>DEDA04B</i>	100mm / 4" d/a spring hinge	brass plated
<i>DEDA04N</i>	100mm / 4" d/a spring hinge	nickel plated
<i>DEDA04PB</i>	100mm / 4" d/a spring hinge	pol. brass
<i>DEDA04PC</i>	100mm / 4" d/a spring hinge	pol. chrome plated
<i>DEDA04SS</i>	100mm / 4" d/a spring hinge	sat. stainless steel

Door width: 700mm
 Door thickness: 25 - 30mm
 Max. door weight: 22Kgs
 Packaging: 1pr



<i>DEDA05</i>	125mm / 5" d/a spring hinge	silver
<i>DEDA05B</i>	125mm / 5" d/a spring hinge	brass plated
<i>DEDA05N</i>	125mm / 5" d/a spring hinge	nickel plated
<i>DEDA05PB</i>	125mm / 5" d/a spring hinge	pol. brass
<i>DEDA05PC</i>	125mm / 5" d/a spring hinge	pol. chrome plated
<i>DEDA05SS</i>	125mm / 5" d/a spring hinge	sat. stainless steel

Door width: 700mm
 Door thickness: 30 - 35mm
 Max. door weight: 27Kgs
 Packaging: 1pr

<i>DEDA06</i>	150mm / 6" d/a spring hinge	silver
<i>DEDA06B</i>	150mm / 6" d/a spring hinge	brass plated
<i>DEDA06N</i>	150mm / 6" d/a spring hinge	nickel plated
<i>DEDA06PB</i>	150mm / 6" d/a spring hinge	pol. brass
<i>DEDA06PC</i>	150mm / 6" d/a spring hinge	pol. chrome plated
<i>DEDA06SS</i>	150mm / 6" d/a spring hinge	sat. stainless steel

Door width: 750mm
 Door thickness: 35 - 40mm
 Max. door weight: 40Kgs
 Packaging: 1pr

CI/SfB			
31	49		
September 2007			



D&E contract double action spring hinge

The D&E contract range has decorative end caps at the top and bottom of the barrel.

DEDA07	175mm / 7" d/a spring hinge	silver
DEDA07B	175mm / 7" d/a spring hinge	brass plated
DEDA07N	175mm / 7" d/a spring hinge	nickel plated
DEDA07PC	175mm / 7" d/a spring hinge	pol. chrome plated

Door width:	850mm
Door thickness:	40 - 45mm
Max. door weight:	55Kgs
Packaging:	1pr

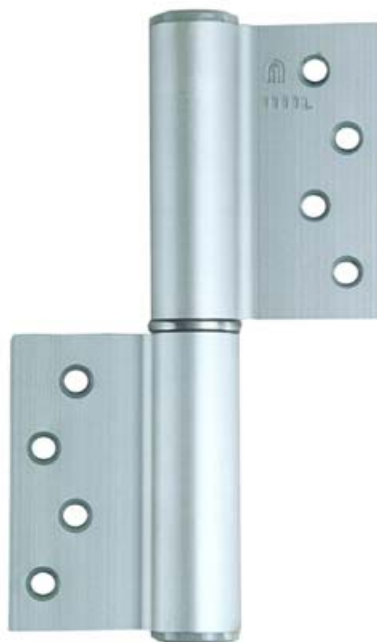

**D&E Auto-hinge 1000 series.**

The 1000 series is a door closer built into a pair of hinges. Comprising of 1 spring hinge and 1 damper hinge and offers a fully adjustable, controlled closing action.

Suitable for use on internal doors up to 35Kg.

DE1111/35/L	auto-hinge - LH	SAA
DE1111/35/R	auto-hinge - RH	SAA

DE1111/35/SL	auto-hinge with H/O - LH	SAA
DE1111/35/SR	auto-hinge with H/O - RH	SAA

DE1110/L	blank hinge - non load bearing - LH	SAA
DE1110/R	blank hinge - non load bearing - RH	SAA

Hold open angle: 85° (*hold open model only*)

Opening angle: 180°

Door weight: 1 pr 35Kg

Packaging: 1 / 10 prs

Supplied handed (see page B-1024)

Supplied complete with fixing screws

See page B-1023 & B-1024 for all technical information including model specification for timber / metal doors in timber / metal frames etc...

**D&E Auto-hinge 100 series.**

The 100 series is a door closer built into a pair of hinges. Comprising of 1 spring hinge and 1 damper hinge and offers a fully adjustable, controlled closing action.

Suitable for use on internal doors up to 40Kg.

DE112/40/L	auto-hinge - LH	silver
DE112/40/R	auto-hinge - RH	silver

DE112/40/SL	auto-hinge with H/O - LH	silver
DE112/40/SR	auto-hinge with H/O - RH	silver

DE110/L	blank hinge - non load bearing - LH	silver
DE110/R	blank hinge - non load bearing - RH	silver

Opening angle: 180°

Hold open angle: 85° & 150° (*hold open model only*)

Door weight: 1 pr 40Kg

Packaging: 1 / 10 prs

Supplied handed (see page B-1024)

Supplied complete with fixing screws

See page B-1023 & B-1024 for all technical information including model specification for timber / metal doors in timber / metal frames etc...

D&E Auto-hinge 100 series.

The 100 series is a door closer built into a pair of hinges. Comprising of 1 spring hinge and 1 damper hinge and offers a fully adjustable, controlled closing action.

Suitable for use on internal doors up to 60Kg.

DE113/60/L	auto-hinge - LH	silver
DE113/60/R	auto-hinge - RH	silver

DE113/60/SL	auto-hinge with H/O - LH	silver
DE113/60/SR	auto-hinge with H/O - RH	silver

DE110/L	blank hinge - non load bearing - LH	silver
DE110/R	blank hinge - non load bearing - RH	silver

Opening angle: 180°

Hold open angle: 85° & 150° (*hold open model only*)

Door weights: 1 pr 60Kg

Packaging: 1 / 10 prs

Supplied handed (see page B-1024)

Supplied complete with fixing screws

See page B-1023 & B-1024 for all technical information including model specification for timber / metal doors in timber / metal frames etc...

**D&E Auto-hinge 100 tri-set series.**

The 113 series tri-set is a door closer built into a set of hinges. The tri-set comprises of 2 spring hinges and 1 damper hinge and offers a fully adjustable, controlled closing action.

Suitable for use on internal doors up to 80Kg.

DE113/80/L	tri-set auto-hinge - LH	silver
DE113/80/R	tri-set auto-hinge - RH	silver

DE113/80/SL	tri-set auto-hinge with H/O - LH	silver
DE113/80/SR	tri-set auto-hinge with H/O - RH	silver

DE110/L	blank hinge - non load bearing - LH	silver
DE110/R	blank hinge - non load bearing - RH	silver

Opening angle: 180°

Hold open angle: 85° & 150° (*hold open model only*)

Door weights: 1 set 80Kg

Packaging: 1 / 10 sets

Supplied handed (see page B-1024)

Supplied complete with fixing screws

See page B-1023 & B-1024 for all technical information including model specification for timber / metal doors in timber / metal frames etc...





D&E Auto-hinge 100 PC series - weather resistant.

The D&E 113PC series is a door closer built into a pair of hinges. Comprising of 1 spring hinge and 1 damper hinge and offers a fully adjustable, controlled closing action which is enhanced by a thermal compensator.

Suitable for use on external doors up to 60Kg.

DE113PC/60/L	PC auto-hinge - LH	silver
DE113PC/60/R	PC auto-hinge - RH	silver

DE113PC/60/SL	PC auto-hinge with H/O - LH	silver
DE113PC/60/SR	PC auto-hinge with H/O - RH	silver

DE110PC/L	PC blank hinge - non load bearing - LH	silver
DE110PC/R	PC blank hinge - non load bearing - RH	silver

Opening angle: 180°

Hold open angle: 85° & 150°

Door weights: 1 pr 60Kg

Packaging: 1 / 10 prs

Supplied handed (see page B-1024)

Supplied complete with fixing screws

See page B-1023 & B-1024 for all technical information including model specification for timber / metal doors in timber / metal frames etc...



D&E Auto-hinge 113 AEM.

The D&E 113AEM is an electro-magnetic hold open device for use with the 112 / 113 Auto-hinge. It can be wired into a fire alarm system.

DE113AEM/L	113 AEM auto-hinge - LH	silver
DE113AEM/R	113 AEM auto-hinge - RH	silver

Opening angle: 180°

Hold open angle: adjustable 30° to 170°

Power: 24 / 48vdc (*please specify*)

Door weights: non load bearing

Packaging: each

Supplied handed (see page B-1024)

Supplied complete with fixing screws



D&E Auto-hinge NK153 series.

The D&E NK153 series is a door closer built into either a pair or set of hinges. There are two door weight configurations. The 60Kg models comprise of 1 spring hinge and 1 damper hinge. The 80Kg models comprise of 2 spring hinges and 1 damper hinge. Both offer a fully adjustable, controlled closing action.

Suitable for use on frameless glass doors up to 60Kg.

DENK153/60/L	NK153 auto-hinge - LH	silver
DENK153/60/R	NK153 auto-hinge - RH	silver

DENK153/60/SL	NK153 auto-hinge with HO - LH	silver
DENK153/60/SR	NK153 auto-hinge with HO - RH	silver

DENK150/L	blank hinge - non load bearing - LH	silver
DENK150/R	blank hinge - non load bearing - RH	silver

Opening angle: 180°

Hold open angle: 85° & 150°

Door weights: 1 pair 60Kg

Glass thickness: 8 to 12mm

Door dimensions: 2100 x 900mm

Packaging: 1 / 10 prs

Supplied handed (see page B-1024)

Supplied complete with fixing screws.

Suitable for use on frameless glass doors up to 80Kg.

DENK153/80/L	NK153 tri-set auto-hinge - LH	silver
DENK153/80/R	NK153 tri-set auto-hinge - RH	silver

DENK153/80/SL	NK153 tri-set auto-hinge with HO - LH	silver
DENK153/80/SR	NK153 tri-set auto-hinge with HO - RH	silver

DENK150/L	blank hinge - non load bearing - LH	silver
DENK150/R	blank hinge - non load bearing - RH	silver

Opening angle: 180°

Hold open angle: 85° & 150°

Door weights: 1 set 80Kg

Glass thickness: 8 to 12mm

Door dimensions: 2200 x 1000mm

Packaging: 1 / 10 prs

Supplied handed (see page B-1024)

Supplied complete with fixing screws.

Part No.		Hand	Max Door Weight	Hold Open Position	Max Opening Angle	Max Door Dimensions
Without hold open	With hold open					

1000 series

To suit a Timber door in a Timber frame

1111R	1111SR	Right	35Kg	85°	180°	W: 850mm H: 2000mm T: min 30mm
1111L	1111SL	Left				
1110R	—	Right	—	—		
1110L	—	Left	—	—		

100 series

To suit a Timber door in a Timber frame

112R	112SR	Right	40Kg	85° & 150°	180°	W: 900mm H: 2100mm T: min 30mm
112L	112SL	Left				
113R	113SR	Right	60Kg			
113L	113SL	Left				
113R Tri-Set	113SR Tri-Set	Right	80Kg			
113L Tri-Set	113SL Tri-Set	Left				
110R	—	Right	—	—		
110L	—	Left				

To suit a Timber door in a Steel frame

122R-T	122SR -T	Right	40Kg	85° & 150°	180°	W: 900mm H: 2100mm T: min 30mm
122L-T	122SL-T	Left				
120R-T	—	Right	—	—		
120L-T	—	Left				

To suit a Steel door in a Steel frame

143R-T	143SR-T	Right	60Kg	85° & 150°	180°	W: 900mm H: 2100mm T: min 30mm
143L-T	143SL-T	Left				
140R-T	—	Right	—	—		
140L-T	—	Left				

To suit a Steel door in a Steel frame

244R-T	244SR-T	Right	120Kg	85° & 150°	180°	W: 1200mm H: 2100mm T: min 40mm
244L-T	244SL-T	Left				
240R-T	—	Right	—	—		
120L-T	—	Left				

Part No.		Hand	Max Door Weight	Hold Open Position	Max Opening Angle	Max Door Dimensions
Without hold open	With hold open					

100 PC series

To suit timber, aluminium & lightweight steel doors

113R-PC	113SR-PC	Right	60Kg	85° & 150°	180°	W: 900mm H: 2100mm T: min 30mm
113L-PC	113SL-PC	Left				
110R	—	Right	—	—		
110L	—	Left				

To suit aluminium, lightweight steel & partition doors

133R-PC	133SR-PC	Right	60Kg	85° & 180°	180°	W: 900mm H: 2100mm T: min 30mm
133L-PC	133SL-PC	Left				
130R-PC	—	Right	—	—		
130L-PC	—	Left				

To suit a Steel door in a Steel frame

143R-T-PC	143SR-T-PC	Right	60Kg	85° & 150°	180°	W: 900mm H: 2100mm T: min 30mm
143L-T-PC	143SL-T-PC	Left				
140R-T-PC	—	Right	—	—		
140L-T-PC	—	Left				

To suit a Steel door in a Steel frame

244R-T-PC	244SR -T-PC	Right	120Kg	85° & 150°	180°	W: 1200mm H: 2100mm T: min 40mm
244L-T-PC	244SL-T-PC	Left				
240R-T-PC	—	Right	—	—		
240L-T-PC	—	Left				

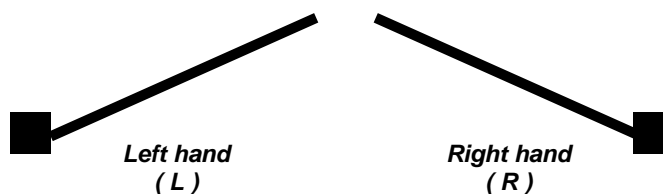



D&E Auto-hinge - Centre Hang type

The D&E Auto-Hinge centre hang type is a concealed single action pivot door closer. Suitable for use on doors ranging from 40Kg up to 510Kg, it offers a controlled closing action.

DEA8K/L centre hang auto-hinge - LH - 40Kg
DEA8K/R centre hang auto-hinge - RH - 40Kg

DEA8/L centre hang auto-hinge - LH - 50Kg
DEA8/R centre hang auto-hinge - RH - 50Kg

DEA10/L centre hang auto-hinge - LH - 85Kg
DEA10/R centre hang auto-hinge - RH - 85Kg

DEA12/L centre hang auto-hinge - LH - 100Kg
DEA12/R centre hang auto-hinge - RH - 100Kg

DEA14/L centre hang auto-hinge - LH - 130Kg
DEA14/R centre hang auto-hinge - RH - 130Kg

DEA16/L centre hang auto-hinge - LH - 160Kg
DEA16/R centre hang auto-hinge - RH - 160Kg

DEA18/L centre hang auto-hinge - LH - 200Kg
DEA18/R centre hang auto-hinge - RH - 200Kg

DEA22/L centre hang auto-hinge - LH - 240Kg
DEA22/R centre hang auto-hinge - RH - 240Kg

DEA26/L centre hang auto-hinge - LH - 310Kg
DEA26/R centre hang auto-hinge - RH - 310Kg

DEA30/L centre hang auto-hinge - LH - 410Kg
DEA30/R centre hang auto-hinge - RH - 410Kg

DEA30H/L centre hang auto-hinge - LH - 510Kg
DEA30H/R centre hang auto-hinge - RH - 510Kg

Opening angle: 180°

Door weights: all door weights shown above are subject to certain criteria -
see pages B-1026 & B-1027 for further information.

Finish: stove enamelled

Packaging: each

Supplied handed (see page B-1026)

Supplied complete with fixing screws

D&E Auto-hinge - Centre Hang Type

CI/SfB

31

49

September 2007

model no.	door dimensions (mm)			max door weight	standard closing force	max opening angle
	width	height	thickness			
A-8K	800 (max)	1850 (max)	36 (min)	40	6.9 N-m	180°
A-8		2000		50	8.9 N-m	
A-10	1000	2100	40	85	10.8 N-m	
A-12	1200			100	15.7 N-m	
A-14	1400			130	19.7 N-m	
A-16	1600	2400	45	160	24.6 N-m	
A-18	1800		50	200	41.2 N-m	
A-22	2200			240	49.1 N-m	
A-26	2600	2600	55	310	60.9 N-m	
A-30	3000			410	68.7 N-m	
A-30H				510		

1. Select an appropriate model according to the dimensions (height x width) of the door.
(See chart on page B-1027)
 2. Ensure that the door weight is within the guidelines set out in the table below.
- N.B. The chart on page B-1027 is based on a wind velocity of 3m/sec. If being used in conjunction with a smoke ventilation system or should the wind conditions be any greater then please contact the sales office.

<i>model</i>	<i>weight / 1m²</i>	<i>type of door</i>
A-8K	27Kg/m ² max	steel door (only for wicket door)
A-8	31Kg/m ² max	steel door
A-10, A-12	39Kg/m ² max	
A-14, A-16	41Kg/m ² max	
A-18, A-22, A-26	45Kg/m ² max	
A-30	52Kg/m ² max	
A-30H	65Kg/m ² max	

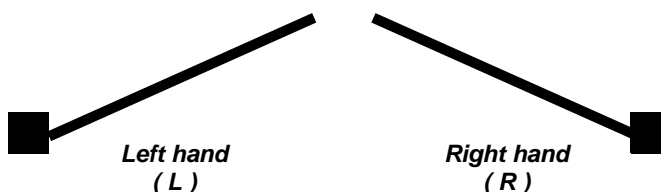

Sales: 01733 896123



B-1026

Fax: 01733 894466

E&OE

D&E Auto-hinge - Centre Hang Type

CI/SfB			
31	49		
September 2007			

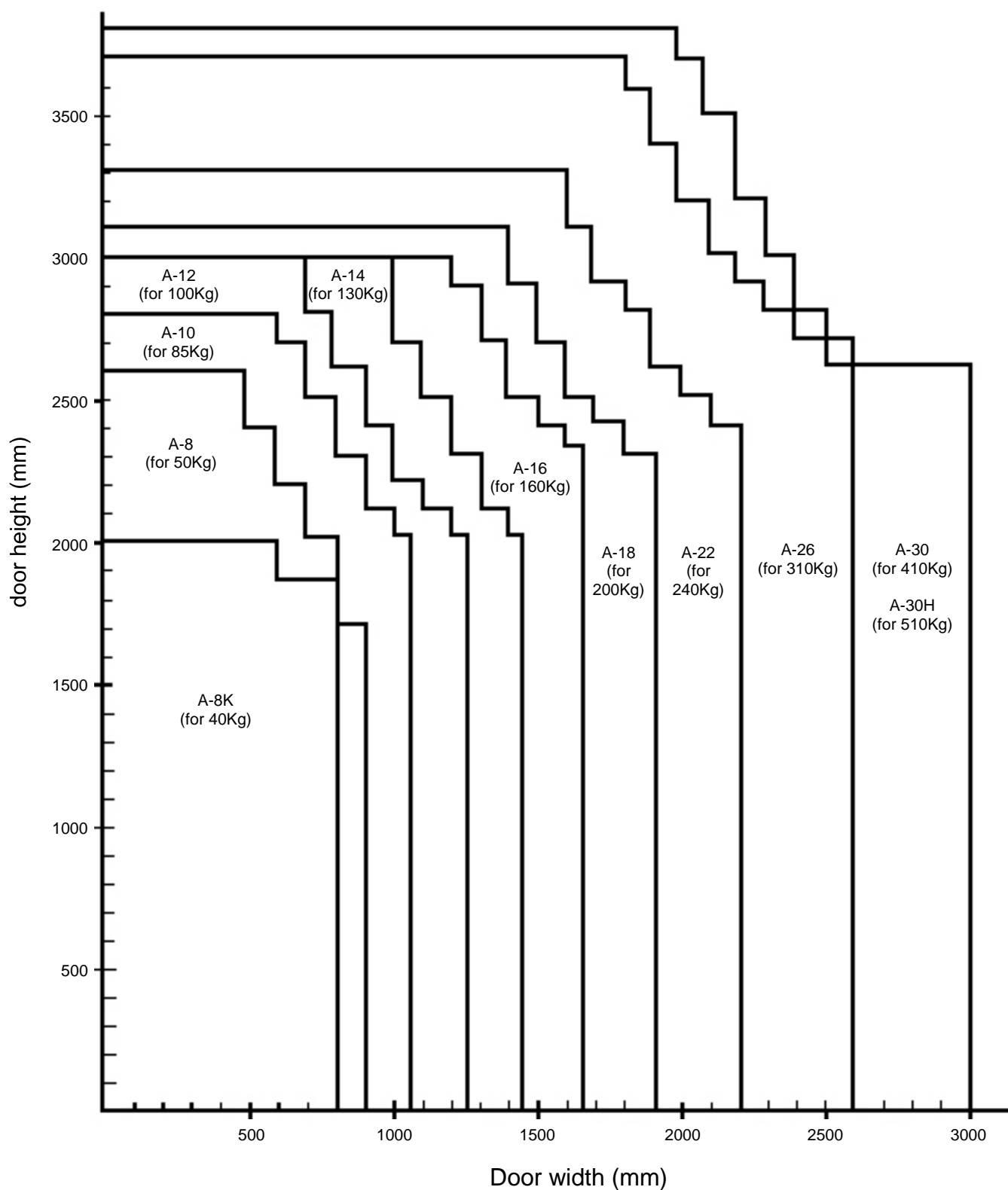

Sales: 01733 896123



B-1027

Fax: 01733 894466

E&OE

Notes

CI/SfB			
	31/59	Xt 7	
September 2007			

[illegible]

Sales: 01733 896123



B-1028

Fax: 01733 894466

E&OE