

ALP602

Touch Bar Panic Latch-Two Point Latching

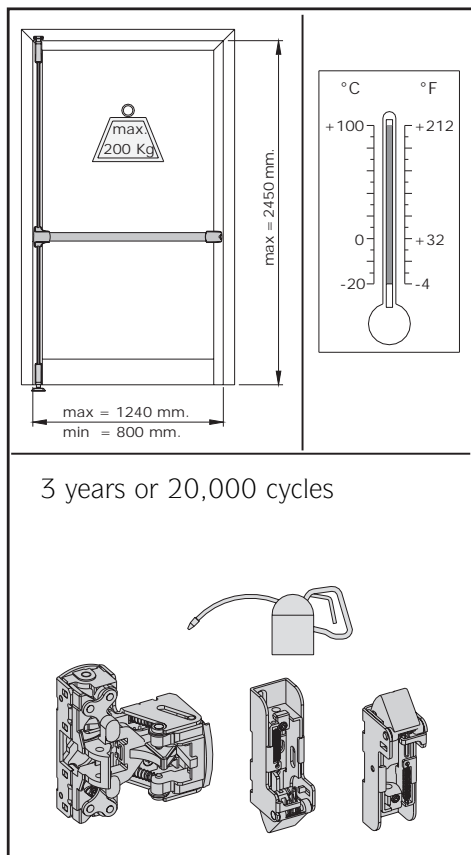

CAUTION

The safety features of this product are essential to its compliance with EN 1125. No modification of any kind, other than those described in these instructions, are permitted.

Alpro cannot bear any responsibility for defects or damages where the product is used outside the application field.

alpro® *First Choice for Locking Solutions*

T 01202 676262

F 01202 680101

E info@alpro.co.uk

W www.alpro.co.uk

ALP602

Touch Bar Panic Latch-Two Point Latching

Mounting and assembly advice:

Alpro panic device systems, conform to the latest European standard EN 1125:2008, guarantee a very high level of people's safety and a satisfactory security on condition that they are fitted to good condition doors and frames.

Doors should be checked in order to ensure correct hanging and freedom from binding.

Care should be taken that any seals fitted to the whole door don't inhibit the correct operations of the panic device system.

On double door sets with rebated meeting stiles and where both leaves are fitted with panic device system, it is essential to check that either leaf will open when it's panic device system is activated and also that both leaves will open freely when both devices are operated simultaneously.

The fixing instructions should be carefully followed during installation. These instructions and any maintenance instructions should be passed on from the installer to the user.

The locking pieces and the keepers should be fitted so as provide secure engagement. Care should be taken to ensure that no projection of the locking pieces, when in withdrawn position, could prevent the door swinging freely.

All the assembled elements should conform to this standard.

The screws supplied are fit for applications on aluminium and steel doors; for wood and PVC applications, please, replace them with suitable screws.

Maintenance:

The following maintenance controls are recommended to be carried out monthly by the occupier or by his approved representative:

- Operate the panic device system to verify that the door open/close movement is correct and consequently that all components are in a satisfactory condition.
- Check that locking pieces are free from obstructions.
- Check that all screws and grub screws are tightly fastened.

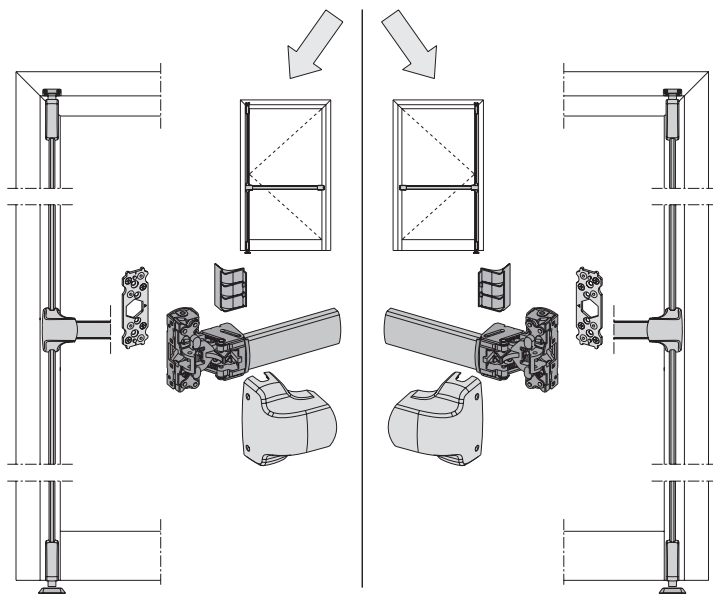

ALP602

Touch Bar Panic Latch-Two Point Latching

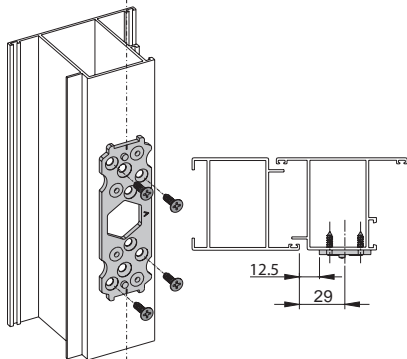
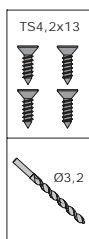
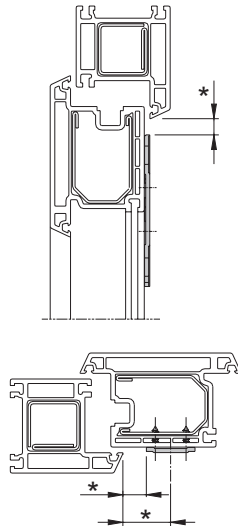
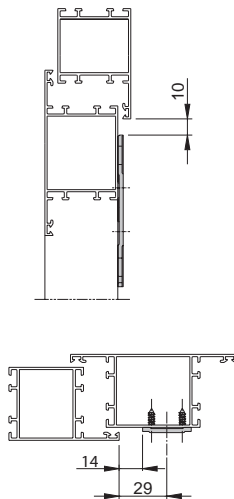
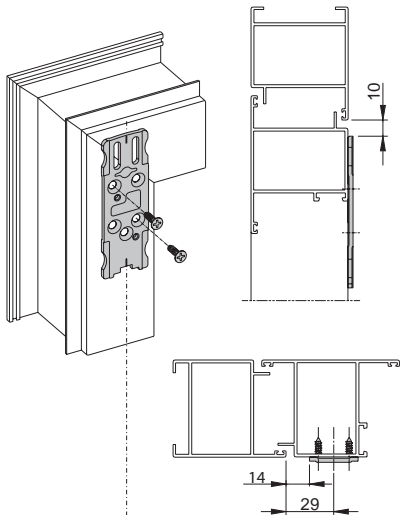
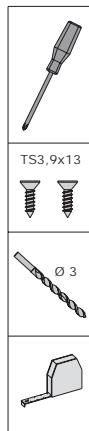

* For positioning dimensions, please contact:
info@alpro.co.uk

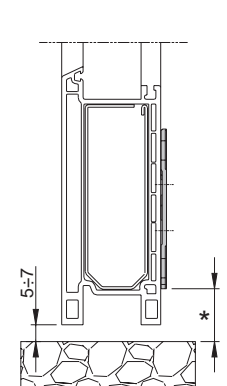
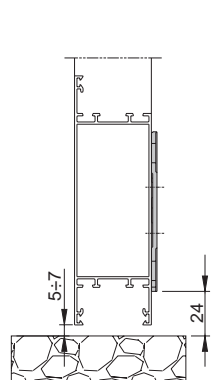
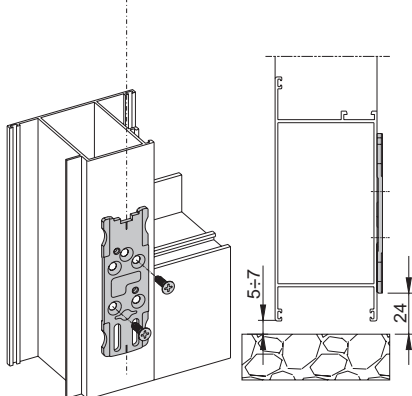
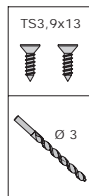
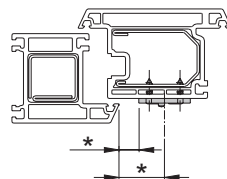
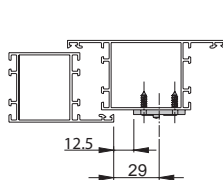

ALP602

Touch Bar Panic Latch-Two Point Latching

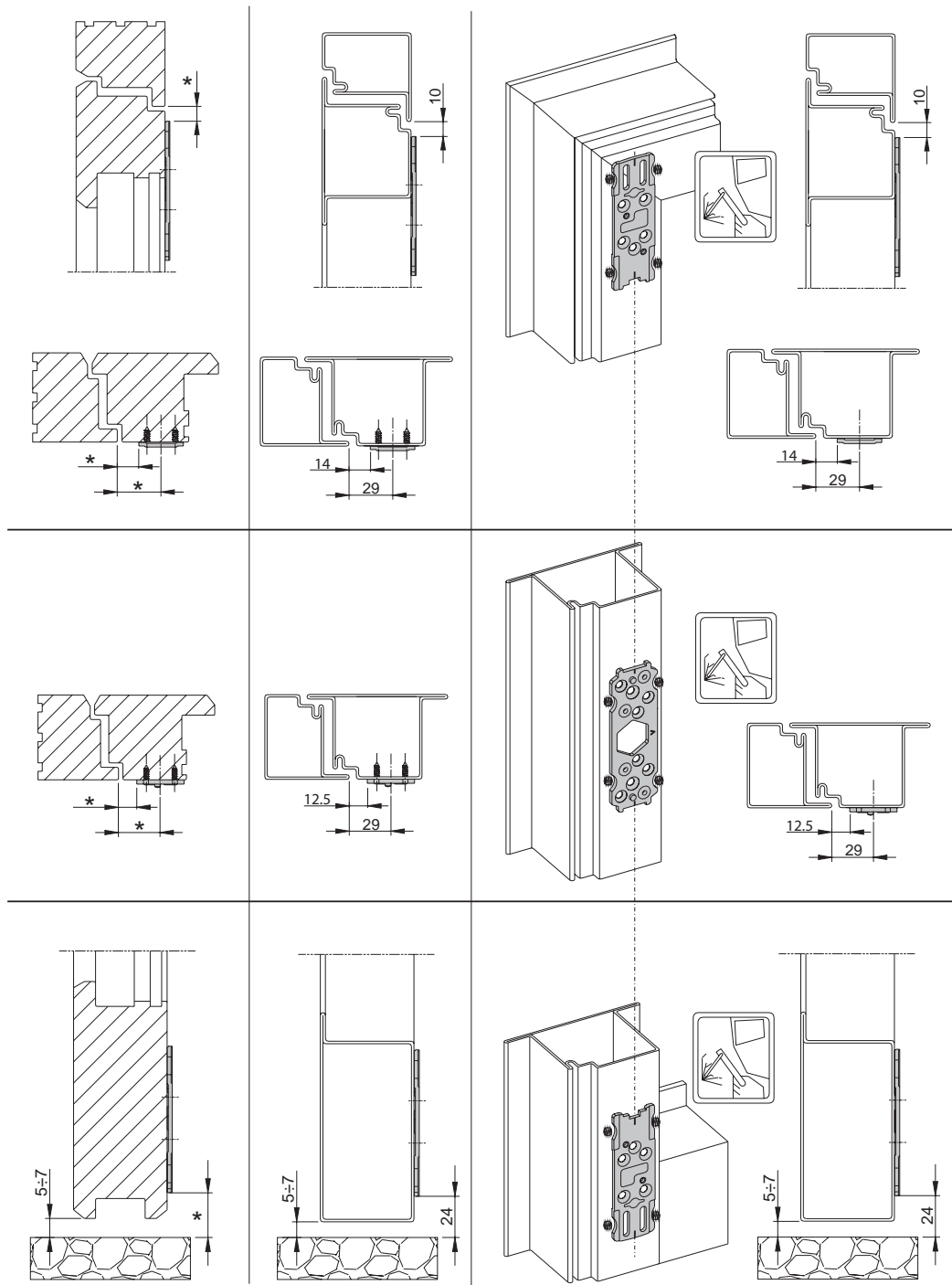

ALP602

Touch Bar Panic Latch-Two Point Latching

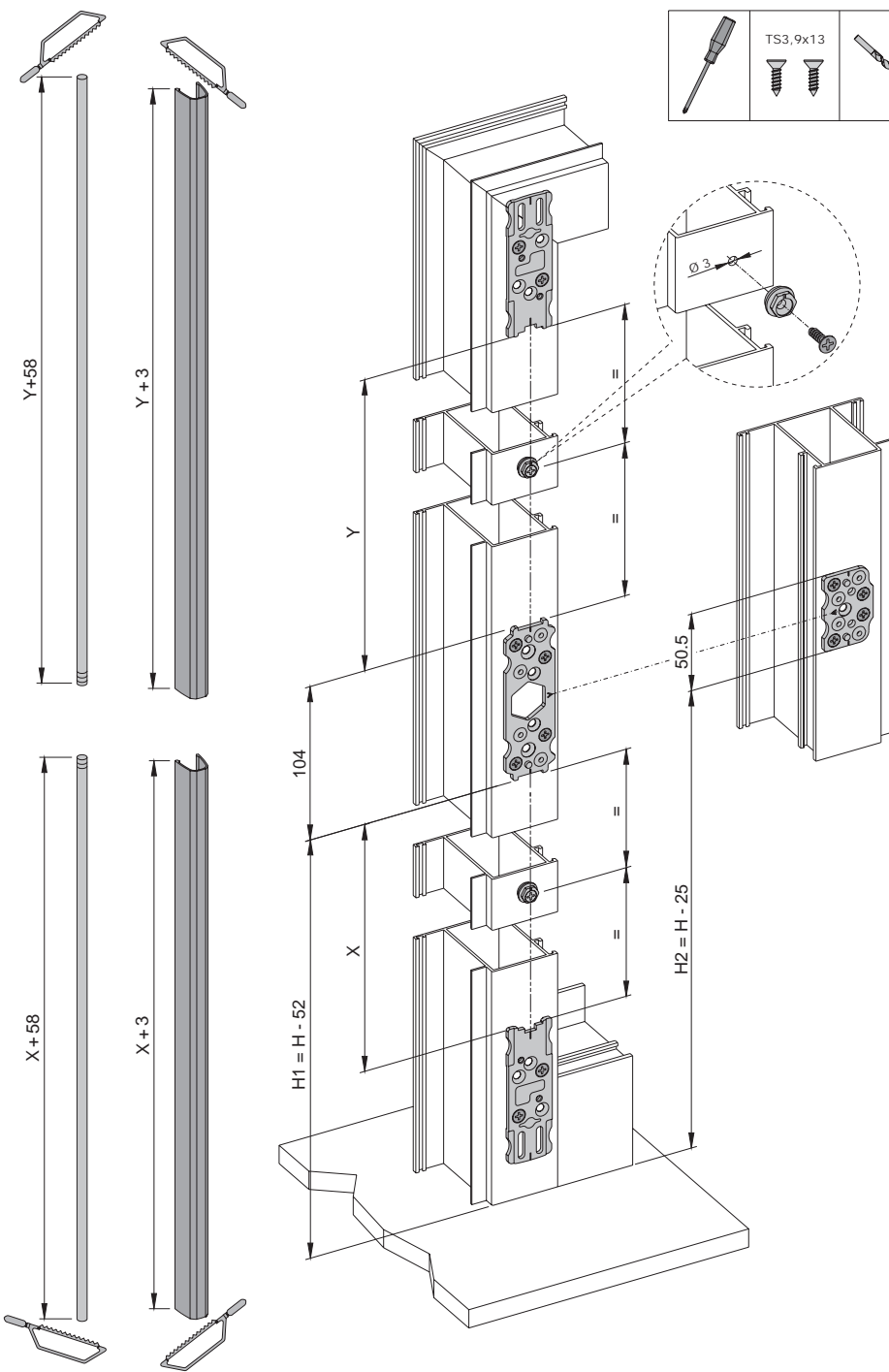

ALP602

Touch Bar Panic Latch-Two Point Latching

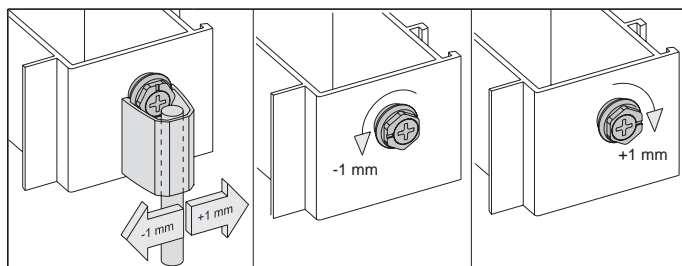
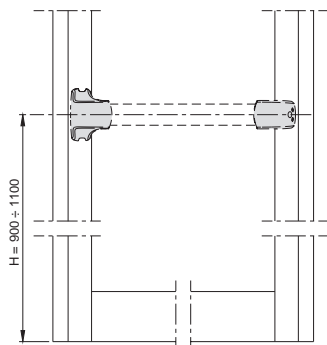
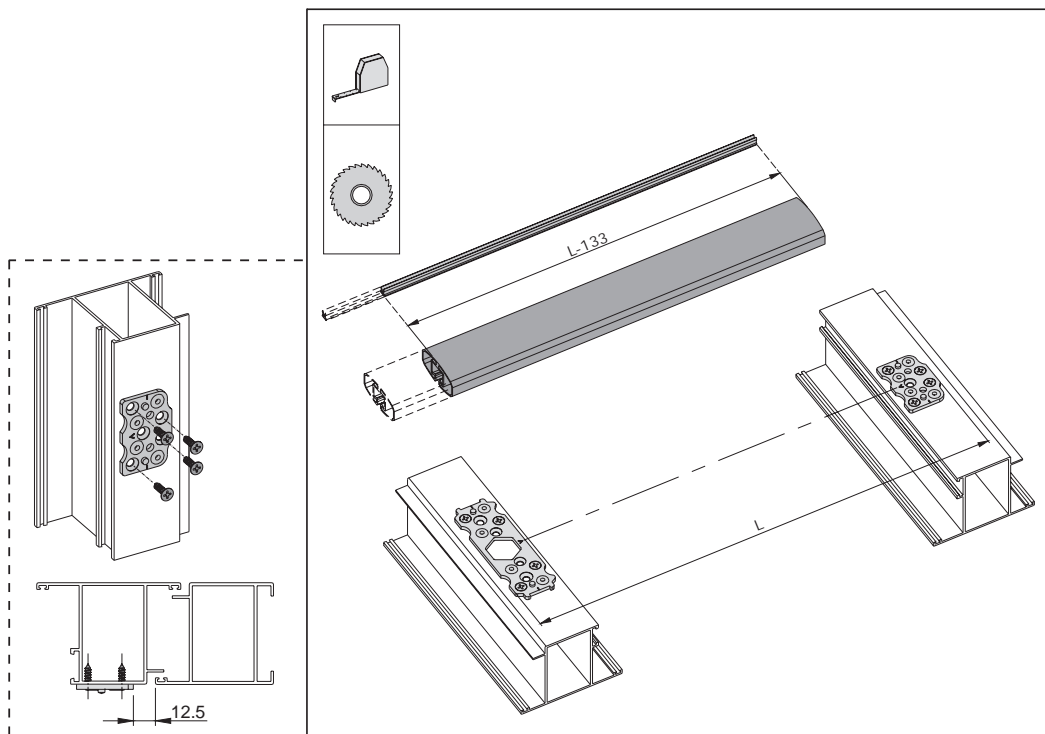

ALP602

Touch Bar Panic Latch-Two Point Latching

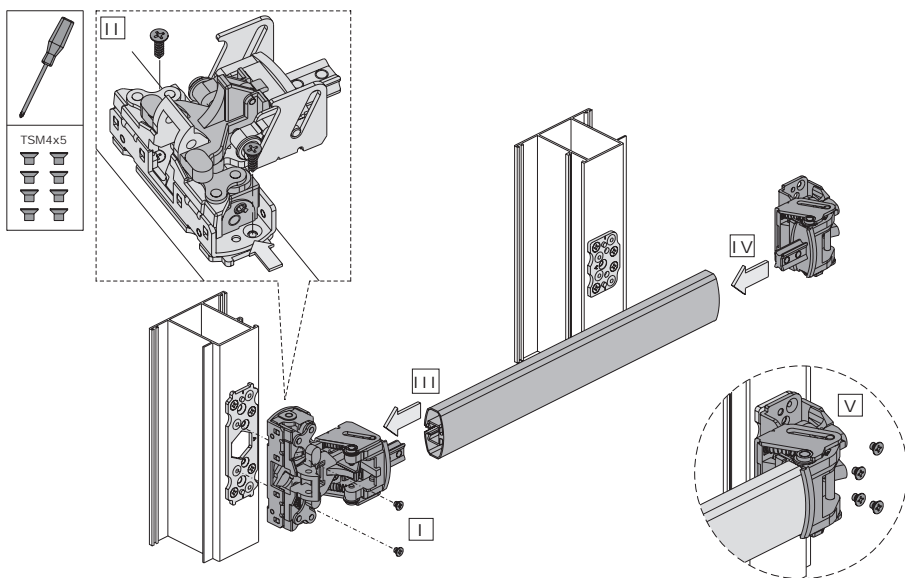
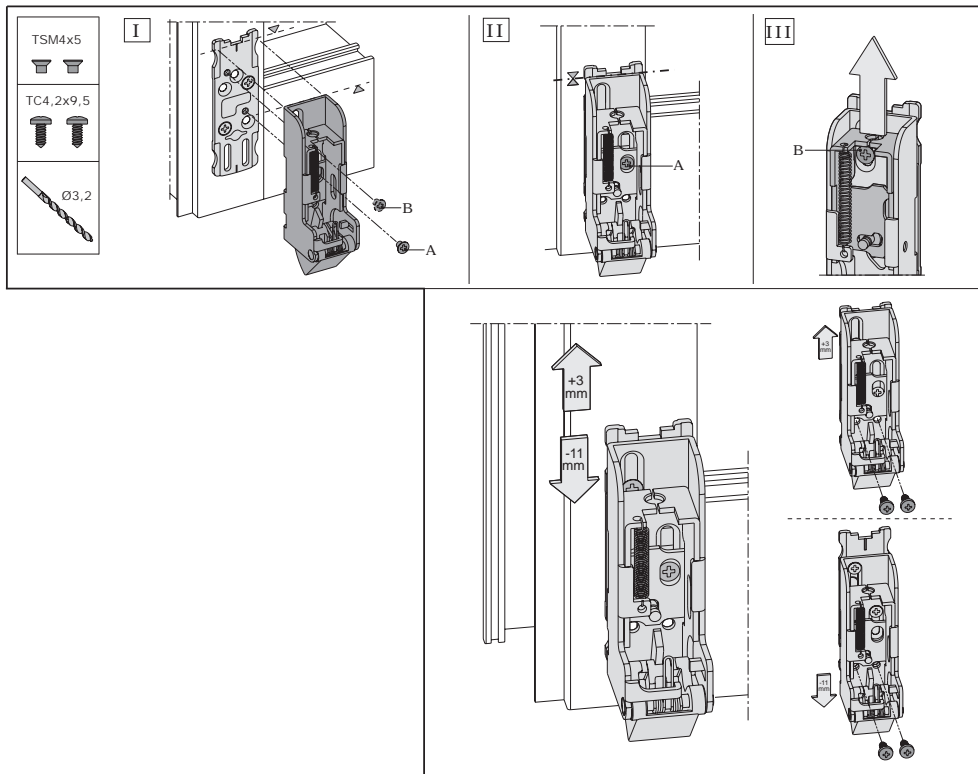

ALP602

Touch Bar Panic Latch-Two Point Latching

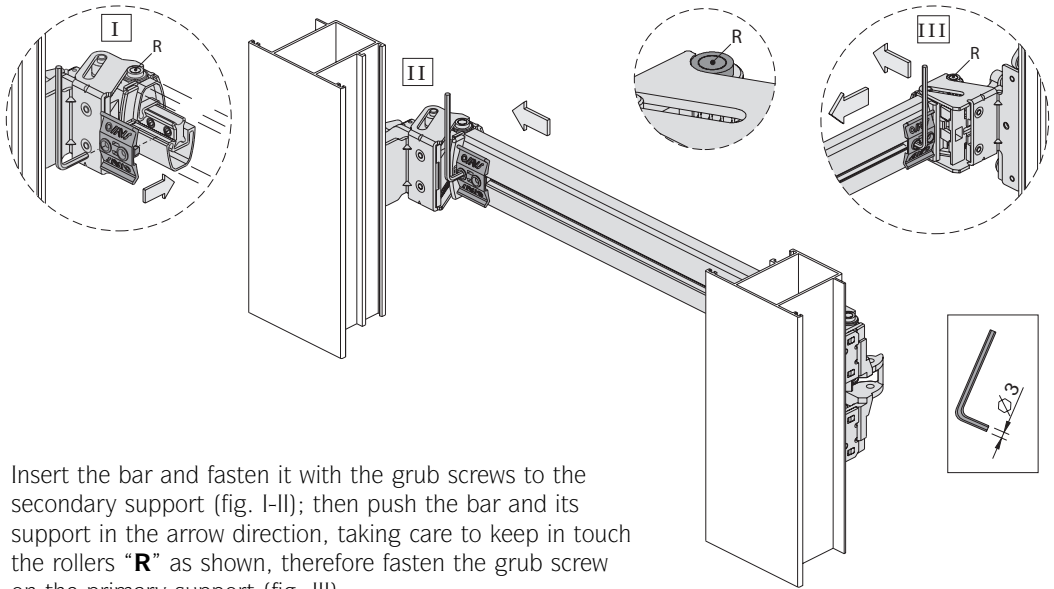

Insert the bar and fasten it with the grub screws to the secondary support (fig. I-II); then push the bar and its support in the arrow direction, taking care to keep in touch the rollers “R” as shown, therefore fasten the grub screw on the primary support (fig. III).

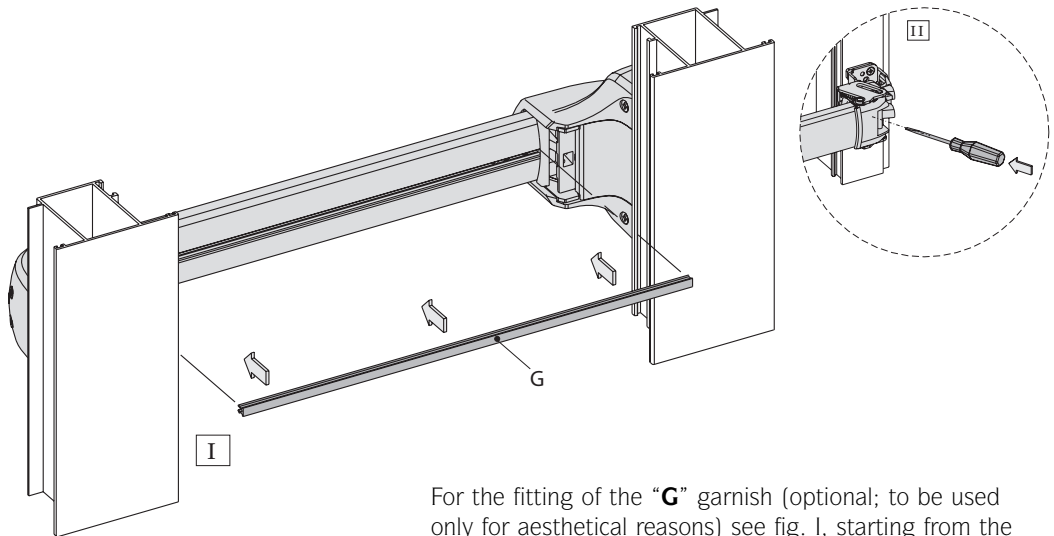

For the fitting of the “G” garnish (optional; to be used only for aesthetical reasons) see fig. I, starting from the ends. In case of removal, operate with a 3mm screw driver, as shown on fig.II.

ALP602

Touch Bar Panic Latch-Two Point Latching

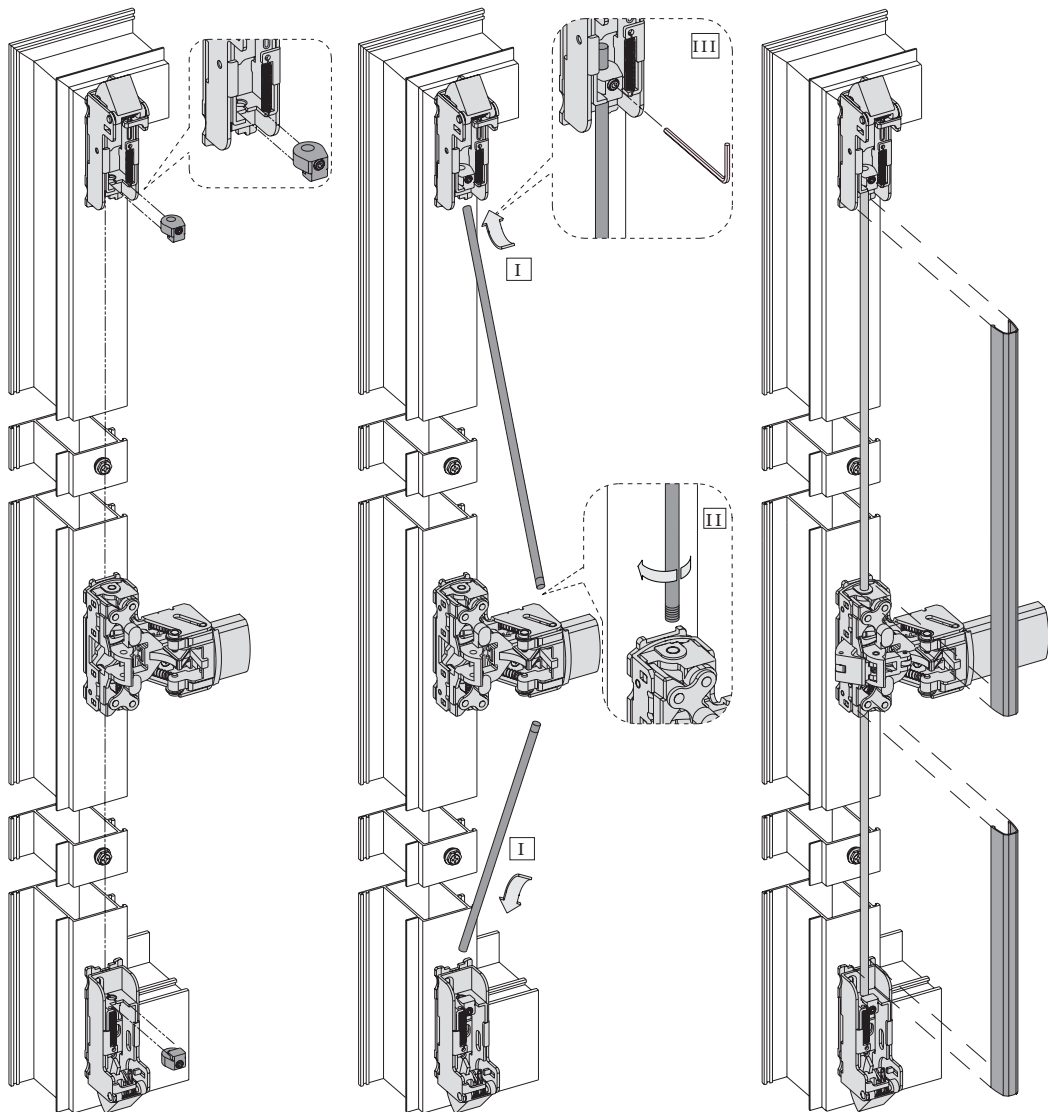
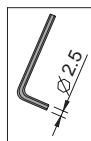

ALP602

Touch Bar Panic Latch-Two Point Latching

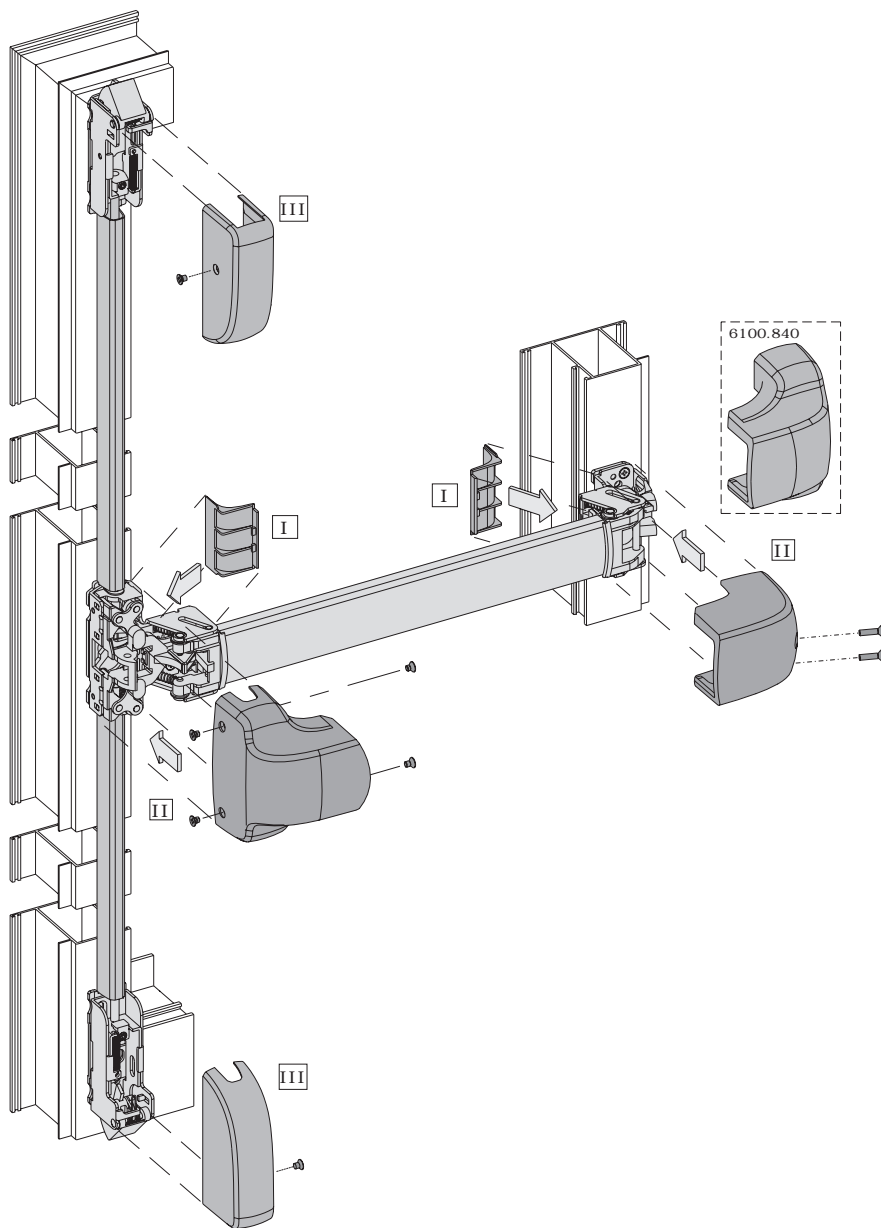
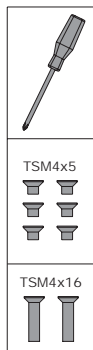

ALP602

Touch Bar Panic Latch-Two Point Latching

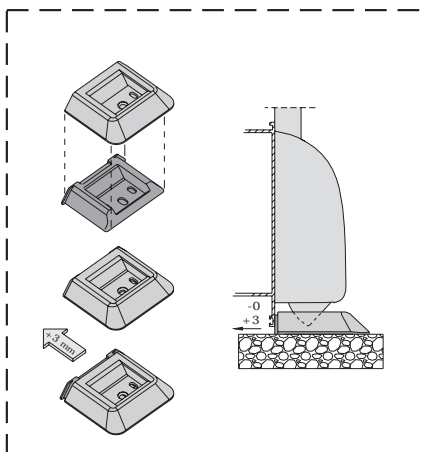
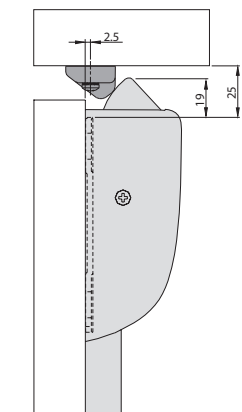
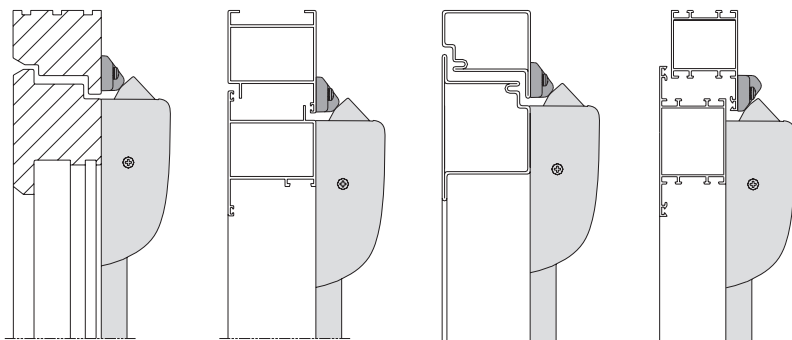
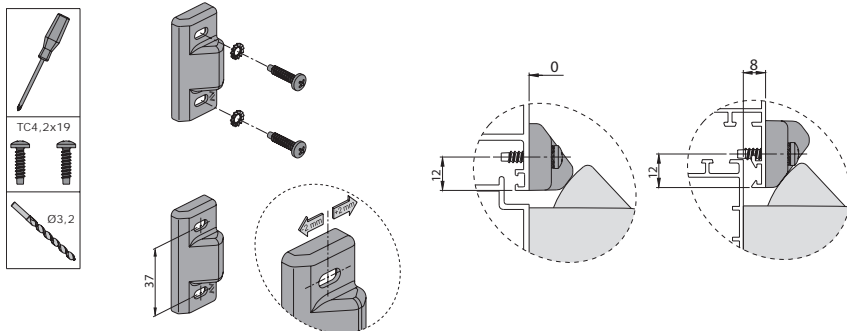

IEC Limited Harwell Road Nuffield Estate Poole Dorset BH17 0BD Great Britain

Registered in England & Wales 1925537
 © March 2012 IEC. All rights reserved.
 All dimensions are nominal and subject to tolerances

T 01202 676262
F 01202 680101
E info@alpro.co.uk
W www.alpro.co.uk