

## Lifting Systems and Accessories



# WE GET IDEAS MOVING

The spirit of innovation and a sense of ideas beyond the familiar has made us into a pioneering company over more than 185 years.

For a quarter of a century, we have been offering customized drive solutions for office and workplace workstations, as well as for shading systems and building technology.

Through our tradition of innovation, we have succeeded in establishing ourselves as a specialist and problem-solver in numerous areas.

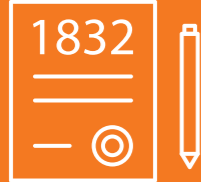

Over 185 years' experience



More than 60 standard solutions for four different market segments



100% Made in Black Forest

# THE RIGHT PRODUCT FOR EACH APPLICATION

## Lifting Systems

- Page 04 3051 Gas spring spindle actuator
- Page 08 3052 Crank lifting system Ket-Twist 500
- Page 12 3053 Crank lifting system Ket-Twist 660
- Page 16 4701 Monitor / TV-Lift Ket-Screen Lift S
- Page 20 4701 Monitor / TV-Lift Ket-Screen Lift L
- Page 24 4701 Monitor / TV-Lift Ket-Spring Lift S

## Accessories

- Page 26 3052.09 Brake unit
- Page 28 5102/5159 Crank handles
- Page 30 5180 Crank-handle
- Page 32 5186 Crank-handle
- Page 34 5187 Crank-handle
- Page 36 5190 Crank-handle
- Page 38 Control box Compact
- Page 40 Hand control and motor cables
- Page 42 Profile tubes - Profile rods



# Gas spring spindle actuator 3051



## Description

Gas spring supported spindle lift drive with mechanical blocking unit. The manual lift drive for two-leg tables is actuated by a manual release with Bowden cables. The safety actuator prevents the user from actuating the table unintentionally.

## Special features

- Rapid height adjustment solely by manual force on the table surface
- Customer specific: Flexible fabrication of connecting tubes
- Quick, easy assembly
- Independence from electrical connections: Free interior design options

## Variant key

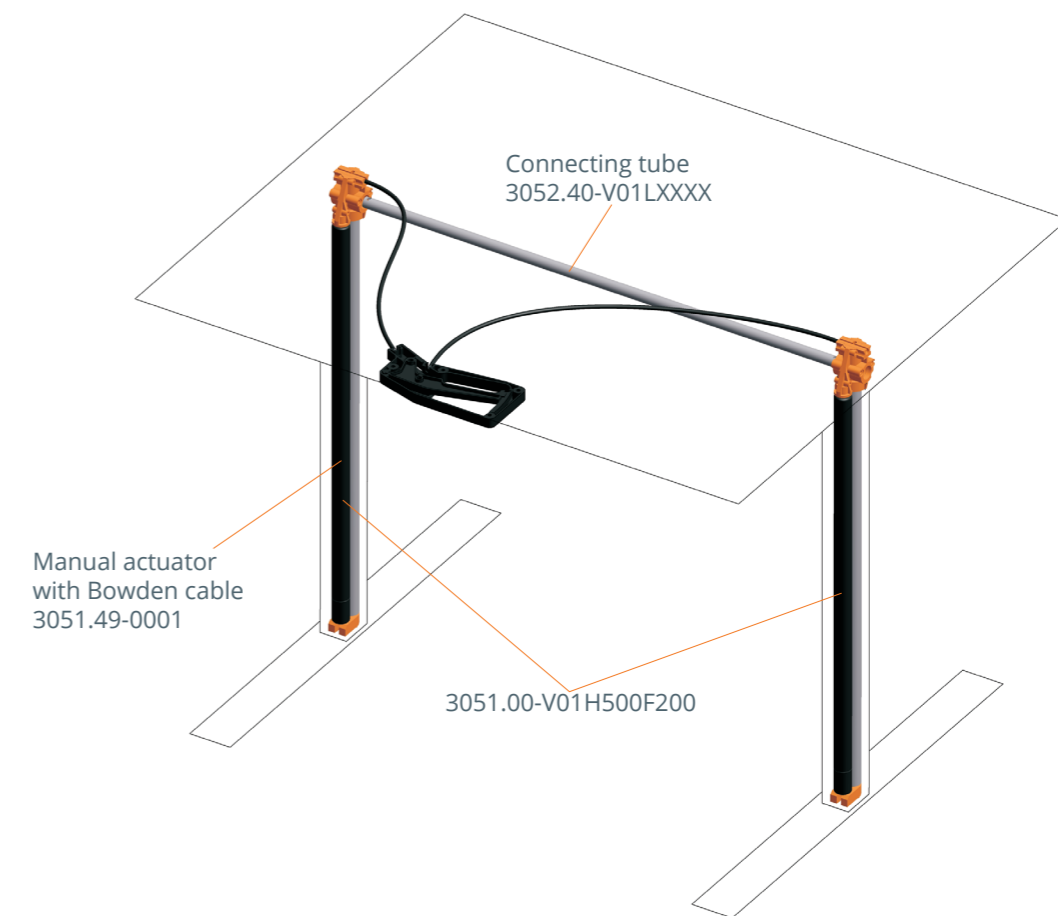
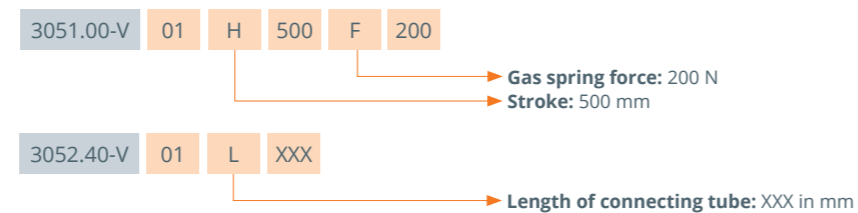

## Technical data

Stroke:	500 mm
Retracted length E:	643 mm
Recommended table load:	20 kg
Static self-locking:	120 kg
Ratio:	1:1
Gas spring force:	200 N/ Lifting unit

Gas spring spindle actuator	Lifting unit	Connecting tube (customer specific)	Manual actuator with Bowden cable
<b>Retracted length*</b>	643 mm	L <sub>1</sub> = a+4 L <sub>2</sub> = b+4	for tables 1200x800 mm to 1600x800 mm
<b>Item number</b>	3051.00-V01H500F200	3052.40-V01LXXX	3051.49-0001

## Technical notes

- Optimum user comfort of the overall system can be only achieved by precise matching of the weight of the plate support, the table top and the guide columns as well as the friction loss of the guide. This coordination is necessary, because the characteristics of different table systems are always individual and must be taken into consideration in the system design.
- Lifting system components must be ordered separately.
- Upon request the lifting system can also be custom dimensioned, i.e. other lift and installation lengths are possible.
- **Safety instruction:** The gas spring develops large acceleration forces unless these are counteracted by a corresponding counter-weight designed into the table. The brakes must not be released unless there is an adequate counterweight to slow the movement

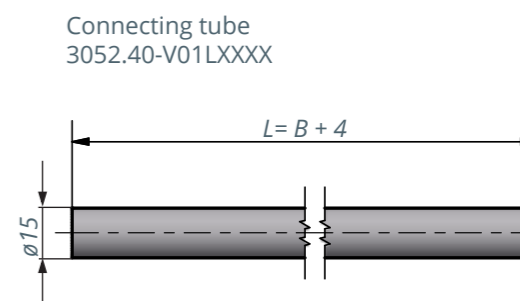
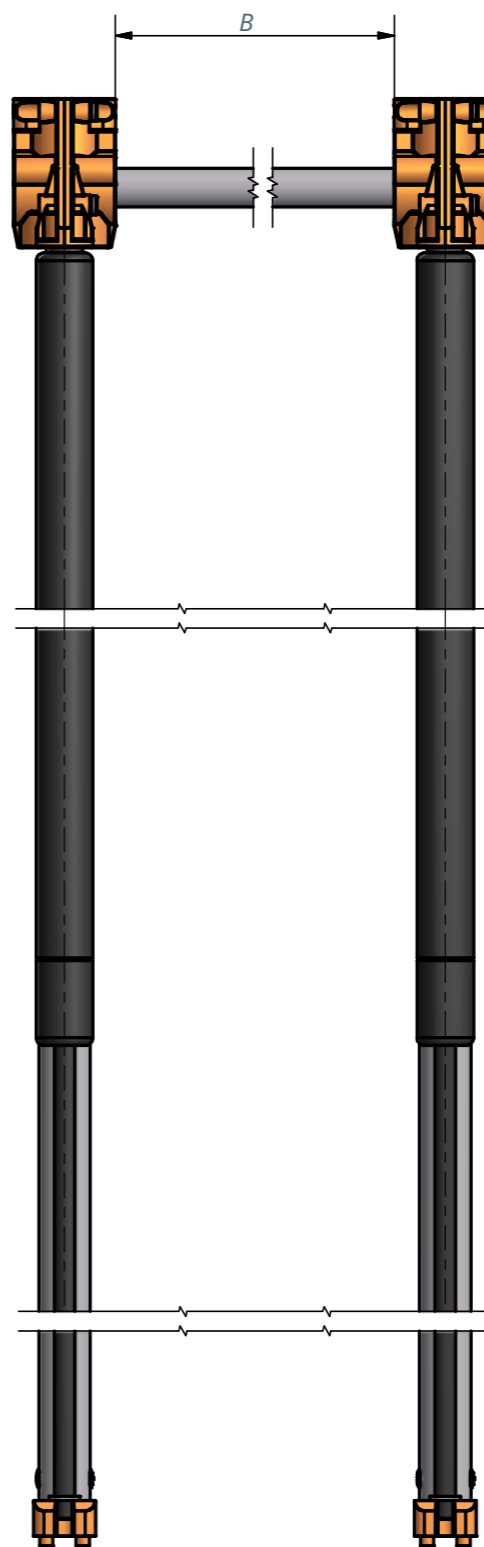
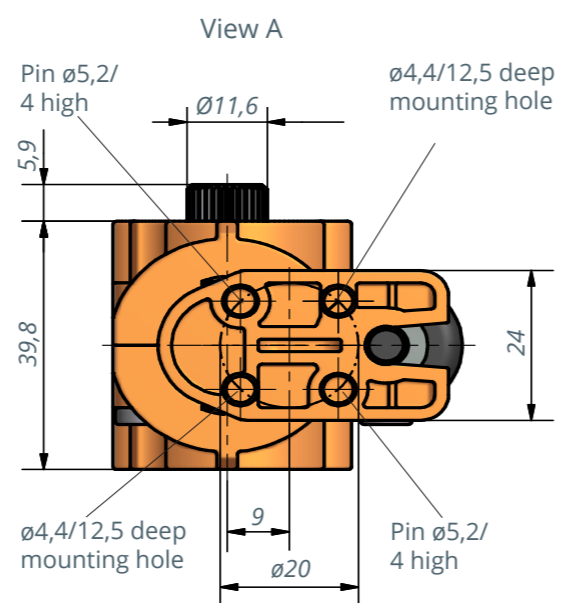
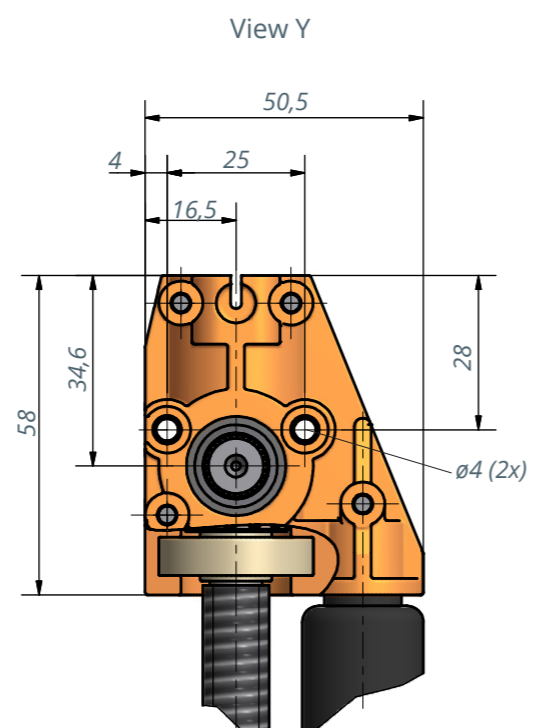
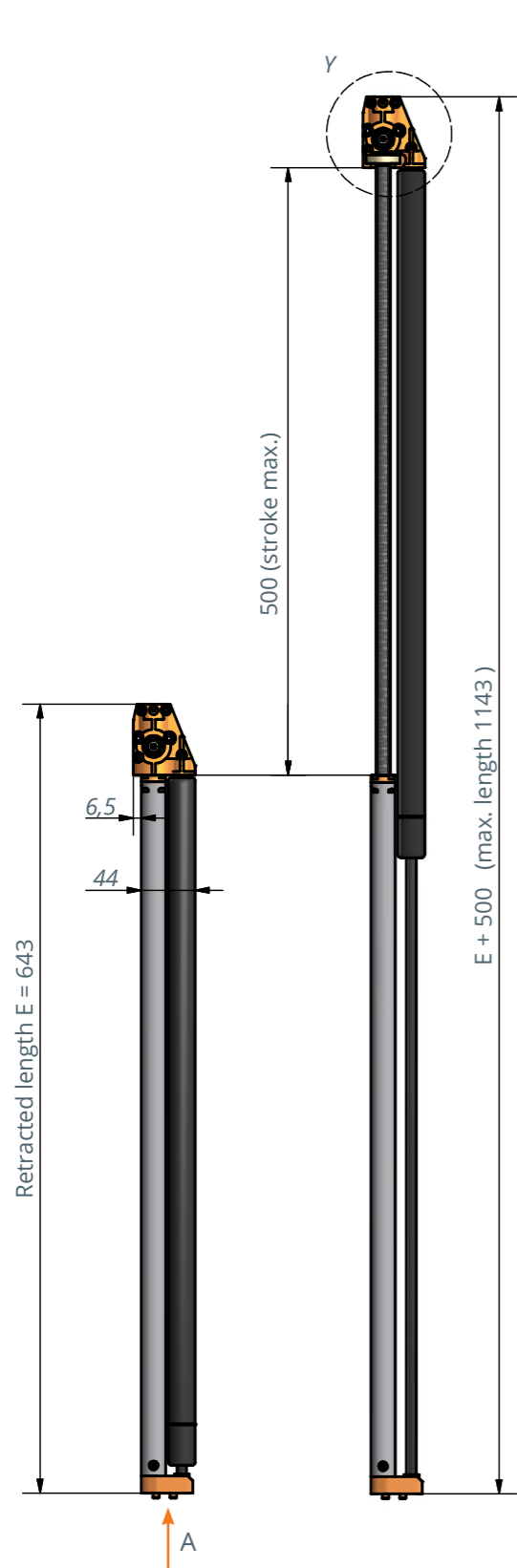

Manual actuator with Bowden cable  
3051.49-0001

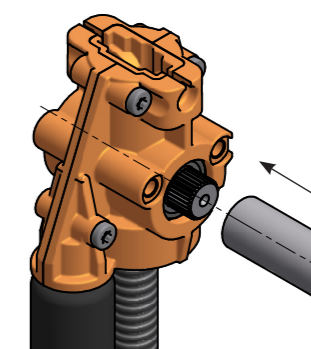

# Crank lifting system Ket-Twist 500 3052



## Description

Ket-Twist 500 is a fast crank lifting system for making custom adjustments to the working height of tables. The system allows a maximum stroke of 500 mm with a minimum clearance of only 625 mm. Each turn of the crank lifts the table 30 mm.

Ket-Twist 500 is ideal for 2-leg table frames with high efficiency guide tubes and handles smoothly and easily under loads of up to 40 kg.

## Special features

- Rapid adjustment:  
With 16.7 turns for maximum height change
- Customer specific:  
Flexible fabrication of connecting tubes
- Quick, easy assembly
- Independence from electrical connections:  
Free interior design options

## Variant key

3052.40-V	01	L	XXXX	→ Length of connecting tube: XXXX in mm
3052.40-V	02	A	XXX	
				→ Length of axis: XXX in mm

## Technical data

Stroke:	500 mm
Retracted length E:	625 mm
Recommended table load:	0 – 40 kg
Static self-locking:	≤ 120 kg
Adjustment path per revolution:	30 mm
Spindle pitch:	30 mm
Ratio:	1:1
Gas spring force:	200 N/ Lifting unit

Crank lifting system	Lifting unit	Connecting tube (customer specific)	Defelction gear with brake unit (customer specific)
<b>Retracted length</b>	625 mm	customer specific	customer specific
<b>Item number</b>	3052.00-0002	3052.40-V01LXXXX	3052.00-V02AXXX

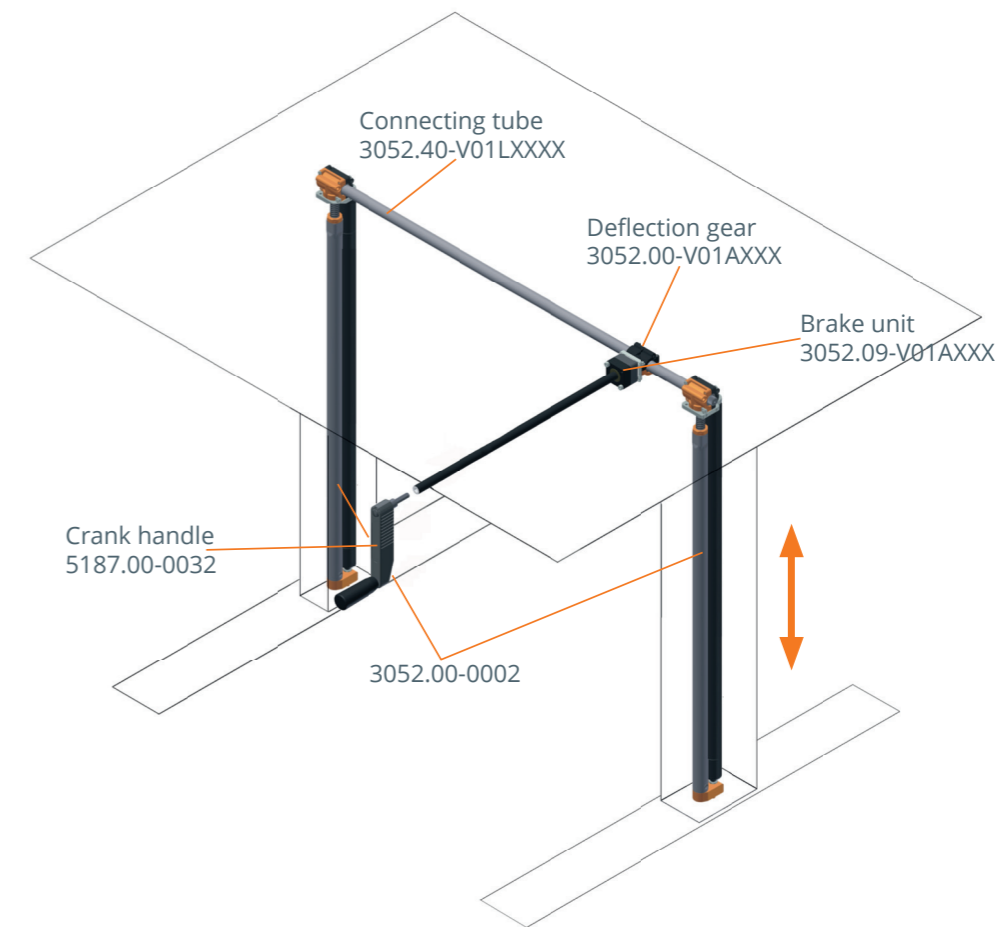

## Technical notes

- Optimum user comfort of the overall system can be only achieved by precise matching of the weight of the plate support, the table top and the guide columns as well as the friction loss of the guide. This coordination is necessary, because the characteristics of different table systems are always individual and must be taken into consideration in the system design.
- Lifting system components must be ordered separately.
- Upon request the lifting system can also be custom dimensioned, i.e. other lift and installation lengths are possible.
- Table manufacturer is responsible for integration of the gas spring assembly.
- **Safety instruction:**  
Gas springs can develop high acceleration forces. Please handle the assembly and this disassembly with care and diligence.

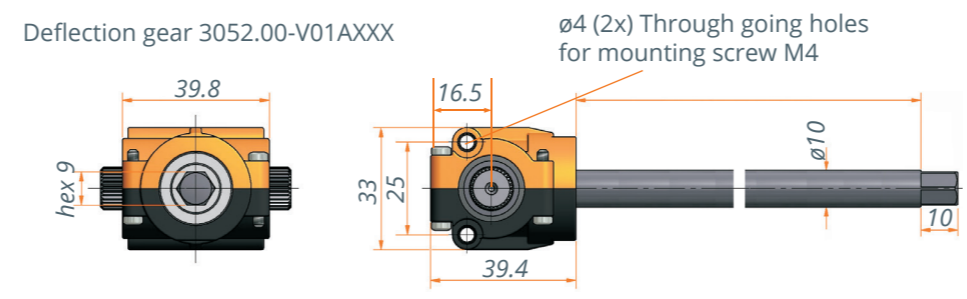
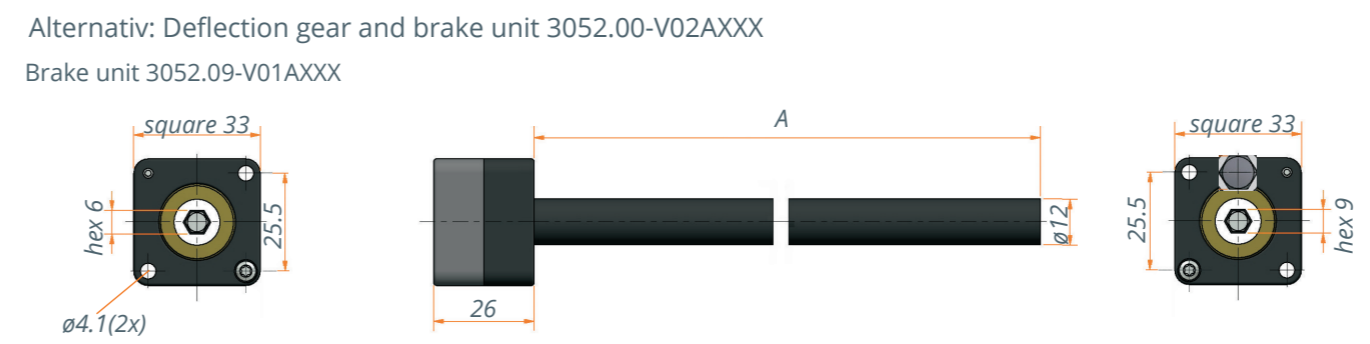
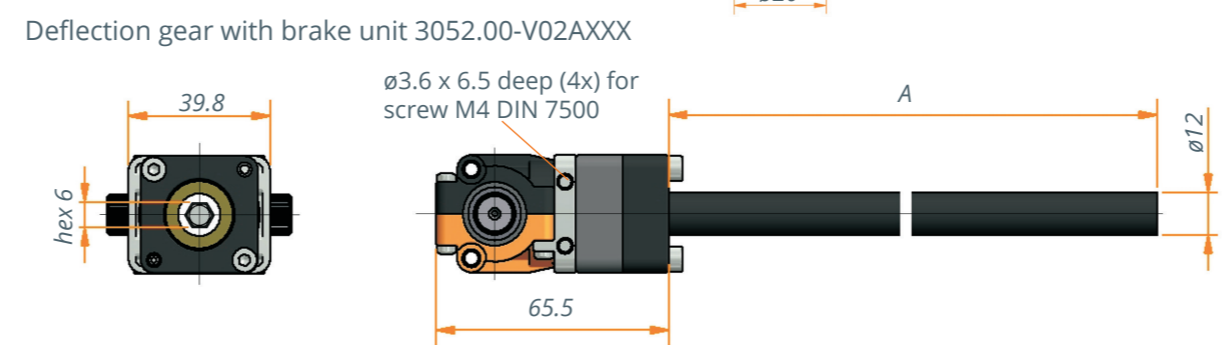
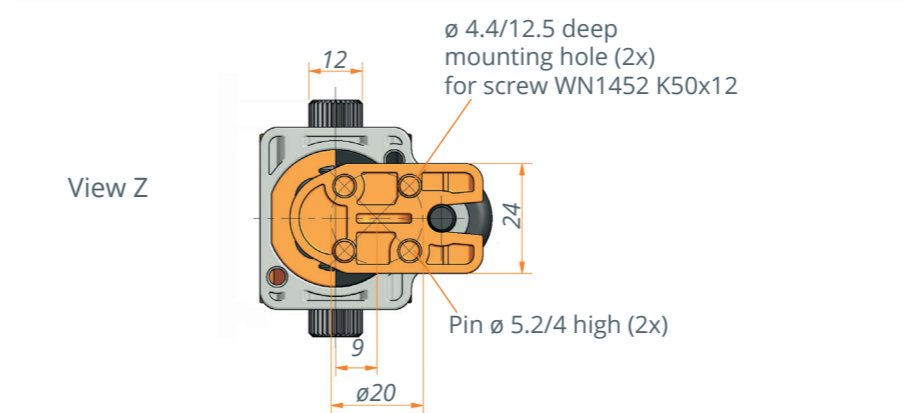
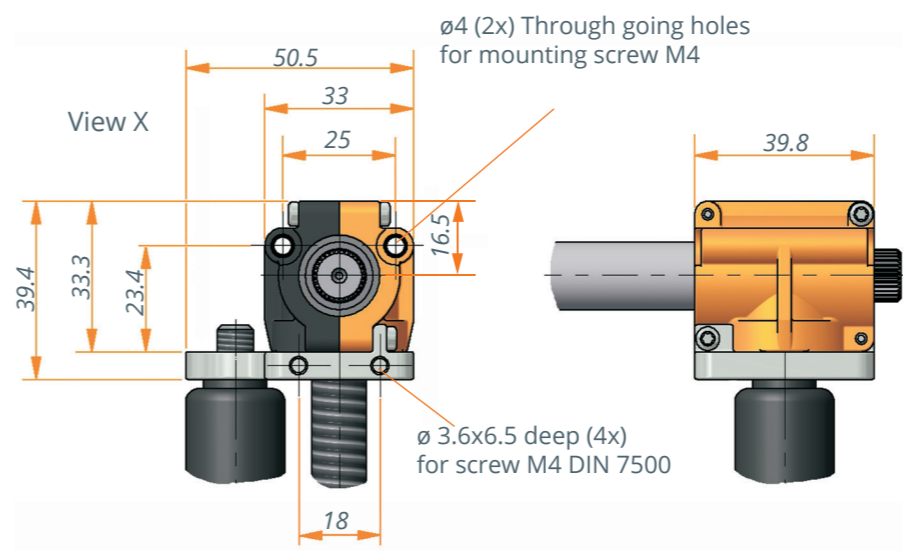
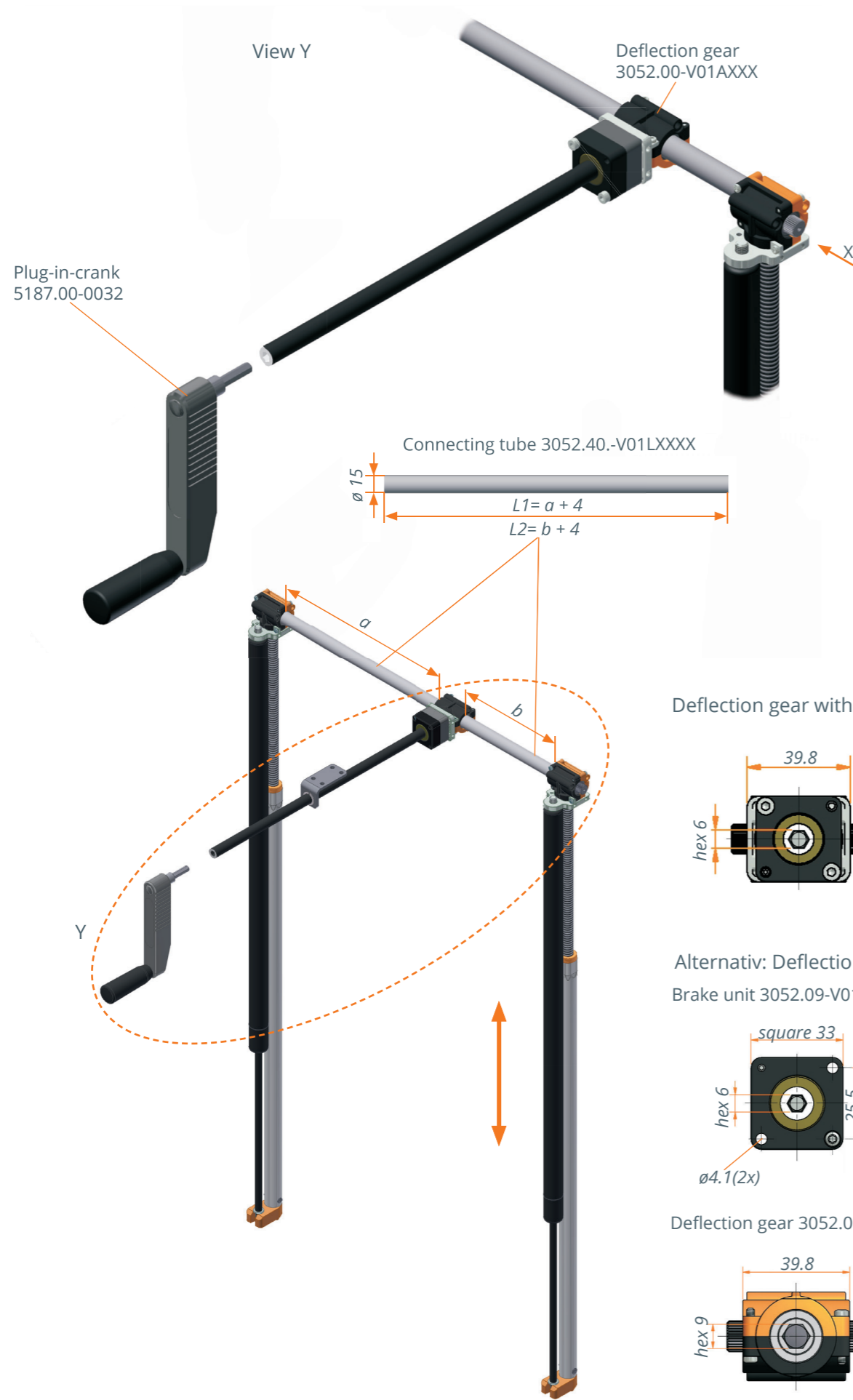

Lifting unit 3052.00-0002

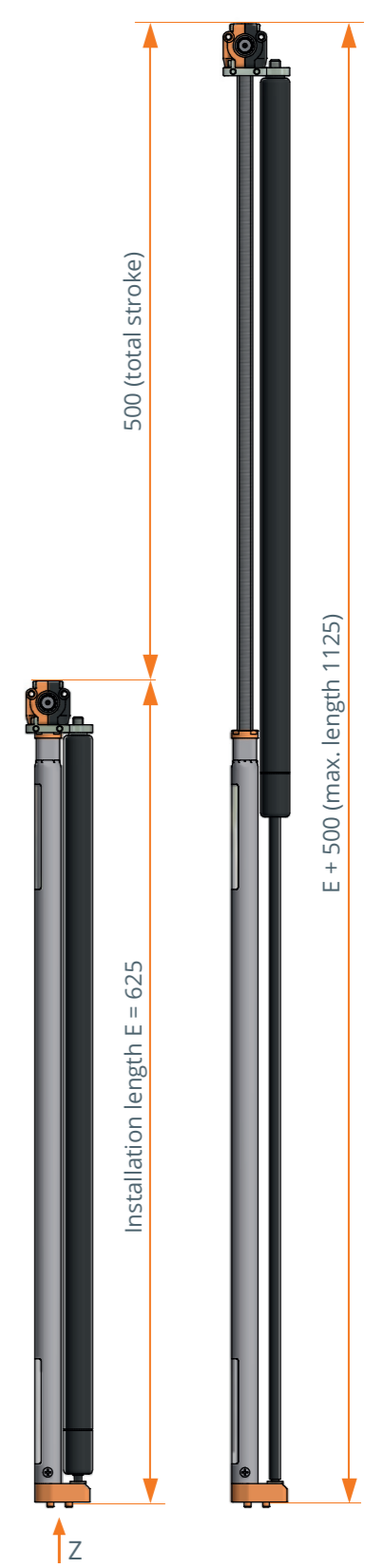

# Crank lifting system Ket-Twist 660 3053

Double telescopic



## Description

Ket-Twist is a fast, double-telescoping, crank-operated lifting system for individually adjusting the working height of tables. The system allows a maximum stroke of 660 mm, requiring a minimal installation length of just 575 mm. Each turn of the crank lifts the table top about 40 mm. Ket-Twist 660 is designed for 2-leg table frames, which have a minimum of friction loss. It works smoothly and easily even with table loads of up to 40 kg.

## Special features

- Compact design: Maximum stroke with minimal installation length
- Fast adjustment: Maximum height change with just 16.5 turns
- Connection tube in customized length
- Design fast and easy assembly
- Quick, easy assembly
- Independent of electrical connections: Flexibility in the room arrangement

## Variant key



## Technical data

Stroke:	660 mm*
Retracted length E:	575 mm*
Recommended table load:	0 – 40 kg
Static self-locking:	≤ 120 kg
Adjustment path per revolution:	40 mm
Spindle pitch:	2 x 20 mm
Ratio:	1:1
Gas spring force:	2 x 250 N/ Hubeinheit

Crank lifting system	Lifting unit	Gas spring assembly	Connecting tube (Customized)	Defelction gear with brake unit (Customized)
<b>Installation length*</b>	575 mm	560 mm	L <sub>1</sub> = a+4 L <sub>2</sub> = b+4	65.5 mm + XXX
<b>Item number</b>	3053.00-0001	3053.16-0001	3052.40-V01LXXXX	3052.00-V02AXXX

\* Other dimensiones can be manufactured on request

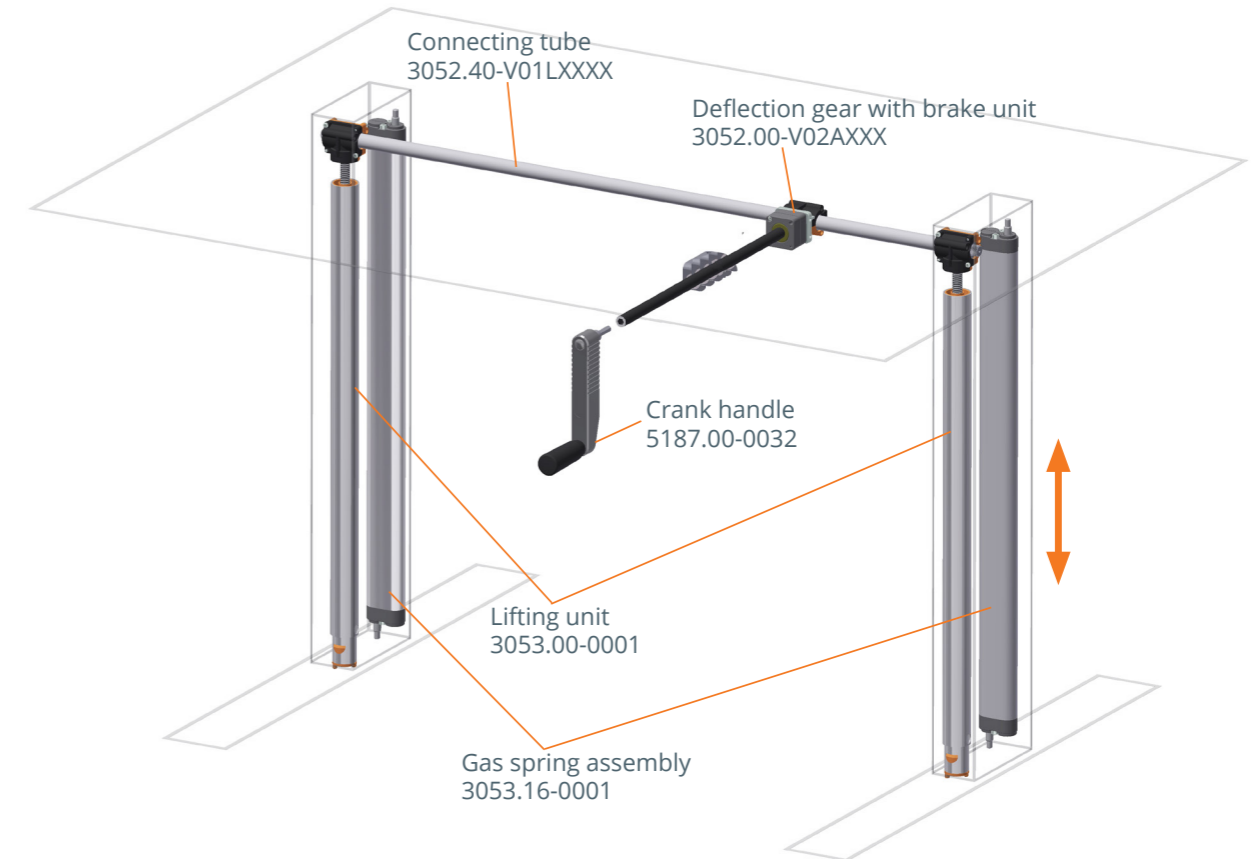

## Technical notes

- Optimum user comfort of the overall system can be only achieved by precise matching of the weight of the plate support, the table top and the guide columns as well as the friction loss of the guide. This coordination is necessary, because the characteristics of different table systems are always individual and must be taken into consideration in the system design.
- Ket-Twist components must be ordered separately.
- Upon request the lifting system can also be custom dimensioned, i.e. other lift and installation lengths are possible.
- Table manufacturer is responsible for integration of the gas spring assembly.
- **Safety instruction:** Gas springs can develop high acceleration forces. Please handle the assembly and this disassembly with care and diligence.

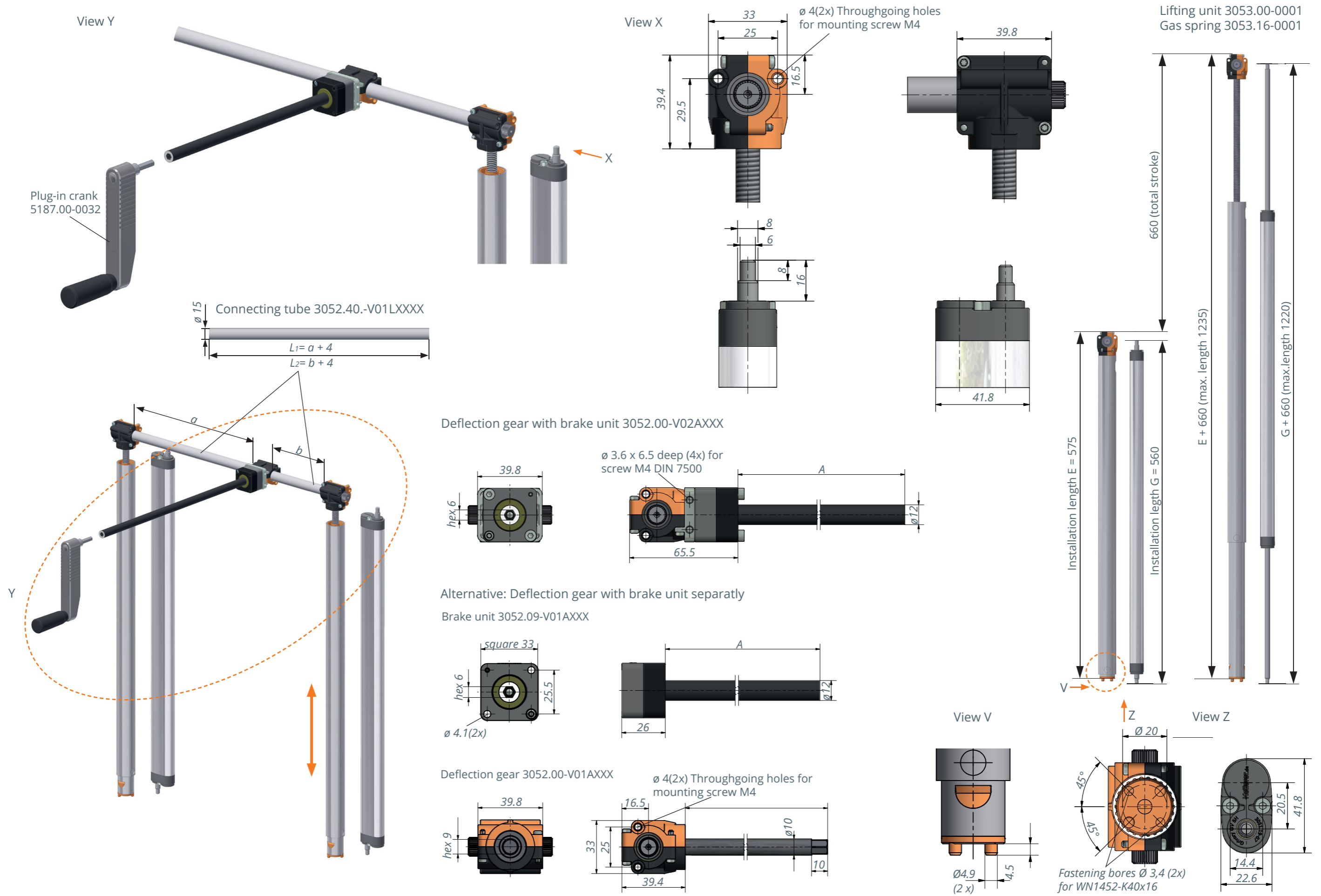

# Monitor / TV-Lift Ket-Screen Lift S 4701

## Description

Cost-efficient, compact lifting system for screens up to 24" and weights up to 25 kg.

## Special features

- High lifting speed
- Simple installation for different assembly situations
- Can be supplied with any stroke up to 750 mm
- Very low noise level allows applications in noise sensitive areas

## Variant key

4701.00- V 0X H XXXX

- ▶ **Stroke:** XXXX in mm
- ▶ **Design:** 0X
- 03:** Version „Standard“  
Fixing of the plate according to VESA
- 05:** Version „Short“  
Fixing of the plate according to VESA
- 07:** Version „Basic“  
Fixing on the runner



## Technical data

Ket-Screen Lift Small	Standard	Short	Basic
<b>Stroke</b>	customer specification max. 750 mm	customer specification max. 750 mm	customer specification max. 750 mm
<b>Retracted length</b>	Stroke+219 mm	Stroke+157 mm	Stroke+215 mm
<b>Maximum load</b>	250 N	250 N	250 N
<b>Maximum screen size</b>	24"	24"	24"
<b>Movement speed</b>	90 mm/s	90 mm/s	90 mm/s
<b>Item number</b>	4701.00-V03HXXXX	4701.00-V05HXXXX	4701.00-V07HXXXX

## Control box Compact-3

- controlled via manual switch
- connection for anti-pinch system
- Dimensions: 264 x 103 x 37 mm

Item: 1000.49-V94HXXXX

## Power cable

Item number: 3143.53-22

## Motor cable

- Connection motor/control box
- Length: 2 m

Item number: 4138.53-02

## RF remote control

- Consisting of, RF receiver, rem control (including battery) and manual



Item number: 3143.47-0001

## Optional

### Up/down Handset HSM-OD-2-LD

- Handset with up-down function



Item number: 3143.47-30

## Technical notes

- **Safety instructions**  
Please take attention to crushing points when installing in a housing.



Optional:  
**Additional mounting plate**

incl. screws for mounting of the push rods

Attention:  
The screws need to be secured with thread lock fluid!

Item number: 4701.35-0007

Optional:  
**Adjustment screw**

2 pieces incl. nut  
adjustment range:  
Standard/Basic - 19 mm  
Short - 75 mm

Item number: 4701.51-0001

Standard

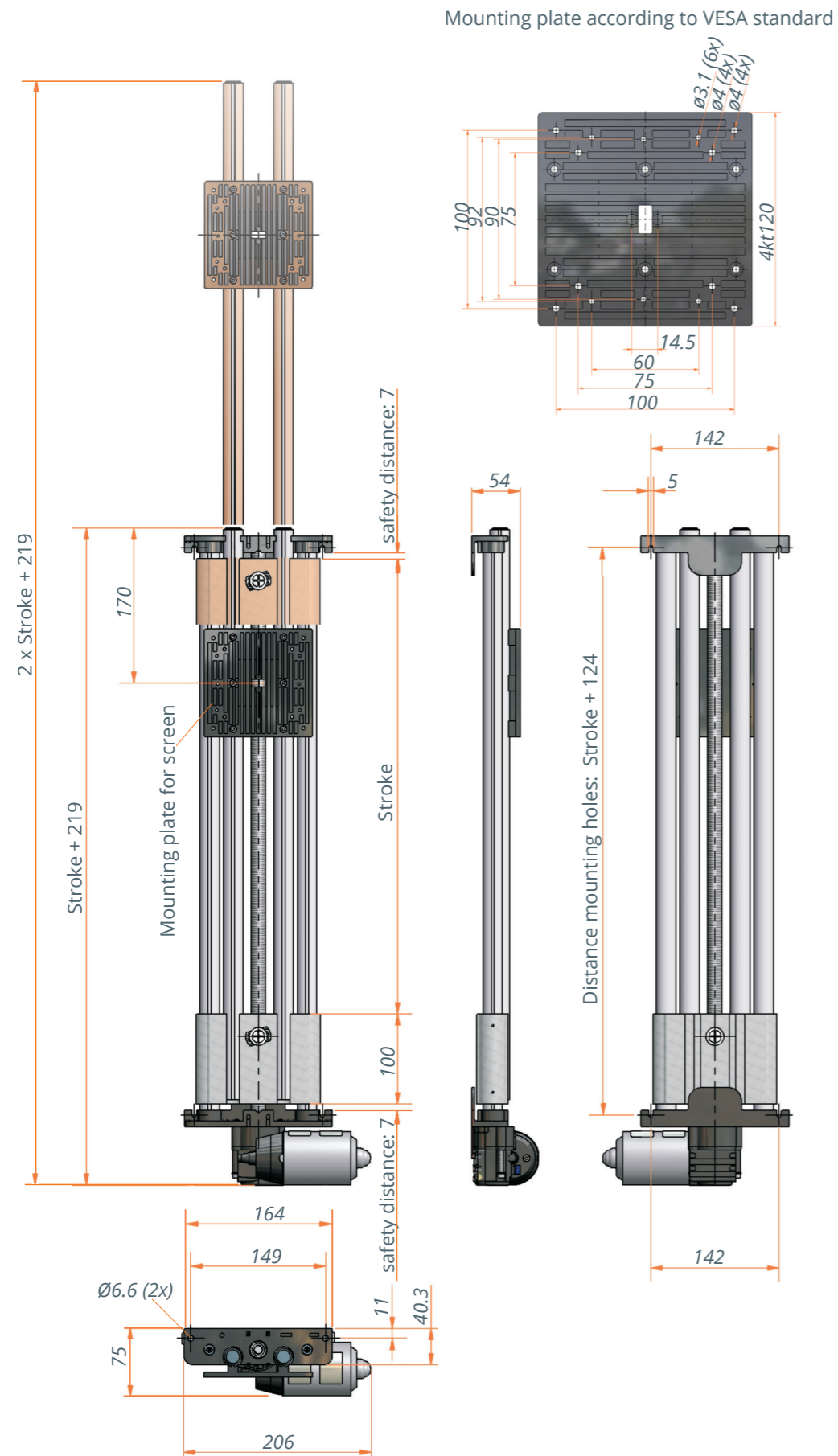

Short

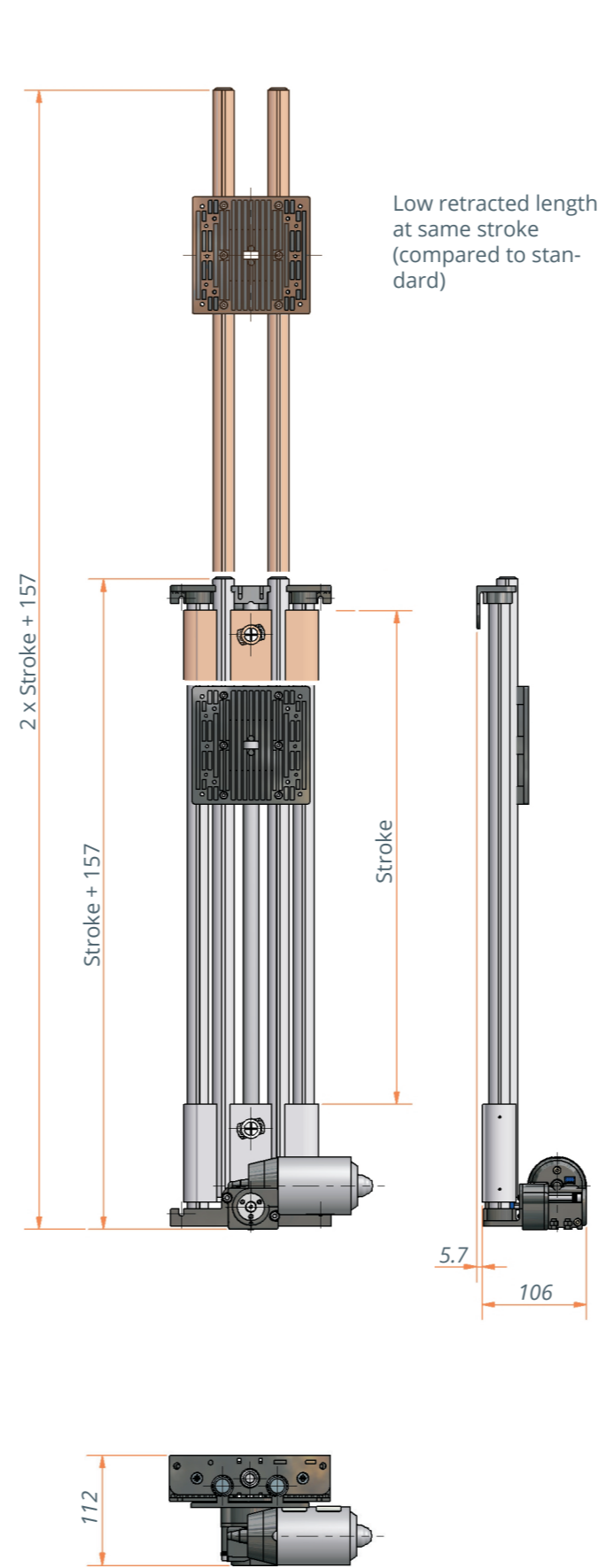

Basic

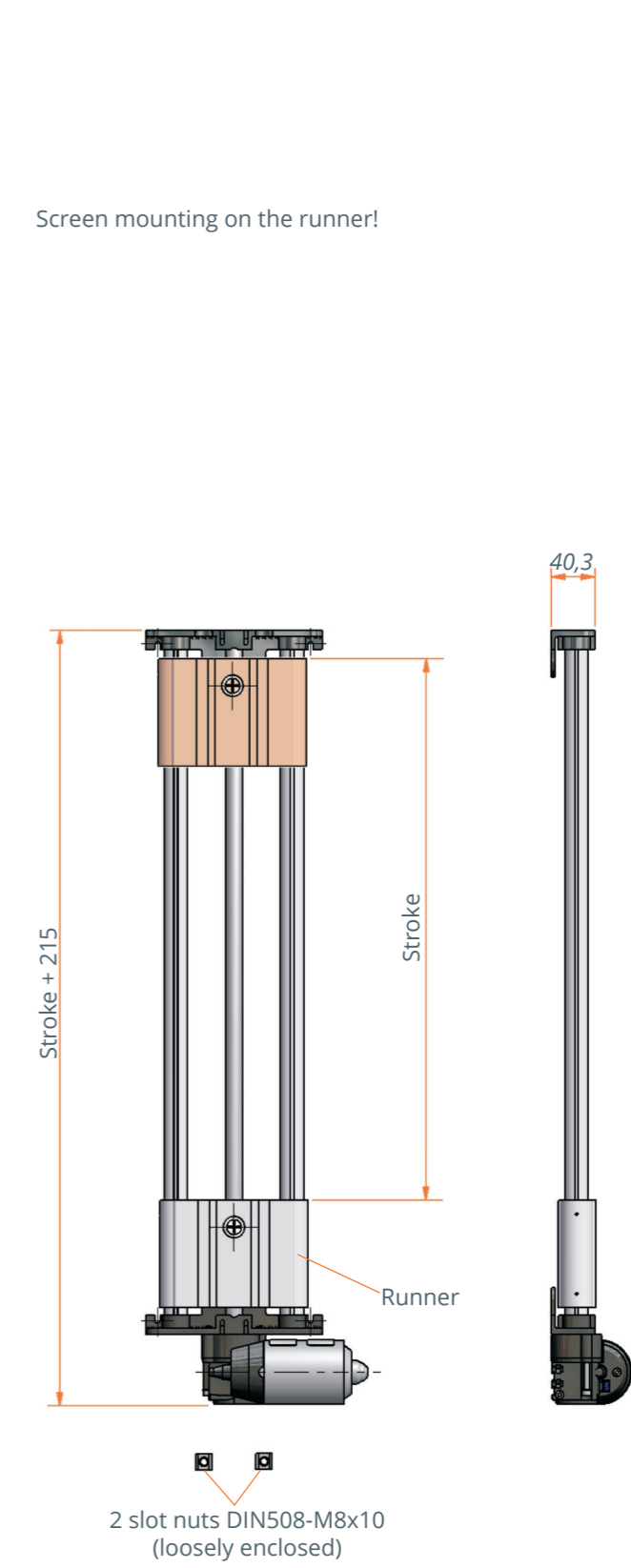

# Monitor / TV-Lift Ket-Screen Lift L 4701

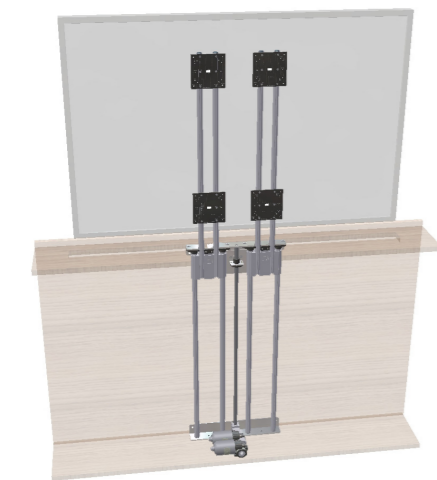

## Description

Cost-efficient, compact lifting system for screens up to 50" and weights up to 70 kg.

## Special features

- High lifting speed
- Simple installation for different assembly situations
- Can be supplied with any stroke up to 1100 mm
- Very low noise level allows applications in noise sensitive areas

## Variant key

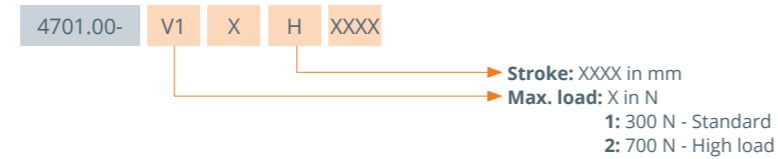

## Technical data

	<i>Ket-Screen Lift Large</i>	<i>Standard</i>	<i>High Load</i>
<b>Stroke</b>	customer specification max. 1100 mm	customer specification max. 1100 mm	customer specification max. 1100 mm
<b>Retracted length</b>	Stroke + 142 mm	Stroke + 142 mm	Stroke + 142 mm
<b>Maximum load</b>	300 N	700 N	
<b>Maximum screen size</b>	50"	50"	
<b>Movement speed</b>	90 mm/s	90 mm/s	
<b>Item number</b>	4701.00-V12HXXXX	4701.00-V11HXXXX	

## Control box Compact-3

- controlled via manual switch
- connection for anti-pinch system
- Dimensions: 264 x 103 x 37 mm

Item number: 1000.49-V94HXXXX

## Power cable

Item number: 3143.53-22

## Motor cable

- Connection motor/control box
- Length: 2 m

Item number: 4138.53-02

## RF remote control

- Consisting of, RF receiver, rem control (including battery) and manual



Item number: 3143.47-0001

## Optional

### Up/down Handset HSM-OD-2-LD

- Handset with up-down function



Item number: 3143.47-30

## Technical notes

- **Safety instructions**  
Please take attention to crushing points when installing in a housing



Optional:  
**Adjustment screw**  
2 pieces incl. nut  
adjustment range: max. 75 mm  
Item number: 4701.51-0001

Standard

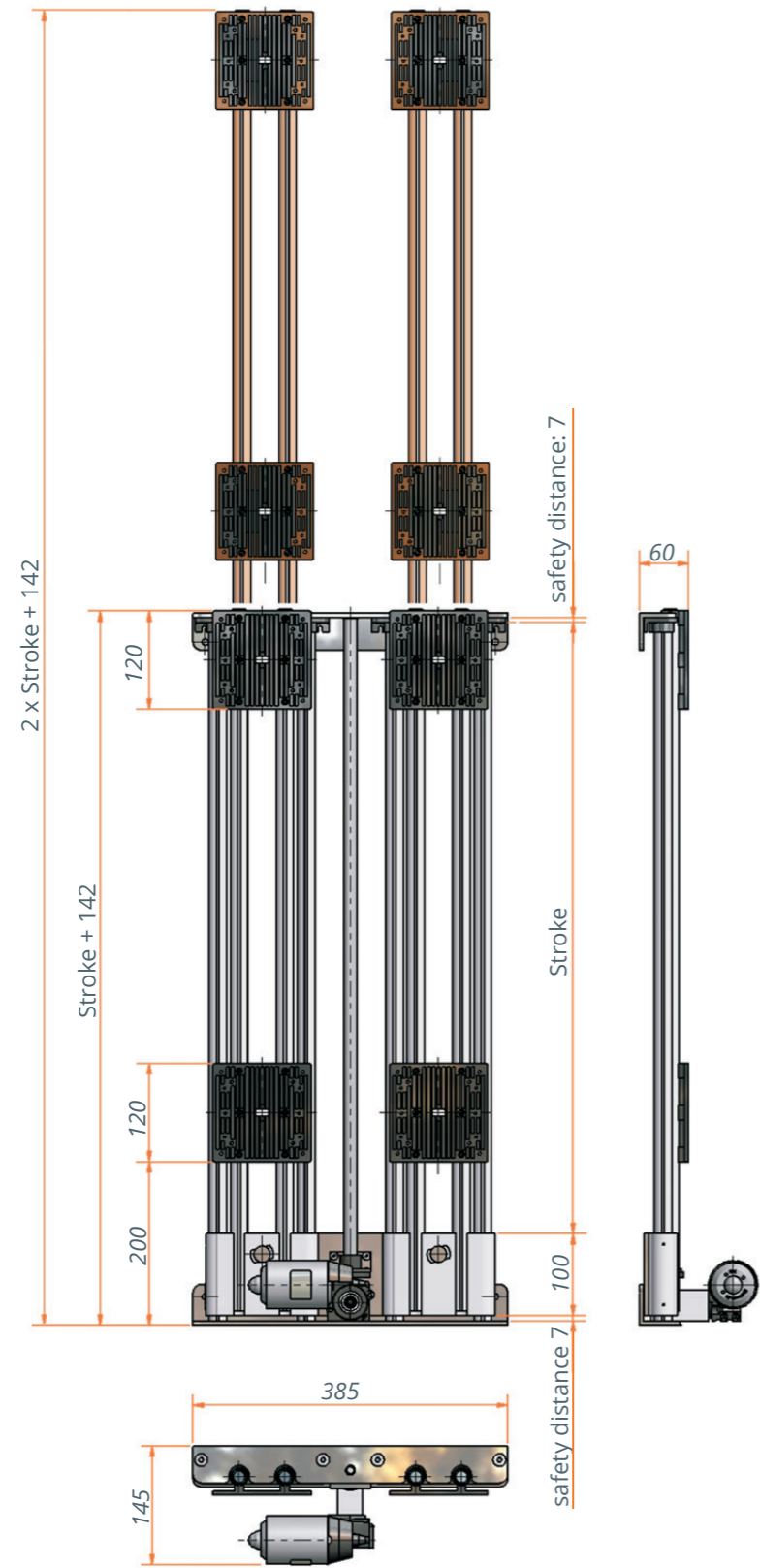

Mounting plate according to VESA Norm

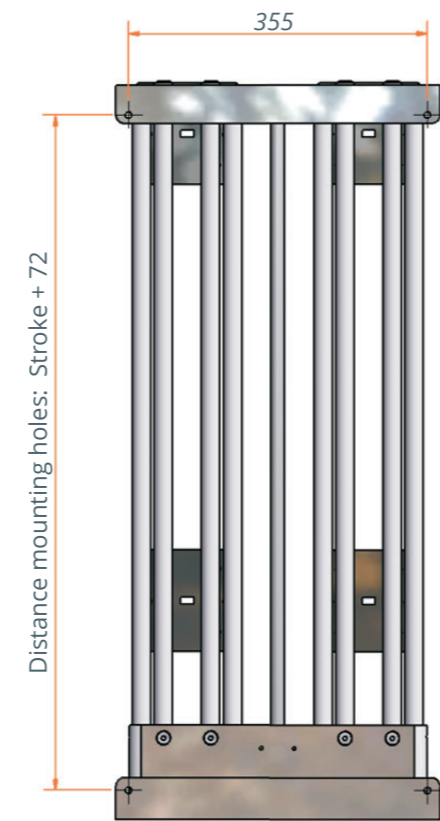
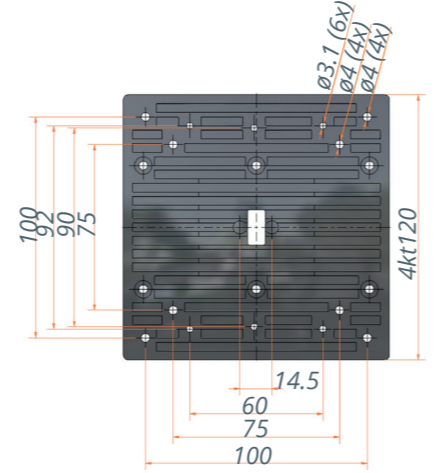

High Load

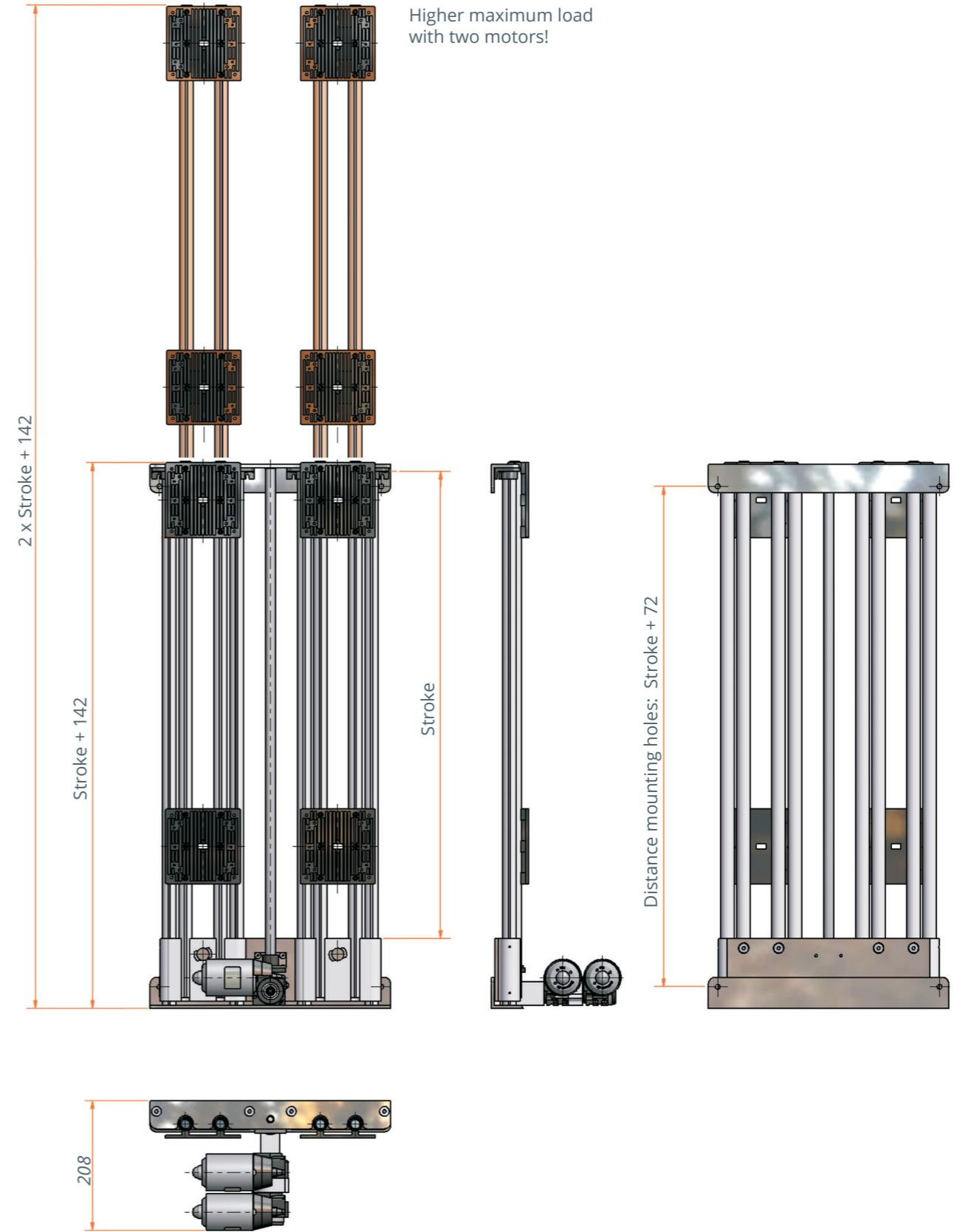

Higher maximum load with two motors!

Distance mounting holes: Stroke + 72

Distance mounting holes: Stroke + 72

# Monitor / TV-Lift Ket-Spring Lift S 4701

## Description

Compact lifting system for flat screens. Lifted by a gas spring without motor drive.

## Special features

- Smooth stop of the unit through a damped gas spring
- Very small unit, suitable for tight spaces
- Customer specific lengths and lifting forces can be realized with a minimum order quantity of 100 pieces

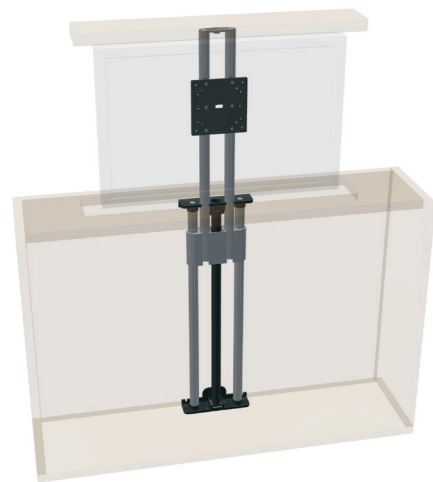

## Technical data

Ket-Screen Lift Small	S 426	S 479	Customized design from 100 pcs. upwards
<b>Stroke</b>	426 mm	479 mm	Customer specification
<b>Min. retracted length</b>	564 mm	617 mm	Stroke +138 mm
<b>Max. load for vertical installation</b>	45 N	80 N	Customer specification
<b>Recommended max. screen size</b>	24"	24"	24"
<b>Item number</b>	4701.00-2000	4701.00-2001	4701.00-2XXX

S 426

S 479

Mounting plate according to VESA standard

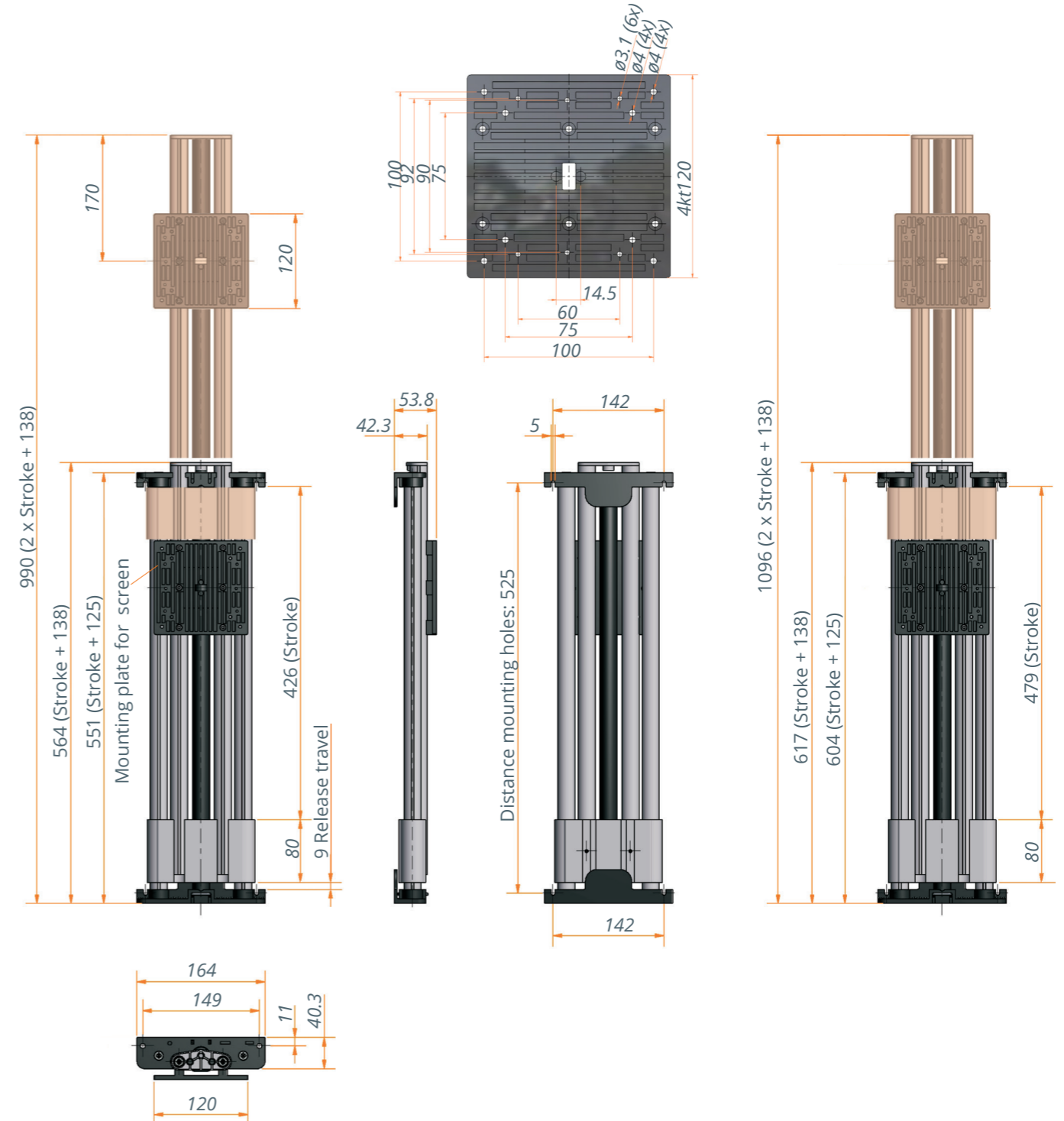

# Brake unit 3052.09

## Description

Very slim, compact brake unit for manually adjustable applications. Can be used flexibly, in combination with lifting gears.

## Special features

- Synthetic gear housing
- Simple mounting
- Input and output can be supplied in various lengths, based on customer requirements

## Variant key

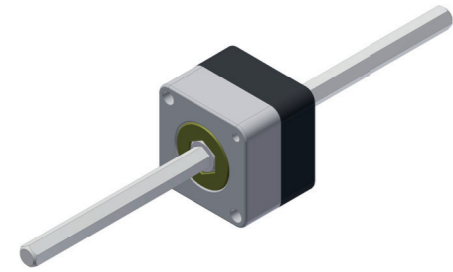
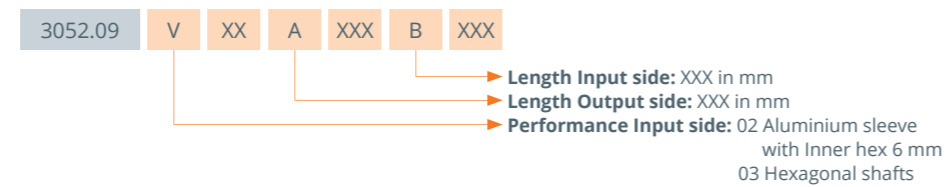

3052.09-V02AXXXBXXX

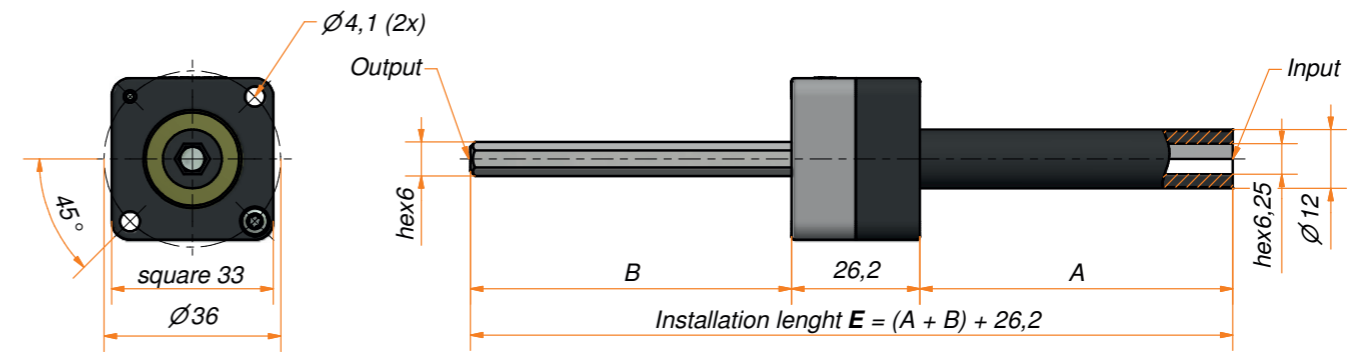

3052.09-V03AXXXBXXX

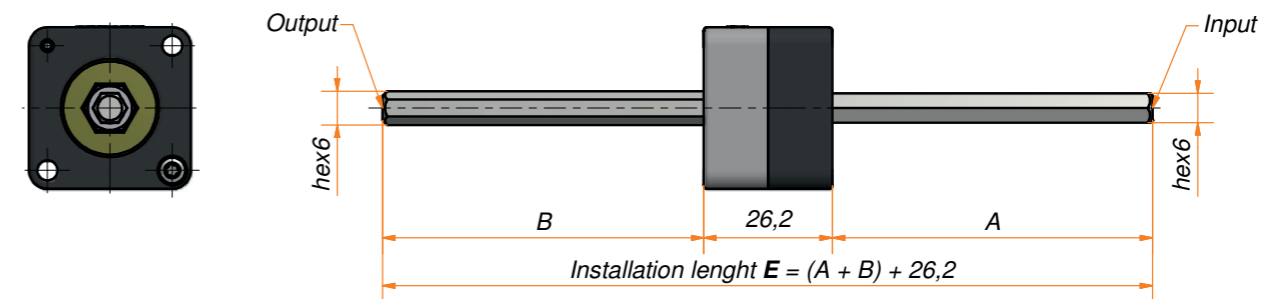

## Technical data

Model	3052.09-V02AXXXBXXX	3052.09-V03AXXXBXXX
<b>Input</b>	Inner hex 6 mm Length A customer specific	Hex 6 mm Length A customer specific
<b>Output</b>	Hex 6 mm Length B customer specific	Hex 6 mm Length B customer specific
<b>Max. holding torque</b>	10 Nm	10 Nm
<b>Max. output torque</b>	4 Nm	4 Nm
<b>Application</b>	Manual drives	Manual drives

# Crank handles 5102/5159

## Description

Wire-flexured cranks in several measurements with crank grips made of synthetic material.



## Special features

- Made of steel or stainless steel
- Customized production possible
- Customer specific solutions can be realized rapidly at a competitive price, by use of a production method which does not depend on specific tools or designs

## Crank-handles with grip 5101.11-01

Item-Number	A	B	D	E	b	Material
5108.00-00	100	Hex 9 mm	Ø10	62	15	Stainless steel
5104.00-00	110	Hex 9 mm	Ø10	60	15	Stainless steel
5109.00-00	110	Inner hex 6 mm	Ø10	60	12	Stainless steel
5102.00-00	110	Hex 9 mm	Ø10	42	16	Stainless steel

## Crank-handles with grip 5120.01-02

Item-Number	A	B	D	E	b	Material
5147.00-00	65	Hex 5 mm	Ø7	53	15	Stainless steel
5132.00-00	90	Hex 5 mm	Ø7	110	15	Stainless steel
5153.00-00	90	Hex 5 mm	Ø7	63	15	Stainless steel
5156.00-13	90	Hex 6 mm	Ø7	33	20	Steel
5187.00-0003	110	Inner hex 6 mm	Ø7	325	300	
5183.00-0000	90	Hex 6 mm	Ø7	200	20	Stainless steel
5156.00-0011	115	Inner hex 6 mm	Ø7/ Ø12	503	480	
5156.00-10	90	Hex 6 mm	Ø7	33	20	Steel
5156.00-00	90	Hex 6 mm	Ø7	33	20	Stainless steel
5159.00-00	90	Hex 6 mm	Ø7	60	20	Stainless steel
5157.00-00	90	Hex 6 mm	Ø7	85	20	Stainless steel
5163.00-00	90	Hex 6 mm	Ø7	116.5	20	Stainless steel
5165.00-00	105	Hex 6 mm	Ø7	85.5	12	Stainless steel
5158.00-00	150	Hex 6 mm	Ø7	33	20	Stainless steel
5133.00-00	90	Hex 7 mm	Ø8	62	15	Stainless steel

## Crank-handles oblique

Item-Number	A	B	D	E	b	Material
5121.00-00 (Angle = 10°)	134	Hex 6 mm	Hex 6 mm	64	64	Steel

Grip 5101.11-01

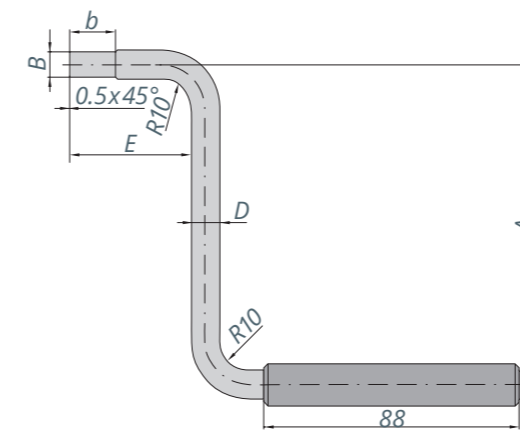

Grip 5120.01-02

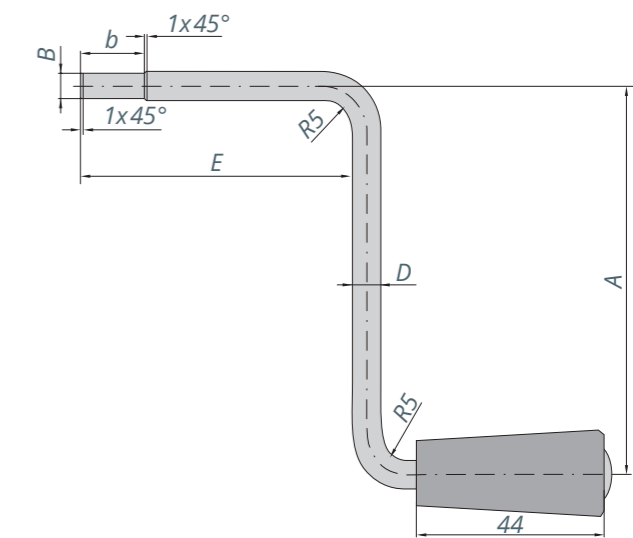

# Crank-handle 5180

## Description

Crank-handle grip and the crank extension are made of glass-fibre reinforced synthetic material.



## Special features

- Modern design
- On request, the type and length of the hexagonal bolt as well as the colour of the crank body can be produced to customer specification
- On request, an own logotype is possible

## Technical data

Model	5180 Standard	5180 Customer specific
Measure a	Hex 9 mm	On request
Measure b	60 mm	On request
Type of hexagonal bolt	Hardened/Blank	On request
Colour (crank body and grip)	Black	On request
Logotype	Without	Your logotype

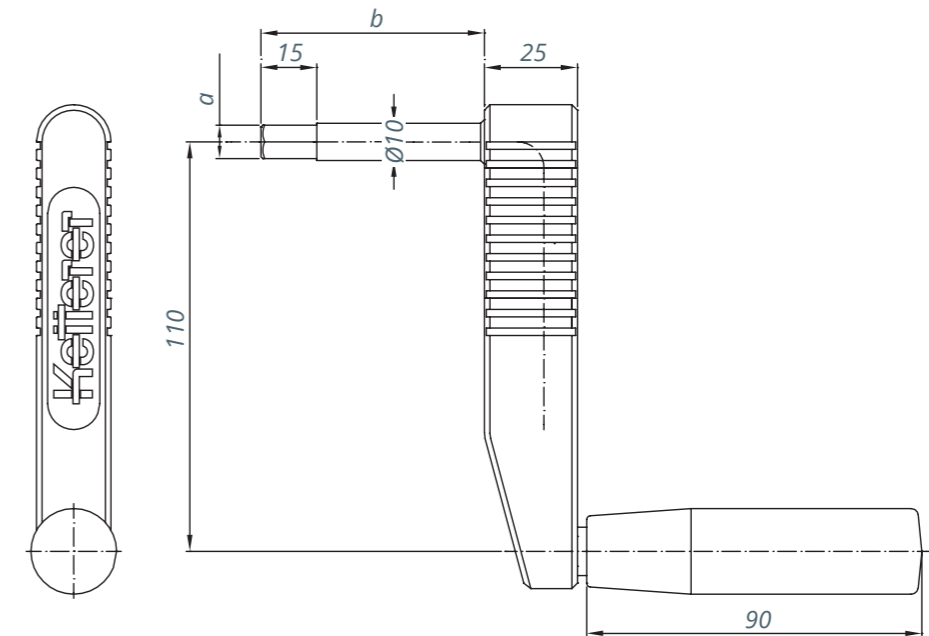

Application example

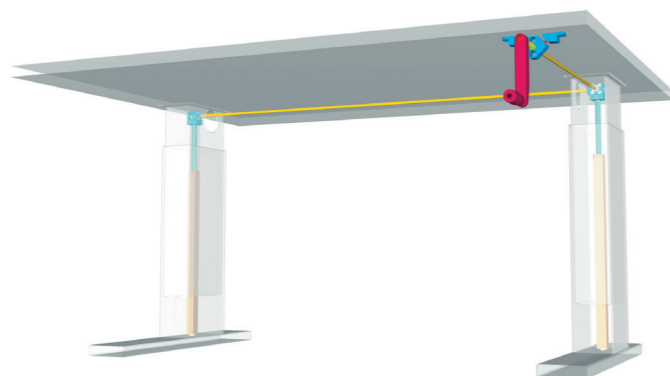

# Crank-handle 5186

## Description

Crank-handle grip and crank extension are made of glass-fibre reinforced synthetic material.

## Special features

- Modern design
- Can be folded by 90°.
- On request, the type and the length of the hexagonal bolt as well as the colour of the crank body can be produced to customer specifications
- On request, an own logotype is possible

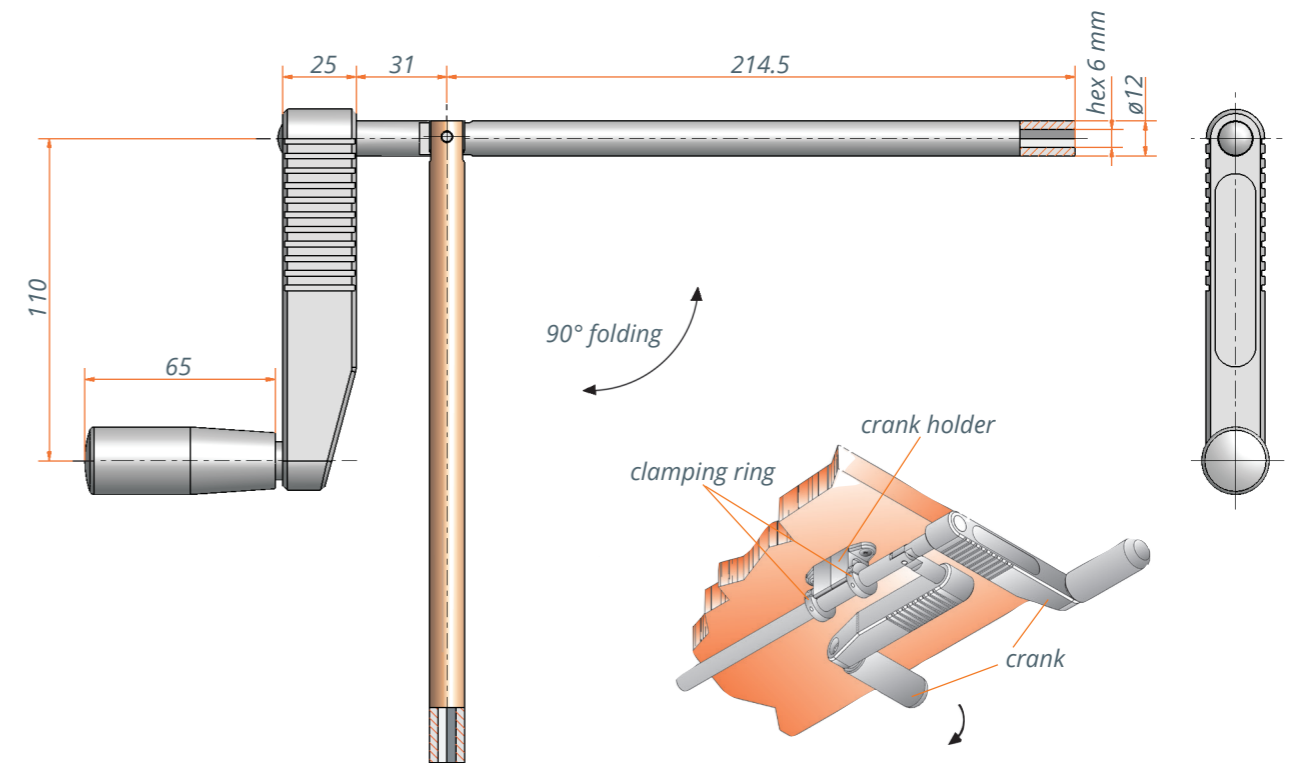

## Technical data

Model	5186
Crank extension	110 mm
Type of hexagonal bolt	Inner hex 6 mm
Dynamic torque	2 Nm

## Technical notes

- Crank holder, made of black synthetic material, for a 12 mm diameter crank shaft. The holder can be adjusted from a height of 12 mm up to 45 mm.
- Clamping ring, made of black synthetic material, for shaft with diameter 12 mm. You need 2 clamping rings to secure the crank shaft on the crank holder. The fixing nut is enclosed.

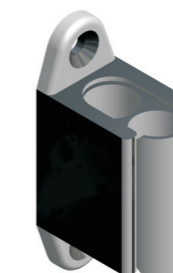
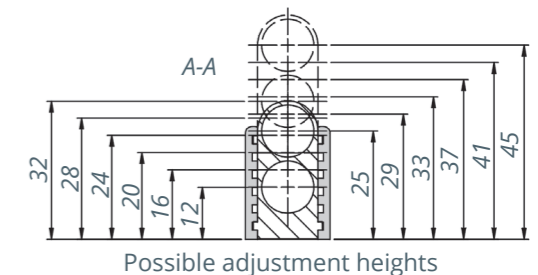

Crank holder  
Order number 5186.19-0000

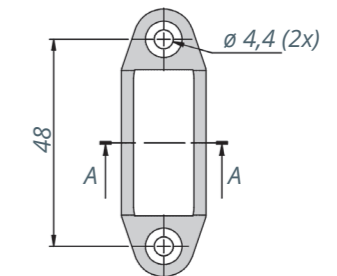

Clamping ring  
Order number 5186.10-0001

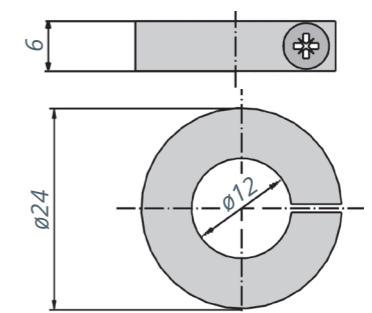

Application example

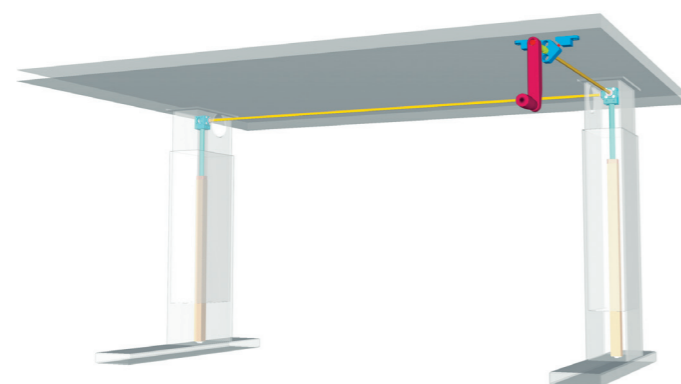

# Crank-handle 5187



## Description

Crank-handle grip and crank extension are made of glass-fibre reinforced synthetic material.

## Special features

- Modern design
- On request, the type and the length of the hexagonal bolt as well as the colour of the crank body can be produced to customer specifications
- On request, an own logotype is possible

## Variant key

5187.00 V XX A XXX

→ Length of crank extension: XXX in mm  
 → Type of profile tube: 01 Inner hex 6 mm  
 02 Inner hex 7 mm

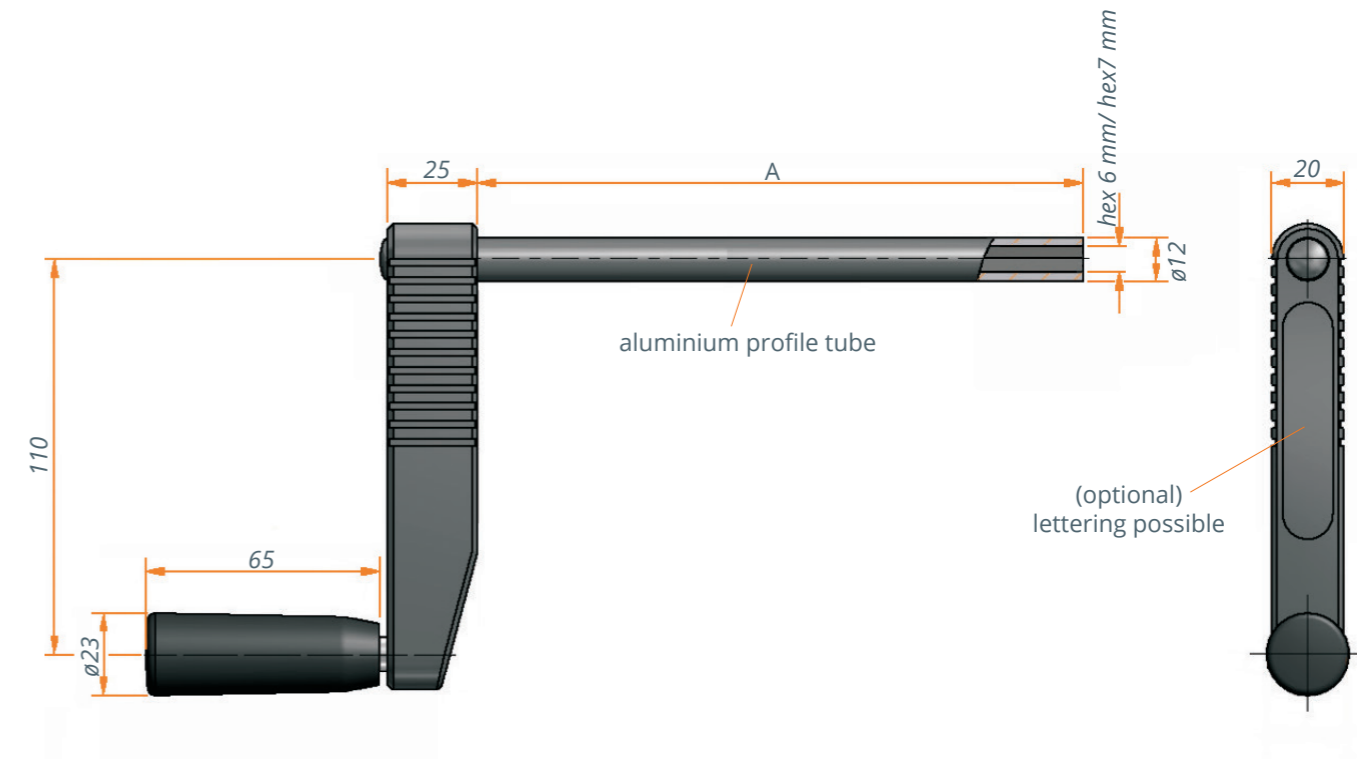

## Technical data

Model	5187.00-V01AXXX	5187.00-V02AXXX
<b>Crank extension</b>	Customer specific	Customer specific
<b>Type of profile tube</b>	Inner hex 6 mm	Inner hex 6 mm
<b>Material</b>	Synthetic crank body and handle	Synthetic crank body and handle
<b>Length A</b>	Customer specific	Customer specific
<b>Colour</b>	Black (more colours available on request)	Black (more colours available on request)

Application example

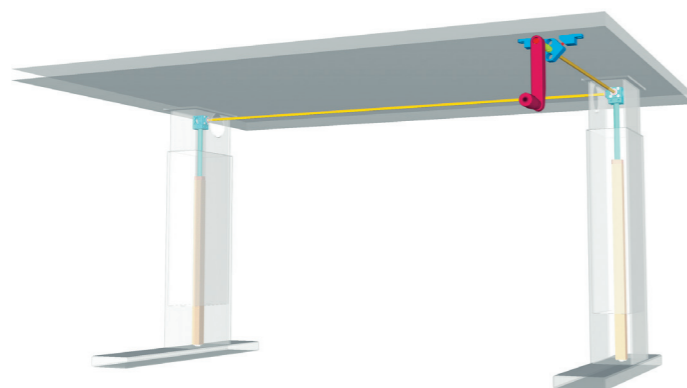

# Crank-handle 5190

## Description

Crank-handle grip and crank extension are made of glass-fibre reinforced synthetic material.

## Special features

- Modern design
- On request, the type and the length of the hexagonal bolt as well as the colour of the crank body can be produced to customer specifications

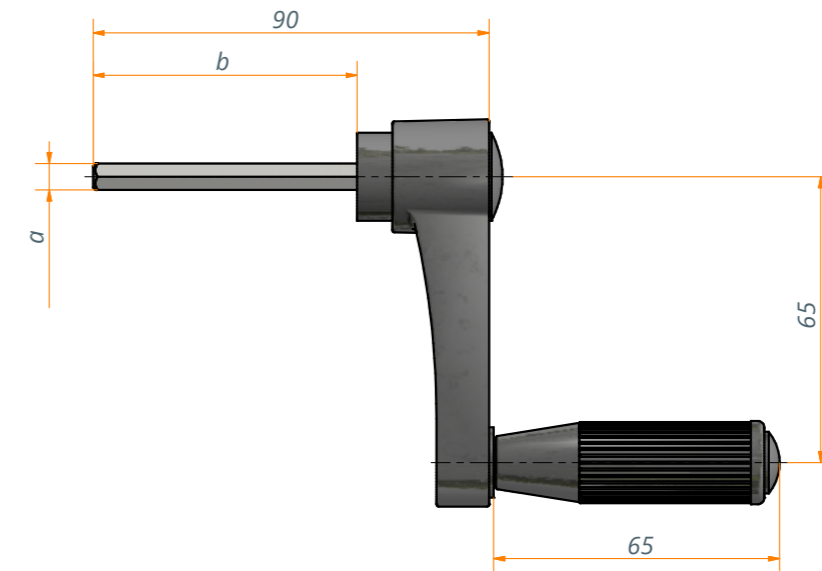

## Technical data

Model	5190.00-0000	5190 Customer specific
Measure a	Hex 6 mm	On request
Measure b	60 mm	On request
Type of hexagonal bolt	Alvanized	On request
Colour (Crank body and grip)	Black	On request

## Application example

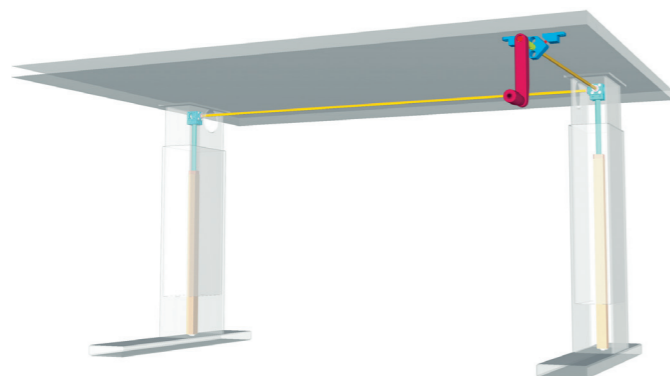

# Control box Compact



## Description

Compact is the control unit for high adjustable workstations and is matched to all Ketterer drives.

With one control unit can be controlled:

- up to three drives in parallel structure (one or two drives follow the master drive)
- two drives synchronously (drives are individually controlled)

## Special features

- Control box Compact<sup>eco</sup>, Firmware-Version 1.9
- Voltage supply variants: 230 V and 110 V
- Freely stroke with hand switch with display (HSU-MDF-4M2-LD or TOUCHfx) programmable
- Ketterer can preprogram a desired stroke
- Duty cycle 2 min. ON/ 18 min. OFF

## Technical data



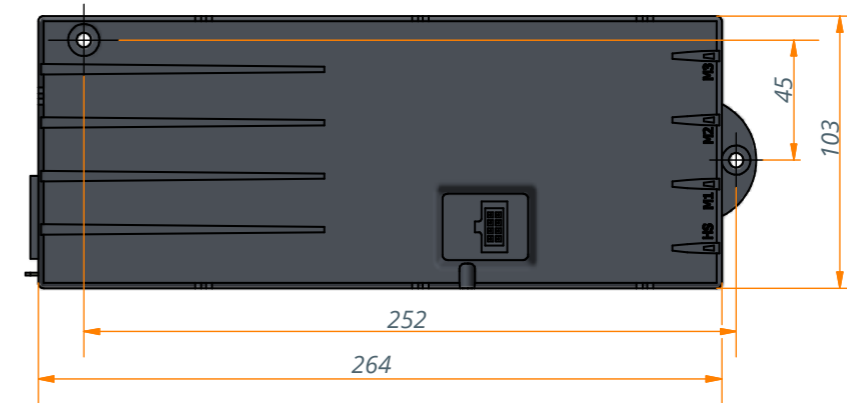

Control box	Description	Drives for use with
1000.49-36 / Compact-e-3-KTS-4778-EU	<b>one to three</b> motors <b>parallel</b>	(4778, 4779)**
1000.49-46 / Compact-e-3-KTS-4778-US	<b>one to three</b> motors <b>parallel</b>	
1000.49-37 / Compact-e-3-KTS-4779-EU	<b>one to three</b> motors <b>parallel</b>	
1000.49-47 / Compact-e-3-KTS-4779-US	<b>one to three</b> motors <b>parallel</b>	(3143, 4114, 4630, 4701, 4773) *
1000.49-01 / Compact-e-3-KTS-4630-EU	<b>one to three</b> motors <b>parallel</b>	
1000.49-02 / Compact-e-3-2-KTT-4630-EU	<b>two</b> motors <b>synchronous</b>	
1000.49-11 / Compact-e-3-KTS-4630-US	<b>one to three</b> motors <b>parallel</b>	4643 **
1000.49-12 / Compact-e-3-2-KTT-4630-US	<b>two</b> motors <b>synchronous</b>	
1000.49-03 / Compact-e-3-KTS-3130-EU	<b>one to three</b> motors <b>parallel</b>	(3120, 3121, 3130, 3131)**
1000.49-04 / Compact-e-3-2-KTT-3130-EU	<b>two</b> motors <b>synchronous</b>	
1000.49-13 / Compact-e-3-KTS-3130-US	<b>one to three</b> motors <b>parallel</b>	
1000.49-14 / Compact-e-3-2-KTT-3130-US	<b>two</b> motors <b>synchronous</b>	3122 **
1000.49-05 / Compact-e-3-KTS-3122-EU	<b>one to three</b> motors <b>parallel</b>	
1000.49-06 / Compact-e-3-2-KTT-3122-EU	<b>two</b> motors <b>synchronous</b>	
1000.49-15 / Compact-e-3-KTS-3122-US	<b>one to three</b> motors <b>parallel</b>	3133.00 **
1000.49-09 / Compact-e-3-KTS-3133.00-EU	<b>one to three</b> motors <b>parallel</b>	
1000.49-10 / Compact-e-3-2-KTT-3133.00-EU	<b>two</b> motors <b>synchronous</b>	
1000.49-19 / Compact-e-3-KTS-3133.00-US	<b>one to three</b> motors <b>parallel</b>	3133.48 **
1000.49-20 / Compact-e-3-2-KTT-3133.00-US	<b>two</b> motors <b>synchronous</b>	
1000.49-07 / Compact-e-3-KTS-3133.48-EU	<b>one to three</b> motors <b>parallel</b>	3133.48 **
1000.49-08 / Compact-e-3-2-KTT-3133.48-EU	<b>two</b> motors <b>synchronous</b>	
1000.49-17 / Compact-e-3-KTS-3133.48-US	<b>one to three</b> motors <b>parallel</b>	
1000.49-18 / Compact-e-3-2-KTT-3133.48-US	<b>two</b> motors <b>synchronous</b>	

\* Motor cable 4138.53-01/ Length 1 m or 4138.53-02/ Length 2 m

\*\* Motor cable 3122.53-02/ Length 1.75 m



further details under [www.logicdata.at](http://www.logicdata.at)

Power cable	Connector
<b>3143.53-22</b> / Power cable <b>LOG-CBL-PWK</b>	plug for control with 3-pin Schuko - Europe 
<b>3143.53-23</b> / Power cable <b>LOG-CBL-PWK-UK</b>	for control with 3-pin plug - UK 
<b>3143.53-24</b> / Power cable <b>LOG-CBL-PWK-DK</b>	for control with 3-pin plug - Denmark 
<b>3143.53-25</b> / Power cable <b>LOG-CBL-PWK-SW</b>	for control with 3-pin plug - Schweiz 
<b>3143.53-28</b> / Power cable <b>LOG-CBL-PWK-USA</b>	for control with 3-pin plug - USA 

## Technical notes

- Power cable has to be ordered separately.
- For stroke programming or changing on site a hand switch with display is always required (see hand control and motor cables).
- Please note the permissible duty cycle of the controller. If the operating times are exceeded the controller switches off automatically.
- Attention: Electric drives usually have a shorter duty cycle than controllers and are thus system-leading.

# Hand control and motor cables



## Description







Ketterer's range of accessories offers a large selection of hand switches in various designs, with or without display, with simple or touch buttons and various motor cables to suit the respective Ketterer drives.

## Special features

- Stepless adjustment
- User-defined and application-oriented control of your stepless adjustment
- Can be used with the Compact controller and all Ketterer motor drives

## Technical data

Motor cable	For use with drives
4138.53-01/ Length 1 m 4138.53-02/ Length 2 m	3143, 4114, 4630, 4701, 4773
3122.53-02/ Length 1,75 m	4643, 3120, 3121, 3131, 3122, 3133.00, 3133.48

Hand switch	Description
3143.47-05/ HSU-MDF-4M2-LD	Switch with display and four memory positions, stroke heights and two up-down buttons, free programmable 
3143.47-43/ TOUCH fx	Switch with display and four memory positions, with touch & click function 
3143.47-30/ HSM-OD-2-LD	Simple hand control, up-down 
3143.47-42/ TOUCH-basic-DN	Simple hand control up-down, with touch function 
3143.47-08/ IRR-DSK-SET-LIGHT	IR remote control consisting of, IR receiver, remote control (including battery) and manual 
3143.47-0001/ Receiver, remote control	RF remote control consisting of RF receiver, remote control (including battery), and manual 

\* Further details under <http://www.logicdata.at>

**Motor cable** 4138.53-01: 1 m long  
4138.53-02: 2 m long

AMP - Serie HE 14 plug allocation

A			B					
1	3	5	7	4	5	6	7	8
2	4	6	8	1	2	3	8	

Pin-No.	signal	colour	Pin-No.	signal	colour
6,8	motor blue	black, blue	4	motor blue	black, blue
5,7	motor red	brown, orange	8	motor red	brown, orange
2	+5VDC, reverb	red	2	+5VDC, reverb	red
4	GND, reverb	grey	3,7	reverb-signal 2	grey
3	reverb-signal 2	green	5	GND, reverb	green
1	reverb-signal 1	violet	1	reverb-signal 1	violet

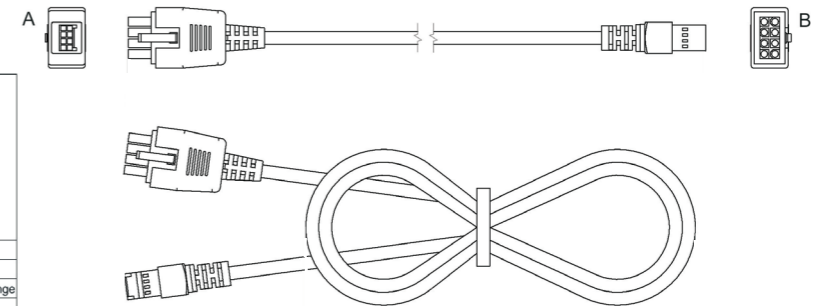

**Motor cable** 3122.53-02: 1.75 m long

AMP - 172160 plug allocation

A			B					
1	4	5	6	4	5	6	7	8
2	3	6	1	2	3	8		

Pin-No.	signal	colour	Pin-No.	signal	colour
1	motor blue	black, blue	4	motor blue	black, blue
2	motor red	brown, orange	8	motor red	brown, orange
3	+5VDC, reverb	red	2	+5VDC, reverb	red
4	reverb-signal 2	green	5	reverb-signal 2	green
5	GND, reverb	gray	3,7	GND, reverb	gray
6	reverb-signal 1	violet	1	reverb-signal 1	violet

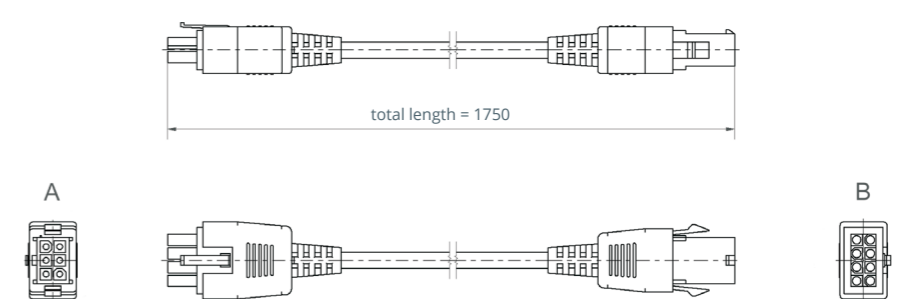

## Technical notes

- Hand switches with touch function require the Compact controller with firmware Version 1.9
- For stroke programming or changing the travel on site a hand switch with display is always required

# Profile tubes - Profile rods

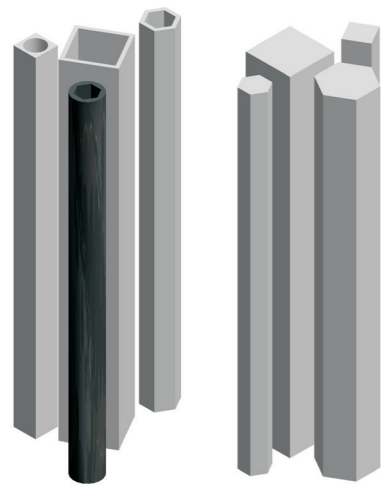

## Description

You get profile rods and profile tubes as rods in a length of 3 m.

## Special features

- Profile rods are made of steel and drawn according to DIN 176 (hexagon bars)
- Profile rods are made of steel and drawn according to DIN 178 (square bars)
- Profile tubes are made of steel and drawing to DIN 2391
- Further profile rods, profile tubes, special lengths and machining on request

## Profile tubes drawn according to DIN 2391

<i>Item number Steel version</i>	<i>Item number Brass version</i>	<i>Item number Aluminium black (anodised) Aluminium-tube DIN 17611 / quality E6</i>	<i>Outer dimension</i>	<i>Inner dimension</i>
209R0.08.0-6kt5	-	-	Ø8	hex 5 mm
209R0.09.0-6kt6-SL	-	-	Ø9	hex 6 mm
209R0.10.0-6kt6	-	-	Ø10	hex 6 mm
209R0.10.0-6kt7	-	-	Ø10	hex 7 mm
209R0.12.0-4kt7	203R0.12.0-4kt7	-	Ø12	square 7 mm
-	203R0.12.0-4kt8	-	Ø12	square 8 mm
209R0.12.0-6kt6	-	201R0.12.0-6kt6SL	Ø12	hex 6 mm
-	-	201R0.12.0-6kt7	Ø12	hex 7 mm
-	-	201R0.12.0-6kt8	Ø12	hex 8 mm
209R6.09.0-6kt6	-	-	hex 9 mm	hex 6 mm
209R6.12.0-6kt9	-	-	hex 12 mm	hex 9 mm

## Profile rods drawn according to DIN 176 (hexagon bars) and according to DIN 178 (square bars)

<i>Item number Steel version</i>	<i>Item number Brass version</i>	<i>Outer dimension</i>
209S4.06.0	203V4.06.0	square 6mm
209S6.05.0		hex 5 mm
209S6.06.0		hex 6 mm
209S6.07.0		hex 7 mm
209S6.08.0	203V6.08.0	hex 8 mm
209S6.09.0		hex 9 mm
209S6.12.0	203V6.12.0	hex 12 mm

B. Ketterer Söhne GmbH & Co. KG  
Bahnhofstrasse 20  
78120 Furtwangen  
Germany

Phone: +49 7723 9323-0  
Mail: [info@ketterer.de](mailto:info@ketterer.de)  
Web: [www.ketterer.de](http://www.ketterer.de)

© Ketterer Drives, 05.06.2019