

Uniclass
L8412
Cl/SfB
71 (72) X

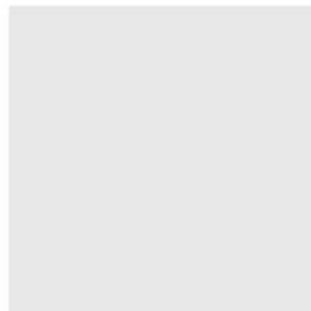

freedom

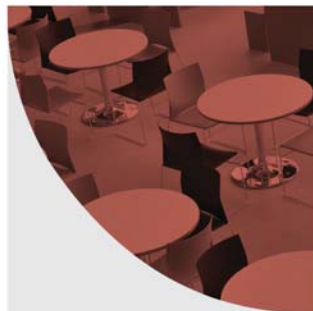
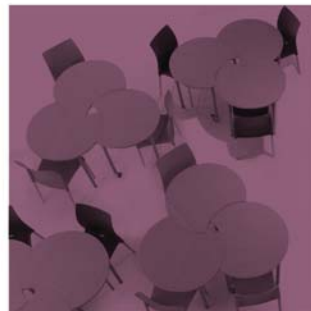
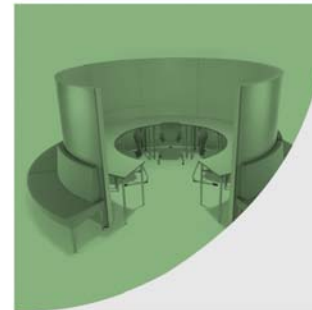
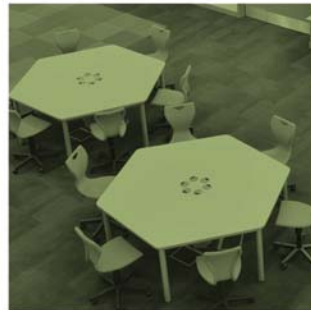

2012 January
product catalogue//

educational furniture and
equipment direct from the
UK manufacturer



“By good design we mean design that is fit for purpose, sustainable, efficient, coherent, flexible, responsive to context, good looking and a clear expression of the requirements of the brief”

Design review, Introduction – Paul Finch

height adjustable//

Fastlift	5-7
Round Central Column	5
Twin Column	6
Single Column	7
Vari-X	8-10
General Purpose Tables	8
Science & Design	9
Computer Workstations	10
Vari-H	11-12
Electric Computer Workstations	11
Electric Group Tables	12
Homecare	13-19
Leisure	13
Group Tables	14
Loose Tables	15-16
Catering (Stainless Steel)	17
Craft Benches & Bespoke Solutions	18
Science	19
Homecare 2	20-21
Design & Tables	20
Catering, Science & Art	21

dining//

Bench & Trumpet	22
Flipo	23

tables//

V-38 Table	24-27
Fun	28-29
V-50 Table	30-31
V-25 Stacking Table	32

ict workspaces//

Music & Saw Tooth	33
Tiered ICT	34
ICT Cluster	35
Daisy Chain ICT Desks	36
Relay Linear ICT Desk	37

seating//

Eduflex Seating	38-39
Sofi, Eduflex Stool & Activo Stool	40
Cool & Cube	41

storage & specialist areas//

Loose Storage	42-43
Locker, Pigeon Hole & Paper Storage	44
Library Shelving	45
Change	46
Make	47
Innovative Fitted Furniture	48-49
Wall Store	50-51

reconfigurable work areas//

Halo Group	52-55
Colours & Measurements	Back Cover

contents



Freedom Ability has established itself as a major provider of seating, desking, storage and specialist furniture to meet the “transformational working agenda”. In order to facilitate this many of the products are mobile, flexible and can be used for multiple activities.

The directors of Freedom Ability have over 40 years experience within the educational furniture marketplace but are also intimately involved in meeting the aspirations of the modern teaching environment through the consultancy service they offer within Halo Education Ltd which has worked on many 'Building Schools for the Future' and Academy programmes.

Freedom Ability supplies many of the leading schools in the UK including Thomas Telford School, Lord Mayor Treloar College, The National Star Centre, Walworth Academy, Lancashire BSF, Birmingham BSF, Tameside BSF and is also a supplier to Carillion Construction, Balfour Beatty Construction and Bovis Lend Lease Ltd.

Freedom Ability is a UK manufacturer supporting British jobs and local industry nationwide. The company practices lean manufacturing principles to offer our customers value for money and rapid delivery. The items within this catalogue have all been developed after listening to customers' needs therefore if you have a special requirement please do not hesitate to contact us.

Rapid adjustment. Minimum to maximum height in just 15 seconds with 580mm of adjustment.



Fastlift Round Tilting Top // Manual Mobile Table (Fast Screw Lift)

Dia:1200 H:550-1130	
Manual Silver frames	
Maple top:	FLSSRT-1200-LM-03
Beech top:	FLSSRT-1200-LM-02
Grey top:	FLSSRT-1200-LM-01

height adjustable//

fastlift range

round central column



The FASTLIFT range of tables adjusts from standing height to sitting height in seconds. This enables the user to be stood in a standing frame or sitting in a chair and also accommodates wheelchair access.

In order to achieve the fastest adjustment speeds available the adjustment is by way of a double acting fast helix screw, which takes just 15 seconds to travel from top to bottom and allows a precise adjustment.

For multi purpose areas the tilting top allows the units to be nested into one another, allowing you to open up a room for role play and other activities and the frame features four wheels allowing mobility within any room.



fastlift range

twin column

Rapid adjustment.
Minimum to maximum height in just 15 seconds with 580mm of adjustment.

Twin column allows unrestricted access.



Fastlift Table //
Fast Acting Double Screw

W:1200 D:600 H:520-1100
With castors; 2 braked, 2 unbraked
Manual Silver frames

Maple top: FLDS-1260-LM-03
Beech top: FLDS-1260-LM-02
Grey top: FLDS-1260-LM-01

Fastlift Table //
Fast Acting Double Screw

W:1500 D:750 H:520-1100
With castors; 2 braked, 2 unbraked
Manual Silver frames

Maple top: FLDS-1575-LM-03
Beech top: FLDS-1575-LM-02
Grey top: FLDS-1575-LM-01

Fastlift Table //
Fast Acting Double Screw Tilting Top

W:1200 D:600 H:620-1200
With castors; 2 braked, 2 unbraked
Manual Silver frames

Maple top: FLDST-1260-LM-03C
Beech top: FLDST-1260-LM-02C
Grey top: FLDST-1260-LM-01C

W:1500 D:750 H:620/1200
With castors; 2 braked, 2 unbraked
Manual Silver frames

Maple top: FLDST-1575-LM-03
Beech top: FLDST-1575-LM-02
Grey top: FLDST-1575-LM-01

fastlift range

single column

Convenient Storage

Altering the table's height allows them to be nested together when the room is being used for other activities. This makes them ideal in dining rooms or halls of residence.



Fastlift Table //
Fast Acting Double Screw

W:600 D:600 H:520-1100
With 2 castors and 2 feet;
Manual Silver frames

Maple top: FLSS-6060-LM-03
Beech top: FLSS-6060-LM-02
Grey top: FLSS-6060-LM-01

Fastlift Table //
Fast Acting Double Screw

W:1200 D:600 H:520-1100
With 2 castors and 2 feet;
Manual Silver frames

Maple top: FLSS-1260-LM-03
Beech top: FLSS-1260-LM-02
Grey top: FLSS-1260-LM-01



vari-x range

general purpose tables

Adjustment Range

The largest range of movement of any height adjustable table on the market with 805mm of adjustment.



Image shown with Silver frame and Maple top.

General Purpose Table //

W:1200 D:680 H:155-960
 With glides;
 Silver frame Maple top: 1200CT-03-G
 Silver frame Beech top: 1200CT-02-G
 Silver frame Grey top: 1200CT-01-G

W:1200 D:680 H:255-1060
 With castors; 2 braked, 2 unbraked
 Silver frame Maple top: 1200CT-03-C
 Silver frame Beech top: 1200CT-02-C
 Silver frame Grey top: 1200CT-01-C

This Vari-X range has the largest range of movement of any height adjustable table on the market. It is the only unit that can be used when lying on the floor, sitting or standing. It may be fitted with a variety of tops and surface accessories, making this system one of the most versatile available.

The Vari-X suite features a wide range of tables with many optional extras. Built to take an evenly distributed load of 40 kg, they are designed to be both extremely versatile and very durable.

This robust design has a simple mechanism designed for all to use. To adjust, simply wind the handle until the required height is achieved. The mechanism is self locking and the handle may be removed to make the unit tamper proof.

Vari-X tables are finished as standard with silver and chrome frames with a maple melamine MDF work surface (and will be supplied as such if no alternative finish code is specified).

Vari-X laboratory tables are finished as standard in silver and chrome frames with a plain grey Trespa Athlon surface (and will be supplied as such if no alternative finish code is specified).

Alternative bespoke frame and worktop finishes are available. Please enquire for further information.

Other work surface materials may be specified e.g Corian or Solid Timber with prices available on request.

vari-x range

science, design and vari-x options

Vari-X laboratory tables are fitted with Trespa Athlon work tops which are impervious to chemical attack. An anti-spillage recess is machined into the work surface to aid user protection.

The worktop of the Vari-X table, with two thirds tilting top, is adjusted via a ratchet mechanism.



Trespa Top Table //

W:1200 D:680 H:155-960
 With glides;
 Silver frame
 Grey Speckle top: 1200LB-08-G
 Silver frame
 Plain Grey top: 1200LB-09-G

W:1200 D:680 H:255-1060
 With castors; 2 braked, 2 unbraked
 Silver frame
 Grey Speckle top: 1200LB-08-C
 Silver frame
 Plain Grey top: 1200LB-09-C



Table with Two Thirds Tilting Top //

W:1200 D:680 H:155-960
 With glides;
 Silver frame Maple top: 1200DB-03-G
 Silver frame Beech top: 1200DB-02-G
 Silver frame Grey top: 1200DB-01-G

W:1200 D:680 H:255-1060
 With castors; 2 braked, 2 unbraked
 Silver frame Maple top: 1200DB-03-C
 Silver frame Beech top: 1200DB-02-C
 Silver frame Grey top: 1200DB-01-C



Handle Conversion //

This optional extra allows for a manual Vari-X unit to also be adjusted with the winding handle at the front right hand side of the unit

Suffix table code with: 1HCONV

vari-x range

manual computer workstations

Mobile I.T. Units

Utilising the successful Vari-X frame the mobile IT units are a popular choice. Available in three standard models with an optional tower hanger (however this does restrict the lower height adjustment), these mobile workstations are fitted as standard with castors; two of the four being fitted with brakes.

Finished with silver frames and three standard worktop finishes; Maple, Beech & Grey (see colour options on the back cover of this brochure).



Computer Trolley //
With Half Shelf

W:1200 D:680 H:255-1060
Silver frame

Maple top: 1200IWS-HS-03
Beech top: 1200IWS-HS-02
Grey top: 1200IWS-HS-01



Computer Trolley //
With Full Shelf

W:1200 D:680 H:255-1060
Silver frame

Maple top: 1200IWS-FS-03
Beech top: 1200IWS-FS-02
Grey top: 1200IWS-FS-01



Computer Trolley //
With Safety Rail

W:1200 D:680 H:255-1060
Silver frame

Maple top: 1200IWS-HR-03
Beech top: 1200IWS-HR-02
Grey top: 1200IWS-HR-01

Powered Height Adjustable Mobile IT Units

Built to the same robust standards as the manual model, the electrically powered units have an adjustment range of 780mm to 1130mm, and may be fitted with the same variety of tops and accessories.

To adjust simply press the button until the required height is achieved. However if the unit is to be used by people who require supervision we recommend that the handset is removed as an additional safety measure once the required height is achieved. Electrical units come complete with a cable remote switch.

Vari-H I.T. Units may be fitted with an optional hanging tower bracket, fitted to the left side for stability.

vari-h range

electric computer workstations



Electric Control //

Adjustment is via this detachable controller with two simple-to-use up and down buttons



Computer Trolley //
With Half Shelf (Electric)

W:1200 D:680 H:780-1130
Silver frame

Maple top: 1200IWS-HSE-03
Beech top: 1200IWS-HSE-02
Grey top: 1200IWS-HSE-01

Computer Trolley //
With Safety Rail (Electric)

W:1200 D:680 H:780-1130
Silver frame

Maple top: 1200IWS-HRE-03
Beech top: 1200IWS-HRE-02
Grey top: 1200IWS-HRE-01



Tower Hanger
(Optional) //

Fitted to the left hand side as standard.
Silver frame
Suffix table code with: VXTH

Computer Trolley //
With Full Shelf (Electric)

W:1200 D:680 H:780-1130
Silver frame

Maple top: 1200IWS-FSE-03
Beech top: 1200IWS-FSE-02
Grey top: 1200IWS-FSE-01

vari-h range

electric group tables



General Purpose Table // Electric

W:1200 D:680 H:680-1030
 With glides;
 Silver frames
 Maple top: 1200IWSE-03-G
 Beech top: 1200IWSE-02-G
 Grey top: 1200IWSE-01-G



Group Dining/Meeting Table // Electric with Glides

W:1500 D:750 H:680-1030
 With glides;
 Silver frames
 Maple top: 1500GE-03-G
 Beech top: 1500GE-02-G
 Grey top: 1500GE-01-G



Group Dining/Meeting Table // Electric with Castors

W:1500 D:750 H:780-1130
 With castors; 2 braked, 2 unbraked
 Silver frames
 Maple top: 1500GE-03-C
 Beech top: 1500GE-02-C
 Grey top: 1500GE-01-C

W:1200 D:680 H:780-1130
 With castors; 2 braked, 2 unbraked
 Silver frames
 Maple top: 1200IWSE-03-C
 Beech top: 1200IWSE-02-C
 Grey top: 1200IWSE-01-C

homecare

leisure

The Homecare frame can be fitted with various tops, including table tennis (not shown).



Height Adjustable Leisure // Snooker and Pool

W:1800 D:900 H:650-950
 Includes; Snooker balls, 2 cues, triangle and scoreboard.
 Manual
 Silver frames: HSNT-1800-900-64

Electric
 Silver frames: HSNT-1800-900-64E



Bespoke Table Football & Table Hockey models are also available. Please contact our sales team for more information.

homecare

group tables

The HOMECARE range of tables are designed to blend in with contemporary furniture design, creating a comfortable environment for users whilst still offering 300mm of height adjustment.

Homecare range

The Homecare leg system can be configured to work with most top sizes and shapes likely to be required, however if castors are required a sub frame may be necessary. All Homecare units have a height adjustment range of 300mm, which is normally sufficient to enable the table to be used by a seated child or a standing adult. All Homecare tables are finished as standard with silver frames and maple tops. Two alternate work tops are available in beech or grey.



Round Table Outer Legs //

W:1400 H:765-1065
With castors; 2 braked, 2 unbraked
Manual Silver frames
Maple top: HMT4C-1414-64-03
Beech top: HMT4C-1414-64-02
Grey top: HMT4C-1414-64-01

Electric:
Silver frames
Maple top: HMT4C-1414-64E-03
Beech top: HMT4C-1414-64E-02
Grey top: HMT4C-1414-64E-01



Dining/Meeting Table //

W:1500 D:1200 H:765-1065
With castors; 2 braked, 2 unbraked
Manual Silver frames
Maple top: HRMT4-1512-64-03
Beech top: HRMT4-1512-64-02
Grey top: HRMT4-1512-64-01

Electric:
Silver frames
Maple top: HRMT4-1512-64E-03
Beech top: HRMT4-1512-64E-02
Grey top: HRMT4-1512-64E-01



Teaching/Feeding Table //

W:1500 D:1200 H:640/940
Manual:
Manual Silver frames
Maple top: HHS4-1512-64-03
Beech top: HHS4-1512-64-02
Grey top: HHS4-1512-64-01

Electric:
Silver frames
Maple top: HHS4-1512-64E-03
Beech top: HHS4-1512-64E-02
Grey top: HHS4-1512-64E-01

homecare

loose tables

Electric Unit Controller

Homecare electric units feature a small control panel fitted to the front right hand side with 4 memory positions, up and down buttons along with a digital readout displaying the table's height during adjustment.

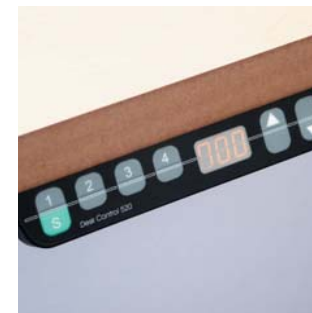

Square Table Small //
(Seats 1 person)

W:800 D:800 H:640-940
Manual:
Silver frames
Maple top: HRT4-0808-64-03
Beech top: HRT4-0808-64-02
Grey top: HRT4-0808-64-01

Electric:
Silver frames
Maple top: HRT4-0808-64E-03
Beech top: HRT4-0808-64E-02
Grey top: HRT4-0808-64E-01



Square Table Large //

W:1200 D:1200 H:640-940
Manual:
Silver frames
Maple top: HRT4-1212-64-03
Beech top: HRT4-1212-64-02
Grey top: HRT4-1212-64-01

Electric:
Silver frames
Maple top: HRT4-1212-64E-03
Beech top: HRT4-1212-64E-02
Grey top: HRT4-1212-64E-01



Rectangular Table //

W:1200 D:600 H:640-940
Manual:
Silver frames
Maple top: HRT4-1206-64-03
Beech top: HRT4-1206-64-02
Grey top: HRT4-1206-64-01

Manual Trespa:
Silver frames
Speckled Grey top: HRT4T-1206-64-08
Plain Grey top: HRT4T-1206-64-09

Electric:
Silver frames
Maple top: HRT4-1206-64E-03
Beech top: HRT4-1206-64E-02
Grey top: HRT4-1206-64E-01

Electric Trespa:
Speckled Grey top: HRT4T-1206-64E-08
Plain Grey top: HRT4T-1206-64E-09

homecare

loose tables



Floor Mounted Post Formed Laminate Worktop //

W:1200 D:600 H:640-940
Manual:
Silver frames
Speckled Grey top: HWTPF-1206-64-03

Electric Silver frames
Speckled Grey top: HWTPF-1206-64E-03



Through fixed worktop fitted with castor option only.



Rectangular Cutout Table //

W:1200 D:600 H:640-940
Manual units:
Silver frames
Maple top: HRT4C-1206-64-03
Beech top: HRT4C-1206-64-02
Grey top: HRT4C-1206-64-01

Electric units:
Silver frames
Maple top: HRT4C-1206-64E-03
Beech top: HRT4C-1206-64E-02
Grey top: HRT4C-1206-64E-01



Rectangular Table Large //

W:1500 D:1000 H:640-940
Manual units:
Silver frames
Maple top: HRT4-1510-64-03
Beech top: HRT4-1510-64-02
Grey top: HRT4-1510-64-01

Electric units:
Silver frames
Maple top: HRT4-1510-64E-03
Beech top: HRT4-1510-64E-02
Grey top: HRT4-1510-64E-01



Rectangular Table Mobile //

W:1200 D:600 H:640-940
With castors; 2 braked, 2 unbraked
Manual Silver frames through fixed top
Maple top: HRT4-1206-64-03-C
Beech top: HRT4-1206-64-02-C
Grey top: HRT4-1206-64-01-C



Supplied with a 4-zone ceramic hob.



Catering Hob //

W:1200 D:600 H:640-940
Manual Silver frames
Stainless Steel top: HSSEH-1206-64-03

Electric Silver frames
Stainless Steel top: HSSEH-1206-64E-03

homecare

catering (stainless steel)



Catering Work Surface //

W:1200 D:600 H:640-940
Manual Silver frames
Stainless Steel top: HSSWS-1206-64-03

Electric Silver frames
Stainless Steel top: HSSWH-1206-64E-03



Catering Sink //

W:1200 D:600 H:640-940
Manual Silver frames
Stainless Steel top: HSLSL-1206-64-03

Electric Silver frames
Stainless Steel top: HSLSL-1206-64E-03

Flexi plumbing kit available, please refer to page 21.

homecare

craft benches & bespoke solutions

We are market leaders of variable height furniture for science & the technologies. In addition to the various units and tables depicted in this brochure we can also design and build bespoke units to your specifications.

Our technical design department can meet most special requirements, such as The Meadows school pictured above. Laboratories, kitchens and other specialist teaching rooms received powered height adjustable units designed, built and installed specifically for the school.



Woodwork/Craft Bench //

W:1475 D:650 H:665-965
Manual Silver frames
Beech Hardwood top
(including 2 vices): HWB4-1666-66-BH

Manual Silver frames
Plain MDF
Lacquered top
(without vice): HWB4-1666-66-09-MDF

Woodwork vice: WWW



Laboratory/Technology Bench //

W:1200 D:700 H:640-940
Manual Silver frames
Iroko top: HBE3-1207-64-03
Trespa Athlon
Plain Grey top: HBE3-1207-64-09

Electric Silver frames
Iroko top: HBE3T-1207-64E-03
Trespa Athlon
Plain Grey top: HBE3T-1207-64E-09

homecare

science



Height Adjustable Science Bollards //

W:600 D:600 H:640-940
Electric/Gas/Water Trespa Athlon Top;
Includes, 2 Twin 13 amp power sockets,
2 90° gas taps, 1 cold water tap and sink.

Maple carcass Plain Grey top:	HSBEGW-0606-64-39
Maple carcass Speckled Grey top:	HSBEGW-0606-64-38
Beech carcass Plain Grey top:	HSBEGW-0606-64-29
Beech carcass Speckled Grey top:	HSBEGW-0606-64-28
Grey carcass Plain Grey top:	HSBEGW-0606-64-19
Grey carcass Speckled Grey top:	HSBEGW-0606-64-18



Electric/Gas Trespa Athlon Top;
Includes; 2 twin 13 amp power sockets,
2 90° gas taps.

Maple carcass Plain Grey top:	HSBEG-0606-64-39
Maple carcass Speckled Grey top:	HSBEG-0606-64-38
Beech carcass Plain Grey top:	HSBEG-0606-64-29
Beech carcass Speckled Grey top:	HSBEG-0606-64-28
Grey carcass Plain Grey top:	HSBEG-0606-64-19
Grey carcass Speckled Grey top:	HSBEG-0606-64-18

Electric Trespa Athlon Top;
Includes; 2 twin 13 amp power sockets,

Maple carcass Plain Grey top:	HSBE-0606-64-39
Maple carcass Speckled Grey top:	HSBE-0606-64-38
Beech carcass Plain Grey top:	HSBE-0606-64-29
Beech carcass Speckled Grey top:	HSBE-0606-64-28
Grey carcass Plain Grey top:	HSBE-0606-64-19
Grey carcass Speckled Grey top:	HSBE-0606-64-18

homecare 2

design & tables

Homecare 2 with 370mm of height adjustment.

These height adjustable units are operated by a manual crank handle, which is removable to prevent tampering. The two telescopic legs offer unrestricted access for the user. The optional wall brackets are height adjustable to avoid existing pipework.

Height Adjustable Tilt-Top Table //

W:1200 D:600 H:680-1050

Frame: Silver

Worktop:

Maple H2CTT-1206-68-03

Beech H2CTT-1206-68-02

Grey H2CTT-1206-68-01



Wall-Mounting Brackets //

Suffix to unit code:

H2-WM



Height Adjustable Table Unit //

W:1200 D:600 H:680-1050

Frame: Silver

Worktop:

Maple H2CT-1206-68-03

Beech H2CT-1206-68-02

Grey H2CT-1206-68-01

The hob is a 4-zone electric hot plate and features a heat protection under tray. The tilting top table uses a ratchet mechanism enabling a variety of different angles to be achieved. The sink is available with either a left or right handed drainer and comes complete with hot and cold taps and waste. An optional flexible plumbing kit is also available.

Flexi Plumbing Kit //

Flexible pipe fittings to fit height adjustable sink unit (1P-trap, 1flexi waste pipe, 2 stainless steel water couplings).

FPK1



Image shows optional wall-mounting brackets.

Height Adjustable Electric Hob Unit //

W:1200 D:600 H:680-1050

Frame: Silver

Worktop

Speckled Grey: H2CTEH-1206-68-03

Nb: These hob units require connection to a cooker circuit and should be installed by a qualified electrician. ALL electrically powered Homecare units should be powered by a power socket RCD protected.

homecare 2

catering, science & art



Height Adjustable Frame Only //

W:1200 D:600 H:680-1050

Frame: Silver

H2CFO-1206-68



Height Adjustable Trespa Table //

W:1200 D:600 H:680-1050

Frame: Silver

Worktop

Speckled Grey H2CSG-1206-68-08

Plain Grey H2CSG-1206-68-09



Image shows optional wall-mounting brackets.

Height Adjustable Sink Unit // Left Hand Drainer

W:1200 D:600 H:680-1050

Frame: Silver

Worktop

Speckled Grey: H2CTSL-1206-68-03

Right Hand Drainer

W:1200 D:600 H:680-1050

Frame: Silver

Worktop

Speckled Grey: H2CTSR-1206-68-03



Height Adjustable Worktop Unit //

W:1200 D:600 H:680-1050

Frame: Silver

Worktop:

Speckled Grey H2CW-1206-68-03

dining//

bench & trumpet

contemporary dining



Bench Table and Bench Seat //

W:2850 D:750 H:740 (Table)
 W:2750 D:280 H:450 (Seats) x 2
 Worktop:
 Maple: BTS-2975-74-03
 Beech: BTS-2975-74-02
 Grey: BTS-2975-74-01

For bespoke colours and finishes,
 please call us for details.



Trumpet Tables are supplied with a chrome base and central column.

Dining Table Standing Height //

Dia:800 H:940
 Worktop:
 Maple: DTCST-0808-94-03
 Beech: DTCST-0808-94-02
 Grey: DTCST-0808-94-01

Dining Table Sitting Height //

Dia:1000 H:750
 Worktop:
 Maple: DTCST-1010-75-03
 Beech: DTCST-1010-75-02
 Grey: DTCST-1010-75-01

Dia:1200 H:750
 Worktop:
 Maple: DTCST-1212-75-03
 Beech: DTCST-1212-75-02
 Grey: DTCST-1212-75-01

Coffee Table Sitting Height //

Dia:800 H:410
 Worktop:
 Maple: DTCST-0808-41-03
 Beech: DTCST-0808-41-02
 Grey: DTCST-0808-41-01

flipo

folding tables



Image shown with optional chrome effect paint

Folding Mobile Round Table //

Diameter:1000 H:720
 Frame: Silver
 Worktop:
 Maple: FPC-1010-72-03
 Beech: FPC-1010-72-02
 Grey: FPC-1010-72-01

Dia:1200 H:720
 Frame: Silver
 Worktop:
 Maple: FPC-1212-72-03
 Beech: FPC-1212-72-02
 Grey: FPC-1212-72-01

The Flipo range features a folding top which enables the unit to be stored quickly, safely and efficiently by nesting them together, as opposed to a conventional stacking system, improving health and safety. The folding mechanism is operated by pulling on the release bar.

Four wheels are fitted to provide maximum manoeuvrability. The wheels are steel housed for extra durability and two feature foot operated brakes.

The frame is epoxy powder coated for durability and the worktop is 27mm thick plastic laminated MDF.

A Trespa worktop is also available at an additional cost, please call us for details.



Image shown with optional chrome effect paint

Folding Mobile Large Table //

W:1200 D:600 H:720
 Frame: Silver
 Worktop:
 Maple: FPR-1206-72-03
 Beech: FPR-1206-72-02
 Grey: FPR-1206-72-01

W:1500 D:750 H:720
 Frame: Silver
 Worktop:
 Maple: FPR-1575-72-03
 Beech: FPR-1575-72-02
 Grey: FPR-1575-72-01

W:2000 D:750 H:720
 Frame: Silver
 Worktop:
 Maple: FPR-2075-72-03
 Beech: FPR-2075-72-02
 Grey: FPR-2075-72-01

tables//

v-38 table

crescent

Multifunctional

The V-38 TABLE range is specially designed to allow multiple configurations. This means the tables can be arranged in various layouts and offer great value for money.



Crescent Table //

Dia:830 D:740 H:710

With glides:

Silver frames:

Maple: V38P-8374-71-03G

Beech: V38P-8374-71-02G

Grey: V38P-8374-71-01G

With castors:

Silver frames

Maple: V38P-8374-71-03C

Beech: V38P-8374-71-02C

Grey: V38P-8374-71-01C

Fitted with 2 adjustable feet & 2 locking
75mm steel housed wheels

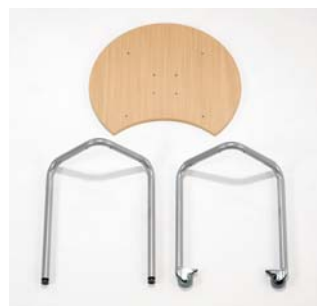

Improve life cycle

The standard leg is used in the Crescent and 600 mm deep Rectangular and Square tables. By standardising legs, components can be re-used to improve life cycle performance.



Size Marks

The V38 tables are available in all size marks, from 0-7 (see table on back cover). Please call us to specify which size mark you require.

V Table Range

The V Table range has been specifically designed to enhance flexibility, durability, style & life cycle. Constructed from 38mm diameter heavy duty steel tubing the common leg frame can be interchanged between various tops to meet varying needs. The work surface is constructed from a 27mm thick high-pressure laminate balanced MDF with three coats of lacquer applied to the MDF edge. When fitted with the optional wheels the units are easy to manoeuvre on a wheelbarrow principle as shown above.

v-38 table

crescent flexibility



Lecture arrangement



Small groups



Rectangle meeting

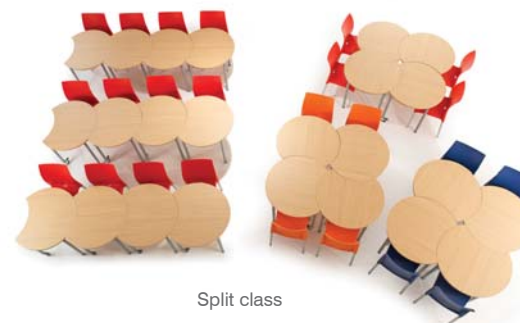

Split class



Circular meeting

v-38 table

rectangular and triangular



Triangular 90° tables can be arranged in pairs to seat four people or two pairs to seat eight. See diagram opposite.

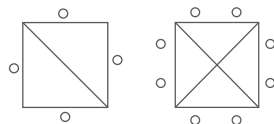

Triangle Table 60° //

W:985 D:780 H:710
 With glides:
 Silver frames
 Maple top: V38T60-9878-71-03G
 Beech top: V38T60-9878-71-02G
 Grey top: V38T60-9878-71-01G

Fitted with 4 adjustable feet

With castors:
 Silver Frames
 Maple top: V38T60-9878-71-03C
 Beech top: V38T60-9878-71-02C
 Grey top: V38T60-9878-71-01C

Fitted with 2 adjustable feet & 1 locking
 75mm steel housed wheel



Triangle Table 90° //

W:900 D:900 H:710
 With glides:
 Silver frames
 Maple top: V38T90-9090-71-03G
 Beech top: V38T90-9090-71-02G
 Grey top: V38T90-9090-71-01G

Fitted with 4 adjustable feet

With castors:
 Silver Frames
 Maple top: V38T90-9090-71-03C
 Beech top: V38T90-9090-71-02C
 Grey top: V38T90-9090-71-01C

Fitted with 2 adjustable feet & 1 locking
 75mm steel housed wheel



Rectangular Table //

W:1200 D:600 H:710
 With glides:
 Silver frames
 Maple top: V38R-1206-71-03G
 Beech top: V38R-1206-71-02G
 Grey top: V38R-1206-71-01G

Fitted with 4 adjustable feet

With castors:
 Silver Frames
 Maple top: V38R-1206-71-03C
 Beech top: V38R-1206-71-02C
 Grey top: V38R-1206-71-01C

Fitted with 2 adjustable feet & 2 locking
 75mm steel housed wheels

For details of our square V-38 please
 phone us.

v-38 table

wave and half round wave



Wave Table //

W:1300 D:825 H:710
 With glides:
 Silver Frames
 Maple top: V38RW-1383-71-03G
 Beech top: V38RW-1383-71-02G
 Grey top: V38RW-1383-71-01G

Fitted with 4 adjustable feet

With castors:
 Silver Frames
 Maple top: V38RW-1383-71-03C
 Beech top: V38RW-1383-71-02C
 Grey top: V38RW-1383-71-01C

Fitted with 2 adjustable feet & 2 locking
 75mm steel housed wheels



Half Round Wave Table //

W:1300 D:735 H:710
 With glides:
 Silver Frames
 Maple top: V38HCW-1374-71-03G
 Beech top: V38HCW-1374-71-02G
 Grey top: V38HCW-1374-71-01G

Fitted with 4 adjustable feet

With castors:
 Silver Frames
 Maple top: V38HCW-1374-71-03C
 Beech top: V38HCW-1374-71-02C
 Grey top: V38HCW-1374-71-01C

Fitted with 2 adjustable feet & 2 locking
 75mm steel housed wheels

fun

teacher and student



Yellow pedestal colour scheme is available on request only.



Fun Admin/Teacher's Station //
With glides

W:1200 D:750 H:710
Frame: Silver
Worktop & Drawer:
Maple: FTR-1275-71-03G
Beech: FTR-1275-71-02G
Grey: FTR-1275-71-01G

W:1500 D:750 H:710
Maple: FTR-1575-71-03G
Beech: FTR-1575-71-02G
Grey: FTR-1575-71-01G



Fun Admin/Teacher's Station //
With castors; 2 braked, 2 unbraked

W:1200 D:750 H:710
Frame: Silver
Worktop & Drawer:
Maple: FTR-1275-71-03C
Beech: FTR-1275-71-02C
Grey: FTR-1275-71-01C

W:1500 D:750 H:710
Maple: FTR-1575-71-03C
Beech: FTR-1575-71-02C
Grey: FTR-1575-71-01C

fun

teacher and student



Image shown with translucent modesty panel and universal right hand drawer unit.



Fun Student Desk //
With glides

W:1200 D:600 H:710
Frame: Silver
Worktop
Maple: FSR-1260-71-03G
Beech: FSR-1260-71-02G
Grey: FSR-1260-71-01G

W:600 D:600 H:710
Maple: FSR-6060-71-03G
Beech: FSR-6060-71-02G
Grey: FSR-6060-71-01G



Fun Student Desk //
With castors; 2 braked, 2 unbraked

W:1200 D:600 H:710
Frame: Silver
Worktop
Maple: FSR-1260-71-03C
Beech: FSR-1260-71-02C
Grey: FSR-1260-71-01C

W:600 D:600 H:710
Maple: FSR-6060-71-03C
Beech: FSR-6060-71-02C
Grey: FSR-6060-71-01C

v-50 table

heavy duty tables for classroom, art, projects, science, & technology.

Seating and Standing Heights Available

These tables are constructed from fully welded heavy duty 50mm round steel tube making them exceptionally strong. The adjustable feet compensate for uneven floors.

Perfect for use in classrooms where durability is the key priority or practical work areas where the strong legs can maintain standing height stability coupled with allowing unrestricted access to all sides. The V-50 range has become a favourite of the academy programme and are regularly specified by the major academy groups.

They are available in a variety of sizes, finishes and shapes, including square, rectangular, trapezoidal and round with a 27mm laminate MDF or 13mm Trespa top.



V-50 Table Square Project //

W:1200 D:1200 H:710	
Frame: Silver	
Laminate sitting	
Worktop:	
Maple:	V50SL-1212-71-03
Beech:	V50SL-1212-71-02
Grey:	V50SL-1212-71-01
Trespa sitting	
Speckled Grey:	V50ST-1512-71-08
Plain Grey:	V50ST-1512-71-09

W:1200 D:1200 H:850	
Laminate standing	
Maple:	V50SL-1212-85-03
Beech:	V50SL-1212-85-02
Grey:	V50SL-1212-85-01
Trespa standing	
Speckled Grey:	V50ST-1212-85-08
Beech:	V50ST-1212-85-09

V-50 Table Rectangular Project //

W:1500 D:750 H:710	
Frame: Silver	
Laminate sitting	
Worktop:	
Maple:	V50RL-1575-71-03
Beech:	V50RL-1575-71-02
Grey:	V50RL-1575-71-01
Trespa sitting	
Speckled Grey:	V50RT-1575-71-08
Plain Grey:	V50RT-1575-71-09

W:1500 D:750 H:850	
Laminate standing	
Maple:	V50RL-1575-85-03
Beech:	V50RL-1575-85-02
Grey:	V50RL-1575-85-01
Trespa standing	
Speckled Grey:	V50RT-1575-85-08
Beech:	V50RT-1575-85-09

V-50 Teacher's Table //

W:1200 D:800 H:710	
Maple:	V50T-1208-71-03
Beech:	V50T-1208-71-02
Grey:	V50T-1208-71-01
W:1200 D:600 H:710	
Maple:	V50T-1206-71-03
Beech:	V50T-1206-71-02
Grey:	V50T-1206-71-01



The trapezoidal table has one 1395mm edge and three 697mm edges. They can be arranged in a multitude of ways to create a true hexagonal work area.

V-50 Table Trapezoidal //

W:1395 D:604 H:710	
Frame: Silver	
Laminate sitting	
Worktop:	
Maple:	V50ZL-1406-71-03
Beech:	V50ZL-1406-71-02
Grey:	V50ZL-1406-71-01
Trespa sitting	
Speckled Grey:	V50ZT-1406-71-08
Plain Grey:	V50ZT-1406-71-09

W:1395 D:604 H:850	
Laminate standing	
Maple:	V50ZL-1406-85-03
Beech:	V50ZL-1406-85-02
Grey:	V50ZL-1406-85-01
Trespa standing	
Speckled Grey:	V50ZT-1406-85-08
Plain Grey:	V50ZT-1406-85-09

v-50 table

rectangular, square and trapezoidal



V-50 Table Square //

W:600 D:600 H:710	
Frame: Silver	
Laminate sitting	
Worktop:	
Maple:	V50SL-0606-71-03
Beech:	V50SL-0606-71-02
Grey:	V50SL-0606-71-01
Trespa sitting	
Speckled Grey:	V50ST-0606-71-08
Plain Grey:	V50ST-0606-71-09

W:600 D:600 H:850	
Laminate standing	
Maple:	V50SL-0606-85-03
Beech:	V50SL-0606-85-02
Grey:	V50SL-0606-85-01
Trespa standing	
Speckled Grey:	V50ST-0606-85-08
Plain Grey:	V50ST-0606-85-09

V-50 Table Rectangular //

W:1200 D:600 H:710	
Frame: Silver	
Laminate sitting	
Worktop:	
Maple:	V50RL-1206-71-03
Beech:	V50RL-1206-71-02
Grey:	V50RL-1206-71-01
Trespa sitting	
Speckled Grey:	V50RT-1206-71-08
Plain Grey:	V50RT-1206-71-09

W:1200 D:600 H:850	
Laminate standing	
Maple:	V50RL-1206-85-03
Beech:	V50RL-1206-85-02
Grey:	V50RL-1206-85-01
Trespa standing	
Speckled Grey:	V50RT-1206-85-08
Plain Grey:	V50RT-1206-85-09

v-25 stacking table

economy teachers & student tables

Economy Tables

The stacking tables uses a rotational stacking system meaning there are no protruding legs outside of the footprint of the worktop. This makes them ideal for group work when a large work surface is required.

All tables use 25mm square tubing frames with 27mm thick high-pressure laminate MDF worktop and all edges are lacquered and profiled.

These tables are available in 600mm square and 1200mm x 600mm rectangular in all size marks (see table on back cover). The optional modesty panel allows these tables to be used as an economical teacher's workstation when used with a mobile drawer pedestal.



Modesty Panel Table //

W:1200 D:600 H:710
 Frame: Silver
 Worktop:
 Maple: V25RMP-1206-71-03G
 Beech: V25RMP-1206-71-02G
 Grey: V25RMP-1206-71-01G

Stacking Table 1200x600 //

W:1200 D:600 H:710
 Frame: Silver
 Worktop:
 Maple: V25R-1206-71-03G
 Beech: V25R-1206-71-02G
 Grey: V25R-1206-71-01G

Stacking Table 600x600 //

W:600 D:600 H:710
 Frame: Silver
 Worktop:
 Maple: V25S-0606-71-03G
 Beech: V25S-0606-71-02G
 Grey: V25S-0606-71-01G

ict workspaces//

music & saw tooth

music, ict & technology workstations



Music Desk //

Height Adjustable (see feature shot)

W:1000 D:800
 Desk Height: 640-940
 Shelf Height: 900-1200
 Shelf Depth: 365
 Frame: Silver
 Worktop:
 Maple: HMUD-1008-72-03
 Beech: HMUD-1008-72-02
 Grey: HMUD-1008-72-01



Music Desk features a pull-out IT keyboard shelf.



Saw toothed desks are ideal for sewing machines and ICT use.

Music Desk //

W:1000 D:800
 Desk Height: 720
 Shelf Height: 980
 Shelf Depth: 365
 Frame: Silver
 Worktop:
 Maple: MUD-1008-72-03
 Beech: MUD-1008-72-02
 Grey: MUD-1008-72-01

Saw Tooth Desk//

W:1200 D:1050 H:720
 Maple: DST-1011-72-03C
 Beech: DST-1011-72-02C
 Grey: DST-1011-72-01C

tiered ict

clear view of user activity

We offer a consultancy and design service for all large-scale specialist teaching areas, along with an itemised quote. Please call us to discuss your requirements.

Tiered ICT benching with a teacher-facing writing plinth allows discreet monitoring of all students' IT activities with the added flexibility, when the student rotates through 180°, of an independent writing surface. The tiered layout also promotes good sightlines between the teacher and student. A section of the front row writing plinth and tiered benching is height adjustable for DDA compliance. This solution was developed for United Learning Trust and the academies that they operate.



ict cluster

group working & collaboration



ICT Cluster // Six Person

W:2000 D:2100

Frame: Silver

Worktop:

Maple: ICTC6-2021-72-03

Beech: ICTC6-2021-72-02

Grey: ICTC6-2021-72-01

ICT Clusters are available also for four, six and eight people. They all feature vertical integral cable segregation.

daisy chain ict desks

linkable tables including power modules & leads



The modesty panel is reversible so the cable management and power units can be on the inside under the table top. Orders less than £950.00 will be delivered flat packed.

These single or two person computer desks feature a rear panel with access to power modules and three compartment cable segregation. This allows a number of desks to offer power charging from one 13 amp power socket. Codes and prices include 1 no. mains lead 1.5m long fitted with a 13amp plug top and 1 no. interconnecting lead 1.5m long enabling daisy chaining of the desks.

Daisy Chain ICT Desks //

W:1200 D:600 H:720
 Frame: Silver
 Worktop:
 Maple: DIT2-1206-72-03
 Beech: DIT2-1206-72-02
 Grey: DIT2-1206-72-01

W:600 D:600 H:720
 Frame: Silver
 Maple: DIT1-0606-72-03
 Beech: DIT1-0606-72-02
 Grey: DIT1-0606-72-01

relay linear ict desk

cable segregation with rotating tower hanger

A two person computer desk with rear and desk-top access to the cable tray and fitted with a rotating tower hanger to enable easy access for the CPU unit. The desk can also be used as an admin or teacher's desk when used in conjunction with a mobile pedestal.

The maximum width between the two tower hangers is 980mm. The maximum width computer tower that can fit into the tower hanger is 170mm.



Image shown with the right hand tower hanger removed to accommodate a loose filing pedestal.



Linear Cable Managed ICT Desk //

W:1500 D:750 H:720
 Frame: Silver
 Worktop:
 Maple: RITR-1575-72-03
 Beech: RITR-1575-72-02
 Grey: RITR-1575-72-01

seating//

eduflex seating

suited system

Eduflex is specifically designed for the education marketplace. The gas injection moulding process of the chair shell maintains stability and aesthetics. Eduflex is available in three designs; four leg is the most economical, reverse cantilever design is height adjustable and will swivel through 360°.

The reverse cantilever design improves health and safety as, when stored on a table, the chair is less likely to fall off the table top and cause injury. This safe storage solution also aids classroom cleaning.



eduflex seating

suited system



Four Leg Chair //

W:430 D:460 H:430-460

430mm-size mark: 5: EF4-4346-43

460mm-size mark: 6: EF4-4346-46

Suffix chair code with:

Green: -10	Yellow: -14
Ivory: -11	Grey: -15
Blue: -12	Orange: -16
Red: -13	Black: -17

Reverse Cantilever Chair //

W:420 D:430 H:430-460

430mm-size mark: 5: EFC-4243-43

460mm-size mark: 6: EFC-4243-46

Suffix chair code with:

Green: -10	Yellow: -14
Ivory: -11	Grey: -15
Blue: -12	Orange: -16
Red: -13	Black: -17

Swivel Chair //

W:575 D:575 H:400-515

Size mark: 5&6 EFO-5757-40

Suffix chair code with:

Green: -10	Yellow: -14
Ivory: -11	Grey: -15
Blue: -12	Orange: -16
Red: -13	Black: -17

Seat Pad for Eduflex Chairs //

Suffix chair code with: EF-SP

Seat pad will be colour matched to the chair e.g. blue seat pad supplied with blue seat shells. Other colours are available on request

Order Codes Explained //

To place an order for a size mark 5 Eduflex Cantilever Chair with a green shell and a seat pad, the code will look as follows:
EFC-4243-43 -10 -EF-SP
(Chair code) (Colour) (Seat pad)

sofi, eduflex stool & activo stool

chairs and stools

Sofi is a lightweight stackable chair with a single moulded polypropylene shell supported with four anodised aluminium legs.

Sofi is suitable for indoor or outdoor use, the seat pan surface incorporates a rain water drain hole. However it is not recommended for classroom use.

Activo and Eduflex stools are stackable and feature a single piece polypropylene moulded seat and back. The frame has been designed to help prevent users tipping backwards on the stool.

They are supported by a cantilever frame which will reduce the risk of damage to floor coverings.

The Activo stool, with it's low back design will allow in most cases for the stools to be stored underneath a standing height loose table whilst standing activities are taking place.



Sofi Chair //

Size mark: 6
W:465 D:510 H:460 (seat only)
Frame: Silver
Seat and Back Shell: Anthracite Grey
(other colours available on request subject to quantity)

SO4-4651-46

Eduflex Stool //

Overall:	Seat:	
H: 845	H: 430	EFO-4243-43
H: 875	H: 460	EFO-4243-46
H: 975	H: 560	EFO-4243-56
H: 1025	H: 610	EFO-4243-61
H: 1075	H: 660	EFO-4243-66
H: 1125	H: 710	EFO-4243-71
H: 1175	H: 760	EFO-4243-76
W: 500	W: 420	
D: 530	D: 430	

Frame: Silver

Suffix chair code with:

Green:	-10	Yellow:	-14
Ivory:	-11	Grey:	-15
Blue:	-12	Orange:	-16
Red:	-13	Black:	-17

Activo Stacking Stool //

Overall:	Seat:	
H: 615	H: 430	AS-3938-43
H: 645	H: 460	AS-3938-46
H: 745	H: 560	AS-3938-56
H: 795	H: 610	AS-3938-61
H: 845	H: 660	AS-3938-66
H: 895	H: 710	AS-3938-71
H: 945	H: 760	AS-3938-76
W: 475	W: 395	
D: 420	D: 380	

Frame: Silver

Seat & Back Shell: Blue (other colours available on request subject to quantity)

Cool is a range of informal and robust low-level seating. It is available in the full range of mainline fabrics and vinyls, swatches are available on request and the upholstery can be in a single or a two tone fabric finish.



Cube Stool //

For upholstery options please request our fabric chart

W:420 D:420 H:430

CS-4242-43

(please suffix order code with fabric choice)



Image shown with optional with 2 tone fabric finish.

Cool Stool Round //

For upholstery options please request our fabric chart

W:470 Diameter H:450

Frame: Silver

CORS-470D-45

(please suffix order code with fabric choice)

Cool Stool Square //

For upholstery options please request our fabric chart

W:480 D:480 H:450

Frame: Silver

COSS-4848-45

(please suffix order code with fabric choice)

Cool Coffee Table //

W:610 D:610 H:410

Frame: Silver

Worktop:

Grey	COCT-6161-41-01
Beech	COCT-6161-41-02
Maple	COCT-6161-41-03

Cool Chair //

For upholstery options please request our fabric chart

W:530 D:620 H:750

Frame: Silver

COLC-5362-75

(please suffix order code with fabric choice)

storage & specialist areas//

loose storage

cupboard storage



Double Door Lockable Cabinet with 4 Internal Adjustable Shelves //

W:1045 D:520 SH:1950

Grey: LSDD-1052-19-01
 Beech: LSDD-1052-19-02
 Maple: LSDD-1052-19-03
 Dark Grey: LSDD-1052-19-04

Internal view



Open Shelf Unit with 4 Internal Adjustable Shelves //

W:1045 D:500 SH:1950

Grey: LSOC-1005-19-01
 Beech: LSOC-1005-19-02
 Maple: LSOC-1005-19-03
 Dark Grey: LSOC-1005-19-04



Mobile Storage Lockable Cupboard - Low Level //

W:1045 D:520 SH:820

Grey: LSMC-1052-82-01
 Beech: LSMC-1052-82-02
 Maple: LSMC-1052-82-03
 Dark Grey: LSMC-1052-82-04



Four Drawer Filing Cabinet Lockable //

W:474 D:615 SH:1320

Grey: LSFC-4761-13-01
 Beech: LSFC-4761-13-02
 Maple: LSFC-4761-13-03
 Dark Grey: LSFC-4761-13-04



Tray/Shelf Storage Unit (8 Trays Included) //

W:1382 D:500 H:774

Grey: LST8-1305-77-01
 Beech: LST8-1305-77-02
 Maple: LST8-1305-77-03
 Dark Grey: LST8-1305-77-04

Jumbo Tray/Shelf Unit (12 Trays Included) //

W:1386 D:500 H:1102

Grey: LSJT-1305-11-01
 Beech: LSJT-1305-11-02
 Maple: LSJT-1305-11-03
 Dark Grey: LSJT-1305-11-04



Kinder Box and Tray Unit (12 Trays Included) //

W:1045 D:500 SH:675

Grey: LSKB-1005-67-01
 Beech: LSKB-1005-67-02
 Maple: LSKB-1005-67-03
 Dark Grey: LSKB-1005-67-04

loose storage

mobile tray & shelf storage



Image shows three of the supplied twelve trays

Tray colours available: Jet Black, Lemon Jelly, Strawberry Jelly, Blueberry Jelly, Kiwi Jelly, Grape Jelly, Translucent and Steel Blue. Other tray colours are available on request.



Mobile Open Tray Unit (24 Trays Included) //

W:1045 D:500 SH:820

Grey: LSTU-1005-82-01
 Beech: LSTU-1005-82-02
 Maple: LSTU-1005-82-03
 Dark Grey: LSTU-1005-82-04



Mobile Open Tray/Shelf Unit (9 Trays in Three of Each Depth Included) //

W:1045 D:500 SH:725

Grey: LSDS-1005-72-01
 Beech: LSDS-1005-72-02
 Maple: LSDS-1005-72-03
 Dark Grey: LSDS-1005-72-04

locker, pigeon hole & paper storage

various sizes

All lockers feature sloping tops to improve hygiene and cleanliness. Lockers are also available with Trespa doors and combination locks. Please ask our sales team on 01254 678777 for details.

These single column freestanding locker units are available in 1, 2, 3, 4 and 5 tier formats. All lockers are supplied with a removable key operated cam barrel lock which is easily replaced with the use of a master key. Optional rotating combination locks with a master key override, are available at extra cost on request, please contact our sales staff for further information.



Pigeon Hole Unit 30 No. //

W:1200 D:300 H:1300
Internal aperture sizes:
W: 376 D:280 H:95
Grey: LSPH30-1203-13-01
Beech: LSPH30-1203-13-02
Maple: LSPH30-1203-13-03
Dark Grey: LSPH30-1203-13-04



A1 Paper Storage 10 Slats //

W:900 D:650 H:1300
Internal aperture sizes:
W: 864 D:630 H:95
Grey: LSPC-9065-13-01
Beech: LSPC-9065-13-02
Maple: LSPC-9065-13-03
Dark Grey: LSPC-9065-13-04

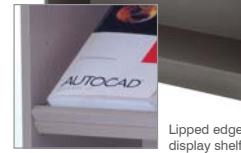

Lipped edge display shelf

library shelving

single & double sided



Low Level Single Sided //

W:1045 D:350 SH:820
Grey: LSU-1035-90-01
Beech: LSU-1035-90-02
Maple: LSU-1035-90-03
Dark Grey: LSU-1035-90-04



Low Level Double Sided //

W:1045 D:700 SH:820
Grey: LSUD-1070-90-01
Beech: LSUD-1070-90-02
Maple: LSUD-1070-90-03
Dark Grey: LSUD-1070-90-04



Two Tier Locker //

W:310 D:520 SH:1886
Grey: LOT2M-3152-18-01
Beech: LOT2M-3152-18-02
Maple: LOT2M-3152-18-03
Dark Grey: LOT2M-3152-18-04
Twin Grey: LOT2M-3152-18-05



Five Tier Locker //

W:310 D:520 SH:1886
Grey: LOT5M-3152-18-01
Beech: LOT5M-3152-18-02
Maple: LOT5M-3152-18-03
Dark Grey: LOT5M-3152-18-04
Twin Grey: LOT5M-3152-18-05



Four Tier Locker //

W:310 D:520 SH:1886
Grey: LOT4M-3152-18-01
Beech: LOT4M-3152-18-02
Maple: LOT4M-3152-18-03
Dark Grey: LOT4M-3152-18-04
Twin Grey: LOT4M-3152-18-05



High Level Single Sided //

W:1045 D:350 SH:1950
Grey: LTU-1035-18-01
Beech: LTU-1035-18-02
Maple: LTU-1035-18-03
Dark Grey: LTU-1035-18-04



High Level Single Sided //
With Display Shelf

W:1045 D:350 SH:1950
Grey: LTUD-1035-18-01
Beech: LTUD-1035-18-02
Maple: LTUD-1035-18-03
Dark Grey: LTUD-1035-18-04



Low Level Double Sided //
With Castors

W:1045 D:700 SH:820
Grey: LSUD-1070-90-01C
Beech: LSUD-1070-90-02C
Maple: LSUD-1070-90-03C
Dark Grey: LSUD-1070-90-04C

storage & specialist areas//

change

single & double sided benching

Durable, Robust and Practical

Tubular steel construction combined with hardwood slats provide a breathable and robust seating surface, complete with steel powder coated hooks, ensures these benches are fit for the demands of the changing room environment. To improve floor cleaning access the benches do not have shoe trays fitted.



Double Sided //

Size mark: 5
W:1500 D:680 H:430 (seat dimensions)
Frame: Silver
Seat: Ash timber

CBDSL-1575-46



Single Sided //

Size mark: 5
W:1500 D:400 H:430 (seat dimensions)
Frame: Silver
Seat: Ash timber

CBSSL-1504-46



Double Sided with Hooks //

Size mark: 5
W:1500 D:755 H:430 (seat dimensions)
Frame: Silver
Seat: Ash timber

CBDSH-1575-16



Single Sided with Hooks //

Size mark: 5
W:1500 D:350 H:430 (seat dimensions)
Frame: Silver
Seat: Ash timber

CBSSH-1504-16

make

craft benches & storage seats

These sturdy fully welded multi-material craft benches will accommodate four students, providing each with their own work area and 7 inch soft jaw woodworking vice. The 50mm thick work surface can be constructed from beech hardwood or MDF and incorporates a central tool well. Optional cupboards are available for storage underneath. The optional engineers vice with tray shown below allows a quick conversion from soft materials to metal. The box storage seat incorporates gas springs for improved safety.



Engineers Vice with Tray //

W:450 (bench tray) D:300 (bench tray)
Vice: Blue
Tray: Beech

MAB-EV



Lid-top blue carpeting excluded

Box Store Seat //

W:1000 D:565 H:460
Carcass:
Grey: BS-1065-46-01
Beech: BS-1065-46-02
Maple: BS-1065-46-03



Multi Materials Craft Bench //
MDF (Including 4 vices)

W:1200 (bench top) D:1200 (bench top)
H:850
Frame: Silver
Worktop: Plain MDF
Workbench: MAMDF-1212-85

Workbench with storage: MAMDFC-1212-85



Multi Materials Craft Bench //
Beech (Including 4 vices)

W:1200 (bench top) D:1200 (bench top)
H:850
Frame: Silver
Worktop: Solid Beech Texwood
Workbench: MAB-1212-85

Workbench with storage: MABC-1212-85

innovative fitted furniture

bespoke design



innovative fitted furniture

bespoke design



Fitted furniture for all subject areas that is learner centred allowing clear sight lines and adequate storage whilst also creating an exciting learning space.

Please contact our sales team to discuss your specific requirements.

wall store

mobile



Mobile Shelf Unit //

W:1200 D:520 H:1600

Grey: WSMS-1252-16-01
 Beech: WSMS-1252-16-02
 Maple: WSMS-1252-16-03
 Dark Grey: WSMS-1252-16-04



Mobile Shelf & Tray Unit //

W:1200 D:520 H:1600

Grey: WSMST-1252-16-01
 Beech: WSMST-1252-16-02
 Maple: WSMST-1252-16-03
 Dark Grey: WSMST-1252-16-04

wall store

fixed

Generic Secondary School Classroom Wall Store

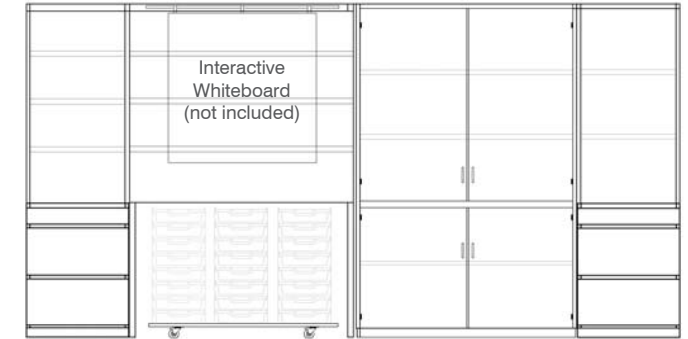

Generic Primary School Classroom Wall Store

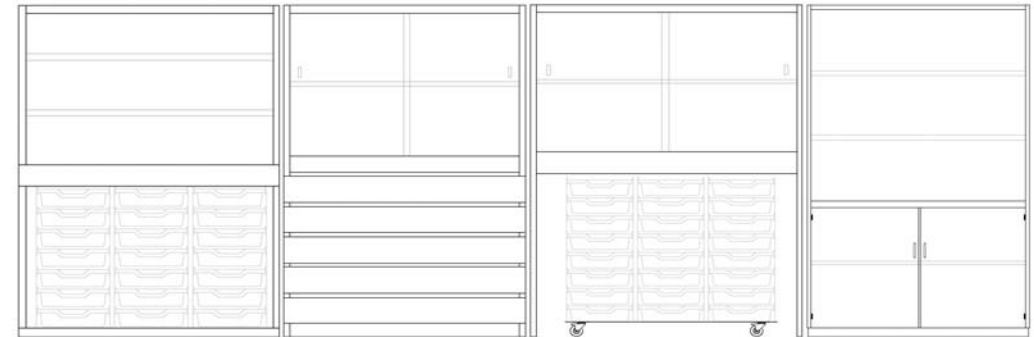

Wall Store

Wall storage provides a considered approach to the storage of materials, resources and students' work. When combined with mobile units the efficiency and organisation of the learning environment is improved.

We offer a consultancy and design service for all large-scale specialist teaching areas, along with an itemised quote.

Please call us to discuss your requirements.

reconfigurable work areas//

halo group

learning pods

The Halo Group is a completely reconfigurable system which allows total flexibility to create an array of different work areas. Halo Group consists of eight individual furniture items in three radii that can be arranged and re-arranged to create a multitude of social or individual activity areas and work stations.

The system features a 1200mm long x 900mm high screen (that can be double configured to create a 1800mm screen), a choice of 900mm or 1800mm end caps, four types of seating (internal or external, seat or bench) internal and external tables and an external library shelving unit.

The system is based on 1 metre, 1.5 metre and 2 metre radii that follow the centreline of the screen.

Available in a variety of laminate finishes and colours, the screens can also incorporate power and data modules. A member of our sales team will happily talk through any bespoke requirements.



Image shows //

Fourteen 1200 x 900mm screens	HPS-R1.512-90
Seven external benches	HPEC-R1.512-44
Seven internal tables	HPIT-R1.512-71
Two 1800mm end caps	HPTE-1808
(Eduflex seating not included)	



Image shows //

Seven 1200 x 900mm screens	HPS-R1.512-90
Seven internal benches	HPIC-R1.512-44
Two 900mm end caps	HPTE-1808



Image shows //

Seven 1200 x 900mm screens	HPS-R1.512-90
Seven external tables	HPET-R1.512-71
Seven internal benches	HPIC-R1.512-44
Two 900mm end caps	HPTE-1808
(Eduflex seating not included)	

Flexible Work Areas to facilitate evolving requirements.

halo group

learning pods



Image shows //

Six 1200 x 900mm screens	HPS-R1.512-90
Six internal benches	HPIC-R1.512-44
Seven external tables	HPET-R1.512-71
Four 900mm end caps	HPTE-1808
(Eduflex seating not included)	



Image shows //

Seven 1200 x 900mm screens	HPS-R1.512-90
Seven external benches	HPEC-R1.512-44
Seven internal tables	HPIT-R1.512-71
Two 900mm end caps	HPTE-1808



Image shows //

Six internal benches	HPIC-R1.512-44
Six group external shelving	HPES-R1.512-14

halo group

learning pods



Group External Shelving //

W:1410 D:330 H:1430
 1 metre radius: HPES-R1.014-14
 1.5 metre radius: HPES-R1.514-14
 2 metre radius: HPES-R2.014-14
 Full range of laminates available



Image shows //

Fourteen 1200 x 900mm screens
 Seven internal benches
 Four external benches
 Three group external shelving
 Two 1800mm end caps
 (Eduflex seating not included)

HPS-R1.012-90
 HPIC-R1.512-44
 HPEC-R1.512-44
 HPES-R1.514-14
 HPTE-1808



1200x900 Screen //

W:1200 D:80 SH:900
 1 metre radius: HPS-R1.012-90
 1.5 metre radius: HPS-R1.512-90
 2 metre radius: HPS-R2.012-90
 Full range of laminates available



Internal Bench //

W:1200 D:560 SH:440
 1 metre radius: HPIC-R1.012-44
 1.5 metre radius: HPIC-R1.512-44
 2 metre radius: HPIC-R2.012-44
 Full range of fabrics available



Image shows //

Fourteen 1200 x 900mm screens
 Six internal benches
 One internal seat
 Seven external benches
 Two 1800mm end caps

HPS-R1.012-90
 HPIC-R1.512-44
 HPIB-R1.512-44
 HPEC-R1.512-44
 HPTE-1808



External Bench //

W:1600 D:560 SH:440
 1 metre radius: HPEC-R1.016-44
 1.5 metre radius: HPEC-R1.516-44
 2 metre radius: HPEC-R2.016-44
 Full range of fabrics available



External Seat //

W:1600 D:560 SH:440
 1 metre radius: HPEB-R1.016-44
 1.5 metre radius: HPEB-R1.516-44
 2 metre radius: HPEB-R2.016-44
 Full range of fabrics available



Internal Seat //

W:1200 D:560 SH:440
 1 metre radius: HPIB-R1.012-44
 1.5 metre radius: HPIB-R1.512-44
 2 metre radius: HPIB-R2.012-44
 Full range of fabrics available



Internal Table //

W:1200 D:500 H:710
 1 metre radius: HPIT-R1.012-71
 1.5 metre radius: HPIT-R1.512-71
 2 metre radius: HPIT-R2.012-71
 Full range of laminates available



External Table //

W:1600 D:600 H:710
 1 metre radius: HPET-R1.012-71
 1.5 metre radius: HPET-R1.512-71
 2 metre radius: HPET-R2.012-71
 Full range of laminates available



End Cap //

W:80 D:20 H:1800
 Tall End Cap: HPTE-1808
 W:80 D:20 H:900
 Low End Cap: HPLE-9008

Measurement Definition

All Freedom Ability tables are ergonomically correct to EN1729 part 1. Please refer to the table above to specify the height of the table or chair that is required. In order to access the height of table or chair required, the childrens popliteal height defines the correct seat and table height. The measurement is taken from the floor to the back of the knee when seated, with thighs horizontal, the lower leg vertical and with feet flat on the floor. Sitting table height is determined by sitting elbow height, measured as the distance from the floor to the underside of the elbow whilst sitting, with the upper arm vertical and lower arm horizontal. Standing work height is determined by standing elbow height, which is the distance from the floor to the underside of the elbow of a standing person with the upper arm vertical and lower arm horizontal. To order the correct size mark please replace the height element of the product code with the height required. eg. V38P-8373-71-03G the digit "71" within this code refers to the product height from the Sitting Working Height row within the table above (all heights within the table above are in centimeters).

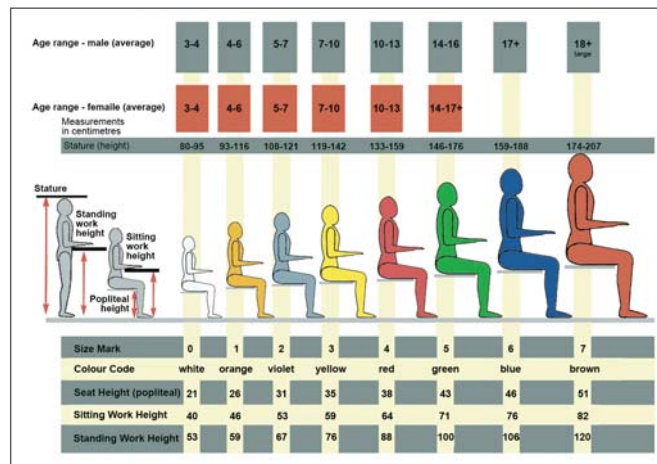

Standard Worktop Colour Chart

Please note if a colour finish is not specified at the time of ordering then the standard default finishes will be supplied. (Nb. Due to printing issues the colour finishes below may not always be a true representation so please use as guidance only)

Melamine MDF Worktops

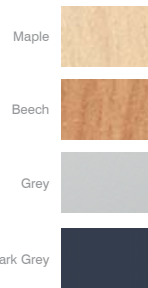

Trespa Athlon Worktops

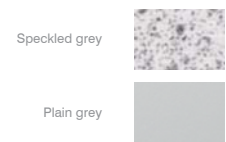

Scanflex Ltd
2 Thursby Road
Croft Business Park
Bromborough
Wirral CH62 3PW
United Kingdom
t: +44 (0) 151 343 1523
f: +44 (0) 151 343 1514



freedom

Freedom Ability's policy is one of continuous improvement, therefore the right is reserved to make changes in design and specification at any time without prior notice, we may also choose to discontinue products.

The products featured within this brochure are protected by copyright, patent, registered and unregistered

design rights.

European registered design also applies to some of the products.

All goods are supplied subject to Freedom Ability's terms and conditions, copies of which are available on request.

Prices do not include VAT.

All carriage is to UK mainland only, please enquire for carriage charges further afield.