



# In-Wall Relay Switch

## Smart Switch Sub-Assembly Instruction Manual

Rev. A-032021

P/N SS01

*\*Please see separate Smart Relay manual for complete instructions. The Smart Switch Sub-Assembly is an accessory part of In-wall Relay Switch and only functional when connected with the Smart Relay.*

### Warnings and Considerations

#### SAVE THESE INSTRUCTIONS

- **Warning!** Turn OFF electrical power before installing or servicing this product. Improper use or installation can cause SERIOUS INJURY, DEATH or LOSS/DAMAGE OF PROPERTY.
- **Warning!** This device must be protected by a circuit breaker (20A max).
- **Important:** This device must be installed by a licensed electrician in accordance with all national and local electrical codes.
- **Caution:** This product must not be wired to a circuit exceeding the rated working voltage.
- **Caution:** Use this device only with copper or copper-clad wire. Do not use aluminum wiring. This product has not been approved for use with aluminum wiring.
- **Important:** Using this product in a manner other than outlined in this document voids your warranty. Further, Focalcrest is NOT liable for any damage incurred with the misuse of this product.
- **Important:** Please use this product in an indoor environment.
- **Important:** Please make sure that the type of load complies with relevant requirements of this device.

### Complete Accessories Include

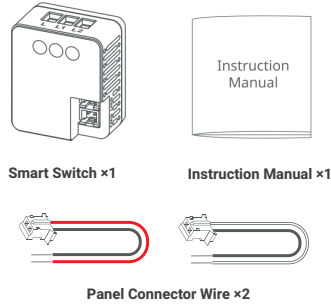

### Product Introduction

**Smart Switch Sub-Assembly** is an optional component of the **In-Wall Relay Switch** when they are used together. The **Smart Switch Sub-Assembly** is designed to allow mechanical switch panels to work with switch commands from the zigbee network. For example, after turning off the lights with a mechanical switch panel, you can turn on the lights through zigbee network commands.

One **Smart Relay** can be connected to one or a series **Smart Switch Sub-Assembly** (multiple point control).

One **Smart Switch Sub-Assembly** can be connected to two circuits of loads, each of which must use one **Smart Relay**.

Technical Specifications	
Model number	SS01
Input Voltage	AC 85V~245V
Max. Load Power	AC 110V/300W AC 220V/600W
Min. Load Power	No limit
Supported Switch Type	Rocker, Rebound
Operating Temperature	0~40°C (32°~104°F)
Relative Humidity	5~85% RH
Product Size (L*W*H)	33.5mm * 28.2mm * 17.3mm (1.32in. x 1.11in. x 0.68in.)

### Fastening screws

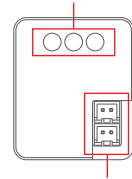

### NOTE

- 'SW1' controls the 'L1'
- 'SW2' controls the 'L2'

SW1: External switch control for load  
SW2: External switch control for load

### Panel Connection port

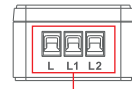

L : Power input for live wire  
L1: Power output for live wire  
L2: Power output for live wire

### Wire Connection port

### Installation Instructions

**Caution:** All installations of this device should be performed by a qualified or licensed electrician!

#### Step 1:

Shut off the main circuit breaker (MCB) for safety during the installation

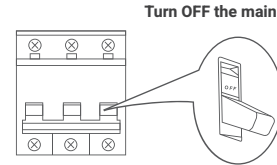

Step 1

#### Step 2:

Remove **mechanical switch panel**.

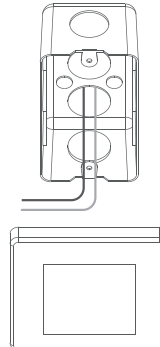

Step 2

#### Step 3:

Connect the wires to the mechanical switch panel according to one of the two diagrams below

- 1 Connect the red wire of 'panel connector wire 1' to 'L1' of the mechanical switch panel;
- 2 Connect the white wire of 'panel connector wire 2' to 'L2' of the mechanical switch panel;
- 3 (Fig. 3a only) Connect the black wires of 'panel connector wire 1' and 'panel connector wire 2' to 'L' of the mechanical switch panel.
- 4 (Fig. 3b only) Connect the black wires of 'panel connector wire 1' and 'panel connector wire 2' to the 'L' and 'L2' respectively of the mechanical switch panel.

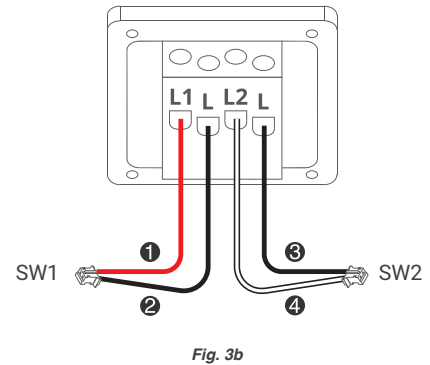
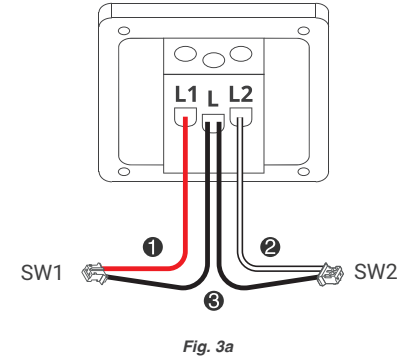

#### Step 4:

Install **Smart Switch Sub-Assembly** to the electrical box:

- 1 Connect the 'panel connector wire' to the 'SW1' terminal on the Smart Switch sub-assembly;
- 2 Connect the live wire to the 'L' terminal on the Smart Switch sub-assembly;
- 3 Connect the load wire to the 'L1' terminal on the Smart Switch sub-assembly.

**NOTE:** For 2-gang switch panels, connect the 'panel connector wire 2' to 'SW2' and connect the second load wire to the 'L2' terminal on **Smart Switch Sub-Assembly**

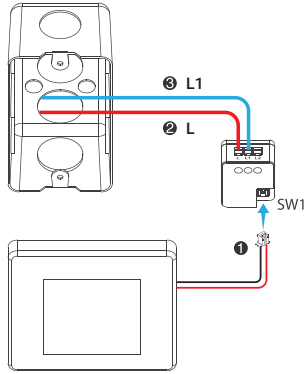

#### Step 5:

If the **Smart Switch Sub-Assembly** and **Smart Relay** are connected correctly, it should look like one of the diagrams below. For more instructions on how to install the **Smart Relay**, please see the **Smart Relay Manual**.

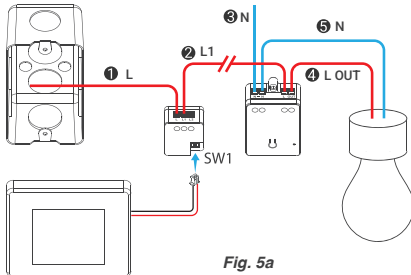

Fig. 5a

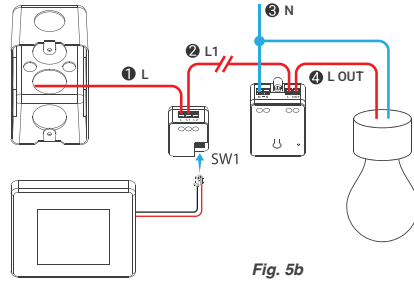

Fig. 5b

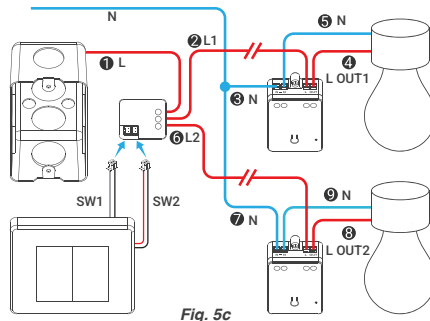

Fig. 5c

#### Step 6:

Before proceeding with this step, please ensure that wires are connected correctly, and the devices are operational.

Tear off the paper off the adhesive and fix the **Smart Switch Sub-Assembly** on a proper plane of the box.



#### Step 7:

Switch on the main circuit breaker (MCB).

#### Step 8:

Operate the mechanical switch panel once and the device will automatically recognize the panel type.

**NOTE:** Supported switch types are rocker and rebound switches.

#### Warranty Policy

##### Focalcrest Limited Warranty

Thank you for purchasing **In-Wall Relay Switch**.

Focalcrest Limited values your business and always strives to provide you the very best quality of service.

##### 1. HARDWARE PRODUCT LIMITED WARRANTY.

Focalcrest warrants to the original end user purchaser, ("Customer") of each new Focalcrest product that such Focalcrest Product hardware and components ("Product Hardware"), when used in accordance with the technical specifications by Focalcrest, will be free, in all material respects, of defects in materials and workmanship under normal use ("Limited Warranty"). This Limited Warranty is non-transferable and sets forth Focalcrest's sole and exclusive liability, and the sole and exclusive remedies available in relation to any non-conformity, defect or similar claim.

##### 2. LIMITED WARRANTY TERM.

This Limited Warranty runs for a period of 2 years from the date that the Customer purchases the Focalcrest Product from an authorized Focalcrest dealer ("Dealer") as shown by an invoice or sales receipt for the Product Hardware ("Hardware Warranty Period"). Customer must retain the appropriate documentation as proof of the purchase date.

##### 2. EXCLUSIONS NOT COVERED BY THIS LIMITED WARRANTY.

This Limited Warranty does not cover, and Focalcrest and its suppliers are not responsible for:

(A) Damage, malfunction, or inoperability of the Focalcrest Product caused by:

- (i) shippers or delivery services, or due to Customer improperly opening the Focalcrest Product packaging;
- (ii) Operation, storage, or application of the Focalcrest Product outside of the environmental, temperature, and other specifications provided in the Documentation;
- (iii) Acts of God, including, but not limited to, flood, fire, earthquake, lightning, electrical surges, or any other external cause;
- (iv) Any act beyond Focalcrest's direct control, including, but not limited to, unauthorized repair or installation by Customer or 3rd party, accident, abuse, misuse, neglect, use of incompatible devices and accessories, operating the Focalcrest Product outside the permitted or intended uses provided in the Documentation, or any other reason besides a defect in material or workmanship;
- (v) Use of incorrect voltage lines, fuses, circuit breakers, or incompatible load types as set forth in the Documentation, or failure to provide adequate, continuous, compatible power to the Product, if applicable;
- (vi) Interference from radio frequencies, infrared sources, or obstacles;

(vii) Normal wear and tear, or failure to install, maintain, or repair the Focalcrest Product in accordance with the Documentation and the applicable provisions of law for the jurisdiction where the Focalcrest Product is being installed;

(viii) Any product, part or software that has been modified to alter functionality or capability without the express written permission of Focalcrest;

(ix) Batteries and consumable parts (if any), unless damage occurred due to a defect in materials or workmanship in the Focalcrest Product;

(x) Cosmetic damage, including, but not limited to, scratches, dents and normal wear and tear;

(xi) Focalcrest Product in which the serial number has been removed or defaced; and

(xii) ANY DAMAGE, MALFUNCTION, OR INOPERABILITY ARISING FROM INSTALLATION, MAINTENANCE, OR PROGRAMMING PERFORMED BY AN INDEPENDENT CONTRACTOR, INCLUDING, WITHOUT LIMITATION, ANY DEALER RECOMMENDED OR CERTIFIED BY Focalcrest.

(B) any on-site labor costs incurred by Customer for the diagnosis, removal, repair, re-installation, and/or reprogramming of the Focalcrest Product;

(C) any non-Focalcrest hardware, including the functionality of 3rd party products controlled or automated by Focalcrest Products or Software (a "Focalcrest System"), batteries or software product (manufacturers, suppliers, or publishers, other than Focalcrest may provide their own warranties to Customer for their products, but Focalcrest, insofar as permitted by law, provides non-Focalcrest Products only "AS IS"); and

(D) the cost of repairing or replacing, or compensation for, any property that is damaged when a Focalcrest Product does not work properly, even if the damage was caused by a Focalcrest Product.

#### Certifications (regional):



#### Disposal Instructions:

This product must not be disposed of with your other household waste. Instead, it is your responsibility to dispose of your waste equipment by handing it over to a designated collection point for the recycling of waste electrical and electronic equipment. The separate collection and recycling of your waste equipment at the time of disposal will help to conserve natural resources and ensure that it is recycled in a manner that protects human health and the environment. For more information about where you can drop off your waste equipment for recycling, please contact your local city office, your household waste disposal service or the shop where you purchased the product.