



---

 **SIMONSWERK**

Hinge Technology  
Issue 5



## SIMONSWERK – Quality

SIMONSWERK is a leading manufacturer of high-quality hinge systems for doors and windows, the focus for which lies in the very latest design and the ultimate in product perfection. The company are committed to innovative product development and the manufacture and sale of their hinges under the motto “The right hinge for the right function”. With a wide-ranging architectural Ironmongery portfolio SIMONSWERK covers almost every area where hinges are required including many special customer solutions.

The Company has developed an extensive range of hinge applications including an outstanding range of high performance solid brass butt and solid aluminium hinges. The usage areas include residential, commercial and leisure markets with hinges manufactured for applications in wood, aluminium, steel, PVCu and glass. The company has won awards for superior levels of customer service and is dedicated to providing high-quality hinge systems for architects, ironmongers, specifiers, interior designers, and building contractors.

## SIMONSWERK – UK

SIMONSWERK UK Ltd, has been producing top quality brass, aluminium and stainless steel hinges for over 35 years and are a wholly owned subsidiary of SIMONSWERK GmbH. The Group are now Europe’s leading supplier of door and window hinge systems to the Architectural Ironmongery and Builders Hardware industry. Based in Tipton, West Midlands a new warehouse was built in 2004 and in 2008 enhanced office and production facilities added. The company are members of the Guild of Architectural Ironmongers.

This catalogue illustrates our UK recommended selection of high performance hinges and hardware for doors, windows, cabinets and conservatories, together with a concise guide to design and use. Our experience enables us to provide in the following pages specification information to assist with the selection of that important “correct hinge for the right function”. Further technical information and tables can be found at the end of this catalogue.



BS EN ISO 9001:2008

Quality & Performance Guaranteed

## INDEX

<b>Hinges</b>	Brass Hinge	Unwashed	Butt Hinge	6		
			Projection	8		
			Parliament	10		
			Counter Flap	11		
			Rising / Falling	13		
			Special Purpose	16		
	Washed	Double Phosphor Bronze	Butt Hinge	20		
			Projection	24		
			Double Stainless Steel	Butt Hinge	28	
				Projection	29	
			Ball Race		Butt Hinge	30
					Projection	34
	Security	39				
	Samson			41		
TriTech			43			
Aluminium Hinge	Washed	Single Delrin	45			
		Double Stainless Steel	46			
		Nylon	48			
		Rising / Falling	49			
Adjustable Hinge		Columbus 3D	52			
		Ultimate 2D	53			
Stainless Steel Hinge		Ball Race	54			
		Rising / Falling	55			
		Spring Hinge	57			
Steel Hinge		Spring Hinge	59			
Nylon Hinge		Unwashed	62			

<b>Hardware</b>	Doorstop	Brass	Concealed Fix	63
			Face Fix	63
			Oval	64
	Floor Stop	Aluminium	Concealed Fix	65
			Face Fix	65
			Oval	66
			Stainless Steel	67
Letter Plate		Aluminium	71	
Flush Bolt		Stainless Steel	73	
		Brass	74	
<b>Technical information</b>	UK Guarantees, Hinge Types, Selection, Specification			75
	Finishes			76
	Hinges Drilled for Projection, Woodscrews			77
	BS EN 1935:2002 Building hardware Single-Axis hinges			78
	Hinge Installation			80

## BRASS HINGE

### Unwashed Brass Butt Hinge

Suitable for cabinets and lightweight flush doors and windows

unwashed butt hinge

Technical Data	920	940	950
Load Capacity (3 Hinges)	–	–	– kg
Height	38.0	51.0	51.0 mm
Width	23.0	28.5	38.0 mm
Knuckle Diameter	4.0	5.0	6.0 mm
Leaf Thickness	1.6	1.7	2.3 mm
Screw Size	4.0	4.0	6.0 g

Technical Data	955	960	965
Load Capacity (3 Hinges)	–	–	10.0 kg
Height	63.0	63.0	75.0 mm
Width	28.5	35.0	35.0 mm
Knuckle Diameter	5.5	5.5	5.5 mm
Leaf Thickness	1.7	2.0	2.0 mm
Screw Size	4.0	6.0	6.0 g

Technical Data	970	1010	1020
Load Capacity (3 Hinges)	10.0	20.0	20.0 kg
Height	75.0	75.0	75.0 mm
Width	42.0	50.0	60.0 mm
Knuckle Diameter	6.0	7.8	8.5 mm
Leaf Thickness	2.0	2.9	3.0/3.6 mm
Screw Size	8.0	8.0	8.0 g

Technical Data	1030	1040	1050
Load Capacity (3 Hinges)	20.0	20.0	20.0 kg
Height	100.0	100.0	100.0 mm
Width	60.0	65.0	75.0 mm
Knuckle Diameter	8.5	9.2	11.0 mm
Leaf Thickness	3.1	3.5	4.0 mm
Screw Size	10.0	10.0	10.0 g

Technical Data	1070	1080
Load Capacity (3 Hinges)	20.0	20.0 kg
Height	125.0	150.0 mm
Width	75.0	75.0 mm
Knuckle Diameter	11.0	11.0 mm
Leaf Thickness	4.0	4.0 mm
Screw Size	12.0	12.0 g

#### Finishes

Self Colour, Polished & lacquered, Satin brass & lacquered, Satin chromium plate, Polished chromium plate, Satin nickel plate, Polished nickel plate, Imitation bronze metal antique

#### Note

Unwashed plain brass butt hinges with 10 year performance guarantee.  
Supplied complete with fixing screws if required.  
Special finishes available upon request see page 76.



0970

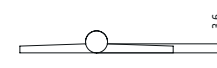
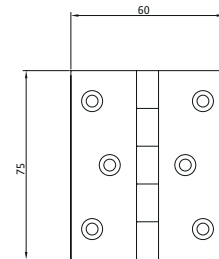

1020

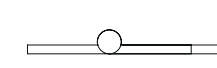
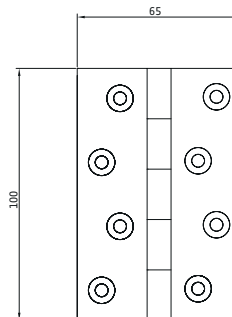

1040



# BRASS HINGE



0305

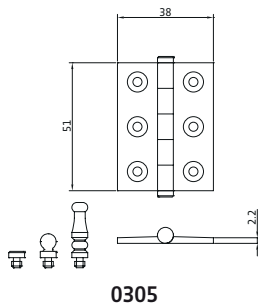

0305

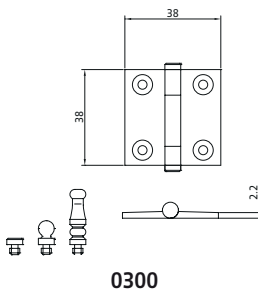

0300

## Unwashed Brass Finial Hinge

Suitable for cabinets and lightweight flush doors and windows

unwashed	finial	butt hinge
----------	--------	------------

Technical Data	0300	0305	0310
Load Capacity (3 Hinges)	20.0	20.0	20.0 kg
Height	38.0	50.0	50.0 mm
Width	38.0	38.0	50.0 mm
Knuckle Diameter	6.3	6.3	6.3 mm
Leaf Thickness	2.2	2.2	2.2 mm
Screw Size	6.0	6.0	6.0 g

Technical Data	0315	0320	0325
Load Capacity (3 Hinges)	20.0	20.0	20.0 kg
Height	63.0	63.0	75.0 mm
Width	50.0	63.0	50.0 mm
Knuckle Diameter	6.3	6.3	6.3 mm
Leaf Thickness	2.2	2.2	2.2 mm
Screw Size	6.0	6.0	6.0 g

### Finishes

Self Colour, Polished & lacquered, Satin brass & lacquered, Satin chromium plate, Polished chromium plate, Satin nickel plate, Polished nickel plate, Imitation bronze metal antique

### Note

Unwashed brass cabinet hinges with detachable decorative finials. Supplied complete with fixing screws if required. Special finishes available upon request see page 76.

### Finial options



STEEPLE



BALL



BUTTON TIP

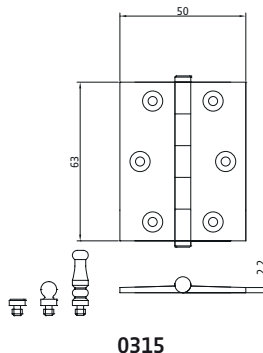

0315

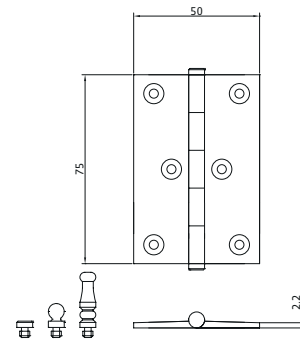

0325

## BRASS HINGE

### Unwashed Brass Projection Hinge

Suitable for lightweight flush doors and french windows

unwashed projection hinge

Technical Data	P1025	P1060	P1075
Load Capacity (3 Hinges)	20.0	20.0	20.0 kg
Height	75.0	100.0	125.0 mm
Width	75.0	100.0	100.0 mm
Knuckle Diameter	11.0	11.0	11.0 mm
Leaf Thickness	4.0	4.0	4.0 mm
Screw Size	10.0	12.0	12.0 g
Amount of Projection	32.0	50.0	50.0 mm

Technical Data	P1085	P1090
Load Capacity (3 Hinges)	20.0	40.0 kg
Height	150.0	125.0 mm
Width	100.0	125.0 mm
Knuckle Diameter	11.0	12.7 mm
Leaf Thickness	4.0	5.0 mm
Screw Size	12.0	12.0 g
Amount of Projection	50.0	68.0 mm

Technical Data	P1095	P1096
Load Capacity (3 Hinges)	40.0	40.0 kg
Height	150.0	150.0 mm
Width	125.0	150.0 mm
Knuckle Diameter	12.7	12.7 mm
Leaf Thickness	5.0	5.0 mm
Screw Size	12.0	12.0 g
Amount of Projection	68.0	75.0 mm

#### Finishes

Self Colour, Polished & lacquered, Satin brass & lacquered, Satin chromium plate, Polished chromium plate, Satin nickel plate, Polished nickel plate, Imitation bronze metal antique

#### Note

Unwashed plain brass projection hinges with 10 year performance guarantee.  
Special finishes available upon request see page 76.  
Supplied complete with fixing screws if required.



P1025

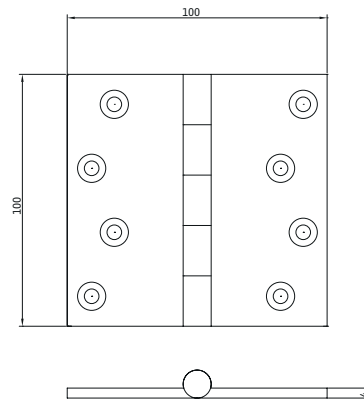

P1060

# BRASS HINGE



P4060

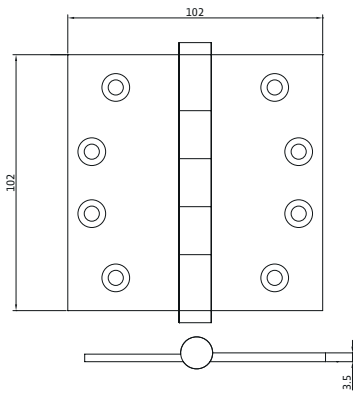

P4060

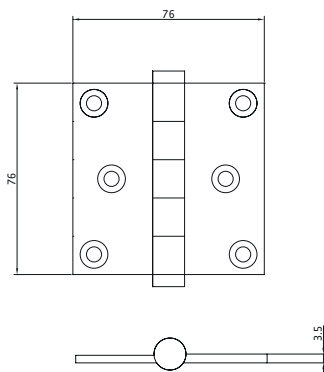

P4020

## Unwashed Brass Finial Projection Hinge

Suitable for lightweight flush doors and french windows

unwashed	finial	projection hinge
----------	--------	------------------

Technical Data	P4020	P4030	P4060
Load Capacity (3 Hinges)	20.0	40.0	40.0 kg
Height	76.0	89.0	102.0 mm
Width	76.0	89.0	102.0 mm
Knuckle Diameter	12.7	12.7	12.7 mm
Leaf Thickness	3.5	3.5	3.5 mm
Screw Size	10.0	10.0	12.0 g
Amount of Projection	32.0	38.0	48.0 mm

### Finishes

Self Colour, Polished & lacquered, Satin brass & lacquered, Satin chromium plate, Polished chromium plate, Satin nickel plate, Polished nickel plate, Imitation bronze metal antique

### Note

Available with threaded detachable button, urn or ball decorative feature finials.  
 Supplied complete with fixing screws if required.  
 Drilled to ANSI pattern.  
 Special finishes available upon request see page 76.

### Finial options

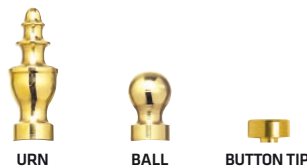

## BRASS HINGE

### Parliament Hinge

Suitable for lightweight flush doors and french windows

parliament

Technical Data	P0550	P0560	P0570
Load Capacity (3 Hinges)	25.0	30.0	35.0 kg
Height	102.0	102.0	102.0 mm
Width	102.0	127.0	152.0 mm
Knuckle Diameter	11.0	12.7	12.7 mm
Leaf Thickness	4.0	5.0	5.0 mm
Screw Size	10.0	10.0	12.0 g
Amount of Projection	64.0	75.0	100.0 mm

#### Finishes

Self Colour, Polished & lacquered, Satin brass & lacquered, Satin chromium plate, Polished chromium plate, Satin nickel plate, Polished nickel plate, Imitation bronze metal antique

#### Note

Supplied complete with fixing screws if required.  
Special finishes available upon request see page 76.



P0560

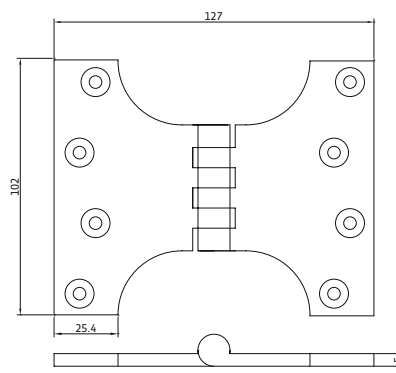

P0560

BRASS HINGE

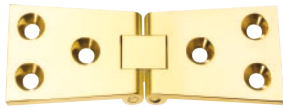

0510

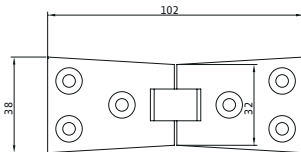

0510

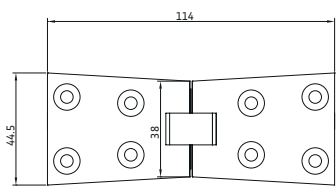

0520



0610

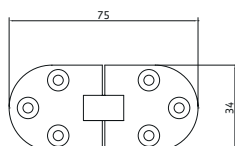

0610

**Counter Flap Dovetail Hinge**

Suitable for bar and shop counters

counter flap			dovetail
--------------	--	--	----------

Technical Data	0500	0510	0520
Load Capacity (2 Hinges)	5.0	10.0	10.0 kg
Height	25.0	32.0/38.0	38.0/44.5 mm
Width	76.0	102.0	114.0 mm
Leaf Thickness	2.6	3.0	4.0 mm
Screw Size	8.0	10.0	10.0 g

**Finishes**

Self Colour, Polished & lacquered, Satin brass & lacquered, Satin chromium plate, Polished chromium plate, Satin nickel plate, Polished nickel plate, Imitation bronze metal antique

**Note**

Brass counterflap hinges for flush wooden counters. Also available with straight edge and radius corners. Supplied complete with fixing screws if required. Special finishes available upon request see page 76.

**Counter Flap Radius Hinge**

Suitable for bar and shop counters

counter flap			radius
--------------	--	--	--------

Technical Data	0610
Height	34.0 mm
Width	75.0 mm
Leaf Thickness	4.0 mm
Screw Size	10.0 g

**Finishes**

See Counter Flap Dovetail Hinge

**Note**

Brass counterflap hinges for flush wooden counters. Supplied complete with fixing screws if required. Special finishes available upon request see page 76.

## BRASS HINGE

### Counter Flap Catch

Suitable for bar and shop counters

counter flap	catch
--------------	-------

Technical Data	0600
Height	36.5 mm
Width	92.0 mm
Max Counter Thickness	53.0 mm
Leaf Thickness	4.0 mm
Screw Size	6.0 g

#### Finishes

Self Colour, Polished & lacquered, Satin brass & lacquered, Satin chromium plate, Polished chromium plate, Satin nickel plate, Polished nickel plate, Imitation bronze metal antique

#### Note

Supplied complete with fixing screws if required.  
Special finishes available upon request see page 76.

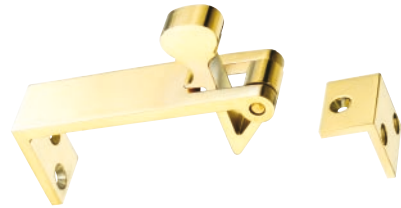

0600

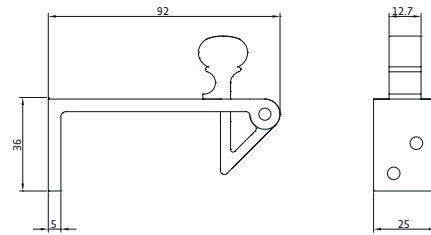

0600

# BRASS HINGE



1841

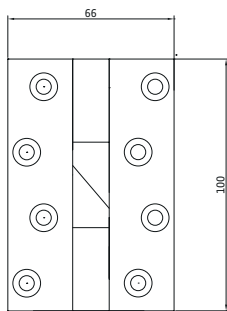

1841

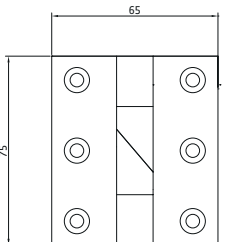

1811

## Brass Falling Hinge

Suitable for medium weight toilet cubicle & internal flush doors

falling

Technical Data	1811	1841
Load Capacity (2 Hinges)	40.0	45.0 kg
Height	75.0	100.0 mm
Width	65.0	65.0 mm
Knuckle Diameter	14.5	14.5 mm
Leaf Thickness	4.0	4.0 mm
Screw Size	10.0	10.0 g

### Finishes

Self Colour, Polished & lacquered, Satin brass & lacquered, Satin chromium plate, Polished chromium plate, Satin nickel plate, Polished nickel plate, Imitation bronze metal antique

### Note

Rise or fall of 13mm at 180°

Brass Pin

Fitted with heavy duty bronze skewers for long life & high resistance to corrosion.

Radius corners optional, by special request.

Handed left or right see fig 2 page 80.

Supplied complete with fixing screws if required.

Special finishes available upon request see page 76.

## BRASS HINGE

### Brass Rising Hinge

Suitable for medium weight toilet cubicle & internal flush doors

rising

Technical Data	1810	1840
Load Capacity (2 Hinges)	40.0	45.0 kg
Height	75.0	100.0 mm
Width	65.0	65.0 mm
Knuckle Diameter	14.5	14.5 mm
Leaf Thickness	4.0	4.0 mm
Screw Size	10.0	10.0 g

#### Finishes

Self Colour, Polished & lacquered, Satin brass & lacquered, Satin chromium plate, Polished chromium plate, Satin nickel plate, Polished nickel plate, Imitation bronze metal antique

#### Note

Rise or fall of 13mm at 180°

Brass Pin

Fitted with heavy duty bronze skewers for long life & high resistance to corrosion.

Radius corners optional, by special request.

Handed left or right see fig 2 page 80.

Supplied complete with fixing screws if required.

Special finishes available upon request see page 76.



1840

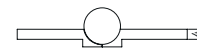
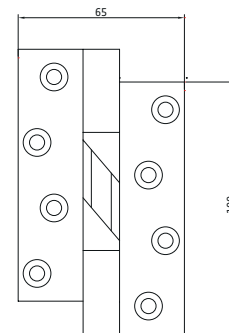

1840

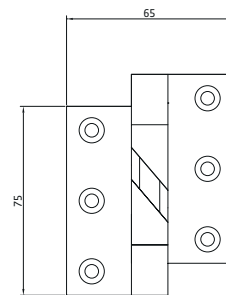

1810

## BRASS HINGE



0100

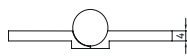
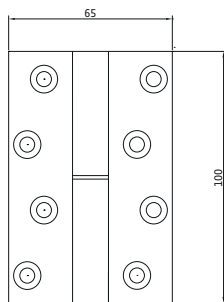

0100

**Brass Support Hinge**

Suitable for medium weight toilet cubicle & internal flush doors

rising

brass

**Technical Data****0100**

Load Capacity (2 Hinges)	65.0 kg
Height	100.0 mm
Width	65.0 mm
Knuckle Diameter	14.5 mm
Leaf Thickness	4.0 mm
Screw Size	10.0 g

**Finishes**

Self Colour, Polished & lacquered, Satin brass & lacquered, Satin chromium plate, Polished chromium plate, Satin nickel plate, Polished nickel plate, Imitation bronze metal antique

**Note**

Fitted with one pair of normal brass rising hinges.  
 Increases weight carrying capacity up to 65 kilos.  
 Supports the top of the door preventing any leverage problems.  
 Handed left or right see fig 2 page 80.  
 Supplied complete with fixing screws if required.  
 Special finishes available upon request see page 76.

## BRASS HINGE

### Brass Lift Off Hinge

Suitable for use on cabinets and lightweight doors

special purpose lift off

Technical Data	0901	0902
Load Capacity (2 Hinges)	10.0	20.0 kg
Height	75.0	75.0 mm
Width	42.0	50.0 mm
Knuckle Diameter	6.0	7.8 mm
Leaf Thickness	2.0	2.9 mm
Screw Size	8.0	8.0 g

#### Finishes

Self Colour, Polished & lacquered, Satin brass & lacquered, Satin chromium plate, Polished chromium plate, Satin nickel plate, Polished nickel plate, Imitation bronze metal antique

#### Note

Brass lift off hinges for easy removal of the door.

Lift off hinges are handed see fig. 2 page 80.

Suitable for use on wooden box lids, wooden chests etc.

Supplied complete with fixing screws if required.

Special finishes available upon request see page 76.



0901

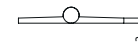
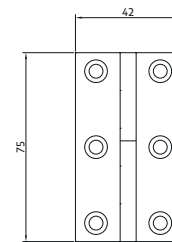

0901

## BRASS HINGE



0960EH

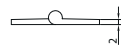
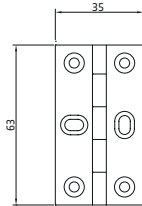

0960EH

### Brass Elongated Screw Hole Hinge

Suitable for use on cabinets and lightweight doors

special purpose

elongated

Technical Data	0950EH	0960EH
Load Capacity (2 Hinges)	10.0	10.0 kg
Height	50.0	63.0 mm
Width	38.0	35.0 mm
Knuckle Diameter	6.0	5.5 mm
Leaf Thickness	2.3	2.0 mm
Screw Size	6.0	6.0 g

#### Finishes

Self Colour, Polished & lacquered, Satin brass & lacquered, Satin chromium plate, Polished chromium plate, Satin nickel plate, Polished nickel plate, Imitation bronze metal antique

#### Note

Brass elongated screw hole cabinet hinges allowing fine adjustment before final fit. Suitable for use on wooden box lids, wooden chests etc. Supplied complete with fixing screws if required. Special finishes available upon request see page 76.

# BRASS HINGE

## Brass Back Flap Hinge

Suitable for use on cabinets and lightweight doors

special purpose back flap

Technical Data	0400	0410	0420
Load Capacity (2 Hinges)	5.0	10.0	15.0 kg
Height	32.0	38.0	51.0 mm
Width	48.0	60.0	76.0 mm
Knuckle Diameter	5.5	6.3	7.8 mm
Leaf Thickness	1.9	1.8/2.5	3.5/2.7 mm
Screw Size	6.0	6.0	8.0 g

Technical Data	0425	0430
Load Capacity (2 Hinges)	15.0	20.0 kg
Height	63.0	76.0 mm
Width	102.0	127.0 mm
Knuckle Diameter	9.3	9.3 mm
Leaf Thickness	3.8	4.0 mm
Screw Size	10.0	12.0 g

### Finishes

Self Colour, Polished & lacquered, Satin brass & lacquered, Satin chromium plate, Polished chromium plate, Satin nickel plate, Polished nickel plate, Imitation bronze metal antique

### Note

Brass back flap hinges for face fixing.  
 Suitable for use on wooden box lids, wooden chests etc.  
 Supplied complete with fixing screws if required  
 Special finishes available upon request see page 76.



0420

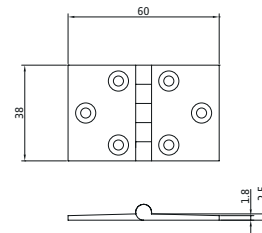

0410

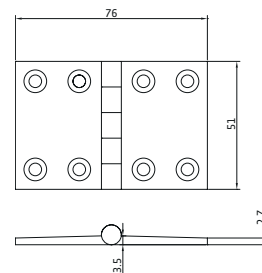

0420

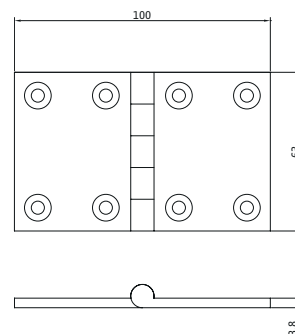

0425

## BRASS HINGE



0990

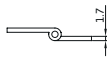
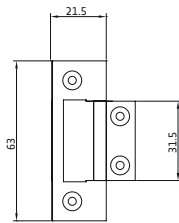

0990

## Brass Flush Hinge

Suitable for use on cabinets and lightweight doors

special purpose flush

Technical Data	0985	0990
Load Capacity (2 Hinges)	5.0	7.5 kg
Height	51.0	63.0 mm
Width	21.5	21.5 mm
Knuckle Diameter	5.0	5.0 mm
Leaf Thickness	1.7	1.7 mm
Screw Size	6.0	6.0 g

### Finishes

Self Colour, Polished & lacquered, Satin brass & lacquered, Satin chromium plate, Polished chromium plate, Satin nickel plate, Polished nickel plate, Imitation bronze metal antique

### Note

Brass flush hinges reducing the need to mortice hinges into cabinets.  
 Suitable for use on wooden boxlids, wooden chests etc.  
 Supplied complete with fixing screws if required  
 Special finishes available upon request see page 76.

## BRASS HINGE

**Washed DPB Brass Butt Hinge**

Suitable for medium to heavy weight flush doors Grade 7

washed DPB butt hinge

Technical Data	1210	1240
Load Capacity (3 Hinges)	20.0	40.0 kg
Height	75.0	100.0 mm
Width	50.0	65.0 mm
Knuckle Diameter	7.8	9.2 mm
Leaf Thickness	3.0	3.5 mm
Screw Size	8.0	10.0 g

Technical Data	1250	1270	1280
Load Capacity (3 Hinges)	40.0	40.0	40.0 kg
Height	100.0	125.0	150.0 mm
Width	75.0	75.0	75.0 mm
Knuckle Diameter	11.0	11.0	11.0 mm
Leaf Thickness	4.0	4.0	4.0 mm
Screw Size	10.0	12.0	12.0 g

**Finishes**

Self Colour, Polished & lacquered, Satin brass & lacquered, Satin chromium plate, Polished chromium plate, Satin nickel plate, Polished nickel plate, Imitation bronze metal antique

**Note**

Double phosphor bronze tab washed brass butt & projection hinges with 10 year performance guarantee.

Supplied complete with fixing screws if required.

Special finishes available upon request see page 76.

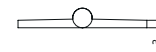
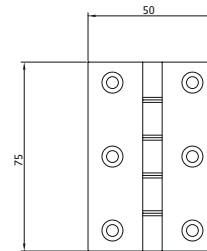
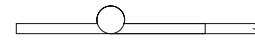
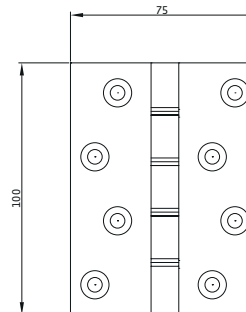
**1210****1210****1250**

BRASS HINGE

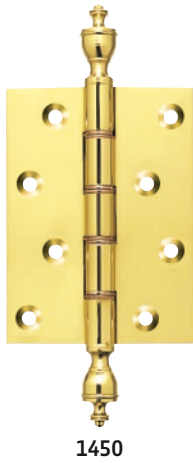

1450

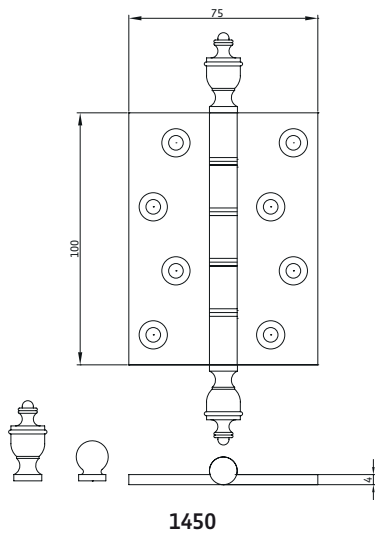

1450

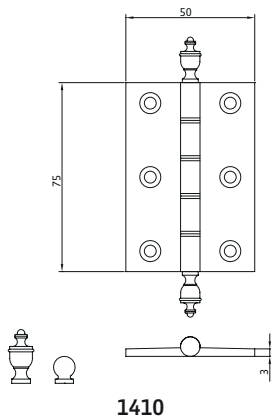

1410

Washed DPB Brass Finial Hinge

Suitable for medium to heavy flush doors Grade 7

washed DPB	finial	butt hinge
------------	--------	------------

Technical Data	1410	1440
Load Capacity (3 Hinges)	20.0	40.0 kg
Height	75.0	100.0 mm
Width	50.0	65.0 mm
Knuckle Diameter	7.8	9.2 mm
Leaf Thickness	3.0	3.5 mm
Screw Size	8.0	10.0 g

Technical Data	1450	1470	1480
Load Capacity (3 Hinges)	40.0	40.0	40.0 kg
Height	100.0	125.0	150.0 mm
Width	75.0	75.0	75.0 mm
Knuckle Diameter	11.0	11.0	11.0 mm
Leaf Thickness	4.0	4.0	4.0 mm
Screw Size	10.0	12.0	12.0 g

Finishes

Self Colour, Polished & lacquered, Satin brass & lacquered, Satin chromium plate, Polished chromium plate, Satin nickel plate, Polished nickel plate, Imitation bronze metal antique

Note

Double phosphor bronze tab washed brass finial hinges with 10 year performance guarantee.

Available with urn or ball type decorative finials.

Supplied complete with fixing screws if required.

Special finishes available upon request see page 76.

Finial options



## BRASS HINGE

### Washed DPB Brass CE Butt Hinge

Suitable for medium to heavy weight flush doors Grade 7

washed DPB butt hinge CE

Technical Data	1240CE	1250CE
Load Capacity (3 Hinges)	40.0	40.0 kg
Height	100.0	100.0 mm
Width	65.0	75.0 mm
Knuckle Diameter	9.2	11.0 mm
Leaf Thickness	3.5	4.0 mm
Screw Size	10.0	10.0 g

Technical Data	1270CE	1280CE
Load Capacity (3 Hinges)	40.0	40.0 kg
Height	125.0	150.0 mm
Width	75.0	75.0 mm
Knuckle Diameter	11.0	11.0 mm
Leaf Thickness	4.0	4.0 mm
Screw Size	12.0	12.0 g

#### Finishes

Self Colour, Polished & lacquered, Satin brass & lacquered, Satin chromium plate, Polished chromium plate, Satin nickel plate, Polished nickel plate, Imitation bronze metal antique

#### Note

Double phosphor bronze tab washed brass butt & projection hinges with 10 year performance guarantee.

Supplied complete with fixing screws if required.

CE marked versions suitable for use on 1/2 hour fire and escape doorsets -supplied complete with intumescent fire pads.

Special finishes available upon request see page 76.

#### Classification key

2	7	2	1	1	4	0	7
---	---	---	---	---	---	---	---

BS EN1935: 2002 Eight Digit Code (p78 for details)



1250CE

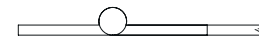
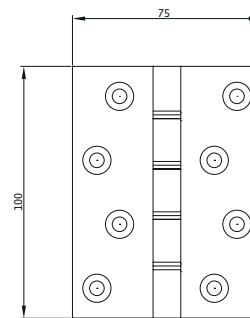

1250CE

BRASS HINGE



1450CE

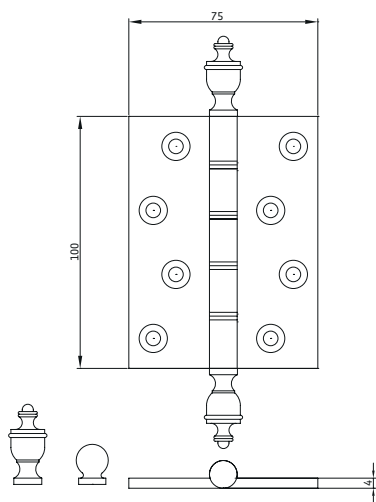

1450CE

Washed DPB Brass CE Finial Hinge

Suitable for medium to heavy flush doors Grade 7

washed DPB	finial	butt hinge CE
------------	--------	---------------

Technical Data	1440CE	1450CE
Load Capacity (3 Hinges)	40.0	40.0 kg
Height	100.0	100.0 mm
Width	65.0	75.0 mm
Knuckle Diameter	9.2	11.0 mm
Leaf Thickness	3.5	4.0 mm
Screw Size	10.0	10.0 g

Technical Data	1470CE	1480CE
Load Capacity (3 Hinges)	40.0	40.0 kg
Height	125.0	150.0 mm
Width	75.0	75.0 mm
Knuckle Diameter	11.0	11.0 mm
Leaf Thickness	4.0	4.0 mm
Screw Size	12.0	12.0 g

Finishes

Self Colour, Polished & lacquered, Satin brass & lacquered, Satin chromium plate, Polished chromium plate, Satin nickel plate, Polished nickel plate, Imitation bronze metal antique

Note

Double phosphor bronze tab washed brass finial hinges with 10 year performance guarantee.

Available with urn or ball type decorative finials.

CE marked versions suitable for use on 1/2 hour fire and escape doorsets - supplied complete with intumescent pads.

Supplied complete with fixing screws if required.

Special finishes available upon request see page 76.

Classification key

2	7	2	1	1	4	0	7
---	---	---	---	---	---	---	---

BS EN1935: 2002 Eight Digit Code (p78 for details)

Finial options



## BRASS HINGE

**Washed DPB Brass Projection Hinge**

Suitable for medium to heavy flush doors Grade 7 and 11

washed DPB projection hinge

Technical Data	P1260	P1262	P1264
Load Capacity (3 Hinges)	40.0	80.0	80.0 kg
Height	100.0	100.0	100.0 mm
Width	100.0	125.0	150.0 mm
Knuckle Diameter	11.0	12.5	12.5 mm
Leaf Thickness	4.0	5.0	5.0 mm
Screw Size	12.0	12.0	12.0 g
Amount of Projection	50.0	68.0	85.0 mm

Technical Data	P1266	P1275	P1285
Load Capacity (3 Hinges)	80.0	40.0	40.0 kg
Height	100.0	125.0	150.0 mm
Width	200.0	100.0	100.0 mm
Knuckle Diameter	12.5	11.0	11.0 mm
Leaf Thickness	5.0	4.0	4.0 mm
Screw Size	12.0	12.0	12.0 g
Amount of Projection	100.0	50.0	50.0 mm

Technical Data	P1295	P1296
Load Capacity (3 Hinges)	80.0	80.0 kg
Height	150.0	150.0 mm
Width	125.0	150.0 mm
Knuckle Diameter	12.5	12.5 mm
Leaf Thickness	5.0	5.0 mm
Screw Size	12.0	12.0 g
Amount of Projection	68.0	85.0 mm

**Finishes**

Self Colour, Polished & lacquered, Satin brass & lacquered, Satin chromium plate, Polished chromium plate, Satin nickel plate, Polished nickel plate, Imitation bronze metal antique

**Note**

Double phosphor bronze tab washed brass butt & projection hinges with 10 year performance guarantee.

Supplied complete with fixing screws if required.

Special finishes available upon request see page 76.



P1262

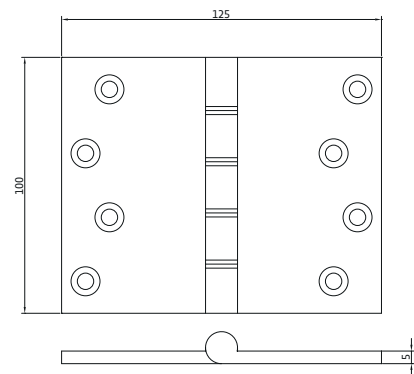

P1262

BRASS HINGE

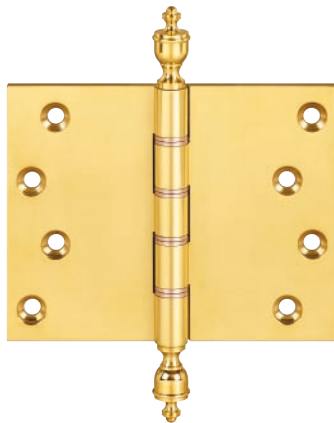

P1462

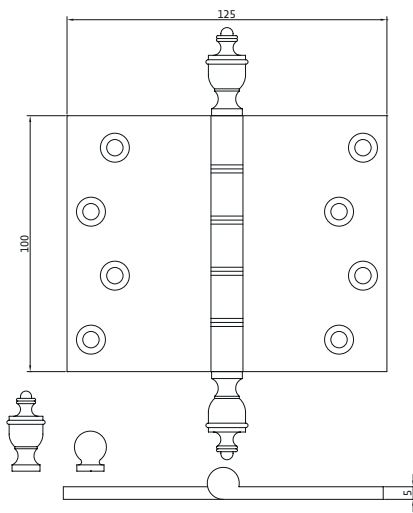

P1462

Washed DPB Brass Finial Projection Hinge

Suitable for medium to heavy flush doors Grade 7 and 11

washed DPB	finial	projection hinge
------------	--------	------------------

Technical Data	P1460	P1462	P1464
Load Capacity (3 Hinges)	40.0	80.0	80.0 kg
Height	100.0	100.0	100.0 mm
Width	100.0	125.0	150.0 mm
Knuckle Diameter	11.0	12.5	12.5 mm
Leaf Thickness	4.0	5.0	5.0 mm
Screw Size	12.0	12.0	12.0 g
Amount of Projection	50.0	68.0	85.0 mm

Technical Data	P1466	P1475	P1485
Load Capacity (3 Hinges)	80.0	40.0	40.0 kg
Height	100.0	125.0	150.0 mm
Width	200.0	100.0	100.0 mm
Knuckle Diameter	12.5	11.0	11.0 mm
Leaf Thickness	5.0	4.0	4.0 mm
Screw Size	12.0	12.0	12.0 g
Amount of Projection	100.0	50.0	50.0 mm

Finishes

Self Colour, Polished & lacquered, Satin brass & lacquered, Satin chromium plate, Polished chromium plate, Satin nickel plate, Polished nickel plate, Imitation bronze metal antique

Note

Double phosphor bronze tab washed brass finial hinges with 10 year performance guarantee.  
Available with urn or ball type decorative finials.  
Supplied complete with fixing screws if required.  
Special finishes available upon request see page 76.

Finial options



URN

BALL

## BRASS HINGE

### Washed DPB Brass CE Projection Hinge

Suitable for medium to heavy flush doors Grade 7 and 11

washed DPB

projection hinge CE

Technical Data	P1260CE	P1285CE
Load Capacity (3 Hinges)	40.0	40.0 kg
Height	100.0	150.0 mm
Width	100.0	100.0 mm
Knuckle Diameter	11.0	11.0 mm
Leaf Thickness	4.0	4.0 mm
Screw Size	12.0	12.0 g
Amount of Projection	50.0	50.0 mm

#### Finishes

Self Colour, Polished & lacquered, Satin brass & lacquered, Satin chromium plate, Polished chromium plate, Satin nickel plate, Polished nickel plate, Imitation bronze metal antique

#### Note

Double phosphor bronze tab washed brass butt & projection hinges with 10 year performance guarantee.

CE marked versions suitable for use on 1/2 hour fire and escape doorsets - supplied complete with intumescent pads.

Supplied complete with fixing screws if required.

Special finishes available upon request see page 76.

#### Classification key

2	7	2	1	1	4	0	7
---	---	---	---	---	---	---	---

BS EN1935: 2002 Eight Digit Code (p78 for details)



P1260

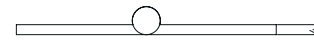
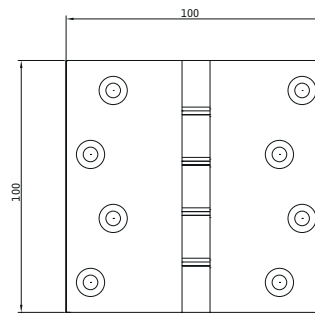

P1260

BRASS HINGE



P1460CE

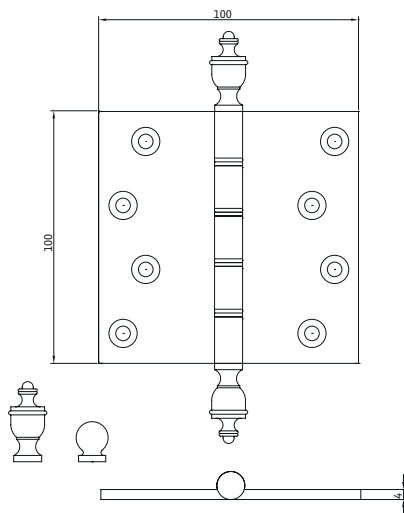

P1460CE

Washed DPB Brass CE Finial Projection Hinge

Suitable for medium to heavy flush doors Grade 7 and 11

washed DPB	finial	projection hinge CE
------------	--------	---------------------

Technical Data	P1460CE	P1485CE
Load Capacity (3 Hinges)	40.0	40.0 kg
Height	100.0	150.0 mm
Width	100.0	100.0 mm
Knuckle Diameter	11.0	11.0 mm
Leaf Thickness	4.0	4.0 mm
Screw Size	12.0	12.0 g
Amount of Projection	50.0	50.0 mm

Finishes

Self Colour, Polished & lacquered, Satin brass & lacquered, Satin chromium plate, Polished chromium plate, Satin nickel plate, Polished nickel plate, Imitation bronze metal antique

Note

Double phosphor bronze tab washed brass finial hinges with 10 year performance guarantee.

Available with urn or ball type decorative finials.

CE marked versions suitable for use on 1/2 hour fire and escape doorsets - supplied complete with intumescent pads.

Supplied complete with fixing screws if required.

Special finishes available upon request see page 76.

Classification key

2	7	2	1	1	4	0	7
---	---	---	---	---	---	---	---

BS EN1935: 2002 Eight Digit Code (p78 for details)

Finial options



URN

BALL

## BRASS HINGE

### Washed DSS Brass Butt Hinge

Suitable for medium to heavy weight flush doors

washed DSS butt hinge

Technical Data	1210	1240	1250
Load Capacity (3 Hinges)	20.0	40.0	40.0 kg
Height	75.0	100.0	100.0 mm
Width	50.0	65.0	75.0 mm
Knuckle Diameter	7.8	9.2	11.0 mm
Leaf Thickness	3.0	3.5	4.0 mm
Screw Size	8.0	10.0	10.0 g

#### Finishes

Self Colour, Polished & lacquered, Satin brass & lacquered, Satin chromium plate, Polished chromium plate, Satin nickel plate, Polished nickel plate, Imitation bronze metal antique

#### Note

Double stainless steel tab washed brass butt & projection hinges with 10 year performance guarantee.

Supplied complete with fixing screws if required.

Special finishes available upon request see page 76.



1210

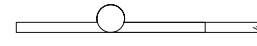
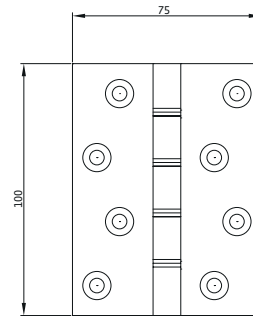

1250

# BRASS HINGE



P1260

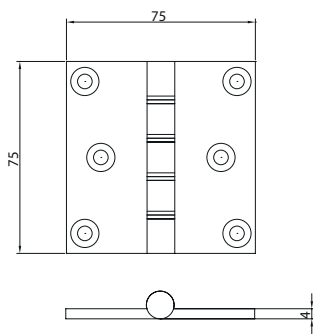

P1225

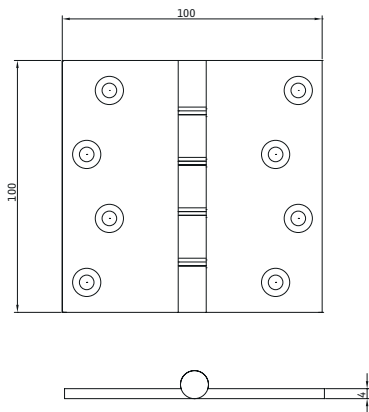

P1260

## Washed DSS Brass Projection Hinge

Suitable for medium to heavy weight flush doors

washed DSS		projection hinge
------------	--	------------------

Technical Data	P1225	P1260
Load Capacity (3 Hinges)	20.0	40.0 kg
Height	75.0	100.0 mm
Width	75.0	100.0 mm
Knuckle Diameter	11.0	11.0 mm
Leaf Thickness	4.0	4.0 mm
Screw Size	10.0	12.0 g
Amount of Projection	32.0	50.0 mm

### Finishes

Self Colour, Polished & lacquered, Satin brass & lacquered, Satin chromium plate, Polished chromium plate, Satin nickel plate, Polished nickel plate, Imitation bronze metal antique

### Note

Double stainless steel tab washed brass butt & projection hinges with 10 year performance guarantee.

Supplied complete with fixing screws if required.

Special finishes available upon request see page 76.

## BRASS HINGE

### Ball Race Brass Butt Hinge

Suitable for medium to heavy weight flush doors Grade 11

ball race butt hinge

Technical Data	1540	1550
Load Capacity (3 Hinges)	60.0	80.0 kg
Height	100.0	100.0 mm
Width	65.0	75.0 mm
Knuckle Diameter	9.2	11.0 mm
Leaf Thickness	3.5	4.0 mm
Screw Size	10.0	10.0 g

Technical Data	1570	1580
Load Capacity (3 Hinges)	80.0	80.0 kg
Height	125.0	150.0 mm
Width	75.0	75.0 mm
Knuckle Diameter	11.0	11.0 mm
Leaf Thickness	4.0	4.0 mm
Screw Size	12.0	12.0 g

#### Finishes

Self Colour, Polished & lacquered, Satin brass & lacquered, Satin chromium plate, Polished chromium plate, Satin nickel plate, Polished nickel plate, Imitation bronze metal antique

#### Note

Ball race brass butt hinges with 10 year performance guarantee.  
Supplied complete with fixing screws if required.  
Special finishes available upon request see page 76.



1550

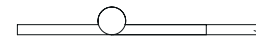
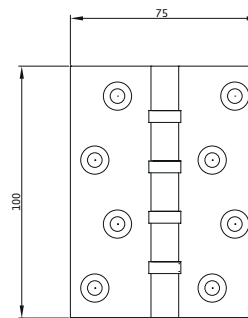

1550

# BRASS HINGE

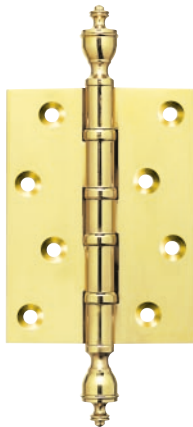

1650

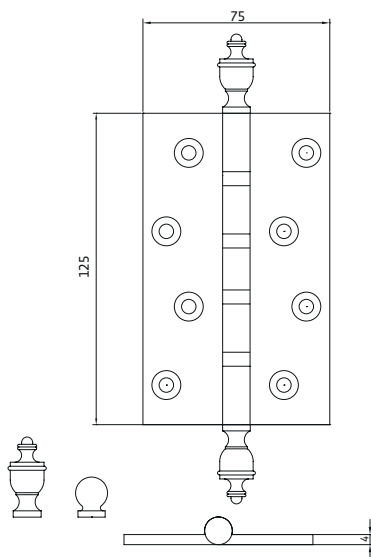

1670

## Ball Race Brass Finial Hinge

Suitable for medium to heavy weight flush doors Grade 11

ball race	finial	butt hinge
<b>Technical Data</b>		
	<b>1640</b>	<b>1650</b>
Load Capacity (3 Hinges)	60.0	80.0 kg
Height	100.0	100.0 mm
Width	65.0	75.0 mm
Knuckle Diameter	9.2	11.0 mm
Leaf Thickness	3.5	4.0 mm
Screw Size	10.0	10.0 g

<b>Technical Data</b>		
	<b>1670</b>	<b>1680</b>
Load Capacity (3 Hinges)	80.0	80.0 kg
Height	125.0	150.0 mm
Width	75.0	75.0 mm
Knuckle Diameter	11.0	11.0 mm
Leaf Thickness	4.0	4.0 mm
Screw Size	12.0	12.0 g

### Finishes

Self Colour, Polished & lacquered, Satin brass & lacquered, Satin chromium plate, Polished chromium plate, Satin nickel plate, Polished nickel plate, Imitation bronze metal antique

### Note

Ball race brass finial hinges with 10 year performance guarantee.  
Available with urn or ball type decorative finials.  
Supplied complete with fixing screws if required.  
Special finishes available upon request see page 76.

### Finial options



URN

BALL

## BRASS HINGE

### Ball Race Brass CE Butt Hinge

Suitable for medium to heavy weight flush doors Grade 11

ball race butt hinge CE

Technical Data	1540CE	1550CE
Load Capacity (3 Hinges)	60.0	80.0 kg
Height	100.0	100.0 mm
Width	65.0	75.0 mm
Knuckle Diameter	9.2	11.0 mm
Leaf Thickness	3.5	4.0 mm
Screw Size	10.0	10.0 g

Technical Data	1570CE	1580CE
Load Capacity (3 Hinges)	80.0	80.0 kg
Height	125.0	150.0 mm
Width	75.0	75.0 mm
Knuckle Diameter	11.0	11.0 mm
Leaf Thickness	4.0	4.0 mm
Screw Size	12.0	12.0 g

#### Finishes

Self Colour, Polished & lacquered, Satin brass & lacquered, Satin chromium plate, Polished chromium plate, Satin nickel plate, Polished nickel plate, Imitation bronze metal antique

#### Note

Ball race brass CE butt hinges with 10 year performance guarantee.  
CE marked versions suitable for use on 1/2 hour fire and escape doorsets - supplied complete with intumescent pads.  
Supplied complete with fixing screws if required.  
Special finishes available upon request see page 76.

#### Classification key

3	7	4	1	1	4	0	11
---	---	---	---	---	---	---	----

BS EN1935: 2002 Eight Digit Code (p78 for details)



1550CE

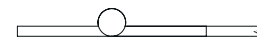
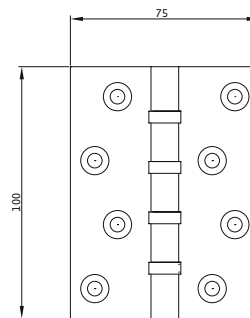

1550CE

BRASS HINGE

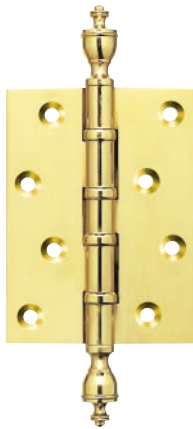

1650CE

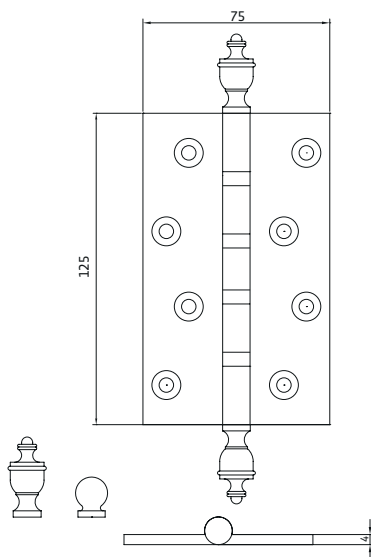

1670CE

**Ball Race Brass CE Finial Hinge**

Suitable for medium to heavy weight flush doors Grade 11

ball race	finial	butt hinge CE
-----------	--------	---------------

Technical Data	1640CE	1650CE
Load Capacity (3 Hinges)	60.0	80.0 kg
Height	100.0	100.0 mm
Width	65.0	75.0 mm
Knuckle Diameter	9.2	11.0 mm
Leaf Thickness	3.5	4.0 mm
Screw Size	10.0	10.0 g

Technical Data	1670CE	1680CE
Load Capacity (3 Hinges)	80.0	80.0 kg
Height	125.0	150.0 mm
Width	75.0	75.0 mm
Knuckle Diameter	11.0	11.0 mm
Leaf Thickness	4.0	4.0 mm
Screw Size	12.0	12.0 g

**Finishes**

Self Colour, Polished & lacquered, Satin brass & lacquered, Satin chromium plate, Polished chromium plate, Satin nickel plate, Polished nickel plate, Imitation bronze metal antique

**Note**

Ball race brass CE finial hinges with 10 year performance guarantee.

Available with urn or ball type decorative finials.

Supplied complete with fixing screws if required.

CE marked versions suitable for use on 1/2 hour fire and escape doorsets -supplied complete with intumescent fire pads.

Special finishes available upon request see page 76.

**Classification key**

3	7	4	1	1	4	0	11
---	---	---	---	---	---	---	----

BS EN1935: 2002 Eight Digit Code (p78 for details)

**Finial options**



URN



BALL



## BRASS HINGE

### Ball Race Brass Projection Hinge

Suitable for medium to heavy weight flush doors Grade 11

ball race projection hinge

Technical Data	P1560	P1575	P1585
Load Capacity (3 Hinges)	80.0	80.0	80.0 kg
Height	100.0	125.0	150.0 mm
Width	100.0	100.0	100.0 mm
Knuckle Diameter	11.0	11.0	11.0 mm
Leaf Thickness	4.0	4.0	4.0 mm
Screw Size	12.0	12.0	12.0 g
Amount of Projection	50.0	50.0	50.0 mm

Technical Data	P1590	P1595
Load Capacity (3 Hinges)	80.0	80.0 kg
Height	125.0	150.0 mm
Width	125.0	125.0 mm
Knuckle Diameter	12.7	12.7 mm
Leaf Thickness	5.0	5.0 mm
Screw Size	12.0	12.0 g
Amount of Projection	68.0	68.0 mm

#### Finishes

Self Colour, Polished & lacquered, Satin brass & lacquered, Satin chromium plate, Polished chromium plate, Satin nickel plate, Polished nickel plate, Imitation bronze metal antique

#### Note

Ball race brass projection hinges with 10 year performance guarantee.  
Supplied complete with fixing screws if required.  
Special finishes available upon request see page 76.



P1590

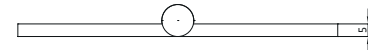
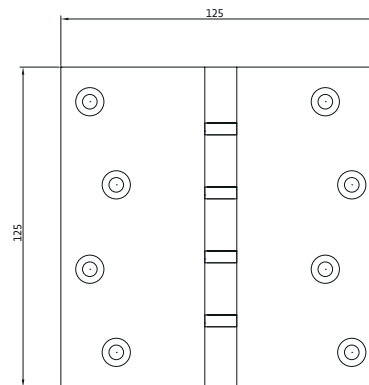

P1590



P1660

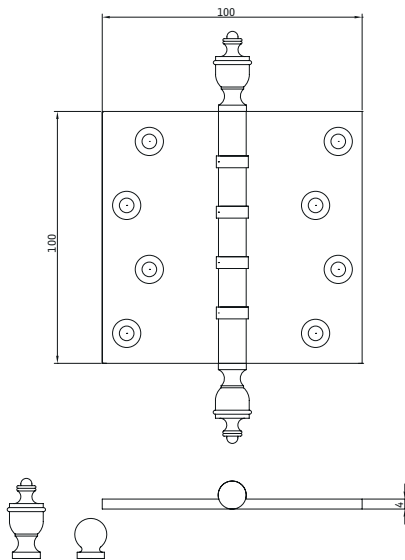

P1660

### Ball Race Brass Finial Projection Hinge

Suitable for medium to heavy weight flush doors Grade 11

ball race	finial	projection hinge
-----------	--------	------------------

Technical Data	P1660	P1675	P1685
Load Capacity (3 Hinges)	80.0	80.0	80.0 kg
Height	100.0	125.0	150.0 mm
Width	100.0	100.0	100.0 mm
Knuckle Diameter	11.0	11.0	11.0 mm
Leaf Thickness	4.0	4.0	4.0 mm
Screw Size	12.0	12.0	12.0 g
Amount of Projection	50.0	50.0	50.0 mm

#### Finishes

Self Colour, Polished & lacquered, Satin brass & lacquered, Satin chromium plate, Polished chromium plate, Satin nickel plate, Polished nickel plate, Imitation bronze metal antique

#### Note

Ball race brass finial projection hinges with 10 year performance guarantee.

Available with urn or ball type decorative finials.

Supplied complete with fixing screws if required.

Special finishes available upon request see page 76.

#### Finial options



URN



BALL

## BRASS HINGE

### Ball Race Brass Finial Projection Hinge

Suitable for medium to heavy weight flush doors Grade 11

ball race	finial	projection hinge
-----------	--------	------------------

Technical Data	P4620	P4630	P4660
Load Capacity (3 Hinges)	40.0	60.0	80.0 kg
Height	76.0	89.0	102.0 mm
Width	76.0	89.0	102.0 mm
Knuckle Diameter	12.7	12.7	12.7 mm
Leaf Thickness	3.5	3.5	3.5 mm
Screw Size	10.0	10.0	12.0 g
Amount of Projection	32.0	38.0	48.0 mm

#### Finishes

Self Colour, Polished & lacquered, Satin brass & lacquered, Satin chromium plate, Polished chromium plate, Satin nickel plate, Polished nickel plate, Imitation bronze metal antique

#### Note

Ball race brass finial projection hinges with 10 year performance guarantee.  
Available with threaded detachable button, urn or ball decorative feature finials.  
Supplied complete with fixing screws if required.  
Drilled to ANSI pattern.  
Special finishes available upon request see page 76.

#### Finial options



URN



BALL



BUTTON TIP



P4660

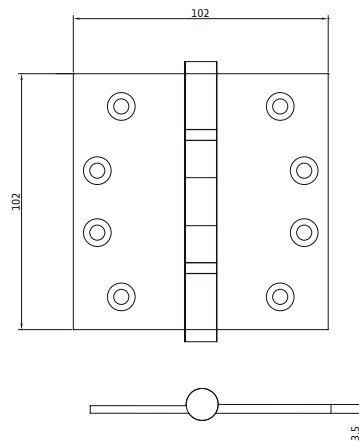

P4660

BRASS HINGE



P1590

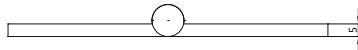
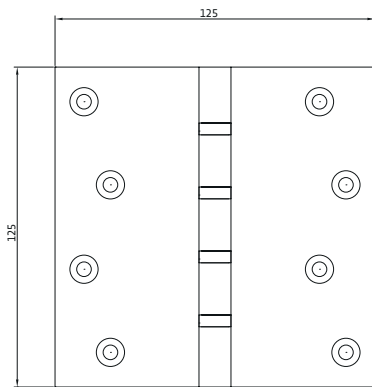

P1590

**Ball Race Brass CE Projection Hinge**

Suitable for medium to heavy weight flush doors Grade 11

ball race | projection hinge CE

Technical Data	P1560CE	P1585CE
Load Capacity (3 Hinges)	80.0	80.0 kg
Height	100.0	150.0 mm
Width	100.0	100.0 mm
Knuckle Diameter	11.0	11.0 mm
Leaf Thickness	4.0	4.0 mm
Screw Size	12.0	12.0 g
Amount of Projection	50.0	50.0 mm

Technical Data	P1590CE	P1595CE
Load Capacity (3 Hinges)	80.0	80.0 kg
Height	125.0	150.0 mm
Width	125.0	125.0 mm
Knuckle Diameter	12.7	12.7 mm
Leaf Thickness	5.0	5.0 mm
Screw Size	12.0	12.0 g
Amount of Projection	68.0	68.0 mm

**Finishes**

Self Colour, Polished & lacquered, Satin brass & lacquered, Satin chromium plate, Polished chromium plate, Satin nickel plate, Polished nickel plate, Imitation bronze metal antique

**Note**

Ball race brass CE butt hinges with 10 year performance guarantee.  
 CE marked versions suitable for use on 1/2 hour fire and escape doorsets - supplied complete with intumescent pads.  
 Supplied complete with fixing screws if required.  
 Special finishes available upon request see page 76.

**Classification key**

3	7	4	1	1	4	0	11
---	---	---	---	---	---	---	----

BS EN1935: 2002 Eight Digit Code (p78 for details)

## BRASS HINGE

### Ball Race Brass CE Finial Projection Hinge

Suitable for medium to heavy weight flush doors Grade 11

ball race	finial	projection hinge CE
-----------	--------	---------------------

Technical Data	P1660CE	P1685CE
Load Capacity (3 Hinges)	80.0	80.0 kg
Height	100.0	150.0 mm
Width	100.0	100.0 mm
Knuckle Diameter	11.0	11.0 mm
Leaf Thickness	4.0	4.0 mm
Screw Size	12.0	12.0 g
Amount of Projection	50.0	50.0 mm

#### Finishes

Self Colour, Polished & lacquered, Satin brass & lacquered, Satin chromium plate, Polished chromium plate, Satin nickel plate, Polished nickel plate, Imitation bronze metal antique

#### Note

Ball race brass CE finial projection hinges with 10 year performance guarantee.  
Available with urn or ball type decorative finials.  
CE marked versions suitable for use on 1/2 hour fire and escape doorsets - supplied complete with intumescent pads.  
Supplied complete with fixing screws if required.  
Special finishes available upon request see page 76.

#### Classification key

3	7	4	1	1	4	0	11
---	---	---	---	---	---	---	----

BS EN1935: 2002 Eight Digit Code (p78 for details)

#### Finial options

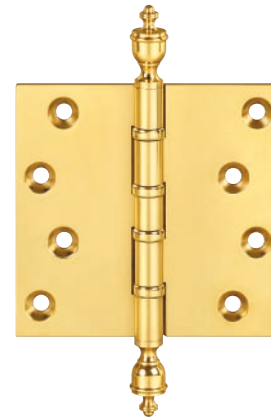

P1660CE

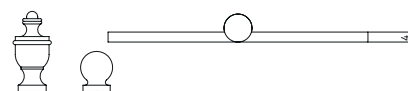
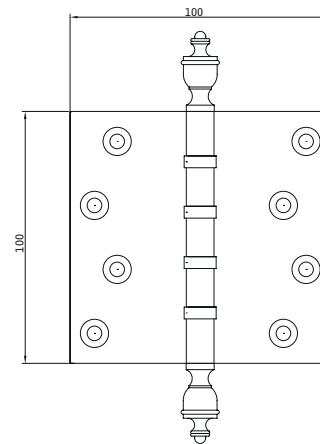

P1660CE

# BRASS HINGE

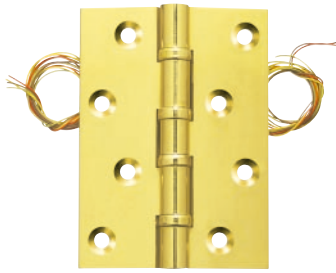

1550 C8

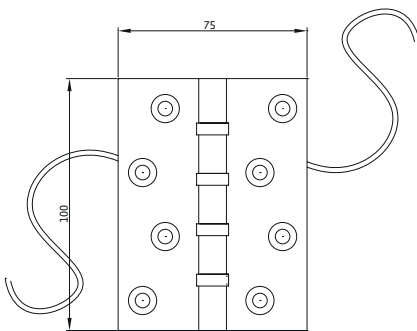

1550 C2

## Ball Race Conductor Brass Butt Hinge

Suitable for medium to heavy weight flush doors Grade 11

ball race	conductor	butt hinge
-----------	-----------	------------

Technical Data	1550C2	1550C4
Load Capacity (3 Hinges)	80.0	80.0 kg
Height	100.0	100.0 mm
Width	75.0	75.0 mm
Knuckle Diameter	11.0	11.0 mm
Leaf Thickness	4.0	4.0 mm
Screw Size	10.0	10.0 g

Technical Data	1550C6	1550C8
Load Capacity (3 Hinges)	80.0	80.0 kg
Height	100.0	100.0 mm
Width	75.0	75.0 mm
Knuckle Diameter	11.0	11.0 mm
Leaf Thickness	4.0	4.0 mm
Screw Size	10.0	10.0 g

### Finishes

Self Colour, Polished & lacquered, Satin brass & lacquered, Satin chromium plate, Polished chromium plate, Satin nickel plate, Polished nickel plate, Imitation bronze metal antique

### Note

Hidden transfer of wires from door to frame eliminates the need for an armoured loop, which are usually exposed to vandals.

Capacity 2 wire 24V 5 Amps.

2, 4, 6 or 8 wire options.

Supplied complete with fixing screws if required.

Special finishes available upon request see page 76.

## BRASS HINGE

### Ball Race Anti Ligature Brass Butt Hinge

Suitable for medium to heavy weight flush doors Grade 11

ball race	anti ligature	butt hinge
-----------	---------------	------------

Technical Data	1550 AL
Load Capacity (2 Hinges)	80.0 kg
Height	100.0 mm
Width	75.0 mm
Knuckle Diameter	11.0 mm
Leaf Thickness	4.0 mm
Screw Size	10.0 g

#### Finishes

Self Colour, Polished & lacquered, Satin brass & lacquered, Satin chromium plate, Polished chromium plate, Satin nickel plate, Polished nickel plate, Imitation bronze metal antique

#### Note

Anti ligature or institution hinges are designed for safety in prisons and hospitals. The knuckles are chamfered intending to try and prevent a person from manipulating door furniture to cause self harm and injury. Supplied with matching socket head woodscrews for enhanced security.

Anti ligature brass butt hinges with 10 year performance guarantee.

Supplied with socket screws.

Special Bit Ref 0030 required for socket screws.

Special finishes available upon request see page 76.



1550 AL

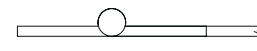
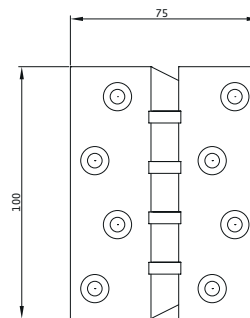

1550 AL

# BRASS HINGE



1880

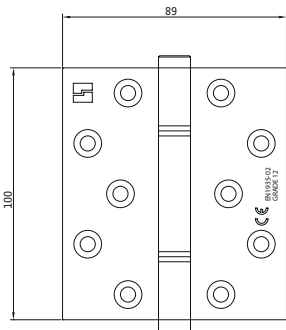

1880

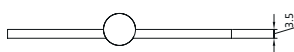

## Samson

Suitable for heavy weight flush doors tested to BS EN 1935 Grade 12-100kgs

### Samson

Technical Data	1850	1850CE
Load Capacity (3 Hinges)	100.0	100.0 kg
Height	100.0	100.0 mm
Width	75.0	75.0 mm
Knuckle Diameter	13.0	13.0 mm
Leaf Thickness	3.5	3.5 mm
Screw Size	10.0	10.0 g

Technical Data	1880	1880CE
Load Capacity (3 Hinges)	100.0	100.0 kg
Height	100.0	100.0 mm
Width	88.0	88.0 mm
Knuckle Diameter	13.0	13.0 mm
Leaf Thickness	3.5	3.5 mm
Screw Size	10.0	10.0 g

### Finishes

Self Colour, Polished & lacquered, Satin brass & lacquered, Satin chromium plate, Polished chromium plate, Satin nickel plate, Polished nickel plate, Imitation bronze metal antique

### Note

High performance concealed bearing brass hinge with 25 year performance guarantee.

Maintenance free.

CE marked version suitable for use on 1 hour and 1/2 hour fire and escape doorsets - supplied complete with intumescent pads.

Security dog bolt, radius corner and designer finial options available.

Supplied complete with fixing screws if required.

Special finishes available upon request see page 76.

### Classification key

4	7	5	1	1	4	0	12
---	---	---	---	---	---	---	----

BS EN1935: 2002 Eight Digit Code (p78 for details)

### Finial options



URN

STAR

BASIC

CROSS

PLANET

SOFT

TOP



## BRASS HINGE

### Samson Projection Hinge

Suitable for heavy weight flush doors tested to BS EN 1935 Grade 12-100kgs

Samson projection

Technical Data	P1860	P1860CE
Load Capacity (3 Hinges)	100.0	100.0 kg
Height	100.0	100.0 mm
Width	100.0	100.0 mm
Knuckle Diameter	13.0	13.0 mm
Leaf Thickness	3.5	3.5 mm
Screw Size	10.0	10.0 g
Amount of Projection	50.0	50.0 mm

#### Finishes

Self Colour, Polished & lacquered, Satin brass & lacquered, Satin chromium plate, Polished chromium plate, Satin nickel plate, Polished nickel plate, Imitation bronze metal antique

#### Note

High performance concealed bearing brass hinge with 25 year performance guarantee.

Maintenance free.

CE marked version suitable for use on 1 hour and 1/2 hour fire and escape doorsets - supplied complete with intumescent pads.

Security dog bolt, radius corner and designer finial options available.

Supplied complete with fixing screws if required.

Special finishes available upon request see page 76.

#### Classification key

4	7	5	1	1	4	0	12
---	---	---	---	---	---	---	----

BS EN1935: 2002 Eight Digit Code (p78 for details)

#### Finial options

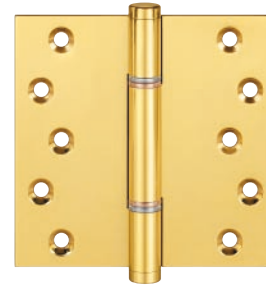

P1860

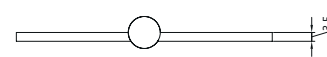
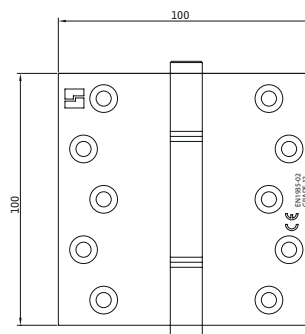

P1860

# BRASS HINGE

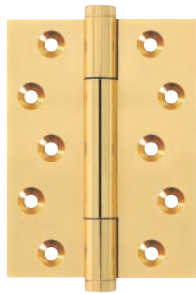

1750

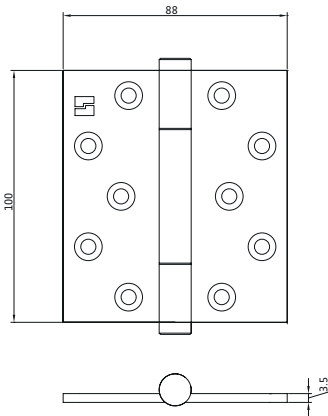

1780

## TriTech

Suitable for heavy weight flush doors tested to BS EN 1935 Grade 14-160kgs

### TriTech

Technical Data	1750	1750CE
Load Capacity (3 Hinges)	160.0	160.0 kg
Height	100.0	100.0 mm
Width	75.0	75.0 mm
Knuckle Diameter	13.0	13.0 mm
Leaf Thickness	3.5	3.5 mm
Screw Size	10.0	10.0 g

Technical Data	1780	1780CE
Load Capacity (3 Hinges)	160.0	160.0 kg
Height	100.0	100.0 mm
Width	88.0	88.0 mm
Knuckle Diameter	13.0	13.0 mm
Leaf Thickness	3.5	3.5 mm
Screw Size	10.0	10.0 g

### Finishes

Self Colour, Polished & lacquered, Satin brass & lacquered, Satin chromium plate, Polished chromium plate, Satin nickel plate, Polished nickel plate, Imitation bronze metal antique

### Note

High performance concealed bearing brass hinge with 25 year performance guarantee.

Maintenance free.

CE marked version suitable for use on 1 hour and 1/2 hour fire and escape doorsets - supplied complete with intumescent pads.

Security dog bolt, radius corner and designer finial options available.

Supplied complete with fixing screws if required.

Special finishes available upon request see page 76.

### Classification key

4	7	7	1	1	4	0	14
---	---	---	---	---	---	---	----

BS EN1935: 2002 Eight Digit Code (p78 for details)

### Finial options



URN

STAR

BASIC

CROSS

PLANET

SOFT

TOP

## BRASS HINGE

### TriTech Projection Hinge

Suitable for heavy weight flush doors tested to BS EN 1935 Grade 14-160kgs

TriTech projection

Technical Data	P1760	P1760CE
Load Capacity (3 Hinges)	160.0	160.0 kg
Height	100.0	100.0 mm
Width	100.0	100.0 mm
Knuckle Diameter	13.0	13.0 mm
Leaf Thickness	3.5	3.5 mm
Screw Size	10.0	10.0 g
Amount of Projection	50.0	50.0 mm

#### Finishes

Self Colour, Polished & lacquered, Satin brass & lacquered, Satin chromium plate, Polished chromium plate, Satin nickel plate, Polished nickel plate, Imitation bronze metal antique

#### Note

High performance concealed bearing brass hinge with 25 year performance guarantee.

Maintenance free.

CE marked version suitable for use on 1 hour and 1/2 hour fire and escape doorsets - supplied complete with intumescent pads.

Security dog bolt, radius corner and designer finial options available.

Supplied complete with fixing screws if required.

Special finishes available upon request see page 76.

#### Classification key

4	7	7	1	1	4	0	14
---	---	---	---	---	---	---	----

BS EN1935: 2002 Eight Digit Code (p78 for details)

#### Finial options



P1760

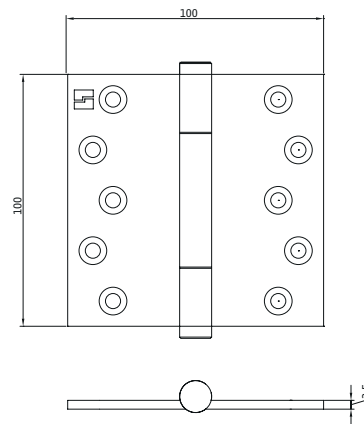

1780

# ALUMINIUM HINGE



2140

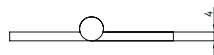
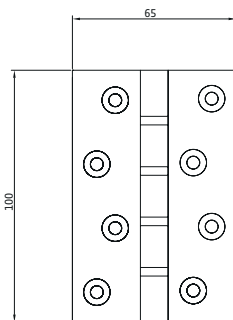

2140

## Washed SD Aluminium Butt Hinge

Suitable for medium weight flush doors

washed SD		butt hinge
-----------	--	------------

Technical Data	2110	P2120
Load Capacity (3 Hinges)	20.0	20.0 kg
Height	75.0	75.0 mm
Width	50.0	75.0 mm
Knuckle Diameter	10.0	11.0 mm
Leaf Thickness	3.0	4.0 mm
Screw Size	8.0	8.0 g

Technical Data	2140	2150
Load Capacity (3 Hinges)	20.0	20.0 kg
Height	100.0	100.0 mm
Width	65.0	75.0 mm
Knuckle Diameter	11.0	11.0 mm
Leaf Thickness	4.0	4.0 mm
Screw Size	10.0	10.0 g

### Finishes

Etched & Anodised, Polished & Anodised

### Note

- 10 year performance guarantee.
- Aluminium pin
- Supplied complete with fixing screws if required.
- Special finishes available upon request.

## ALUMINIUM HINGE

### Washed DSS Aluminium Butt Hinge

Suitable for medium to heavy weight flush doors

washed DSS butt hinge

Technical Data	2010	2040	2050
Load Capacity (3 Hinges)	20.0	40.0	40.0 kg
Height	75.0	100.0	100.0 mm
Width	50.0	65.0	75.0 mm
Knuckle Diameter	10.0	11.0	11.0 mm
Leaf Thickness	3.0	4.0	4.0 mm
Screw Size	8.0	10.0	10.0 g

#### Finishes

Etched & Anodised, Polished & Anodised

#### Note

10 year performance guarantee.  
Stainless steel pin  
Supplied complete with fixing screws if required.  
Special finishes available upon request.



2050

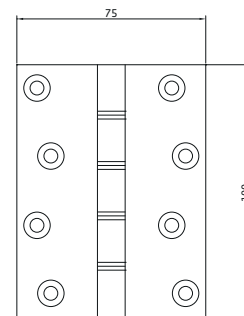

2050

# ALUMINIUM HINGE



2050

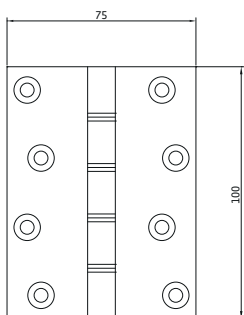

2050



2075

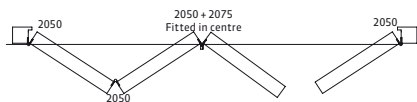

## Washed DSS Aluminium Bi-Folding Butt Hinge

Bi-Folding door systems which allow large openings onto patio and garden areas

washed DSS	bi-folding	butt hinge
------------	------------	------------

Technical Data	2050	2075
Load Capacity (3 Hinges)	40.0*	40.0* kg
Height	100.0	100.0 mm
Width	75.0	75.0 mm
Knuckle Diameter	11.0	11.0 mm
Leaf Thickness	4.0	4.0 mm
Screw Size	10.0	10.0 g

### Finishes

Etched and Anodised, Silver Powder Coated

### Note

For use with top hung or bottom track sliding door gear.

Double Stainless Steel Washers.

Centre handle hinge (2075) for easy operation.

\*Weight carrying capacity will largely depend on sliding door gear used.

# ALUMINIUM HINGE

## Washed Nylon Aluminium Butt Hinge

Suitable for medium to heavy weight flush doors

washed nylon

butt hinge

Technical Data	2030
Load Capacity (3 Hinges)	40.0 kg
Height	101.6 mm
Width	80.0 mm
Knuckle Diameter	12.0 mm
Leaf Thickness	3.0 mm
Screw Size	10.0 g

### Finishes

Gold Anodise to F3 finish, Silver Anodise to F1 finish

### Note

Radius Corner

Integral Dog Bolt with anti hacksaw feature.

Nylon bush bearings

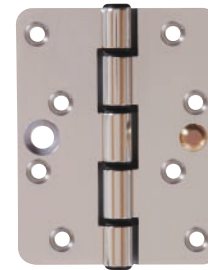

2030

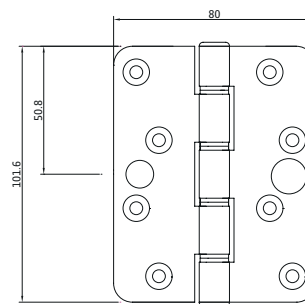

2030

# ALUMINIUM HINGE



2841

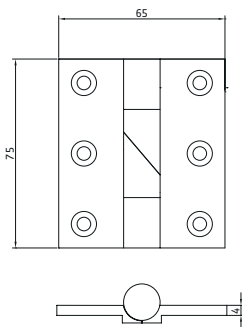

2811

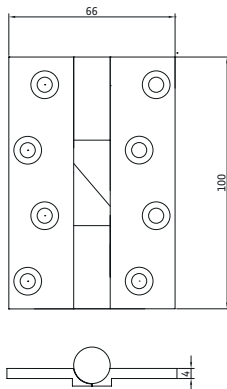

2841

## Aluminium Falling Hinge

Suitable for medium weight toilet cubicle & internal flush doors

falling

Technical Data	2811	2841
Load Capacity (2 Hinges)	20.0	25.0 kg
Height	75.0	100.0 mm
Width	65.0	65.0 mm
Knuckle Diameter	14.5	14.5 mm
Leaf Thickness	4.0	4.0 mm
Screw Size	10.0	10.0 g

### Finishes

Etched & Anodised, Polished & Anodised

### Note

Rise or fall of 13mm at 180°

Galvanised steel pin

Fitted with medium duty galvanised steel skewers.

Handed left or right see fig 2 page 80.

Supplied complete with fixing screws if required.

# ALUMINIUM HINGE

## Aluminium Rising Hinge

Suitable for medium weight toilet cubicle & internal flush doors

rising

Technical Data	2810	2840
Load Capacity (2 Hinges)	20.0	25.0 kg
Height	75.0	100.0 mm
Width	65.0	65.0 mm
Knuckle Diameter	14.5	14.5 mm
Leaf Thickness	4.0	4.0 mm
Screw Size	10.0	10.0 g

### Finishes

Etched & Anodised, Polished & Anodised

### Note

Rise or fall of 13mm at 180°

Galvanised steel pin

Fitted with medium duty galvanised steel skewes.

Handed left or right see fig 2 page 80.

Supplied complete with fixing screws if required.



2840

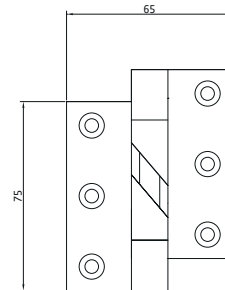

2810

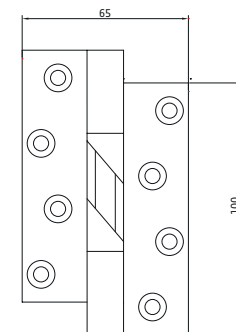

2840

## ALUMINIUM HINGE



0200

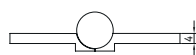
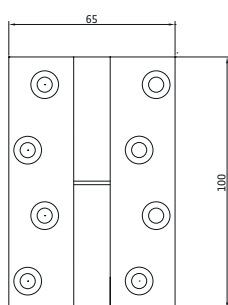

0200

## Aluminium Support Hinge

Suitable for medium weight toilet cubicle & internal flush doors

rising

### Technical Data

Technical Data	0200
Load Capacity (2 Hinges)	45.0 kg
Height	100.0 mm
Width	65.0 mm
Knuckle Diameter	14.5 mm
Leaf Thickness	4.0 mm
Screw Size	10.0 g

### Finishes

Etched & Anodised, Polished & Anodised

### Note

Fitted with one pair of normal aluminium rising hinges.  
Increases weight carrying capacity up to 45 kilos.  
Supports the top of the door preventing any leverage problems.  
Handed left or right see fig 2 page 80.  
Supplied complete with fixing screws if required.

## ADJUSTABLE HINGE

### Columbus 3D

Easy adjustment to door position in all three directions

#### Columbus 3D

#### Technical Data

Load Capacity (3 Hinges)	70.0 kg
Height	92.0 mm
Width	32.0 mm
Knuckle Diameter	13.0 mm
Leaf Thickness	2.5 mm
Receiver Depth	14.0 mm

#### Adjustment

Height	+/- 3mm
Side	+/- 2mm
Depth	+/- 4mm

#### Finishes

include: Brass, Polished Chromed, Stainless Steel  
 Powder Coated Colours: Silver, White, Black, Brown, Gold  
 Other finishes available to special order

#### Note

Quick and easy mounting.  
 Maintenance free.  
 Optional security device for outward opening doors.  
 Three way adjustable hinges allow adjustment to doors horizontally, vertically and compression by turning socket screws.

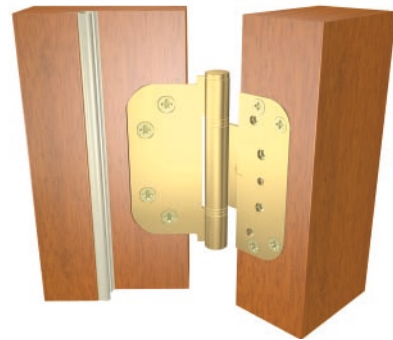

Allen Key Adjustment

# ADJUSTABLE HINGE



## Ultimate 2D

Doors should be mounted using 2 guide and 1 set hinge

### Ultimate 2D

Technical Data	Guide	Set
Load Capacity (3 Hinges)	70.0	70.0 kg
Height	92.0	92.0 mm
Width	32.0	32.0 mm
Knuckle Diameter	13.0	13.0 mm
Leaf Thickness	2.5	2.5 mm
Receiver Depth	15.0	15.0 mm

### Adjustment

Height	+/- 2.5mm
Side	+/- 2mm

### Finishes

include: Brass, Stainless Steel

Powder Coated Colours: Silver, White, Black, Brown, Gold

Other finishes available to special order

### Note

Two way adjustable hinges allow easy adjustment to doors horizontally and vertically with the turn of a screw.

Quick and easy mounting.

Maintenance free.

Optional security device for outward opening doors.



**Set Hinge**  
Vertical adjustment

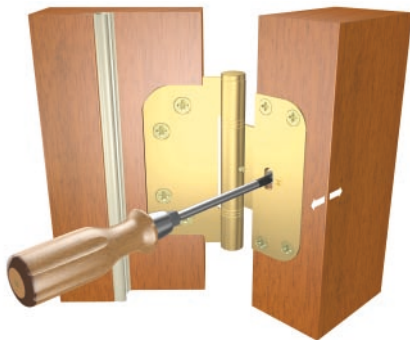

**Guide Hinge**  
Horizontal adjustment

## STAINLESS STEEL HINGE

### Ball Race Stainless Steel CE Butt Hinge

Suitable for heavy weight flush doors tested to BS EN 1935 Grade 13 (120Kgs)

ball race butt hinge CE

Technical Data	B4030
Load Capacity (3 Hinges)	120.0 kg
Height	101.6 mm
Width	76.0 mm
Knuckle Diameter	14.0 mm
Leaf Thickness	3.0 mm
Screw Size	10.0 g

#### Note

High performance bearing stainless steel hinge - 102mm x 76mm x 3mm-  
CE marked  
Certifire Approved  
Quality Kite marked  
Available in satin or bright polished finish.  
Suitable for use on 1/2 hour and 1 hour fire & escape doors sets using 1mm  
intumescent pads.  
Supplied complete with 8 x N°10g stainless steel fixing wood screws pozi drive.

#### Classification key

4	7	6	1	1	4	0	13
---	---	---	---	---	---	---	----

BS EN1935: 2002 Eight Digit Code (p78 for details)

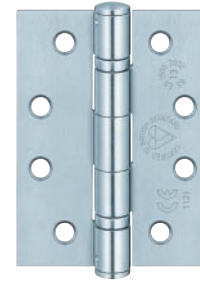

B4030

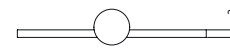
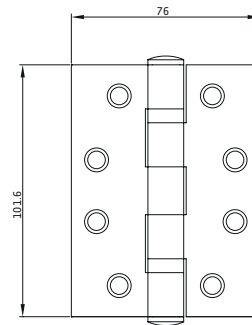

B4030

## STAINLESS STEEL HINGE

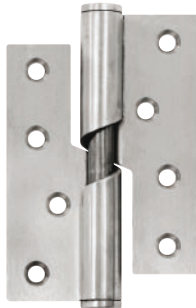

1940

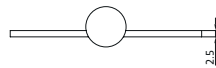
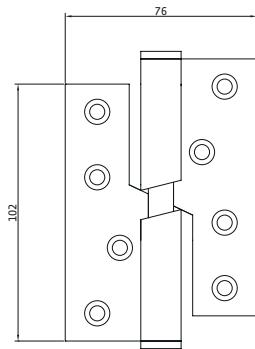

1940

**Stainless Steel Rising Hinge**

Suitable for medium weight toilet cubicle & internal flush doors

rising

**Technical Data**

	<b>1940</b>
Load Capacity (3 Hinges)	40.0 kg
Height	102.0 mm
Width	76.0 mm
Knuckle Diameter	14.0 mm
Leaf Thickness	3.0 mm
Screw Size	10.0 g

**Finishes**

Satin Stainless Steel, Bright Polished Stainless Steel

**Note**

Rise or fall of 8mm at 180°  
 Stainless Steel Pin  
 Handed left or right see fig 2 page 80.  
 Low cost hinges.  
 Supplied complete with fixing screws.  
 Grade 304 Stainless Steel.

## STAINLESS STEEL HINGE

### Stainless Steel Falling Hinge

Suitable for medium weight toilet cubicle & internal flush doors

falling

Technical Data	1941
Load Capacity (3 Hinges)	40.0 kg
Height	102.0 mm
Width	76.0 mm
Knuckle Diameter	14.0 mm
Leaf Thickness	3.0 mm
Screw Size	10.0 g

#### Finishes

Satin Stainless Steel, Bright Polished Stainless Steel

#### Note

Rise or fall of 8mm at 180°

Stainless Steel Pin

Handed left or right see fig 2 page 80.

Low cost hinges.

Supplied complete with fixing screws.

Grade 304 Stainless Steel.



1941

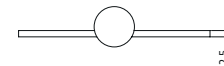
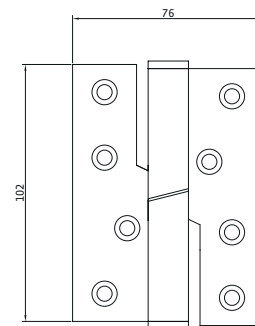

1941

# STAINLESS STEEL HINGE



0103

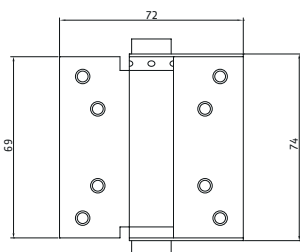

0103

## Stainless Steel Single Action Hinge

Suitable for medium weight internal flush doors

single action

Technical Data	0103	0103
Load Capacity (2 Hinges)	18.0	25.0 kg
Height	75.0	100.0 mm
Knuckle Diameter	21.0	21.0 mm
Screw Size	6.0	6.0 g

Technical Data	0103	0103
Load Capacity (2 Hinges)	30.0	45.0 kg
Height	125.0	150.0 mm
Knuckle Diameter	21.0	21.0 mm
Screw Size	8.0	8.0 g

### Finishes

Satin Stainless Steel

### Note

Adjustable spring tension  
Grade 304 Stainless Steel

## STAINLESS STEEL HINGE

### Stainless Steel Double Action Hinge

Suitable for medium weight internal flush doors

double action

Technical Data	0101	0101
Load Capacity (2 Hinges)	18.0	25.0 kg
Height	75.0	100.0 mm
Knuckle Diameter	21.0	21.0 mm
To Suit Maximum Door Thickness	29.0	30.0 mm
Screw Size	6.0	6.0 g

Technical Data	0101	0101
Load Capacity (2 Hinges)	30.0	45.0 kg
Height	125.0	150.0 mm
Knuckle Diameter	21.0	21.0 mm
To Suit Maximum Door Thickness	38.0	38.0 mm
Screw Size	8.0	8.0 g

#### Finishes

Satin Stainless Steel

#### Note

Adjustable spring tension.

Grade 304 Stainless Steel.

Supplied with complete set of fitting instructions.

10 year guarantee does not apply to spring hinges.

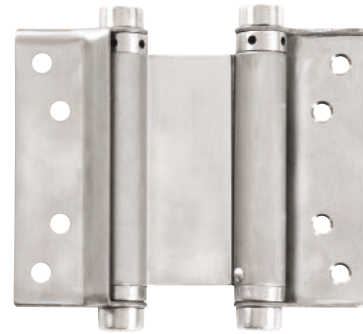

0101

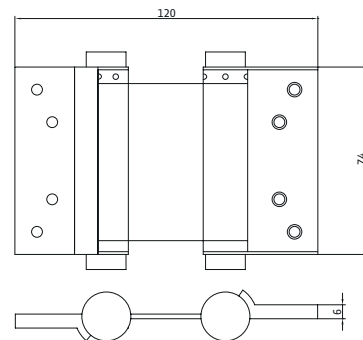

0101

# STEEL HINGE



0103

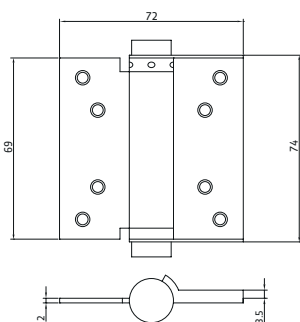

0103

## Steel Single Action Hinge

Suitable for medium weight internal flush doors

single action

Technical Data	0103	0103
Load Capacity (2 Hinges)	18.0	25.0 kg
Height	75.0	100.0 mm
Knuckle Diameter	21.0	21.0 mm
Screw Size	6.0	6.0 g

Technical Data	0103	0103
Load Capacity (2 Hinges)	30.0	45.0 kg
Height	125.0	150.0 mm
Knuckle Diameter	21.0	21.0 mm
Screw Size	8.0	8.0 g

### Finishes

Zinc Plated, Brass plated

### Note

Adjustable spring tension  
10 year guarantee does not apply to spring hinges

## STEEL HINGE

### Steel Single Action Fire Rated Hinge

Suitable for use Fire Doors tested within a timber doorset to BS EN 1634-1 2000

single action	fire rated
---------------	------------

Technical Data	0105
Load Capacity (3 Hinges)	40.0 kg
Height	101.0 mm
Width	76.0 mm
Knuckle Diameter	18.0 mm
Leaf Thickness	2.5 mm
Screw Size	10.0 g

#### Finishes

Satin Chrome, Polished Chrome

#### Note

- Adjustable spring tension
- Intumescent pads not necessary
- Square corner only
- 10 year guarantee does not apply to spring hinges
- Complete with fixing screws



0105

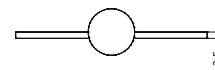
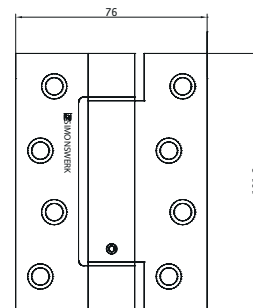

0105



# STEEL HINGE

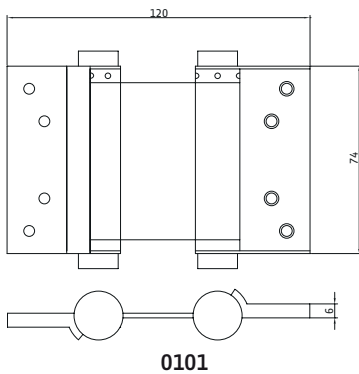
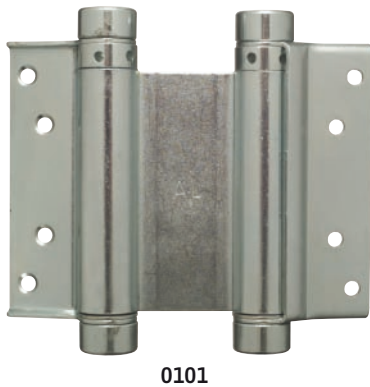

## Steel Double Action Hinge

Suitable for medium weight internal flush doors

double action

Technical Data	0101	0101
Load Capacity (2 Hinges)	18.0	25.0 kg
Height	75.0	100.0 mm
Knuckle Diameter	21.0	21.0 mm
To Suit Maximum Door Thickness	28.0	34.0 mm
Screw Size	6.0	6.0 g

Technical Data	0101	0101
Load Capacity (2 Hinges)	30.0	45.0 kg
Height	125.0	150.0 mm
Knuckle Diameter	21.0	21.0 mm
To Suit Maximum Door Thickness	45.0	45.0 mm
Screw Size	8.0	8.0 g

### Finishes

Zinc Plated, Brass plated

### Note

Adjustable spring tension.  
 Supplied with complete set of fitting instructions.  
 10 year guarantee does not apply to spring hinges.

## NYLON HINGE

### Unwashed Nylon Butt Hinge

Suitable for very light weight doors

unwashed | nylon hinge

Technical Data	3205
Load Capacity (3 Hinges)	10.0 kg
Height	75.0 mm
Width	50.0 mm
Knuckle Diameter	8.0 mm
Leaf Thickness	3.0/4.0 mm
Screw Size	7.0 g

#### Finishes

Bronze, Natural

#### Note

10 year guarantee does not apply.  
Zinc Plated Steel Pin



3205

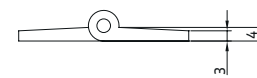
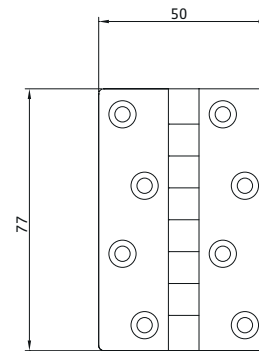

3205



7510



7510



7511

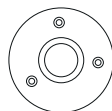
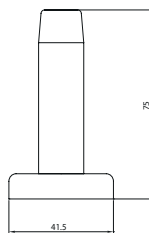

7511

### Brass Concealed Fix Door Stop

Skirting board mounted doorstop with concealed althread fixing

brass		concealed fix
-------	--	---------------

Technical Data	7500	7510
Diameter of body	19.0	19.0 mm
Length	65.0	75.0 mm
Screw Size	10.0	10.0 g

#### Finishes

Self Colour, Polished & lacquered, Satin brass & lacquered, Satin chromium plate, Polished chromium plate, Satin nickel plate, Polished nickel plate, Imitation bronze metal antique

#### Note

Complete with fixing screw.  
Skirting board fixing (easily removed for re-decorating).  
Prevents door handle damage to walls.  
Special finishes available on request.

### Brass Face Fix On A Round Rose Door Stop

Skirting board mounted doorstop with round rose fixing

brass		face fix
-------	--	----------

Technical Data	7501	7511
Diameter of body	19.0	19.0 mm
Diameter of base	41.5	41.5 mm
Length	65.0	75.0 mm
Screw Size	6.0	6.0 g

#### Finishes

Self Colour, Polished & lacquered, Satin brass & lacquered, Satin chromium plate, Polished chromium plate, Satin nickel plate, Polished nickel plate, Imitation bronze metal antique

#### Note

Supplied complete with fixings.  
Skirting board fixing.  
Prevents door handle damage to walls.  
Special projecting sizes available upon request.  
Special finishes available on request.

## DOOR STOP

### Brass Concealed Fix On A Round Rose Door Stop

Skirting board mounted doorstop with round rose fixing and concealing cover

brass concealed fix

Technical Data	7505	7515
Diameter of body	19.0	19.0 mm
Diameter of base	47.0	47.0 mm
Length	65.0	75.0 mm
Screw Size	6.0	6.0 g

#### Finishes

Self Colour, Polished & lacquered, Satin brass & lacquered, Satin chromium plate, Polished chromium plate, Satin nickel plate, Polished nickel plate, Imitation bronze metal antique

#### Note

Supplied complete with fixings.  
Threaded cover for appealing aesthetics concealing fixings.  
Prevents door handle damage to walls.  
Special projecting sizes available upon request.  
Special finishes available on request.

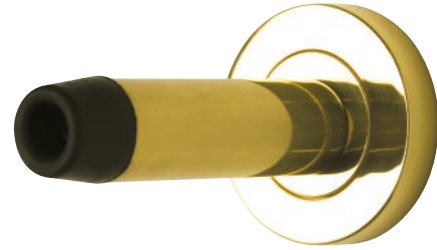

7515

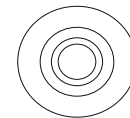
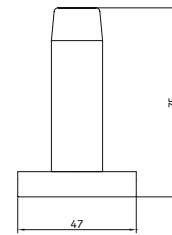

7515

### Brass Oval Door Stop

Floor Mounted Doorstop

brass oval

Technical Data	7400
Diameter of body	45.0 mm
Screw Size	6.0 g

#### Finishes

Self Colour, Polished & lacquered, Satin brass & lacquered, Satin chromium plate, Polished chromium plate, Satin nickel plate, Polished nickel plate, Imitation bronze metal antique

#### Note

Supplied complete with fixings  
Floor mounted



7400

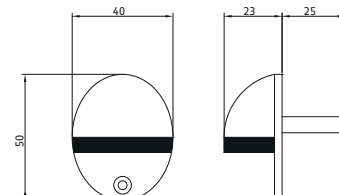

7400

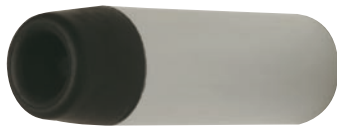

7010



7010

### Aluminium Concealed Fix Door Stop

Skirting board mounted doorstop with concealed althread fixing

aluminium | | concealed fix

Technical Data	7000	7010
Diameter of body	19.0	19.0 mm
Length	65.0	75.0 mm
Screw Size	10.0	10.0 g

#### Finishes

Gold Anodised, Polished Anodised, Powder Coated

#### Note

Complete with fixing screw.  
 Skirting board fixing (easily removed for re-decorating).  
 Prevents door handle damage to walls.  
 Special finishes available on request.



7011

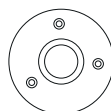
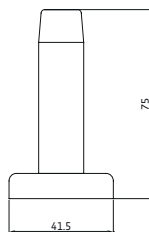

7011

### Aluminium Face Fix On A Round Rose Door Stop

Skirting board mounted doorstop with round rose fixing

aluminium | | face fix

Technical Data	7001	7011
Diameter of body	19.0	19.0 mm
Diameter of base	41.5	41.5 mm
Length	65.0	75.0 mm
Screw Size	6.0	6.0 g

#### Finishes

Gold Anodised, Polished Anodised, Powder Coated

#### Note

Supplied complete with fixings.  
 Skirting board fixing.  
 Prevents door handle damage to walls.  
 Special projecting sizes available upon request.  
 Special finishes available on request.

## DOOR STOP

### Aluminium Concealed Fix On A Round Rose Door Stop

Skirting board mounted doorstop with round rose fixing and concealing cover

aluminium concealed fix

Technical Data	7091	7099
Diameter of body	19.0	19.0 mm
Diameter of base	47.0	47.0 mm
Length	65.0	75.0 mm
Screw Size	6.0	6.0 g

#### Finishes

Gold Anodised, Polished Anodised, Powder Coated

#### Note

Supplied complete with fixings.  
Push fit cover for appealing aesthetics concealing fixings.  
Prevents door handle damage to walls.  
Special projecting sizes available upon request.  
Special finishes available on request.



7099

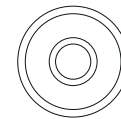
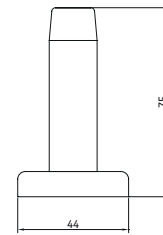

7099

### Aluminium Oval Door Stop

Floor Mounted Doorstop

aluminium oval

Technical Data	7200
Diameter of body	45.0 mm
Screw Size	6.0 g

#### Finishes

Gold Anodised, Polished Anodised, Powder Coated

#### Note

Supplied complete with fixings  
Floor mounted



7200

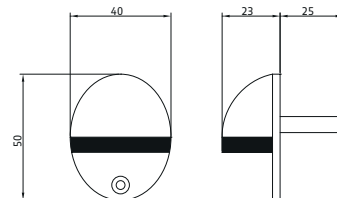

7200

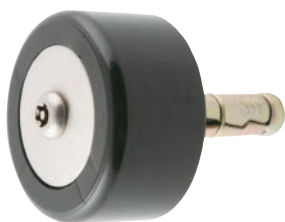

0005

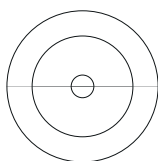

0005

## Stainless Steel Floor Stop

Heavy duty floor stop with black polyurethane buffer

stainless steel

floor stop

### Technical Data

0005

Floor Depth Required	60.0 mm
Body Diameter base	50.0 mm
Face Plate	40.0 mm
Buffer Diameter	60.0 mm
Buffer Height	30.0 mm

### Finishes

Satin Stainless Steel

### Note

Supplied with M8 Stainless Steel 6-lobe button head security bolt, M8 Rawbolt and 'L' shaped 6-lobe wrench.  
400kg load tested.

## DOOR STOP

### Stainless Steel Floor Stop Hold Open Device

Spring loaded stop can be depressed to hold door open

stainless steel | hold open device | floor stop

Technical Data	0007	0008
Floor Depth Required	54.0	54.0 mm
Body Diameter base	35.0	35.0 mm
Face Plate	45.0Sqx2.5	45.0 Diameterx2.5 mm
Buffer Diameter	25.0	25.0 mm
Buffer Hight	20.0	20.0 mm

#### Finishes

Satin Stainless Steel

#### Note

Floor mounted Door Stop  
 - 0007 Timber Floor  
 - 0008 Concrete Floor  
 Grade T316 Stainless Steel  
 Supplied complete with fixings

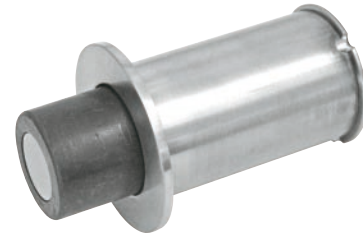

0008

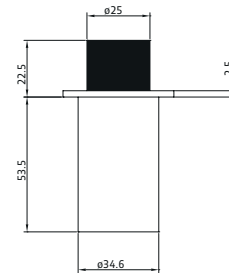
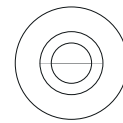

0008

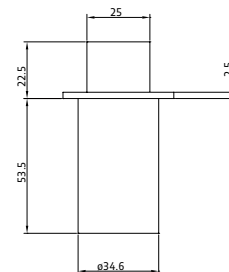
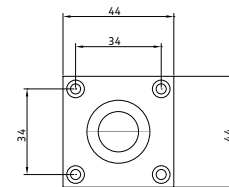

0007

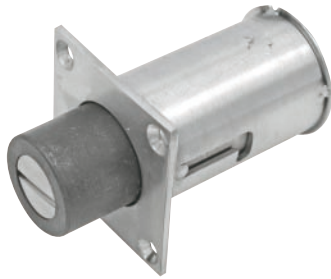

0009

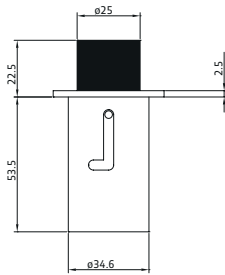
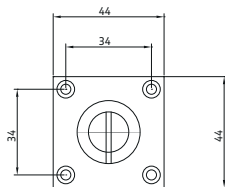

0009

### Stainless Steel Floor Stop Hold Open Device With Backstop/Lock Down

Spring loaded stop can be depressed and turned to make stop inoperable

stainless steel	hold open device	floor stop
-----------------	------------------	------------

Technical Data	0009	0010
Floor Depth Required	54.0	54.0 mm
Body Diameter base	35.0	35.0 mm
Face Plate	45.0Sqx2.5	45.0 Diameterx2.5 mm
Buffer Diameter	25.0	25.0 mm
Buffer Hight	20.0	20.0 mm

#### Finishes

Satin Stainless Steel

#### Note

- Floor mounted Door Stop
- 0009 Timber Floor
- 0010 Concrete Floor
- Grade T316 Stainless Steel
- Supplied complete with fixings

## DOOR STOP

### Stainless Steel Floor Stop Hold Open Device With Backstop/Lock Down

Complete with backstop to prevent door handle damage to walls

stainless steel | hold open device | floor stop

Technical Data	0011	0012
Floor Depth Required	54.0	54.0 mm
Body Diameter base	35.0	35.0 mm
Face Plate	125.0x45.0x2.5	125.0x45.0x2.5 mm
Buffer Diameter	25.0	25.0 mm
Buffer Hight	20.0	20.0 mm

#### Finishes

Satin Stainless Steel

#### Note

Floor mounted Door Stop  
 - 0011 Timber Floor  
 - 0012 Timber Floor + Lock Down  
 Grade T316 Stainless Steel  
 Supplied complete with fixings

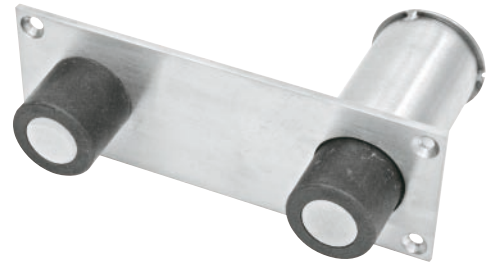

011

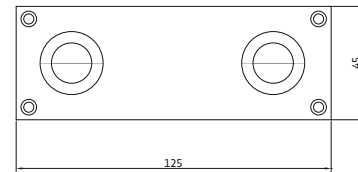
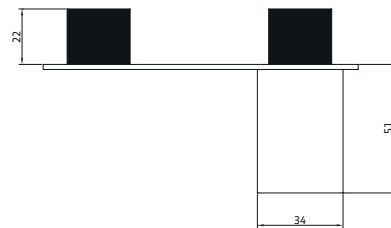

011

# LETTER PLATE

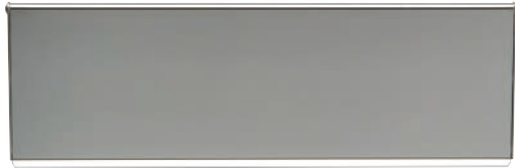

5502

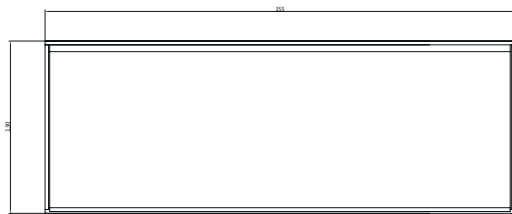

5502

## Aluminium Commercial Letter Plate Outward

Suitable for commercial premises where parcels need to be delivered

aluminium	outward	letter plate
-----------	---------	--------------

Technical Data	5502	5503
Height	135.0	135.0 mm
Width	355.0	406.0 mm
Opening Aperture	97.0x305.0	97.0x355.0 mm
Screw Size	6.0	6.0 g

### Finishes

Stainless steel effect, Etched anodised, Polished anodised, Satin brass plated, Polished brass plated. Powder coated finishes on request

### Note

Outward opening.  
Face Fixed or Bolt Through Fixing.  
Spring Tensioned.



5513

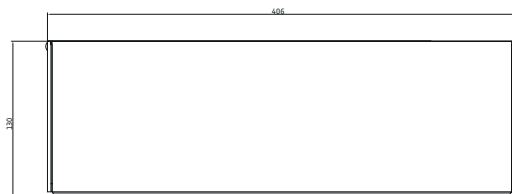

5513

## Aluminium Commercial Inner Flap

Suitable for commercial premises where parcels need to be delivered

aluminium		inner flap
-----------	--	------------

Technical Data	5512	5513
Height	130.0	130.0 mm
Width	355.0	406.0 mm
Opening Aperture	120.0x315.0	120.0x365.0 mm
Screw Size	6.0	6.0 g

### Finishes

Stainless steel effect, Etched anodised, Polished anodised, Satin brass plated, Polished brass plated. Powder coated finishes on request

### Note

Face Fixed or Bolt Through Fixing to match 5502 & 5503 Letter Plates.

## LETTER PLATE

### Aluminium Commercial Letter Plate Inward

Suitable for commercial premises where parcels need to be delivered

aluminium	inward	letter plate
-----------	--------	--------------

Technical Data	7702	7703
Height	125.0	125.0 mm
Width	355.0	406.0 mm
Opening Aperture	75.0x290.0	75.0x340.0 mm

#### Finishes

Etched and Anodised, Polished and Anodised, Stainless Steel effect

#### Note

Inward Opening.  
Face Fix or Bolt Through Fixing.  
Spring Tentioned.



7703

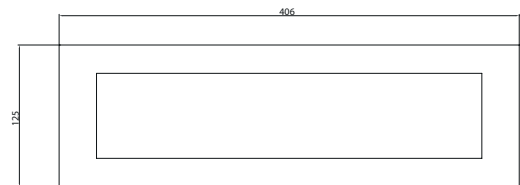

7703

### Aluminium Residential Letter Plate fire rated

Suitable for door thicknesses 40-80mm

aluminium	fire rated	letter plate
-----------	------------	--------------

Technical Data	5520
Height	70.0 mm
Width	302.0 mm
Opening Aperture	35.0x254.0 mm

#### Finishes

Stainless Steel effect

#### Note

Fire Rated Sleeved Letter Plate and Inner Flap.  
Certifire Approved.  
Complete with intumescent sleeve.



5520

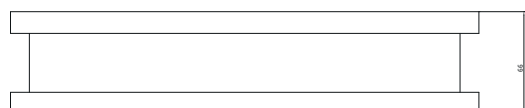
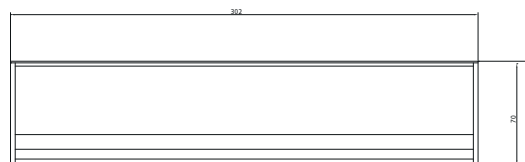

5520

## FLUSH BOLT



3240

### Stainless Steel Flush Bolt

Smooth easy lever action

stainless steel

Technical Data	3240	3241
Length	150.0	200.0 mm
Width	22.0	22.0 mm
Shoot Diameter	12.0	12.0 mm
Length Throw	16.0	16.0 mm
Depth Mortice	22.0	22.0 mm

#### Finishes

Satin Stainless Steel, Polished Stainless Steel

#### Note

Lever action.  
Smooth easy action.  
High quality spring.

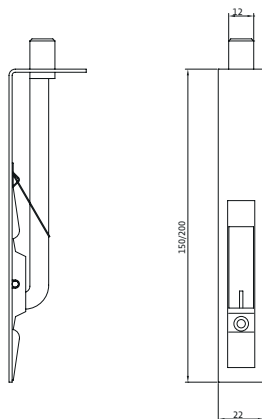

3240

# FLUSH BOLT

## Brass Flush Bolt

Smooth easy lever action

brass

Technical Data	3340	3341
Length	152.0	203.0 mm
Width	19.0	19.0 mm
Shoot Diameter	11.0	11.0 mm
Length Throw	16.0	16.0 mm
Depth Mortice	22.0	22.0 mm

### Finishes

Polished and Lacquered, Satin Chrome, Bright Chrome

### Note

Lever action.

Radius ends ideal for CNC or router preparation.

Smooth easy action.

High quality spring.



3341

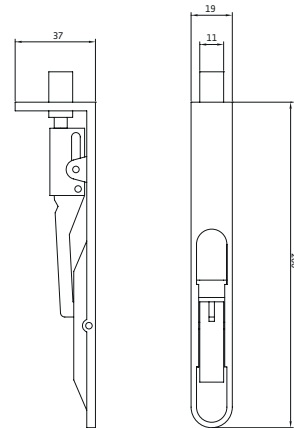

3341

## TECHNICAL INFORMATION

---

### UK GUARANTEES

All our hinges are given a weight loading based on three hinges per door leaf. Where we give a recommendation of 10 kilos and above, we will guarantee the performance of the hinge for 10 years, subject to compliance with fitting instructions provided in every box of hinges. Selected hinges specify a 25 year guarantee where stated.

---

### HINGE TYPES

<b>Brass</b>	Produced to precise standards, in a wide range of anti-bacterial quality finishes for trouble free use. Suitable for fire doors where indicated.
<b>Aluminium</b>	High standard hinges in a variety of finishes. Not suitable for fire doors.
<b>Stainless Steel</b>	“Rolled Joint” method of manufacture, with good durable surface finish, which performs well when fitted with Ball Races.
<b>Projection</b>	The P symbol shown next to various hinge reference numbers throughout the catalogue identifies projection hinges which are drilled with holes towards the edge of a broad hinge leaf enabling the hinge to clear obstructions when fully opened beyond 90°.

---

### SELECTION – Refer to Technical Section

When deciding on finish and the best hinge for each application take into account adjusted door weight; appearance to match both the environment and product; position of doors or windows within a building and direction of opening; type of building use e.g. hospital and its location e.g. coastal environments need special consideration as certain finishes are not suitable; frequency of use; security and fire resistance requirements.

---

### SPECIFICATION

**CE Marking** – To comply with the new UK Construction Products Regulations CE marking is required for hinges used on fire, smoke and escape route doors. Hinges marked in the catalogue with a CE Reference have been successfully performance tested and also where indicated fire tested up to 30 minutes and 1 hr respectively.

**European Standards** – Hinges detailed in this catalogue comply as required to the European Standard BS/EN 1935 : 2002. The standard covers Building Hardware – Single-Axis Hinges - Requirements and Test Methods as detailed in table A shown in the Technical Section.

**Building Regulations** – Approved Document B to the Building Regulations (England and Wales) recognises the importance of independent product conformity certification. It states: ‘Third party conformity certification schemes not only provide a means of identifying materials and designs of systems, products or structures which have demonstrated that they have the requisite performance in fire, but additionally provide confidence that the systems, materials, products or structures actually supplied are provided to the same specification or design as that tested/assessed.’

The estimated frequency of operation of doors is shown in table B.

**Corrosion** – Hinges are tested in a laboratory controlled environment for corrosion resistance as specified in BS EN 1670:1998.

**Strength & Durability** – Specification for hinges detailed in this catalogue meet European Standard BS/EN 1935 : 2002.

## TECHNICAL INFORMATION

### Finishes



Polished and Lacquered



Polished unlacquered



Satin Brass and Lacquered



Copper Plated



Imitation Bronze Metal Antique



Antique



Antique Gold



Pewter



Black Nickel Plated



Satin Chrome Plated



Satin Nickel Plated



Bright Nickel Plated



Bright Chrome Plated

## TECHNICAL INFORMATION

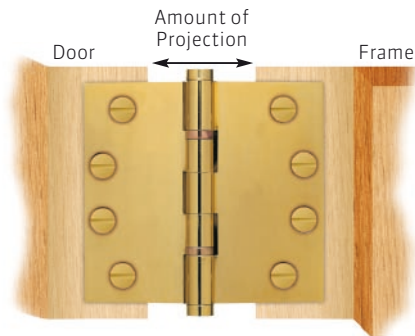

### Hinges Drilled for Projection

The 'P' symbol shown next to various hinges throughout the price list highlights our Projection Hinges. These are drilled with holes towards the edge of a broad hinge leaf enabling the hinge to clear obstructions when fully open beyond 90°.

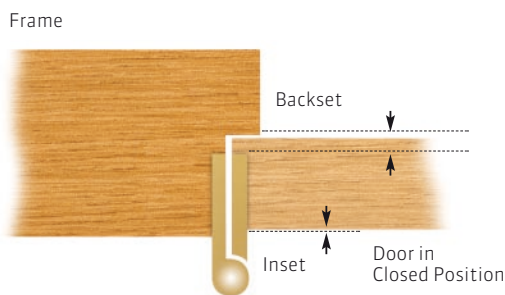

It is recommended that the backset should not be less than 12mm (14mm if using an intumescent strip).

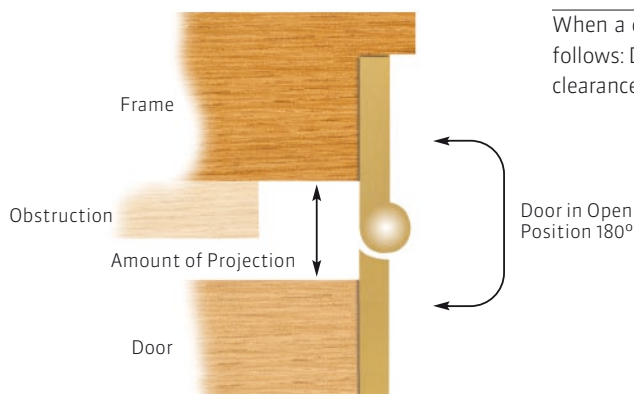

When a door is to be opened beyond 90° the width of a hinge can be calculated as follows: Door thickness plus inset (Normally 3.2mm) less backset. Double this and add clearance required.

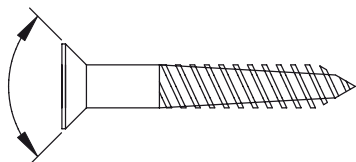

### Wood screws

Customers have the option of buying brass and aluminium hinges complete with the appropriate size and finish of wood screws. These screws are made by a leading international manufacturer of wood screws and are all recessed head type (Pozi drive).

The screws are approximate matching finishes for the hinges, and although not a perfect match, are the nearest finish available.

Details are as follows:-

#### Gauge/Size

N°4x1/2" (12.7mm)  
N°10x1.1/4" (32mm)

N°6x3/4" (19.05mm)  
N°12x1.1/4" (32mm)

N°8x1" (25.4mm)

## TECHNICAL INFORMATION

### BS EN1935: 2002 Building hardware Single-Axis hinges – Requirements and Test Methods

The standard provides details on product types, classification by use, test cycles, door mass, corrosion resistance, as well as definitions, product performance requirements, test apparatus, test methods and making of products. In addition, the published standards include annexes illustrating the various points made through diagrams and supplementary text.

This European Standard has replaced the previous national product performance standard BS 7352: 1990 Strength and durability performance of metal hinges for side hanging applications and dimensional requirements for template drilled hinges.

#### SCOPE

The standard includes a wide range of hinges and includes single axis hinges and lift off hinges for use on windows and doors.

#### DIGIT 1 – Category of use

For all internal or external doors for use by the public or others, with little or no incentive to take care. i.e. where there is chance of misuse of the door.

- Grade 1** Light duty. Example: Domestic or office situation, areas with no access to general public.
- Grade 2** Medium duty. Example: Domestic and office situation where limited access is allowed to the general public.
- Grade 3** Heavy duty. Example: Public and institutional buildings such as libraries, hospitals and schools.
- Grade 4** Severe duty. Example: Hinges for use on doors, which are subject to frequent violent usage..



#### DIGIT 2 – Number of test cycles

When deciding on finish and the best hinge for each application take into account; appearance to match both the environment and product; position of doors or windows within building and direction of opening; type of building use e.g. hospital and its location, coastal situation; frequency of use; (see tables A&B) security and fire resistance requirements.



#### TESTING – Refer to Table A

There are three categories identified for hinges manufactured to this standard.

- Grade 3** 10,000 test cycles
- Grade 4** 25,000 test cycles
- Grade 7** 200,000 test cycles

#### DIGIT 3 – Test door mass

Eight test door mass grades are identified according to table 1 of the BS EN1935: 2002 standard.



#### DIGIT 4 – Fire Behaviour

Two grades of fire behaviour are identified for hinges manufactured to this standard.

- Grade 0** Not Suitable for use on fire resistant and / or smoke control door assemblies
- Grade 1** Suitable for use on fire / smoke resistant door assemblies subject to satisfactory assessment of the contribution of the hinges to the fire resistance of the specified fire / door assemblies.



#### DIGIT 5 – Safety

All hinges are required to satisfy the essential requirement of safety in use. Therefore only grade 1 is identified.



## TECHNICAL INFORMATION

### BS EN1935: 2002 Building hardware Single-Axis hinges – Requirements and Test Methods



#### DIGIT 6 - Corrosion resistance

Five grades of corrosion resistance are identified according to BS EN1670:

- Grade 0 No defined corrosion resistance
- Grade 1 Mild resistance
- Grade 2 Moderate resistance
- Grade 3 High resistance
- Grade 4 Very high resistance



#### DIGIT 7 - Security - Burglar-resistance (seventh digit)

Two grades of security are identified for hinges manufactured to this European Standard:

- Grade 0 Not suitable for use on burglar –resistant door assemblies;
- Grade 1 Suitable for use on burglar resistant door assemblies, subject to satisfactory assessment of the contribution of the hinges to the burglar resistance of specified burglar-resistant door assemblies.



#### DIGIT 8 - Hinge grade

Fourteen grades of hinge are identified in this European Standard as detailed in Table A.

Table A

Grade	Max. mass of hinged door leaf kgs	Max. annual number of operations (cycles)
1	10	10,000
2	20	10,000
3	20	25,000
4	20	200,000
5	40	10,000
6	40	25,000
7	40	200,000
8	60	10,000
9	60	25,000
10	60	200,000
11	80	200,000
12	100	200,000
13	120	200,000
14	160	200,000



#### MARKING

The standard requires that single axis hinges manufactured in accordance with this standard for use on fire –resistant and or/ smoke control doors or locked doors on escape routes, shall be marked as follows:

- a) The manufacturers name or trademark or other means of identification
- b) The hinge grade according to Table A
- c) The number of the European Standard (BS EN 1935)

#### FIRE RATED HINGES

Hinges supplied for use on fire and escape door sets will be supplied complete with intumescent pads, which must be fitted behind each hinge flap, between the timber door and frame and the metal hinge leaves.

## TECHNICAL INFORMATION

### Hinge Installation

#### NUMBER OF HINGES

Normally three hinges are fitted to each door leaf in accordance with BS 4787 part 1. For doors exceeding 2100mm in height a fourth hinge should be used.

#### HINGE INSTALLATION

Hinges should be installed in accordance with the door manufacturer's recommendations and instructions. Where no such instructions are available care must be taken to ensure that the hinges are correctly aligned and fixed securely to door and frame. The screw holes should be piloted and screwheads must be flush with the hinge face to ensure that the door closes properly.

#### HINGE POSITIONING

It is usually acceptable to line up the centre hinge with the door handle.

Equally spaced hinges will minimise warping which may occur in environments with extremes of temperature or humidity on either side of the door, Fig.1, a and b.

Unequally spaced hinges Fig.1, c and d, improve load bearing. This is recommended where the hinges are operating near their load bearing maximum or where door closers, particularly back check door closers, are in operation and the door has a high frequency of use.

FIGURE 1

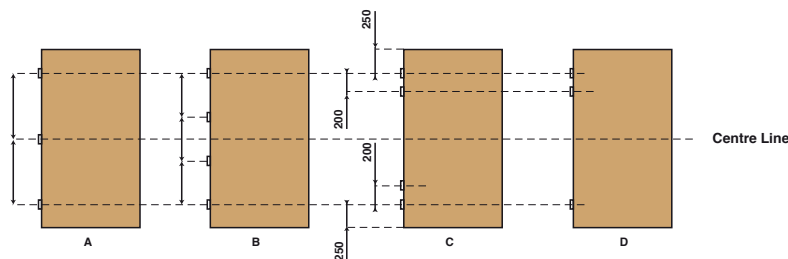

#### LIFT-OFF AND RISING/FALLING HINGES

Lift-off, rising and falling hinges are handed and must be specified to operate in either a clockwise closing or an anti-clockwise closing direction. The leaf with the pin in the upwards position must be fitted to the frame. Hinge operation is either clockwise closing or anti-clockwise closing and should be specified using the ISO 5 clockwise closing and ISO 6 anti-clockwise closing convention.

FIGURE 2

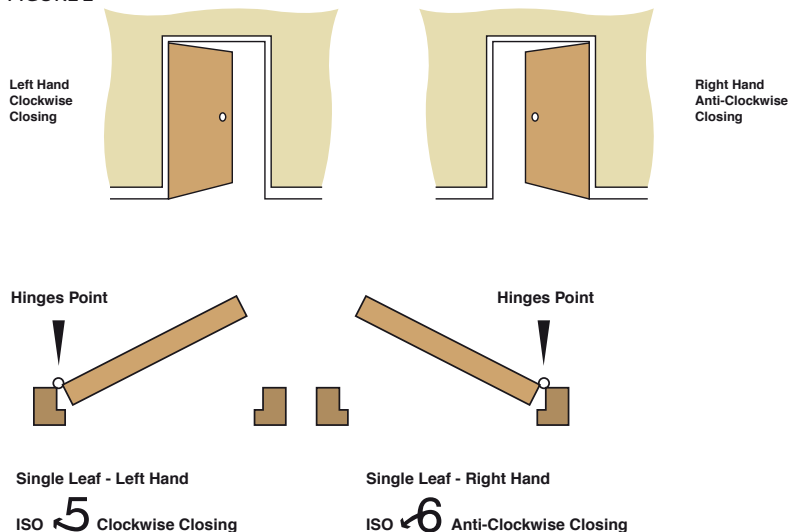

## TECHNICAL INFORMATION

### Hinge Installation

Table B

#### DOOR SITUATION AND ESTIMATED NUMBER OF OPERATIONS

<b>High frequency heavy duty situations:</b>	<b>Daily</b>	<b>Annually</b>
Large departmental store entrances	5,000	1,500,00
Large office building entrance	4,000	920,00
Cinema or theatre entrance	1,300	455,00
School entrance	1,250	225,00
Entrance door to school toilets	1,250	225,00
City centre shop entrance	1,000	300,00
Large city bank entrance	1,000	250,00
School corridor fire door	600	108,00
Town bank entrance	500	125,00
City centre restaurant entrance	500	150,00
Large office corridor fire door	450	120,00
Large office or factory toilet entrance	400	92,00
Hospital ward door	350	128,00
<b>Medium frequency medium duty situations:</b>		
School classroom door	80	15,00
Office door	75	18,00
Store toilet door	60	18,00
Dwelling rear or side entrance	15	5,40
Dwelling front entrance	12	4,40
<b>Low frequency light duty situations:</b>		
Dwelling living room communications doors	30	10,80
Dwelling bathroom/toilet door	20	7,20
Dwelling cupboard door	12	4,30
Dwelling bedroom door	9	3,20
Dwelling wardrobe/closet door	6	2,20
Dwelling cabinet furniture door	5	1,80

Table C

#### MASS RANGES OF TYPICAL DOORS

	<b>Size (mm)</b>	<b>Mass (kg)</b>	<b>Duty</b>
Cupboard, wardrobe, cabinet louvered doors and shutters	2040 x 626 x 40	3 to 10	Light
Light internal large wardrobe and large louvered doors	2040 x 926 x 40	10 to 17.5	Light
Medium internal doors	2040 x 1012 x 40	17.5 to 25	Medium
Heavy internal doors	2040 x 1012 x 40	25 to 37.5	Medium
Half hour fire doors	2040 x 826 x 44	25 to 37.5	Heavy
Light external doors	2040 x 907 x 40	20 to 37.5	Heavy
Heavy external doors	2040 x 1002 x 44	37.5 to 55	Heavy
One hour fire doors	2040 x 826 x 54	37.5 to 72.5	Heavy
Oversize or special external doors	2040 x 1200	55 to 110	Heavy

## TECHNICAL INFORMATION

---

### Hinge Installation

---

Table D

#### SIDE LOADING CALCULATIONS

Door Size		Factor	Normal Increase of mass of door leaf %
Door Height mm	Door Width mm		
2000	1000	2	0
2000	1050	1.9	10
2000	1100	1.82	18
2000	1150	1.74	26
2000	1200	1.66	33
2000	1250	1.6	40



our **PRODUCTSELECTOR** on  
[www.simonswerk.co.uk](http://www.simonswerk.co.uk)

Brochure Hinge Technology Issue 5  
08/2012



SIMONSWERK do not accept responsibility for misprints and subsequent specification changes although every effort has been made to avoid any errors during preparation of this brochure.

**SIMONSWERK UK Ltd.**

Burcot Works, Spring Street  
UK - Tipton, West Midlands DY4 8TF

Phone 0121 522 2848  
Fax 0121 557 7042

[sales@simonswerk.co.uk](mailto:sales@simonswerk.co.uk)  
[www.simonswerk.co.uk](http://www.simonswerk.co.uk)

