

8th Edition

Boneham and Turner Ltd
the precision engineers



www.boneham.co.uk

Shims



Shims to Order

- Rectangular, circular or special shapes
- Steel, brass, stainless, copper and laminated
- Thickness range .001" (0.025mm) to .125" (3.125mm) dependent on material
- Rapid quotation and manufacturing service
- Competitive Prices
- Quality Assured
- Quality Materials
- Large Tooling Range Available
- Deliveries to suit your requirements

Various Applications

- Pumps
- Clutches
- Actuators
- Brakes
- Valves
- Compressors
- Power Transmissions
- Gear Boxes

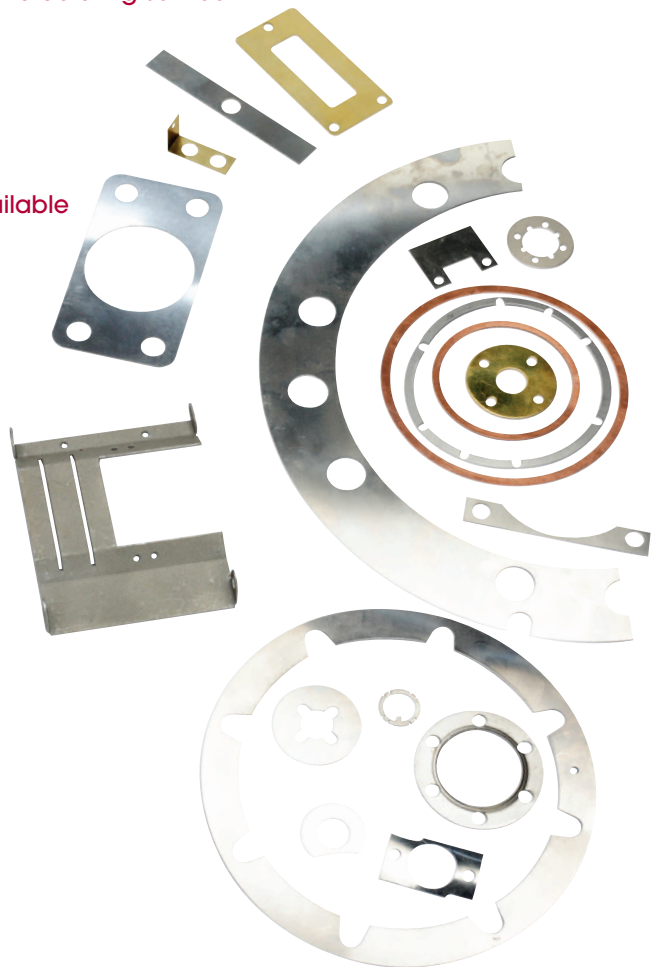

We would be pleased to quote for your requirements
Tel: 01623 445 450 Fax: 01623 445 451



Shim Material

Steel			CS4/CR4			Brass			CZ108			Stainless			302		
Thickness		Width	Thickness		Width	Thickness		Width	Thickness		Width	Thickness		Width			
.001	(.025mm)	12"	.002	(.05mm)	8"	.001	(.025mm)	12"									
.0015	(.038mm)	12"	.003	(.076mm)	12"	.002	(.05mm)	12"									
.002	(.05mm)	24"	.004	(.1mm)	6"	.003	(.076mm)	12"									
.003	(.076mm)	24"	.005	(.127mm)	12"	.004	(.1mm)	12"									
.004	(.1mm)	24"	.010	(.25mm)	12"	.005	(.127mm)	12"									
.005	(.127mm)	24"	.015	(.38mm)	12"	.006	(.152mm)	12"									
.006	(.152mm)	24"	.020	(.5mm)	12"	.008	(.2mm)	12"									
.007	(.177mm)	24"				.010	(.25mm)	12"									
.008	(.2mm)	24"				.015	(.38mm)	6"									
.010	(.25mm)	24"				.020	(.5mm)	12"									
.012	(.30mm)	12"				.025	(.635mm)	12"									
.015	(.38mm)	24"				.030	(.76mm)	TO ORDER									
.020	(.5mm)	24"				.040	(1mm)	TO ORDER									
.025	(.635mm)	12"															
.030	(.76mm)	TO ORDER															
.030	(.91mm)	TO ORDER															
.040	(1mm)	TO ORDER															
.050	(1.27mm)	TO ORDER															
.060	(1.5mm)	TO ORDER															
.080	(2.03mm)	TO ORDER															
.100	(2.54mm)	TO ORDER															
.118	(3mm)	TO ORDER															
.125	(3.17mm)	TO ORDER															

All thicknesses to standard gauge sizes
 Other materials available to order - Aluminium, Phospher Bronze
 Also Laminated Steel, Brass, Aluminium, Stainless Steel



Euco Milling Arbor Micrometer Spacers

Imperial								
REF	BORE	OD	KEY WAY WIDTH	KEY WAY DEPTH	FLANGE DIAM	THREAD DIAM	MINIMUM WIDTH	EXPANSION
MSSO	3/4	1.48	1/8	5/64	1.22	1.04	.250	.040
MSSOA	3/4	1.48	1/8	5/64	1.22	1.04	.438	.080
MSS1	1	1.88	1/4	3/32	1.50	1.44	.250	.040
MSS1A	1	1.88	1/4	3/32	1.50	1.44	.438	.080
MSS2	1.1/4	2.22	5/16	1/8	1.88	1.72	.250	.040
MSS2A	1.1/4	2.22	5/16	1/8	1.88	1.72	.438	.080
MSS3	1.1/2	2.56	3/8	5/32	2.19	2.10	.250	.040
MSS3A	1.1/2	2.56	3/8	5/32	2.19	2.10	.438	.080
MSS4B	2	3.31	1/2	3/16	2.81	2.68	.438	.080
MSS5	2.1/2	3.98	5/8	7/32	3.50	3.25	.438	.080

Metric								
REF	BORE	OD	KEY WAY WIDTH	KEY WAY DEPTH	FLANGE DIAM	THREAD DIAM	MINIMUM WIDTH	EXPANSION
MSM5	16	34.30	4	2	27	23.30	6.30	1
MSM5A	16	34.30	4	2	27	23.30	11	2
MSM7	22	43.20	6	2.61	35	31.75	6.30	1
MSM7A	22	43.20	6	2.61	35	31.75	11.00	2
MSM1	27	50.20	7	3.25	43	38.90	6.30	1
MSM1A	27	50.20	7	3.25	43	38.90	11.00	2
MSM12	32	56.20	8	3.25	48	43.66	6.30	1
MSM12A	32	56.20	8	3.25	48	43.66	11.00	2
MSM12D	32	54.00					17.50	5
MSM15	40	67.10	10	4	58	55.70	6.30	1
MSM15A	40	67.10	10	4	58	55.70	11.00	2
MSM15D	40	62.00					17.50	5
MSM20A	50	83.60	12	4	71	68.26	11.00	2
MSM25A	60	100.80	14	4.50	89	81.15	11.00	2

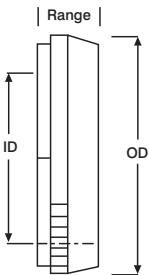

Min. expansion

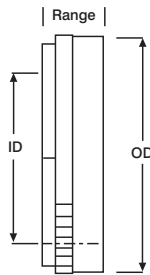

max. expansion

The material used is an alloy steel specially selected for wear resistance and durability, satin chrome plated, faces lapped.

All spacers have a thread pitch of 1mm. The engraved scale on imperial spacers is provided with 40 divisions, every fourth division is numbered (0-9) each graduation is .001" and adjustment is accurate to approximately .0005". Any closer adjustment is easily made after a trial cut.

Metric spacers have 50 divisions, every fifth division is numbered (0-9) each graduation is .02mm and adjustment is accurate to approximately 0.1mm

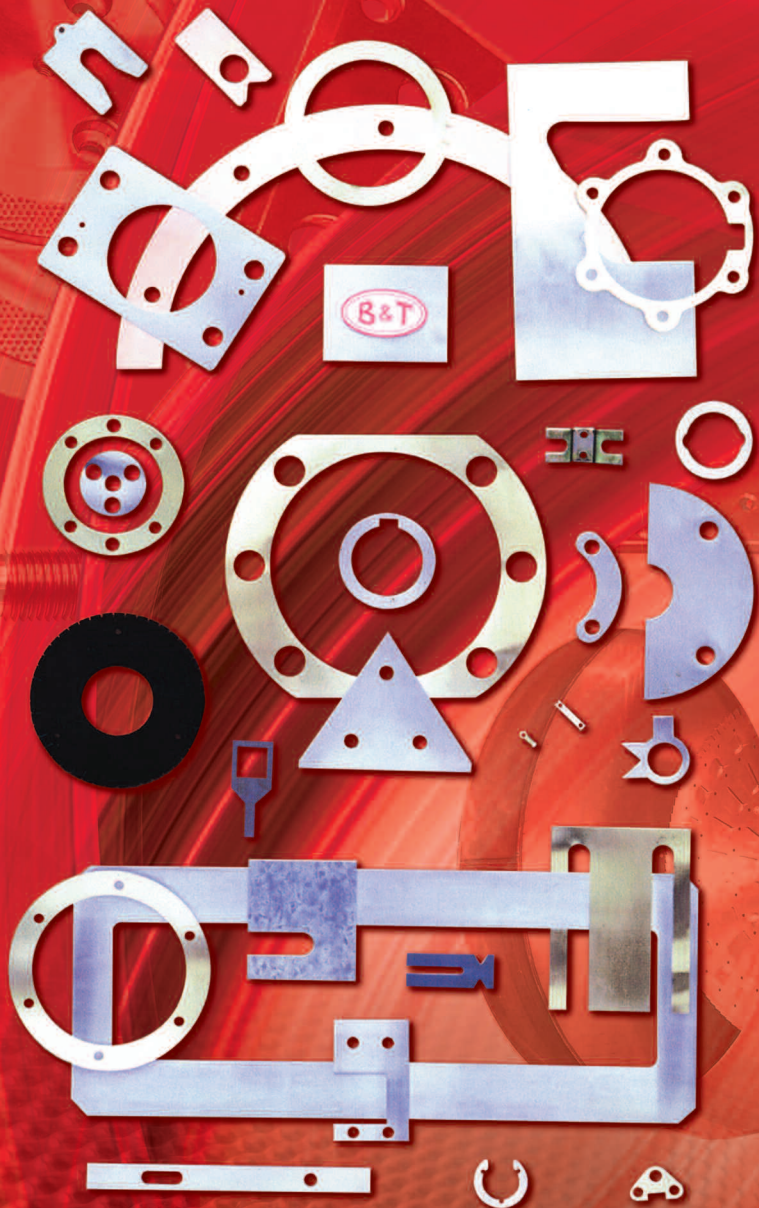

Range of Shims

Oddicroft Industrial Estate, Oddicroft Lane, Sutton In Ashfield,
Nottinghamshire NG17 5FS

Telephone: +44 (0)1623 445 450 Fax: +44 (0)1623 445 451

www.boneham.co.uk sales@boneham.co.uk



FM25000
ISO 9001