

// Comprehensive fire protection: fire and smoke protection combined



## Sliding Fire Doors

T30 and T90 Single and Double-Leaf





## Fire protection

**T30**

**T90**

# Hörmann Sliding Fire Doors for the Reliable Protection of Buildings

### Hörmann T30/T90 Sliding Doors On request also smoke-tight

For all building areas Hörmann supplies reliable sliding door solutions, matched to the thermal load and meeting the operational and risk-level requirements. These are available as single and double-leaf versions and, if required, also with a smoke-tight function for safeguarding emergency and escape routes (see also pages 6, 7).

The designs with fire protection characteristics are tested to DIN 4102, are continually quality monitored by the materials testing institute in Brunswick and are approved by the DIBt (German Institute for Construction Engineering), Berlin.

Approval certificates:

No. Z-6.12-1462	T30 HG 21, single leaf
No. Z-6.12-1653	T30 HG 15, double leaf
No. Z-6.11-1463	T30 HG 18, single leaf
No. Z-6.11-1690	T30 HG 17, double leaf

In-house checks and external monitoring ensure the recognized high quality standard of our products; in the case of fire doors in compliance with the regulations and with smoke-tight doors in accordance with our own self-commitment and sense of responsibility.

Depending on the approval, fire and smoke-tight sliding doors are suitable for 2-3 operations per day.

### Design and quality features

- Door leaf, double-skinned, overall thickness 72 mm
- Flush-fitting construction of door leaf high panels in any height (panel width depending on door height 300-1170 mm)
- Neat panel joints with no cover plates to compromise the aesthetics
- 1 mm thick stress-free straightened thin steel sheets
- Insulating boards bonded over the entire surface, so nothing can warp
- Wicket door opening in both directions optional
- Double-leaf doors on request also with unequal leaf width  
Minimum leaf width 1000 mm
- Surface: door leaf, track cladding and closing weight cover in galvanized material.  
On request, primer-coated in off-white (similar to RAL 9002).  
RAL to choice on request
- Low door leaf weight  
T30 only 40 kg/m<sup>2</sup>  
T90 only 50 kg/m<sup>2</sup>
- Low-cost, time-saving installation



## Safety that Comes with the Competence of the Specialist

### Fittings and closing devices

- Top track section fully clad across the entire width (structural opening and parking area)
- The individual panels are suspended from the track via sprung track roller pairs on ball bearings
- Closing weight entirely covered
- Grab and inset handle on the closing side panel (with double-leaf doors on both sides)
- Bottom guide roller on the fitted side located on the end panel
- Automatic closing via counterweight
- Closing with hydraulic end-of-travel damping
- Closing controller for infinite control of the closing speed

Sliding doors are generally supplied without a lock (lock available on request).

### Size range (Clear opening size)

### Dimensions in mm

Size range (Clear opening size)	Dimensions in mm	
<b>T30 HG 21</b>	single-leaf	
Width	1000 - 1500	1501 - 8500
Height	2000 - 2500	2000 - 6000
<b>T30 HG 15</b>	double-leaf	
Width	2500 - 3000	3001 - 8500
Height	2000 - 2500	2000 - 6000
<b>T90 HG 18</b>	single-leaf	
Width	1000 - 1500	1501 - 8500
Height	2000 - 2500	2000 - 6000
<b>T90 HG 17</b>	double-leaf	
Width	2500 - 3000	3001 - 8500
Height	2000 - 2500	2000 - 6000

For fitting details and diagrams of sizes see pages 8-11

SPECIFICATIONS: [WWW.HOERMANN.COM](http://WWW.HOERMANN.COM)

Copyright. No part of this brochure may be reproduced without our permission.  
Subject to design changes.



## Fire protection

T30

T90

# Special Solutions for Special Applications

### Hold-open device

The hold-open device is made up of the following components:

- 1 magnetic clamp per door leaf
- 2 smoke detectors (further smoke detectors depending on door size and on-site conditions), for configuration of smoke detectors see page 15.
- 1 mains rectifier 24V
- 1 surface-mounted push-button

### Wall types and fitting

The doors are approved for fitting into:

- concrete** ≥ 140 mm, plug-and-screw fixing
- brickwork** ≥ 240 mm, threaded rods
- gas concrete** ≥ 240 mm, plug-and-screw fixing or threaded rods

### For the lintel the following conditions apply

For fire-resistant walls of masonry a **reinforced concrete lintel** is necessary across the width of the structural opening. The lintel in the parking area must be made of fire-resistant masonry. For fire-resistant walls of concrete or gas concrete, a reinforced concrete lintel is also necessary in the side parking area, in other words across the entire length of the track.

### Special door versions

- Recess shutter on T30/T90 doors for improved aesthetics (see page 14)
- T30/T90 doors for applications involving a continuous ceiling with non-bearing lintel (see pages 8-10)
- T30/T90 doors in a radiused version (radius at least 15°) subject to approval in individual cases
- Different versions are possible following prior enquiry and subject in each instance to the approval of the highest building authorities in the respective country.

### Further special options and equipment

- Siting of the closing weight behind the opened door on single-leaf doors
- Mortise/swivel bolt lock, e.g. to secure storerooms, perforated for profile cylinder, backset 120 mm, fitted at the factory.
- Profile cylinder 40.5 + 40.5 mm
- Electric opener, suitable for 2-3 door operations per day (no increase in the opening frequency).  
Separate controls, photocell, red signal light and acoustic signal  
For double-leaf doors the following applies:
  - equal division of door leaves = 1 opener (increased headroom)
  - unequal division of door leaves = 2 openers



## The Practical Alternative Simply Open the Wicket Door

### Sliding doors with wicket door with or without threshold

For the fluent flow of pedestrian traffic and the easy wheeling through of sack trucks or smaller transport vehicles in the version without threshold. For fire protection reasons, it is general practice to equip wicket doors with a slide rail overhead door closer.

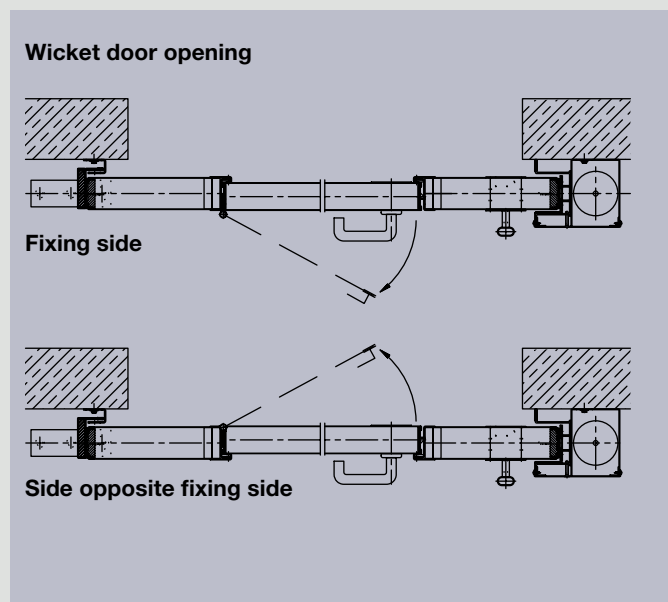

Wicket door	with threshold	without threshold
Overall thickness		
<b>T30</b>	62	62
<b>T90</b>	72	62
Fitted from structural opening width		
<b>T30</b>	2125	2125
<b>T90</b>	2125	2125
Fitted in structural opening heights		
<b>T30</b>	2300 - 6000	2100 - 6000
<b>T90</b>	2300 - 6000	2100 - 6000
Lever handle set with profile cylinder/cylinder length		
<b>T30</b>	40.5 + 35.5	40.5 + 35.5
<b>T90</b>	40.5 + 45.5	40.5 + 35.5
Clear passage		
<b>T30</b>	1000 x 1962	1000 x 2000
<b>T90</b>	1005 x 1963	1000 x 2003
Threshold height approx.		
<b>T30</b>	42	--
<b>T90</b>	42	--



**Fire/smoke protection**

**T30**      **T90**

## Smoke-Tight Sliding Fire Doors for Safe Emergency and Escape Routes

**Fire protection plus smoke-tightness**  
**The safe system**

Over and above the fire protection function, Hörmann smoke-tight sliding fire doors (DIN 4102) are also tested in accordance with the requirements for smoke-tightness (DIN 18095). They are recommended for all areas with pedestrian traffic where in the event of fire it is vital to protect people against the spread of highly dangerous smoke gases, such as in hospitals, supermarkets, D.I.Y. superstores, underground garages and large entertainment complexes.

**All-round seal provides a high level of smoke-tightness**

The newly developed seal to all 4 sides comprises lateral seals at the sides as well as drag seals at the top and bottom. An additional, flat stainless steel floor rail affords the door a smooth-sliding action.

**Single and double-leaf smoke-tight doors up to a door leaf surface of 28 m<sup>2</sup>**

Hörmann supplies smoke-tight sliding doors up to the 28 m<sup>2</sup> size range (clear opening size) combined with the fire-resistant classes T30 and T90 as single and double-leaf door versions\*.

**For smoke-tightness reasons, these doors are not approved for use with a wicket door.**

**Design and quality features**

- Door leaf, double-skinned, overall thickness 72 mm
- Flush-fitting construction of door leaf high panels in any height (panel width depending on the door height 300-1170 mm)
- Neat panel joints without any cover sheets to compromise the aesthetics
- 1 mm thick stress-free straightened thin metal sheets
- Insulating boards bonded over the entire surface, so nothing can warp
- Double-leaf doors on request also with unequal leaf width  
Minimum leaf width 1000 mm
- Surface: door leaf, track cladding and closing weight cover in galvanized material. On request, primer-coated in off-white (similar to RAL 9002). RAL to choice on request
- Low door leaf weight  
T30 only 40 kg/m<sup>2</sup>  
T90 only 50 kg/m<sup>2</sup>
- Low-cost, time-saving installation



## Comprehensive Fire Protection: Fire and Smoke Protection Combined

### Fittings and closing devices

- Top track section fully clad across the entire width (structural opening and parking area)
- The individual panels are suspended from the track via sprung track roller pairs running on ball bearings
- Closing weight entirely covered
- Grab and inset handle on the closing side panel (with double-leaf doors on both sides)
- Bottom guide roller on the fixing side located on the end panel
- Counterweight for automatic closing
- Closing with hydraulic end-of-travel damping
- Closing controller for infinite control of the closing speed

Sliding doors are generally supplied without a lock (lock available on request)

### Wall types and fitting

The doors are approved for fitting into:

- concrete** ≥ 140 mm, plug-and-screw fixing
- brickwork** ≥ 240 mm, threaded rods
- gas concrete** ≥ 240 mm, plug-and-screw fixing or threaded rods

### For the lintel the following conditions apply

For fire-resistant walls of masonry a **reinforced concrete lintel** is necessary in the area of the structural width. The lintel in the parking area must be of fire-resistant masonry.

For fire-resistant walls of concrete or gas concrete, a reinforced concrete lintel is also necessary in the side parking area, in other words across the entire length of the track.

### Size range Dimensions in mm (Clear opening size)

Size range	Dimensions in mm (Clear opening size)
<b>T30</b> <b>T90</b>	single-leaf
Width	1500 - 7000*
Height	2000 - 4500*
<b>T30</b> <b>T90</b>	double-leaf
Width	3000 - 7000*
Height	2000 - 4500*

In the above size ranges we supply smoke-tight sliding fire doors in T30 (fire-retardant) and T90 (fire-resistant).

### \*Maximum sizes

	6000	6250	6500	6750	7000
Width	6000	6250	6500	6750	7000
Height	4500	4375	4250	4125	4000

For fitting details and diagrams of sizes see pages 12-13

# Single-Leaf Sliding Doors, HG 21, HG 18 Fitting Details

View of door/vertical section

Sliding fire doors are fitted to the interior wall

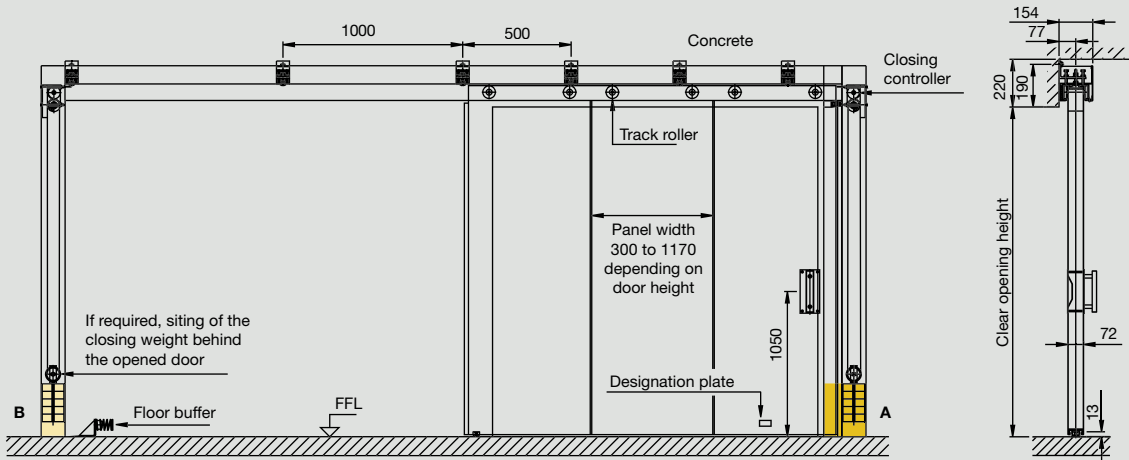

Horizontal section

Space required for closing weight on run-in side

A

T30	Opening width + 400 mm	with opener + 200 mm
T90	Opening width + 440 mm	with recess shutter + 80 mm

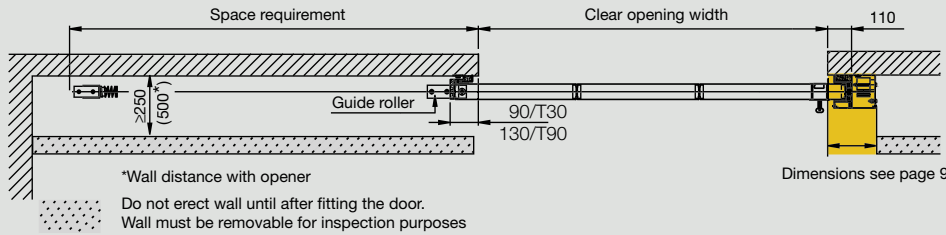

Horizontal section

Space required for closing weight behind opened door

B

T30	Opening width + 400 mm	with opener + 200 mm
T90	Opening width + 440 mm	with recess shutter + 80 mm

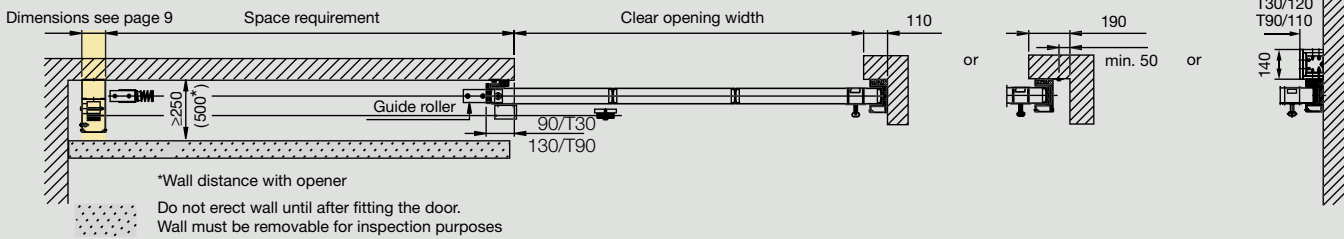

Wall and ceiling installation

Dimensions in mm

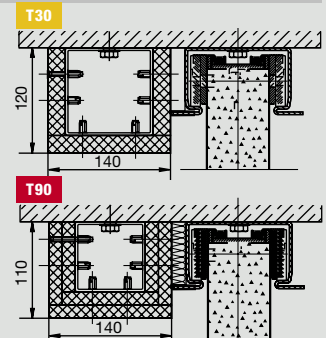
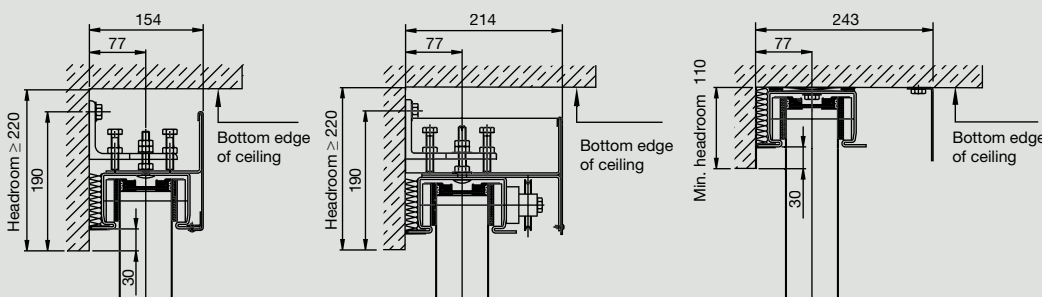

Wall installation (standard)  
Closing weight on run-in side

Wall installation (standard)  
Closing weight behind the opened door

Ceiling installation

Ceiling installation  
Dummy lintel

# Single-Leaf Sliding Doors Fitting Details

Space required for closing weight (depends on size)

Dimensions in mm

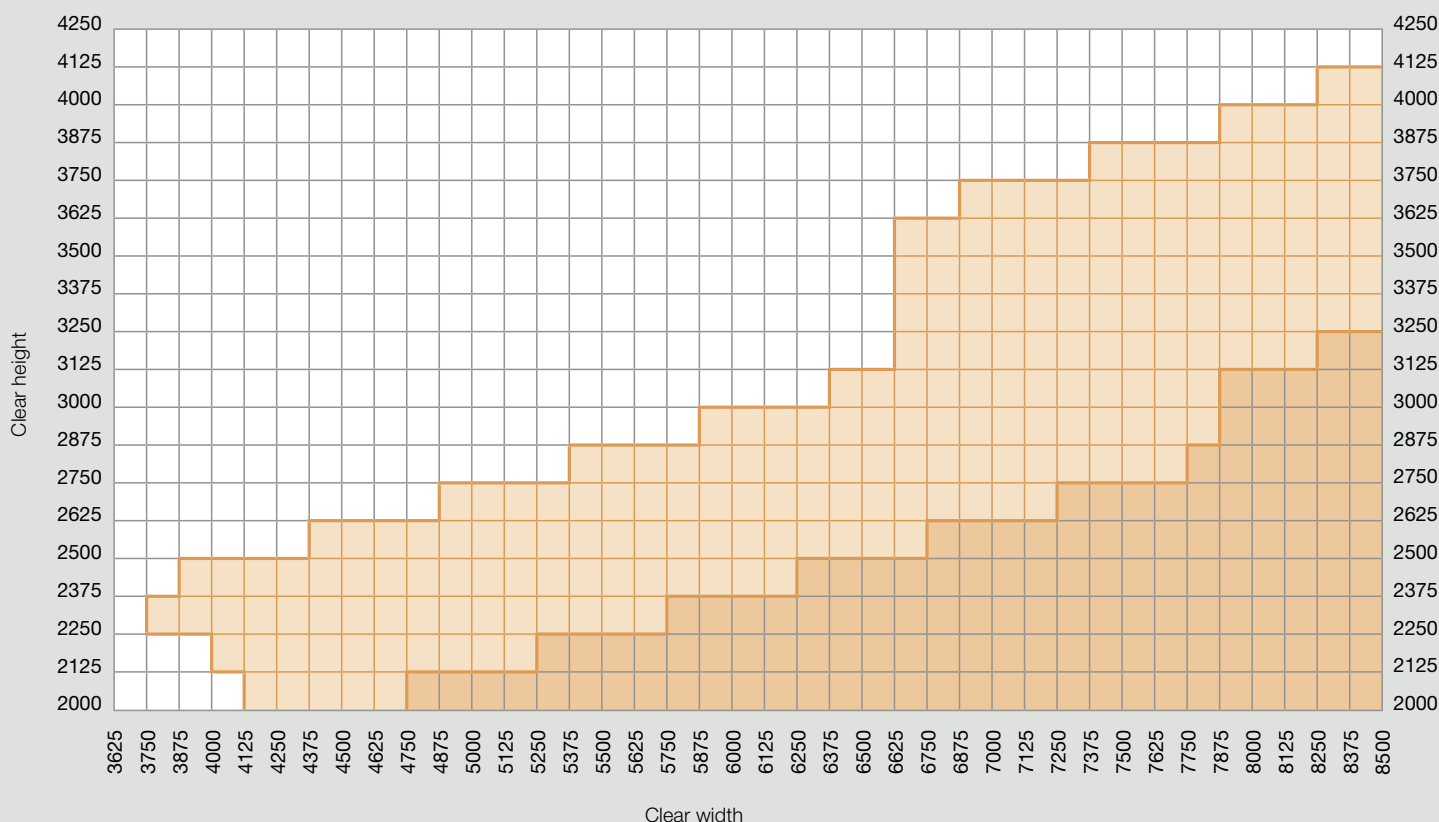

	Space required for closing weights	Opener					
		without	with	without	with	without	with
<b>A</b>	Run-in without recess shutter	230	345	340	455	450	565
	Run-in with recess shutter	270	385	380	495	490	605
<b>B</b>	Behind the opened door	115	230	230	345	340	455

Diagram of sizes also applies to	T30	T90	T30	T90
Width x Height	1000 x 2500 up to 1500 x 2500		1501 x 6000 up to 8500 x 6000	

Space required in the parking area		T30	T90
<b>A</b>	Sliding fire door	Width + 400*	440*
	Opener without closing weight	Width + 600*	640*
	1 recess shutter without opener	Width + 480*	520*
	2 recess shutters without opener	Width + 560*	600*
	1 recess shutter without opener	Width + 680*	720*
	2 recess shutters with openers	Width + 760*	800*
<b>B</b>	*plus required space for closing weight behind the opened door		

8 examples for establishing the space requirement: single-leaf T30 sliding door 6000 x 2500 mm					
Space requirement	Version with:				
	Fire door	recess shutter	opener	opener + recess shutter	
<b>A</b>	Closing weight	340	380	455	495
	Parking area	6400	6560 (6480)	6600	6760 (6680)
<b>B</b>	Closing weight	230	230	345	345
	Parking area	6630	6710	6945	7025

# Double-Leaf Sliding Doors, HG 15, HG17 Fitting Details

## View of door/vertical section

Sliding fire doors are fitted to the interior wall

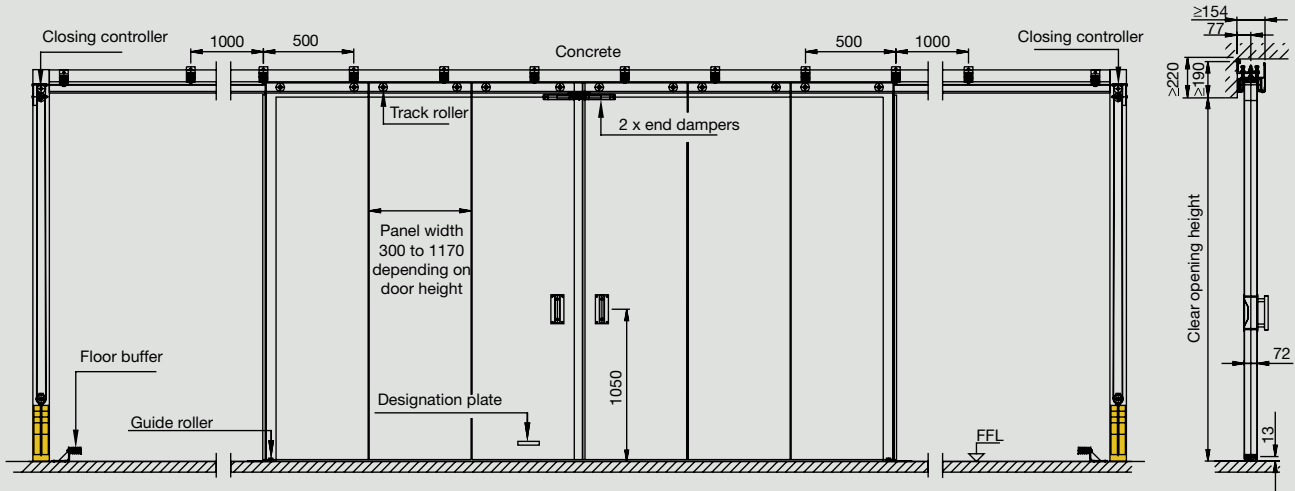

## T30 Horizontal section

## Space required for closing weight

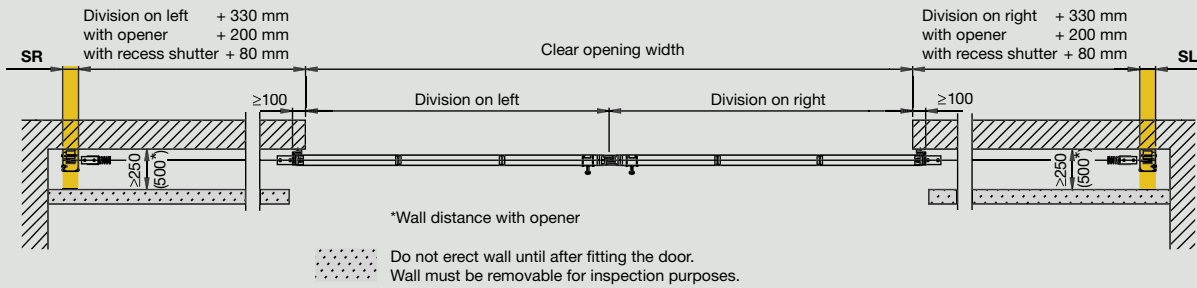

## T90 Horizontal section

## Space required for closing weight

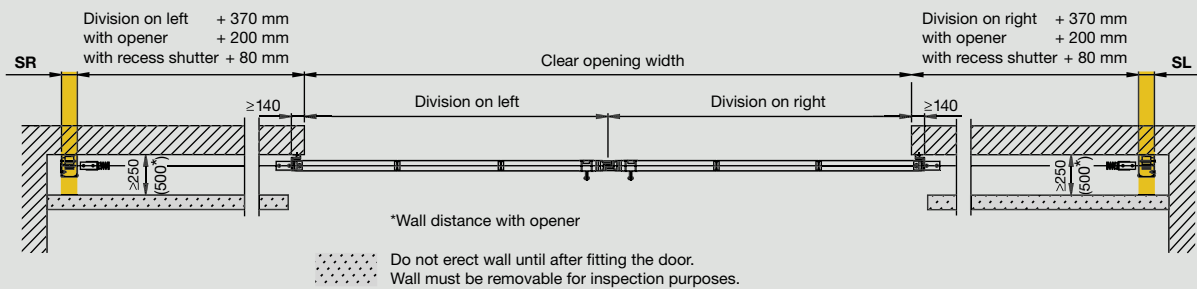

## Wall and ceiling installation

## Dimensions in mm

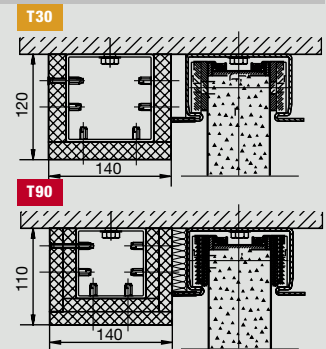
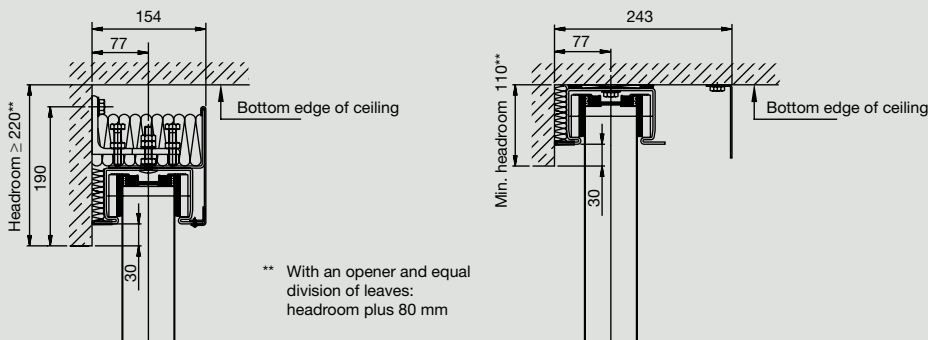

Wall installation (standard)

Ceiling installation

Ceiling installation  
Dummy lintel

# Double-Leaf Sliding Doors Fitting Details

Space required for closing weight (depends on size) **per door leaf**

Dimensions in mm

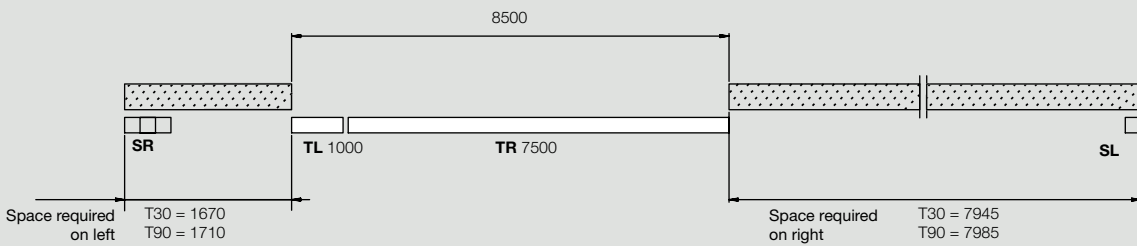
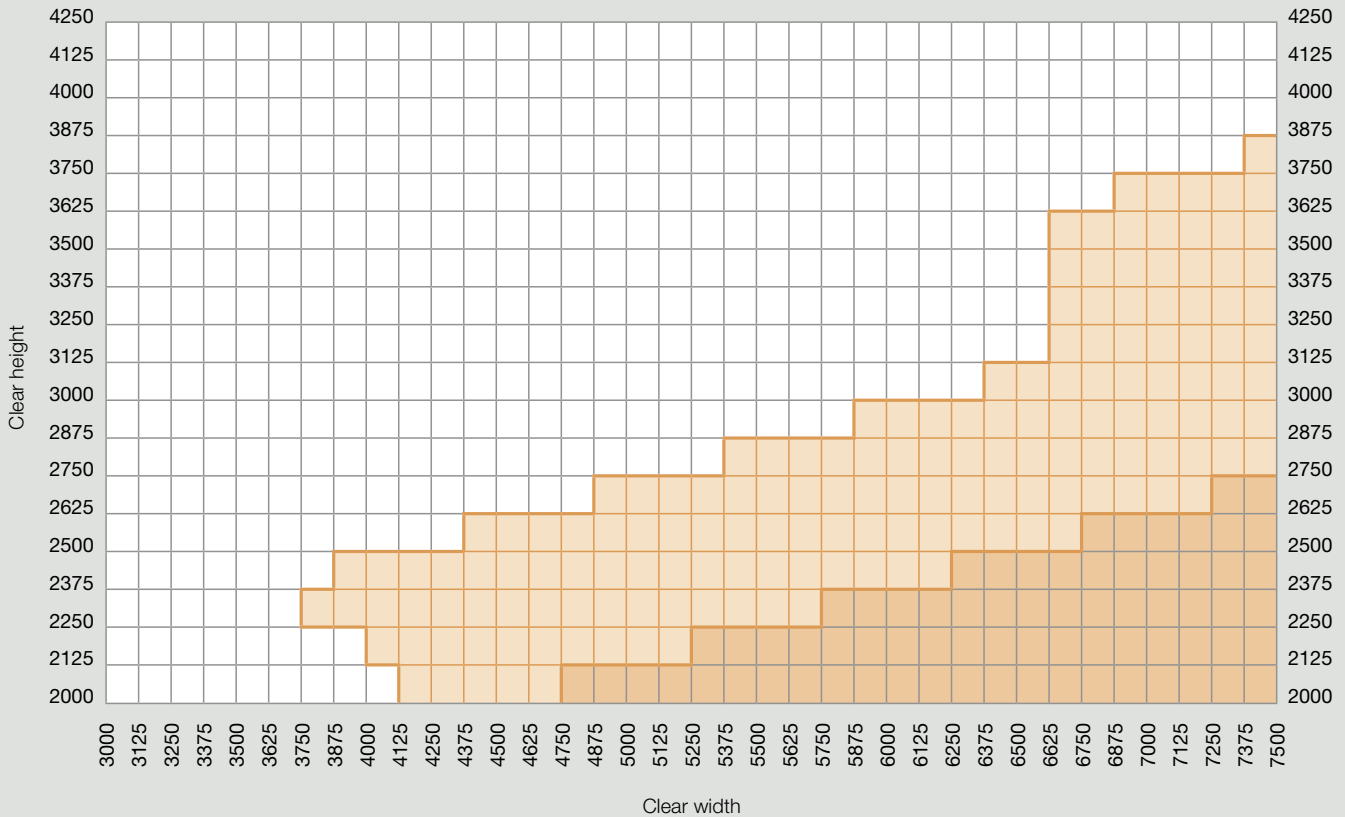

We show the space required on both sides for a structural opening size of 8500 x 2500 mm with unequal division of a double-leaf door without opener and recess shutter.

- TL = Door section on left
- TR = Door section on right
- SL = Space required for closing weight, door section on left (in parking area on right)
- SR = Space required for closing weight, door section on right (in parking area on left)

Space required for closing weights	Opener					
	without	with	without	with	without	with
Parking area SL/SR	115	230	230	345	340	455

Diagram of sizes also applies to	T30	T90	T30	T90
Width x Height	2500 x 2500 up to 3000 x 2500		3001 x 6000 up to 8500 x 6000	3001 x 6000 up to 8500 x 6000

Space requirement in the parking area	T30		T90	
	left	right	left	right
Sliding fire door	TL+330+SR	TR+330+SL	TL+370+SR	TR+370+SL
with opener	TL+530+SR	TR+530+SL	TL+570+SR	TR+570+SL
with recess shutter	TL+410+SR	TR+410+SL	TL+450+SR	TR+450+SL
with opener plus recess shutter	TL+610+SR	TR+610+SL	TL+650+SR	TR+650+SL

Overall space requirement for central division of leaves up to 7000 mm opening width	T30	T90
Sliding fire door	Width + 890	970
Opener	Width + 1090	1170
Recess shutter without opener	Width + 1050	1130
Recess shutter with opener	Width + 1250	1330

# Single and Double-Leaf Sliding Doors Fitting Details

View of door/vertical section

Fire and smoke-tight sliding doors are fitted to the interior wall

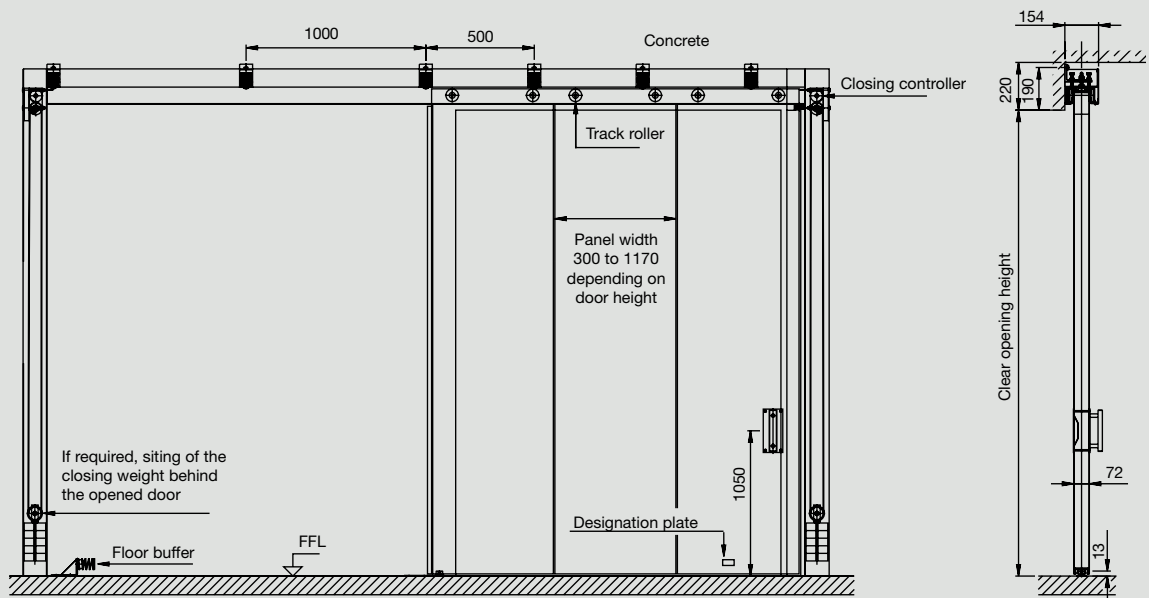

Parking area

**T90**

Run-in side

**T30** **T90**

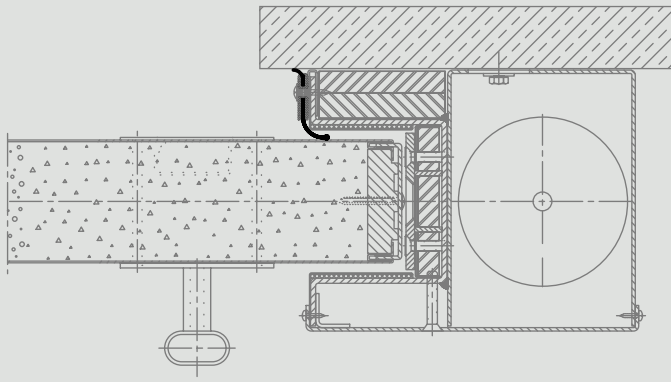
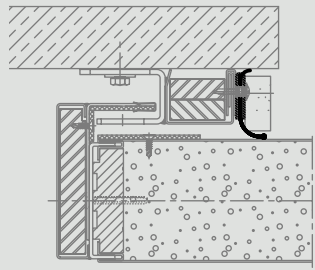

**T30**

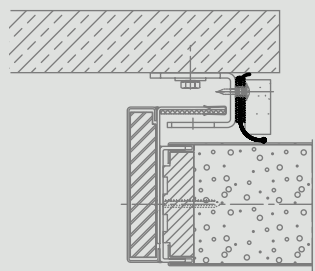

Wall and ceiling installation as for fire and smoke-tight sliding doors, see fitting details on pages 8-11.

# Single and Double-Leaf Sliding Doors Fitting Details

Size range (clear opening size)

Dimensions in mm

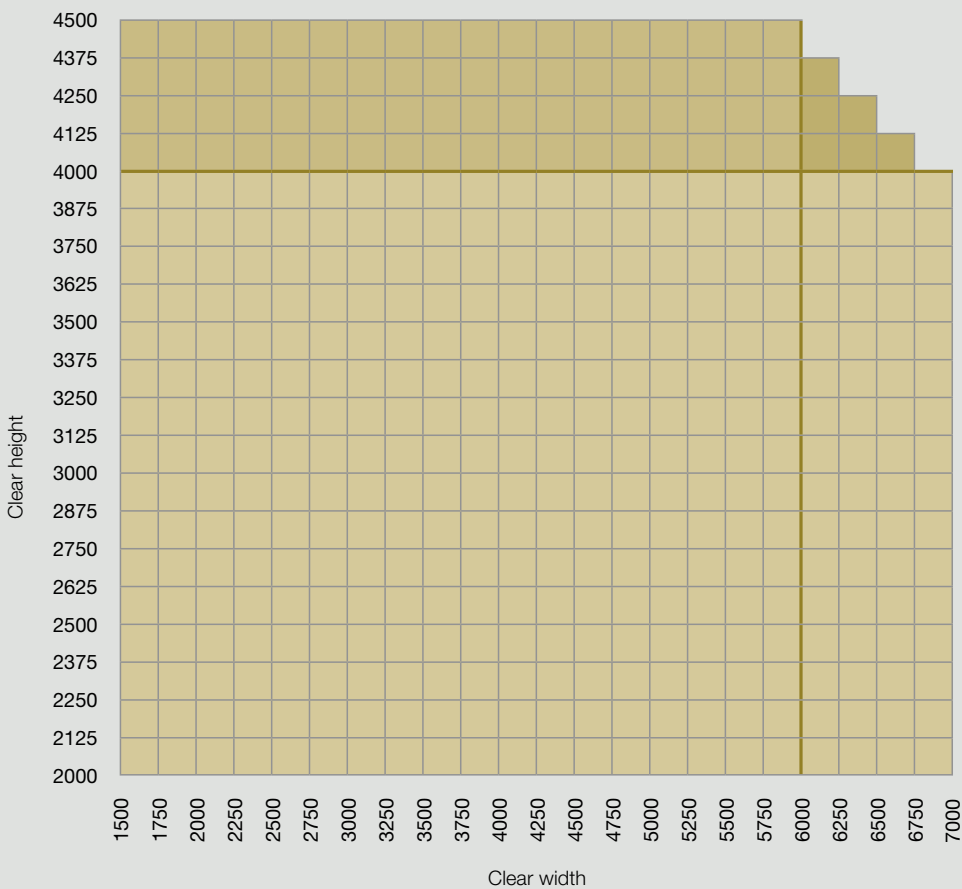

Maximum sizes

Width	6000	6250	6500	6750	7000
Height	4500	4375	4250	4125	4000

**Top door guidance**

**T30** **T90**

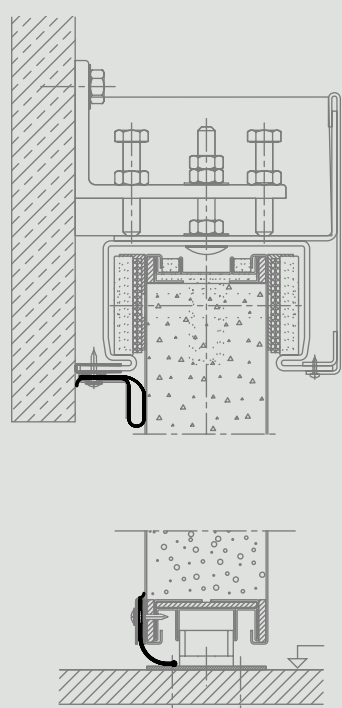

**Bottom door guidance with stainless steel rail**

# Recess Shutter for Single and Double-Leaf Sliding Doors

For fire and smoke-tight sliding doors fitted between a wall recess

Dimensions in mm

Sliding door closed

Recess shutter opened

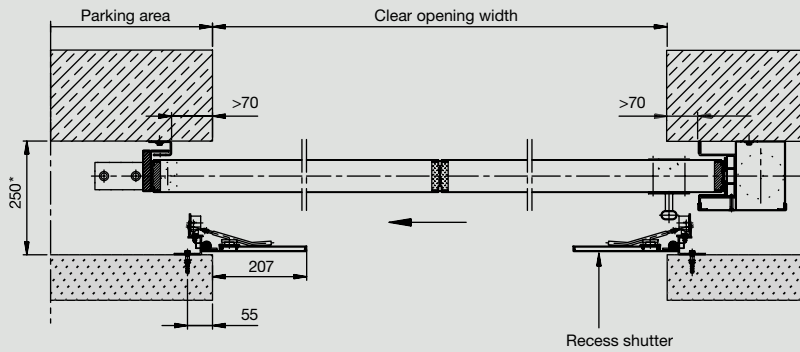

Diagram shows a recess shutter on both sides, also possible on one side.  
\* Wall distance with opener 500 mm.

Sliding door opened

Recess shutter closed

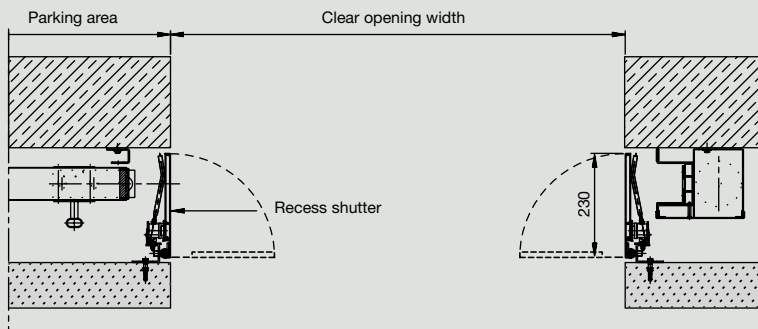
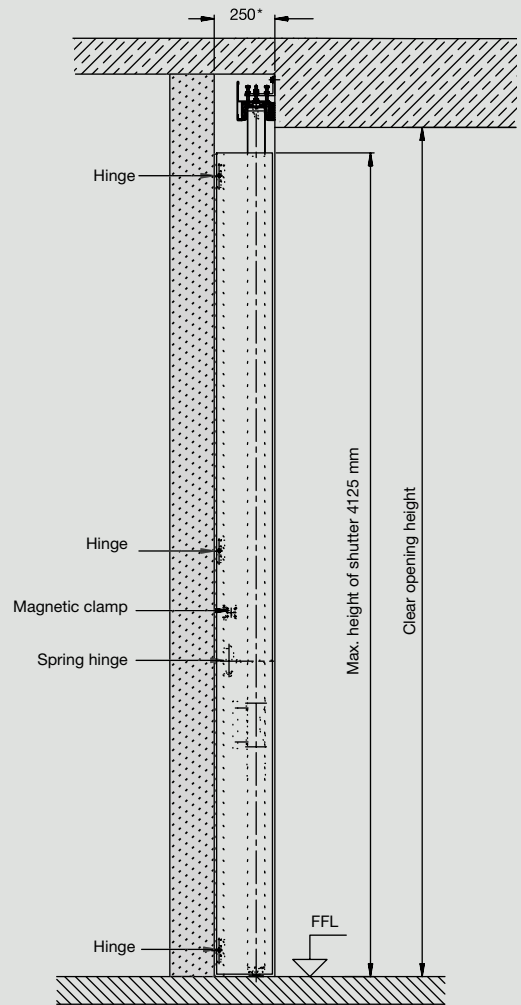

Diagram shows a recess shutter on both sides, also possible on one side.



Do not erect wall until after fitting the door.  
Wall must be removable for inspection purposes.

Space required in the parking area for single-leaf sliding doors see page 9.  
Space required in the parking area for double-leaf sliding doors see page 11.

Recess shutter for sliding fire doors T30 and T90, single and double-leaf  
Material: galvanized steel, surface in door colour.  
Shutter width: 230 mm (wall distance 250 mm).  
Shutter height: max. 4125mm

No retrofitting possible because a wider door leaf is required!

# Configuration of Smoke Detectors

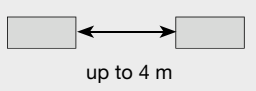
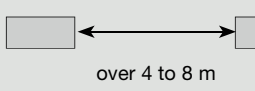
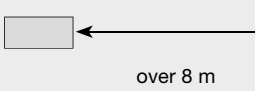
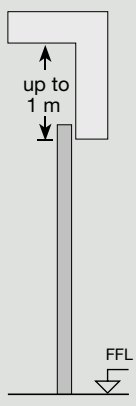
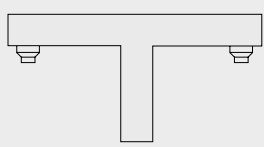
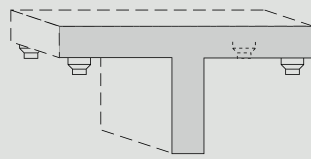
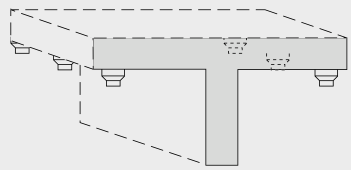
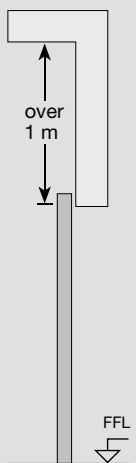
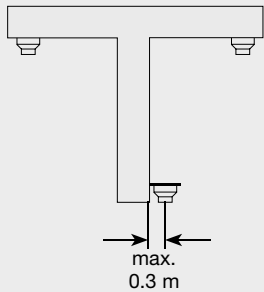
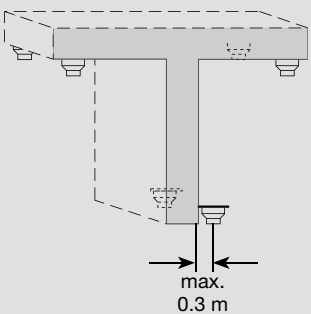
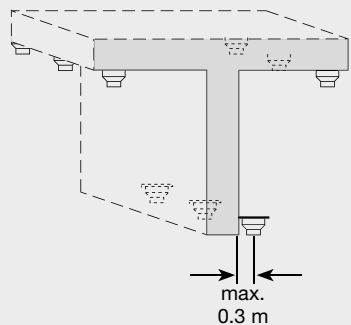
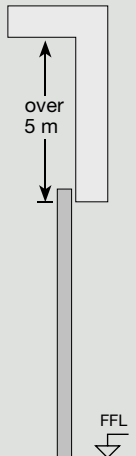
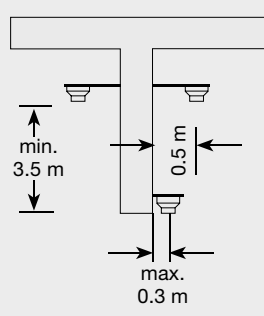
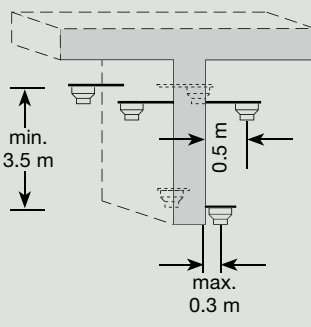
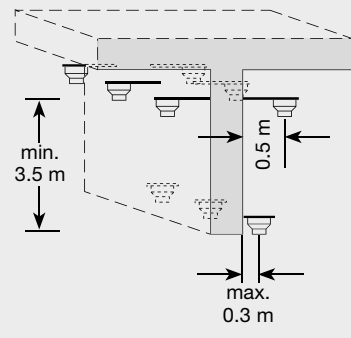
Opening width	Dimensions in mm		
	 <p>up to 4 m</p>	 <p>over 4 to 8 m</p>	 <p>over 8 m</p>
Headroom	2 ceiling detectors	4 ceiling detectors	6 ceiling detectors
<p><b>1</b></p> 	<p><b>A</b></p> 	<p><b>B</b></p> 	<p><b>C</b></p> 
Headroom	2 ceiling-/1 lintel detector	4 ceiling-/2 lintel detectors	6 ceiling-/3 lintel detectors
<p><b>2</b></p> 	<p><b>A</b></p>  <p>max. 0.3 m</p>	<p><b>B</b></p>  <p>max. 0.3 m</p>	<p><b>C</b></p>  <p>max. 0.3 m</p>
Headroom	3 lintel detectors	6 lintel detectors	9 lintel detectors
<p><b>3</b></p> 	<p><b>A</b></p>  <p>min. 3.5 m</p> <p>0.5 m</p> <p>max. 0.3 m</p>	<p><b>B</b></p>  <p>min. 3.5 m</p> <p>0.5 m</p> <p>max. 0.3 m</p>	<p><b>C</b></p>  <p>min. 3.5 m</p> <p>0.5 m</p> <p>max. 0.3 m</p>

# Hörmann: Quality without Compromise



Hörmann KG Amshausen



Hörmann KG Antriebstechnik



Hörmann KG Brandis



Hörmann KG Brockhagen



Hörmann KG Dissen



Hörmann KG Eckelhausen



Hörmann KG Freisen



Hörmann KG Ichtershhausen



Hörmann KG Werne



Hörmann Genk NV, Belgium



Hörmann Beijing, China



Hörmann Inc. Vonore TN, USA

Hörmann is the only manufacturer worldwide that offers you a complete range of all major building products from one source.

We manufacture in highly-specialized factories using the latest production technologies.

The close-meshed network of sales and service companies throughout Europe, and activities in the USA and China, make Hörmann your strong partner for first-class building products, offering "Quality without Compromise".

**GARAGE DOORS**

**OPERATORS**

**INDUSTRIAL DOORS**

**LOADING EQUIPMENT**

**HINGED DOORS**

**DOOR FRAMES**

