

Decisive product advantages



Wicket door with trip-free threshold
DURATEC synthetic glazing



Hörmann Sectional Doors with Wicket Door with Trip-Free Threshold



- Helps to avoid accidents
- Flat stainless steel threshold rail
- Easy to roll over
- Optimal sealing thanks to an adjustable threshold profile with flexible seal
- Under certain circumstances approved as:

As an unobstructed passage
(up to 7000 mm door width)

As an escape door
(up to 5500 mm door width)

Only Hörmann's wicket doors with trip-free thresholds can be used in automatic operation, as opposed to the press and hold operation used by other manufacturers, this is thanks to Hörmann's leading edge photocell VL2.



Take a look at the video at:
www.hoermann.com



Only from Hörmann

EUROPEAN PATENT

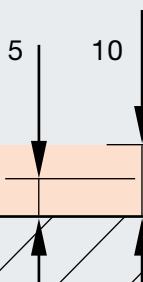

Hörmann

Standard: Wicket door **with extremely flat trip-free threshold**, only 5 mm on the outside and 10 mm (13 mm from 5500 mm door width) at the highest point – with no risk of tripping.



Competitor doors with wicket door and trip-free threshold

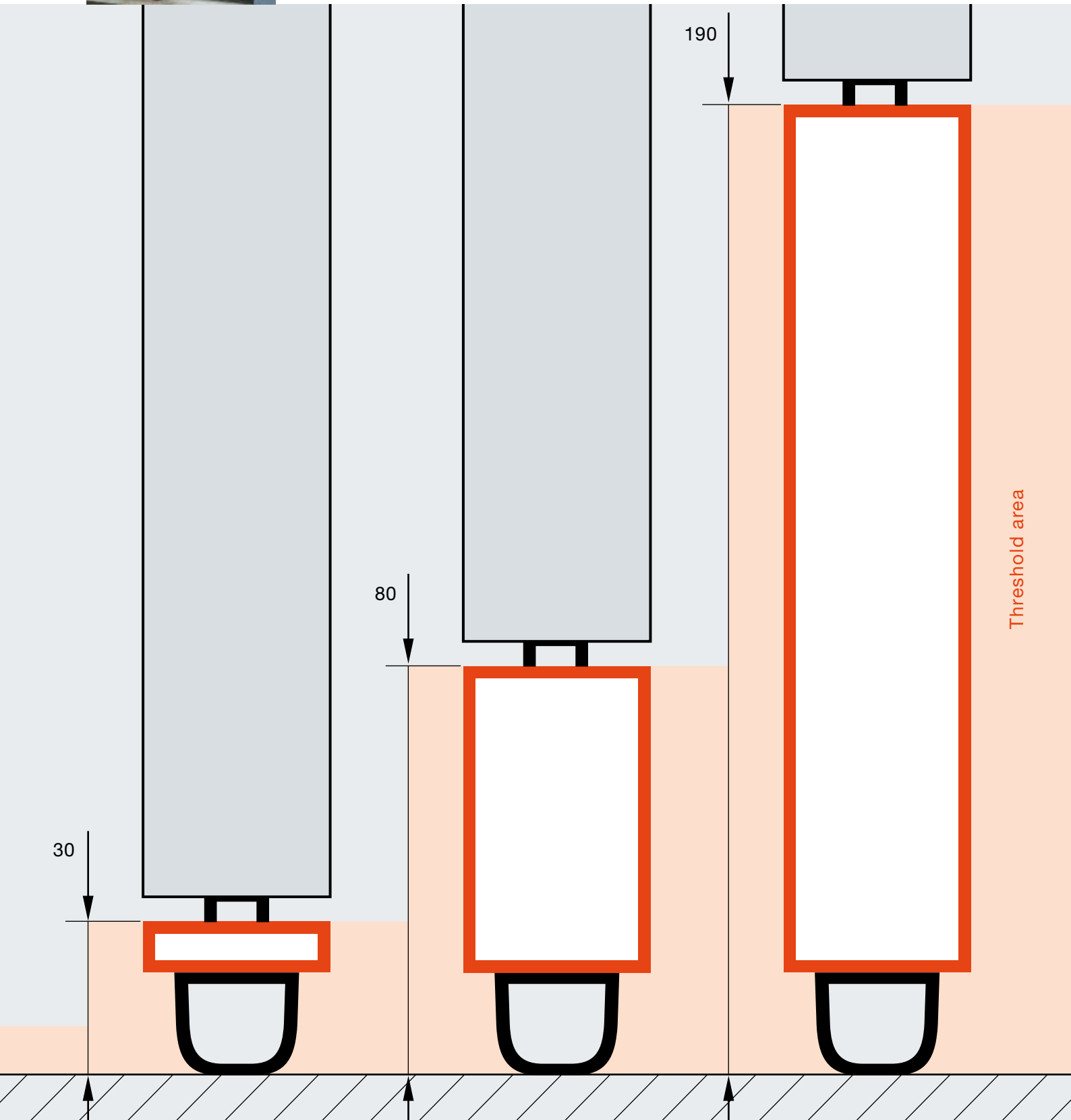

Competitor A

Wicket door with 30-mm-high threshold – substantial tripping risk, cannot be rolled over

Competitor B

Wicket door with 80-mm-high threshold – substantial tripping risk, cannot be rolled over

Competitor C

Wicket door with 190-mm-high threshold with tripping risk and large reduction of the passage

DURATEC synthetic glazing



Only from Hörmann

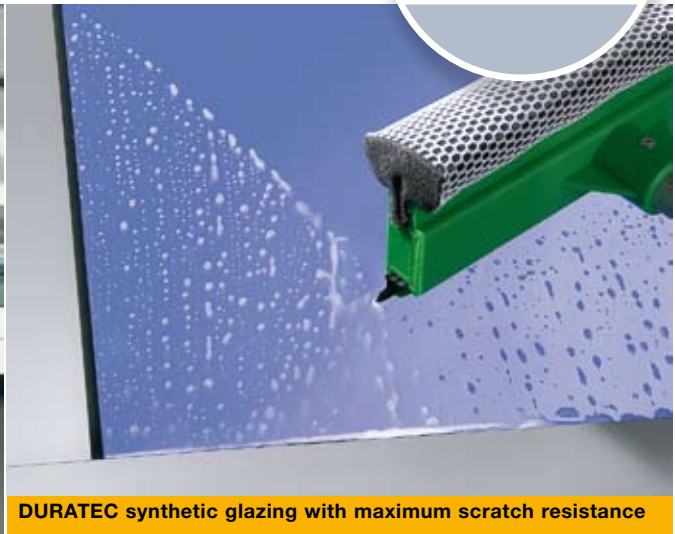

DURATEC synthetic glazing with maximum scratch resistance

- A permanently clear view
- Special surface coating in car headlight quality
- Maximum scratch resistance
- As standard without surcharge

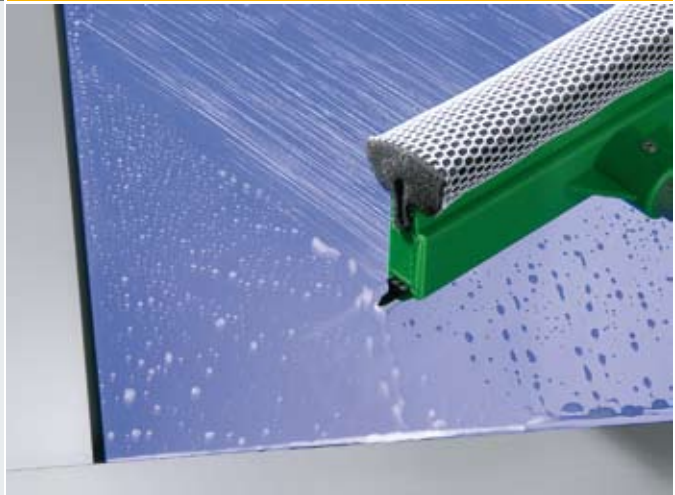

Sensitive, common synthetic glazing

Improved thermal insulation

An additional advantage of the **26-mm-thick DURATEC glazing** is the substantially improved thermal insulation. In comparison with 16 mm glazing, the thermal insulation value is up to 20% better. Triple glazing with even better thermal insulation is optionally available.

Only from Hörmann

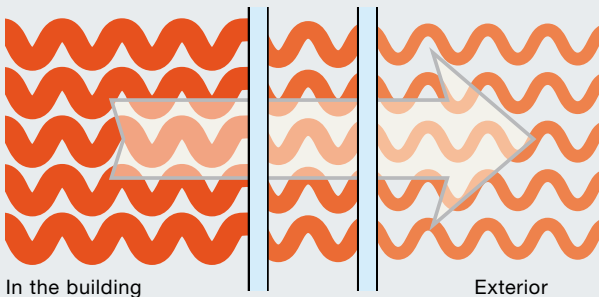

In the building

Exterior

DURATEC double glazing with up to 20% better thermal insulation with a 26-mm pane thickness

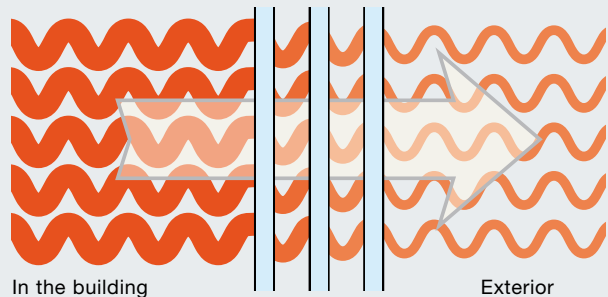

In the building

Exterior

DURATEC triple glazing with up to 30% better thermal insulation in comparison with 16-mm glazing