



Decking for Holiday & Park Homes

Supplying bespoke, innovative
and quality decking solutions
for over 30 years.





We are deeply integrated with our business. Between us, we make sure that no order goes out until it is perfect.

When you choose The Mayfield Group, you are choosing a brand that has over 30 years experience putting customers at the heart of everything we do to deliver stunning decking solutions that add value to your home.

Value, as you know, isn't measured solely by return on investment. It's measured by the smiling faces around your BBQ, the guests who repeatedly book your lodge every summer and the memories created between family and friends. That's what we think about everytime we design a made-to-measure deck. When we founded The Mayfield Group in 1989, we were determined to bring you more of what matters. Our decking range is designed to be forgotten. That means more time enjoying yourself and less time maintaining your deck. It's designed to give you that tingling feeling when you step onto

it for the first time. With six charming colours and a range of accessories, we can design a bespoke deck to enhance the aesthetic of any home.

We have worked hard to build a brand and a product that we're proud of. By overseeing every project and quality-checking every deck, we're confident that you will fall in love with your new decking. From our family to yours, thank you for choosing The Mayfield Group.

Debbie Jarmey
Founder

Mike Jarmey
Managing Director

About Mayfield Decking

- 4-5 About The Mayfield Group
- 10-11 The Mayfield Difference

- 6-9 Sustainability

Hampton Decking

- 12-13 Welcome to Hampton Decking
- 16-17 Hampton Decking Gallery
- 20-21 **NEW** Canopy Decks
- 24 UPVC Balustrades

- 14-15 Colour Options
- 18-19 Windsor LED Lighting
- 22-23 **NEW** Snugs
- 25 Glass Balustrades

Focus Decking

- 26-27 Welcome to Focus Decking

- 28-29 Focus Decking Features

How to Choose

- 30-31 What's Right For You?

More

- 32-33 Hot Tubs
- 36-37 Deck Me: Online Deck Designer
- 40 WashBomb by Mayfield
- 42-43 Standard Sundeck Range
- 46-47 Birds Eye Park Bliss View
- 50-51 Let us help you

- 34-35 Skirting, Gates & Accessories
- 38-39 Hampton Residential Decking
- 41 Our Partners
- 44-45 Bespoke Decking
- 48-49 Nationwide Supplier Network



A little bit about us

Your Mayfield deck is the ultimate accessory for your home, adding a luxury finish to your outdoor escape.

The Mayfield Group has been supplying Sundecks for holiday homes across the UK since 1989. Today, we've made sure that designing and ordering your new Sundeck from Mayfield could not be easier.

When it comes to the design, don't hold back. Choose a colour that compliments your home and dress your deck with a unique mix of contemporary accessories. Every enquiry we receive is followed up by a dedicated member of our team. You'll receive a transparent, no-obligation quote with no nasty hidden costs.

To make it easier, we'll manage the installation for you. Once you've decided on your Sundeck design, our team will liaise with your park to get your dream deck installed. Our no-fuss approach gives you the chance to relax. After your Sundeck has been installed, enjoy it worry-free.

Our decking range has a longer lifespan than standard timber decks and as it's made from low maintenance materials you won't need to think about regular cleaning or repairs. A Mayfield deck really is the best option for anyone looking to reinvent their outdoor space and make the most of their summer.



Quality Guaranteed

Fully Tested & Certified To BS Standards

Our products are not just built to an industry standard. They are built, fully tested and certified to British Standards including BS5395 stairs and walkways code of practice and are UL94-VO fire rated.

Low Maintenance

Our sun decks require the minimum of maintenance as they are made from high performance external grade materials.

Weather Resistant

British Standard BS EN607 10 year colourfast weather tested, our uPVC products will not warp, splinter or crack. Our C16 strength graded treated timber will not rot and will resist insect and fungal attack.

Slip and Stain Resistant

Our sun decks are British Standard BS7976-2 with textured and embossed surfaces to ensure slip resistance. The materials used to make our sun decks are non-porous, making them resistant to most food and beverage staining.

Low Noise

Our decking planks are individually installed onto timber or aluminium sub-frames using our unique decking clips. This prevents the planks rubbing together and squeaking, whilst also preventing the growth of algae between the planks.

Very Durable

Made using high-impact modifiers, the products used in the construction of our sun decks have been tested to British Standard physical load test BS6399-PT1.

30+

30+ Years Experience



British Standards



Multiple Warranties



Fast Quotations



Latest Technology



British Manufacturing

Sustainability

The Mayfield Group pride ourselves on our sustainable approach to decking. From manufacturing to installation and aftercare, our team works tirelessly to reduce the impact every Mayfield deck has on the environment.

We chose to use recycled materials in our products as a conscious measure to reduce the impact The Mayfield Group has on the environment. By doing so, we are helping to reduce the amount of new plastics being made, which in turn reduces the harmful disruption and damage being done to the natural world.

Our commitment to a better planet doesn't stop there. The Mayfield Group are continuously looking for new innovations that can push the industry towards a more sustainability-driven future. We work closely with suppliers to minimise our carbon footprint and are looking for ways to reduce our timber usage. Our most recent product, aluminium decking sub-frames, offers an alternative to timber without tarnishing the quality or look of your deck.

A Mayfield deck is a step towards a cleaner planet.



The Mayfield Group are proud supporters of the Bumblebee Conservation Trust since 2005



Plastics

Our materials are made from up to 80% recycled raw materials during the manufacturing process. Using recycled materials does not affect the quality in anyway and they carry the same structural benefits as virgin materials. We use recycled materials in our products as a conscious measure to improve our environment as we value the world we live in. Recycling also keeps waste out of the environment and out of our oceans which is definitely a good thing. We could argue that we are also helping to reduce climate change as using recycled materials uses less energy on sourcing virgin materials and thus lowering carbon emissions.

The recycled materials we use are widely available through our trusted supply chain so there is little chance of them running out. The materials used to make our products are also 100% recyclable and any offcuts from installations are reprocessed back into raw materials which are then reintroduced back in to the manufacturing stream to make further products.

Polypropylene Decking Slabs

We source recycled materials and manufacture all our products right here in the UK.

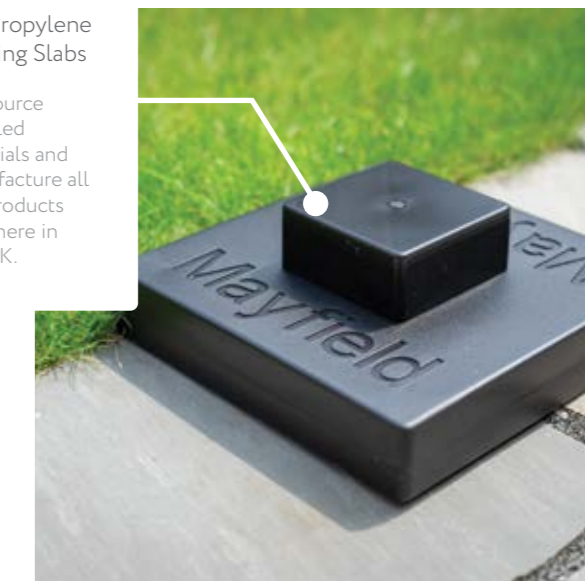

Timber

We use FSC timber to form the substructures on our decks as it is a sustainable material sourced from well-managed forests. Using timber in construction locks away carbon for long periods. (It has been calculated that a typical 3-bedroom semi-detached timber frame house, using about 6m³ of timber and wood-based products, stores about 1.2 tonnes of carbon, equivalent to over 4 tonnes of atmospheric CO₂). And even when wood is eventually recycled, it releases its carbon back into the atmosphere within a relatively short time. Therefore timber, being relatively newly grown and then returned directly to nature, is in effect carbon neutral.



Sustainability

NEW

Aluminium Sub-Frames

While the timber that we use is sustainably sourced, we are making an active effort to reduce the amount of timber used in Mayfield decks. Our latest development, Aluminium Deck Sub-Frames, have a longer lifespan than its timber alternative and doesn't affect the overall quality of the finish. The material is strong, dependable and is helping to reduce our impact on the environment.

When we started looking into environmentally-friendly alternatives to timber, we analysed various materials including aluminium, composite lumber and galvanised steel. Of course, it was aluminium that came out on top due to its sustainability, availability and cost.

We designed the new product with the final Sundeck in mind. It had to offer sublime quality, look fantastic and stand the test of time. We had the structurally tested through simulation software and are pleased to say it meets British Standards BS6399.

Sustainability was the driving force behind this innovation. Not only is aluminium widely available in the UK, but it's also 100% recyclable (just like our deck boards). Did you know that of the 100 billion tonnes of aluminium produced in the last 100 years, 75% of it is still in use? That's down to its recyclability.

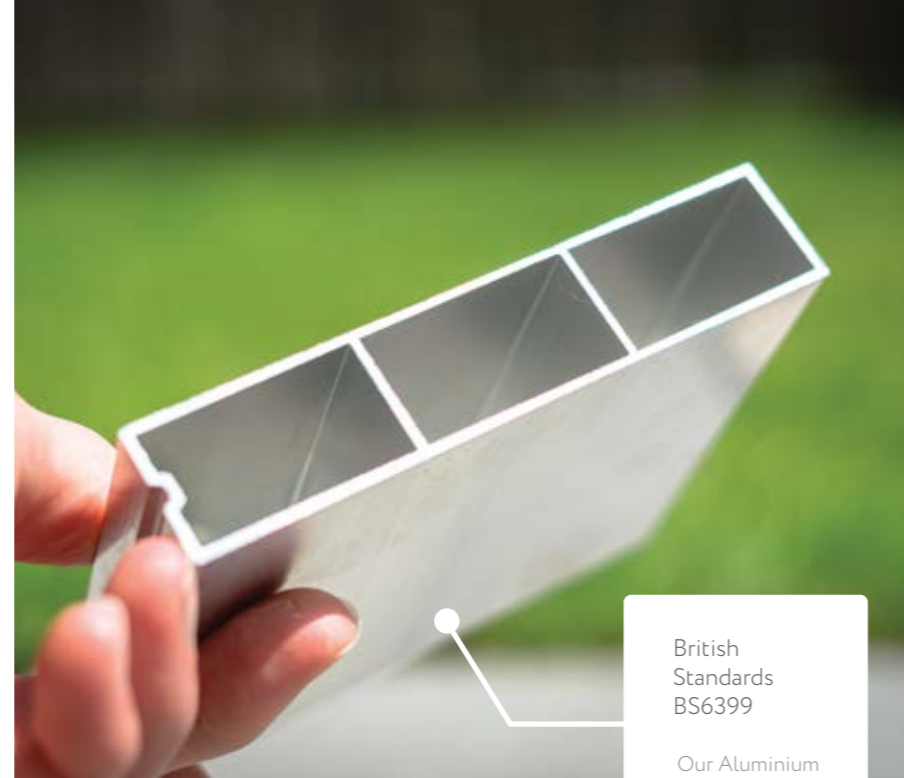

British Standards BS6399

Our Aluminium Deck Sub-Frame passed the test!



Strong and Lightweight

Perfect for bespoke decking projects and a luxury Hot Tub!

Considerations

Please consider our environmental statement when purchasing your Sundeck. Above and beyond price, we all have a responsibility for the health of our planet. When purchasing a Mayfield Sundeck you can be assured that you will be investing in a great product that has the very best in 'Green' credentials.

As well as offering a sustainable alternative to timber, aluminium is also fireproof and impervious to moisture. It won't rot or sag over time making it a cost-effective long-term solution.

We've made sure upgrading to an Aluminium Deck Sub-frame couldn't be easier. Give our team a call to find out how we can help you: 01202 233 959.

The Mayfield Group are leading the way in sustainable Sundecks by putting their environmentally-friendly foot forward and bringing innovative new designs to the market every single year. Alongside our Aluminium Deck Sub-frame, Mike Jarney has been

developing the Mark 2 Silverback Step - designed to make your Sundeck even stronger.

So is your garden in need of a makeover? Or are you looking at a fleet of gorgeous Sundecks for your holiday park? As the staycation trend continues and more travellers are looking for sustainable accommodation options, a Mayfield deck might be exactly what you need.

We're proud to be at the forefront of change. While we've always made a conscious effort to reduce the negative impact we have on the environment, this year we've created two new products that eliminate the need for timber altogether.



Rust-Free

Make sure your Sundeck can withstand the British weather!



The Mayfield Difference

When choosing a Mayfield Sundeck, there are no limitations. We have a huge selection of styles, colours, finishes and accessories to choose from to complement all modern homes, and our friendly, experienced Sundeck sales and design team are on hand to assist you every step of the way. When your Sundeck has been designed and ordered, we will keep you and your park updated with installation dates.

If you have any questions please call our team. Our 30+ years of experience means we can offer advice and ideas for your Sundeck and we will work closely with you to design and create the perfect outdoor living space that's right for you and your family's needs.

Hampton Decking is a cut above. It represents the pinnacle of our 30+ years of experience making custom decks.

Premium Sundecks and Decking

The Hampton Range is the next step towards modern, luxury decking. The range allows you to design a Sundeck with a unique personality by featuring a range of deck accessories, mixing colour options and creating new shapes. There's nothing that The Mayfield Group can't do when it comes to your Sundeck, so let your imagination run wild. Create the perfect space for you and your family to enjoy for years to come.

Available in a range of six colours.

The Hampton Range is further enhanced with the option to add Windsor LED lights to the top of each post. Windsor LED lights instantly create a warm, inviting evening environment to really get the most out of your sundeck, even after the sun goes down.



Deck Colours	14-15
Gallery	16-17
Windsor LED Lights	18-19
Canopy Decks	20-21
Snugs	22-23
Balustrades	24-25

Deck Colours

A Mayfield deck brings high-quality, luxury deck boards together with modern, stylistic design. We offer a range of six colours, making sure that your deck is designed to compliment the aesthetics of your home. From Seamist Green to Coconut Brown, our unique colour range brings personality and spirit to your outdoor space. Enhance your decking with our full range of accessories, each available in a variety of styles, finishes and colours.

Our team are on hand and ready to offer advice when it comes to designing your Sundeck. Get in touch with them today.

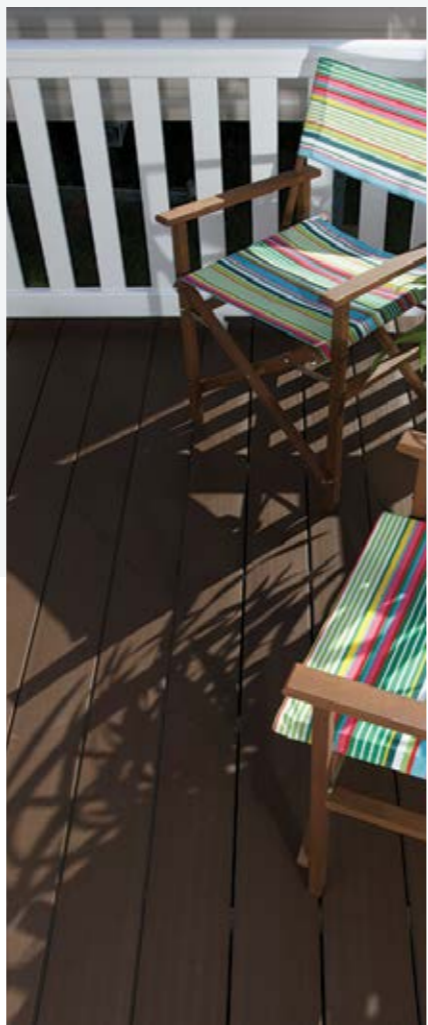

All 'as standard' Hampton Deck Features

With the hampton range, your bespoke deck will look and feel like the luxury Sundeck you deserve. With a great selection of colour and decking accessories, designing your dream deck has never been easier... But it doesn't just look great.

- ✓ 12 Year Colourfast Warranty
- ✓ Slip Resistant
- ✓ Stain Resistant
- ✓ Weather Resistant
- ✓ Low Maintenance
- ✓ Quality Guaranteed
- ✓ Fully Tested



Dolphin Grey



Brownsea Brown



Coconut Brown



Kimmeridge Grey



Seamist Green



Cornish Cream



WINDSOR LED

DESIGNED & DEVELOPED BY:
MAYFIELD

By adding one of our amazing lighting options, the enjoyment of your Sundeck doesn't need to stop when the sun goes down.

When considering lighting ask our sales team for the options available, and be inspired to add a glow to your deck. Lighting makes all the difference when entertaining or using your deck in the evenings, as well as looking amazing. Good lighting is about complementing your Sundeck and the correct lighting will enhance features such as balustrades, hot tubs and dining areas.

Our legendary Windsor Light was given a complete overhaul in 2020 and is packed with great features. Available on both our Hampton & Focus Sundecks, this modern lighting will illuminate your decking area long after the sun has gone down. Windsor LED lights are attractive and affordable.

Please note:

Mayfield decking installers are not qualified electricians and therefore do not connect the lights. This must be done by a park approved electrician and could incur additional costs. Please speak to your park operator for more information on this.

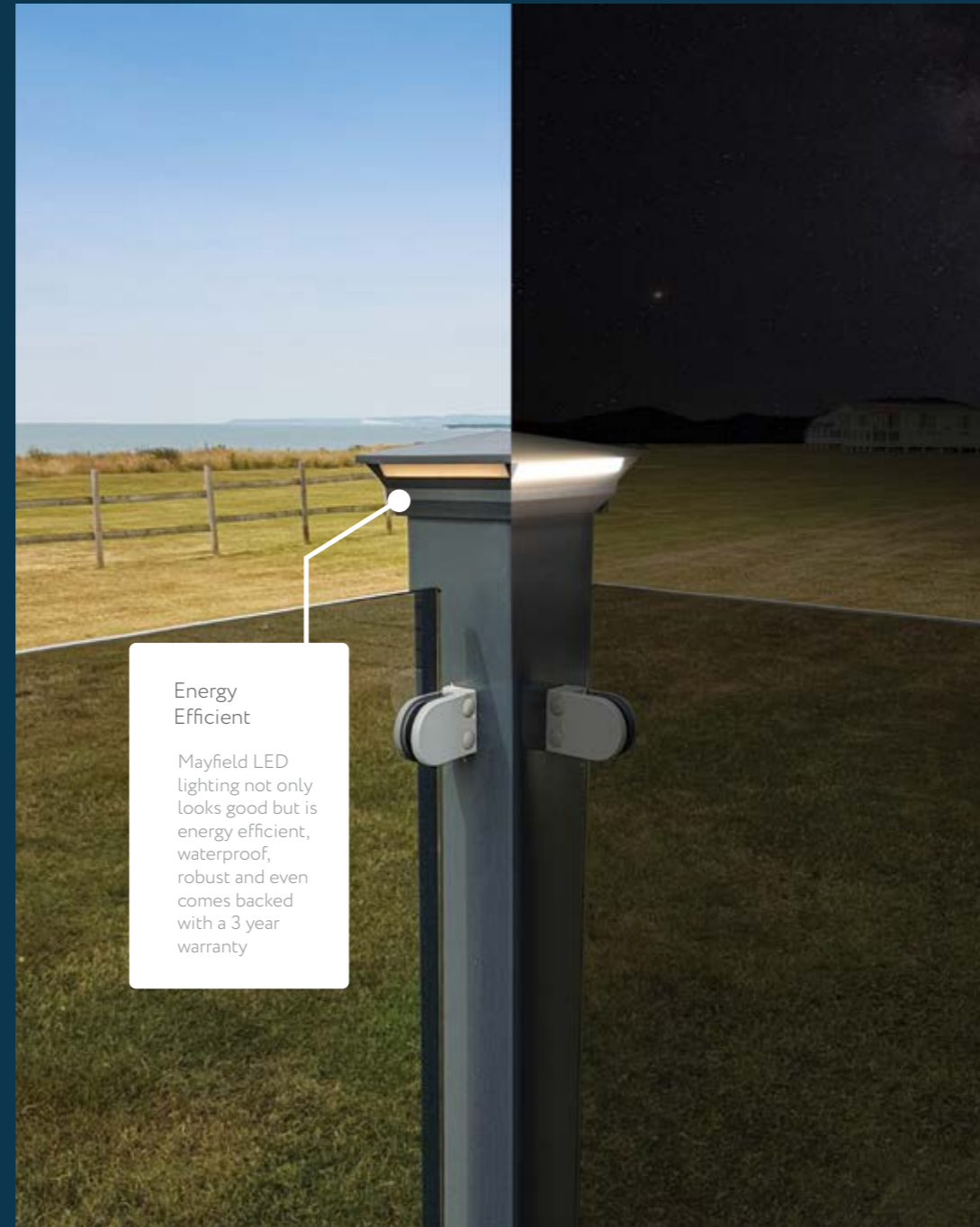

Energy Efficient
Mayfield LED lighting not only looks good but is energy efficient, waterproof, robust and even comes backed with a 3 year warranty



"The new LED Windsor Lights are modern, sleek and efficient, a wonderful enhancement to our decking. Installation was professional and the customer service second to none."

Andy Devlin

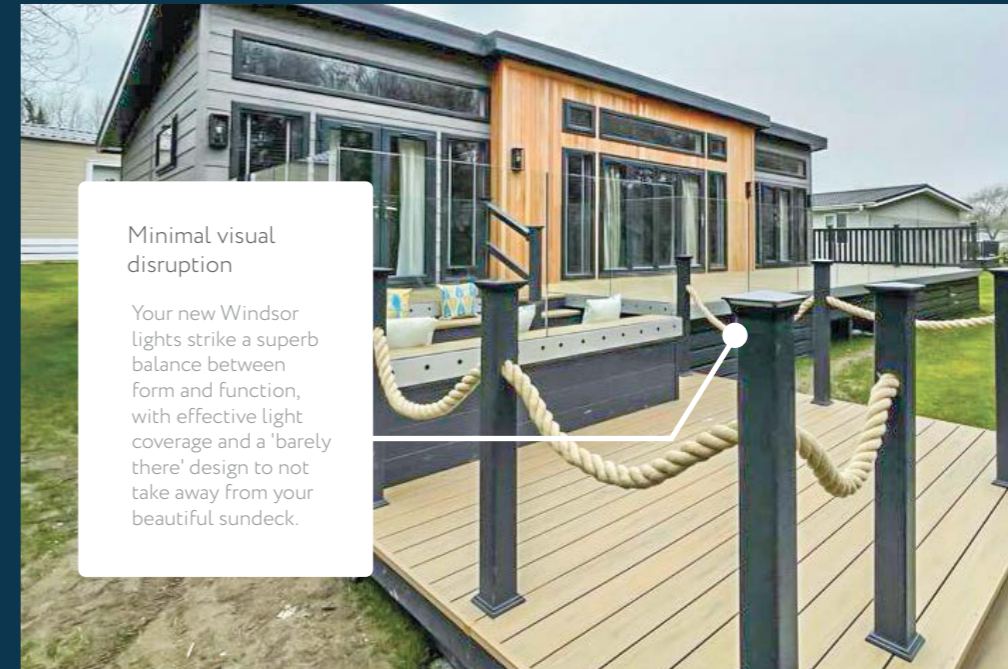

Minimal visual disruption
Your new Windsor lights strike a superb balance between form and function, with effective light coverage and a 'barely there' design to not take away from your beautiful sundeck.



Colours:

- White
- Cream
- Golden Oak
- Brown
- Green
- Slate

NEW

Canopy Decks

Picture this. You've arrived back at your holiday home and its raining cats and dogs. You have a car full of shopping and you need a shelter to protect you whilst you fiddle around with your keys to unlock your entrance door. We've all been there and we all know how nice it is to have a roof over your head to protect you from the elements on days just like this.

Fast forward to the afternoon and the sun is now beating down. You want to dine alfresco but there's a little too much wind to put your parasol up and stop it flying away. You could dine inside but its like an oven. Oh what to do. A quandary. Or is it?

At Mayfield, we have a fantastic rapport with our customers and we take time to listen to their wants and needs. Being master deck builders, we have the ability to turn great ideas into reality, from canopies to snugs to decks on stilts or even decks in lakes with pontoons for you to fish from and catch your supper!



Rise & Shine!
Canopies are a fantastic option for anyone looking to get more use out of their Sundeck

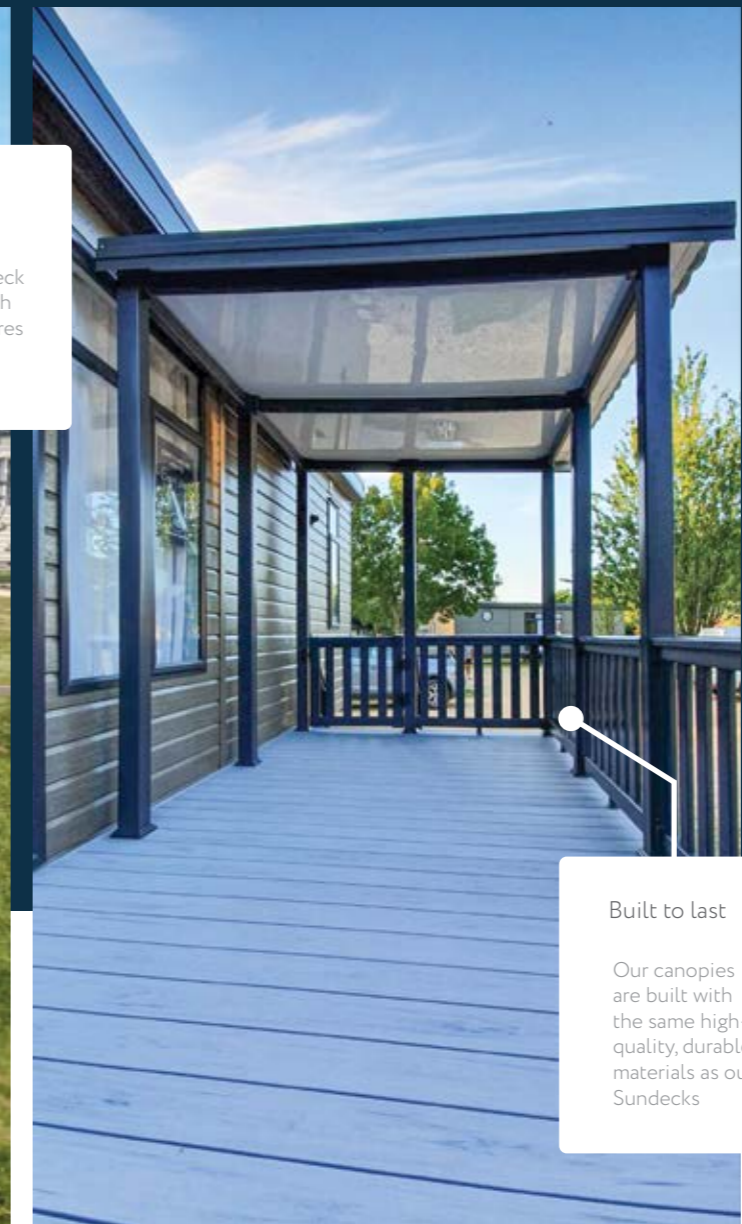

Bespoke Design
Make your deck stand out with unique features and decking accessories



Built to last
Our canopies are built with the same high-quality, durable materials as our Sundecks

We believe Canopy Decks allow you to truly unlock your deck's full potential for maximum relaxation and enjoyment. Let Mayfield help you create your canopy deck today.

Mike Jarmey
Mike Jarmey
Managing Director



NEW

Snugs

Do you want a Sundeck that makes people stop and say WOW? That's exactly what The Mayfield Group are all about. We're constantly striving to bring new ideas to the table and our latest innovation, Sundeck Snugs, will help you get more out of your decking all year round.

Snugs are created using the same deck boards as your Sundeck. The sunken space offers that comfy, cosy feeling whilst sheltering you from the elements and helping you get more out of your deck. Your snug is the perfect spot for any outdoor occasion.

Take advantage of bespoke seating, ClearView balustrades and LED lighting to design a snug that people love spending time in. Our team are on hand to help you build the deck of dreams so don't hold back.



Get that Comfy, Cosy Feeling
Sink into your deck with one of our custom-built snugs

Shelter From The Elements
Enjoy more of the British Summer and shelter from the wind with our ClearView balustrades.

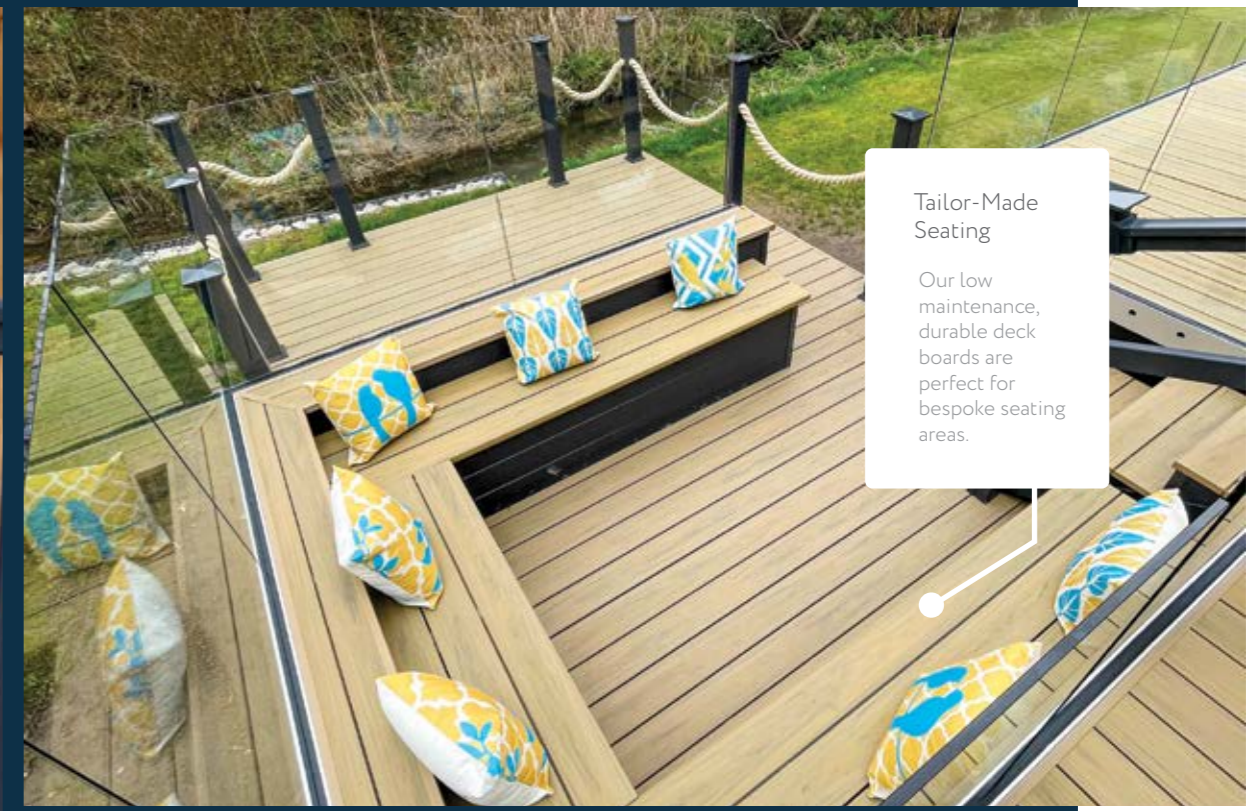

Tailor-Made Seating
Our low maintenance, durable deck boards are perfect for bespoke seating areas.



AS STANDARD

UPVC Balustrades Finishes

The Hampton Range comes in a choice of three balustrade styles: Victorian, Colonial and ClearView glass. The standard balustrade is available in six colours and comes with the option to include our Windsor LED lights on each post.

Hampton newel posts come with our colonial style Windsor caps and concealed fittings, both unique to Mayfield. You'll get a gorgeous, clean finish and concealed fittings with colonial style Windsor collars.

'As standard' with Hampton

Your Hampton balustrades come in two beautiful styles and six colours for you to choose from.

- ✓ Easy to clean and stain resistant
- ✓ Choice of colours
- ✓ No visible fixings
- ✓ External radius brackets
- ✓ British Standard BS6180

Colonial Balustrade



Colonial Balustrades

Colonial balustrades feature a thicker post, ideal for a bit more privacy and wind protection!

Victorian Balustrade



Victorian Balustrades

Victorian balustrades feature a thinner post creating a 'lighter' feel. Great for visibility!

Colours:

- White
- Cream
- Golden Oak
- Brown
- Green
- Slate

PREMIUM UPGRADE

Glass Balustrades

If your holiday or park home has a fabulous view, why not make the most of it with our ClearView Balustrades.

ClearView is available in framed and frameless designs with clear, tinted, obscured and sandblasted options, providing protection against the wind and adding a touch of opulence.

ClearView Balustrades

- ✓ Supplied with 10mm toughened glass as standard
- ✓ Powder coated stainless steel glass clamps
- ✓ Tints: Clear / Bronze / Smoke / Blue
- ✓ Sandblasted options including park logos/designs
- ✓ Bespoke sizes available
- ✓ Bespoke glass options available

Infinity Balustrades

- ✓ Double glazed glass panels
- ✓ Seamless design
- ✓ Superb wind protection
- ✓ Tints: Clear/Bronze/Smoke/Blue
- ✓ Privacy glass option available

Infinity Glass Option

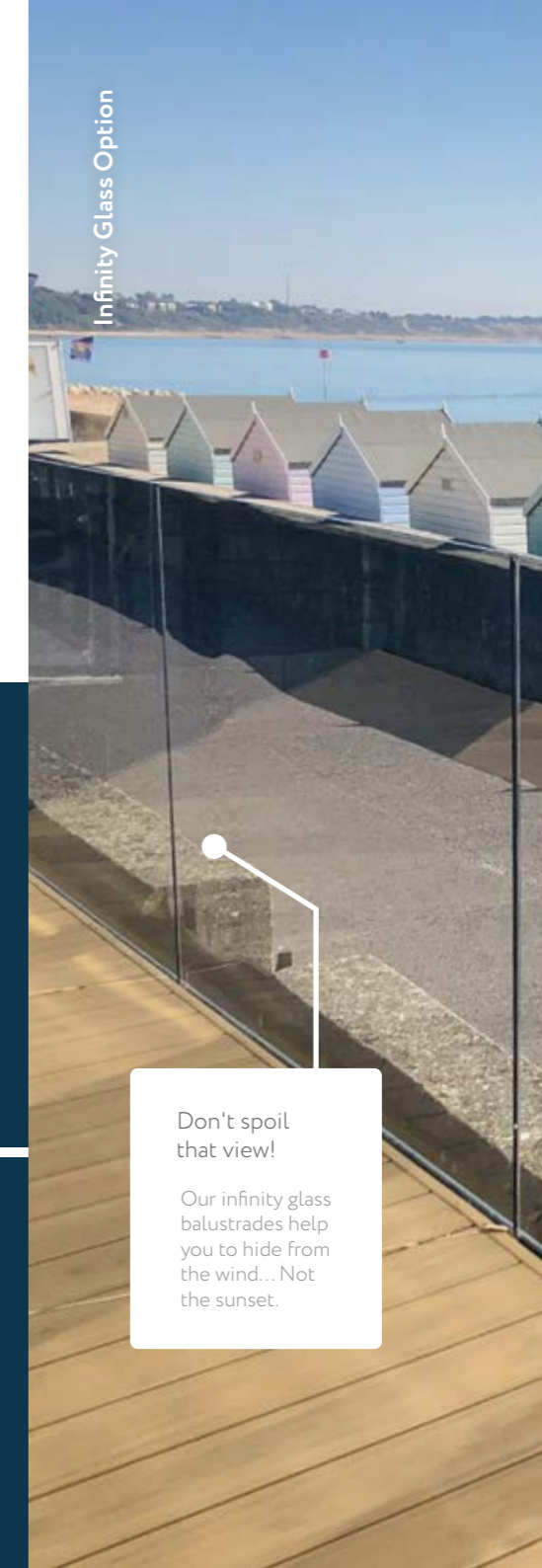

Don't spoil that view!

Our infinity glass balustrades help you to hide from the wind... Not the sunset.

ClearView Option



Make the most of your view!

ClearView Balustrades - designed for people who like their scenery uninterrupted!

Focus Decking represents our best value offering for individual customers or fleets.

Essential Sundecks and Decking

Our Focus Range of Sundecks has been designed specifically for the cost conscious customer, or park looking for fleet options. The Focus Range does not offer all the options that come as standard with the Hampton Range but still offers a high quality product with a key feature being the wider decking boards, which at 235mm look and feel robust and are manufactured in a very eye catching Driftwood colour.

The Focus Range has been weather tested to ensure long-term low-maintenance and has a three year manufacturer's warranty. Ask your nearest Mayfield approved installer for further information.



Essential on price, not quality.

As with our Hampton Range, our Focus Range promises a high-quality finish. It is tested to ensure your deck continues to be an outdoor area that you are proud of for years to come. Your Focus Range includes Colonial Balustrades, Windsor Collars and Flat Post Caps. Your Sundeck will look and feel robust, making it a fantastic addition to your holiday home.

While this product was developed for the budget-conscious, we have taken no shortcuts when it comes to the design or manufacturing process. The deck boards are manufactured using long-term, ultra low maintenance materials.



3 Year Manufacturers Warranty

Wider Deck Boards

Made using high-quality materials that make your decking look and feel more robust

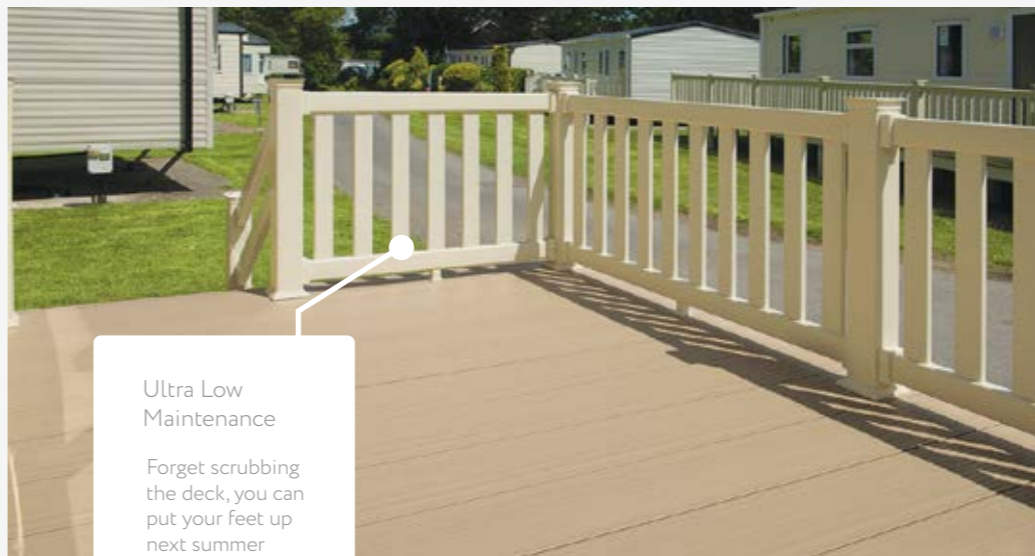

Ultra Low Maintenance

Forget scrubbing the deck, you can put your feet up next summer



Driftwood

Decking Colour Options

The Focus Range is available in our popular decking colour, Driftwood. It has been designed to compliment any home.



Ultra Low Maintenance



High Quality Materials



All 'as standard' Focus Deck Features

- ✓ 3 Year Manufacturers Warranty
- ✓ Wider Deck
- ✓ Slip Resistant
- ✓ Stain Resistant
- ✓ Weather Resistant
- ✓ Low Maintenance
- ✓ Fully Tested

What's Right For You?

Whether you choose our Focus Range or our Hampton Range, we guarantee that you will be happy with the overall finish and quality of your new deck. The table to the right gives you a side-by-side comparison of the two to help you choose the right product for you.



Make the right choice

Our Sundeck range has a longer lifespan than a traditional timber deck so make sure you choose what is best for you.



Hampton

- ✓
- ✓
- ✓
- ✓
- ✓
- ✓
- ✓
- ✓
- ✓
- ✓
- ✓
- ✓
- ✓
- ✓
- ✓
- ✓
- ✓
- ✓

Focus

- ✓
-
-
-
-
- ✓
- ✓
- ✓
- ✓
- ✓
- ✓
- ✓
- ✓
- ✓
- ✓
- ✓
- ✓
- ✓

Features

- 100 x 50 Treated Timber Subframes
- 125 x 50 Treated Timber Subframes
- Optional Aluminium Subframe
- Optional Aluminium Step
- Windsor Post Cap
- Windsor Collar
- Flat Post Cap
- Colonial Balustrade Option
- Victorian Balustrade Option
- ClearView Glass Options
- Optional Handrail Heights
- Mayfield Slabs
- Custom Sundeck Design
- 12 Year Colourfast Warranty
- 3 Year Colourfast Warranty



Choosing the right deck can be difficult. But not with Mayfield. Rest assured any Mayfield Deck is of superior quality and will last many years. The table left illustrates specific differences between our Focus and Hampton Range.



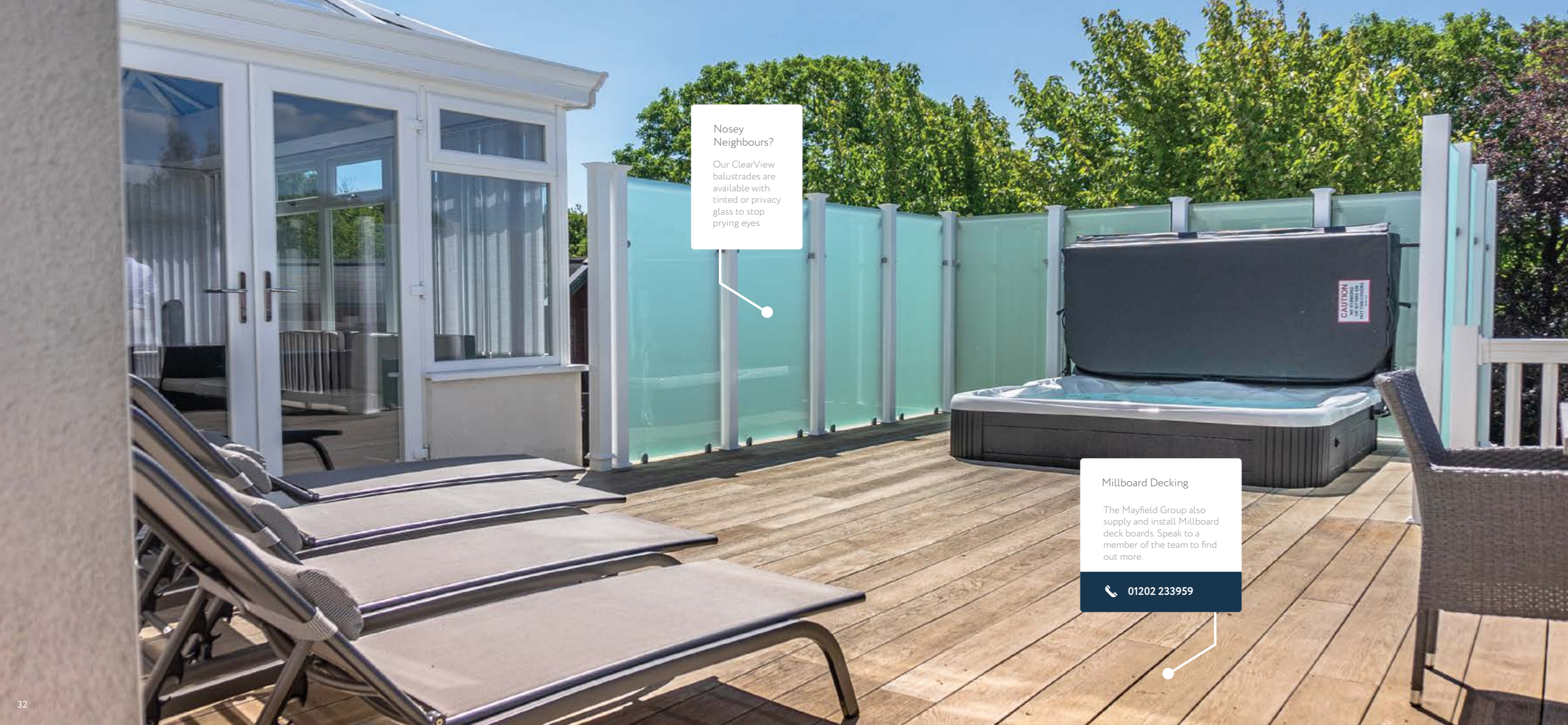

Nosey Neighbours?
Our ClearView balustrades are available with tinted or privacy glass to stop prying eyes

Millboard Decking
The Mayfield Group also supply and install Millboard deck boards. Speak to a member of the team to find out more.

☎ 01202 233959

Hot Tubs

We have a wide selection of holiday home Hot Tub models ranging from 3 to 8 persons. All Hot Tubs are manufactured with only premium quality materials and have an extensive range of high-end features as standard. All our Hot Tubs are supplied with comprehensive warranties as standard and our installation and service teams operate nationwide providing on-site training for your maintenance staff if required.

- ✓ Colour – Sterling Silver finish, white acrylic with luxurious silver and grey marbling highlights.
- ✓ Deluxe Roxul thermal retention system up to 4 times more effective than spray foam.
- ✓ Colour changing LED lighting to enhance the customer experience.
- ✓ Fully adjustable hydrotherapy jets for the ultimate massage.
- ✓ Park Controls Pump/Light On/Off Only and Coded Temperature Control.
- ✓ Easy maintenance in-line dosing unit for chlorine or bromine erosion.
- ✓ Spa Heat ready – when upgrading to the Climacube heat system.
- ✓ 2" pipe for quicker drainage.

Skirting Options

Having skirting installed to your home and Sundeck adds more than cosmetic finishing touches. Available in Fully Enclosed or Ranch Style, the benefits of having skirting include:

- ✓ Helps prevent heat loss
- ✓ Reduces draughts under home
- ✓ Virtually maintenance free
- ✓ Enhances visual appearance
- ✓ Reduces risk of water pipes freezing
- ✓ Prevents pests getting under home
- ✓ Large range of colours available
- ✓ Adds value and style



Ranch Skirting

Available in white and cream or in vinyl wrapped Dark Green, Dark Brown, Golden Oak or Slate Grey supplied with two access gates as standard (more are available on request). Fitted by our team of professional installers to ensure a perfect finish to any home.



Skirting Gate

A must with Ranch Style Skirting, these gates allow quick and easy maintenance access, fitted with our own top quality fixings to ensure no rust or corrosion. Two gates are fitted as standard with every skirting order and more are available on request.

Gates & Accessories

Gates

Mayfield Sundeck gates are made with Masterjoints, which are stronger and better by design than welded equivalents. All our gates are fitted using Masterjoint hinges and latches which will not rust, are extremely robust and carry a lifetime warranty.



Masterjoint Gate

Stairs & Access Ramps

Our Sundeck & Free Standing steps are made to building regulation specification. They are made from Tricoya, a superior, stable and durable material, that offers incredible outdoor weathering characteristics. Our steps are robust, corrosion free and modern in design.

Our access ramps are built to DDA regulations. They allow easy access to your Sundeck & home for those who need assistance. Our access ramps are quality built and available with the added options of LED lighting and skirting to enhance the overall look.



DDA compliant access ramp

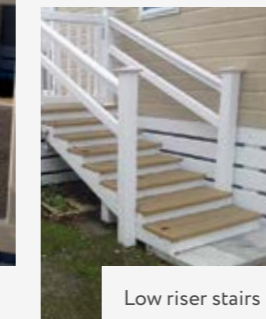

Low riser stairs



Free standing step

Rail Supports & Handrail Brackets

Our balustrade bracketry and supports have been designed to perfectly match the profiles they are joining so that they complement the overall finish of your Sundeck. Every bit of attention to details has been considered such as the feel of product, how it is mounted, and all whilst keeping the fixings hidden from sight. This may seem a small bit of detail but we pride ourselves on being in complete control of our own designs which are unique features on a Mayfield Sundeck.



Foot Block



Handrail Bracket

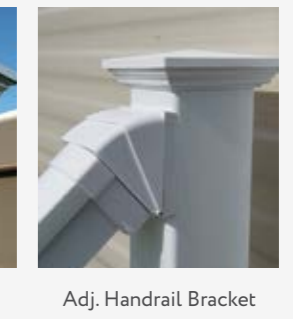

Adj. Handrail Bracket

deckme.co.uk

Design the Deck of Your Dreams With Deckme

Use deckme to create your perfect Sundeck. It's simple, easy to use and fun designing your own. When you are happy with your design, submit it and our team will review your choices and may help with recommendations before sending you a quotation shortly afterwards.

TheMayfieldGroup.co.uk/deck-me

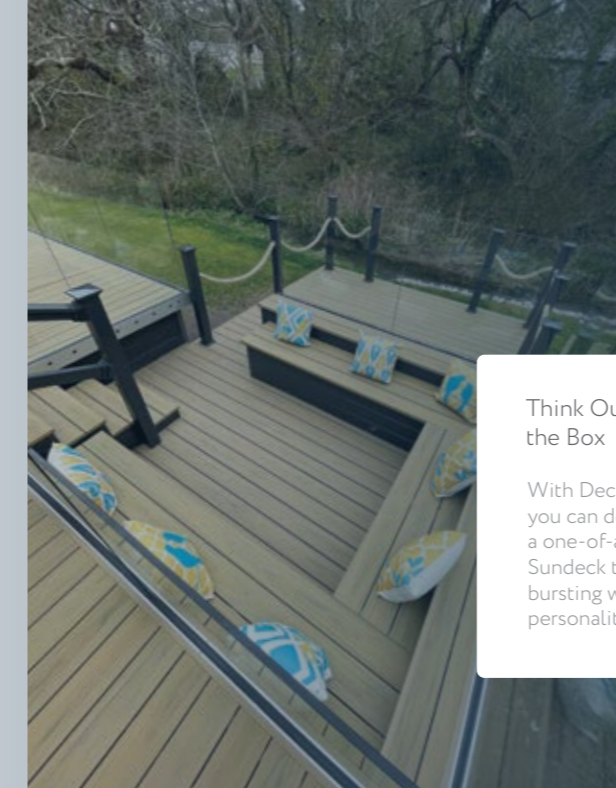

Think Outside the Box

With Deckme, you can design a one-of-a-kind Sundeck that's bursting with personality



How it works:

1. Simply visit deckme.co.uk
2. Fill in your details adding the size, make & model of your home.
3. Drag and drop the tiles around your home and create your perfect Sundeck.
4. Click 'Submit Design' and we will reply with a quotation.

TheMayfieldGroup.co.uk/deck-me



Sundeck Designer Programme

Why wait for someone to show you a design? Deckme allows you to create your own Sundeck in four easy steps



12 Year
Colourfast
Warranty



Hampton Residential Decking

Hampton decking is a unique product. It is not a composite and is highly weather and UV resistant making it easy to maintain. It is made from up to 80% recycled materials as a conscious measure to improve our environment as we value the world we live in. Using recycled materials does not affect the quality in any way and these materials can be 100% recycled. Hampton Decking is a cost effective, ultra-low maintenance alternative to timber and composite products.

- ✓ No Annual Treatments Required
- ✓ Wood Free (No Warping, Twisting or Splinters)
- ✓ UV Weather Resistant (BS EN607)
- ✓ Fire Rated (UL94-V0)
- ✓ Slip Resistant (BS7976-2)
- ✓ Load Tested (BS6399-1)
- ✓ 100% Recyclable
- ✓ 80% Recycled Materials Used
- ✓ Made in the UK
- ✓ 6 Colour Options
- ✓ Stain Resistant

"Having the deck put down has been like building an extension to the house at a tiny fraction of the cost. We love the extra space! Also with two little ones, letting them come in and out without having to go up or down a step is completely worry-free. They love it, should have done it years ago!"

Tiphaine McConnell



DESIGNED & DEVELOPED BY:
MAYFIELD

Keep your deck squeaky clean with Wash Bomb

Wash Bomb is a custom made cleaning product and the only cleaner Mayfield recommend to clean your Sundeck. It will remove light soiling and is safe and easy to use. For tougher stains, use a more concentrated solution and watch the Wash Bomb work its magic!

Simply pour the contents of the sachet into a bucket of warm water and wash away the grime with a sponge. It is non-foaming, anti-microbial (helps to prevent algae growth) and does not contain any harmful solvents that could harm the environment. Wash Bomb also has many more cleaning capabilities.

- ✓ Leaves no white residue
- ✓ Biodegradable & Solvent free
- ✓ Can be used neat for heavy grease deposits

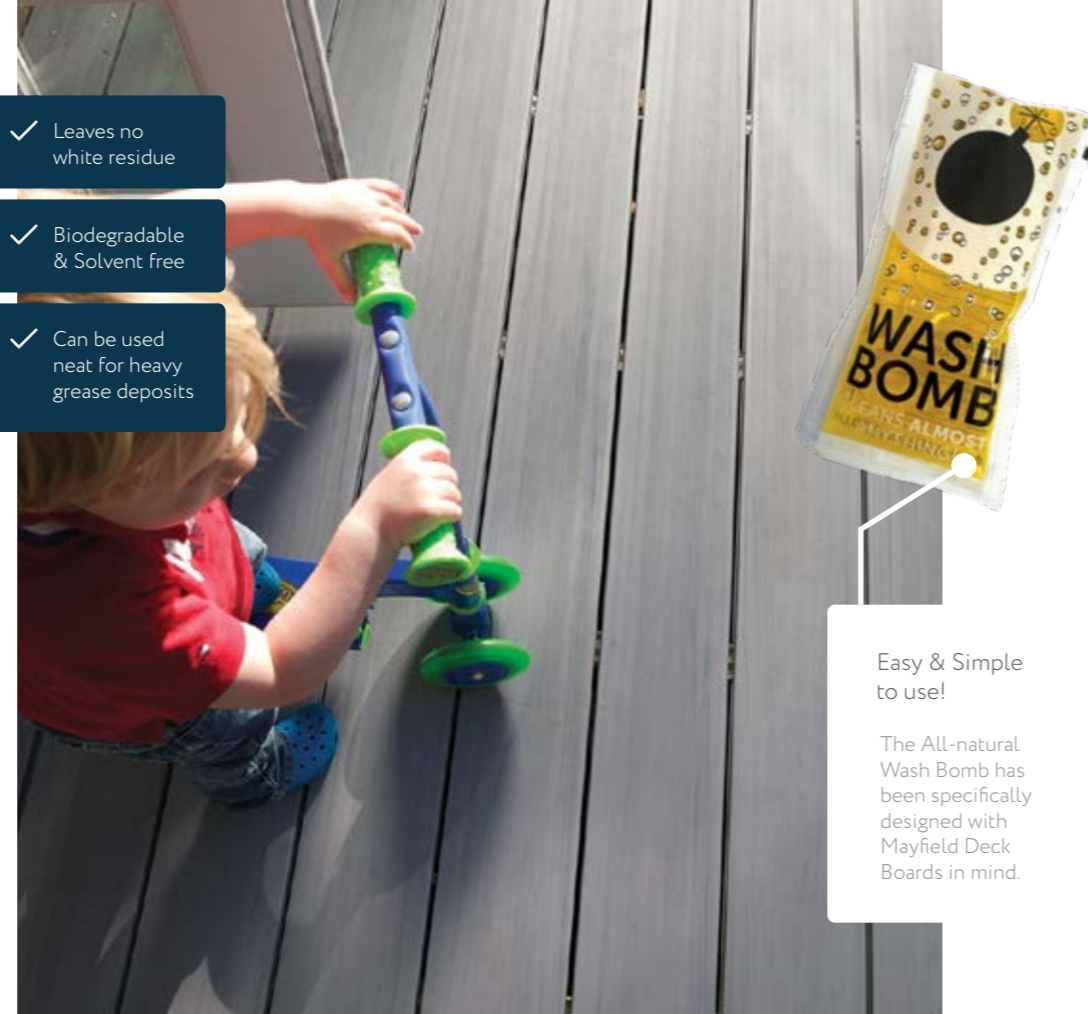

Easy & Simple to use!
The All-natural Wash Bomb has been specifically designed with Mayfield Deck Boards in mind.

Holiday & Park Home Partners

With over 30 years under our belts, we're proud of the relationships we have forged along the way. Here are a selection of our holiday home and park partners that we have been installing Sundecks at for many years.



Shop Now at:

TheMayfieldGroup.co.uk/Washbomb

Find out more:

TheMayfieldGroup.co.uk/our-partners

Standard Sundeck Range

Our standard Sundeck range are our most popular designs and as such are more cost effective than designing your own (custom) Sundeck. Our SD Sundecks range from PS1 – SD18 in the sizes shown and offered in uPVC balustrade only. Most are off the shelf designs offering a quicker installation turnaround.

PS1 4' x 4'

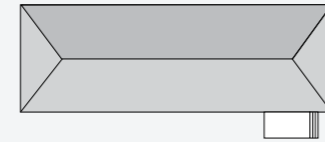

PS2 8' x 4'

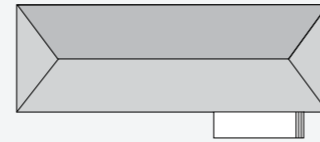

SD1 12' x 4'

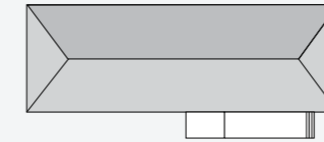

SD2 24' x 4'

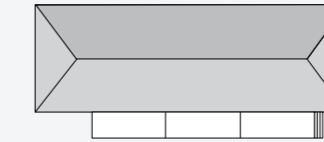

SD3 32' x 4'

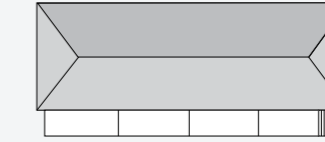

SD4 12' x 8'

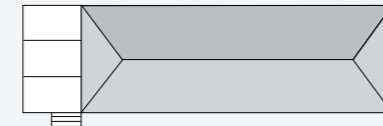

SD5 16' x 8'

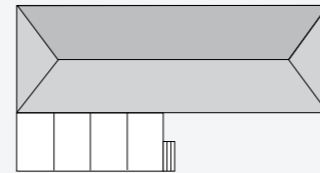

SD6 20' x 8'

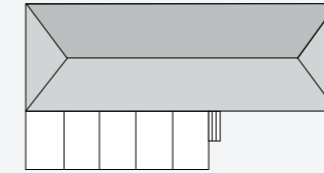

SD7 24' x 8'

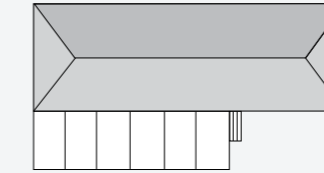

SD8 32' x 8'

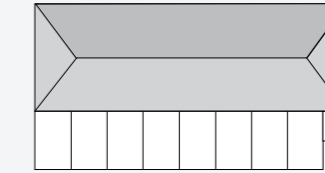

SD9 12' x 8' with 12' x 4' walkway

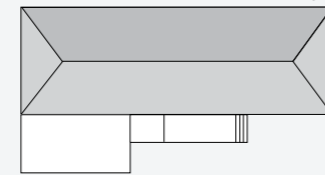

SD10 12' x 8' with 16' x 4' walkway

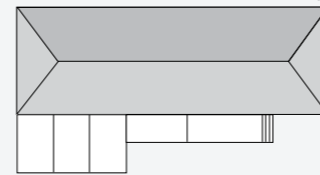

SD11 16' x 8' with 12' x 4' walkway

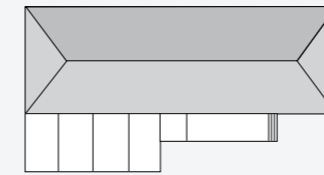

SD12 16' x 8' with 12' x 4' return

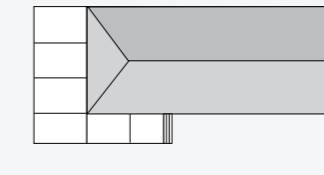

SD13 16' x 8' with 16' x 4' walkway

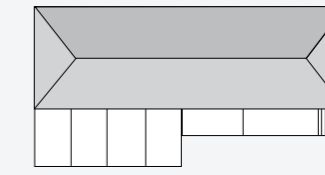

SD14 16' x 8' with 16' x 4' return

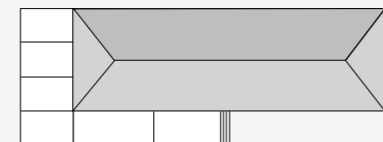

SD15 16' x 8' with 20' x 4' return

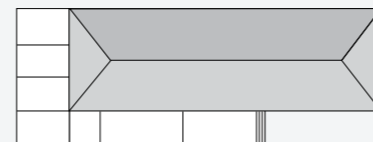

SD16 16' x 8' with 24' x 4' return

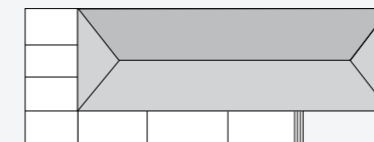

SD17 16' x 8' with 32' x 4' return

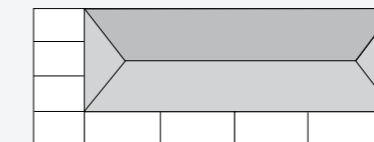

SD18 20' x 8' with 20' x 8' return

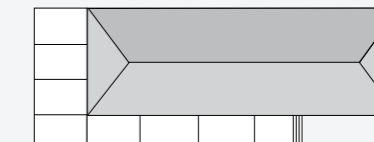

Variable balustrade heights available on all our Hampton Sundecks

Looking for something more **bespoke?**



Turn to the next page to be wowed by some of our bespoke decking solutions.



Bespoke Decking is our chance to throw the rule book out the window. With 30+ years of experience, no challenge is too great for us.

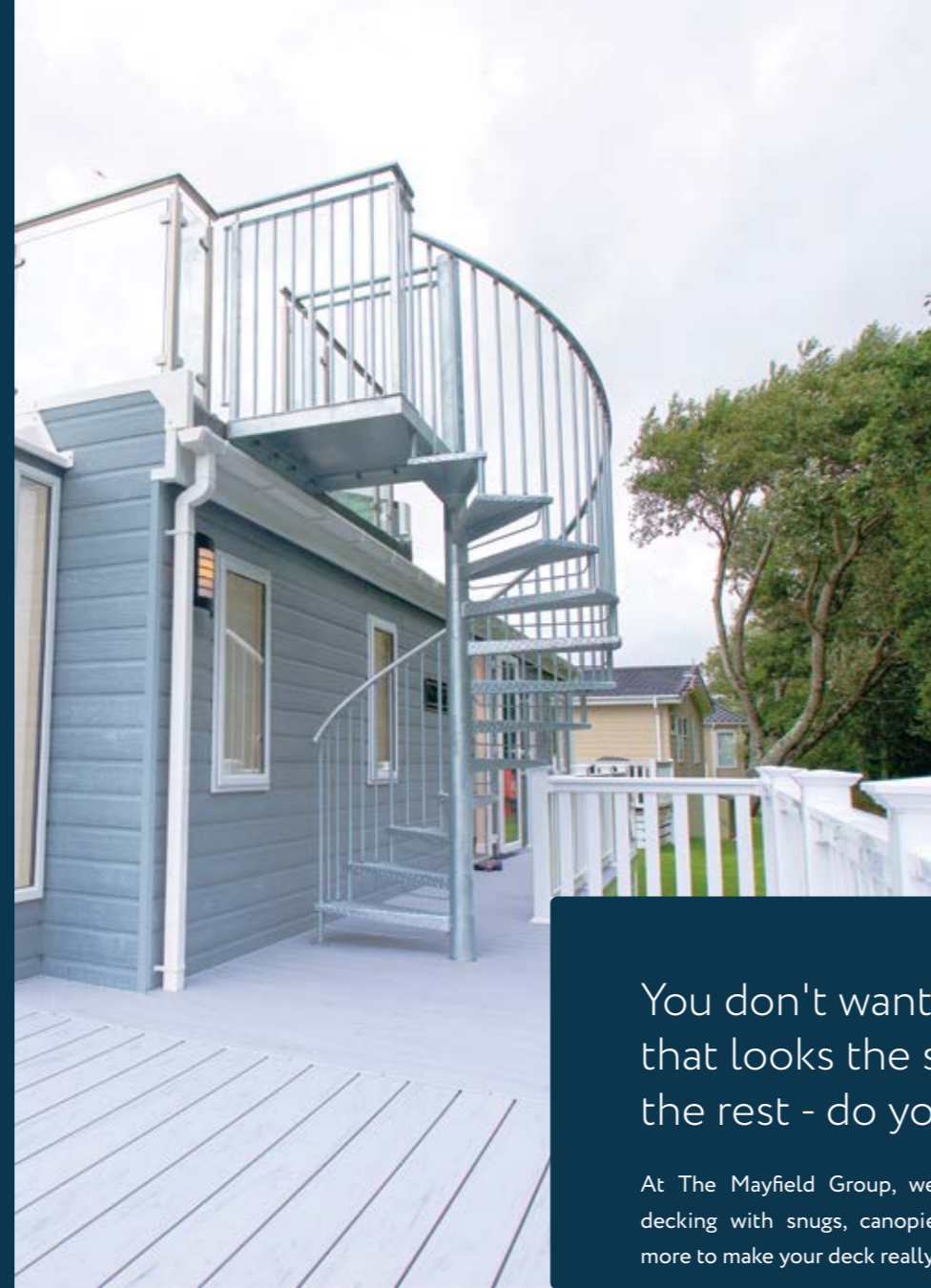

Sundeck on the roof?
No problem.



Something a bit different?
Let's see what we can do.

You don't want a sundeck that looks the same as all the rest - do you?

At The Mayfield Group, we specialise in bespoke decking with snugs, canopies, spiral staircases and more to make your deck really stand out.



Can you put a hot tub up there?
Yes, yes we can.



Make your vision come to life?
We've got this.



What about this?
Alright, off we go.

Peaked your interest?

The beauty of a made-to-measure Sundeck is it screams personality, looks fantastic and really compliments your home. Nothing is holding you back when it comes to the design. Just speak to the Mayfield deck designers and bring your vision to life.

[TheMayfieldGroup.co.uk/bespoke](https://www.themayfieldgroup.co.uk/bespoke)



We've Got Dealers Nationwide

In our 30 years, The Mayfield Group has grown to become the leading supplier of uPVC decking in the UK. None of this would be possible without our trustworthy network of approved suppliers that install both the Hampton and Focus Range up and down the country. We are more than thrilled to introduce you to the entire Mayfield family and your next Sundeck installer.



Mayfield Modway:
Unit 4, 6 Simonsburn Road, Loreny Industrial Estate, East Ayrshire, Scotland, KA1 5LA



Mayfield Eurofit:
Unit 24, Spencer Court, Blyth Riverside Business Park, Blyth, Northumberland, NE24 5TW



Mayfield PGM:
Unit 6, Waxholme Trading Park, Waxholme Lane, Waxholme, Withernsea, North Humberside, HU19 2BJ



Mayfield Evabel:
Unit 2, Fairfield Business Park, Longsight Road, Clayton Le Dale, Blackburn, BB2 7JA



Mayfield GPS:
Unit 2 Riseborough Court, Vanguard Road, Garton Hall Industrial Estate, Great Yarmouth, NR31 0NT



Mayfield Wales:
Unit 14, Eastern Avenue, Waterloo Industrial Estate, Pembroke Dock, SA72 4RT



Mayfield Precision Decking:
Edithmead Leisure, Highbridge, Somerset, TA9 4HE



Mayfield HQ & IOW Hub:
Head Office, 68 Old Wareham Road, Poole, Dorset, BH12 4QR





Mayfield Wildwood:
Newhouse Farm, Northiam, Rye, East Sussex, TN31 6JL



Let us help you today

Call us today to book an appointment at your holiday home at a time that suits you.

-  01202 233959
-  [TheMayfieldGroup.co.uk](https://www.themayfieldgroup.co.uk)
-  sales@TheMayfieldGroup.co.uk



Here's a place
for your notes...

Your approved
installer is:

 01202 233959

 The Mayfield Group Ltd
68 Old Wareham Road,
Poole, Dorset, BH12 4QR

 TheMayfieldGroup.co.uk

 sales@TheMayfieldGroup.co.uk

