

Section 3

Skirtings, Capping Strips & Accessories

Information to ensure the correct selection of skirtings, capping strips and other accessories along with details of colour availability. Details of Gradus pvc skirtings, metal skirtings, cove formers and capping strips can be found in this section.

Choosing the right skirting

Area of Application

Skirtings, cove formers and capping strips are used to provide clean, neat solutions for junctions where the floor meets the wall.

Gradus offers solutions to suit most contract applications, from 'critical' clean areas where a homogeneous finish is essential such as hospital wards, treatment rooms, and food & pharmaceutical environments, through to commercial office, education or retail environments where functionality needs to be combined with aesthetics.

Healthcare, food & pharmaceutical and education environments in particular benefit from the use of pvc skirtings that can be welded to resilient floorcoverings in order to create completely impervious seals to meet cleaning and hygiene requirements.

For further guidance on the use of pvc skirtings in healthcare environments refer to: Health Technical Memorandum (HTM): Flooring 61 – 3 Design Guidance, Skirtings 3.13 - 3.19.

Materials & Profiles

Options

Selecting the correct type of skirting profile will ensure that product performance matches the environment requirements and will result in a functional, low maintenance alternative to traditional skirtings.

Pvc Skirtings

Set-in – typically used with resilient floorcoverings, this type of skirting is welded to the floorcovering in order to create an impervious seal. Ideal for critical clean areas (e.g. treatment rooms, pharmaceutical production) or areas subject to wet cleaning (e.g. school and hospital corridors). Selected set-in skirtings are available in 15m coils in order to reduce the number of vertical joints required.

Sit-on – typically used with hard floorcoverings. Ideal for use in areas where a neat, clean finish is required but an impervious seal is not required e.g. general circulation areas in schools and hospitals.

Flat – used primarily with textile floorcoverings to form a neat, low-maintenance alternative to timber skirting.

Capping Strips & Cove Formers – used when floorcoverings are continued up the wall. Cove former ensures a consistent cove is achieved and supports the floorcovering at a weak point. Capping strips provide a neat finish where the floorcovering stops.

Stratum Pvc Skirting

An alternative to traditional timber skirting, this 10mm thick skirting provides the look of painted wood whilst offering a low maintenance solution. Ideal for creating a neat finish in non-critical clean areas, and in all contract environments where ongoing maintenance and aesthetics are important factors.

Metal Skirtings

Modern alternative to pvc or timber skirtings. Creates a modern, hi-tech finish for environments such as commercial office, retail and leisure. Low voltage cable management system also incorporated in selected profiles.

Aesthetics

Gradus skirtings & cappings are available in a range of colours and finishes to complement most interior environments.

In addition, the use of a skirting that contrasts in colour and luminance with the floorcovering can assist visually impaired people to determine the borders of the room. As a guide, skirtings should either match the wall colour, or provide a complete contrast with both the wall and floor.

For further details on visual contrast see pages 134-135.



Visit: www.gradusworld.com to download: AutoCAD drawings, Gradus & NBS Specifications, Cleaning & Maintenance, Installation Guidelines and Health & Safety Data Sheets.

Colour Availability

Standard

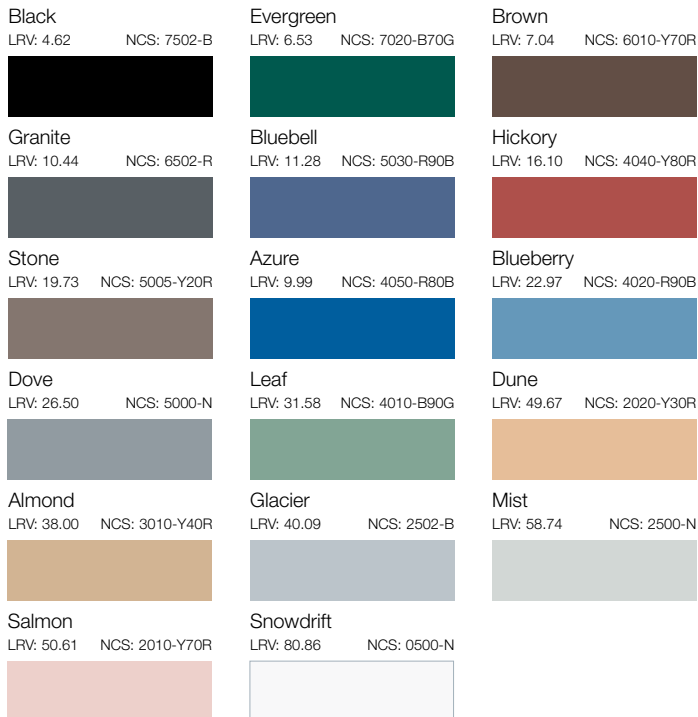

Metallics



Metals



Please note: Due to the limitations of the printing process, colours within this catalogue should not be relied upon for colour matching. An accurate colour match can only be achieved by requesting the relevant product sample(s) from Gradus Technical Support on 01625 428922.

- Available from stock
- ▲ Available subject to minimum quantities & lead times

	Stratum STM7510, STM10010	SI100, SI10055, SI10032, SI100502.5, SI100503.2, SI150, SO25, FS150B	SI100502, SO100, FS303, FS100B, PCS40	SO75, SO150	CS1100502, HCS48	CS1100502.25	DFS100	P Range Skirtings & PCS40P	CC40, CC75	CCF1001	TC47	TC48	MCS48	MCC40, MCC75	MAS90 Range	MAS95 Range, MAS97 Range	MSS790 Range	ACC40
Standard																		
● Black		●	●	●	●	●	●	●	●									
● Evergreen		▲	●	●	●	▲	▲	▲				●						
● Brown		●	●	●	●	●	●	●										
● Granite	●	●	●	●	●	●	●	▲	●									
● Bluebell		▲	●	●	●	▲	●	▲	●									
● Hickory		▲	●	▲	●	▲	●	▲										
● Stone		▲	●	●	●	▲	●	▲										
● Azure		▲	●	▲	●	▲	●	▲										
● Blueberry		▲	●	▲	●	▲	●	▲										
● Dove	●	●	●	●	●	●	●	▲	●	●								
● Leaf		▲	●	▲	●	▲	●	▲										
● Dune		▲	●	▲	●	▲	●	▲										
● Almond		▲	●	●	●	▲	●	▲										
● Glacier		▲	●	●	●	▲	●	▲										
● Mist		▲	●	▲	●	▲	●	▲										
● Salmon		▲	●	▲	●	▲	●	▲										
● Snowdrift	●	▲	●	●	●	▲	●	▲	●	●	●	●						
Metallics																		
● Burnt Almond												●						
● Zinc												●	●					
● Doubloon												●	●	●				
● Platinum												●	●	●				
● Silver												●	●	●				
Metals																		
● Aluminium																		●
● Silver Anodised Aluminium															●	●		
● Satin Silver Anodised Aluminium															●	●		
● Satin Titanium Anodised Aluminium															●	●		
● Polished Titanium Anodised Aluminium															●	●		
● Satin Stainless Steel																	●	

Stratum™ Skirtings - Pvc

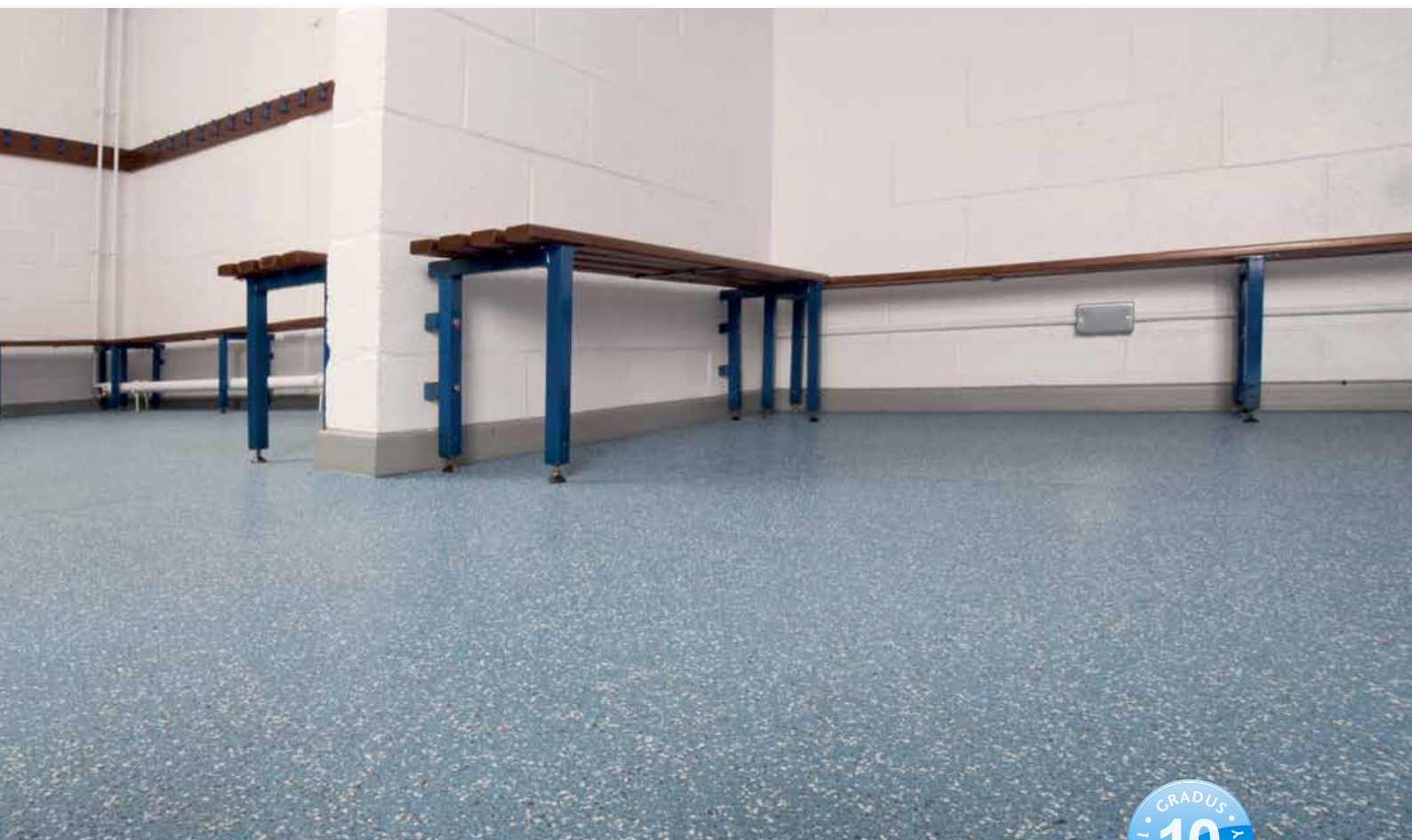

Description

The Gradus Stratum range comprises heavy-duty pvc skirting profiles suitable for a wide range of contract applications including education, healthcare and commercial office.

Life cycle analysis shows Stratum is a cost effective alternative to wood skirtings. The smooth matt finish is resistant to stains, dents and scratches, and will not splinter, chip and crack like traditional wood skirtings, offering a low maintenance hygienic solution to wall base finishing.

Stratum can be installed around gentle curves and can also accommodate and disguise minor irregularities in wall surfaces.

Profile Information

- Suitable for interior use in most areas
- Stratum is a cost effective alternative to finished timber skirting it utilises up to 80% recycled pvc in its construction and is suitable for all areas that require a high quality finish to be maintained through the life of the building
- Eliminates the need for processes normally associated with wood skirting such as sanding, priming, filling and painting

Installation Advice

- Stratum skirtings are installed to the wall using a proprietary cartridge adhesive
- Internal/external corners can be mitred on site

Colour

- For larger colour swatches see page 105



Visit: www.gradusworld.com to download: AutoCAD drawings, Gradus & NBS Specifications, Cleaning & Maintenance, Installation Guidelines and Health & Safety Data Sheets.



For guidance on the correct selection of skirtings see page 104.

Description	Semi-flexible pvc skirting
Application	Ideal for use in most areas
Profiles	10mm thick, 2 heights - 75mm and 100mm Supplied in 2m lengths
Dimensions shown are nominal. Illustrations are 70% size in mm. Products subject to minor design alterations without notice.	

Colour options:

- Granite ●
- Dove ●
- Snowdrift ○



Stratum contains up to 80% recycled content

Low maintenance alternative to timber

STM 75 10
Sit-On

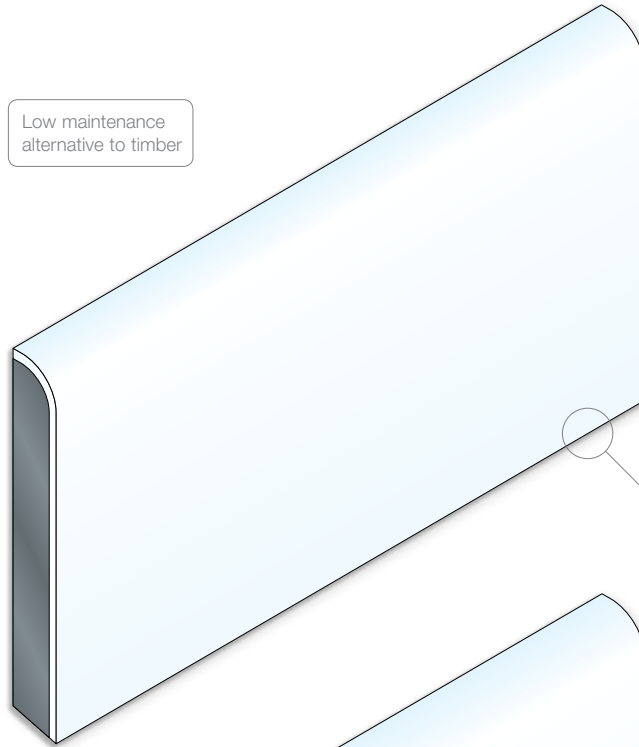
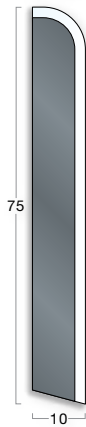

Chamfered base to allow tight fit to floorcovering

STM 100 10
Sit-On

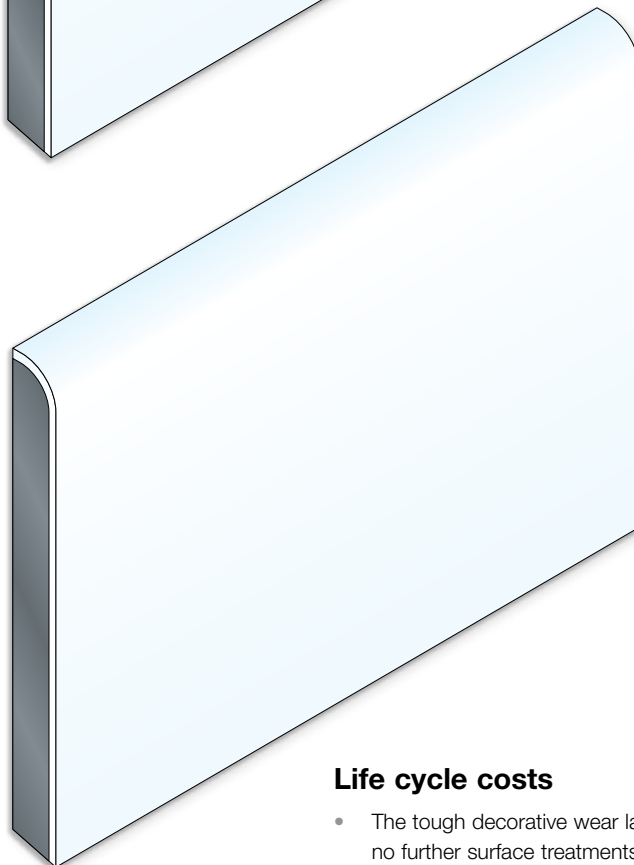
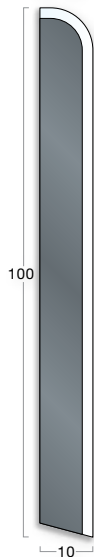

Life cycle costs

- The tough decorative wear layer on Stratum requires no further surface treatments to protect the finish and offers a low maintenance alternative to traditional timber skirting where the life cycle costs of redecoration can be expensive.
- Typical example: timber skirting is typically redecorated once in a 10 year period – total expenditure is approximately 50% more than material and labour costs spent on installing Stratum. The saving will be greater if redecoration is required more often.

Pvc Skirtings



Description

An extensive range of pvc skirtings, through-coloured for maximum performance and maintenance. Profile designs are available for use in conjunction with floorcoverings from all major manufacturers. Suitable for a wide range of commercial applications.

Installation Advice

- Pvc skirtings are secured to all wall surfaces using contact adhesive

Profile Information

- Suitable for interior use
- Set-in skirtings are ideal for use in areas subject to regular wet cleaning e.g. hospital treatment areas as they can be welded to the floorcovering to provide an impervious seal.
- Coillable set-in skirtings minimise vertical joints. Ideal in areas where both the horizontal and vertical joints require welding e.g. food preparation areas & clinical treatment areas.

Colour

- For larger colour swatches see page 105

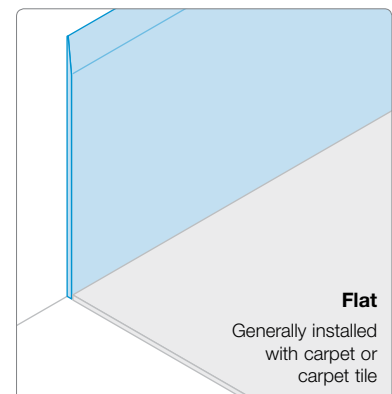
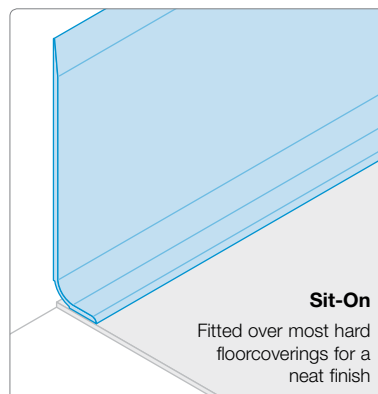
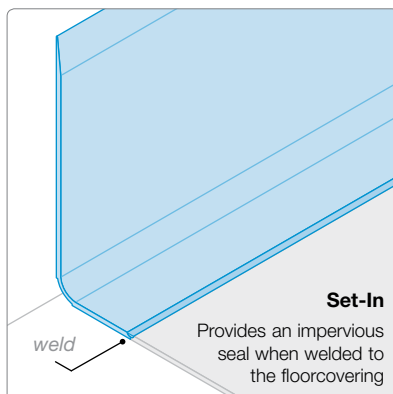

Skirtings - Set-In

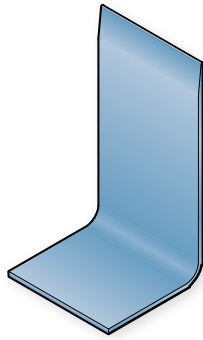

Set-In
Provides an impervious seal when welded to the floorcovering

To reduce the quantity of vertical joints on an installation use CSI 100 50 2 or CSI 100 50 2.25 – supplied in 15m coils.

SI 100 and SI 150 suitable for cold welding only.

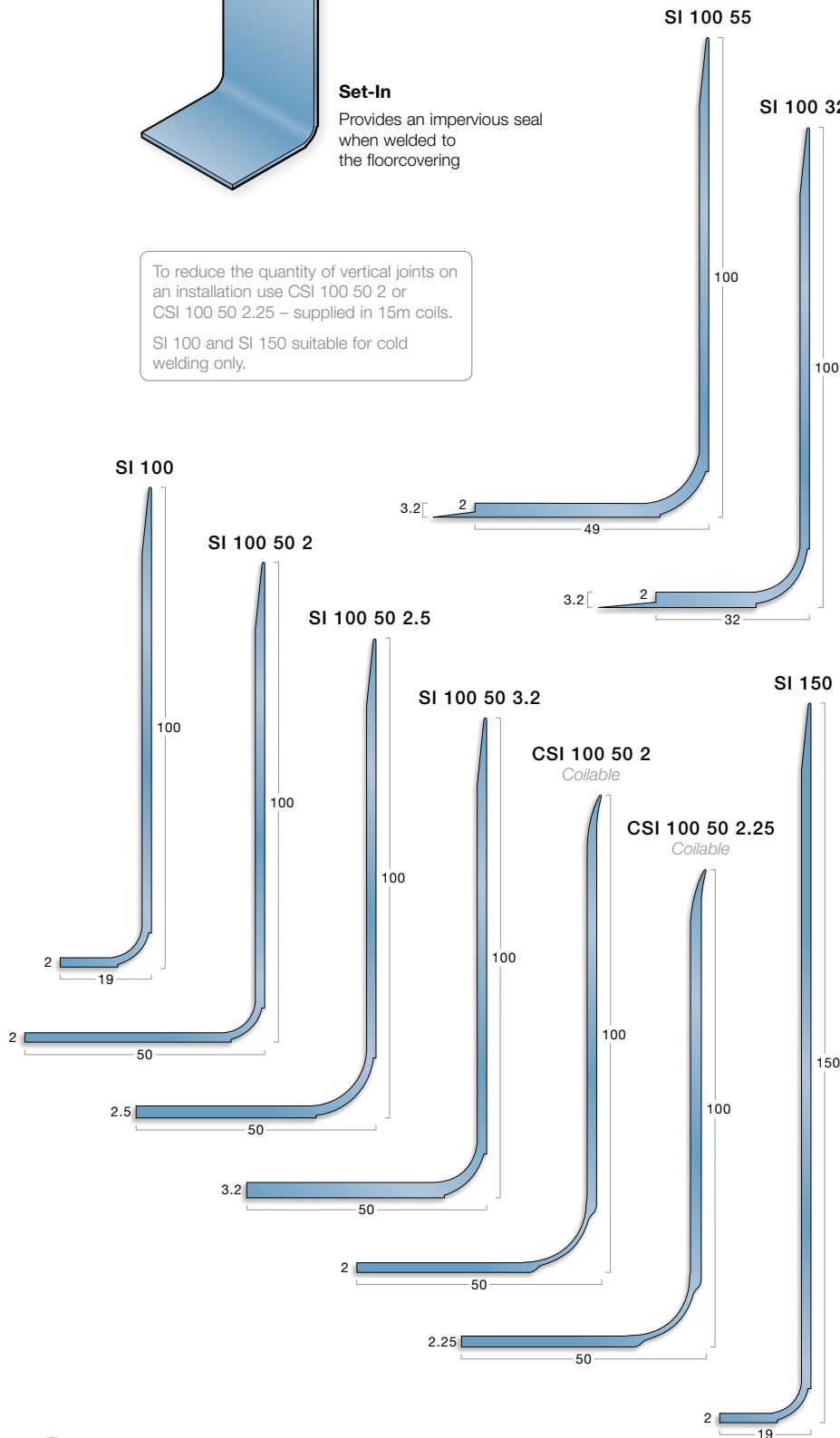

Colour options:

All profiles:

- Black ●
- Brown ●
- Granite ●
- Dove ●

CSI 100 50 2 also available in:

- Evergreen ●
- Stone ●
- Bluebell ●
- Almond ●
- Glacier ●
- Snowdrift ○

SI 100 50 2 also available in:

- Evergreen ●
- Stone ●
- Bluebell ●
- Hickory ●
- Azure ●
- Blueberry ●
- Leaf ●
- Almond ●
- Dune ●
- Salmon ●
- Glacier ●
- Mist ●
- Snowdrift ○

All other skirtings are available in (subject to minimum quantities and lead times):

- Evergreen ●
- Stone ●
- Bluebell ●
- Hickory * ●
- Azure * ●
- Blueberry * ●
- Leaf * ●
- Almond ●
- Dune * ●
- Salmon * ●
- Glacier ●
- Mist * ●
- Snowdrift ○



For guidance on the correct selection of skirtings see page 104.

Description	Flexible pvc set-in and coilable set-in skirting.
Application	Ideal for critical clean areas where a homogeneous finish is required e.g. hospital treatment areas.
Profiles	Various gauges to suit different thicknesses of resilient floorcovering. All supplied in 2m lengths. Coilable skirtings are supplied in 15m coils to minimise vertical joints.
Dimensions shown are nominal. Illustrations are 70% size in mm. Products subject to minor design alterations without notice.	

* Excluding CSI 100 50 2 and CSI 100 50 2.25

Skirtings - Sit-On & Flat

FS 303

Colour options:

All profiles:

- Black
- Brown
- Granite
- Dove

SO 75, SO 100, SO 150, FS 303 and FS 100 B also available in:

- Evergreen
- Stone
- Bluebell
- Hickory*
- Azure*
- Blueberry*
- Leaf*
- Almond
- Dune*
- Salmon*
- Glacier
- Mist*
- Snowdrift

* SO 75 and SO 150 are available subject to minimum quantities and lead times.

DFS 100 also available in:

- Bluebell
- Almond
- Snowdrift

SO 25 and FS 150 B are available in all other colours subject to minimum quantities and lead times.

DFS 100 also available in Evergreen, Stone and Glacier subject to minimum quantities and lead times.

Sit-On

Fitted over most hard floorcoverings for a neat finish



Flat

Generally installed with carpet or carpet tile

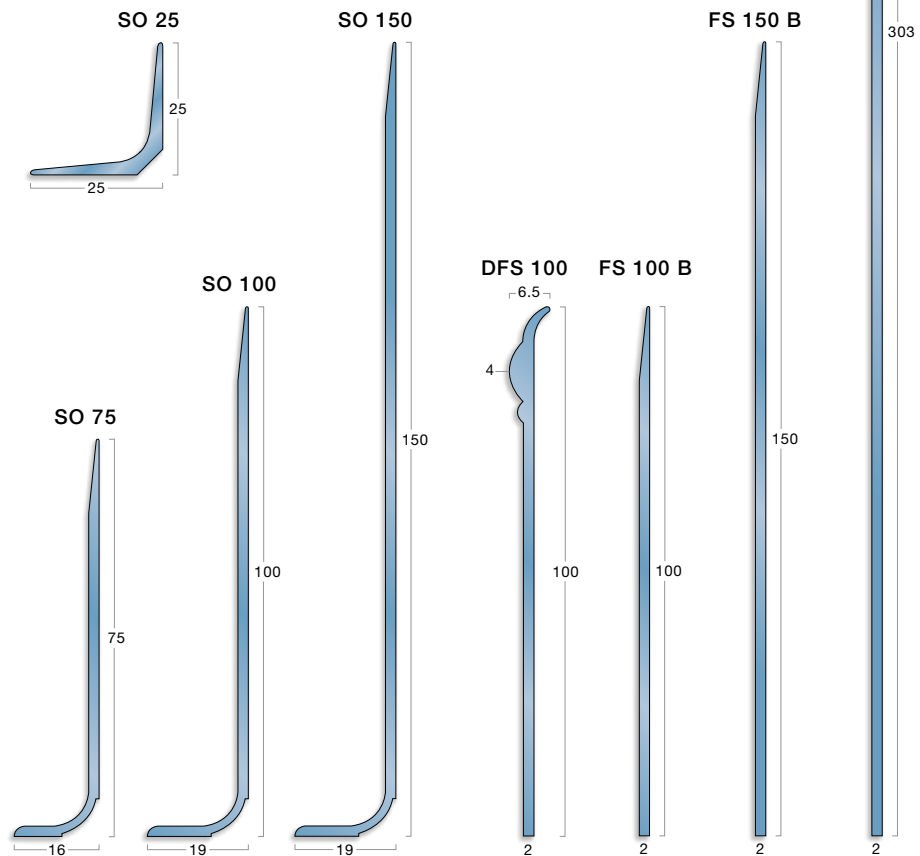
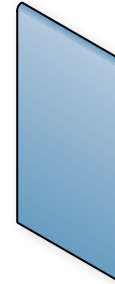

For guidance on the correct selection of skirtings see page 104.

Description	Flexible pvc flat or sit-on skirting.
Application	Sit-on - ideal for use in areas such as hospital corridors, schools etc. Flat - ideal for use with textile floorcoverings - provides a low maintenance alternative to timber skirting.
Profiles	Various heights to suit different applications. FS303 is used to form an internal stringer to stairs. Sit-on skirtings supplied in 2m lengths. Flat skirtings are supplied in 15m coils to minimise vertical joints.
Dimensions shown are nominal. Illustrations are 70% size in mm. Products subject to minor design alterations without notice.	

'P' Range Skirtings - Set-In, Sit-On & Flat

Colour options:

- Black

All profiles are available in all other standard pvc skirting colours subject to minimum quantities and lead times.

Coilable skirtings are only available in selected colours.

Sit-On

Fitted over most hard floorcoverings for a neat finish



Flat

Generally installed with carpet or carpet tile



FS 303 P

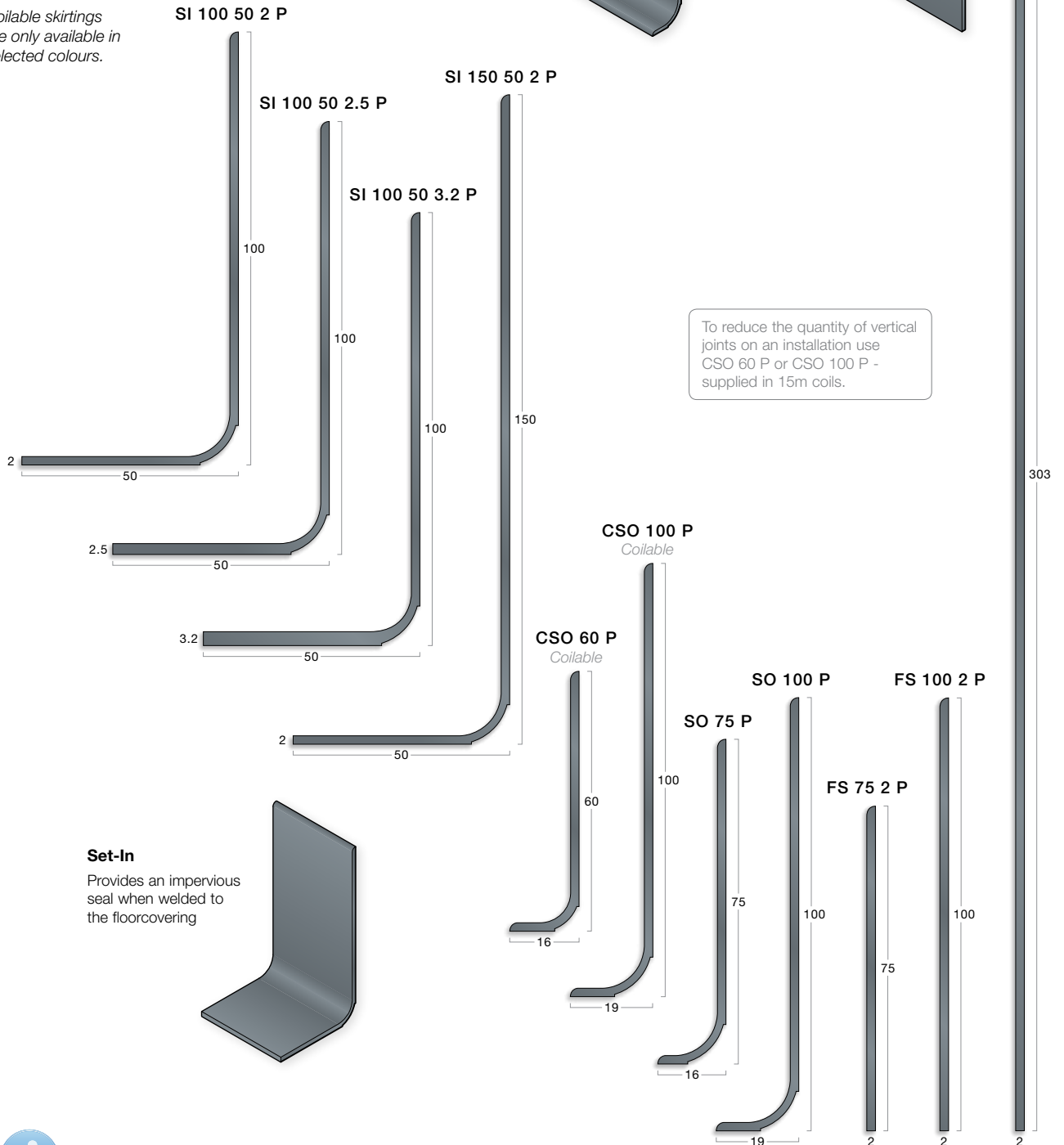

To reduce the quantity of vertical joints on an installation use CSO 60 P or CSO 100 P - supplied in 15m coils.

Set-In

Provides an impervious seal when welded to the floorcovering



For guidance on the correct selection of skirtings see page 104.

Description	Flexible pvc sit-on, sit-on coilable, set-in and flat skirting.
Application	Ideal for use in areas where functionality is a priority.
Profiles	Available in Black only. Set-in and sit-on skirtings supplied in 2m lengths. Flat and coilable skirtings are supplied in 15m coils to minimise vertical joints. Dimensions shown are nominal. Illustrations are 70% size in mm. Products subject to minor design alterations without notice.

Capping Strips & Cove Formers



Description

An extensive range of pvc, PVC-u and aluminium capping strips, cove formers and accessories used where floorcoverings are dressed up the wall to form a skirting with a neat finish, and to join floorcoverings to wall finishes. Suitable for use with carpet, resilient floorcoverings and ceramic tiles. Available in choice of colours that can be used in conjunction with floorcoverings from all major manufacturers. Suitable for a wide range of commercial applications.

 Visit: www.gradusworld.com to download: AutoCAD drawings, Gradus & NBS Specifications, Cleaning & Maintenance, Installation Guidelines and Health & Safety Data Sheets.

Profile

- Suitable for interior use
- Capping seals provide a decorative, neat edge where resilient floorcoverings are dressed up the wall to form a skirting. Available to suit resilient floorcoverings up to 5mm thick
- Carpet caps provide a decorative, neat edge where carpets are dressed up the wall to form a skirting. Available to suit carpets up to 7mm thick (compressed thickness)
- Cove formers provide a neat cove allowing floorcoverings to be dressed up the wall to form a skirting and supports the floorcovering at a weak point
- Tile caps are for use where ceramic wall tiles are finished against a resilient floor finish that has been dressed up the wall to form a skirting. Available to suit resilient flooring up to 6mm thick

Installation Advice

- Capping seals and tile caps are secured to wall surfaces using contact adhesive
- Carpet caps are secured with screws and adhesives to wall surfaces

Colour

- For larger colour swatches see page 105

Capping Strips & Cove Formers

Capping Seals

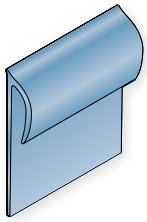

Flexible pvc capping seals are used to finish the top of a resilient floorcovering where it has been covered up the wall. Capping seals are usually used in conjunction with a cove former (see page 114).

HCS48

pvc

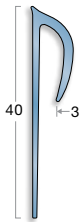

MCS48

pvc Metallic

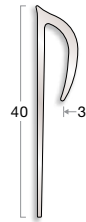

PCS40

pvc

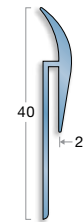

PCS40P

pvc 'P' Range

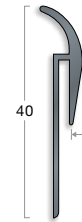

Colour options:

HCS48:

- Black ●
- Evergreen ●
- Brown ●
- Granite ●
- Bluebell ●
- Stone ●
- Dove ●
- Almond ●
- Glacier ●
- Snowdrift ○

MCS48:

- Zinc ●
- Doubleloon ●
- Platinum ●
- Silver ●

PCS40:

- Black ●
- Evergreen ●
- Brown ●
- Azure ●
- Granite ●
- Bluebell ●
- Stone ●
- Hickory ●
- Blueberry ●
- Dove ●
- Leaf ●
- Almond ●
- Dune ●
- Salmon ●
- Glacier ●
- Mist ●
- Snowdrift ○

PCS40P:

- Black ●

CCF 100 1:

- Dove ●
- Almond ●
- Glacier ●
- Snowdrift ○

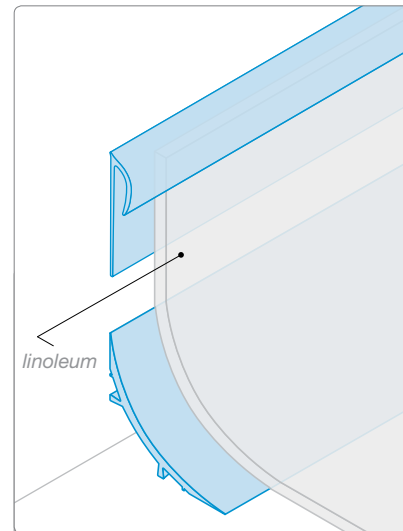

HCS48 capping seal with CF38 cove former and a 3mm linoleum.

Cove Formers

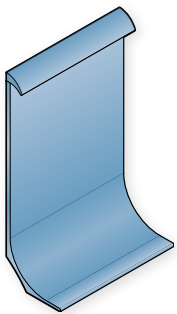

CCF 100 1 is a one piece PVC-u cove former combining a pvc capping seal.



CCF 100 1 contains up to 50% recycled content

CCF 100 1

Co-extruded PVC-u with pvc capping

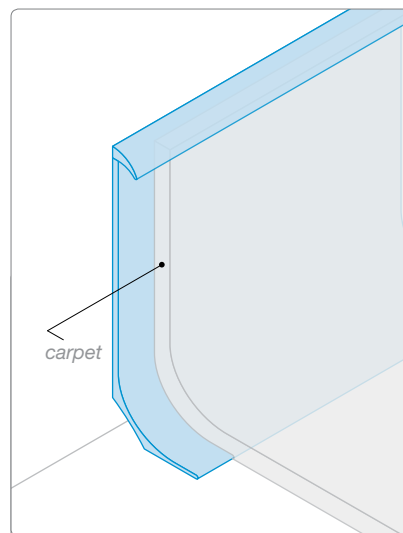
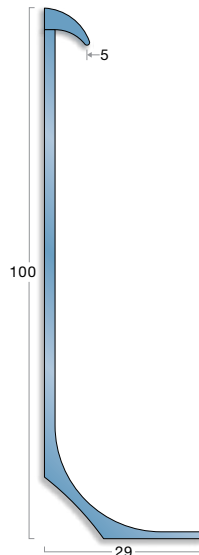

CCF 100 1 fitted with a broadloom carpet to allow the carpet to continue up the wall with a capping seal to protect the exposed edge.

Capping Strips & Cove Formers

Carpet Caps

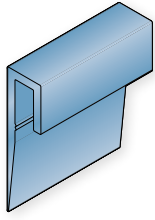

Carpet caps are used to provide a neat finish where carpet or carpet tile is continued up the wall. Available in choice of PVC-u, Metallic PVC-u and Aluminium. Carpet caps can be combined with a cove former where required to help form a cove.

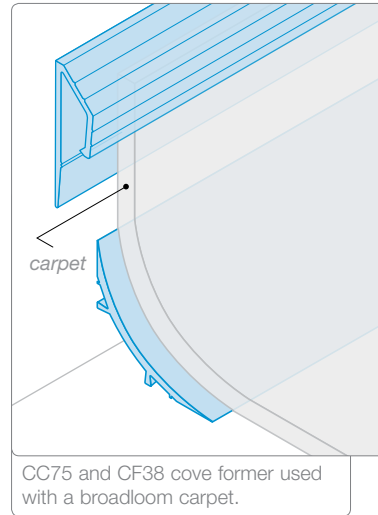
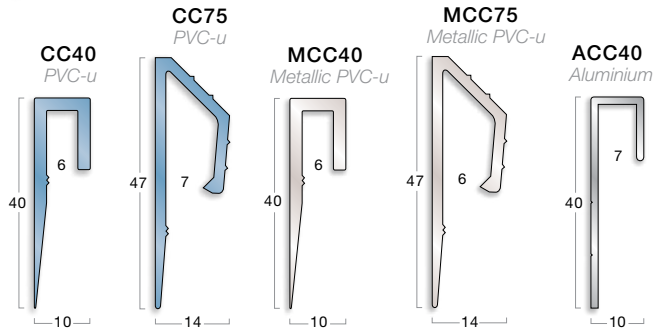

Colour options:

CC40 and CC75:

- Black ●
- Brown ●
- Granite ●
- Bluebell ●
- Dove ●
- Snowdrift ○

MCC40 and MCC75:

- Zinc ●
- Doublon ●
- Silver ●

ACC40:

- Aluminium ●

TC47:

- Snowdrift ○

TC48:

- Black ●
- Burnt Almond ●
- Zinc ●
- Doublon ●
- Platinum ●
- Silver ●
- Snowdrift ○

CF:

- Black ●

Tile Caps

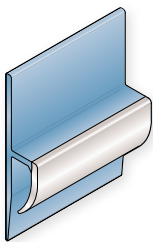

Tile caps are used where ceramic wall tiles are finished against a resilient floor finish that has been dressed up the wall to form a skirting.

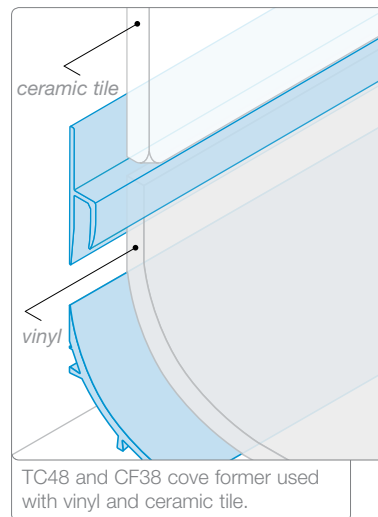
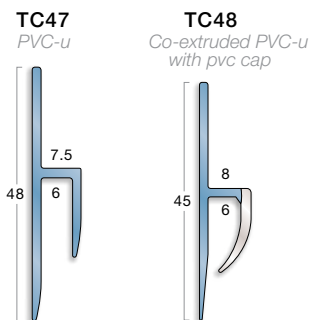

Cove Formers

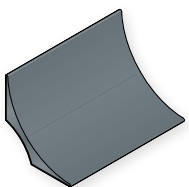

Cove formers are used to form a cove where floorcoverings are continued up the wall. Cove formers are usually used in conjunction with a capping seal or carpet cap to finish the raw edge of the floorcovering (see page 113).

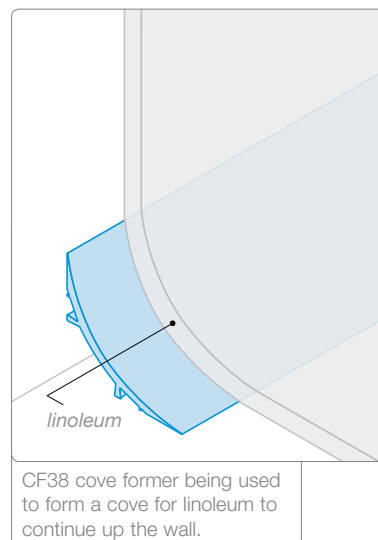
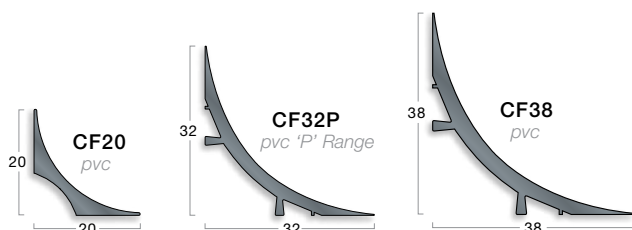
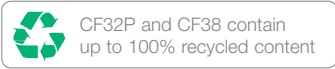

Dimensions shown are nominal. Illustrations are 70% size in mm. Products subject to minor design alterations without notice.

Metal Skirtings

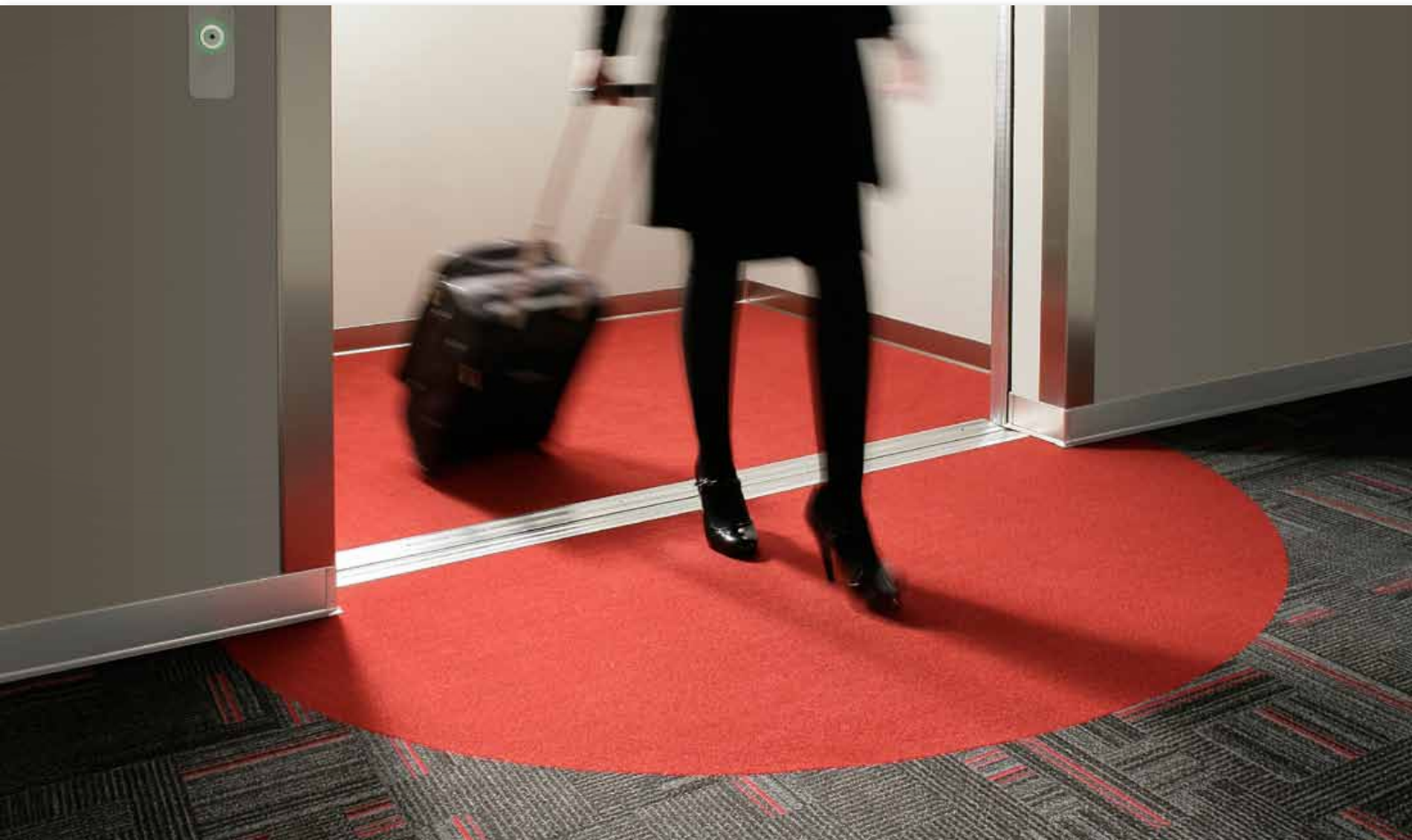

Description

Gradus metal skirtings are available in a variety of designs and heights to suit the requirements of modern commercial environments.

Profiles are available in a variety of finishes including stainless steel and aluminium.

MAS95 and MAS97 profiles have also been designed with a cable tidy feature where low voltage cables e.g. computer and telephone cables, can be hidden from view.

Which Skirting?



slimline skirting profile in either silver anodised aluminium or stainless steel.



anodised aluminium skirting profile fixed to the wall using interlocking fixing brackets.

Profile Availability

Profile designs to accommodate most floorcoverings

- Sit-on skirtings in a variety of heights – 60mm, 70mm, 80mm and 100mm
- MAS90, MAS95 & MAS97 supplied in 2m lengths (anodised aluminium)
- MSS790 supplied in 2.7m lengths (stainless steel)
- Internal corners, external corners and end caps in metal finish
- PVC-u are available for neat finishing on site
- Subject to lead times

Installation Advice

Visit www.gradusworld.com for full installation instructions

- MAS95 and MAS97 profiles are fixed to the wall using screw fixings
- MAS90 and MSS790 profiles are fixed to the wall using appropriate adhesive
- Coordinating PVC-u accessories available for neat finishing on-site.

Colour

- For larger colour swatches see page 105

Metal Skirtings - Modern Hi-Tech Finishing

MAS90 Aluminium Skirtings

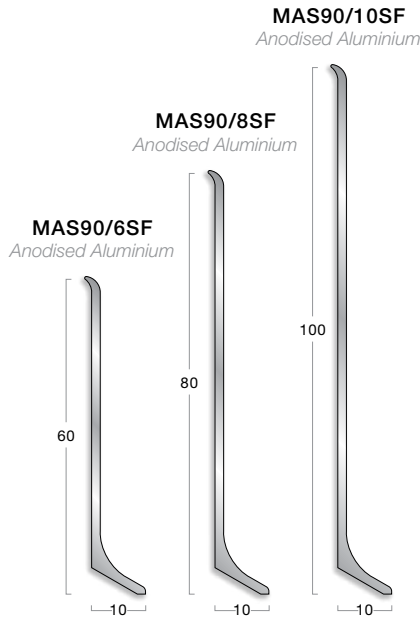

Description	Anodised aluminium
Application	Ideal for use in areas where a modern hi-tech finish is required. Designed to be installed on top of the floorcovering. The capped toe design of the profile allows wall-to-floor expansion gaps to be hidden when installed with tiled floorcoverings.
Profiles	Supplied in 2m lengths. Dimensions shown are nominal. Illustrations are 70% size in mm. Products subject to minor design alterations without notice.

PVC-u accessories are available for the MAS90 profiles for neat finishing on site. These are supplied in a choice of metal finishes to co-ordinate with the skirting profiles.

Skirting Profile	Height	Finish	End Caps	Junction	External Corner	Internal Corner
MAS90/10SF	100mm	Silver	MAS90/10P	MAS90/10G	MAS90/10E	MAS90/10I
MAS90/8SF	80mm	Silver	MAS90/8P	MAS90/8G	MAS90/8E	MAS90/8I
MAS90/8SSF	80mm	Satin Silver	MAS90/8SP	MAS90/8SG	MAS90/8SE	MAS90/8SI
MAS90/8TSF	80mm	Polished Titanium	MAS90/8TP	MAS90/8TG	MAS90/8TE	MAS90/8TI
MAS90/8TMSF	80mm	Satin Titanium	MAS90/8TMP	MAS90/8TMG	MAS90/8TME	MAS90/8TMI
MAS90/6SF	60mm	Silver	MAS90/6P	MAS90/6G	MAS90/6E	MAS90/6I
MAS90/6SSF	60mm	Satin Silver	MAS90/6SP	MAS90/6SG	MAS90/6SE	MAS90/6SI
MAS90/6TSF	60mm	Polished Titanium	MAS90/6TP	MAS90/6TG	MAS90/6TE	MAS90/6TI
MAS90/6TMSF	60mm	Satin Titanium	MAS90/6TMP	MAS90/6TMG	MAS90/6TME	MAS90/6TMI

Note: All accessories are supplied in packs of 4 except for End Caps which are supplied as 4 sets of 2 (one left hand and one right hand)

MSS790 Stainless Steel Skirtings

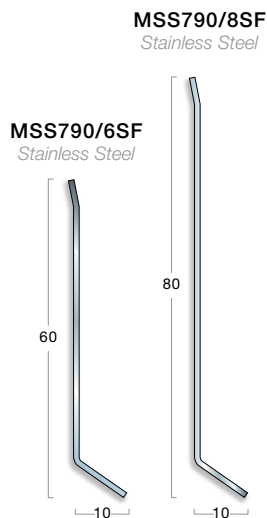

Description	Stainless steel satin finish
Application	Ideal for use in areas where a modern hi-tech finish is required. Designed to be installed on top of the floorcoverings. The capped toe design of the profile allows wall-to-floor expansion gaps to be hidden when installed with tiled floorcoverings.
Profiles	Supplied in 2.7m lengths. Dimensions shown are nominal. Illustrations are 70% size in mm. Products subject to minor design alterations without notice.

Accessories are available for the MSS790 profiles for neat finishing on site. These are supplied in satin finish PVC-u to co-ordinate with the skirting profiles.

Skirting Profile	Height	Finish	End Caps	Junction	External Corner	Internal Corner
MSS790/8SF	80mm	Satin	MSS790/8PS	MSS790/8GS	MSS790/8ES	MSS790/8IS
MSS790/6SF	60mm	Satin	MSS790/6PS	MSS790/6GS	MSS790/6ES	MSS790/6IS

Note: All accessories are supplied in packs of 4 except for End Caps which are supplied as 4 sets of 2 (one left hand and one right hand)

Metal Skirtings - Modern Hi-Tech Finishing

MAS95 Interlocking Aluminium Skirtings

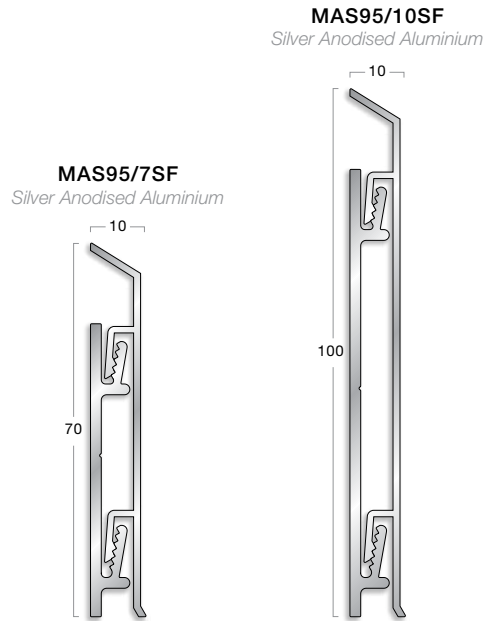

Description	Silver anodised aluminium with interlocking aluminium fixing brackets.
Application	Ideal for use in areas where a modern finish is required. Design allows low voltage (computer & telephone) cables to be hidden behind the skirting profile.
Profiles	Supplied in 2m lengths. 5 fixing brackets supplied per length. Dimensions shown are nominal. Illustrations are 70% size in mm. Products subject to minor design alterations without notice.

Accessories are available for the MAS95 profiles for neat finishing on site. These are supplied in silver finish PVC-u to co-ordinate with the aluminium skirting profiles.

Skirting Profile	Height	Finish	End Caps	Junction	External Corner	Internal Corner
MAS95/10SF	100mm	Silver	MAS95/10P	MAS95/10G	MAS95/10E	MAS95/10I
MAS95/7SF	70mm	Silver	MAS95/7P	MAS95/7G	MAS95/7E	MAS95/7I

Note: All accessories are supplied in packs of 4 except for End Caps which are supplied as 4 sets of 2 (one left hand and one right hand)

MAS97 Interlocking Aluminium Skirting

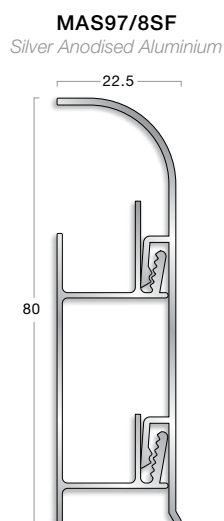

Description	Silver anodised aluminium with interlocking PVC-u fixing brackets.
Application	Ideal for use in areas where a modern finish is required. Design allows low voltage (computer & telephone) cables to be hidden behind the skirting profile.
Profiles	Supplied in 2m lengths. 5 fixing brackets supplied per length. Dimensions shown are nominal. Illustrations are 70% size in mm. Products subject to minor design alterations without notice.

Accessories are available for the MAS97 profiles for neat finishing on site. These are supplied in silver finish PVC-u to co-ordinate with the aluminium skirting profiles.

Skirting Profile	Height	Finish	End Caps	Junction	External Corner	Internal Corner
MAS97/8SF	80mm	Silver	MAS97/8P	MAS97/8G	MAS97/8E	MAS97/8I

Note: All accessories are supplied in packs of 4 except for End Caps which are supplied as 4 sets of 2 (one left hand and one right hand)

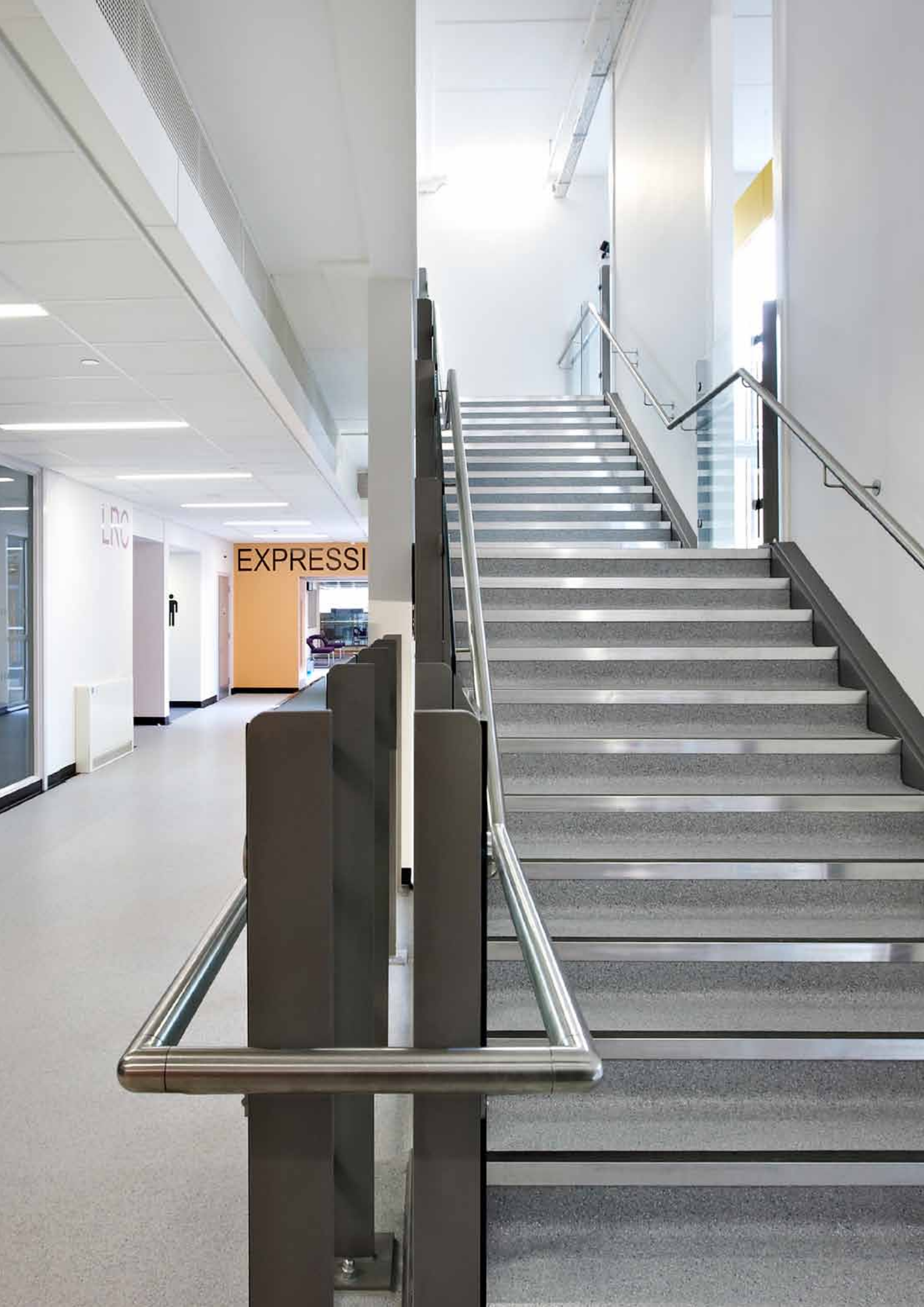

EXPRESSI

INFO
LINO

