

QUICK SET UP GUIDE FOR THE LIVE LINK MOVEMENT SENSOR

1. Connect the cable into the nurse call socket (use splitter if needed)

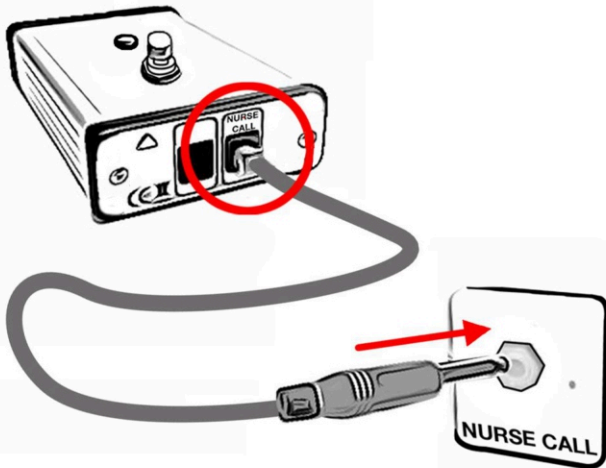

2. Position sensor in the area to be monitored (ensure there are no obstructions)

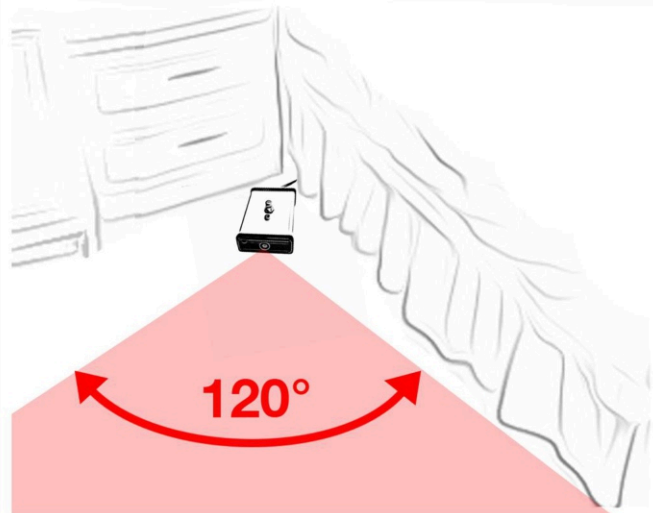

3. To set the movement sensor push down on the button **once**

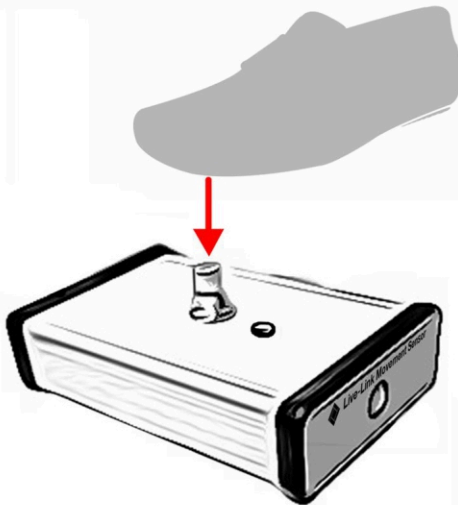

4. The LED light will flash for **20 Seconds** to allow time for staff to exit the room

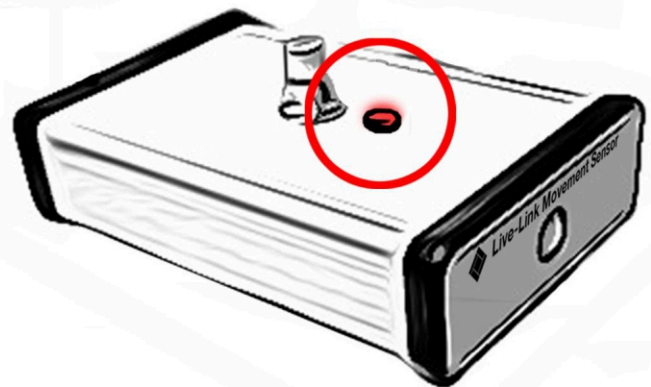

5. When resident triggers sensor it will activate the nurse call system.



6. To switch off sensor push down **once** and then reset the nurse call system. See to resident & repeat process from step 3...



IMPORTANT WARNING!

The Movement Sensor is designed to be installed by the Care Staff.

If a user fails to position and switch on the sensor correctly, it will not pick up any movement.

It is the responsibility of the Care Staff to see that it is properly installed and tested with each use. Failure to test the Movement Sensor before each use, misuse, or inappropriate cleaning will void the warranty. These units are not a substitute for routine visual monitoring protocols and good care. There are clear guidelines on the set up of this product which must be followed. Failure to comply with these warnings may result in injury or death to the person in your care.

Live-Link Movement Sensor.

The Live-Link Movement Sensor is capable of monitoring residents for the following;

1. **Resident attempting to leave their Bed:** The best way to achieve this is to place the Live-Link Movement Sensor on an adjustable overbed table situated at the bottom of the bed at a height of approximately 33" (840mm) with the Sensor facing towards the headboard (these measurements are based on the average height of a bed). Some testing of the equipment simulating a resident rising will need to be carried out by staff to assess best positioning of the equipment.
2. **Resident leaving their Bed:** Place the Live-Link Movement Sensor on the floor with the Sensor facing towards the bed area that needs to be covered
3. **Resident exiting their Room:** If staff are happy with a resident getting out of bed for whatever reason but would like some way of knowing if a resident leaves their bedroom the Live-Link Movement Sensor may be placed on the floor with the Sensor facing across the bedroom door.

NB: When a member of staff enters a residents room for any reason they must **FIRST** push down the silver button once on the Live-Link Movement Sensor and if activated reset the Room Unit. To set the Live-Link Movement Sensor push down the silver button once. The Sensor will flash for 20 seconds to allow staff time to exit the room. The Live-Link Movement Sensor is now set.

To Set the Live-Link Movement Sensor

If the Room Unit that the Live-Link Movement Sensor is to be connected into needs to also have a Pear Push Lead connected into it a Splitter will be required

- Connect the Splitter into the Room Unit
- Connect the Pear Push Lead into one of the sockets on the Splitter if needed
- Connect the cable provided into the remaining socket on the Splitter and connect the other end into the 'Nurse Call' socket which is located on the back of the Live-Link Movement Sensor
- Position the Live-Link Movement Sensor in the area to be monitored
- Set the Live-Link Movement Sensor by pushing down the silver button once. The LED will flash for 20 seconds to allow staff time to exit the room
- The Live-Link Movement Sensor is now set
- When the resident triggers the Live-Link Movement Sensor it will activate a call on the Room Unit
- On entering the room reset the Live-Link Movement Sensor **FIRST** by pushing down the silver button once and then go to the Room Unit and press Reset
- To set the Live-Link Movement Sensor push down the silver button once. The LED will flash for 20 seconds to allow staff time to exit the room
- The Live-Link Movement Sensor is now set
- Variances occur with certain light exposure. Pointing Sensor towards direct sunlight will decrease the performance of the unit. Avoid this if possible

IMPORTANT WARNING!

The Movement Sensor is designed to be installed by the Care Staff.

If a user fails to position and switch on the sensor correctly, it will not pick up any movement.

It is the responsibility of the Care Staff to see that it is properly installed and tested with each use. Failure to test the Movement Sensor before each use, misuse, or inappropriate cleaning will void the warranty. These units are not a substitute for routine visual monitoring protocols and good care. There are clear guidelines on the set up of this product which must be followed. Failure to comply with these warnings may result in injury or death to the person in your care.