

Busbar systems up to 1600 A (185 mm)

Busbar support (3-pole)

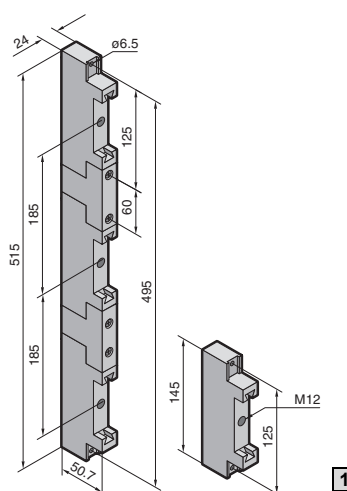
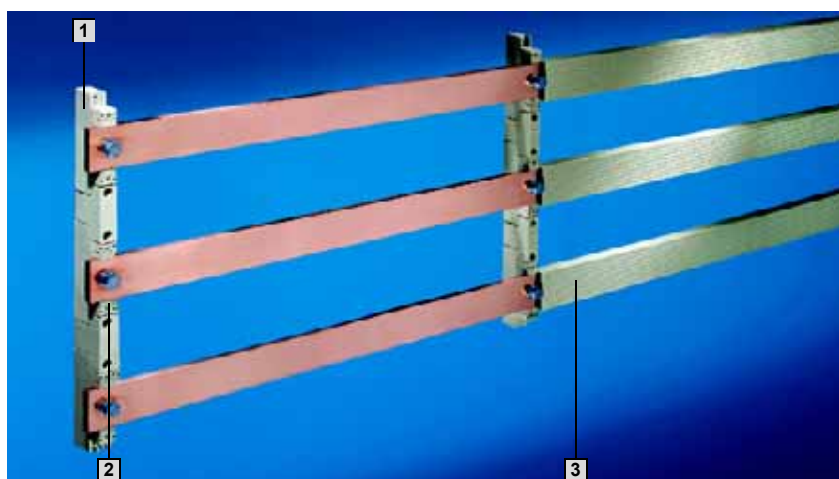

Material:

Fibreglass-reinforced, thermoplastic polyester (PBT). Continuous operating temperature max. 140°C. Fire protection corresponding to UL 94-V0.

Colour:

RAL 7035

Note:

The base component of the busbar support may also be used as a single-pole support.

Short-circuit protection diagram,

see page 1232.

Technical information

for the calculation of rated currents, see page 1247.

Design	Packs of	1
Number of poles		3-pole
Bar centre distance		185 mm
Max. bar accommodation without inserts		80 x 10 mm
With inserts for bar accommodation		50 – 60 x 10 mm
Tightening torque		
● Assembly screw		3 – 5 Nm
● Bar fastening screw		40 Nm
Model No. SV	2	3052.000
Accessories		
2 Inserts to adapt the bar dimensions		
50 x 10 mm	24	3074.000
60 x 10 mm	24	3075.000

Busbars E-Cu

To DIN EN 13 601.

Length: 2400 mm/bar.

Dimensions in mm	Packs of	Model No. SV	Page
50 x 10	3	3588.000	
60 x 10	3	3589.000	
80 x 10 ¹⁾	3	3590.000	

Accessories

3 Busbar cover section (length 1 m/each) for E-Cu

50 x 10 – 60 x 10 mm	10	3085.000	408
----------------------	----	----------	-----

¹⁾ Other busbar lengths, see page 409.

Busbar systems up to 1600 A (185 mm)

Connection clamps

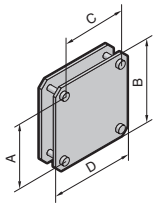
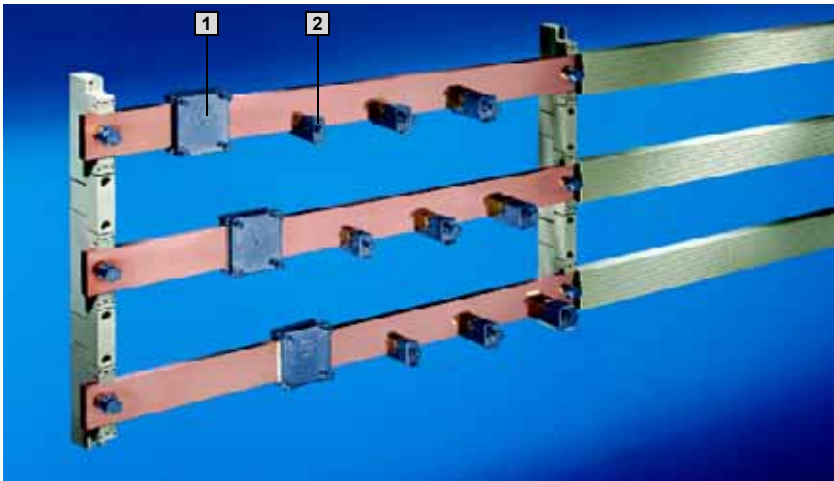

1 Plate clamps

For connecting laminated copper bars; no drilling required.

Material:
Sheet steel, zinc-plated, passivated.

+ Accessories:

Laminated copper bars, see page 411.

For busbars mm	Clamping area for laminated copper bars mm	Tightening torque Nm	A mm	B mm	C mm	D mm	Packs of	Model No. SV
50 x 10	34 x 10	6 – 8	60	75	40	55	3	3560.000
50 x 10	54 x 10	6 – 8	60	75	60	75	3	3562.000
60 x 10	34 x 10	6 – 8	70	85	40	55	3	3561.000
60 x 10	54 x 10	6 – 8	70	85	60	75	3	3563.000
80 x 10	65 x 10	6 – 8	90	105	71	86	3	3460.500

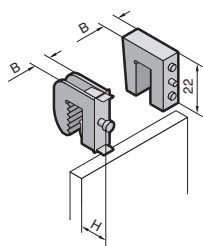

2 Conductor connection clamps

For 10 mm bar thickness.

Material:
Sheet steel, zinc-plated, passivated (SV 3455.500 – SV 3459.500), brass (SV 3555.000).

Note:

Conductor connection clamps for 5 mm bar thickness, see page 358.

+ Accessories:

Laminated copper bars, see page 411.

Connection of round conductors ¹⁾ mm ²	Clamping area for laminated copper bars mm	Tightening torque Nm	Width (B) mm	Height (H) mm		Packs of	Model No. SV
				min.	max.		
1 – 4	–	2	8	–	–	15	3555.000
1 – 4	–	2	11	17	23	15	3455.500
2.5 – 16	8 x 8	3	14	22	29	15	3456.500
16 – 50	10.5 x 11	6 – 8	18.5	26	39	15	3457.500
35 – 70	16.5 x 15	10 – 12	24.5	39	57	15	3458.500
70 – 185	22.5 x 20	12 – 15	30.5	44	66	15	3459.500

¹⁾ Wire end ferrules should be used with fine wire conductors.

Busbar systems up to 1600 A (185 mm)

NH fused isolators, size 00 – 3 (3-pole)

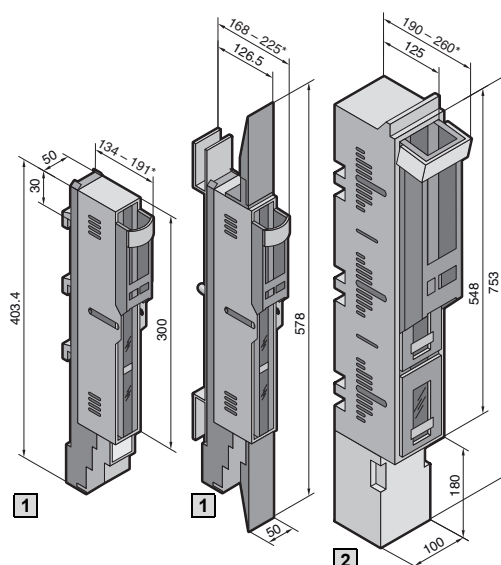

Material:

Cover (size 00 – 3):
Fibreglass-reinforced polyamide
Strip chassis (size 00):
Fibreglass-reinforced polyamide
Strip chassis (size 1 – 3):
Duroplastic polyester
Contact tracks:
Silver-plated hard copper

Scope of supply SV 3591.040:

including
1 busbar adaptor¹⁾,
2 compensating panels,
3 inserted screw nuts M12

Scope of supply SV 3591.050:

including
1 busbar adaptor¹⁾,
(double adaptor),
4 compensating panels,
3 inserted screw nuts M12

Scope of supply SV 3485.000 – SV 3487.000:

including
3 inserted screw nuts M12
¹⁾ Tightening torque 25 Nm
(bar attachment)

Technical information,
see page 1244.

B
2.4

Busbar systems up to 1600 A (185 mm)

Design	Packs of	1		2			Page
Size		00	1	2	3		
Rated current		160 A	250 A	400 A	630 A		
Rated operating voltage		690 V~	690 V~	690 V~	690 V~		
Cable outlet		top/bottom	top/bottom	top/bottom	top/bottom		
Type of connection		Screw M8	Screw M12	Screw M12	Screw M12		
Tightening torque							
● Assembly screw		14 Nm	40 Nm	40 Nm	40 Nm		
● Terminal screw		14 Nm	40 Nm	40 Nm	40 Nm		
Packs of		1	2	1	1		
Model No. SV		3591.040	3591.050	3485.000	3486.000	3487.000	

Accessories

Accessories	Packs of	3591.040	3591.050	3485.000	3486.000	3487.000	Page
3 Identification label support	6	3595.010	3595.010	–	–	–	406
Micro-switch	5	3071.000	3071.000	3071.000	3071.000	3071.000	406
Lug terminal connection parts	1 set	3592.020	3592.020	–	–	–	407
Clamp-type terminal connection	1 set	3592.010	3592.010	–	–	–	407



Inserted screw nuts M12

Self-holding nuts with knurled ring.
For drilled holes in busbars Ø 14.5 mm.

Packs of	Model No. SV
30	3591.060