

Operating housings

Features



Modern, flexible production technology demands solutions which precisely meet the required standards of ergonomics, user-friendliness, hygiene and corrosion protection at the operating interface. The Rittal Command Panel range is tailored to these requirements. Supplemented by a support arm or pedestal system, system accessories or system climate control, an enclosure becomes a complete solution. All this is achieved quickly and practically on your behalf.

1.4 B Operating housings

Compact Panel, aluminium



Front panels are inserted from the rear and secured with a screw clamp.



Rear door hinged optionally on the right or left by loosening the screws.



Mounting optionally on support arm system CP-S or directly with the wall attachment, vertically hinged, see page 977.



CP pedestal, height adjustable, the ideal attachment for light operating units. Adjustment range 200 mm, swivel area max. 180°, see page 1136.



The cable conduit ensures safe cable routing between the machine and the operating console, see page 1065.

Quickline Panel



Simple door opening: Release the hinge pins from the outside with a screwdriver, and it's done.



Simple attachment of TS 8 system accessories with the mounting bracket CP 6205.100, see page 1004.

Command Panel housing with door, with handle strips



For additional aluminium front panels, the handle strips may be set forward by up to 5 mm.



Rear panel with welded nuts for the attachment of mounting plate or support rails.

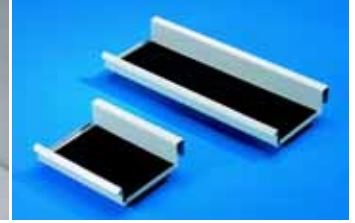

Space for tools, measuring instruments or scanners with the utility shelf, screw connection, see page 1123.

Operating housing with handle strips



Interior installation of the enclosure via side mounting angles with system punchings.



Additional installation space is created by the perforated mounting strips on both sides in the rear door.



The support arm bracket 90° CP-L may be used for external mounting of compact support arm systems, see page 254.

Operating housing with display panel front



For installation or servicing, the hinged display panel front may be opened from the inside by loosening the screws.



Interior installation of the enclosure via side mounting angles with system punchings.



For the support of keyboards. For programming and servicing work, the vertically hinged utility bars, CP 6514.200, may be externally mounted, see page 1140.

Operating housing with wide VIP 6000 frame



External mounting of VIP keyboard housings via frame connectors, rigid or adjustable, see page 225.



Interior installation of the enclosure via side mounting angles with system punchings.



The interface flap SZ 2482.200 ensures secure accommodation of sockets, ports or drives, see page 1150.

Operating housings

Features



Premium Panel, stainless steel (may be found in the stainless steel section on page 311)



Exceptionally hygienic, thanks to easy-to-clean, external, highly resistant silicone seal.



Pressure washer-resistant (protection category IP 69K to DIN 40 050-9) and high EMC shielding effect thanks to ideal shaping of the seal and all-round metallic contact between the enclosure and the rear panel.



Suitable for use in clean rooms to meet the most demanding requirements, certified by the Fraunhofer-Institut IPA.



Clear hygiene benefits compared with external hinges, rear panel bracket CP 6682.000, see page 962.

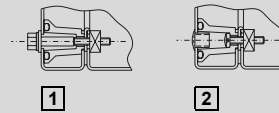

Screw fastening of the rear panel optionally via external hex screws **1** or internal screws, concealed with plastic stoppers **2**.



Protected cable routing from the operating housing to the keyboard housing via a robust duct connector.



Operating housing with door, stainless steel (may be found in the stainl. steel section on p. 312)



Rear panel with welded nuts for the attachment of mounting plate or support rails.

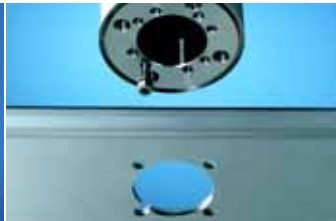

Simple mounting on the support arm system CP-S stainless steel by locating the pre-assembled screw in the cut-out.



Safe handling when swivelling, thanks to side handle strips.

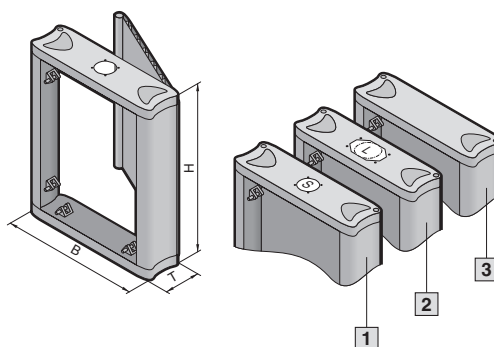

For small operating units built into front panels. The front panel is inserted from the rear and secured with screw clamps. Special front panels with a material thickness of between 2 and 6 mm are possible. Rear panel optionally hinged on the left or right.

Material:

Roof tray, base tray, rear panel: Aluminium
Side parts: Extruded aluminium section
Screw cover: Plastic

Surface finish and colour:

Roof tray, base tray, side parts: Powder-coated, RAL 7024
Rear panel: Natural-anodised
Screw cover: Similar to RAL 7024

Protection category:

IP 65 to EN 60 529/09.2000

Supply includes:

Roof tray, base tray, rear panel, side parts, screw cover, including seal and screw clamp.



Rittal service:

- Other RAL colours
- Holes and cut-outs in the roof and base tray

Detailed drawing,
see page 1215.

Property rights:

German patent no. 102 16 448
German patent no. 102 16 366

Assembly examples:

with wall mounting bracket

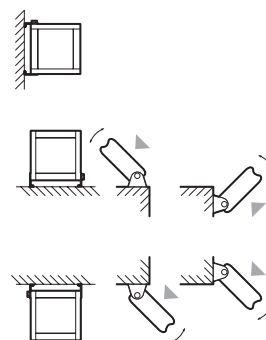

with support arm connection

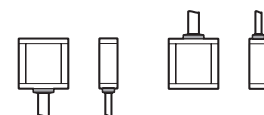

Width (B) mm	Packs of	241	241	241	315	315	Page
Height (H) mm		238	388	521	238	388	
Depth (T) mm		87	87	87	87	87	
To fit	Front panel width mm	178	178	178/4 U	252	252	
	Front panel height mm	200	350	482.6/19"	200	350	
1 Model No. CP (with support arm connection CP-S)	1	6340.000	6340.100	6340.200¹⁾	6340.300	6340.400	
2 Model No. CP ¹⁾ (with support arm connection CP-L, □ 120 x 65 mm)	1	6340.010	6340.110	6340.210	6340.310	6340.410	
3 Model No. CP ¹⁾ (without support arm connection)	1	6340.020	6340.120	6340.220	6340.320	6340.420	
Weight (kg)		2.8	3.8	4.5	3.4	4.5	

Accessories							
Front panel, 3.0 mm aluminium, natural-anodised	1	6028.500	6028.510	6028.520	6028.530	6028.540	1120
Wall mounting bracket, vertically hinged	1 set	6341.000	6341.000	6341.000	6341.000	6341.000	977
Pedestal, height-adjustable	1	6510.500	-	-	6510.500	-	1136
Cable conduit and accessories				see page			1065
Cover plate for support arm connection CP-S	1	6505.200	6505.200	6505.200	6505.200	6505.200	1124
Spring nut M5	50	6108.000	6108.000	6108.000	6108.000	6108.000	1011

¹⁾ Extended delivery times.
To order different heights for front panel width:
- 178 mm use Model No.: CP 6342.109
- 252 mm use Model No.: CP 6342.209
and additionally specify the front panel height. Extended delivery times.

Quickline Panel

Quickline Panel
1.4 B

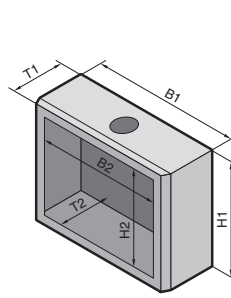

CP 6690.500

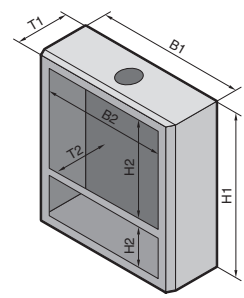

CP 6691.500

The Command Panel for every occasion

- Support arm cut-out may be at the top or bottom by simply refitting:
 - Door with one aperture: Simply rotate, and swap over the door hinge if necessary.
 - Door with two apertures: Remove the door, rotate the enclosure, exchange the lock parts, and re-attach the door.
- Standard support arm cut-out CP-L Ø 130 mm, easily swapped for a larger support arm system CP-XL/CP/Q by drilling 4 holes.

- Hinges right and left with multiple function:
 - Door hinging on l/h or r/h side. With symmetrical enclosures, by rotating the enclosure body against the door.

Direct Command Panel mounting:

Door with one aperture:

- **Siemens Sinumerik:**
 - OP 010,
 - OP 010 C,
 - OP 012,
 - OP 015.

- **Siemens Simatic:**
 - Panel PC 477, 577, 677B (12" keys, 15" touchscreen),
 - OP 277 10",
 - MP 277B 10" keys,
 - MP 377B 12" keys.

Door with two apertures:

- MCP 483C,
- MCP 483,
- PP 012.

Material:

Enclosure and door: Sheet steel

Surface finish:

Dipcoat-primed, powder-coated in textured RAL 7035 on the outside

Supply includes:

Enclosure with cut-out and reinforcement, prepared for support arm system CP-L Ø 130 mm, door with foamed seal, threaded bolts in all 4 corners for flexible interior installation via mounting brackets (see table).



Rittal service:

Other dimensions and apertures for different controllers available on request.

Detailed drawing, see page 1215.

Width (B1) mm	575		Page
Height (H1) mm	383	538	
Depth (T1) mm	191		
For installation panel W x H	482.6 mm (19") x 310 mm (7 U)	482.6 mm (19") x 310 mm (7 U) + 482.6 mm (19") x 155 mm (3.5 U)	
Cut-out size B2 x H2	450 mm x 290 mm	450 mm x 290 mm + 450 mm x 137.5 mm	
Installation depth (T2) mm	185		
Support arm connection	Top	Top	
Model No. CP	6690.500	6691.500	
Accessories			
Mounting bracket for the installation of punched section with mounting flange and TS support strips	6205.100	6205.100	1004
Punched section with mounting flange	horizontal	8612.160	993
	vertical	–	8612.150
TS mounting bars	horizontal	4696.000	997
	vertical	4594.000	4695.000



Fast service and good access

- Simple door opening: Release the hinge pins from the outside with a screwdriver, and it's done.
- Easy door removal: Open the door, release the hinge pins and remove.



Perfect interior installation

- Use of TS 8 system accessories: TS punched sections with mounting flanges and TS supports strips, for vertical or horizontal installation (see table).
- Simple attachment with mounting bracket CP 6205.100.

Command Panel housing with door

based on AE

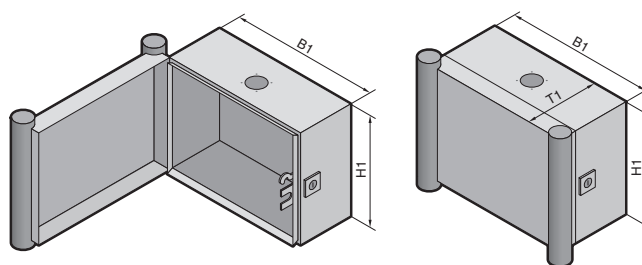

B
1.4

Command Panel housing with door

Material and surface finish:

Enclosure and door:
Sheet steel, dipcoat-primed
and powder-coated in
textured RAL 7035
Handle strips:
Aluminium, powder-coated in
RAL 5018
Cover caps:
Plastic, RAL 5018

Protection category:
IP 55 to EN 60 529/09.2000

Supply includes:

Enclosure with cut-out and
reinforcement for support arm
system CP-L¹⁾, Ø 130 mm,
with seal.
Door with sealing frame, side
handle strips and end caps.

Note:

The support arm connection and
door hinge may be swapped
over by rotating the enclosure.



Rittal service:

- Other sizes
- Other RAL colours
- Modified support arm cut-out
or door hinge
- Drilled holes and cut-outs for
keypads and operator panels
- Aluminium front panels
(up to 5 mm thick, may be
positioned on the enclosure
front between the side handle
strips and door)
available on request.

Detailed drawing,
see page 1216.

Approvals,
see page 38.

Width (B1) mm	Packs of	300	300	300	400	400	500	Page
Height (H1) mm		200	300	400	300	400	500	
Depth (T1) mm		180	180	180	180	180	180	
Model No. CP ¹⁾	1	6534.000	6535.000	6537.000	6536.000	6538.000	6544.000	
Weight (kg)		5.5	7.1	8.4	8.4	10.6	14.5	

Accessories

	AE type		1032.500	1033.500	1034.500	1030.500	1380.500	1050.500	
Matching mounting plate	Model No. ³⁾		0271.324	0271.926	0271.927	0274.131	0271.548	0271.333	128/129
Support rails ²⁾	Model No.	10	2316.000	2316.000	2316.000	2317.000	2317.000	2318.000	1002

Lock systems

Standard double-bit lock insert may be exchanged for 41 mm lock inserts, plastic handle and T handle, type C,
see page 954 – 956.

¹⁾ To order a Command Panel housing with door with mounting cut-out CP-S, please use the extension number .080.
Delivery times available on request.

²⁾ Only with vertical attachment of punched rail 23 x 23 mm, see page 998.

³⁾ Delivery times available on request.



Signal pillar LED compact.
Model No. see page 1125.



Utility bars, vertically hinged
for keyboards.
Model No. see page 1140.

Command Panel

based on AE

1.4

Command Panel

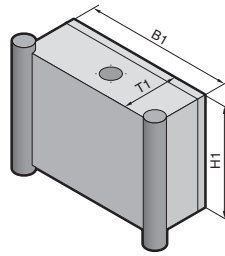

Material and surface finish:

Enclosure and door:
Sheet steel, dipcoat-primed
and powder-coated in
textured RAL 7035
Handle strips:
Aluminium in RAL 7030
Cover caps:
Plastic, RAL 7030

Protection category:

IP 55 to EN 60 529/09.2000

Supply includes:

Enclosure with cut-out and
reinforcement for support arm
system CP-L, Ø 130 mm and
with mounting angles spot
welded at the sides.
Front with maximum cut-out,
covered with easily machinable
3 mm aluminium front panel and
side handle strips with end
caps.
Rear with door.

Note:

The support arm connection and
door hinge may be swapped
over by rotating the enclosure.



Rittal service:

- Other sizes
- Other RAL colours
- Modified support arm cut-out or door hinge
- Drilled holes and cut-outs for keypads and operator panels available on request.

Property rights:

German patent no. 44 13 543
French patent no. 95 04769
GB patent no. 2 288 971
Ital. patent no. 01273518
Jap. patent no. 2 820 637
US patent no. 5,662,397
German registered design
no. M 94 03 156
U.K. reg. des. no. 2 042 639
Jap. reg. des. no. 955 950
US design patent
no. des. 375,938

Detailed drawing,
see page 1216.

Approvals,
see page 38.

Width (B1) mm	Packs of	300	380	380	500	600	Page
Height (H1) mm		200	300	380	500	380	
Depth (T1) mm		155	210	210	210	210	
Model No. CP	1	6540.200 ¹⁾	6531.200	6530.200	6532.200	6533.200	
Weight (kg)		4.9	9.3	10.2	15.4	14.6	

Accessories

Support strips for attaching to the mounting angles of the side panel	20	-	-	4594.000	4309.000	4594.000	964
---	----	---	---	----------	----------	----------	-----

Lock systems

Standard double-bit lock insert may be exchanged for 27 mm lock inserts, type A, lock cylinder, plastic handles and T-handles, type B, see page 954 – 957.

¹⁾Support arm connection and door hinge at the bottom.



Support arm bracket 90° CP-L
for the assembly of compact
support arm systems.
Model No. see page 254.



Open pedestal
for the entry of cables with
pre-assembled connectors.
Model No. see page 294.

Command Panel

based on AE with display panel front

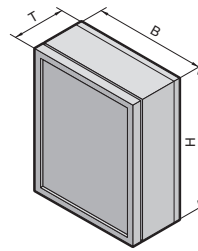

Material and surface finish:

Enclosure and door:
Sheet steel, dipcoat-primed
and powder-coated in
textured RAL 7035
Frame and front panel:
Aluminium, natural-anodised.

Protection category:
IP 54 to EN 60 529/09.2000

Supply includes:

Enclosure without support arm
connection with mounting
angles spot-welded at the sides.
With maximum cut-out at the
front and fitted, easily machina-
ble 3 mm front panel with
aluminium frame,
with r/h hinge, screw-fastened
from the inside.
Rear door, r/h hinge,
with two cam locks (for
CP 6442.500 one lock).



Rittal service:

- Other sizes
- Other RAL colours
- With support arm cut-out
- Drilled holes and cut-outs
for keypads and operator
panels
available on request.

Detailed drawing,
see page 1217.

Approvals,
see page 39.

Width (B) mm	Packs of	380	380	500	600	Page
Height (H) mm		380	600	500	600	
Depth (T) mm		249	249	249	249	
Model No. CP	1	6442.500	6462.500	6552.500	6662.500	
Weight (kg)		9.5	13.4	18.0	19.6	

Accessories

Reinforcement plate with support arm cut-out CP-L	1	6143.210	6143.210	6143.210	–	296
Enclosure reinforcement with support arm cut-out CP-L	1	–	–	–	6503.000	296

Lock systems

Standard double-bit lock insert may be exchanged for 27 mm lock inserts, type A,
lock cylinder, plastic handles and T-handles, type B, see page 954 – 957.

To order Command Panels in RAL 7032, please add extension .200 to the Model No. Delivery times available on request.



TFT monitor
for industrial use.
Model No. see page 1133.



Support for keyboards.
Model No. see page 1140.

Command Panel

based on AE with wide VIP 6000 frame

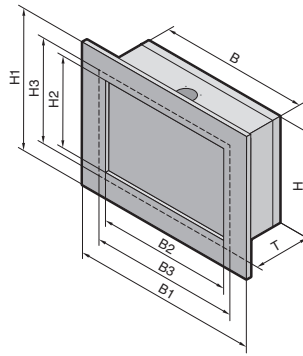

Width dimensions:

B = enclosure width
 B1 = B + 79 mm, overall width
 B2 = B - 42 mm, clearance between the front frames
 B3 = B - 5 mm, front panel width

Height dimensions:

H = enclosure height
 H1 = H + 79 mm, overall height
 H2 = H - 42 mm, clearance between the front frames
 H3 = H - 5 mm, front panel height

Depth dimensions:

T = enclosure depth

1.4

Command Panel

The right frame, even for deeper operator panels.

On request, the compact enclosure AE can be equipped with a stylish VIP 6000 frame mounted on the rear panel. The large AE door provides easy access for servicing.

Material and surface finish:

Enclosure and door:
 Sheet steel, dipcoat-primed and powder-coated in textured RAL 7035
 Front plate:
 3 mm aluminium, natural-anodised
 Frame section:
 Aluminium, powder-coated in RAL 7035
 Frame corner pieces:
 Die-cast zinc, powder-coated in RAL 7035

Protection category:

IP 56 to EN 60 529/09.2000, complies with NEMA 12.

Supply includes:

Enclosure with integral roof or base reinforcement and connection for support arm system CP-L or CP-XL or CP-Q. Aluminium front plate and front frame supplied loose, door at rear.

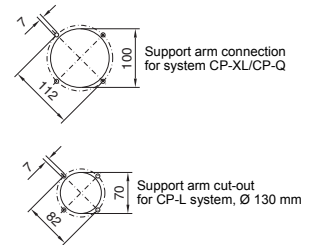

Command Panel with wide VIP 6000 frame in the dimensions of compact enclosures AE or in individual dimensions	Basic Model No. CP	Design code number	
	6541.009		
Support arm connection for support arm system			
Without	6541.009	0	
CP-XL or CP-Q top	6541.009	1	
CP-XL or CP-Q bottom	6541.009	2	
CP-L, Ø 130 mm, top	6541.009	3	
CP-L, Ø 130 mm, bottom	6541.009	4	
Cable tube connection			
Without	6541.009	X	0
Bottom	6541.009	X	1
Dimensions			
Individual sizes mm	6541.009	X	X W x H x D:
Like compact enclosure AE (see page 128)	6541.009	X	X Model No. AE:
Lock systems			
Standard double-bit lock insert may be exchanged for 27 mm lock inserts, type A, lock cylinder, plastic handles and T-handles, type B, see page 954 – 957.			

Order example 6541.009 **4 1** W x H x D: 537 x 352 x 350 mm (or e.g. AE 1050.600)

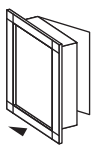

Order example

Model No. CP 6541.009

Design code numbers:

- Support arm connection CP-L, Ø 130 mm, bottom (4)
- Cable tube connection at the bottom (1)
- Individual dimensions:
 W x H x D: 537 x 352 x 350 mm

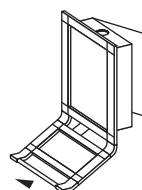

Additional mounting of a VIP 6000 keyboard housing is possible via the design code number (see page 223).

The front panel width refers to an enclosure width B - 54 mm and is achieved via a frame connector, which is included with the supply of the keyboard housing.



Different viewing angles of the machine, tall or short operating staff, sitting or standing – with the support arm systems from Rittal, the interaction between monitoring and operating is achieved to perfection.

Four different systems are used, depending on the system configuration, jib length and enclosure weight.

Load capacity CP-S steel/stainless steel

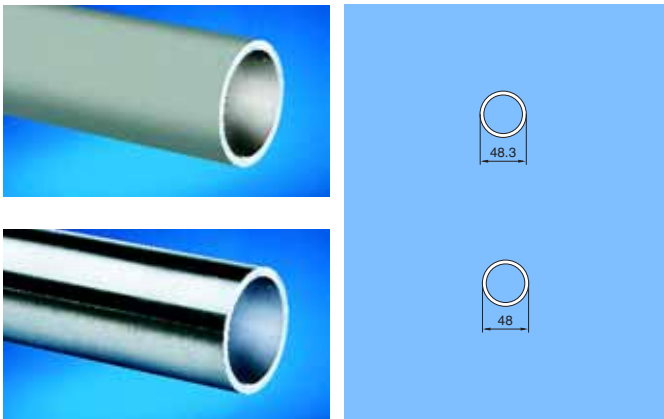

Support arm system CP-S, see page 313.

When using CP-S in conjunction with CP-L (in the horizontal development of the system), the CP-L load diagram applies.

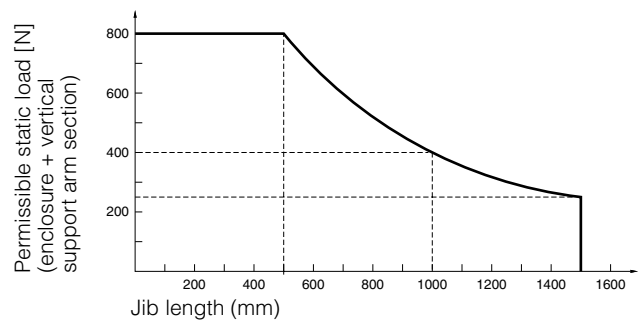

Load capacity CP-L

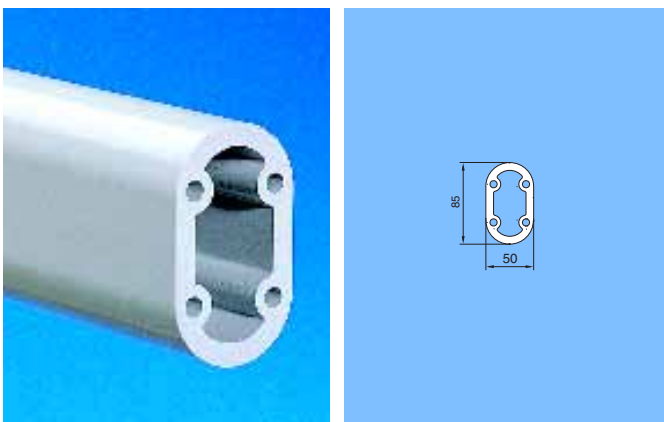

- 1 System assembly without intermediate hinge
- 2 System assembly with one intermediate hinge
- 3 System assembly with one intermediate hinge and one top-mounted/wall-mounted joint

Permissible load depending on system assembly
Intermediate hinge CP 6523.0X0 should only be used once per system!

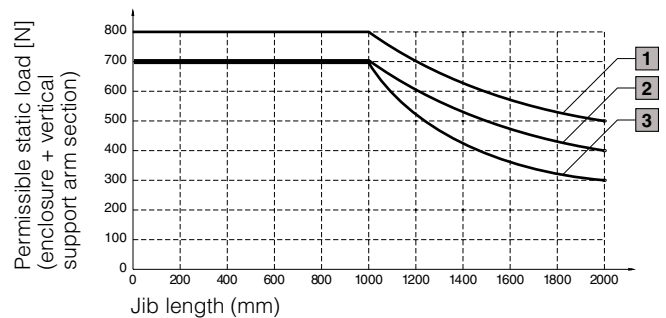

Support arm systems

Features

Load capacity CP-XL

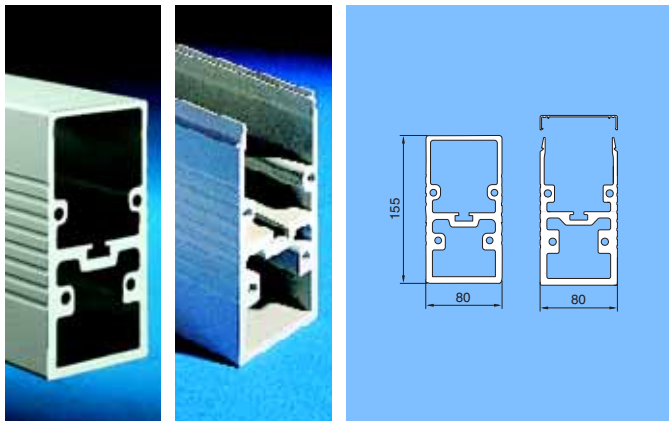

- 1 Open and solid support section without intermediate hinge
- 2 Solid support section with one intermediate hinge
- 3 Open support section with one intermediate hinge

Permissible load depending on system assembly
Intermediate hinge CP 6120.000 should only be used once per system!

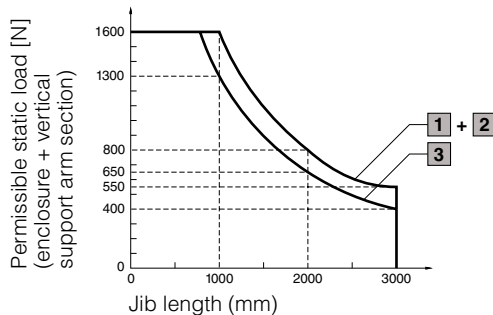

Load capacity CP-Q

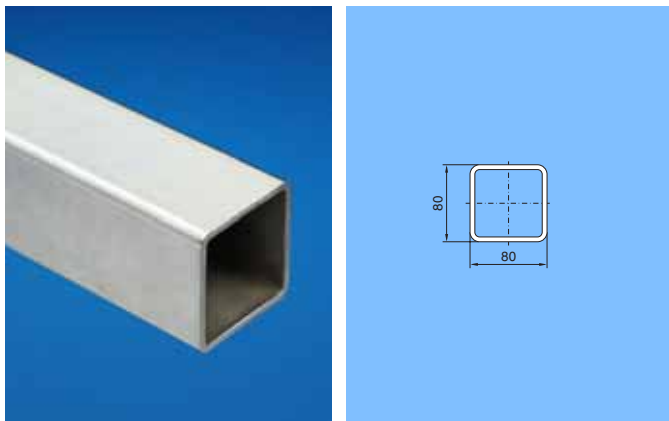

- 1 Without intermediate hinge
- 2 With one intermediate hinge

Permissible load depending on system assembly
Intermediate hinge CP 6080.140 should only be used once per system!

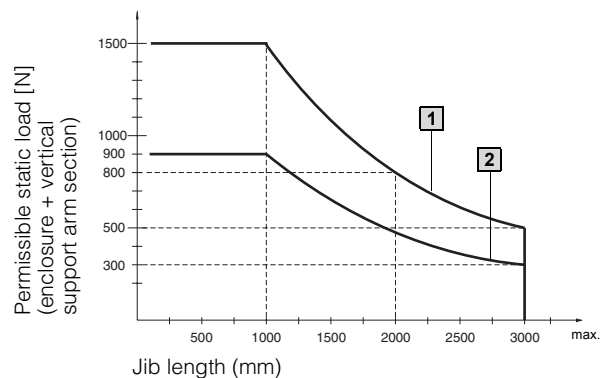

CP-S steel and stainless steel

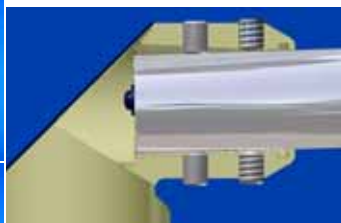
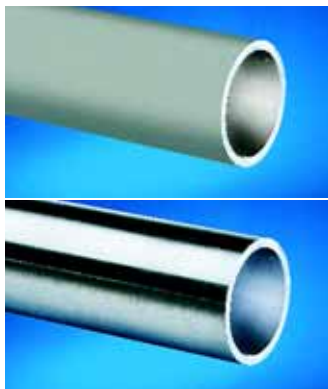

The angle coupling and angle piece, wall-mounted and top-mounted joint of the system from steel have an integral adjustment facility.

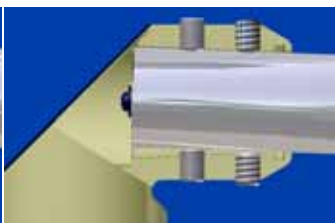

In this way, deviations in the horizontal of up to $\pm 2.5^\circ$ can be compensated in a flash.



The enclosures are easily located on the enclosure coupling of the stainless steel system with a pre-assembled screw.



Angle adaptor 90°

The ideal connection of the CP-S and CP-L systems.

Due to the differing requirements and slightly deviating attachment types, the support arm and enclosure should be made from the same material (steel or stainless steel).

CP-L aluminium



The alternative for the configuration of compact systems – the 90° support arm bracket.



Signal pillars may be mounted on many connecting elements of the systems using the mounting component, see page 1129.



The height-adjustable support arm offers even better ergonomics.



Angle adaptor 90°

The ideal connection of the CP-XL and CP-L systems.

CP-XL aluminium

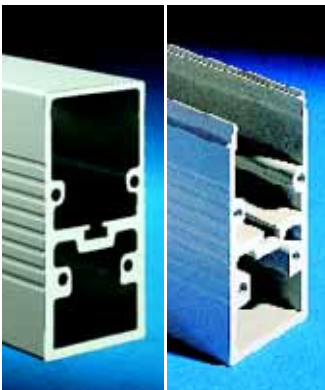

With quadruple screw-fastening, the system offers a particularly high level of safety.



Two ducts allow the control cable and supply voltage to be separated.



A stable base point for the system – the custom-produced pillar, see page 295.

CP-Q steel



The support arm system has adjustment options if 4 clamping screws are used.



Removable panel for problem-free cable entry.



Concertina section with zip for easy access during assembly and service.

Support arm systems

Getting from the enclosure to the matching support arm components

The diagrams show how the connection points of the Rittal enclosures may be continued with support arm systems, either directly or via adaptors.

There is a choice of four support arm systems, depending on your design, load and cabling requirements.

tiltable or rotatable components

System end

CP-S steel
For small and lightweight enclosures.

CP-S stainless steel
For use where there are special requirements in terms of corrosion and hygiene.

CP-L
The system for average command panel weights, stylish lines, and outstanding solution diversity.

CP-XL
The system for extreme loads. Also with open cable duct for super-easy cable entry.

CP-Q
The square alternative to the CP-L and CP-XL support arm systems.

Support arm systems

1.4

	Enclosure	Continuation with support arm system
CP-S steel		CP-S steel: 1.1 see page 242 CP-L: 1.6 see page 250

CP-S stainless steel		CP-S stainless steel: 1.1 see page 313 – 316
-----------------------------	--	--

CP-L Ø 130 mm		CP-L: 1.1 see page 250
		CP-L: 1.2 see page 250
		CP-XL: 1.3, 1.4 see page 268
		CP-Q: 1.2, 1.3 see page 280

	Enclosure	Continuation with support arm system
CP-L 120 x 65 mm		CP-L: 1.4 see page 250
		CP-S steel: 1.2 see page 242
		CP-L: 1.6 see page 250

CP-XL		CP-XL: 1.1 see page 268
		CP-XL: 1.2 see page 268 CP-Q: 1.2, 1.3 see page 280
		CP-L: 1.3, 1.4 see page 250

VESA 75		CP-S: 1.3 see page 242 CP-L: 1.6 see page 250
----------------	--	--

Make a simple sketch showing the basic form of the support arm. Next, select the corresponding support arm components. Start with **1** system start by selecting the appropriate enclosure situation.

▶ Continue with CP-S according to the item numbers.

▶ System changes are indicated by the colour.

▶ Green = CP-L

System continuation/system end:



all directions



vertical



horizontal



angled



tiltable or



rotatable components



From position **3** enclosure attachments, a support section is required between each component (minimum length approx. 100 mm, for wall/floor mounting approx. 160 mm).

T Support sections

T1 Support section CP-S

$A_{min.} = 100 \text{ mm}$

$A_{max.} = 2000 \text{ mm}$

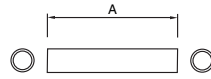

A mm	RAL 9006 Model No. CP
500	6501.010
1000	6501.030
as per specifications	6501.340 ¹⁾

See page 243.

¹⁾ Delivery times available on request.

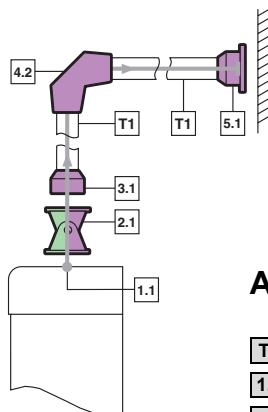

Assembly example:

- T1** Support section CP-S
- 1.1** Mounting cut-out CP-S
- 2.1** Tilting enclosure attachment, top mounting
- 3.1** Enclosure attachment CP-S
- 4.2** Angle piece 90° CP-S
- 5.1** Wall/base mounting CP-S

Note:

After any given support section, the 90° angle adaptor CP-L to CP-S may be used as a transition to the CP-L system.



Load diagram,
see page 237.

Support arm system CP-S steel

Fast selection

1 System start

Enclosure with mounting cut-out

<p>1.1 Mounting cut-out CP-S see page 240</p> 	<p>▶ 2.1 3.1 3.2 3.4</p>
<p>1.2 Mounting cut-out CP-L, 120 x 65 mm see page 240</p> 	<p>▶ 2.1 3.3</p>
<p>1.3 Mounting cut-out VESA 75 see page 240</p> 	<p>▶ 2.1</p>

3 Enclosure attachments

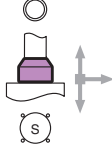
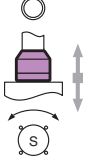
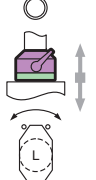
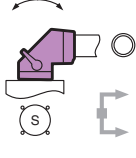
<p>3.1 CP-S attachment CP-S CP 6501.070 (RAL 7024) see page 244</p> 	<p>▶ 4.1 4.2 5.1 5.2 5.3</p>
<p>3.2 Housing coupling, round CP-S CP 6501.050 (RAL 7024) see page 245</p> 	
<p>3.3 Housing coupling CP-S, for support arm connection CP-L 120 x 65 mm CP 6501.130 (RAL 7024) see page 245</p> 	
<p>3.4 Angle coupling 90° CP-S CP 6501.120 (RAL 7024) see page 246</p> 	<p>▶ 5.1 5.2 5.3</p>

4 Angle components

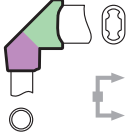
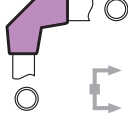
<p>4.1 Angle adaptor 90° CP-L to CP-S CP 6501.090 (RAL 7024) see page 264</p> 	<p>▶ CP-L s. p. 250</p>
<p>4.2 Angle piece 90° CP-S CP 6501.140 (RAL 7024) see page 247</p> 	<p>▶ 5.1 5.2 5.3</p>

5 System end

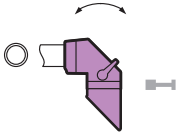
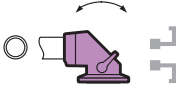
<p>5.1 Wall/base mounting CP-S CP 6501.110 (RAL 7024) see page 248</p> 	<p>▶</p>
<p>5.2 Wall-mounted hinge CP-S CP 6501.150 (RAL 7024) see page 249</p> 	<p>▶</p>
<p>5.3 Top-mounted joint CP-S CP 6501.160 (RAL 7024) see page 248</p> 	<p>▶</p>

2 Tilting adaptor

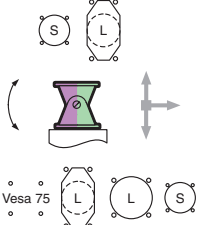
<p>2.1 Enclosure attachment, tilting, top mounting¹⁾ IW 6902.670 (RAL 7024) see page 243</p> 	<p>▶ 3.1 3.2 3.4 ▶ CP-L 2.4 s. p. 251</p>
--	---

¹⁾ May also be used rotated through 180°, e. g. from CP-L 120 x 65 mm or CP-S to CP-L Ø 130 mm.



Support section CP-S

Attached to the connection components with 2 clamping screws.

Dimensions:

External diameter: 48.3 mm
Wall thickness: 4.0 mm

Material:

Steel conduit, powder-coated

Colour:

RAL 9006

Note:

Bent support sections available on request.

A mm	Weight kg	Model No. CP
500	2.1	6501.010
1000	4.2	6501.030
To specifications A =	4.2 kg/m	6501.340 ¹⁾

¹⁾ Delivery times available on request.

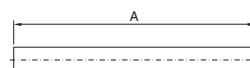

A_{min.} = 100 mm

A_{max.} = 2000 mm



Enclosure attachment, tilting, top mounting

For mounting on:

- IW worktop, prepared for enclosure attachment CP-L, Ø 130 mm, see page 184
- Surfaces
- Enclosure attachment/coupling CP-L □ 120 x 65 mm, see page 260/262
- Attachment/housing coupling CP-S (may also be used as tilting adaptor +100°/-60° for CP-S), see page 244/245.

To fit enclosures up to 20 kg with support arm connection:

- CP-S
- CP-L, □ 120 x 65 mm
- CP-L Ø 130 mm
- VESA Standard 75.

With cable tube for protected cable entry.

Tilt angle:

+100°/-60°, adjustable in 7.2° increments via clamping lever and may be limited to +100°/-15° using the stop screw supplied loose.

Colour RAL	Weight kg	Model No. IW
7024	0.8	6902.670

Material:

Sheet steel, spray-finished

Supply includes:

Assembly parts and plastic concertina section.



Accessories:

IW worktops prepared for enclosure attachment, see page 184.



View A

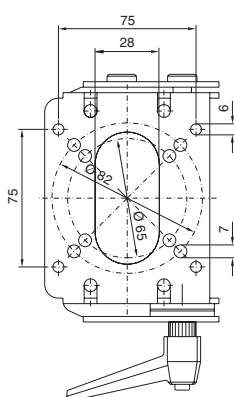

B

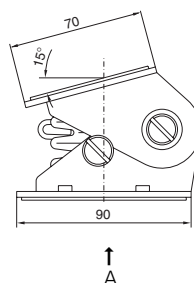

A

View B

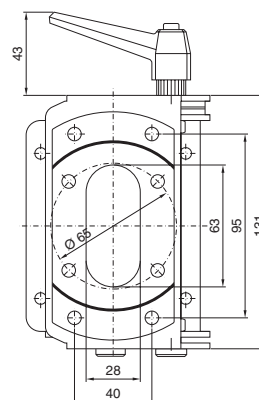

Support arm system CP-S

Steel

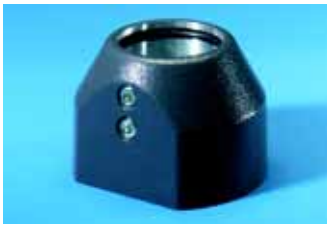

CP-S attachment

For rigid attachment of the
 ● enclosure to the support section,
 ● support arm to flat surfaces, rear¹⁾.
 With two drilling patterns for
 a) Rittal Command Panels
 b) Complete Control Panels

Material:

Die-cast zinc

Supply includes:

Seal and 2 clamping screws for support section CP-S.

Colour RAL	Weight kg	Model No. CP
7024	1.0	6501.070

¹⁾Maximum load 400 N

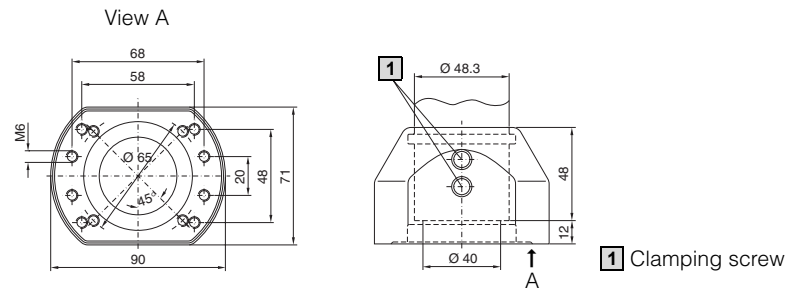

Mounting cut-outs

a)

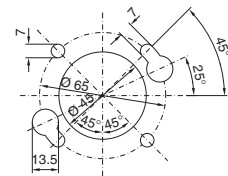

b)

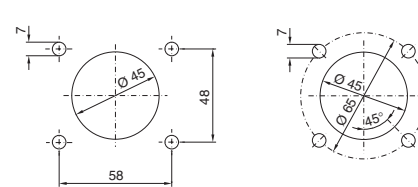



Enclosure coupling CP-S

for support arm connection CP-S, round

For swivel mounting of the enclosure on the vertical section of the support arm system.

- With two drilling patterns for
 a) Rittal Command Panels
 b) Complete Control Panels

Rotation range:

Approx. 305°, lockable via clamping lever.
 By inserting additional tension pins 4 x 16 mm to ISO 8752 the rotation range may be limited to ±7°, 44°, 104°, 142°.

Colour RAL	Weight kg	Model No. CP
7024	1.1	6501.050

Material:

Die-cast zinc

Supply includes:

Seal, 2 clamping screws for support section CP-S and clamping lever.

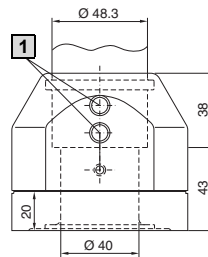
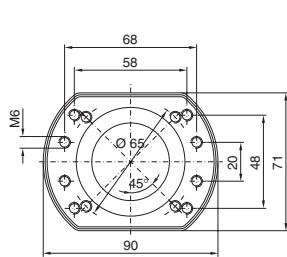

1 Clamping screw

Mounting cut-outs

a)

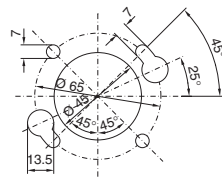

b)

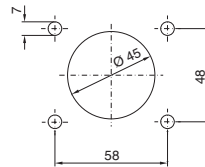

Like cut-out a), but with lock holes

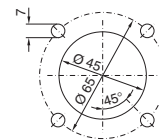

Enclosure coupling CP-S

for support arm connection CP-L, 120 x 65 mm

For swivel mounting of the enclosure on the vertical section of the support arm system.

For mounting on:

- Comfort Panel standard dimensions CP 6371.000 – .020
 CP 6371.120 – .170
 CP 6371.220 – .240
 (see page 194)
- Optipanel to fit TFT monitors CP 6380.010 – .040 (see page 205)
- Optipanel W x H x D = 19" x 7 U x 100 mm CP 6380.000 (see page 205)
- Optipanel installation depth 50 mm, with rear support arm connection (see page 209)
- Compact Panel CP 6340.X10 (see page 231).

Colour RAL	Weight kg	Model No. CP
7024	1.5	6501.130

Rotation range:

Approx. 305°, lockable via clamping levers.
 By inserting additional tension pins 4 x 16 mm to ISO 8752 the rotation range may be limited to ±7°, 44°, 104°, 142°.

Material:

Die-cast zinc

Supply includes:

Seals, 2 locking screws.

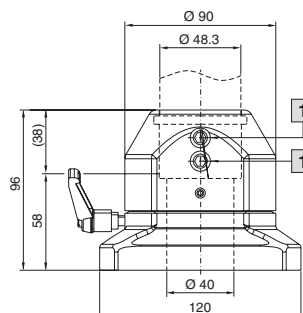

1 Locking screw

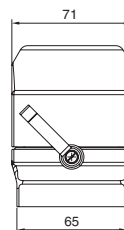

Mounting cut-out, enclosure

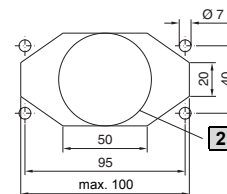

2 Alternative max. Ø 55 mm

Support arm system CP-S

Steel

1.4 B Support arm system CP-S

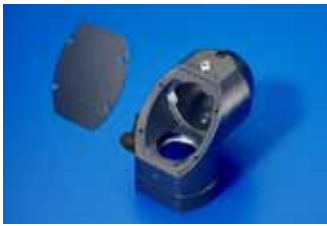

Angle coupling 90° CP-S

For swivel fastening of the enclosure to the horizontal support arm system.

- Enclosure top-mounted or suspended
- Adjustment option of the support arm system (see page 238)
- Removable panel for problem-free cable entry

Rotation range:

Approx. 305°, lockable via clamping levers. By inserting additional tension pins 4 x 16 mm to ISO 8752 the rotation range may be limited to ±7°, 44°, 104°, 142°.

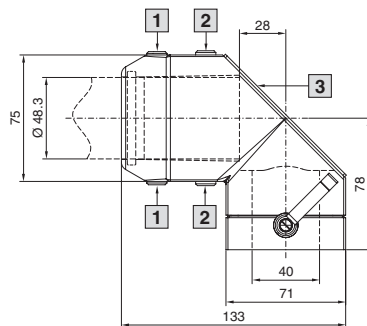

- 1** Locking screw
- 2** Adjusting screw
- 3** Removable plate

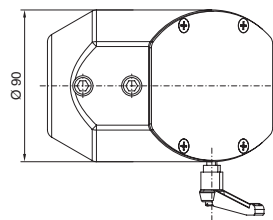

Colour RAL	Weight kg	Model No. CP
7024	1.6	6501.120

Material:

Cast aluminium/die-cast zinc

Supply includes:

Seals, 2 locking screws and 2 adjusting screws.

Possible mounting cut-outs of enclosures

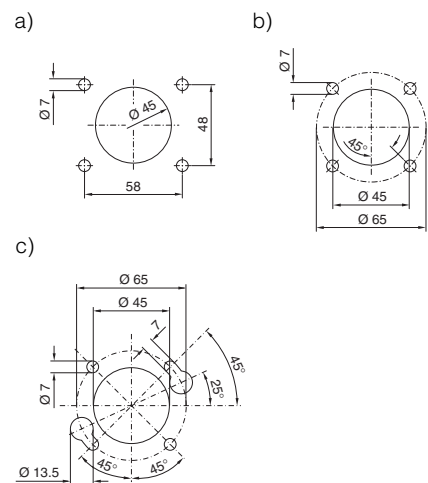

Version c) for quick/one-man assembly



Angle adaptor 90° CP-L to CP-S

see page 264.

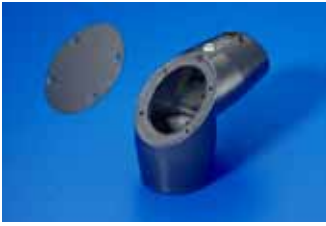

Angle piece 90°CP-S

For connecting horizontal and vertical support arm components.

- Adjustment option of the support arm system (see page 238)
- Removable panel for problem-free cable entry

Material:

Cast aluminium

Supply includes:

Seals, 4 locking screws and 2 adjusting screws.

Colour RAL	Weight kg	Model No. CP
7024	1.1	6501.140



Accessories:

Mounting component for signal pillars (SZ 2375.030), see page 1129.

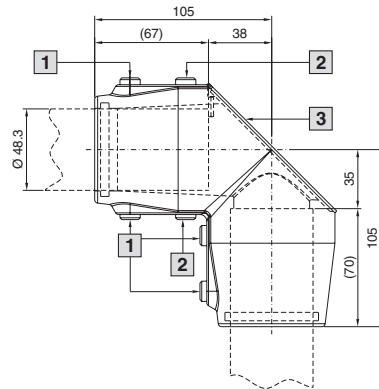

- 1** Locking screw
- 2** Adjusting screw
- 3** Removable plate

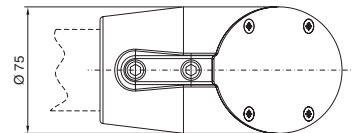

Mounting components

for support arm systems

For mounting a signal pillar, see page 1129.

Support arm system CP-S

Steel



Wall/base mounting CP-S

For rigid attachment of the support section to surfaces. With flange for front mounting.

Material:

Cast aluminium

Supply includes:

Seal, 2 clamping screws for support section CP-S and 3 pre-fitted adjusting screws.

Colour RAL	Weight kg	Model No. CP
7024	0.7	6501.110

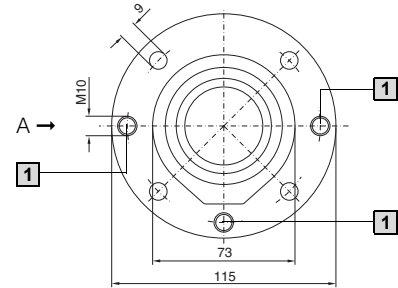

1 Adjusting screw

View A

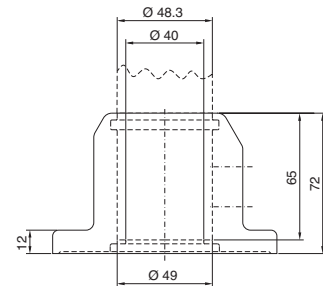

Mounting cut-out

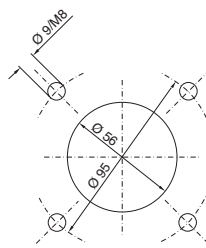

Top-mounted joint CP-S

For swivel mounting of the support arm system to horizontal surfaces.

- Enclosure top-mounted or suspended
- Adjustment option of the support arm system (see page 238)
- Removable panel for problem-free cable entry

Rotation range:

Approx. 300°. By inserting additional pins 6 x 20 mm to ISO 8752 the rotation range may be limited to ±6°, 51°, 96°. To lock the joint, the screw may be exchanged for standard clamping lever M6 x 25 mm.

Colour RAL	Weight kg	Model No. CP
7024	1.8	6501.160

Material:

Cast aluminium

Supply includes:

Seals, 2 locking screws and 2 adjusting screws.

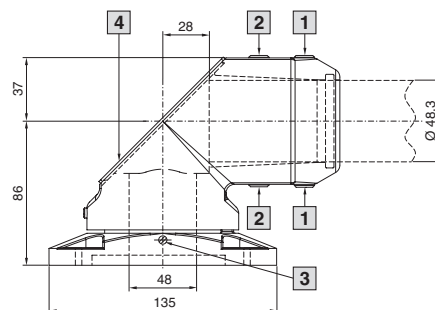

Mounting cut-out

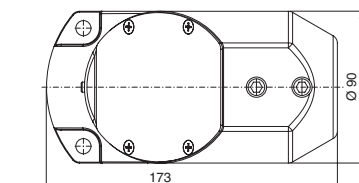
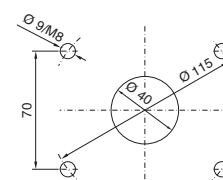

- 1 Locking screw
- 2 Adjusting screw
- 3 Screw for adjusting rotatability
- 4 Removable plate



Wall-mounted hinge CP-S

For vertically hinged mounting of the support arm on vertical surfaces.

- Machined keyhole as mirror image for support arm outlet at the top or bottom for easy one-man assembly.
 - Pre-mount the screws on a vertical surface
 - Locate the wall-mounted hinge (support arm system pre-mounted)
 - Tighten the screws
- Adjustment option of the support arm system (see page 238)
- Removable panel for problem-free cable entry

Rotation range:

Approx. 300°. By inserting additional pins 6 x 20 mm to ISO 8752 the rotation range may be limited to ±6°, 51°, 96°. To lock the joint, the screw may be exchanged for standard clamping lever M6 x 25 mm.

Colour RAL	Weight kg	Model No. CP
7024	2.2	6501.150

Material:

Cast aluminium

Supply includes:

Seals, 2 locking screws and 2 adjusting screws.

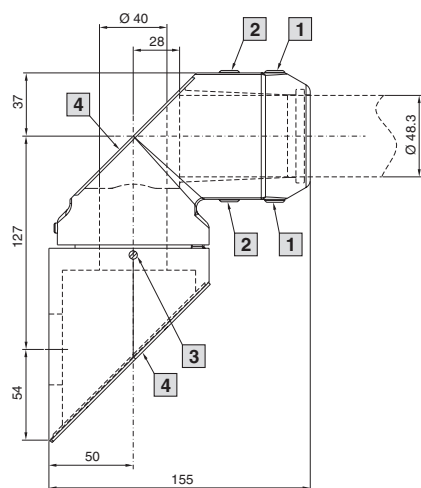

- 1** Locking screw
- 2** Adjusting screw
- 3** Screw for adjusting rotatability
- 4** Removable plate

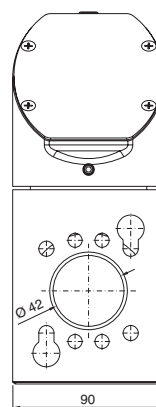

Mounting cut-out 90°

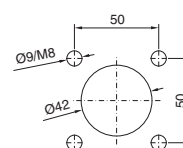

Support arm system CP-L

Fast selection

Make a simple sketch showing the basic form of the support arm. Next, select the corresponding support arm components. Start with **1** system start by selecting the appropriate enclosure situation.

▶ Continue with CP-L according to the item numbers.

System changes are indicated by the colour.

▶ Violet = CP-S

▶ Blue = CP-XL

System continuation/system end:

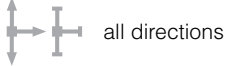

all directions

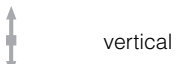

vertical

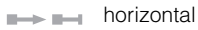

horizontal



angled

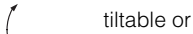

tiltable or



rotatable components

From position **3** enclosure attachments, a support section is required between each component (minimum length approx. 100 mm, for wall/floor mounting approx. 160 mm). The cross-sections indicate the installation position(s).

X = 0 (RAL 7030)

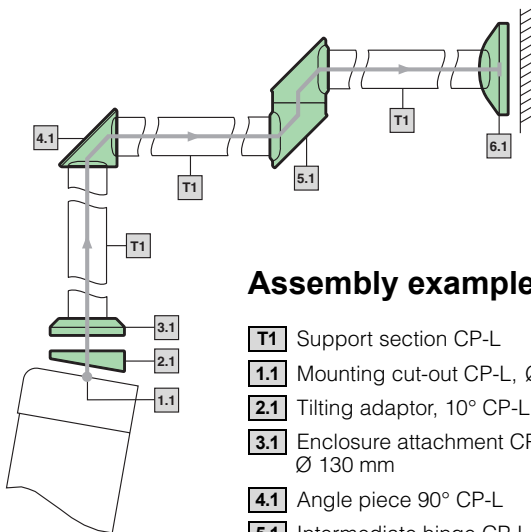

Assembly example:

- T1** Support section CP-L
- 1.1** Mounting cut-out CP-L, Ø 130 mm
- 2.1** Tilting adaptor, 10° CP-L, Ø 130 mm
- 3.1** Enclosure attachment CP-L, Ø 130 mm
- 4.1** Angle piece 90° CP-L
- 5.1** Intermediate hinge CP-L
- 6.1** Wall/base mounting CP-L

T Support sections

T1 Support section CP-L

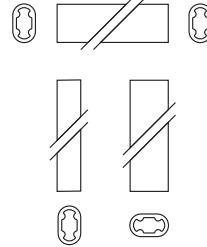

Length mm	Colour RAL	Model No. CP
250	7035	6509.000
500	7035	6511.000
1000	7035	6513.000
2000	7035	6515.000
250	9006	6509.010
500	9006	6511.010
1000	9006	6513.010
2000	9006	6515.010

See page 254

T2 Support arm CP-L, height-adjustable

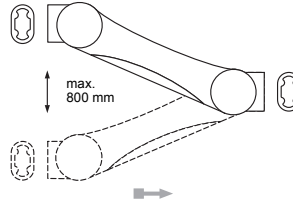

Colour: RAL 7024/9006

Weight range kg	Length mm	Model No. CP
10 – 20	962	6510.210
19 – 30	958	6510.310

See page 252

T3 Support arm bracket 90°, CP-L

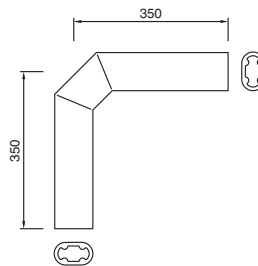

Colour RAL	Model No. CP
7035	6519.000
9006	6519.010

See page 254

1 System start

Enclosure with mounting cut-out

1.1 Mounting cut-out CP-L, Ø 130 mm 	<p>▶</p> <p>2.1</p> <p>2.2</p> <p>2.4</p> <p>3.1</p> <p>3.2</p> <p>3.3</p>
1.2 Connection plate for support arm CP-L CP 6528.2X0 , see page 259 	
1.3 Connection adaptor CP-L to CP-XL CP 6528.0X0 , see page 258 	

1.4 Mounting cut-out CP-L, 120 x 65 mm 	<p>▶</p> <p>2.3</p> <p>2.4</p> <p>3.4</p> <p>3.5</p> <p>3.6</p> <p>▶</p> <p>CP-S</p> <p>3.3</p> <p>s. p. 242</p>
---	--

1.5 Connection console CP-L 120 x 65 mm A CP 6508.0X0 on Optipanel support plate B CP 6508.100 Other enclosures with mounting cut-out C for connection console see page 261 	<p>▶</p> <p>2.3</p> <p>2.4</p> <p>3.4</p> <p>3.5</p> <p>3.6</p> <p>▶</p> <p>CP-S</p> <p>3.3</p> <p>s. p. 242</p>
1.6 Mounting cut-out VESA 75 see page 240 	<p>▶</p> <p>2.4</p>

2 Tilting adaptor

<p>2.1 Tilting adaptor 10° CP-L, Ø 130 mm CP 6527.0X0, see page 255</p>	<p>3.1 3.2 3.3</p>
<p>2.2 Tilting adaptor +/- 45° CP-L, Ø 130 mm CP 6529.0X0, see page 255</p>	

<p>2.3 Tilting adaptor, 10° CP-L, 120 x 65 mm CP 6527.1X0, see page 256</p>	<p>3.4 3.5 3.6</p>
<p>2.4 Enclosure attachment, tilting, top mounting¹⁾ CP 6902.670 (RAL 7024), see page 243</p>	<p>3.4 3.5</p> <p>CP-S s. p. 241 242</p>

¹⁾ May also be used rotated through 180°, e. g. from CP-L 120 x 65 mm or CP-S to CP-L Ø 130 mm.

²⁾ Via T3 support arm bracket 90° CP-L.

3 Enclosure attachments

<p>3.1 Enclosure attachment CP-L, Ø 130 mm CP 6525.5X0, see page 256</p>	<p>4.1 4.2 4.3 6.1 6.2 6.3 6.4</p>
<p>3.2 Housing coupling CP-L, Ø 130 mm CP 6525.0X0, see page 262</p>	<p>4.1 4.3 6.1 6.2 6.3²⁾ 6.4²⁾</p>
<p>3.3 Angle coupling 90° CP-L, Ø 130 mm CP 6526.0X0, see page 263</p>	<p>4.1 5.1 6.1 6.2 6.3 6.4</p>
<p>3.4 Enclosure attachment CP-L, 120 x 65 mm CP 6525.6X0, see page 257</p>	<p>4.1 4.2 4.3 6.1 6.2 6.3²⁾ 6.4²⁾</p>
<p>3.5 Housing coupling CP-L, 120 x 65 mm CP 6525.1X0, see page 262</p>	<p>4.1 4.3 6.1 6.2 6.3²⁾ 6.4²⁾</p>
<p>3.6 Enclosure attachment CP-L, 120 x 65 mm, locatable CP 6525.2X0, see page 260</p>	<p>4.1 4.2 4.3 6.1 6.2</p>

5 Intermediate hinge

<p>5.1 Intermediate hinge CP-L CP 6523.0X0, see page 265</p>	<p>6.1 6.2</p>
---	--------------------

4 Angle components

<p>4.1 Angle piece 90° CP-L CP 6524.0X0, see page 263</p>	<p>5.1 6.1 6.2 6.3 6.4</p>
<p>4.2 Articulated joint 90° CP-L CP 6524.2X0, see page 264</p>	
<p>4.3 Angle adaptor 90° CP-L to CP-S CP 6528.100, see page 264</p>	<p>CP-XL s. p. 268</p>

6 System end

<p>6.1 Wall/base mounting, small, CP-L CP 6520.5X0, see page 265</p>	
<p>6.2 Wall/base mounting, large, CP-L CP 6520.0X0, see page 266</p>	
<p>6.3 Top-mounted joint CP-L CP 6522.0X0, see page 266</p>	
<p>6.4 Wall-mounted hinge CP-L CP 6521.0X0, see page 267</p>	

Notes:

Re T2
Support arm, height adjustable should always be inserted as the first horizontal component after the enclosure.

Re 5.1 / 6.3 / 6.4
It is always expedient to use only one intermediate hinge or one wall mounted hinge.

Two joints will restrict load capacity and make positioning the Command Panel more difficult.

Load diagram,
see page 237.

Re 4.1
Two angle pieces may also be used one after the other.

Support arm system CP-L

Support arm, height adjustable



Support arm, height adjustable CP-L

Offers enhanced ergonomics thanks to:

- Adjustment range
 - for tall and short operators
 - for seated and standing work adjustable to up to 800 mm as required via an adjustment screw at the front of the support arm.
- Precise coordination of the compression spring to the enclosure weight via an adjusting screw at the rear of the support arm.
- Complete functional reliability – if the compression spring breaks, the arm will remain in position.
- Plastic casing clips off for access to the integral U-section cable tray.
- Tilting angle of the mounted enclosure is identical in every height position.

Material:

Plastic-coated steel

Supply includes:

Round tube with compression spring relief and U-section cable tray, 2 threaded connectors, plastic casing, including assembly parts.

Overall length mm	Colour RAL	Weight range kg ¹⁾	Model No. CP
962	9006	10 – 20	6510.210
958	9006	19 – 30	6510.310

¹⁾ For configured enclosure and vertical support section.

20 kg version

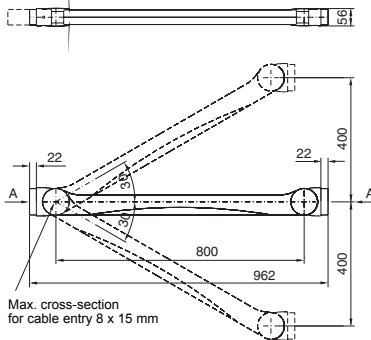

View A

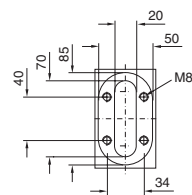

30 kg version

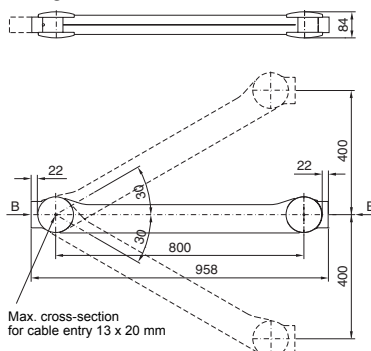

View B

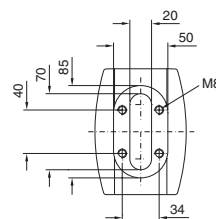

Support arm system CP-L

Support arm, height adjustable

The versatile combination options with horizontal mounting are illustrated in this diagram.

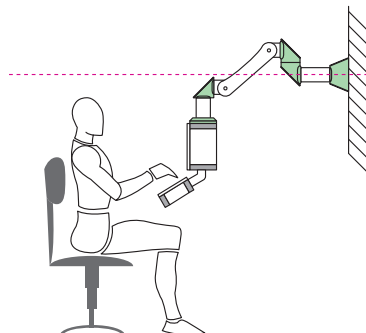
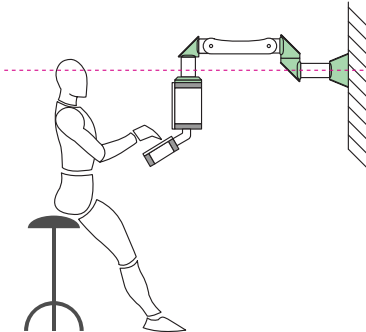
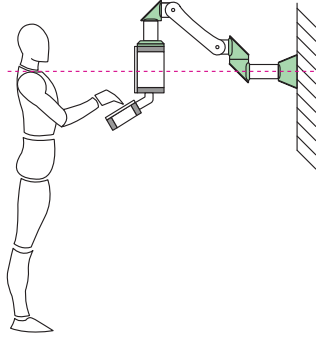

Enclosure side

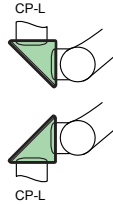

Angle piece 90° CP-L
Model No. 6524.0X0¹⁾,
see page 263.

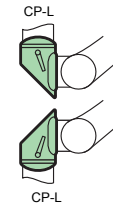

Angle piece 90° CP-L
Model No. 6524.2X0¹⁾,
see page 264.

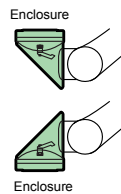

Angle coupling 90° CP-L
for support arm connection
Ø 130 mm
Model No. 6526.0X0¹⁾,
see page 263.



Enclosure attachment CP-L
for support arm connection
Ø 130 mm
Model No. 6525.5X0¹⁾,
enclosure attachment CP-L
for support arm connection
□ 120 x 65 mm
Model No. 6525.6X0¹⁾,
see page 256/257.

Enclosure with rear support arm
cut-out/reinforcement available on
request.

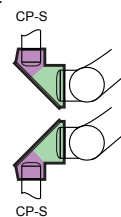

Angle adaptor 90°, CP-L to CP-S
Model No. 6501.090 (RAL 7024),
see page 264.

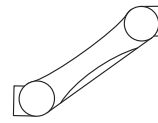

Attachment side

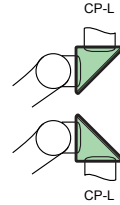

Angle piece 90° CP-L
Model No. 6524.0X0¹⁾,
see page 263.

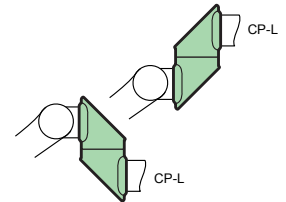

Intermediate hinge CP-L
Model No. 6523.0X0¹⁾,
see page 265.

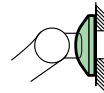

Wall/base mounting, small
CP-L
Model No. 6520.5X0¹⁾,
see page 265.

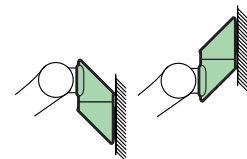

Wall-mounted hinge CP-L
Model No. 6521.0X0¹⁾,
see page 267.

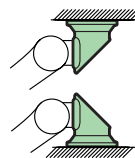

Top-mounted joint CP-L
Model No. 6522.0X0¹⁾,
see page 266.

¹⁾ Key:
X = 0 RAL 7030
X = 1 RAL 7024

B
1.4

Support arm system CP-L

Support arm system CP-L

Aluminium



Support section CP-L

Attachment to the connection components with 4 self-tapping screws in a screw channel, may be cut to any required length, no thread-tapping required.

Dimensions:
50 x 85 mm

Wall thickness:
8 mm

Material:
Extruded aluminium section

Note:
Load information,
see page 237.

German patent no. 43 31 124
French patent no. 94 10 806
Ital. patent no. 01275022
Jap. patent no. 2730621
US patent no. 5,460,894

Length (L) ¹⁾ mm	Weight kg	RAL 7035 Model No. CP	RAL 9006 Model No. CP
250	1.3	6509.000	6509.010
500	2.6	6511.000	6511.010
1000	5.1	6513.000	6513.010
2000	10.2	6515.000	6515.010

¹⁾ L min = 135 mm



Rittal service:

Support section CP-L, open with two chambers for cable entry:

- sealed, e. g. for standard cabling,
- open, with plastic cover section for easy retro-fitting of cables.

Available on request.

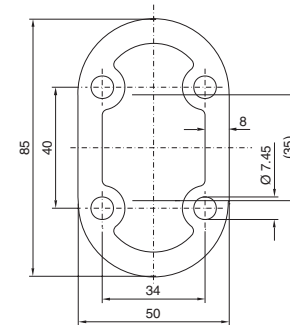
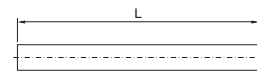

Support arm bracket 90° CP-L

The compact, welded alternative; no thread-tapping required.

Material:
Extruded aluminium section

Colour RAL	Weight kg	Model No. CP
7035	3.4	6519.000
9006	3.4	6519.010

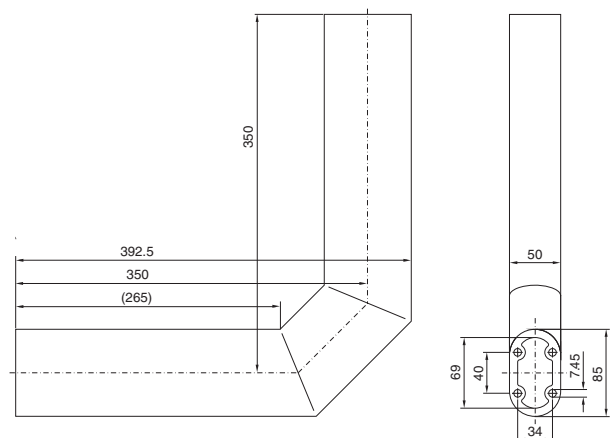

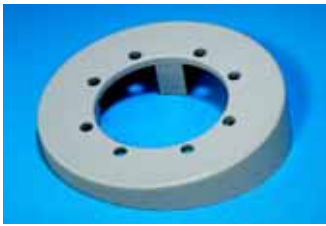

Tilting adaptor, 10° CP-L

for support arm connection Ø 130 mm

For mounting between:

- Housing coupling CP-L (CP 6525.0X0)
- or
- Enclosure attachment CP-L (CP 6525.0X0)
- or
- Angle coupling 90° CP-L (CP 6526.0X0) and the Command Panel.

Material:

Die-cast zinc

Supply includes:

Seal and assembly parts.



Colour RAL	Weight kg	Model No. CP
7030	0.6	6527.000
7024	0.6	6527.010

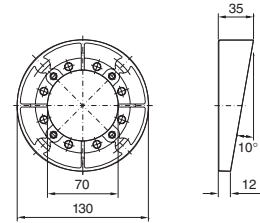

Mounting cut-out Enclosure CP-L, Ø 130 mm

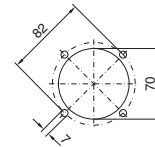

Tilting adaptor, ±45° CP-L

for support arm connection Ø 130 mm

For mounting between:

- Housing coupling CP-L (CP 6525.0X0)
- or
- Enclosure attachment CP-L (CP 6525.0X0)
- or
- Angle coupling 90° CP-L (CP 6526.0X0) and the Command Panel.

Tilting angle:

Adjustable in 7.5° increments

Material:

Cast aluminium

Supply includes:

Seal, plastic concertina section and assembly parts.

German patent no. 195 40 298

US patent no. 5,911,393



Colour RAL	Weight kg	Model No. CP
7030	1.3	6529.000
7024	1.3	6529.010

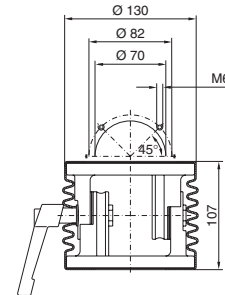

Mounting cut-out Enclosure CP-L, Ø 130 mm

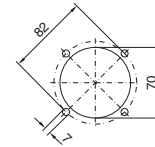

Support arm system CP-L

Aluminium

1.4 Support arm system CP-L



Tilting adaptor, 10°CP-L

for support arm connection $\square 120 \times 65$ mm

For mounting between:

- Housing coupling CP-L (CP 6525.1X0)
- or
- Enclosure attachment CP-L (CP 6525.6X0)
- or
- Housing coupling CP-S (CP 6501.130) and the Command Panel.

Material:

Die-cast zinc

Supply includes:

Seal and assembly parts.



Colour RAL	Weight kg	Model No. CP
7030	0.4	6527.100
7024	0.4	6527.110

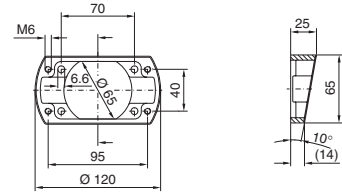

Mounting cut-out
Enclosure CP-L $\square 120 \times 65$ mm

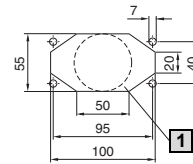

1 Alternative max. $\varnothing 55$ mm



Enclosure attachment, tilting

Assembly,
see page 243.

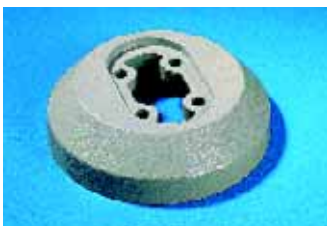

Enclosure attachment CP-L

for support arm connection $\varnothing 130$ mm

For rigid fastening of the enclosure to the support arm system.

Material:

Die-cast zinc

Supply includes:

Seals and self-tapping screws for CP-L support section attachment.



Colour RAL	Weight kg	Model No. CP
7030	1.0	6525.500
7024	1.0	6525.510

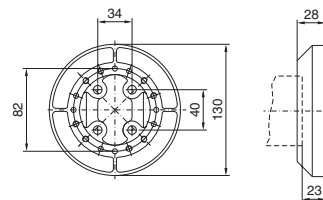

Mounting cut-out
Enclosure CP-L, $\varnothing 130$ mm

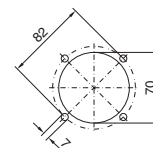



Enclosure attachment CP-L

for support arm connection □ 120 x 65 mm

For rigid fastening of the enclosure to the support arm system.

Material:

Die-cast zinc

Supply includes:

Seals and self-tapping screws for CP-L support section attachment.

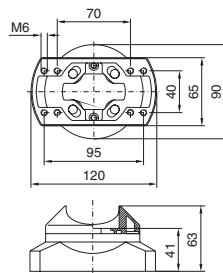

Colour RAL	Weight kg	Model No. CP
7030	1.0	6525.600
7024	1.0	6525.610

+ Accessories:

Connection console CP-L, CP-L, see page 261.

Mounting cut-out
Enclosure CP-L □ 120 x 65 mm

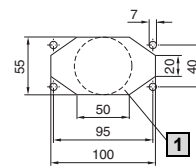

1 Alternative max. Ø 55 mm



Enclosure attachment, tilting, base mounting

CP-L □ 120 x 65 mm

For mounting beneath:

- IW worktop with pedestal
- Sufficiently large surfaces.

Fits enclosures with mounting cut-out:

- CP-L □ 120 x 65 mm (e. g. Optipanel, see page 205, Comfort Panel, see page 194).

With mounting cut-out for connector grommet for sealed cable entry.

Tilt angle:

+40°/-40°, lockable via clamping lever

Material:

Sheet steel, spray-finished

Supply includes:

Assembly parts

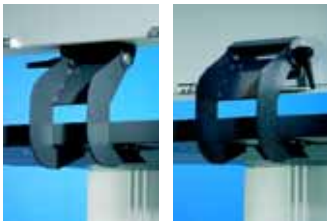

Colour RAL	Weight kg	Model No. IW
7024	1.6	6902.640

Note:

The enclosure attachment can be mounted either on the support arm connection of the Optipanel enclosure or on the underside or rear of any enclosure.

+ Accessories:

Connector gland, see page 1057.
IW worktop, see page 184.
Pedestal, see page 290.

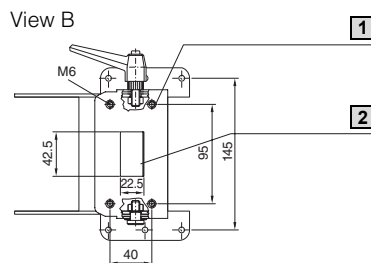

1 Prepared for enclosure with connection CP-L/CP-S, □ 120 x 65 mm or connection console CP-L CP 6508.0X0

2 Preparation for connector grommet SZ 2400.300/SZ 2400.500

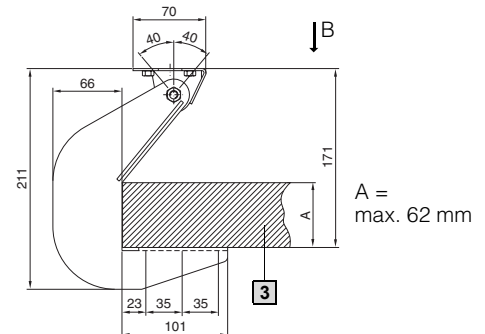

3 Worktop, e.g. IW 6902.310/IW 6902.320

Support arm system CP-L

Aluminium



Connection adaptor CP-L on CP-XL or CP-L on CP-Q

for mounting between:

- Enclosure with support arm connection CP-L and
- Support arm system CP-XL or CP-Q.

May also be used for the attachment of command panels with cut-out for CP-L directly to machines and systems without a support arm. The mounting cut-out CP-XL or CP-Q should be provided there.

Assembly sequence:

- Mount the connection adaptor on the supporting structure
- Mount the enclosure and tighten the screws

The seal to the supporting structure is available on request, if required.

Material:

Cast aluminium

Supply includes:

Seal and assembly parts.



Height mm	Colour RAL	Weight kg	Model No. CP
20 ¹⁾	7030	0.6	6528.000
20 ¹⁾	7024	0.6	6528.010
55 ²⁾	7030	0.7	6528.500
55 ²⁾	7024	0.7	6528.510

¹⁾ If the load permits, also suitable for mounting between enclosure with support arm connection CP-XL or CP-Q and support arm system CP-L Ø 130 mm.

²⁾ For Command Panel VIP 6000, see page 213, 3.1. Operating housing, design code number 1 to 5.

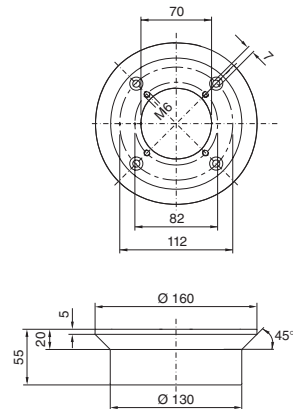
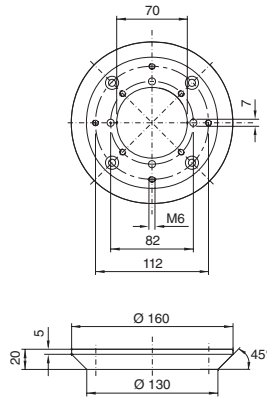

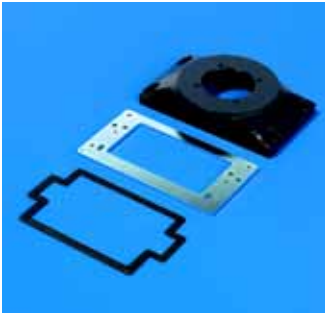

Connection plate CP-L

With reinforcement plate

- For easy location of the Command Panel onto the support arm or pedestal.
- Easily screw-fastened from the outside after drilling 4 holes \varnothing 7 mm.
- More space for cable entry plus clamping bracket.

For mounting:

- Comfort Panel¹⁾
 - VIP 6000²⁾
 - Optipanel³⁾
 - Sheet steel Command Panel⁴⁾
- on:

Support arm system components	CP-L
Enclosure attachment	CP 6525.5X0
Housing coupling	CP 6525.0X0
Angle coupling	CP 6526.0X0
Tilting adaptor 10°	CP 6527.0X0
Tilting adaptor +/- 45°	CP 6529.0X0

- 1** Pre-install screws, locate the enclosure, tighten the screws, and it's done!



Mounting cut-out CP-L

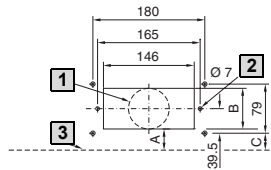

- 1** Alternative \varnothing B
2 \varnothing 6 mm only with metal enclosures for securing the reinforcement plate
3 Outer edge of enclosure at the rear

	Installation depth mm	A	B	C
Comfort Panel	152/308	28.9	77.9	30.5
	191 – 464	43.1	82.5	48.1
VIP 6000	155 – 185	32.5	81	30.5
	295 – 438	174.5	81	173
Optipanel	150	34	65.5	28
Metal enclosure	–	1)	86	1)

¹⁾ Make the drilled holes/cut-out in the centre of the enclosure reinforcement plate.

With support arm connection	Colour RAL	Weight kg	Model No. CP
CP-L	7030	0.7	6528.200
CP-L	7024	0.7	6528.210

Note:

The square support arm cut-out can be prepared on request.

Material:

Connection plate: Cast aluminium
 Reinforcement plate: Sheet steel 6 mm

Supply includes:

Seals and assembly parts.

¹⁾ From a front panel width 247 mm and installation depth 152 mm.

²⁾ From a front panel width of 265 mm.

³⁾ From a front panel width of 220 mm and installation depth of 150 mm.

⁴⁾ Mounting surface, minimum W x D = 300 mm x 135 mm (e.g. Command Panel housing with door).

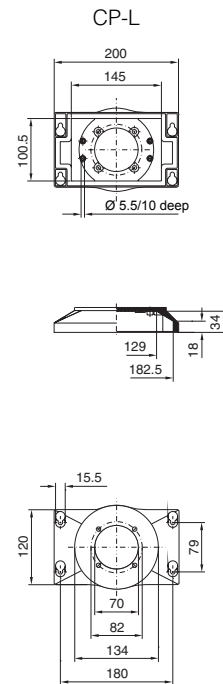

Support arm system CP-L

Aluminium



Enclosure attachment locatable CP-L

for support arm connection \square 120 x 65 mm

For rigid fastening of the enclosure to the support section.

With "machined keyholes" for easy, secure mounting by just one person:

- Screw the enclosure attachment to the support arm.
- Secure the supporting plate to the inside of the enclosure and pre-fit two screws from the outside.
- Locate the enclosure and tighten the screws.

For enclosures from a depth of 70 mm.

Material:

Enclosure attachment: Die-cast zinc
Support plate: Sheet steel

Supply includes:

Seal, support plate and assembly parts.



Colour RAL	Weight kg	Model No. CP
7030	0.4	6525.200
7024	0.4	6525.210



Also required:

Articulated joint 90° CP-L, see page 264.

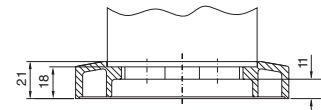
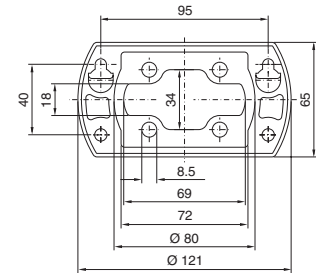

Mounting cut-out
Enclosure \square 120 x 65 mm

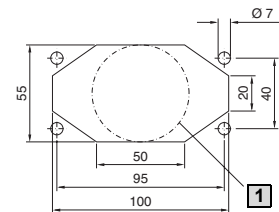

1 Alternative max. \varnothing 55 mm



Connection console CP-L

For rear connection of slimline operating housings. Removable lid for simple cable entry.

Material:

Cast aluminium

Supply includes:

Seals and assembly parts for mounting on the enclosure and 2 cable ties.

Mounting options:

1. Optipanel

Retro-fitting:

- Cut-out in rear panel/door
 - With support plate CP 6508.100 (see page 262) directly screw-fastened to extrusion (see Fig. A)
- Selection via design code number (see page 209, item 2.3, selection 7 or 8):
Connection console and support plate are fitted.



Fig. A Optipanel



Fig. B General

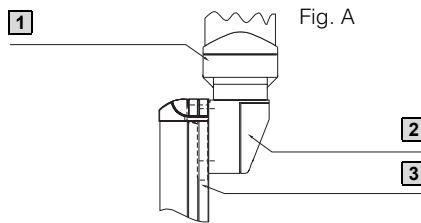

2. General

e.g.

- Terminal boxes (see page 116),
- Cast aluminium enclosures (see page 114)

the connection console may be mounted
a) directly, flush with enclosure edge (see Fig. B top),
b) in the centre with spacer plate CP 6508.200 (available on request) (see Fig. B bottom), to the rear panel of the enclosure. Additional reinforcement of the rear panel should be checked in individual cases.

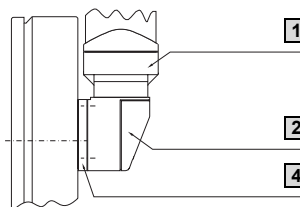
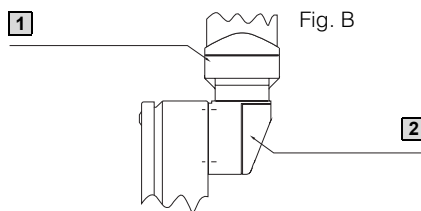

Colour RAL	Weight kg	Model No. CP
7030	0.7	6508.000
7024	0.7	6508.010



Also required:

Enclosure attachment CP 6525.6X0), see page 257.
Housing coupling (CP 6525.1X0), see page 262.
Tilting adaptor 10° (CP 6527.1X0), see page 256.
Housing coupling CP-S (CP 6501.130), see page 245.



Accessories:

Spacer plate (CP 6508.200), available on request.
Support plate Optipanel CP 6508.100, see page 262.

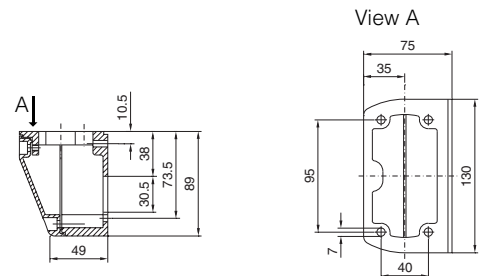

Mounting cut-out

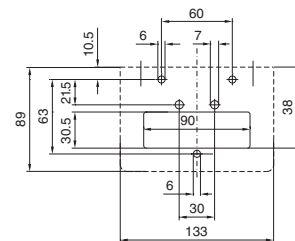

- 1 Support arm component CP-L □ 120 x 65 mm
- 2 Connection console CP-L
- 3 Support plate (inside)
- 4 Spacer plate

Support arm system CP-L

Aluminium



Optipanel support plate

For mounting on the enclosure section. The rear panel or door are recessed in this area, thereby ensuring easy access in case of servicing.

Material:
Cast aluminium

Supply includes:
Seals and assembly parts.

Weight kg	Model No. CP
0.2	6508.100



Housing coupling CP-L

for support arm connection Ø 130 mm

For swivel mounting of the enclosure on the vertical section of the support arm system.

Rotation range:
Approx. 310°, lockable via clamping levers. By inserting additional tension pins 5 x 18 mm to ISO 8752 the rotation range may be limited to ±5°, 65°, 95° and 155°.

Material:
Die-cast zinc

Supply includes:
Seals and self-tapping screws for CP-L support section attachment.

Colour RAL	Weight kg	Model No. CP
7030	1.7	6525.000
7024	1.7	6525.010

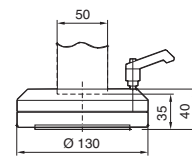

Mounting cut-out
Enclosure CP-L, Ø 130 mm

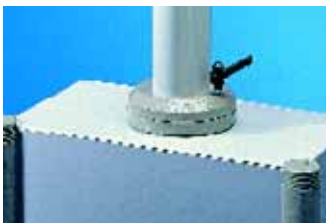
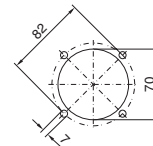

Housing coupling CP-L

for support arm connection 120 x 65 mm

For swivel mounting of the enclosure on the vertical section of the support arm system.

Rotation range:
Approx. 350°, lockable via clamping levers. By inserting additional tension pins 6 x 20 mm to ISO 8752 the rotation range may be limited to ±5° and ±100°.

Material:
Die-cast zinc

Supply includes:
Seals and self-tapping screws for CP-L support section attachment.

Colour RAL	Weight kg	Model No. CP
7030	1.4	6525.100
7024	1.4	6525.110

⊕ Accessories:

Connection console CP-L (CP 6508.0X0), siehe Seite 261.



Mounting cut-out
Enclosure CP-L 120 x 65 mm

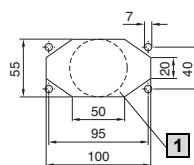

1 Alternative max. Ø 55 mm

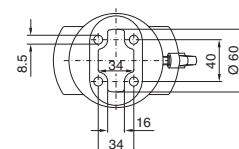
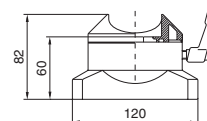
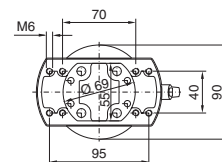

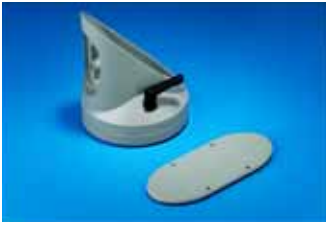

Angle coupling 90° CP-L

for support arm connection Ø 130 mm

For swivel mounting of the enclosure on the horizontal part of the support arm system. Enclosure may be suspended or top-mounted. The removable plate enables problem-free cable entry.

Rotation range:

Approx. 310°.

By inserting additional tension pins 5 x 18 mm to ISO 8752 the rotation range may be limited to ±5°, 65°, 95° and 155°.

Material:

Cast aluminium/die-cast zinc

Supply includes:

Seals, adjustment set and self-tapping screws for CP-L support section attachment.



Colour RAL	Weight kg	Model No. CP
7030	1.9	6526.000
7024	1.9	6526.010

+ Accessories:

Mounting component for signal pillars (SZ 2375.000), see page 1129.

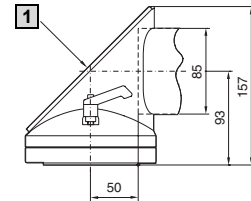

1 Removable plate

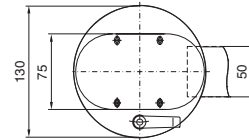

Mounting cut-out
Enclosure CP-L, Ø 130 mm

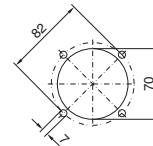

Angle piece 90° CP-L

For connecting horizontal and vertical support arm components. The removable plate ensures easier cable entry.

Material:

Die-cast zinc

Supply includes:

Seals, adjustment set and self-tapping screws for CP-L support section attachment.

German patent no. 43 31 125

French patent no. 94 10901

Italian patent no. 012 74 738

Japanese patent no. 2 809 993

US patent no. 5,533,763



Colour RAL	Weight kg	Model No. CP
7030	1.4	6524.000
7024	1.4	6524.010

+ Accessories:

Mounting component for signal pillars (SZ 2375.000), see page 1129.

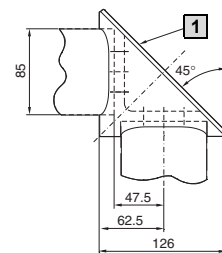

1 Removable plate
75 x 174 mm

Support arm system CP-L

Aluminium

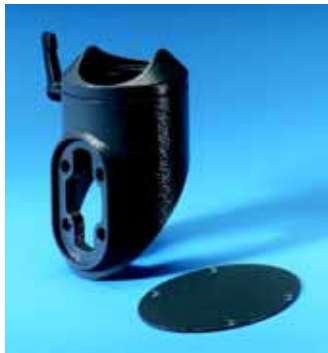

Articulated joint 90° CP-L

The swivel connection between horizontal and vertical support sections. With very slimline enclosures, there is no need for the deep housing coupling. With the shallow enclosure attachment (CP 6525.2X0), the support section may also be attached with its wide side.

Rotation range:

Approx. 325°.
Option of limiting the rotation range via the use of additional tension pins 5 x 18 mm to ISO 8752 to ±54° and ±98°.

Material:

Cast aluminium/die-cast zinc

Supply includes:

Seals, self-tapping screws for support section attachment and adjustment set.

Note:

May only be top-mounted/suspended on the enclosure side.

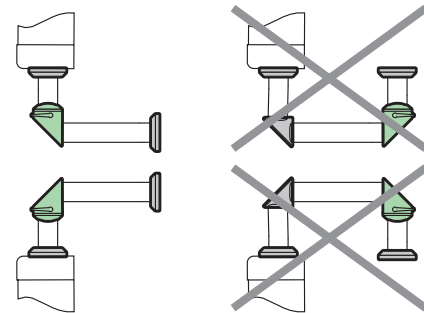

Colour RAL	Weight kg	Model No. CP
7030	1.2	6524.200
7024	1.2	6524.210



Also required:

Enclosure attachment, suspended CP-L for support arm connection □ 120 x 65 mm (CP 6525.2X0), see page 260,
or enclosure attachment CP-L for support arm connection □ 120 x 65 mm (CP 6525.6X0), see page 257.

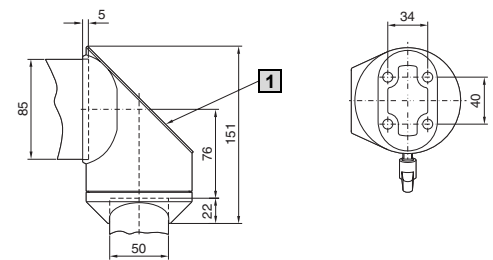

1 Removable plate

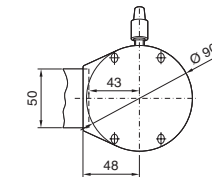

Angle adaptor 90°

Connection component between:
• small and larger support arm systems.
Outlet optionally at the top or bottom if this configuration is chosen for static or visual reasons. The removable cover ensures easier cable entry.

Material:

Cast aluminium

Supply includes:

Seal for support section attachment.



CP 6501.090

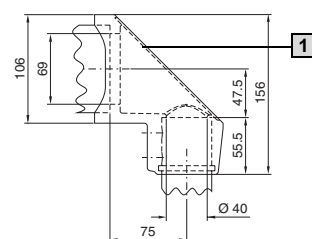

1 Removable plate
71 x 149 mm

2 Removable cover

	Colour RAL	Weight kg	Model No. CP
CP-L to CP-S	7024	1.0	6501.090
CP-XL to CP-L	7024	1.7	6528.110¹⁾
CP-XL to CP-L	7030	1.7	6528.100

¹⁾ Extended delivery times.

CP 6528.100

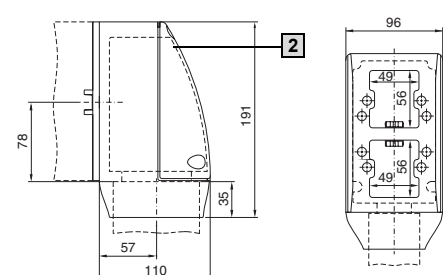

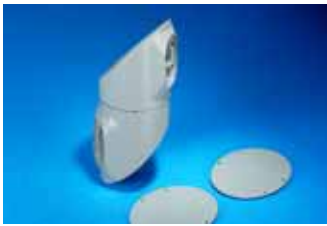

Intermediate hinge CP-L

For vertically hinged connection of horizontal support sections within the support arm system. The removable plates ensure simple cable entry.

Rotation range:

Approx. 315°.
Option of restricting the rotation range in 60° increments with the screws supplied loose.

Material:

Cast aluminium

Supply includes:

Seals, adjustment set and self-tapping screws for CP-L support section attachment.

German patent no. 44 03 593

French patent no. 94 10902

Italian patent no. 01274751

Japanese patent no. 2 675 264

US patent no. 5,522,118

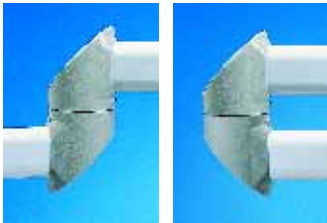

Colour RAL	Weight kg	Model No. CP
7030	3.2	6523.000
7024	3.2	6523.010

+ **Accessories:**

Mounting component for signal pillars (SZ 2375.020), see page 1129.

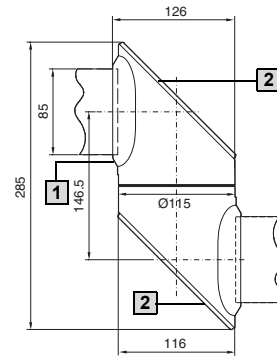

1 Screw for adjusting rotatability

2 Removable plate



Wall/base mounting bracket, small, CP-L

For rigid attachment of the support arm system to vertical or horizontal surfaces.

Particularly suitable for the configuration of compact support arm systems with cable infeed from the inside.

Material:

Cast aluminium

Supply includes:

Seals, adjustment set for support section and self-tapping screws for CP-L support section attachment.



Colour RAL	Weight kg	Model No. CP
7030	0.6	6520.500
7024	0.6	6520.510

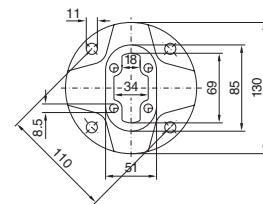
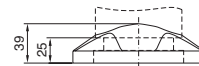

Mounting cut-out

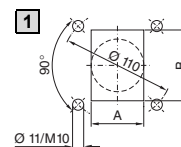

1 Alternative Ø 52 mm
A = max. 52 mm
B = max. 70 mm

Support arm system CP-L

Aluminium



Wall/base mounting, large CP-L

For rigid attachment of the support arm system to vertical or horizontal surfaces with cable infeed from the inside.

Material:

Cast aluminium

Supply includes:

Seals, opportunity for adjustment with grub screws and self-tapping screws supplied loose for CP-L support section attachment.



Mounting cut-out

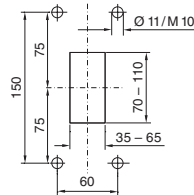

Colour RAL	Weight kg	Model No. CP
7030	1.9	6520.000
7024	1.9	6520.010

+ Accessories:

Pillar, see page 295.

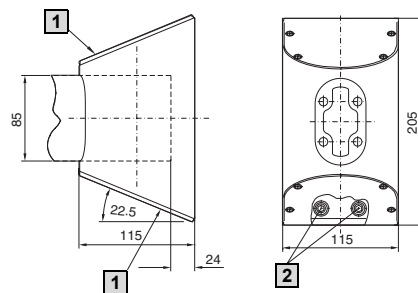

- 1 Removable plate
- 2 Adjusting screws

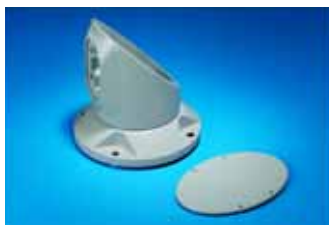

Top-mounted joint CP-L

For swivel mounting of the support arm system on horizontal surfaces – also suitable for suspending from the ceiling. The removable plate enables simplified cable entry.

Rotation range:

Approx. 315°.

Option of restricting the rotation range in 60° increments and adjusting the mobility of the joint with the screws supplied loose. To lock the joint, the screw may be exchanged for standard clamping lever M8 x 16.

Material:

Cast aluminium

Supply includes:

Seals, adjustment set and self-tapping screws for CP-L support section attachment.

Note:

Not suitable for the suspension of enclosures.



Mounting cut-out

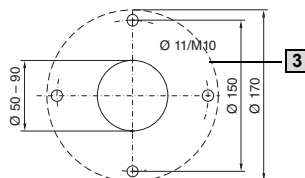

Colour RAL	Weight kg	Model No. CP
7030	3.0	6522.000
7024	3.0	6522.010

+ Accessories:

Pillar, see page 295.
Mounting component for signal pillars (SZ 2375.020), see page 1129.

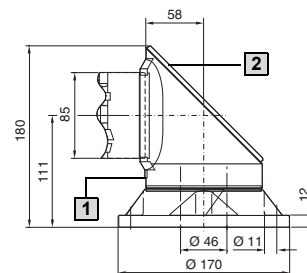

- 1 Screw for adjusting rotatability
- 2 Removable plate
- 3 Mounting surface



Wall-mounted hinge CP-L

For vertically hinged mounting of the support arm surface on vertical surfaces. The removable plates facilitate problem-free cable routing or cable entry.

Rotation range:

Approx. 315°.

Option of restricting the rotation range in 60° increments and adjusting the mobility of the joint with the screws supplied loose. To lock the joint, the screw may be exchanged for standard clamping lever M8 x 16.

Material:

Cast aluminium

Supply includes:

Seals, adjustment via grub screws, adjusting screws and self-tapping screws for CP-L support section attachment.

German patent no. 44 03 593

French patent no. 94 10902

Italian patent no. 01274751

Japanese patent no. 2 675 264

US patent no. 5,522,118

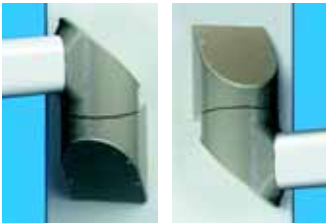

Colour RAL	Weight kg	Model No. CP
7030	3.2	6521.000
7024	3.2	6521.010



Accessories:

Pillar, see page 295.

Mounting component for signal pillars (SZ 2375.020), see page 1129.

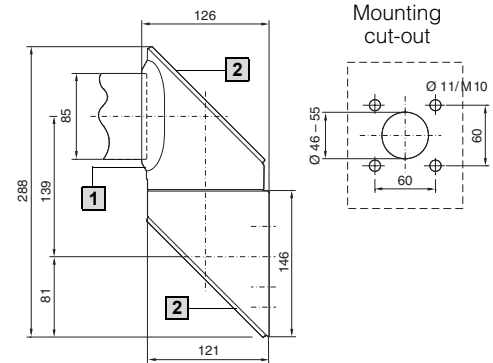

1 Screw for adjusting rotatability

2 Removable plate



Mounting components

for support arm systems

For external mounting of a signal pillar, see page 1129.

Support arm system CP-XL

Fast selection

Make a simple sketch showing the basic form of the support arm. Next, select the corresponding support arm components. Start with **1** system start by selecting the appropriate enclosure situation.

Support arm system CP-XL

1.4

▶ Continue with CP-XL according to the item numbers.

System continuation/system end:

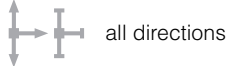

all directions



vertical

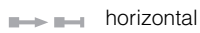

horizontal



angled



rotatable components



From position **3** enclosure attachments, a support section is required between each component (minimum length approx. 100 mm, for wall/floor mounting approx. 160 mm). The cross-sections indicate the installation position(s).



X = 0 (RAL 7030)

X = 1 (RAL 7024)

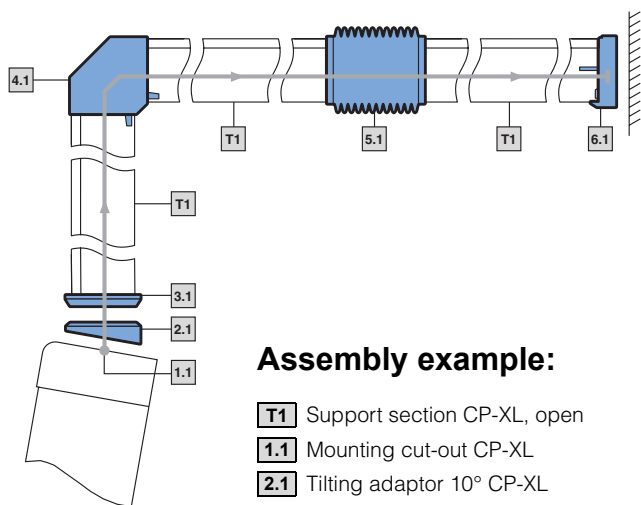

Assembly example:

- T1** Support section CP-XL, open
- 1.1** Mounting cut-out CP-XL
- 2.1** Tilting adaptor 10° CP-XL
- 3.1** Enclosure attachment CP-XL, round
- 4.1** Angle piece 90° CP-XL, outlet at bottom
- 5.1** Intermediate hinge CP-XL
- 6.1** Wall/base mounting CP-XL

T Support sections

T1 Support section CP-XL, open

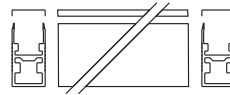

Length mm	Colour RAL	Model No. CP
500	7035	6050.000
1000	7035	6100.000
2000	7035	6200.000

See page 270

T2 Support arm CP-XL, solid

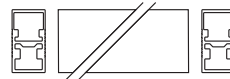

Length mm	Colour RAL	Model No. CP
500	7035	6050.500
1000	7035	6100.500
2000	7035	6200.500

See page 270

1 System start

Enclosure with mounting cut-out

1.1 Mounting cut-out CP-XL



▶
2.1
3.1
3.2
3.3
3.4
3.5

1.2 Connection adaptor CP-L to CP-XL

CP 6528.0X0 see page 258

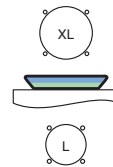

1.3 Connection adaptor CP-L to CP-XL

for VIP 6000 enclosures with installation depths 155, 185 and 295 mm

CP 6528.5X0 see page 258

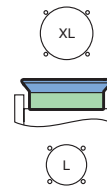

1.4 Connection plate with reinforcement plate

CP 6528.420 (width 200 mm)
CP 6528.430 (width 418 mm)

see page 274



▶
2.1
3.1
3.2
3.3
3.4

Note:

- Only insert one intermediate hinge
- Two angle pieces may also be used one after the other
- With angle pieces, take care to ensure correct positioning of the support section cable duct
- **Load diagram**, see page 237.

2 Tilting adaptor

2.1 Tilting adaptor 10° CP-XL
CP 6023.0X0 see page 271

3.1
3.3
3.4

3 Enclosure attachments

3.1 Enclosure attachment CP-XL, round
CP 6130.6X0 see page 271

4.1
4.2
5.1
6.1
6.2
6.3

3.2 Enclosure attachment CP-XL, rectangular
CP 6130.5X0 see page 272

3.3 Housing coupling CP-XL
CP 6130.0X0 see page 272

3.4 Angle coupling 90° CP-XL
CP 6040.0X0 see page 275

3.5 Housing coupling for desktop mounting
CP 6528.400 (width 200 mm)
CP 6528.410 (width 418 mm)
 see page 273

4 Angle components

4.1 Angle piece 90° CP-XL, outlet at bottom
CP 6140.0X0 see page 276

5.1
6.1
6.2
6.3

4.2 Angle piece 90° CP-XL, outlet at top
CP 6180.0X0 see page 276

5 Intermediate hinge

5.1 Intermediate hinge CP-XL
CP 6120.0X0 see page 277

4.1
4.2
6.2
6.3

6 System end

6.1 Wall/base mounting CP-XL
CP 6160.0X0 see page 279

6.2 Top-mounted joint CP-XL
CP 6170.0X0 see page 278

6.3 Wall-mounted hinge CP-XL
CP 6110.0X0 see page 277

Support arm system CP-XL

Aluminium

Support arm system CP-XL

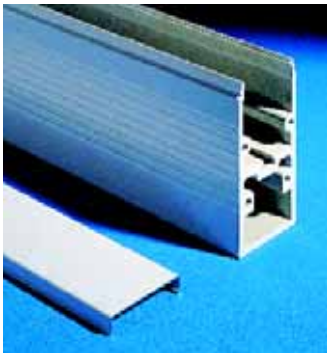

Support section CP-XL, open

Attachment to the connection components with 4 self-tapping screws in a screw channel, may be cut to any required length. With open cable duct, for easy servicing access and for pre-assembled cables with connectors; easily locked via clip-in lid.

Dimensions:

80 x 155 mm

Material:

Extruded aluminium section

Supply includes:

Clip-in lid

Length mm	Colour RAL	Weight kg	Model No. CP
500	7035	4.9	6050.000
1000	7035	9.8	6100.000
2000	7035	19.6	6200.000

Note:

Load information, see page 238.



Accessories:

Adjustment set for support section, see page 270.

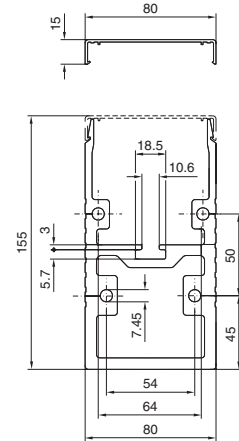

Support section CP-XL, solid

The alternative solution for higher loads and torsion compared with the CP-L support section, open.

Dimensions:

80 x 155 mm

Material:

Extruded aluminium section

Length mm	Colour RAL	Weight kg	Model No. CP
500	7035	5.5	6050.500
1000	7035	11.0	6100.500
2000	7035	22.0	6200.500

Note:

Load information, see page 238.



Accessories:

Adjustment set for support section, see page 270.

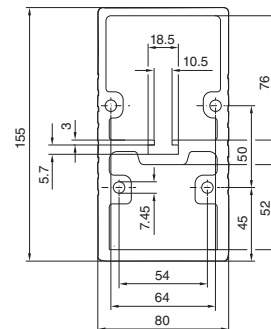

Adjustment set for support section CP-XL

The adjustment set also supports retrospective alignment of the CP support section.

Material:

Sheet steel 1.0 mm, zinc-plated, passivated.

Packs of	Model No. CP
10	6205.000



Connection adaptor CP-L to CP-XL

see page 258.



Tilting adaptor 10° CP-XL

For mounting between:

- Housing coupling (CP 6130.0X0)
- or
- Enclosure attachment (CP 6130.6X0)
- or
- Angle coupling (CP 6040.0X0) and the command panel.

Material:

Die-cast zinc

Supply includes:

Seals and assembly parts.

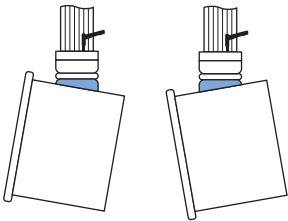

Colour RAL	Weight kg	Model No. CP
7030	1.4	6023.000
7024	1.4	6023.010 ¹⁾

¹⁾ Extended delivery times.

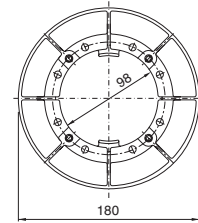
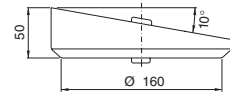

Mounting cut-out enclosure CP-XL

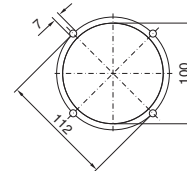

Enclosure attachment CP-XL, round

For rigid external mounting of enclosures to:

- Support section
- Tilting adaptor 10° (CP 6023.0X0)

Material:

Die-cast zinc

Supply includes:

Seals and self-tapping screws for CP-XL support section attachment.

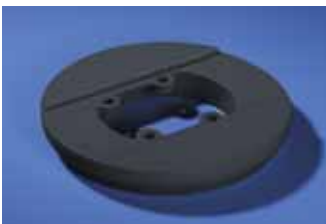

Colour RAL	Weight kg	Model No. CP
7030	1.6	6130.600
7024	1.6	6130.610

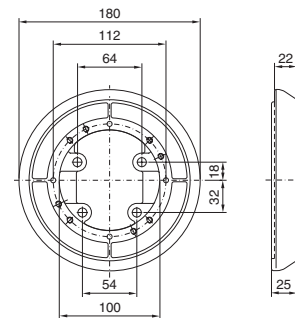

Support arm system CP-XL

Aluminium

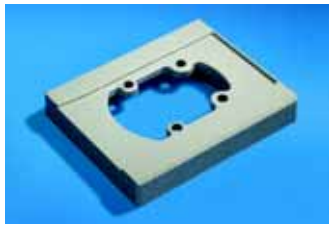

Enclosure attachment CP-XL, rectangular

For rigid external mounting on the enclosure.

Material:
Die-cast zinc

Supply includes:
Seal and self-tapping screws for CP-XL support section attachment.

Colour RAL	Weight kg	Model No. CP
7030	1.2	6130.500
7024	1.2	6130.510 ¹⁾

¹⁾ Extended delivery times.

Mounting cut-out enclosure CP-XL

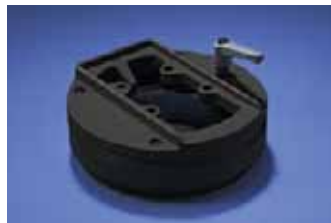
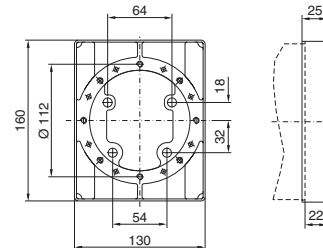
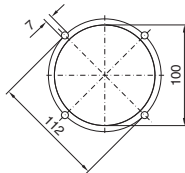

Housing coupling CP-XL

For swivel mounting of the enclosure on the vertical section of the support arm system.

Rotation range:
Approx. 350°

Material:
Die-cast zinc

Supply includes:
Seals and self-tapping screws for CP-XL support section attachment.

Note:
By inserting pins 5 x 12 to DIN EN ISO 8741, the rotation range may be limited in 90° increments.

Colour RAL	Weight kg	Model No. CP
7030	6.8	6130.000
7024	6.8	6130.010

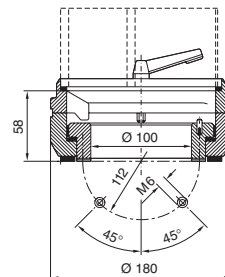

Mounting cut-out enclosure CP-XL

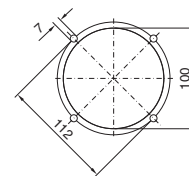

Adaptor with connector cut-out 24-pole

For partitioning between the command panel and support arm or stand system.

To fit:

- Housing coupling for desktop mounting
CP 6528.400 (W = 200 mm)
CP 6528.410 (W = 418 mm)
- Connection plates CP-XL with reinforcement plate
CP 6528.420 (W = 200 mm)
CP 6528.430 (W = 418 mm)

Material:
Sheet steel, zinc-plated, passivated

Supply includes:
Seal and assembly parts.

Packs of	Model No. SZ
1	2477.010

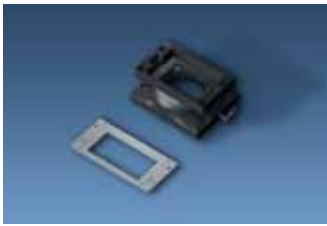

Housing couplings CP-XL

for desktop mounting

The stable, rotating connection with extra space for cable routing.
Design width = 418 mm for additional stability of the roof and base with heavy installed equipment.

For mounting

- Command Panels from an installation depth of 150 mm

on

- IW worktops
- Horizontal surfaces (floors or ceilings)

Attachment

- Of the Command Panel: one-man assembly via machined keyholes
- On surfaces: via external screws with cover

Rotation range:

Max. 350°, lockable via clamping levers.
By using additional M6 cheese-head screws, the rotation range may be limited to $\pm 28^\circ$, $\pm 73^\circ$, $\pm 118^\circ$, $\pm 163^\circ$.

Material:

Housing coupling: Cast aluminium/die-cast zinc
Reinforcement plate: Sheet steel, 6 mm

Surface finish:

Housing coupling:
Powder-coated in textured RAL 7024
Reinforcement plate:
Sheet steel, zinc-plated, passivated

Supply includes:

Reinforcement plate, seals and assembly parts.



Design	VIP 6000	Opti-panel	Comfort Panel	Weight kg	Model No. CP
W = 200 mm	222 ¹⁾	244 ¹⁾	247 ¹⁾	3.4	6528.400
W = 418 mm	410 ¹⁾	432 ¹⁾	435 ¹⁾	4.2	6528.410

¹⁾ From front panel width mm without keyboard housing; with keyboard housing on request.

	Installation depth mm	A	B	C
Comfort Panel	152/308	28.9	77.9	30.5
	191 – 464	43.1	82.5	48.1
VIP 6000	155 – 185	32.5	81	30.5
	295 – 438	174.5	81	173
Optipanel	150	34	65.5	28
Metal enclosure	–	¹⁾	86	¹⁾

¹⁾ Make the drilled holes/cut-out in the centre of the enclosure reinforcement plate.

Accessories:

Adaptor with connector cut-out, 24-pole (SZ 2477.010), see page 272.

Note:

With the Comfort Panel, Optipanel and VIP 6000 enclosures, the rectangular support arm cut-out may be ordered and prepared using the design code:

Comfort Panel, see page 197.

Optipanel, see page 209.

VIP 6000, see page 220.

Mounting cut-out for surfaces
CP 6528.400/.410

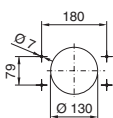

CP 6528.400

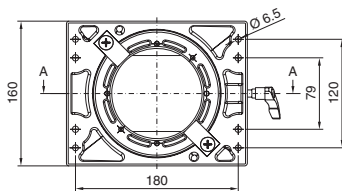

CP 6528.410

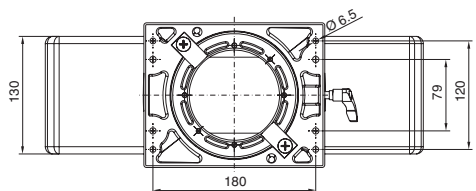

Mounting cut-out, enclosure side
CP 6528.400

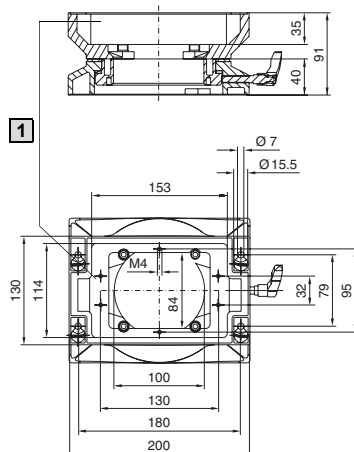
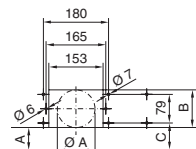

CP 6528.410

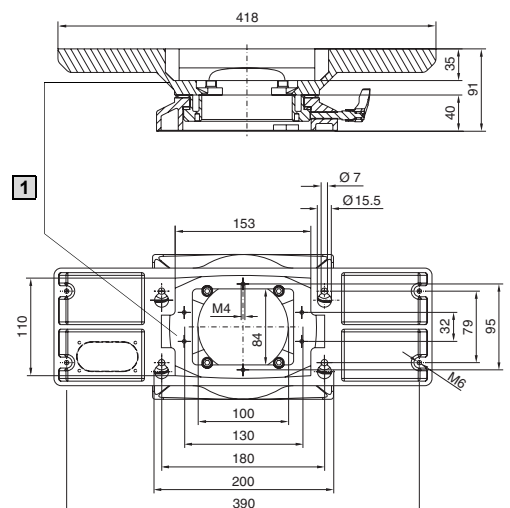
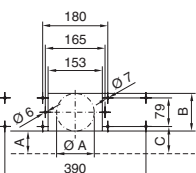

A or $\emptyset A$ is manufactured to order in the case of Optipanel, VIP 6000 and Comfort Panel.

A_{max.} = 100 mm

Rittal Catalogue 32/Industrial Enclosures

1 Space/preparation for assembly of adaptors with connector cut-out, 24-pole SZ 2477.010

Support arm system CP-XL

Aluminium

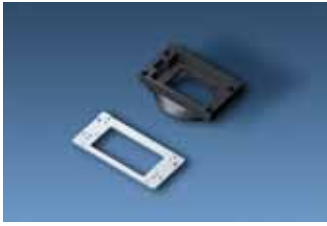

Connection plates CP-XL

With reinforcement plate

For easy location of the Command Panel onto the support arm system or pedestal via machined keyholes.

Design width = 418 mm for additional stability of the roof and base with heavy installed equipment, with extra space for cable routing.

Material:

Connection plate: Cast aluminium
Reinforcement plate: Sheet steel, 6 mm

Surface finish:

Connection plate:
Powder-coated in textured RAL 7024
Reinforcement plate:
Sheet steel, zinc-plated, passivated

Supply includes:

Seals and assembly parts.



Command Panels from an installation depth of 150 mm:

Design W =	VIP 6000	Opti-panel	Comfort Panel	Weight kg	Model No. CP
200 mm	222 ¹⁾	244 ¹⁾	250 ¹⁾	2.4	6528.420
418 mm	410 ¹⁾	432 ¹⁾	460 ¹⁾	3.2	6528.430

¹⁾ From front panel width mm without keyboard housing; with keyboard housing on request.

	Installation depth mm	A	B	C
Comfort Panel	152/308	28.9	77.9	30.5
	191 – 464	43.1	82.5	48.1
VIP 6000	155 – 185	32.5	81	30.5
	295 – 438	174.5	81	173
Optipanel	150	34	65.5	28
Metal enclosure	–	¹⁾ 86		¹⁾

¹⁾ Make the drilled holes/cut-out in the centre of the enclosure reinforcement plate.



Accessories:

Adaptor with connector cut-out, 24-pole (SZ 2477.010), see page 272.

Note:

With the Comfort Panel, Optipanel and VIP 6000 enclosures, the rectangular support arm cut-out may be ordered and prepared using the design code:

Comfort Panel, see page 200.

Optipanel, see page 209.

VIP 6000, see page 220.

For mounting Command Panels on:

Support arm system	CP-L Ø 130 mm ¹⁾	CP-XL	CP-Q
Enclosure attachment	CP 6525.510	CP 6130.610	–
Housing coupling	CP 6525.010	CP 6130.010	CP 6080.120
Angle coupling	CP 6526.010	–	CP 6080.110
Tilting adaptor 10°	CP 6527.010	–	–
Tilting adaptor ±45°	CP 6529.010	–	–

¹⁾Via connection adaptor CP-L to CP-XL CP 6528.010

Mounting cut-out CP 6528.420

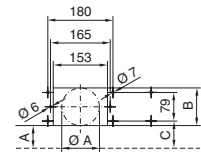

CP 6528.420

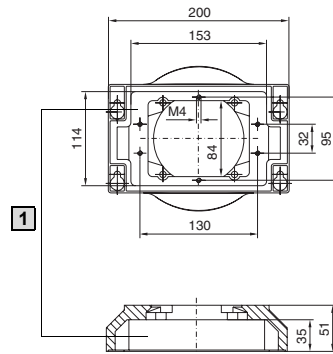

CP 6528.430

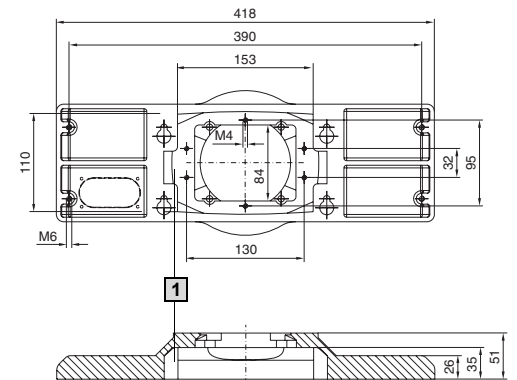

CP 6528.430

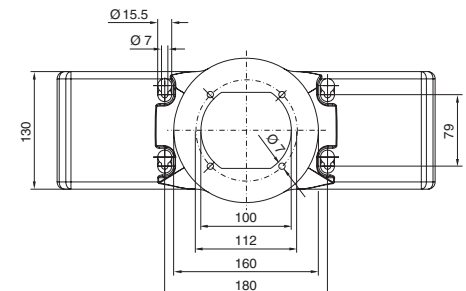
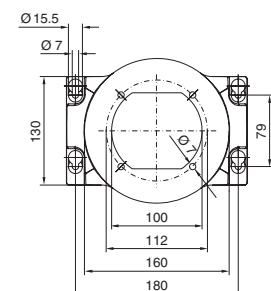
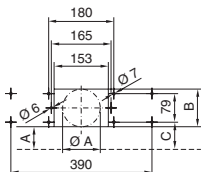

A or Ø A is manufactured to order in the case of Optipanel, VIP 6000 and Comfort Panel.
A_{max.} = 100 mm

1 Space/preparation for assembly of adaptors with connector cut-out, 24-pole SZ 2477.010



Angle coupling 90° CP-XL

For swivel mounting of the enclosure on the horizontal part of the support arm system. Enclosure may be suspended or top-mounted.

Rotation range:
Approx. 350°

Material:
Spheroidal-graphite cast iron and die-cast zinc

Supply includes:
Seals, plastic casing and self-tapping screws for CP-XL support section attachment.

Note:
By inserting pins 5 x 12 to DIN EN ISO 8741, the rotation range may be limited in 90° increments.

German patent no. 4033747
Italian patent no. 1252120



Colour RAL	Weight kg	Model No. CP
7030	6.2	6040.000
7024	6.2	6040.010¹⁾

¹⁾ Extended delivery times.

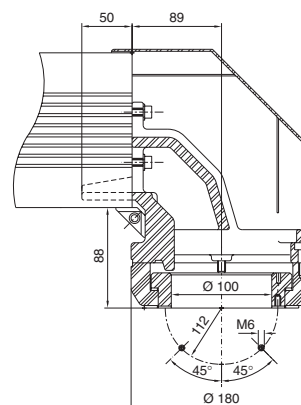

Mounting cut-out enclosure CP-XL

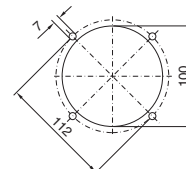

Top-mounting is only possible as shown in the diagrams below (without intermediate hinge).

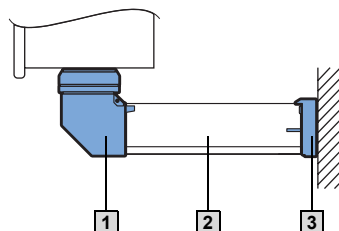

- 1** Angle coupling CP 6040.0X0
- 2** Support section CP-XL
- 3** Wall/base mounting bracket 6160.0X0

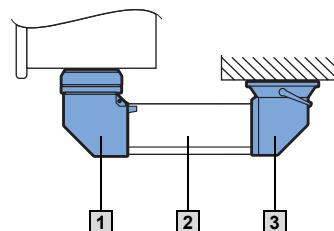

- 1** Angle coupling CP 6040.0X0
- 2** Support section CP-XL
- 3** Top-mounted joint CP 6170.0X0

Support arm system CP-XL

Aluminium



Angle adaptor 90° CP-XL to CP-L

see page 264.



Angle piece 90° CP-XL

For connecting horizontal and vertical support arm components.

Material:

Spheroidal-graphite cast iron

Supply includes:

Seals, plastic casing and self-tapping screws for CP-XL support section attachment.

German patent no. 58901106

European patent no. 0330027

with validity for IT



Outlet	Colour RAL	Weight kg	Model No. CP
Bottom	7030	2.4	6140.000
Bottom	7024	2.4	6140.010 ¹⁾
Top	7030	3.6	6180.000
Top	7024	3.6	6180.010 ¹⁾

¹⁾ Extended delivery times.

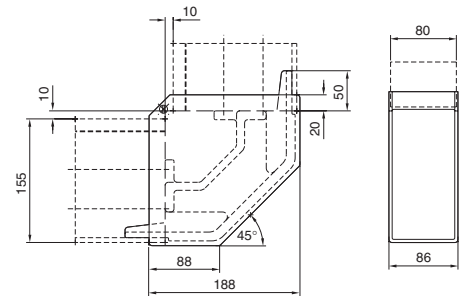
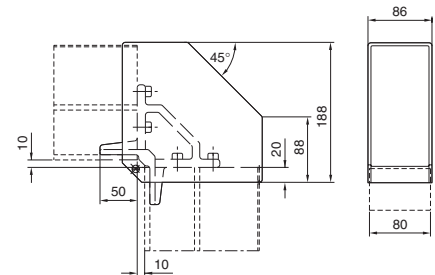



Intermediate hinge CP-XL

For vertically hinged connection of horizontal support sections within the support arm system.

Rotation range:
Approx. 180°

Material:
Spheroidal-graphite cast iron

Supply includes:
Self-tapping screws for CP-XL support section attachment and divided concertina section with zip for uninhibited access to the cable duct.

Note:
Rotation range may be reduced with rotation range limiter CP-XL, CP 6110.100.

German patent no. 3805424
European patent no. 0330029
with validity for IT

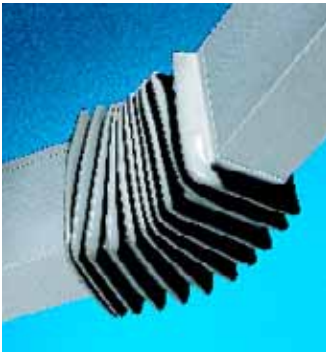

Colour RAL	Weight kg	Model No. CP
7030	6.5	6120.000
7024	6.5	6120.010 ¹⁾

¹⁾ Extended delivery times.

+ Accessories:

Rotation range limiter CP-XL, see page 278.

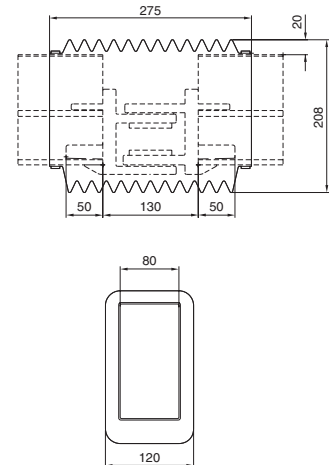

Wall-mounted hinge CP-XL

For vertically hinged mounting of the support arm surface on vertical surfaces.

Rotation range:
Approx. 180°

Material:
Spheroidal-graphite cast iron

Supply includes:
Seals, concertina section and assembly parts.

Note:
Rotation range may be reduced with rotation range limiter CP-XL, CP 6110.100.



Colour RAL	Weight kg	Model No. CP
7030	8.5	6110.000
7024	8.5	6110.010 ¹⁾

¹⁾ Extended delivery times.

+ Accessories:

Pillar, see page 295.
Rotation range limiter CP-XL, see page 278.

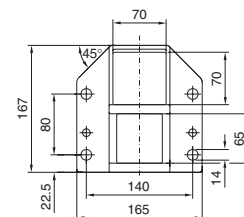

Mounting cut-out

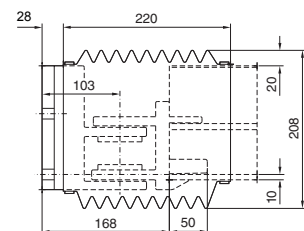
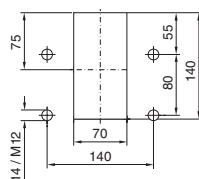

Support arm system CP-XL

Aluminium

1.4 B Support arm system CP-XL



Rotation range limiter CP-XL

Suitable for:

- Wall-mounted hinge (CP 6110.0X0)
- Intermediate hinge (CP 6120.0X0).

Material:

Steel, zinc-plated, passivated

Supply includes:

2 steel disks, slotted, including 3 cheese-head screws for assembly.



Packs of	Weight kg	Model No. CP
1 set	0.6	6110.100

Adjustable swivel area:

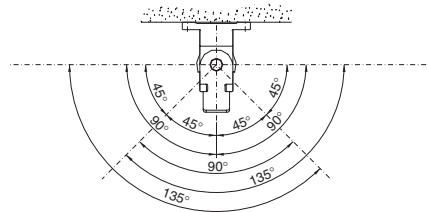

Top-mounted joint CP-XL

For swivel mounting of the support arm system on horizontal surfaces – also suitable for suspending from the ceiling.

Rotation range:

Approx. 350°, lockable.
Rotation range may additionally be reduced and adjusted in 60° increments via the limit plate.

Material:

Steel and cast parts

Supply includes:

Seals and plastic casing, self-tapping screws for CP-XL support section attachment and limit plate.

Note:

Safety end stop as anti-twist protection.

Colour RAL	Weight kg	Model No. CP
7030	11.9	6170.000
7024	11.9	6170.010¹⁾

¹⁾ Extended delivery times.

Accessories:

Pillar, see page 295.

Mounting cut-out

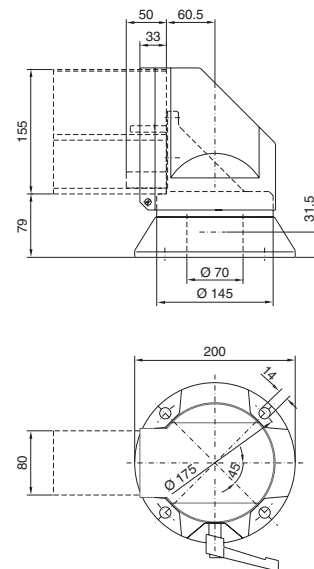
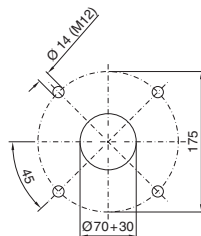

Support arm system CP-XL

Aluminium



Wall/base mounting CP-XL

For rigid attachment of the support arm system to vertical or horizontal surfaces.

Material:
Spheroidal-graphite cast iron

Supply includes:
Seals and self-tapping screws for CP-XL support section attachment.

Colour RAL	Weight kg	Model No. CP
7030	4.1	6160.000
7024	4.1	6160.010¹⁾

¹⁾ Extended delivery times.

Accessories:

Pillar, see page 295.

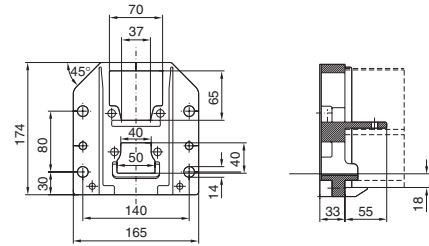

Mounting cut-out

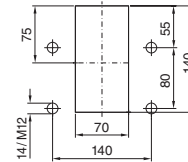

B
1.4
Support arm system CP-XL

Support arm system CP-Q

Fast selection

Make a simple sketch showing the basic form of the support arm. Next, select the corresponding support arm components. Start with **1** system start by selecting the appropriate enclosure situation.

Support arm system CP-Q

1.4

▶ Continue with CP-Q according to the item numbers.

System continuation/system end:

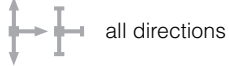

all directions

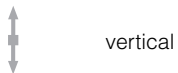

vertical

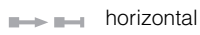

horizontal



angled

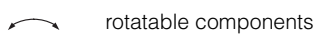

rotatable components

From item 2.1 enclosure attachments, a support section is required between each component.
Minimum length between:
Items 2.1 and 3.1 = 200 mm
Items 3.1 and 4.1/5.1 = 260 mm
Items 4.1 and 5.1 = 310 mm

T Support sections

T1 Support section CP-Q,



Length mm	Weight kg	Model No. CP
500	5.5	6080.050
1000	11.0	6080.100
2000	22.0	6080.200

See page 282

1 System start

Enclosure with mounting cut-out

1.1 Mounting cut-out CP-Q/CP-XL

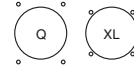

▶
2.1
2.2

1.2 Connection adaptor CP-L to CP-Q

CP 6528.010 (RAL 7024)
see page 258

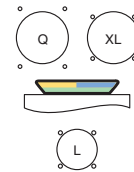

1.3 Connection adaptor CP-L to CP-Q

CP 6528.510 (RAL 7024)
see page 258

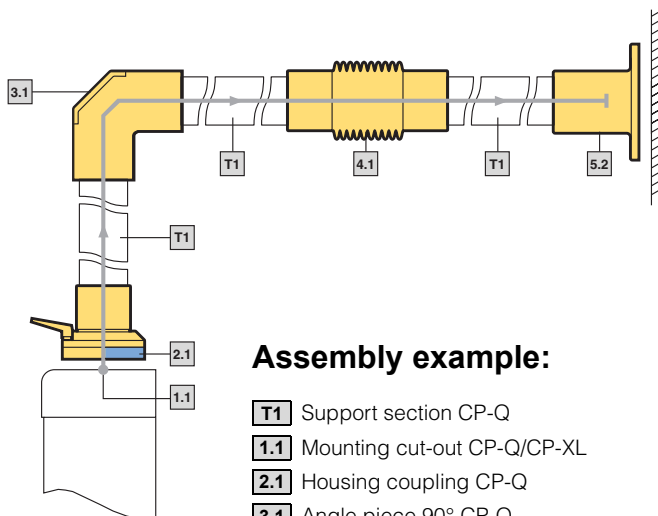
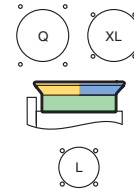

Assembly example:

- T1** Support section CP-Q
- 1.1** Mounting cut-out CP-Q/CP-XL
- 2.1** Housing coupling CP-Q
- 3.1** Angle piece 90° CP-Q
- 4.1** Intermediate hinge CP-Q
- 5.2** Wall/base mounting CP-Q

Note:

- Only insert one intermediate hinge
- Two angle pieces may also be used one after the other
- **Load diagram,** see page 238.

2 Enclosure attachments

3 Angle components

4 Intermediate hinge

5 System end

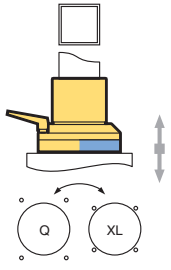
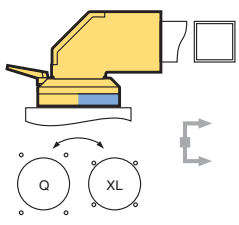
<p>2.1 Housing coupling CP-Q</p> <p>CP 6080.120 (RAL 7024), see page 282</p> 	<p>▶</p> <p>3.1 5.2</p>
<p>2.2 Angle coupling 90° CP-Q</p> <p>CP 6080.110 (RAL 7024), see page 283</p> 	<p>▶</p> <p>3.1 4.1 5.1 5.2 5.3</p>

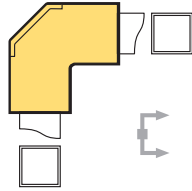
<p>3.1 Angle piece 90° CP-Q</p> <p>CP 6080.130 (RAL 7024), see page 283</p> 	<p>▶</p> <p>4.1 5.1 5.2 5.3</p>
--	---

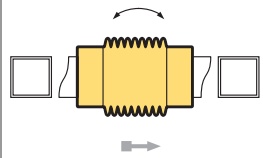
<p>4.1 Intermediate hinge CP-Q</p> <p>CP 6080.140 (RAL 7024), see page 284</p> 	<p>▶</p> <p>5.2 5.3</p>
--	-----------------------------

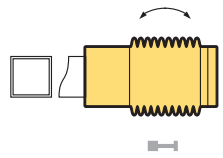
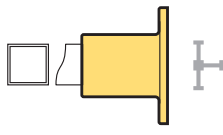
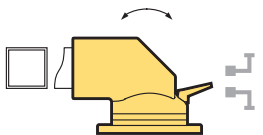
<p>5.1 Wall-mounted hinge CP-Q</p> <p>CP 6080.150 (RAL 7024), see page 284</p> 	<p>▶</p>
<p>5.2 Wall/base mounting CP-Q</p> <p>CP 6080.170 (RAL 7024), see page 285</p> 	<p>▶</p>
<p>5.3 Top-mounted joint CP-Q</p> <p>CP 6080.160 (RAL 7024), see page 285</p> 	<p>▶</p>

Support arm system CP-Q

Steel, 80 x 80 mm



Support section CP-Q

Attached to the connection components via clamping screws.

Dimensions:
□ 80 x 80 mm

Wall thickness:
5.0 mm

Material:
Extruded steel tubular section

Surface finish:
Zinc-plated

L mm ¹⁾	Weight kg	Model No. CP
500	5.5	6080.050
1000	11.0	6080.100
2000	22.0	6080.200

¹⁾ L min. = 200 mm

Note:
Load information, see page 238.

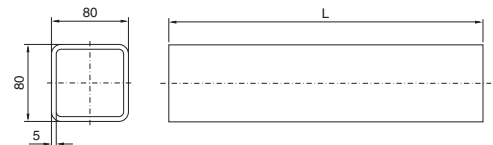

Support arm system CP-Q

1.4



Connection adaptor CP-L to CP-Q

see page 258.

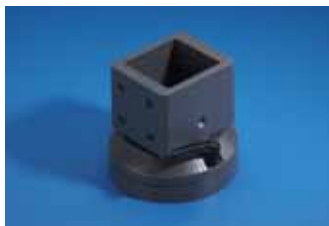

Housing coupling CP-Q

for support arm connection CP-XL

For swivel mounting of the enclosure on the vertical section of the support arm system.

Rotation range:
Approx. 350°, lockable via clamping lever.
Fit additional M6 x 10 screws as per DIN EN ISO 4762 to restrict the rotation range to 20° increments.

Material:
Cast aluminium

Supply includes:
Assembly parts and seals.

Colour RAL	Weight kg	Model No. CP
7024	4.7	6080.120

Note:
For enclosures with support arm connection CP-L Ø 130 mm, a CP-L to CP-Q connection adaptor (CP 6528.010 or CP 6528.510) is also required.



Possible mounting cut-outs

Mounting cut-out 1
Compatible with Rittal CP-XL

Mounting cut-out 2

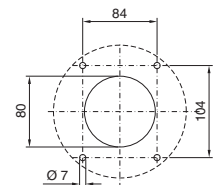
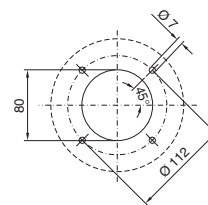
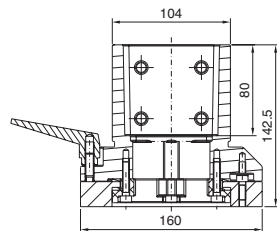

Support arm system CP-Q

Steel, 80 x 80 mm



Angle coupling 90° CP-Q

For swivel fastening of the enclosure to the horizontal support arm system.

- Enclosure top-mounted or suspended
- The support arm system is adjustable via clamping screws
- Removable panel for problem-free cable entry

Rotation range:

Approx. 350°, lockable via clamping levers. Fit additional M6 x 10 screws as per DIN EN ISO 4762 to restrict the rotation range to 20° increments.

Material:

Cast aluminium

Supply includes:

Assembly parts and seals.

Colour RAL	Weight kg	Model No. CP
7024	6.2	6080.110

Note:

For enclosures with support arm connection CP-L Ø 130 mm, a CP-L to CP-Q connection adaptor (CP 6528.010 or CP 6528.510) is also required.

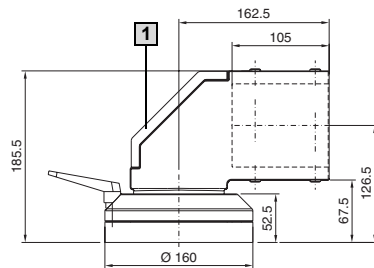

1 Removable plate

Possible mounting cut-outs

Mounting cut-out 1
Compatible with Rittal CP-XL

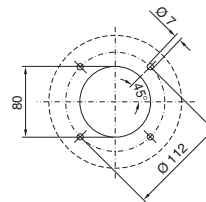

Mounting cut-out 2

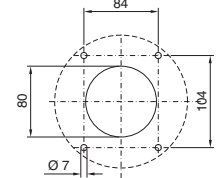

Angle piece 90° CP-Q

For connecting horizontal and vertical support arm components.

- The support arm system is adjustable via 4 clamping screws
- Removable panel for problem-free cable entry

Material:

Steel

Supply includes:

Assembly parts and seals.

Colour RAL	Weight kg	Model No. CP
7024	8.2	6080.130

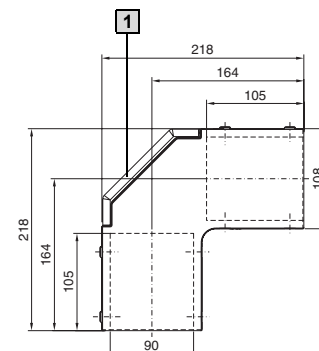

1 Removable plate

Support arm system CP-Q

Steel, 80 x 80 mm

1.4 B Support arm system CP-Q



Intermediate hinge CP-Q

For vertically hinged connection of horizontal support sections within the support arm system.

- Concertina section with zip for easy mounting and access during service.

Rotation range:

Approx. 180°

Material:

Zinc-coated steel, plastic

Supply includes:

Assembly parts and concertina section.

Colour RAL	Weight kg	Model No. CP
9005	14.6	6080.140

+ **Accessories:**

Rotational range available on request.

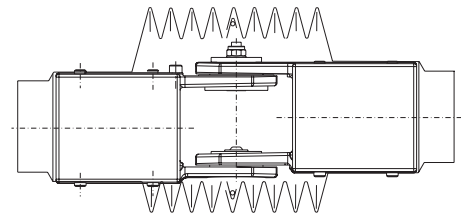
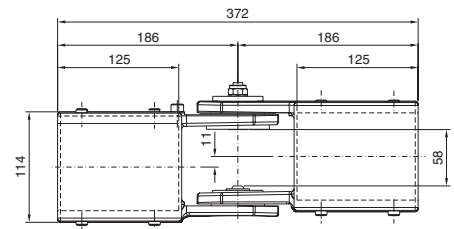

Wall-mounted hinge CP-Q

For vertically hinged mounting of the support arm on vertical surfaces.

- Concertina section with zip for easy mounting and access during service.

Rotation range:

Approx. 180°

Material:

Plastic coated steel

Supply includes:

Assembly parts and concertina section.

Colour RAL	Weight kg	Model No. CP
9005/7024	11.7	6080.150

+ **Accessories:**

Rotational range available on request.

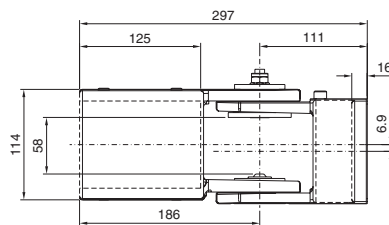

Mounting cut-out

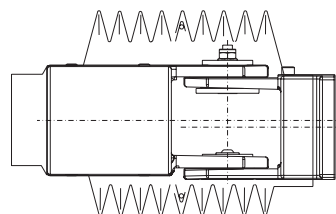
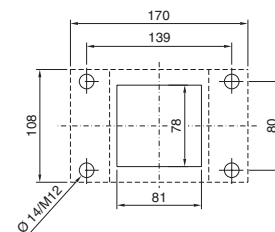

Support arm system CP-Q

Steel, 80 x 80 mm

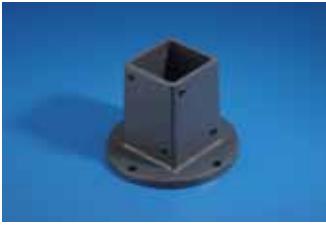

Wall/base mounting CP-Q

For rigid attachment of the support section to vertical and horizontal surfaces. With flange for front mounting.

Material:
Steel, spray-finished

Supply includes:
Assembly parts.

Colour RAL	Weight kg	Model No. CP
7024	5.9	6080.170

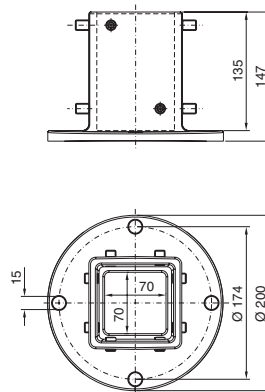
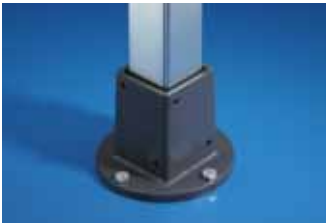

Mounting cut-out

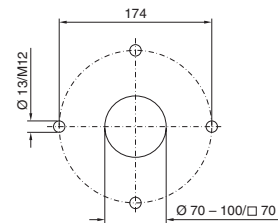

Top-mounted joint CP-Q

For swivel mounting of the support arm system to horizontal surfaces.

- Suspended or top-mounted
- Adjustment facility for the support arm system
- Removable panel for problem-free cable entry

Rotation range:
Approx. 350°, lockable via clamping levers.
Fit additional M8 x 8 or M8 x 10 screws as per DIN EN ISO 4762 to restrict the rotation range to 20° increments.

Material:
Steel, spray-finished

Supply includes:
Assembly parts.

Colour RAL	Weight kg	Model No. CP
7024	11.3	6080.160

+ Accessories:

Pillar,
see page 295.



Mounting cut-out

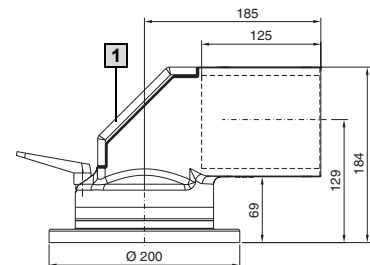
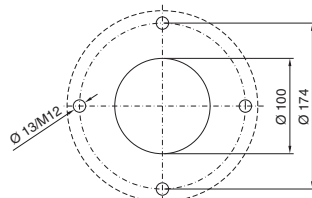

1 Removable plate

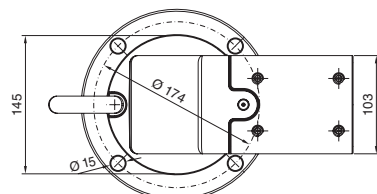

Stand systems

Features



Bringing movement to Rittal stand systems, to meet all your ergonomic and technical requirements.

For every enclosure type, height variability, mobile use, and accommodation of cables. Our extensive solution diversity meets every conceivable requirement.

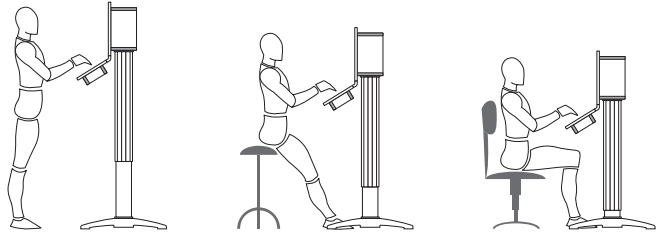

1.4 B Stand systems

Powerful pillars with numerous options – fixed . . .

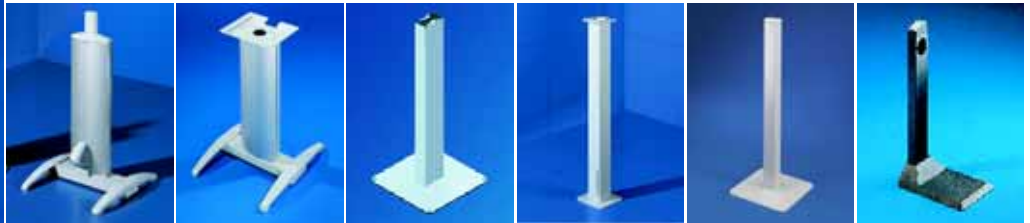

Pedestal for Command Panel
with support section CP-L
Pedestal for IW worktops

Pillar, small
For compact assemblies

Pillar, large
The robust base point for heavy assemblies.

Pedestal, open
With cable duct open

Pedestal for operating housing
Suitable for side mounting of operating housings.

. . . and with variable height



Lifting pillar, electric
Height adjustment (from 670 to 1140 mm), spindle drive secured against unintentional dropping.



Support section, height-adjustable
Adjustment range from 732 to 1122 mm. Inner section for external mounting of operating housings.



Pedestal, modular, small
for the configuration of compact operating stations. Height of support section may be shortened by sawing to the required length.

Pedestals in every variant – fixed or mobile



Pedestal base plate, large
Fitted with: Cut-out for concealed mounting of cable conduit adaptors and PG segments.



Cross member with cast feet
Steel cross member with mounting holes for lifting pillar.



Pedestal, mobile CP-L/CP-XL
for changing locations.

Pedestal, height-adjustable

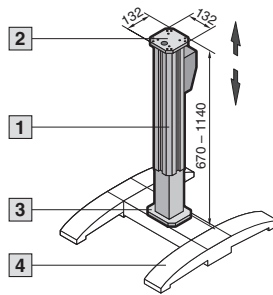

May be compiled from the following modules:	Model No. CP	Page
1 Lifting pillar, electric	6142.000	see below
Control unit for external mounting on surfaces/enclosures	6142.020	
4 Cross member with cast feet	6142.100	291

Mounting surface, head plate

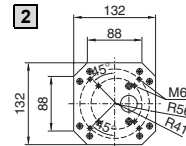

Mounting surface, base plate

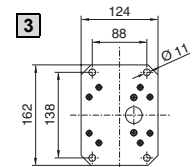

1 Lifting pillar, electric

Height adjustment 470 mm (from 670 to 1140 mm), spindle drive secured against unintentional dropping. With electronic overload cut-out to protect the drive. Adjuster unit made from extruded aluminium sections with all-round groove.

2 Head plate

- For direct mounting of worktop attachment IW, enclosures with support arm connection
 - CP-L, Ø 130 mm
 - CP-XL
- For swivel mounting of enclosures, including those with keyboard support, via wall/base mounting bracket, small CP-L, CP 6520.5X0, in conjunction with support arm system CP-L.

3 Base plate

For external mounting on the cross member or a sub-structure provided by the customer.

Note:

Only suitable for upright assembly.

Weight kg	Packs of	Model No. CP
13.8	1	6142.000

Technical specifications:

Permissible load: Max. 80 kg
Duty cycle: Max. 6 min/h with continuous operation
Ambient temperature: +5°C to +40°C
Mains connection: 230 V/50 Hz
Transformer: 24 V DC

Protection category:

IP 65 to EN 60 529/09.2000 (for electrical components).

Supply includes:

Adjusting drive with transformer, head and base plate.

! Also required:

Control unit, see page 287.

+ Accessories:

Cross member with cast feet CP 6142.100, see page 291.
Worktop attachment CP 6902.780, see page 1124.
Wall/base mounting, small CP-L, CP 6520.5X0, see page 265.



Control unit

for height adjustment of the lifting pillar. Design ready for connection with spiral cable and connector. With mounting brackets for screw fastening.

Design	Protection rating	Model No. CP
External mounting on surfaces/enclosures	IP 30	6142.020

Stand systems

Pedestal, modular, CP-S

Stand systems
1.4 B

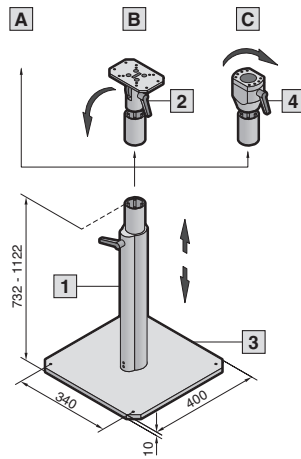

For small panels and keyboard housings up to 20 kg

May be compiled from the following modules:	Model No. CP	Page
1 Support section, height-adjustable	6146.200	288
2 Tilt adjustment	6146.300	289
3 Pedestal base plate	6146.100	289
4 CP-S attachment or CP-S housing coupling	6501.070	244
	6501.050	245

External mounting of operating housings or other devices:

- A** Direct screw-fastening
- B** With tilt adjuster **2**
- C** With attachment 6501.070 or housing coupling 6501.050 CP-S, see page 244/245.



Support section

height-adjustable

Adjustment range from 732 to 1122 mm.
Inner section for external mounting of operating housings.

External section with:

- Clamping screws at the rear for external mounting on pedestal base plate CP 6146.100
- Clamping lever for height fixing
- Surface for external cable routing.

Material:

Extruded aluminium section, natural-anodised

Supply includes:

Inner and outer section including locking lever and assembly parts for external mounting on the base plate and enclosure.

Weight kg	Packs of	Model No. CP
3.0	1	6146.200

+ Accessories:

Tilt adjustment CP 6146.300, see page 289.
Pedestal base plate CP 6146.100, see page 289.
Attachment CP-S CP 6501.070, see page 244.
Housing coupling CP-S CP 6501.050, see page 245.

✎ Rittal service:

Other heights available on request.

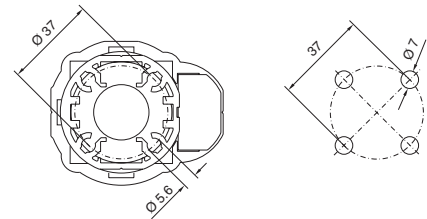

Gas-pressurised spring

- For relief with height adjustment
- Optional installation
- Internal mounting
- Load capacity 15 kg
- Length 490/885 mm

Supply includes:

Assembly parts for installing in the support section, height-adjustable.

Packs of	Model No. CP
1	6146.400

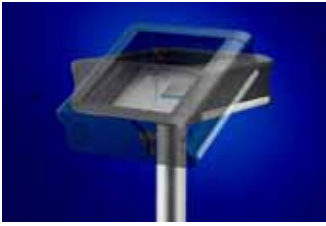

Tilt adjustment

For direct top-mounting on enclosures with mounting cut-out:

- CP-S
- CP-L, □ 120 x 65 mm
- CP-L, Ø 130 mm

Cannot be combined with enclosure attachment or coupling.

Adjustment range:
±30°

Material:
Sheet steel, zinc-plated, passivated

Supply includes:
Locking lever and assembly parts for height-adjustable mounting on the support section.



Packs of	Model No. CP
1	6146.300



Rittal service:

As tilt adjustment for support arm system CP-S on request.

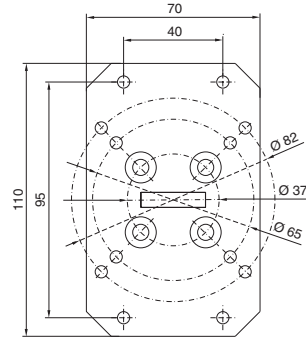

Pedestal base plate

With large surface for stability and welded tube connectors (Ø 48.3 mm) to accommodate the external profile of the support section, height-adjustable. Base mount from the outside using screws up to M10.

Material:
Sheet steel, powder-coated



Colour RAL	Packs of	Model No. CP
7024	1	6146.100



Accessories:

Twin castors CP 6148.000, see page 907.

Stand systems

Pedestals

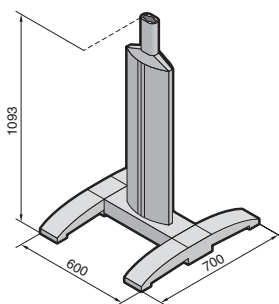

1 + 2

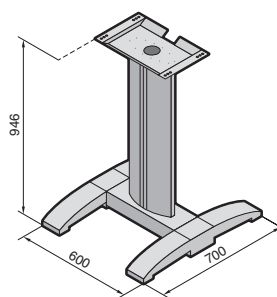

3

Detailed drawing, see page 1217.



1



2



3

Pedestal

One oval panel is permanently screw-fastened, whilst the other can be opened by "spreading" with a screwdriver for easy laying of cables. In order to ensure opening of the front panels, we recommend that the adjustable frame connector be used with all panels with keyboard housing.

Material:

Feet: Cast aluminium
Cross member, vertical support tubes: Steel
Panels: Aluminium section

Supply includes:

for Command Panel:

- 2 cast aluminium feet,
- 1 cross member made of steel,
- 2 steel support tubes welded to cross member,
- 2 oval panels made from aluminium section,
- 1 top cover made from cast aluminium with support section CP-L, partially pre-assembled.

for IW worktops:

- 2 cast aluminium feet,
- 1 cross member made of steel,
- 2 steel support tubes welded to cross member,
- 2 oval panels made from aluminium section,
- 1 worktop attachment of sheet steel.

	For Command Panel		For IW worktops	Page
	1 with drilled hole for cable entry in cross member	2 with cable conduit adaptor and drilled hole for cable entry in cross member	3 with drilled hole for cable entry in cross member	
Design				
W x H x D mm ¹⁾	600 x 1093 x 700	600 x 1093 x 700	600 x 946 x 700	
Model No.	6141.000	6141.100	6141.200	
Weight kg	34.9	35.1	33.7	
Colour RAL	7035/ natural-anodised	7035/ natural-anodised	7035/ natural-anodised	
Accessories				
Twin castors	6148.000, 4634.500	6148.000, 4634.500	6148.000, 4634.500	907
Levelling feet	4612.000	4612.000	4612.000	906
Base mount	6147.000	6147.000	6147.000	291
Foot rest	6145.100	6145.100	6145.100	291
Trim panel	6144.100	6144.100	6144.100	291
Cable conduit		see page		1065
Enclosure attachment CP-L, Ø 130 mm	6525.5X0	6525.5X0	–	256
Enclosure attachment CP-L, □ 120 x 65 mm	6525.6X0	6525.6X0	–	257
Housing coupling CP-L, Ø 130 mm	6525.0X0	6525.0X0	–	262
Housing coupling CP-L, □ 120 x 65 mm	6525.1X0	6525.1X0	–	262
Enclosure attachment CP-L, □ 120 x 65 mm, locatable	6525.2X0	6525.2X0	–	260
Enclosure attachment, tilting	–	–	6902.640	257
Worktop without handle (W x H x D 950 x 38 x 600 mm)	–	–	6902.310	184
Worktop with handle (W x H x D 950 x 38 x 658 mm)	–	–	6902.320	184

¹⁾ Other widths and heights and support tubes available on request.
X = 0 (RAL 7030), X = 1 (RAL 7024)



Cross-member

with cast feet

Steel cross member with mounting holes for lifting pillar or other individual assemblies, including 2 cast aluminium feet.

Colour RAL	Weight kg	Model No. CP
7035	5.8	6142.100



Accessories:

Foot rest CP 6145.100,
trim panel CP 6144.100,
base mount CP 6147.000,
see page 291.
Twin castors,
see page 907.

Detailed drawing,
see page 1219.



Base mount

Brackets for screw-fastening from below to the cast feet with posidrive raised countersunk screws M12.

Optionally with projection at the front, interior or sides, with Ø 11 mm hole for screw-fastening to the base.

Material:

Sheet steel, zinc-plated, passivated

Supply includes:

Posidrive raised countersunk screws M12.

Packs of	Model No. CP
4	6147.000



Trim panel

Material:

Cast aluminium

Supply includes:

Assembly parts for screw-fastening between the cast feet at the front or rear.

Colour RAL	Model No. CP
7035 textured	6144.100



Foot rest

Material:

Connector pieces: Cast aluminium
Round tube section: Aluminium

Supply includes:

Assembly parts.

Colour RAL	Weight kg	Model No. CP
7035 textured/ natural-anodised	0.6	6145.100

Stand systems

Pedestals

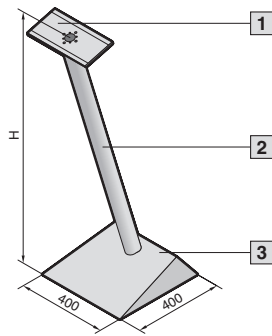

Pedestal modular, CP-L

May be compiled from the following modules:	Model No. CP	Page
1 Enclosure reinforcement	6143.210	296
2 Support section, straight (may be shortened to required length by sawing) 500 mm 1000 mm (H + 65 mm) 2000 mm	6511.0X0	254
	6513.0X0	254
	6515.0X0	254
3 Pedestal base plate, small	6143.200	292

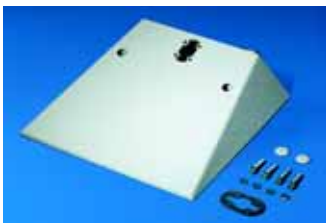

Pedestal base plate

small

- With one hole at the rear for commercially available cable conduit gland M20.
- With two holes at the top (including sealing bung) for floor attachment.
- Prepared on the inside for a cable clamp for strain relief.

Material:

Sheet steel, 2.5 mm

Supply includes:

Assembly parts.

Note:

Commercially available screws up to M8 may be used for floor attachment.

Weight kg	Colour RAL	Model No. CP
6.3	7035	6143.200

+ Accessories:

Cable clamp DK 7077.000 or DK 7078.000, see page 1064.

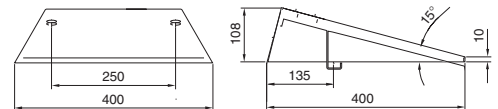

Pedestal base plate

large

- Cut-out for concealed mounting of cable conduit adaptor M50
- Cut-out for PG segments (EL 2235.010 to EL 2235.080) or cable conduit adaptor up to Ø 70 mm
- Integral cable clamping bracket

Material:

Sheet steel, powder-coated

Supply includes:

Integral reinforcement and mounting cut-out for support section CP-L or CP-XL, complete with assembly parts for configuration of the support section.

For support section	Colour RAL	Weight kg	Model No. CP
CP-L	7035	12.4	6137.535
CP-XL	7035	13.1	6137.035

! Also required:

Support section CP-L, see page 254, CP-XL, see page 270.

+ Accessories:

CP enclosure or worktops according to choice.
Twin castors, see page 907.
Levelling feet PS 4612.000, see page 906.
Cable conduit, see page 1065.
Wall mounting bracket KL 1580.000 or KL 1590.000 for base attachment, see page 975.

Detailed drawing,
see page 1219.



Pedestal

mobile

Consisting of:
 2 sheet steel axles, each with
 2 die-cast zinc roller bearings with plastic coating,
 4 twin castors, 2 x with, 2 x without locks,
 1 cross-brace, screw-fastened, of sheet steel with
 integral cable clamping bracket,
 1 support section of aluminium (for CP 6136.000
 with clip-in lid),
 partially pre-assembled.

Colour:

Powder-coated in RAL 7035,
 corner pieces in RAL 7030.



Pedestal, mobile with support section	Model No. CP
CP-L (see page 254)	6136.500
CP-XL (see page 270)	6136.000

+ Accessories:

Enclosure attachment for	Model No. CP	Page
6136.500 CP-L	6525.5X0 6525.6X0	256/257
6136.000 CP-XL	6130.5X0 6130.6X0	271/272

Detailed drawing,
 see page 1218.



Pedestal

for operating housing

For side mounting.

Consisting of:

- Pedestal plate, on castors
- Support section
- End cap with recessed handle

Supply includes:

Assembly parts.

Dimensions:

W x H x D:
 360 x 500 x 995 mm

Note:

Up to a maximum enclosure width of 380 mm.

Colour RAL	Weight kg	Model No. CP
9011	23.6	6135.000

Mounting cut-out

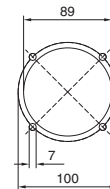

Stand systems

Pedestals/pillars



Pedestal, open

With cable duct open

- for inserting cables with pre-assembled connectors
- for optimum service access.

Head plate with accommodation for:

- CP-L housing coupling for support arm connection \varnothing 130 mm, CP 6525.0X0, see page 262
- CP-L enclosure attachment for support arm connection \varnothing 130 mm, CP 6525.5X0, see page 256

Material:

Pedestal tube: Steel, spray-finished in RAL 7035
Cover section: Plastic RAL 7030

Design:

400 x 400 mm, 10 mm thick base plate, with 4 x \varnothing 11 mm mounting holes.
Pedestal tube W x H = 86 x 73 mm, 3 mm thick, head and base plates welded on.

Supply includes:

Assembly parts and cover section.

- 1 Cover section just clips on
- 2 With cable clamping bracket



1



2

Height (H) mm	Weight kg	Model No. CP
1093	24	6215.000
To specifications	–	6215.100¹⁾

¹⁾ Delivery times available on request.

+ Accessories:

Cable tie SZ 2597.000, see page 1066.

Detailed drawing, see page 1218.

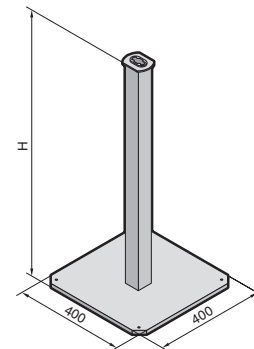

Pillar

small

For heavy assemblies, connection plates at the top for support arm components CP-XL.

- With cut-out for 24-pole connectors for cable entry at the bottom rear,
- Height: 1150 mm.

Material:

Steel

Design:

Base plate cross-section 500 x 500 mm, 12 mm thick, with 4 mounting holes.
Pedestal tube (cross-section 160 x 80 mm, wall thickness 3.2 mm) welded to base plate.

Colour RAL	Model No. CP
7035	6214.500

+ Accessories:

Housing coupling CP-XL, see page 272.

Enclosure attachment CP-XL, see page 271, 272.

Detailed drawing, see page 1218.

Stand systems

Enclosure reinforcements

1.4 Stand systems



CP 6143.310



CP 6143.210

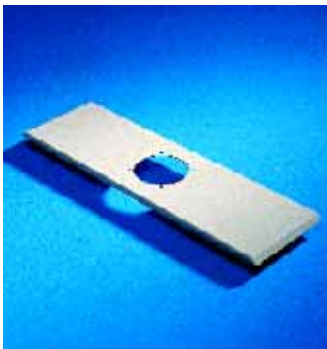

CP 6503.000

Enclosure reinforcement

For external or internal reinforcement of enclosures of a corresponding size. Smaller enclosures may also be mounted directly without enclosure reinforcement.

Supply includes:

Assembly parts for the enclosure and support section plus 2 seals.

For enclosure	Support arm connection	Material	Weight kg	Model No. CP
B1 ≥ 300 mm, T1 ≥ 150 mm	CP-S	Stainless steel 1.4301	0.9	6143.310
B1 ≥ 300 mm, T1 ≥ 150 mm	CP-L	Sheet steel	0.9	6143.210
CP 6662.000 or AE (B1 = 600 mm, T1 ≥ 210 mm)	CP-XL	Sheet steel	2.2	6503.000

CP 6143.310

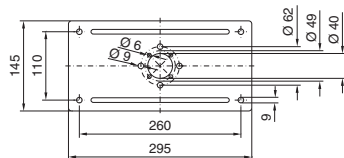

CP 6143.210

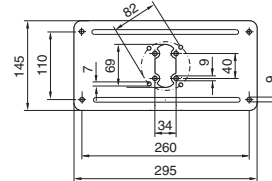

B = Width
T = Depth

CP 6503.000

