



High quality event displays



When you buy an Expand product you will get a high quality event display that is easy to use and that can be set up and taken down over and over again without being worn out.

Quality pays off long term. The product comes with a warranty. It has a long lifetime and you use it for many years. When you need to update your message, you just order a new graphic - both environmental friendly and cost-effective long-term.

Quality is more than durable products. Expand is one of the leading manufacturers in the world within portable event displays and has been in the business since 1978. With Expand offices in seven countries, distributors in over 60 countries and large warehouses in several locations in the world, we offer a global distribution and fast and secure deliveries. Our core values are: "being intelligent & innovative in everything we do" – from market research, product development, testing and design to delivery and service. We focus on continuously developing our sustainability efforts throughout the entire process.

Please find Expand's **ISO 9001 Certificate, Product Warranty, Codes of Conduct, Quality Policy and Environmental Policy** on www.expandmedia.com.



■ Products for indoor use	
Ideas for your event	4-5
Counter/transport box:	
Expand PodiumCase	6-7
Large displays/Pop-ups	
Expand 2000	9
Expand MediaWall	10
Expand MediaWall XL	11
Expand MediaFabric	12
Expand Tower	13
Expand MonitorStand	14
Carpets	15
Retractable displays/Roll-ups	
Expand MediaScreen 1	17
Expand MediaScreen 2	18
Expand MediaScreen 3	19
Expand QuickScreen 3	20
Expand MediaScreen 4	21
Expand M2	21
Expand MediaScreen XL	22
Non-retractable banners	
Expand BannerStand	25
Expand SmartStand	26
Brochure stands	
Expand BrochureStand	27
Expand BrochureHolder	27
■ Products for outdoor use	
Expand FlagStand XL	29
Expand FlagStand 1	30
Expand MediaScreen 2 outdoor	31
Expand DisplayTunnel	32
Spotlights	33
■ 3D tool & Artwork	34

Event kits - ideas for your event or exhibition stand



Expand BrochureStand

Expand MediaWall XL

Expand PodiumCase

Expand MonitorStand

Electra
BICYCLE COMPANY®



High Visual Impact

Combine a gigantic pop up wall with digital signage.

The extra large pop up is 460 cm wide and 264 cm tall. The kit also includes a stable literature stand for your catalogues. The Expand MonitorStand for your flat screen enables you to show your digital presentation or movie. A logo carpet with the colour of your choice, creates the perfect setting.

Expand PodiumCase

Pack your Expand MediaWall XL in the Expand PodiumCase, our transport box on wheels that easily converts into a spacious counter. The other products are delivered in nylon carry bags.



Impact Value Display



Versatile Exhibition Stand



Dynamic Display



360 degrees



Digital Signage



Quick Impact Display

A stand that is extra quick to set up.

Sometimes time is crucial. This kit enables you to get an entire stand up in a few minutes. The counter is also your transport case on wheels. The two retractable displays, Expand MediaScreen 1, need 30 second each and the large fabric backdrop is set up in a minute. Pack your brochures in the literature stand prior to your event and then just set it up on location.

Check out more event kits

www.expandmedia.com

Scan the QR code with your smartphone.



Textile Display

Maximum Impact

Outdoor Event

Master Exhibit

Match Your Message Stand



Expand PodiumCase

A transport box that can be turned into a spacious counter

To create the counter, just open the box and put on the accompanying wooden top. The counter provides a large surface to gather around at your event.



Expand PodiumCase is perfect for transporting our large display walls and most of our other products.



It fits into the trunk of your car.





Table tops in birch, aluminium, oak & black plastic. The black plastic version is a lightweight table top that also can be used outdoors.



Inside, there are detachable shelves to hold your brochures, demo products and drinks.



It can also be used closed, then with a smaller table top (available in birch, aluminium & oak).



Use our sign kit **Expand Header** to create a promotion stand.

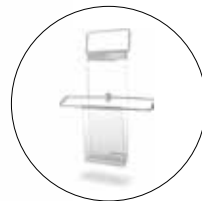

Add the **Expand BrochurePocket** for your brochures.

Sizes:

Width: open 123 cm (closed 65 cm)
 Height: open 99 cm (closed 97,5 cm)
 Depth: open 61 cm (closed 43,5 cm)
 Weight: 10 kg

Accessories:

Shelves, table top, monitor holder, Expand Header, Expand BrochurePocket

Large displays/pop-ups

If you want to create extra impact, a large display is the perfect choice. With our pop-up walls, you will get a large image up quickly and easily.

- Large display that creates extra impact
- Impressive size and yet very quick and easy to set up
- Comes in transport box or bag with wheels for easy transportation





Expand 2000

Pop up system with endless possibilities

The Expand 2000 is one of the most flexible display wall systems on the market today. It allows you to choose from a wide range of designs, shapes and sizes to create your own unique display wall. Perfect for your trade show.



L-shape

S-shape

U-shape



A showcase to promote your products

Sizes:

Width: Flexible
Height: 225, 300, 370 cm

Accessories:

Spotlight, shelves, Expand PodiumBox or Expand PodiumCase





Expand PodiumCase
 Pack your Expand MediaWall in the Expand PodiumCase, a combined counter and transport box on wheels.



Nylon bag
 It can also be transported in our nylon bag on wheels. (sizes 1x3–4x3)

Expand MediaWall

Our popular pop up wall

It has the perfect curve to maximize the visibility of your message. Despite its size it is quick and easy to set up. It is one of the lightest pop up walls on the market. It is available in five different sizes to fit different locations and meet various needs. Used for events, exhibitions and perfect as a backdrop. Add spotlights to highlight your message.

Sizes & weight



5x3
 Width: 405 cm
 Height: 230 cm
 Depth: 100 cm
 Weight incl. graphic: 18.6 kg



4x3
 Width: 337 cm
 Height: 230 cm
 Depth: 72 cm
 Weight incl. graphic: 15.9 kg



3x3
 Width: 270 cm
 Height: 230 cm
 Depth: 56 cm
 Weight incl. graphic: 13.1 kg



2x3
 Width: 203 cm
 Height: 230 cm
 Depth: 52 cm
 Weight incl. graphic: 10.4 kg



1x3
 Width: 125 cm
 Height: 230 cm
 Depth: 35 cm
 Weight incl. graphic: 7.7 kg



Expand MediaWall XL

A gigantic pop up wall

This super size pop up wall makes you stand tall among the rest. It is both taller and wider than traditional pop up walls. Despite its impressive size it is easily set up by one person.

Pack it in our Expand PodiumCase, a combined transport box and counter that fits in your car. Spotlights are available to enhance the impact of your message.



Expand PodiumCase

Pack your Expand MediaWall XL in the Expand PodiumCase, a transport box on wheels that easily converts to a spacious counter.

Sizes & weight



5x3
 Width: 460 cm
 Height: 264 cm
 Depth: 108 cm
 Weight incl. graphic: 23.7 kg



4x3
 Width: 390 cm
 Height: 264 cm
 Depth: 80 cm
 Weight incl. graphic: 20.4 kg



The Expand MediaWall XL offers a 33 percent larger graphic surface than our regular Expand MediaWall.





Expand MediaFabric

A large fabric pop-up wall that you set up in a minute

Your image is printed on fabric that is fastened on to the product, which means that you do not need to attach your image to the product each time you set it up. It is automatically stretched to a smooth surface.

The Expand MediaFabric uses Velcro® to attach the image, which makes it extra easy to replace when needed.



Also available in a curved version.

Sizes:

Width: 150-445 cm
Height: 225-300 cm

Accessories:

Spotlight, Expand PodiumCase,
Bag with wheels



Delivered in a nylon bag or the Expand PodiumCase for easy transportation.

Expand Tower

Cylinder shaped display that attracts extra attention

The Expand Tower is a highly effective medium for attracting a little extra attention. On a small floor surface, the circular shape allows you to come up with different and creative solutions for your message and logo.

Delivered in a nylon bag for easy transportation.

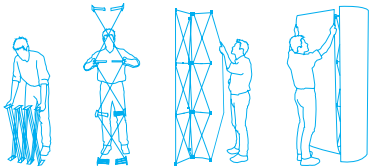

Create a striking eye-catcher by backlighting your Expand Tower.



Sizes:

Diameter: 66 cm

Height: 225, 300 cm

Accessories:

Spotlight, lighting tubes for backlighting

Expand MonitorStand

Stand for your flat screen

The stand enables you to show your digital presentation or movie. You set it up in a few minutes. It can be used stand alone or integrated in a pop-up/large display wall. Perfect for your exhibition stand or in-store marketing activities.

The pole holds a channel where you easily hide the cables for the monitor. The Expand MonitorStand supports VESA 100 and 200.

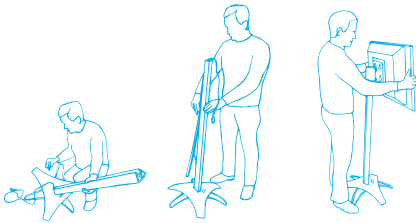

Add a laptop shelf

Perfect for your laptop or computer keyboard.



Sizes:
Foot: H x Ø: 100 x 590 mm
Pole: 122 cm, 175 cm, 195 cm

Accessories:
Laptop shelf

Carpets

With your logo or image

A carpet creates the perfect setting for your event or exhibition stand. Get a carpet with your logo or image. We offer different types of carpets, such as single use carpets, expo carpets, entrance carpets, washable carpets for long-term use. Available with or without blanket-stitching.



Washable carpet with blanket stitching



Single use carpet

Entrance carpet with logo & image



Expo carpet for your exhibition stand



Retractable displays/roll-ups

Easy to use, these are our most popular products

- Fast and easy to set up – get your message up in 30 seconds
- Perfect when you need to set up and take down your message often
- Comes in a bag for easy transport





Sizes:

Width: 85, 100, 150 cm

Height: Flexible between 160-225 cm

Accessories:

Spotlight

Expand MediaScreen 1

A cost-effective display with telescopic pole

With its compact shape and streamlined design, this retractable display fits in almost any environment.

The Expand MediaScreen 1 is equipped with a foldable support foot to ensure stability.

The telescopic pole makes it easy to adjust the height.



It is also available in 150 cm width, perfect as a backdrop.

Expand MediaScreen 2

Double-sided retractable display

Expand MediaScreen 2 is perfect in environments where people pass by from different directions. Expose the same message on both sides or show two separate messages.

Expand MediaScreen 2 is also available for outdoor use, see Expand MediaScreen 2 outdoor on page 31.

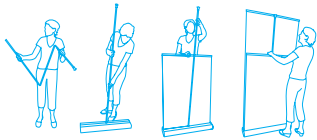

Sizes:

Width: 85,100 cm

Height: 200, 220 cm

Accessories:

Spotlight



Sizes:

Width: 85 cm
 Height 160-225 cm (telescopic pole)
 Weight: 3.9 kg (7.7 incl. bag)

Accessories:

Spotlight



Expand MediaScreen 3

Top of the line retractable display

It comes in both a matte and polished aluminium design with a selection of modern accent colours. Graphic change is fast with only a few clicks, which allows for easy update of campaigns and messages. Reuse this retractable banner for a long time and simply change your graphic - both cost-effective and environmentally friendly.

This retractable banner offers further exclusivity with Expand's design and quality. Delivered in a highly protective hard case, for maximum protection during transport and storage.



Easy to replace banner

1. Click to open the snap locks
2. Remove the graphic cassette
3. Insert your new graphic
4. Close the snap locks - ready!



Always a vertical graphic, even if the floor is uneven. Simply turn the knob to adjust the leaning. It has never been easier.



Find your favourite. Choose between polished or matte aluminium base with accent colours in Ruby Black, Polar White, Grey Rubber, Chrome or Midnight Blue.



Expand QuickScreen 3

Available in seven colours

The Expand QuickScreen 3 has an attractive and unique design that adds an extra dimension of exclusivity, which thereby strengthens the impact of your message.

With its ingenious system of separate graphic cassettes, you can easily change your image in a few minutes.

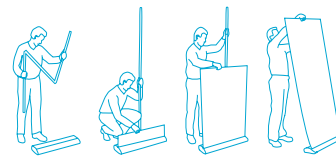

Sizes:

Width: 50, 85, 100 cm

Height: Flexible between 160-225 cm

Accessories:

Spotlight

Expand MediaScreen 4 & Expand M2

Simple change of graphics

These two retractable displays are suitable choices when you need to change your image often or wish to vary between different images in your display. This way your marketing becomes more cost-effective.



The graphic that you do not use, is protected in the paper tube.



Expand M2



Expand MediaScreen 4



Changing graphics only takes a minute

Just open the unit, take out the graphic roll and replace it with a new one.

Sizes:

Expand MediaScreen 4 : 85 & 100 cm.

Expand M2 : 85 cm.

Height: Flexible between 160-225 cm

Accessories:

Spotlight



Expand M2

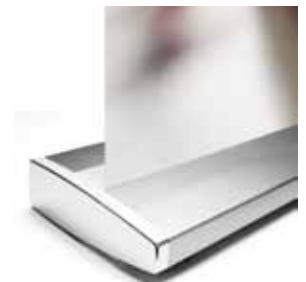

Expand MediaScreen 4



Expand MediaScreen XL

An extra tall, extra wide retractable display

With Expand's patented magnetic couplings you can also easily combine several Expand MediaScreen XL to create an extra large backdrop.

It is delivered in a nylon bag. Or use several and pack them in the Expand Podium-Case, a combined counter and transport box on wheels.

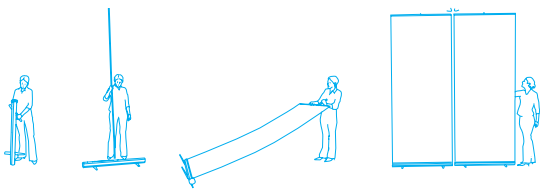

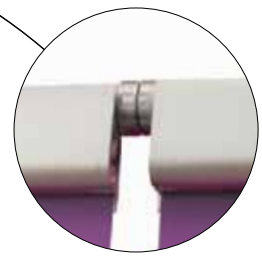

Expand's patented magnetic connectors



Pack your Expand MediaScreen XL in the Expand PodiumCase, our transport box on wheels that easily converts into a spacious counter.

A large backdrop in a box

The Expand MediaScreen XL is quick and easy to set up. The patented magnetic connectors allow you to join several displays with a simple click. The 3x3 m backdrop fit into the Expand PodiumCase - a transport box that easily converts into a spacious counter.

Sizes:

Width: 100, 120 cm
 Height: 200, 218, 250, 300 cm

Accessories:

Spotlight



Perfect to use as a single retractable banner as well.

Non retractable displays

Lightweight displays in various sizes and designs

- Foldable (does not have a retractable function)
- Set up in a minute - with a few simple operations
- Perfect for long-term use, when you do not need to set up and take down your message often
- Comes in a bag for easy transport





Expand BannerStand

Lightweight display with a slim design

Designed for those who need a flexible system that can be tailored to suit different needs and requirements, and it is available in 20 different sizes.

Our patented magnetic tape allows you to combine several Expand BannerStands seamlessly, creating one large image.

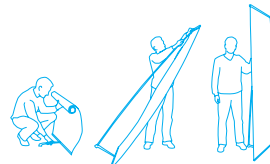

Sizes:

Width: 40, 60, 70, 80, 100 cm

Height: 140, 180, 200, 220, 250 cm

Accessories:

Spotlight



Expand SmartStand

Lightweight, double-sided display

With the Expand SmartStand you can lift your image up from the floor level. It has a telescopic pole, which makes it easy to change the height as well as adapting the size of the image to suit your specific needs. Available in many sizes.

Choose the double-sided version to present your message from two directions for maximum impact.

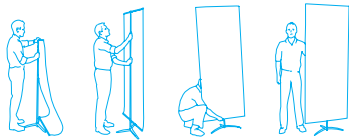

Sizes:

Width: 50, 60, 70, 80 cm

Height: Flexible 160-210 cm

Accessories:

Spotlight

Expand BrochureStand

A compact and stylish brochure stand

The Expand BrochureStand is a practical and easy-to-carry brochure rack. The pockets are spacious and will take various types of documents up to A4 format.

Made from carefully selected material and designed with precision, it guarantees problem free usage and a long lifetime. All components are recyclable.

The brochure stand is delivered in a durable bag.



The stable magnetic locking connector makes it very easy to move when set up.



Load it with brochures even when collapsed.



Size & weight

Width: 26 cm
 Height: 140 cm (17.5 cm collapsed)
 Height: 173 cm (20.5 cm collapsed)
 Floor space: 26 x 40 cm
 Weight: 4.3 kg or 4.9kg
 Tray space: 22 x 36.5 x 2.8 cm

Accessories

Graphic holder

Expand BrochureHolder

Lightweight brochure stand

This brochure stand is very light and easy to set up. Both versions come in a practical nylon bag.

Size & weight

Widths: 25 and 50 cm
 Height: 136 cm
 Weight: 1.5 kg

Accessories

Spotlight





Outdoor products

Outdoor displays for any outdoor event, campaign or point of sales activity

Our outdoor products have gone through a rigorous development and testing process to handle wear and tear by weather and wind.

All outdoor products are portable and come in a bag/case for easy transportation.

Expand FlagStand XL

Extra tall and stable flag stand for outdoor use

The Expand FlagStand XL is a stable, portable flag stand with a telescopic function, making it possible to vary the height up to 5.5 m. The simple construction with very few loose parts allows for simple transportation and makes the product fast to mount and set up.

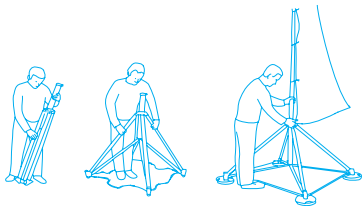

The Expand FlagStand XL comes in two versions – either with cast iron weights or with waterbags.



Sizes:

Width: 120 cm

Product height: 550 cm



Expand FlagStand 1

A portable flag stand for outdoor use

The Expand FlagStand 1 is a lightweight, portable flag stand perfect for all outdoor events, marketing activities and campaigns.

It is very stable even in strong winds and is available either with an X base or with a ground stake. Whatever logo, image or text featured on the flag, you can be sure of exceptional visibility.

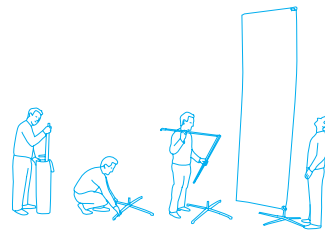

Sizes:

Width: 100 cm

Product height: 210 , 310 & 410 cm



The flag can be designed in various shapes and sizes



Size:
Width: 85 cm
Height: 180, 200 cm

Accessories:
Support feet

Expand MediaScreen 2 outdoor

The portable retractable display for outdoor use

This double-sided display is equipped with support feet and a resilient support pole to guarantee stability even by stronger winds. It is of very high quality to resist wear and tear by weather and wind and can be used on almost any surfaces such as sand, snow, grass and asphalt.

Expand MediaScreen 2 outdoor has a patent pending solution and is the perfect tool for all kinds of outdoor events.

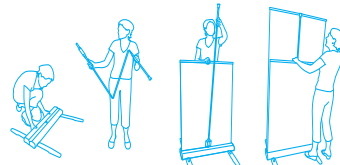



Expand DisplayTunnel

Designed to look and perform like nothing else on the market.

With Expand DisplayTunnel, you get a three-dimensional shape with higher visual impact than the traditional flat sign systems. The shape makes it effective both as a media and as a demarcation/signpost, for instance at sports events.

To set it up, all you have to do is to open the bag. You are done in five seconds!

Sizes:
 Width: 62 cm
 Height: 58 cm
 Length: 200 cm

All you need to do is open the bag, Expand DisplayTunnel does the rest by itself!



Expand Spotlights

Highlight your message

Add a spotlight to your display to enhance the impact and colour of your graphics. We offer both halogen and LED spotlights. LED is the light of the future with a life expectancy of 50.000 hours (halogen: 2.000 hours) - both cost-effective and environmentally friendly.

For our pop ups walls

Expand Spotlight (LED)

- Environmentally friendly & cost-effective - long life expectancy & energy efficient (19 W)
- Complies with all CE, UL and CSA requirements
- Delivered in a nylon bag



Expand Spotlight (150W)

- Halogen
- Safety certified
- Delivered in a nylon bag



For our retractable, non-retractable displays & Expand BrochureHolder

Expand Spotlight (50W)

- Halogen
- Safety certified
- Delivered in a hardcase





What about the artwork?

To get the most out of your message, please find some useful advice for designing the artwork:

Place the logotype in the top to make sure it is visible from a distance. Also remember to put the message where it is visible.

Put some time into the copy text and try to keep it short. In most cases, you only have a few seconds to catch the attention of your audience.

Choose a font that is easy to read and a font size that is suitable for the reading distance.

Avoid too much text and images as it easily results in a design that is too busy and your audience may miss your message completely.

Please find artwork templates for all of our products as well as technical guidelines on www.expandmedia.com.

Do you need help with the design of the artwork?
Please contact us.



Plan your stand in our free 3D tool

What will my event or exhibition stand look like? With our 3D tool you will quickly see how much you can fit into your floor space and how it will look. Choose your floor plan size, drag and drop the products and even upload your own jpeg files to apply to your displays.

Go to www.expandmedia.com to use our free 3D tool.



expandmedia.com

Contact us – we deliver worldwide.

Sweden & all countries not listed below .

Expand International AB
Palmfeltsvagen 1C
SE-121 62 Johanneshov, Sweden
Tel +46 (0) 8 55 69 69 40, Fax+46 8 (0) 55 69 69 01
E-mail info@expandmedia.com

UK

Expand International (GB) Ltd.
Unit 1, Saxon Business Centre, Windsor Avenue, Merton
London SW19 2RR
Tel +44 (0)208 540 8800 Fax +44 (0)208 540 0500
E-mail info.uk@expandmedia.com

Germany, Austria & Switzerland

Expand International Deutschland GmbH
Holzstraße 2
40221 Düsseldorf
Deutschland
Tel: +49 (0)211-220597-0 Fax: +49 (0)211-220597-79
E-mail info.de@expandmedia.com

France

Display France Sarl
Parc d'affaires de Limonest
1 rue des Vergers - Bât. 5
FR-69760 Limonest
Tel +33 4 78 66 47 30, Fax +33 4 78 66 47 39
E-mail france@expandmedia.com

North, Central & South America

Expand International of America, Inc.
400 Long Beach Blvd
Stratford, CT 06615 USA
Tel +1 (203) 870 2030, Fax: +1 (203) 870 2034
Toll free phone: 1-800-758-3020
E-mail us@expandmedia.com



expandmedia.com