

LP1600 Loading Platforms

FOR SAFE LOADING & ACCESS TO TANKERS

Safe and easy access to the tops of road and rail tankers and ISO containers

The IFC LP1600 loading platform has been developed to provide a low cost, easy to install and safe solution for accessing the tops of tankers and ISO containers.

The LP1600 is ideal for smaller operations or where space is at a premium. It is easy and fast to install and can be operational within a day.

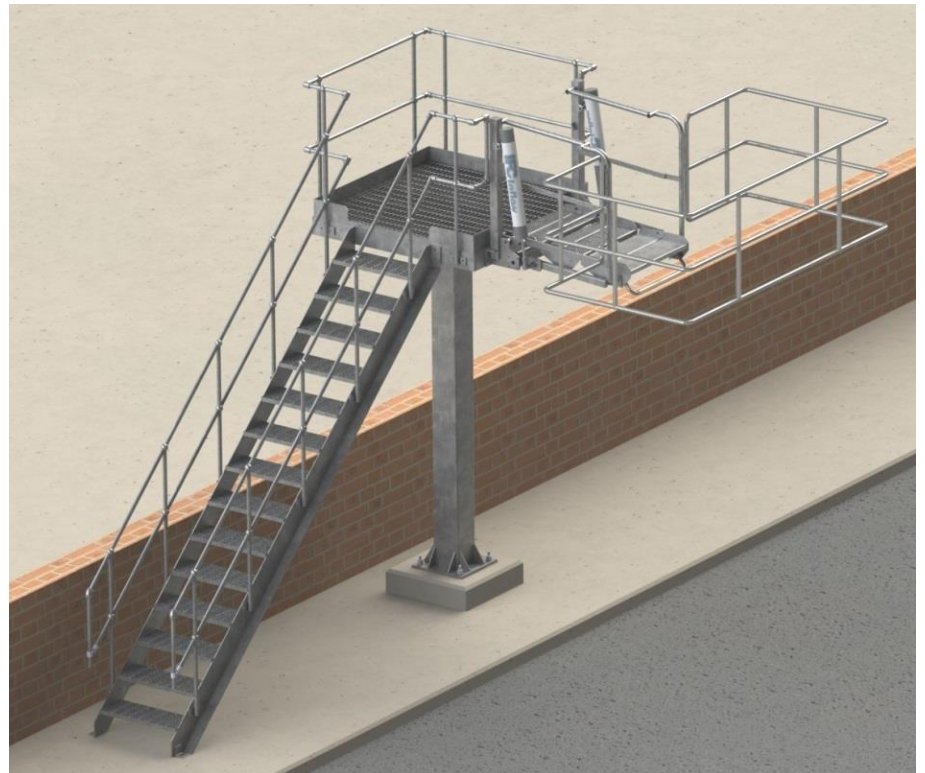

Features and Benefits

- Ideal for top loading, tanker safety & hygiene inspections, venting, load sampling, washing and tanker de-contamination
- Space saving modular pedestal design for small site footprint
- Designed with operator safety in mind
- Anti slip access steps, platform floor & folding stairs along with safety hand rails & knee bars on steps and platform as standard
- Large 1.6m square working platform allows fitting of folding stairs, top loading arms and other equipment
- Designed to provide a robust, durable solution to safely access the tops of tankers
- Fulfils all current health & safety requirements for working at height on tankers

S1007D Datasheet

SAFE TANKER ACCESS SOLUTIONS

Leaders in tanker access systems

Technical data:

Dimensions

Main deck area:	1600mm x 1600mm
	Height less than 4.0mtr
Access stair width:	750mm inside dimension
Handrail height:	1050mm
Step riser:	220mm

Specification

Material of construction:	Mild steel
Finish:	Hot dipped galvanised to BS1461
Main Support:	Single box column
Intermediate support:	Single box column
Grating / stair treads:	Standard open mesh (other types optional)
	Included
Kicker plate:	Knee guard & hand rail height 34mm OD
Hand railing:	
Foundation mounting:	Optional cast-in bolt cage

Variations

The LP1600 can be supplied with many options including:-

Higher platforms up to 6m. Platforms over 4m high require an intermediate platform half way up the access steps

800mm wide folding stairs can be fitted to any of the 3 spare platform sides

Top loading arms and other equipment can be supplied and installed

Larger platforms for 2600mm wide folding stairs, dual support columns and angled access steps available

IFC Inflow also design and install full length gantry's fitted with a range of tanker equipment including sliding and wide folding stair options.

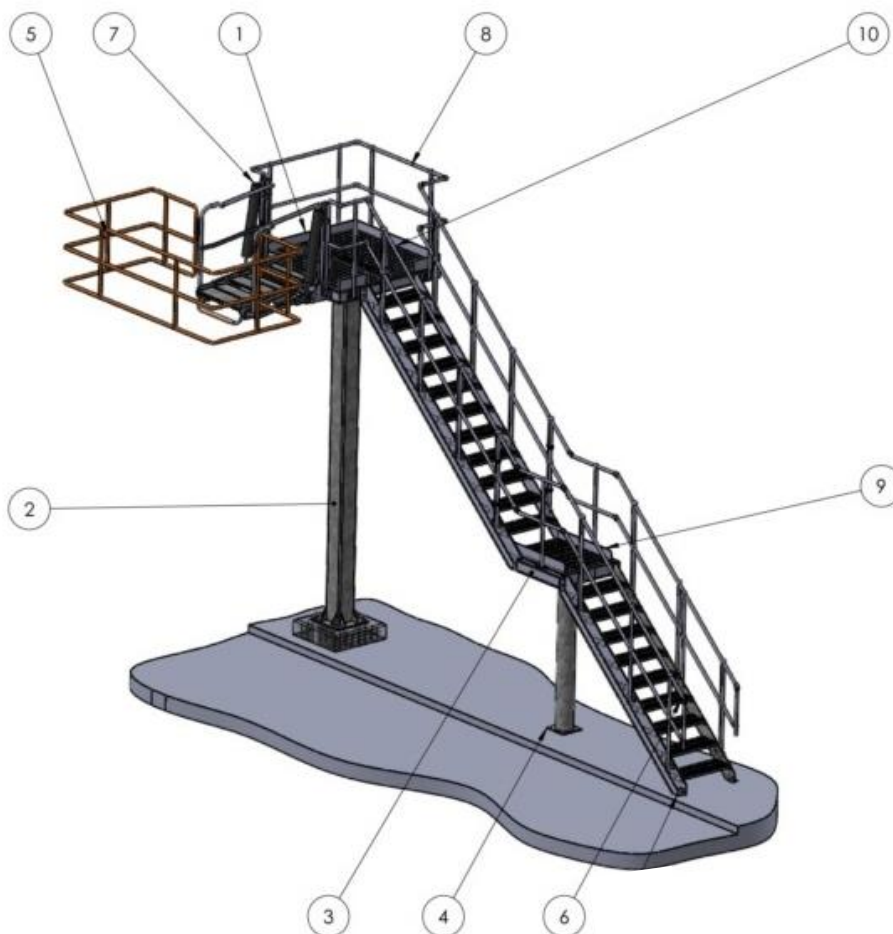

ITEM NO.	DESCRIPTION
1	LP1600 LOADING PLATFORM
2	MAIN SUPPORT COLUMN
3	INTERMEDIATE PLATFORM IF REQUIRED
4	INTERMEDIATE COLUMN IF REQUIRED
5	SC1428 SAFETY CAGE 1400 x 2800
6	STAIR TREAD - OPEN MESH
7	FS1250 '3 STEP' FOLDING STAIRS
8	HANDRAIL ASSEMBLY
9	INTERMEDIATE FLOORING ASSEMBLY
10	MAIN FLOORING ASSEMBLY

For all **YOUR** tanker access solutions



INDUSTRIAL FLOW CONTROL LTD, 3 RYDER WAY, BASILDON, ESSEX. SS13 1QH. UK

T: +44 1268 596900 **E:** sales@IFCinflow.com