

Project Profile : Flexible dining space

- **Client:**
West Sussex County Council
- **Location:**
Durrington First and Middle School
- **Lifespan:**
40 + years
- **Completion date:**
June 2012
- **Size:**
192 m²
- **Project cost:** Typically £345 k
(excluding ground works)



Fordingbridge were commissioned to design and build this flexible dining space as part of a government initiative to provide hot meals to primary school children across the country.

The turnkey project was finished on time and on budget in June ready for new hot meals to be served up in September.

The finished building comprises a kitchen space, toilet facilities and a large dining hall which can be divided using a folding wall into two independent teaching spaces.

An eye catching colour scheme echoes the school's blue uniform, and an attractive curved canopy provides solar shading in summer.

The finished product is one which has transformed the school's offering to parents and children, and is a flagship for permanent, inspiring modern construction in the county.

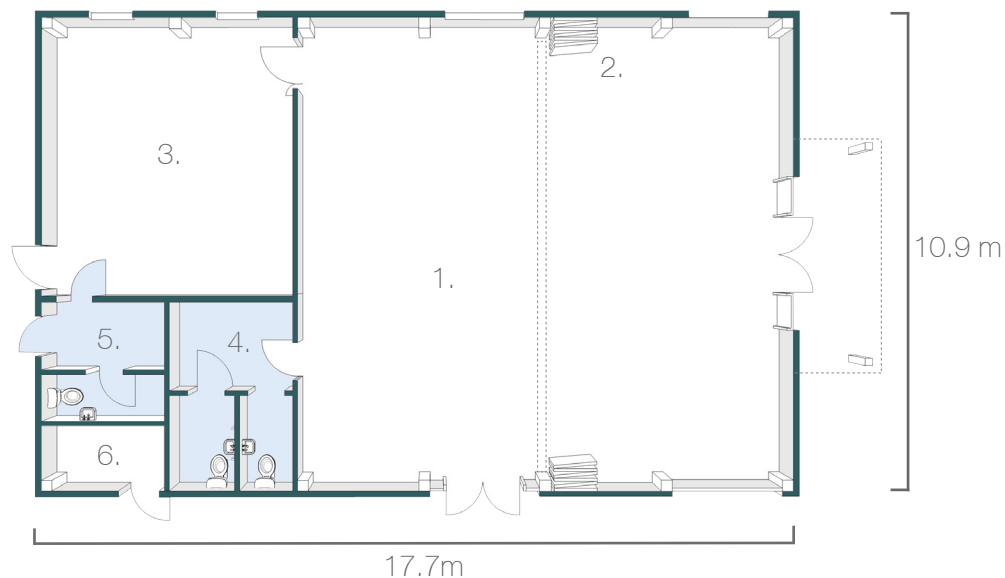

1. Flexible dining space
2. Folding wall creates two separate teaching spaces.
3. Kitchen
4. Cloak room and WCs
5. Changing area and
6. Plant room



At Fordingbridge we offer a turnkey solution taking your project from concept to completion...

- Initial consultation
- Feasibility
- Design & Planning
- Construction
- Completion



Simplicity in Construction

We use a tried and tested construction method, with standardised components manufactured off site. The minimal use of wet trades means buildings can be occupied within weeks rather than months.

EPC- Energy Performance Certificate



Sustainable, energy efficient & cost effective.

At Fordingbridge we believe that all buildings should be intrinsically sustainable no matter what the size, use or budget. Here are a few design aspects that ensure that our buildings are not only welcoming places for our clients but are also extremely energy efficient and cost effective:

- Curved sustainably sourced FSC laminated timber frame. Timber makes a great natural structural material with an excellent strength to weight ratio.
- Low maintenance, highly insulated composite wall and roof panels, minimise heat loss from the building. Our construction teams pay particular attention to sealing the buildings for air tightness to avoid warm air escaping.
- Fordingbridge use argon filled double glazing with a low emission coating as standard in all of our buildings. This provides an exceptionally low U-Value, meaning very little heat can escape from the building.
- Natural ventilation: a passive ventilation system and opening windows provides enough fresh air to remove the need for mechanical ventilation.
- An underfloor heating system supplied via an air source heat pump, provides heating with an extremely low energy demand.