

BARRIER BY DESIGN

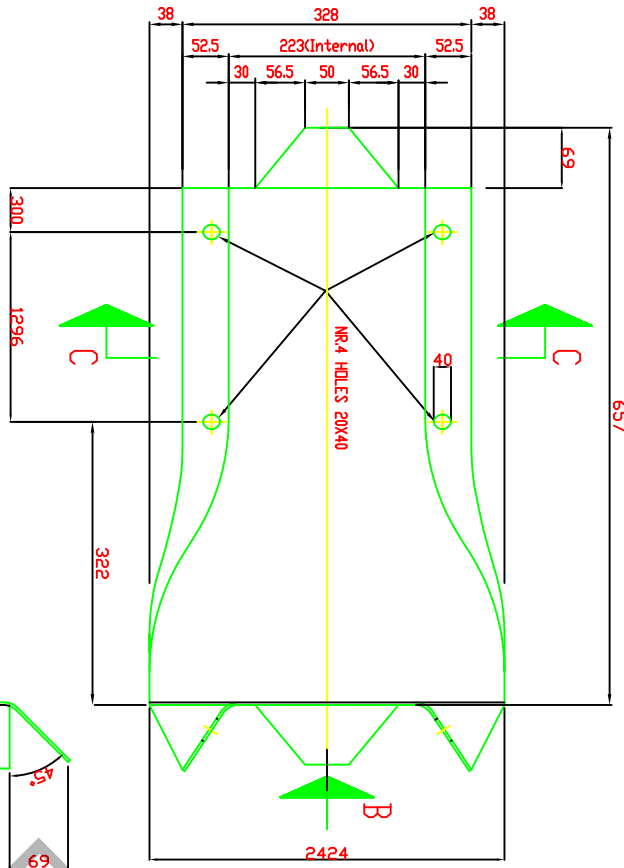

VIEW 'B'

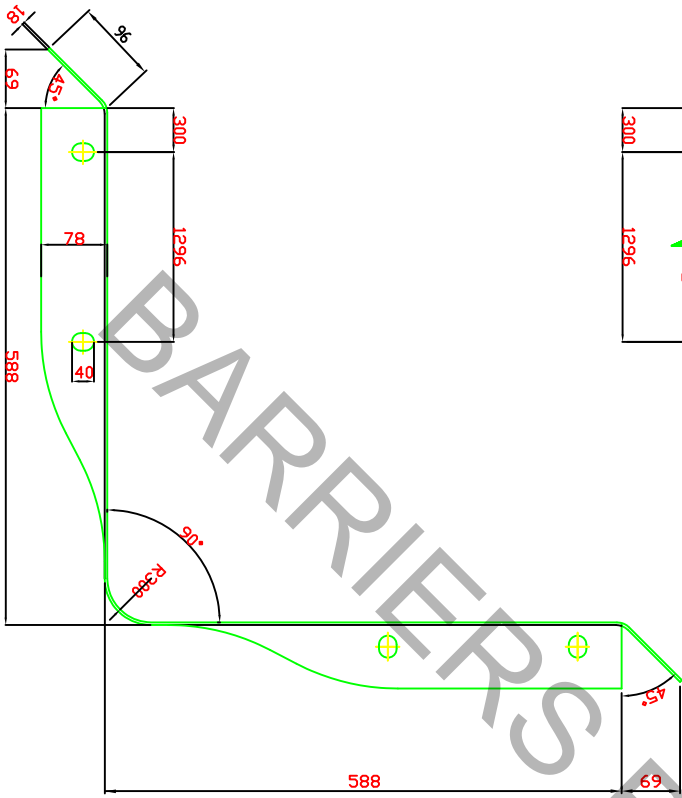
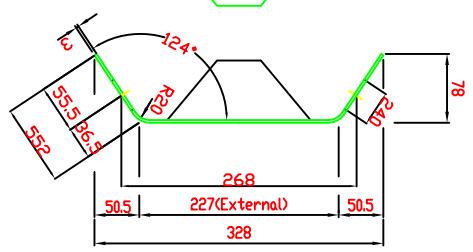

SECTION C-C

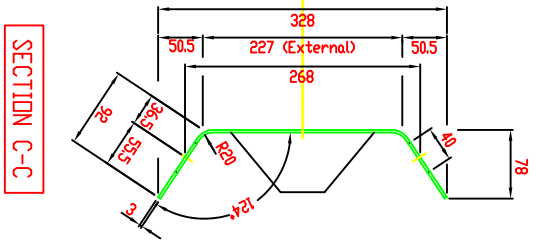
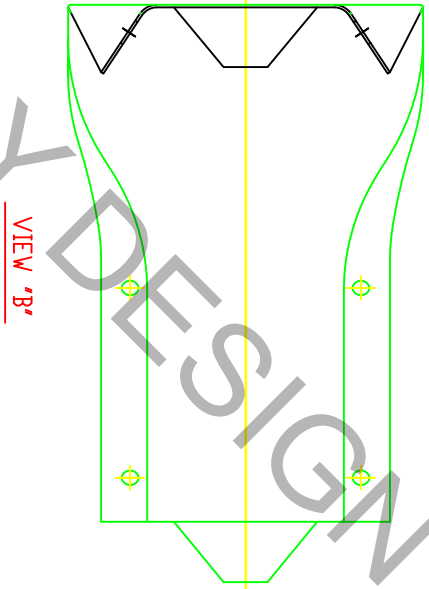
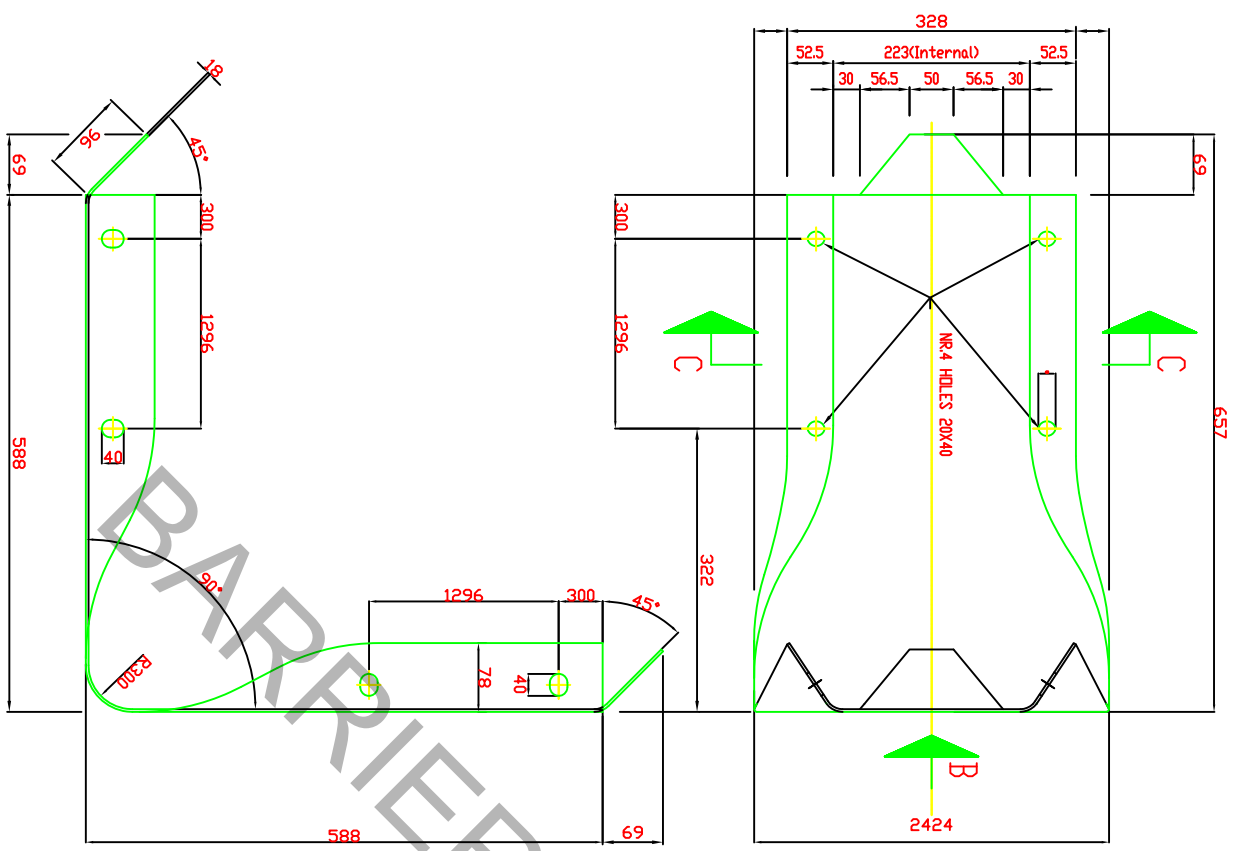

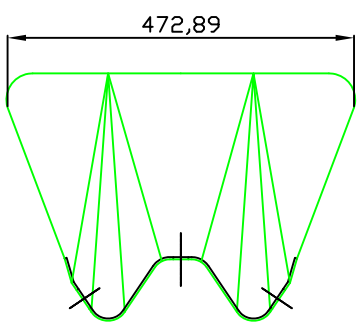
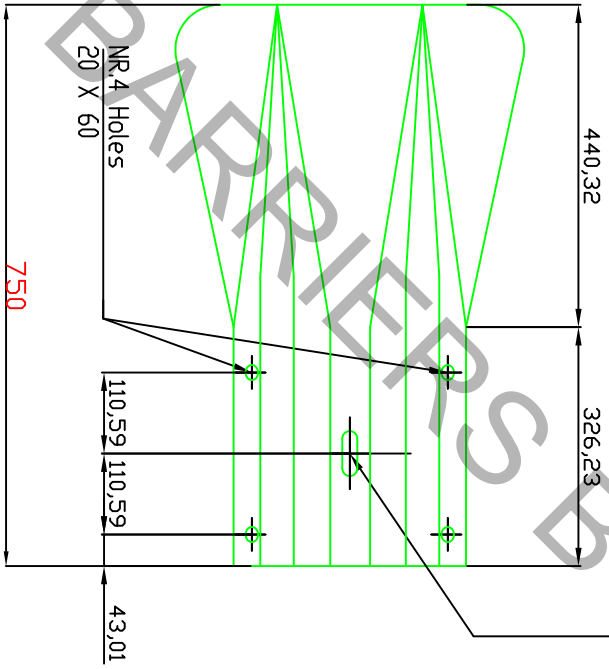

HOLE 20 X 60

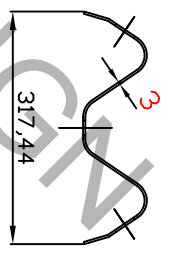
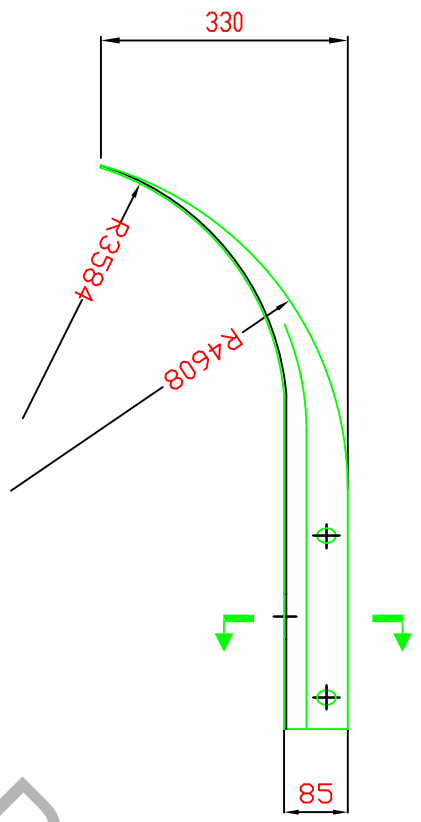

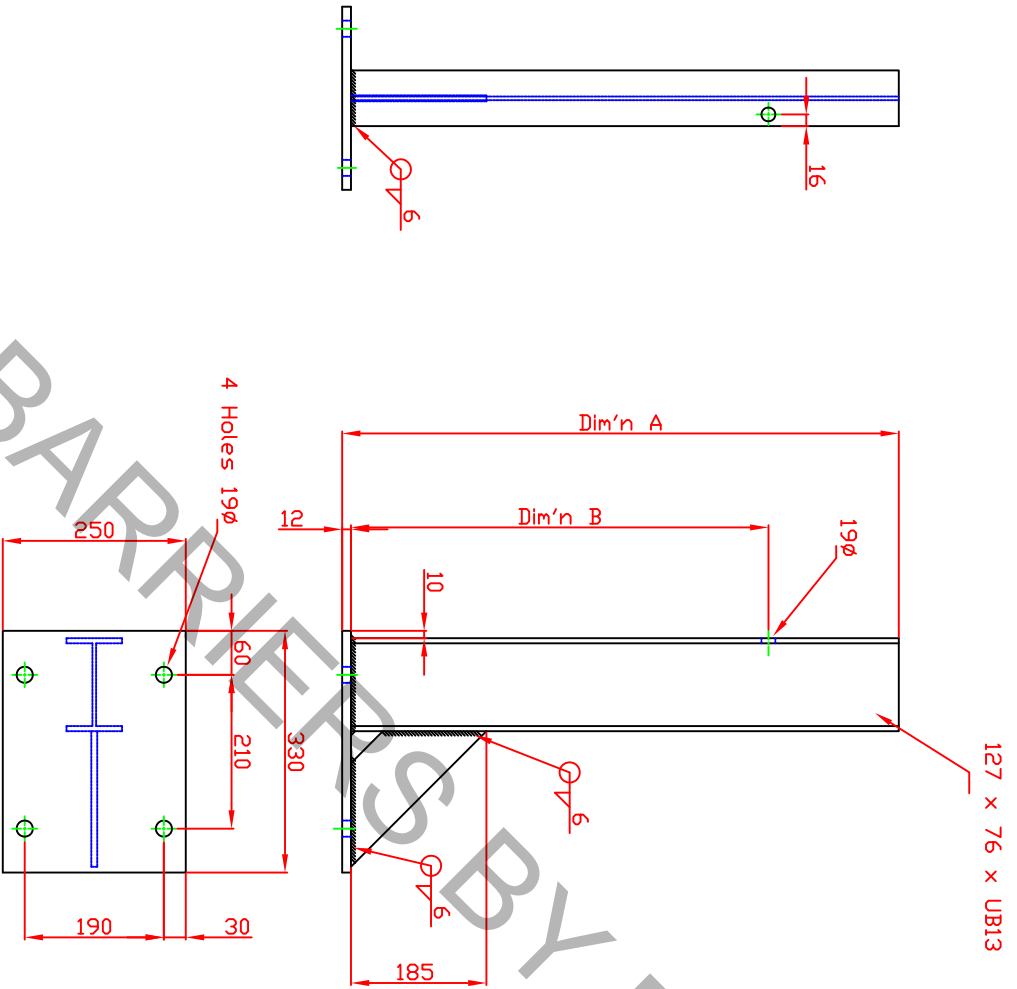

Des No	Type	Dim'n A	Dim'n B
SBD560H/D	P224-1	560	370
SBD760H/D	P224-2	760	570
SBD900H/D	P224-3	900	810
SBD1000H/D	P224-5	1000	810
SBD1100H/D	P224/6	1100	910
SBD1200H/D	P224-7	1200	1010
SBD1260H/D	P224-8	1260	1070
SBD1300H/D	P224-4	1300	1110

NOTE
 The actual cut length of the leg is minus 12mm from Dim A to allow for the footplate.

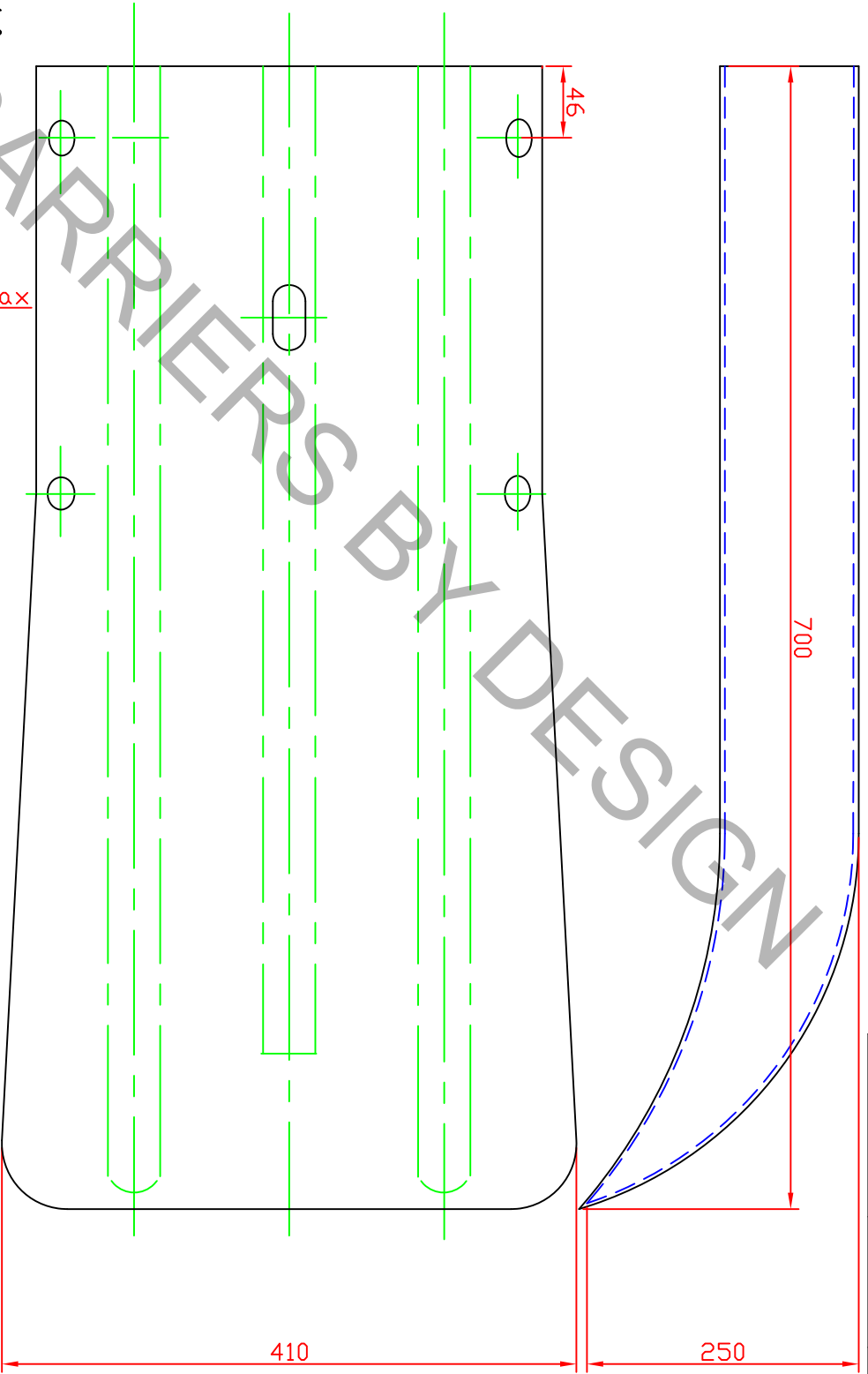
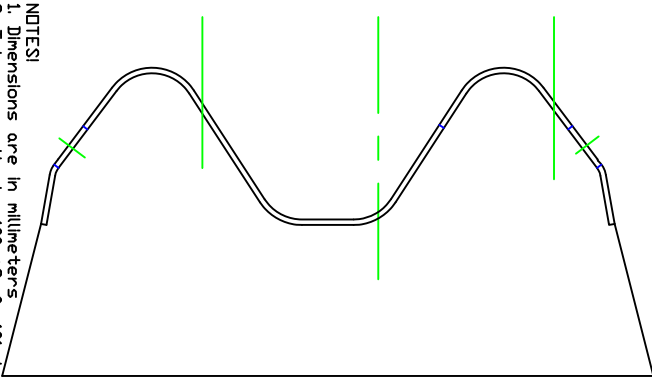
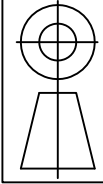

- NOTES:
1. Dimensions are in millimeters.
 2. Tolerances: Up to 400 +2, 0; 401 to 800 +4, 0; 801 and over +6, 0. Except where otherwise stated.
 3. Remove all burrs and sharp edges.
 4. Durably mark manufacturers ID, and date.
 5. Traffic face of beam to be straight within tolerance shown.
 6. The sections of the beam profile between radii shall not deviate from a straight line by more than +/-1.

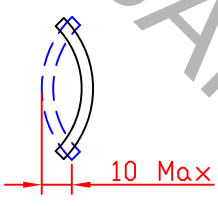

Material Type	Mat'l Size	Qty
BS EN 10	C/Barrier	1

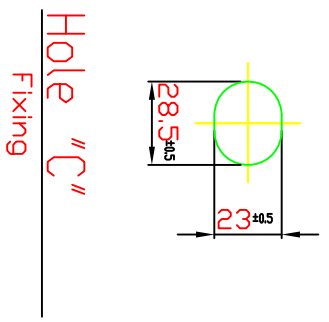
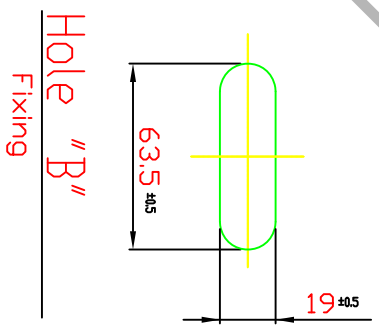
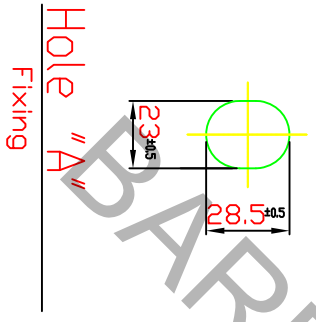
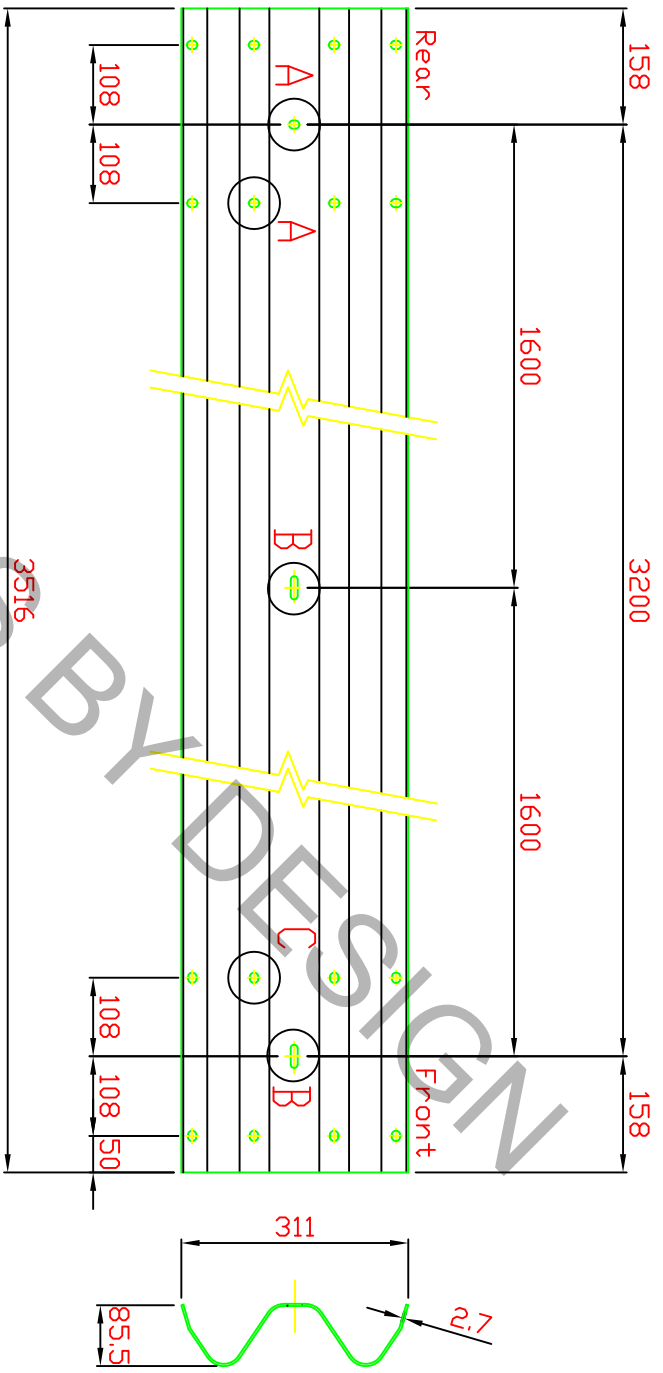

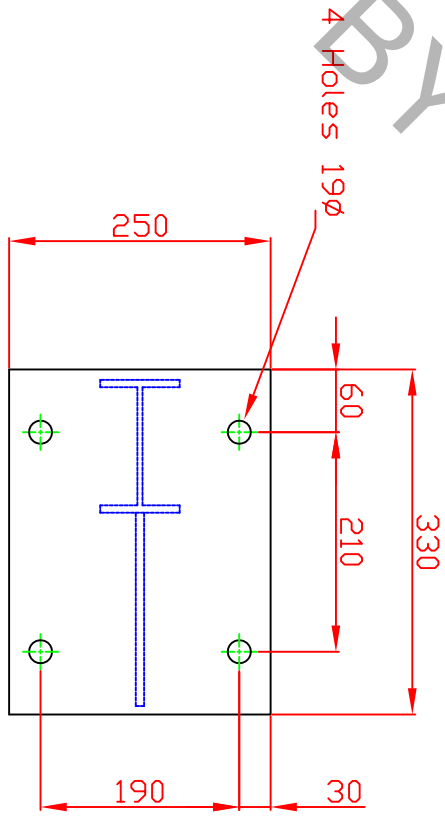
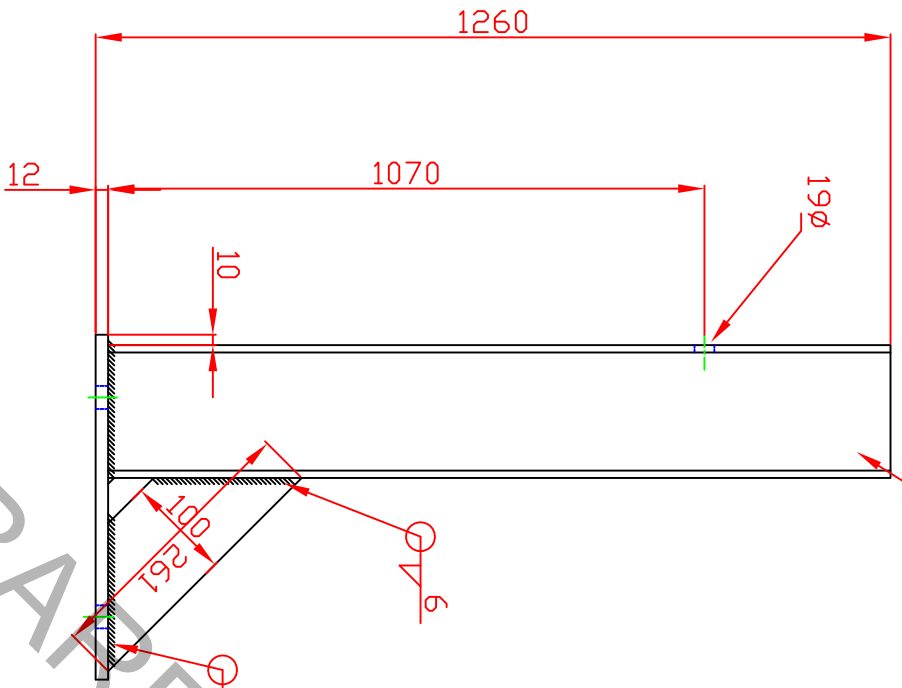

BARRIERS BY DESIGN

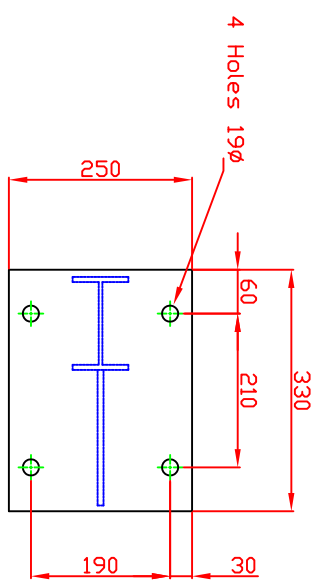
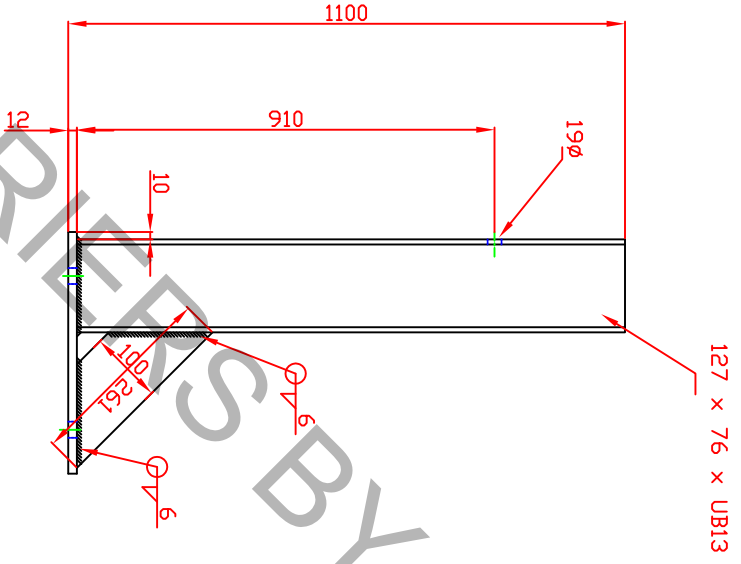
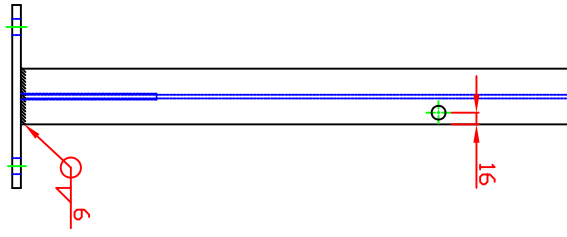

BARRIERS BY DESIGN

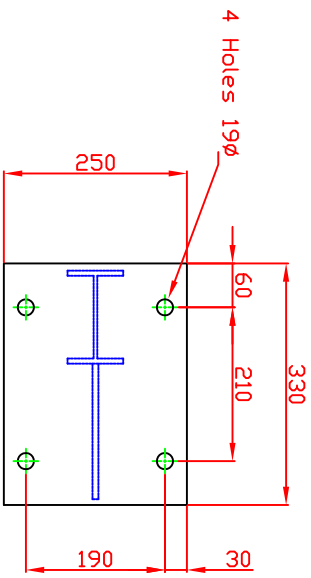
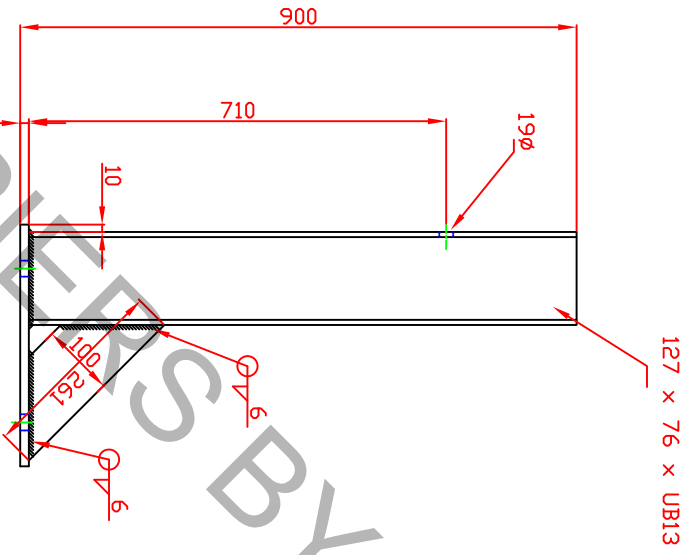
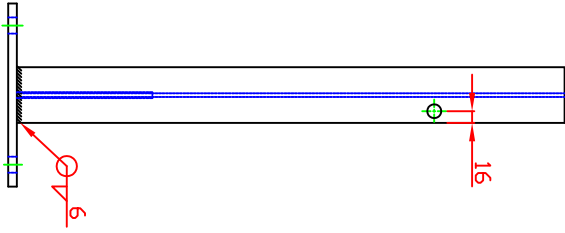

BARRIERS BY DESIGN

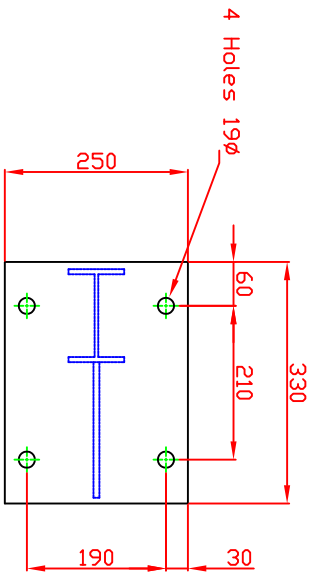
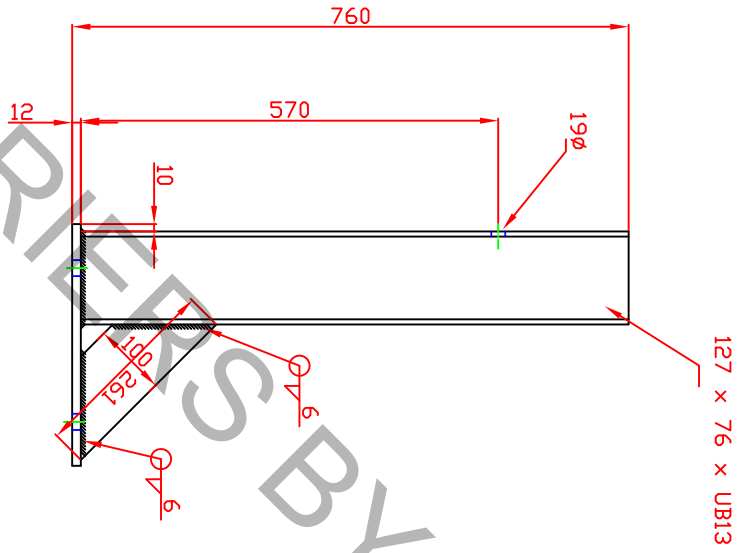
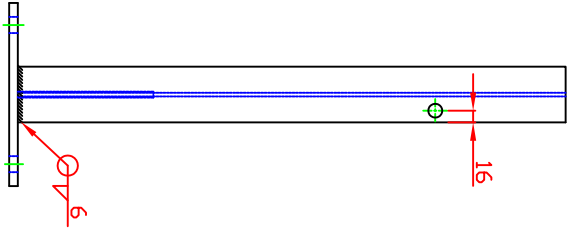

BARRIERS BY DESIGN

