



Creative
Space Solutions



Moveable Walls • Sliding Partitions



Becker (Sliding Partitions) Ltd.

Wemco House, 477 Whippendell Road,
Watford, Herts WD18 7QY

t 01923 236906 f 01923 230149

email: sales@becker.uk.com

www.becker.uk.com

Moveable Walls
Sliding Partitions

A photograph of a modern office interior. In the foreground, a large, semi-transparent glass partition is visible, with a close-up of a person's face looking through it. The background shows a long, bright office space with a red accent wall, a long white conference table with black chairs, and various workstations with desks and computers. The ceiling has recessed lighting.

**Quality and experience
in space management**

Becker has been established since 1986 and today we offer one of the widest ranges of sliding folding partitions and moveable walls in the country. Our commitment to delivering a first class product with a first class service has placed us at the forefront of our industry.

Becker (Sliding Partitions) Ltd. is supplied by the Becker factory in Germany and also factories in the UK, Holland, Sweden and Finland. By selecting specialist manufacturers to produce systems to our exacting standards, we are able to offer a wide choice and thereby ensure that our customers receive the best system to meet their particular requirements.

We are pleased that much of our work is repeat business or based on recommendation.



Over the years we have built up an impressive portfolio of clients including some of the country's leading companies and institutions e.g. Tesco, Marks and Spencer, John Lewis, IBM, Barclays Bank, Ford Motor Company, British Aerospace, The Eden Project, Oxford and Cambridge Universities, The BBC, Government Offices in Whitehall, as well as many schools, hospitals, churches and community centres etc. throughout the Country.

Barclays Bank,
City of London



Monoplan

A top hung moveable wall system with individually operated interlocking panels that have retractable seals top and bottom. It has the appearance of a permanent wall when closed

4 - 13



SM Folding Walls

A top hung or floor supported hinged panel system that offers excellent levels of sound reduction. The system is custom made to order and panels vary in width from (approx) 500-925mm

14 - 19



Harmonika

A top hung or floor supported concertina system available with a vinyl or hard faced finish. The vinyl option is the most economic in our range. The system is made to measure and is available in a number of levels of sound reduction

20 - 23



Versiplan

A top hung or floor supported concertina system presenting a flat elevation in the closed position. The system is hard faced and offers a good range of acoustic levels

24 - 25



Uno & Duplo

A top hung system available in single or double skin format. The shell construction of the Duplo offers good levels of sound reduction. The Uno is the most economical solution when a hard faced finish is required

26 - 29



MonoGlass

Widely used in restaurants, storefronts and office environments. Constructed from toughened glass panels and available in moveable, folding, fixed and sliding wall configurations

30 - 33



Sunflex

This fully weather-rated glazed system, offering high levels of thermal efficiency, is manufactured in aluminium or timber. Used in both the commercial and domestic market, the system maximises the full opening potential of any aperture

34 - 35

Monoplan

The Monoplan is a top quality moveable wall system that allows you to optimise the use of available space with speed and ease. This sophisticated system does not require a floor track and yet once positioned the panels form a rigid wall giving all the properties and appearance of a permanent wall.

*Education Centre,
Eden Project, Cornwall*

Monoplan

The Monoplan system comprises panels up to 1240mm wide which interlock to form a wall. Actual panel widths are determined by the site aperture, there are no standard sized panels or 'make up' panels.



Features and benefits

- Top hung system without the need for a floor track
- Retractable top and bottom seals ensure effortless movement of panels
- Combines elegance with robust construction
- Concealed or exposed panel edge profiles
- Numerous panel stacking options for complete flexibility
- Sealed for life roller assemblies provide smooth and silent movement
- The system offers various levels of sound reduction
- Extensive range of surface finishes available

Unique track and carrier system ensuring quiet and easy movement of panels

Operable top (and bottom) seals

Isolated aluminium frame construction for enhanced acoustics

Extensive range of surface finishes can be applied

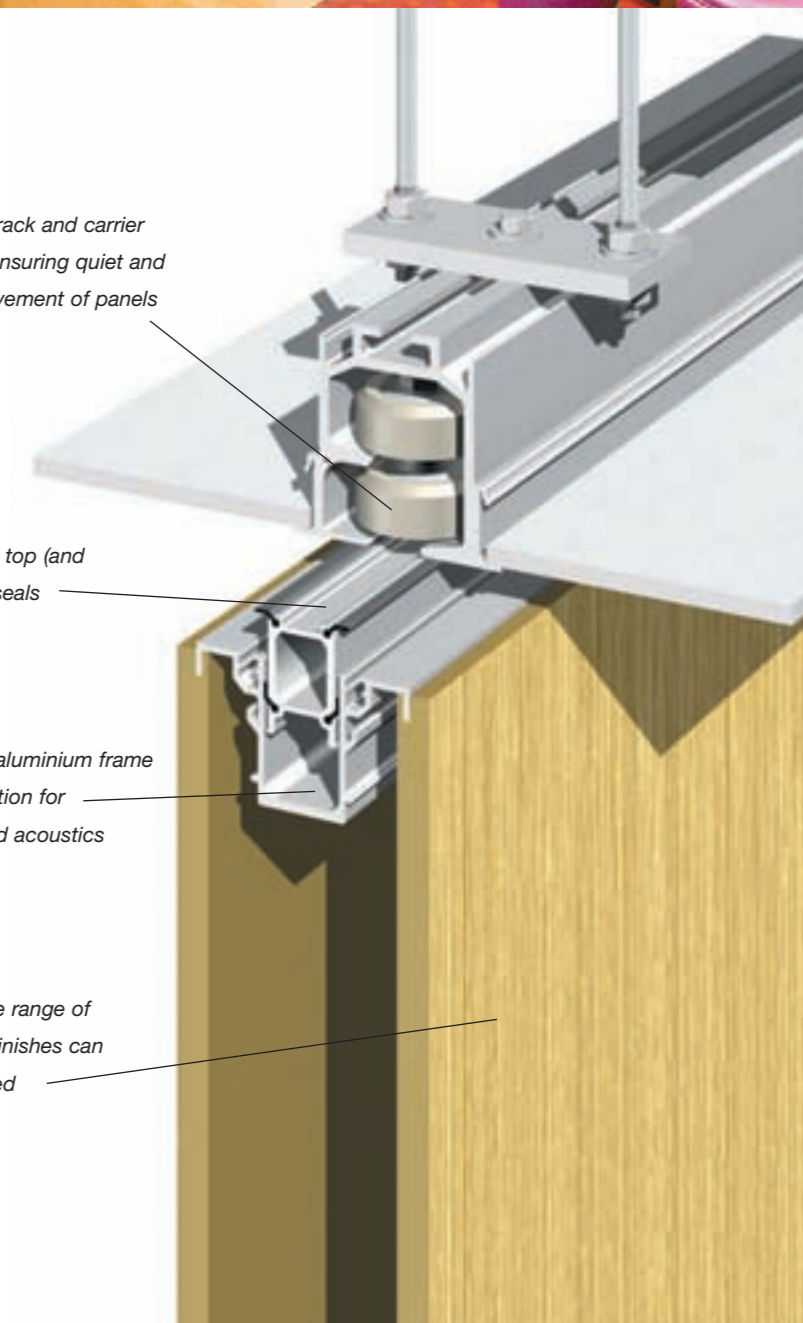



Monoplan

Bespoke solutions

Each moveable wall is specifically made to your requirements. Of course, not all walls are simple straight line divisions. Pass doors, Angles or Vision Panels may be included in the design.



Durham County Hall

Operation

When moving a wall panel there is a 20-25mm gap between the top of the panel and the underside of the head track, there is a similar gap between the bottom of the panel and the floor. Once a panel is positioned, acoustic integrity is maintained along the top and bottom of the panel by extending pressure seals. The pressure seals are extended and retracted by a single 180° turn of a removable operating handle.

Final closure of the wall is achieved by extending a telescopic sleeve on the last panel. This action simultaneously extends the top and bottom seals.

Touch Base in Swindon
Monoplan 110

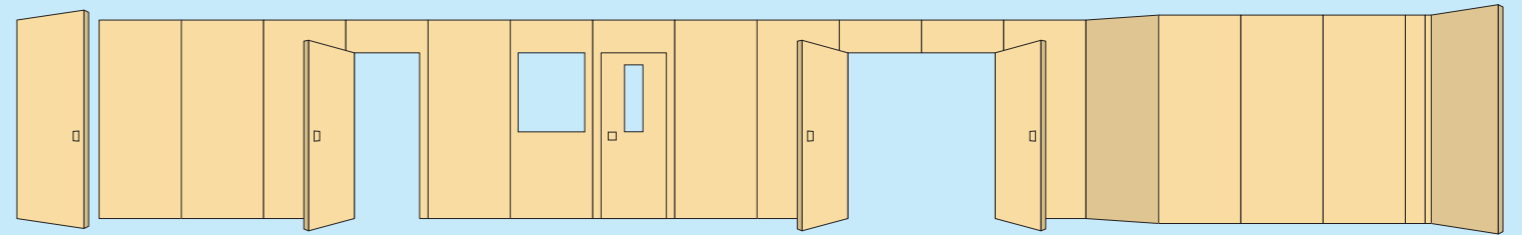

Illustrated above are some of the special features offered

Construction

Wall panels are of double skin construction with a robust internal aluminium frame. The panel faces are not 'hard' fixed to the frame and therefore when sound waves 'hit' one side of the wall the vibration caused is not directly transferred to the opposite face. Aluminium edge profiles may be CONCEALED, OR EXPOSED to provide a trim.

Heavy duty rubber gaskets are fitted to the panel profiles ensuring maximum acoustic sealing to all surrounding surfaces. The highest levels of sound reduction are achieved by

introducing rubberised bitumen membranes and mineral wool insulation to the core of each panel.

The rapid action mechanism, which operates the retractable seals, is designed to exert sufficient pressure to achieve the high levels of sound reduction offered. The retractable seals are designed to tolerate deviations in floor level and the deflections of supporting structures. The tolerance limit is evaluated for each individual application.



Hotel banqueting

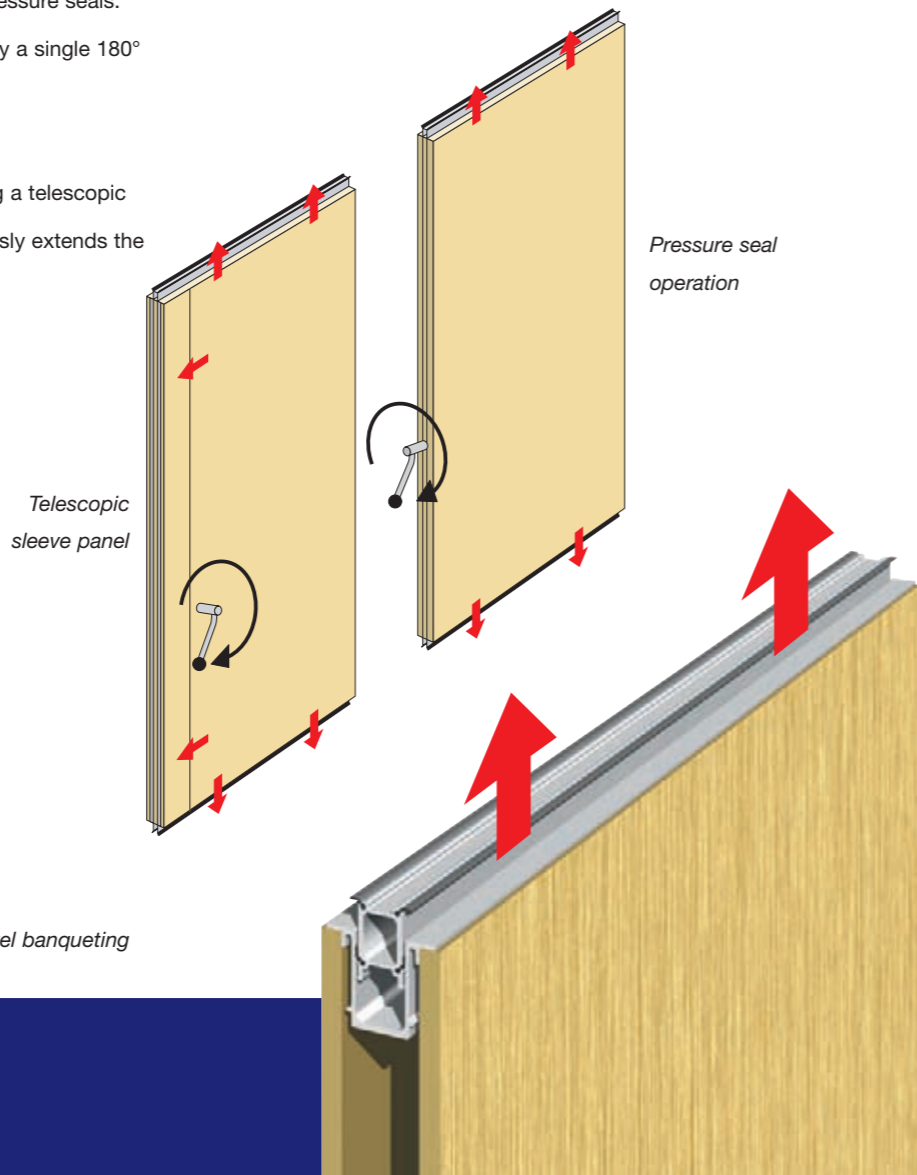

Concealed panel profiles

Exposed panel profiles



6.8m high panels with a single central roller

Monoplan

Panel Stacking

Panels with double rollers can be stacked in a variety of positions. Panels with a single roller may be parked to one or both sides of the opening

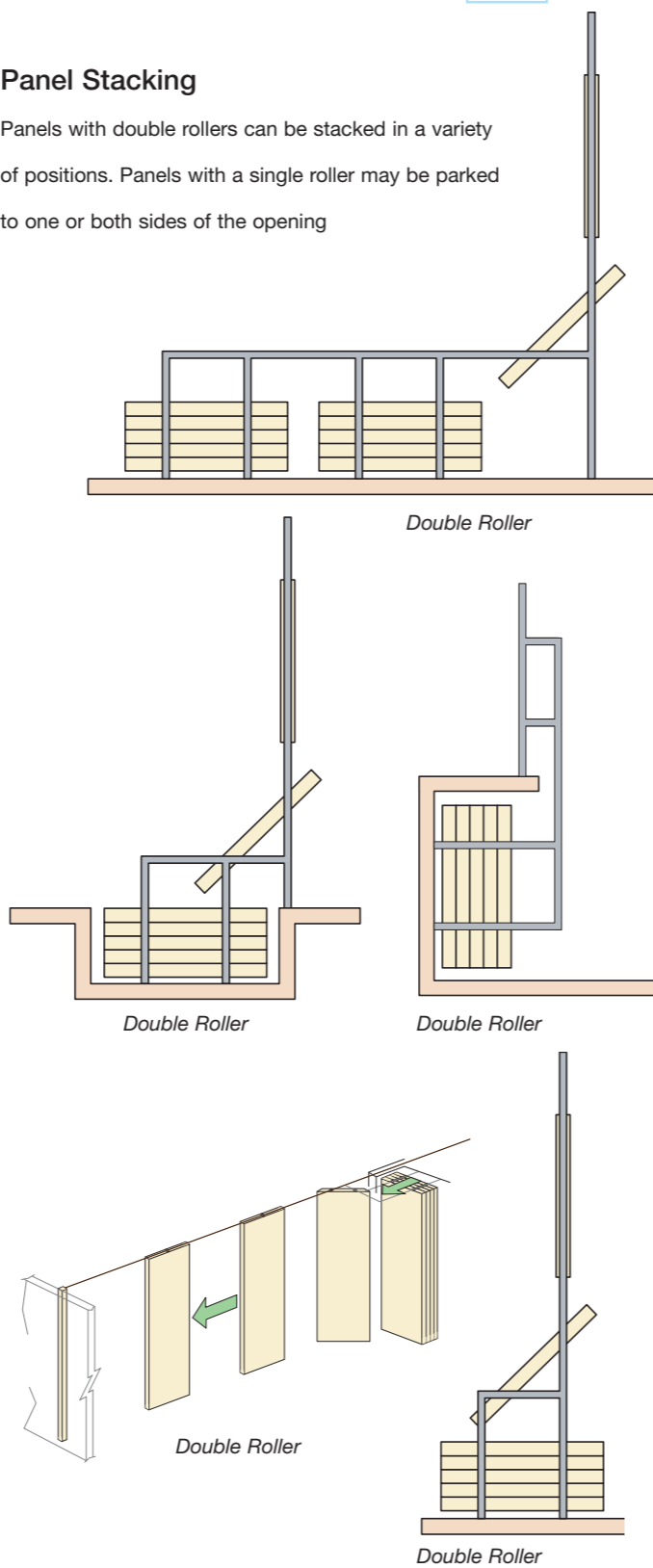

Panel options

There are 3 panel options; Type 85, Type 100, and Type 110. Type 85 and Type 100 have an aluminium edge trim. Type 110 has a concealed profile detail allowing the face finish to return around the edge of each panel.

Track Types

There are 2 track types. One for single roller installations and one for double rollers. Each panel option may have either track type.

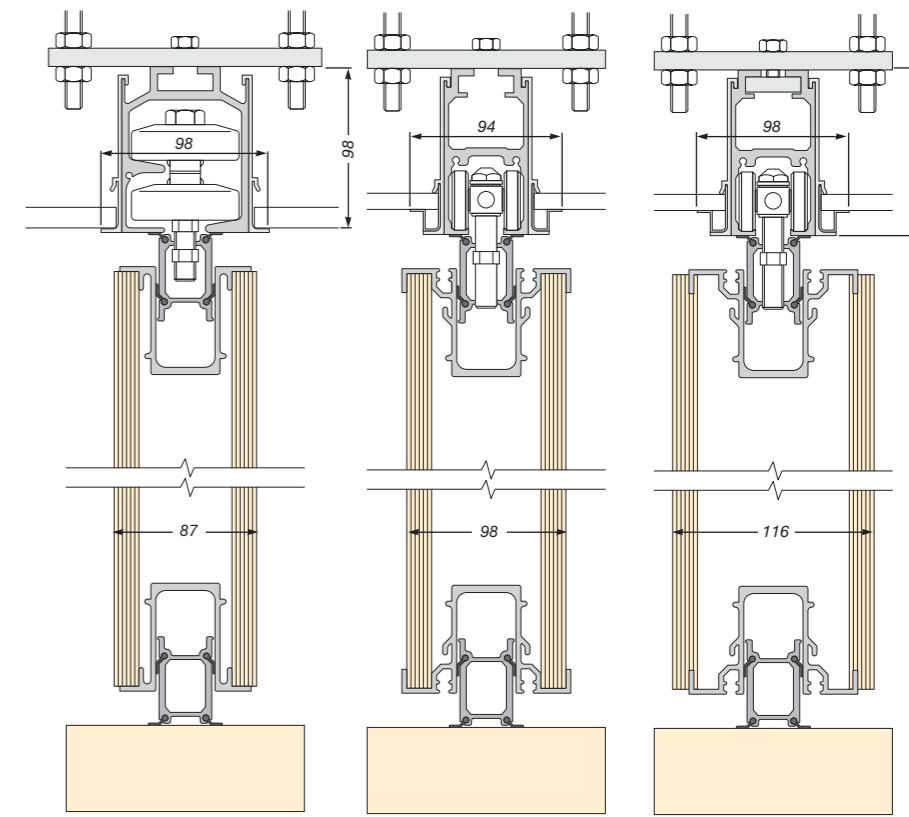

Type 85 With double roller track
Type 100 With single roller track
Type 110 With single roller track

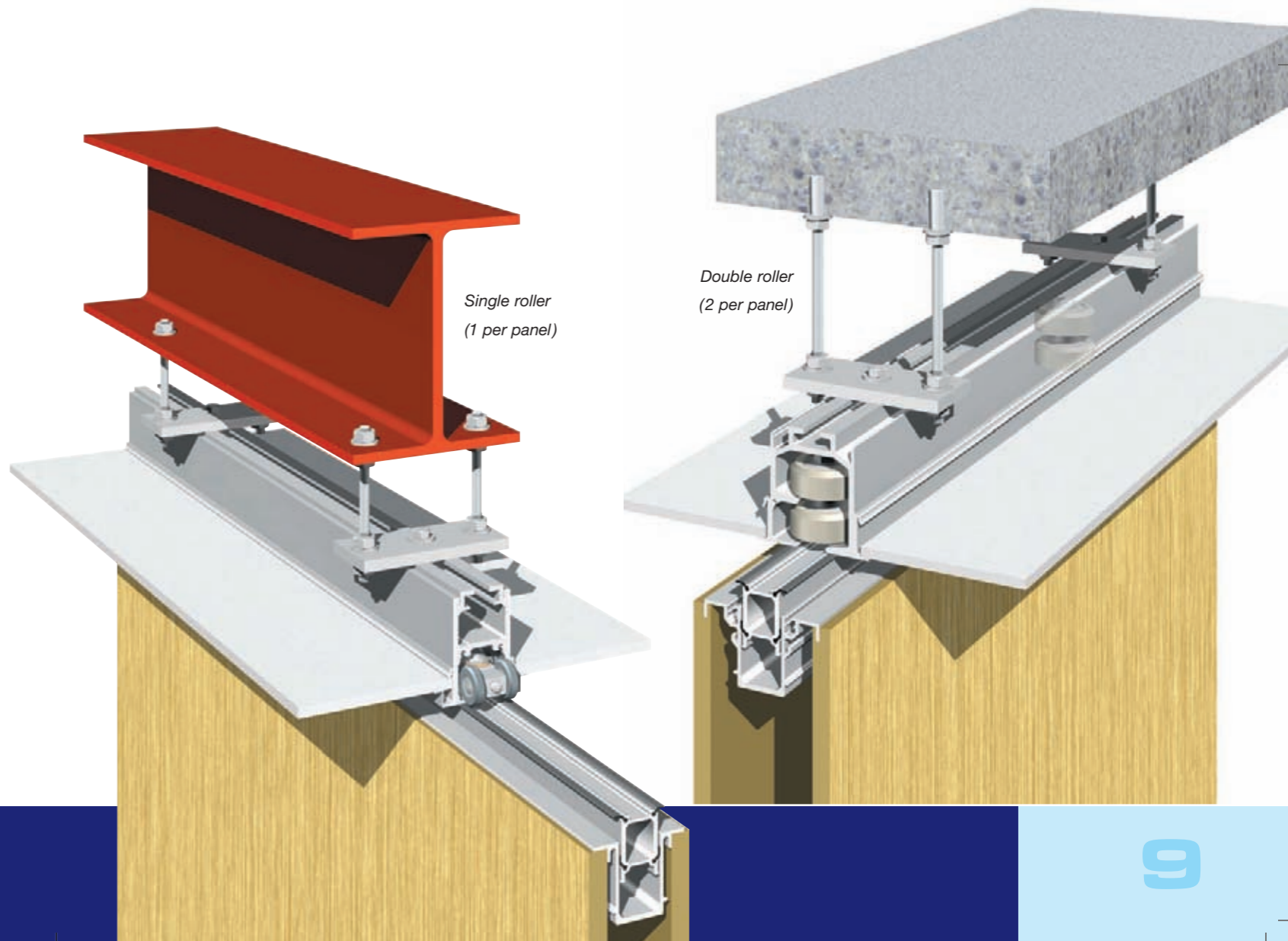

Monoplan-S



Monoplan-S



The Monoplan S is the most robust option in the Monoplan range. Panel faces are suspended from a steel frame with just 2 points of contact. The edges of panel faces are slotted into aluminium profiles. This method of cladding the steel frame allows the panel faces to be acoustically separated from each other and thereby minimises the transfer of sound waves through the system. Each panel has an extruded aluminium male profile to one vertical edge and a female profile to the other.

These profiles are fitted with magnetic membranes which ensure positive interlocking of the panels. Once the wall panels have been adjusted for height and level the roller stems are locked with a fail-safe mechanism to ensure that the panels will align perfectly every time the wall is set up. Pressure seals extend from the top and bottom of each panel exerting a closing pressure of 2kn providing panel stability and excellent acoustic sealing.

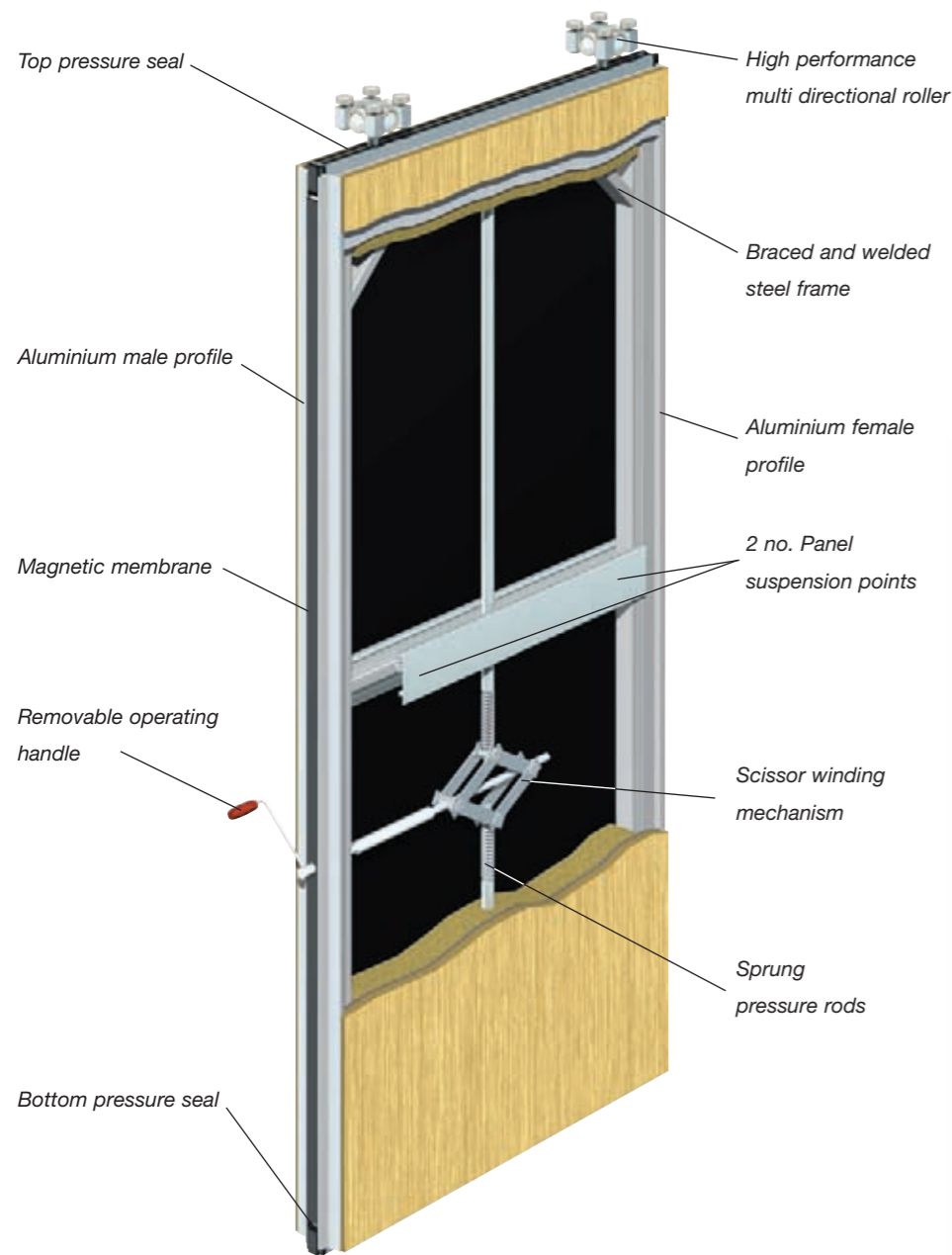

Features and benefits

- Braced and welded steel frame
- Magnetic male / female edge profiles with an attractive force of 70 N per metre
- 2kn top and bottom seal pressure
- Up to 56dB sound reduction
- Choice of exposed or concealed edge profiles
- 1 hour and 1/2 hour fire resistant options
- Demountable panel faces can be changed with ease
- Internal telescopic unit
- Fail safe lock to roller stems
- Semi-automatic option

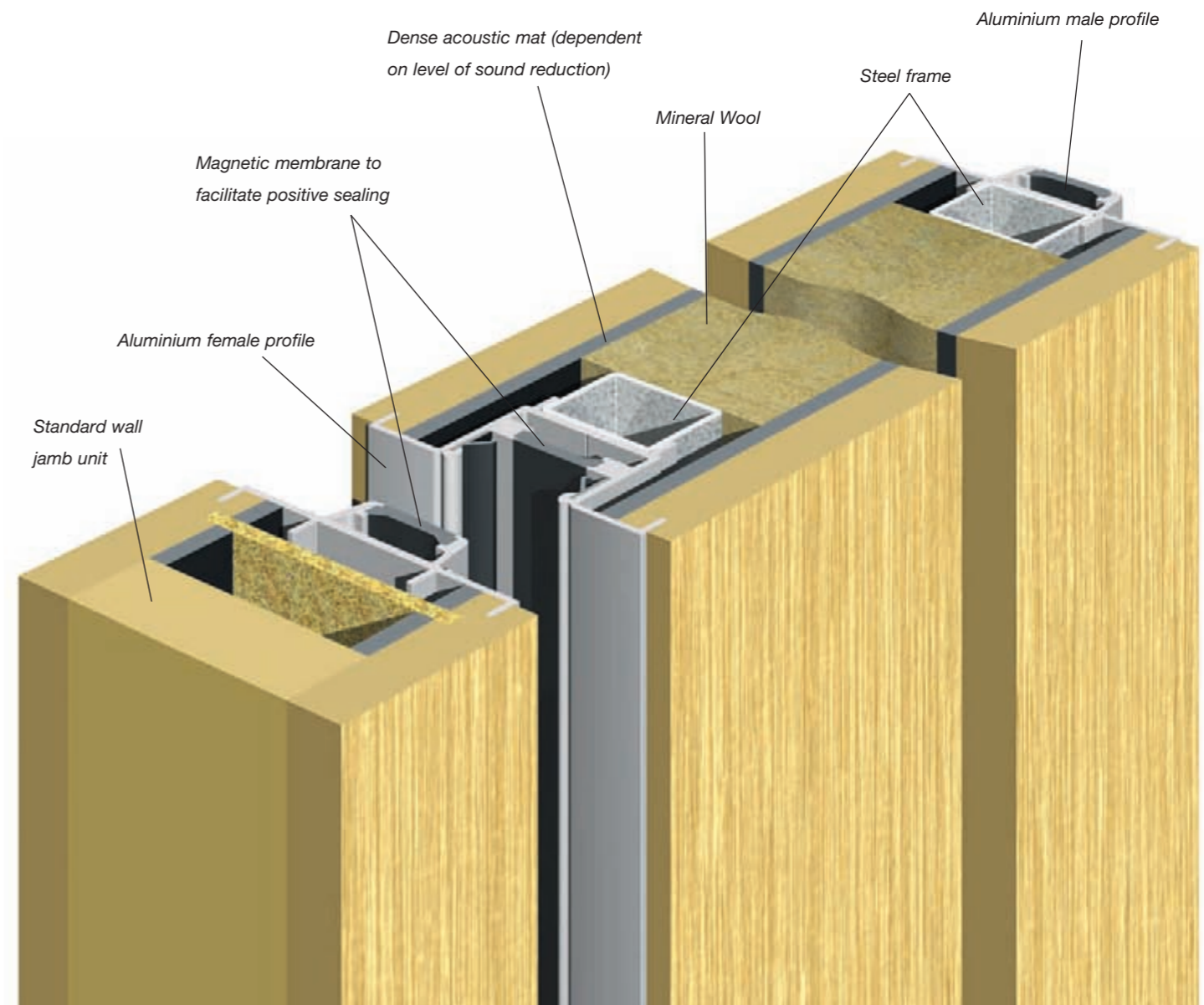

Monoplan



Aberdeen
Exhibition Centre

Product Selector

Type	Acoustic (R'w)	Thickness (mm)	Weight (kg/m ²)	Max Panel Width (mm)	Max Panel Height (mm)	Exposed/Concealed Edge Profiles
Aluminium framed						
85	37/42	87	36/43	1240	5000	EXP
100	39/46/50	97	34/45/53	1240	5000	EXP
110	37/41/45/ 50/53	116	38/42/46/ 54/57	1240	5000	CON
Steel framed						
S100K	40/42/44/ 46/49/53	100	43/44/48/ 50/53/57	1240	10,000	CON
S100U	40/42/44/ 46/49/53	104	43/44/48/ 50/53/57	1240	10,000	EXP
S130K	56	124	62	1240	10,000	CON
S130U	56	128	62	1240	10,000	EXP

Installation

Becker offer a full installation service complying with the requirements of 'FastTrack' contracts by carrying out a first fix of supports, tracks and baffles and a second fix of the finished panels.

We also offer a complete 'Turn Key' operation, carrying out the installation and all associated works (e.g. taking down and reinstating ceilings, providing primary steel supports etc.). To avoid disrupting a working environment the installation can be programmed to take place out of normal working hours, causing little or no inconvenience to the client.

Our team of fitters have many years of experience in the partition industry. We therefore offer a complete installation package including structural support, acoustic baffles, ceiling works and associated builder's works. Our prices include, off loading, haulage and the supply of all plant necessary to complete the installation.



Monoplan Type 100
finished in carpet

Finishes

Virtually any finish that can be applied to a conventional wall can be applied to the Monoplan System e.g. paint or wall covering. A large number of our installations are finished in veneer, melamine or laminate.

The Monoplan System can also incorporate skirtings, dados, presentation rails and display boards etc. Recent installations have included finishes such as chalk board, cork pin board, carpet and veneer with inlay.

Acoustics

The Monoplan System offers sound reduction levels from R'w 37 – 56dB. These levels are backed up by certificates awarded by a reputable independent body. They are not in-house tested. Full test results are available on request. (see Product Selector chart on page 12 for more details)

Fire Performance

Class 'O' or '1' Spread of Flame panels are available to your requirements. 'Monoplan Type 100 has 1 hour and 1/2 hour fire assessments.



Monoplan Type 100 with inset
display rails at Adidas offices



Monoplan Type 100 S
finished with skirting,
panelling, dado, and
wall covering.

S M

SM Folding walls

This competitively priced system combines the ease and speed of a Sliding Partition with the 'permanent' appearance of a Moveable Wall System. By the very nature of its design the system incorporates a pass door.



Typical example of an end pivot SM 3 Folding Wall



Fully glazed SM 2

Acoustic Seal located in head track

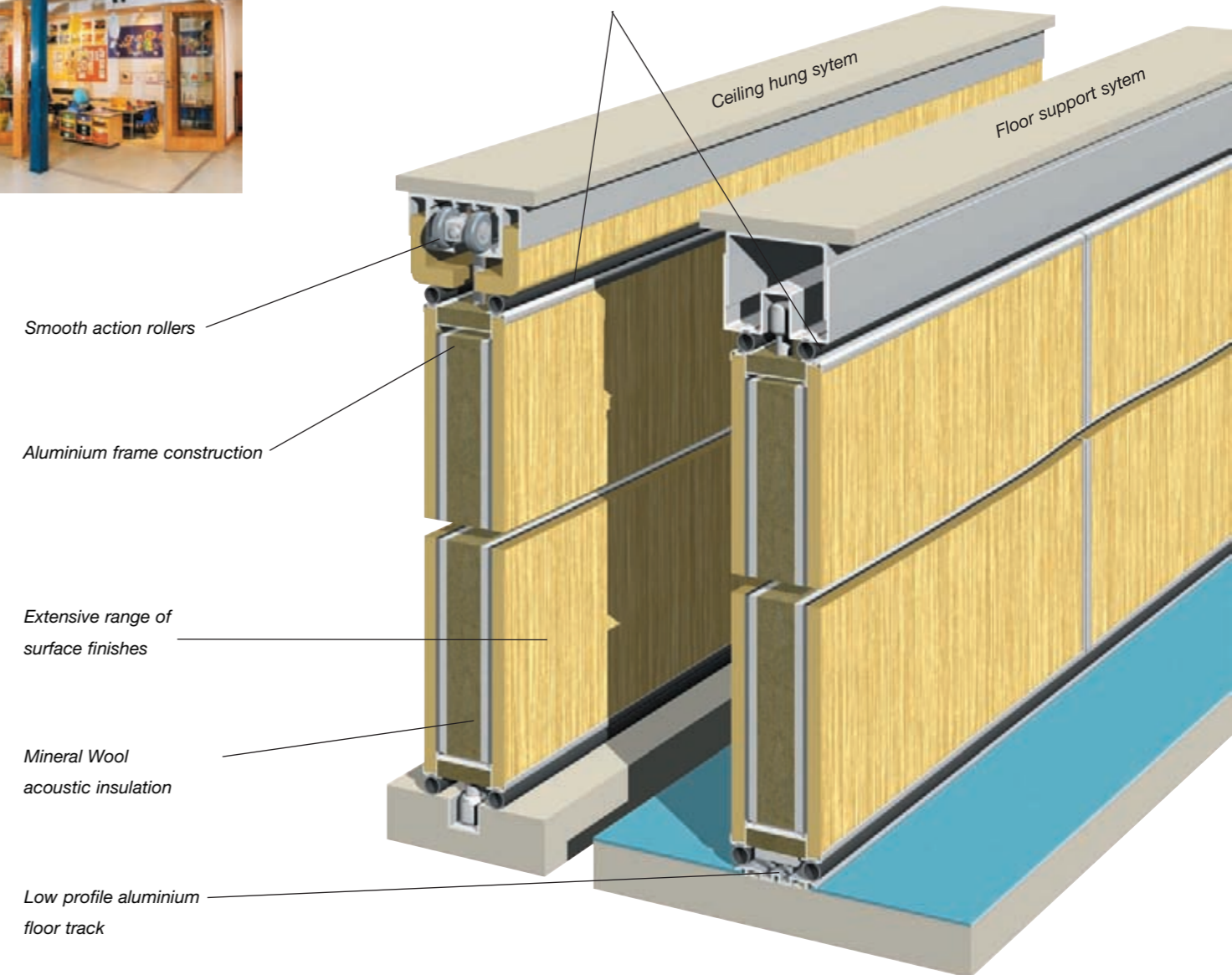

SM

SM Folding walls



Construction

Panels are aluminium framed, faced with high density particle board and edged all round with anodised aluminium profiles. Vertical profiles incorporate compressible bulb seals. Horizontal profiles incorporate sweep seals. Core materials include mineral wool and plasterboard. The floor supported option sits on a low profile alloy floor track which is no more obtrusive than carpet trim and can be easily cleaned. Each panel is framed with aluminium profiles providing protection to all edges. Profiles can be powder coated or anodised to customers choice of colour.

Bovis Construction

I have taken time out to write and thank you for your contribution on the Bluewater project. Your professional approach has ensured that your contract has run smoothly. I look forward to working with you again in the future.

Peter Chana - Project Manager

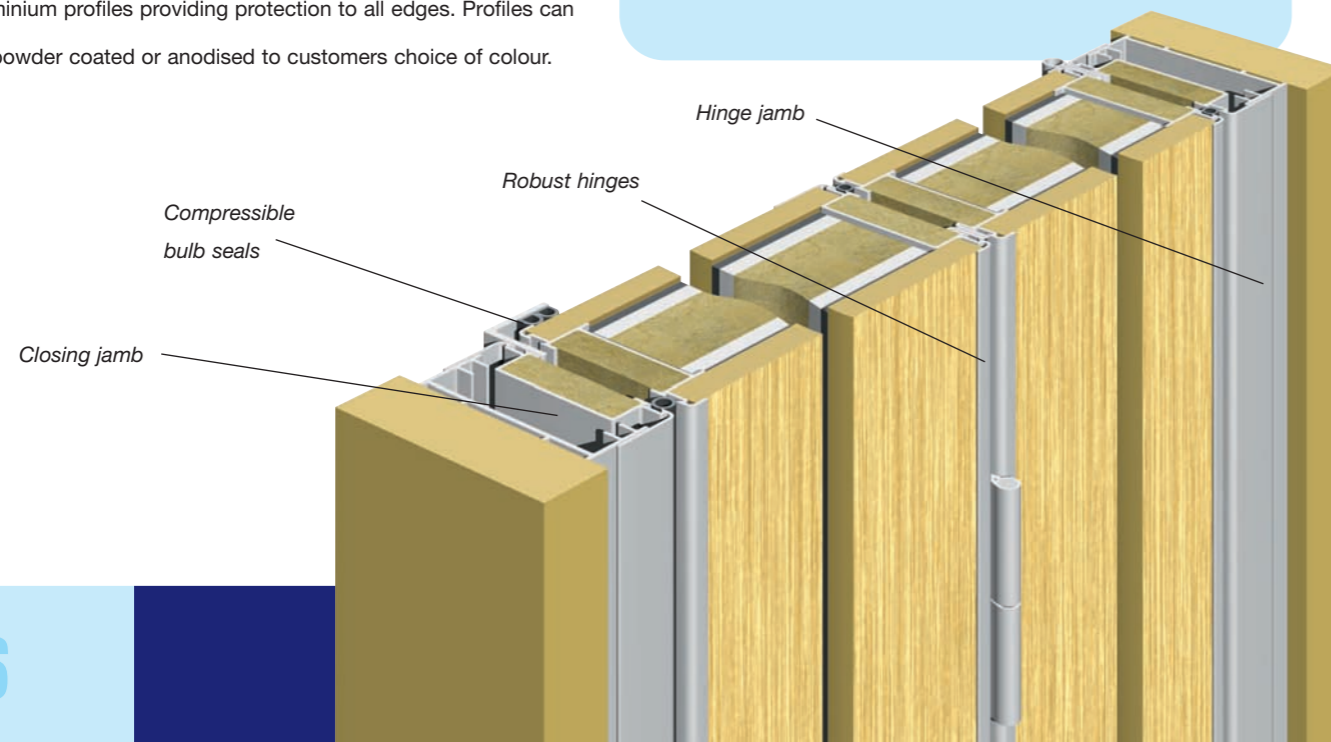

Operation

The emphasis here is on simplicity and smooth movement. The continuously hinged panels are pulled from their parked position to 'close' (or extend) the wall and pushed back to the parked position to 'open' (or fold) the wall. Final flat alignment of wall panels is assisted pneumatically by a gas piston located in

the top track. A lever or recess handle is fitted to the lead panel and this combined with a vertical rebated profile provides the system with its pass door. The door is available with or without a lock cylinder.

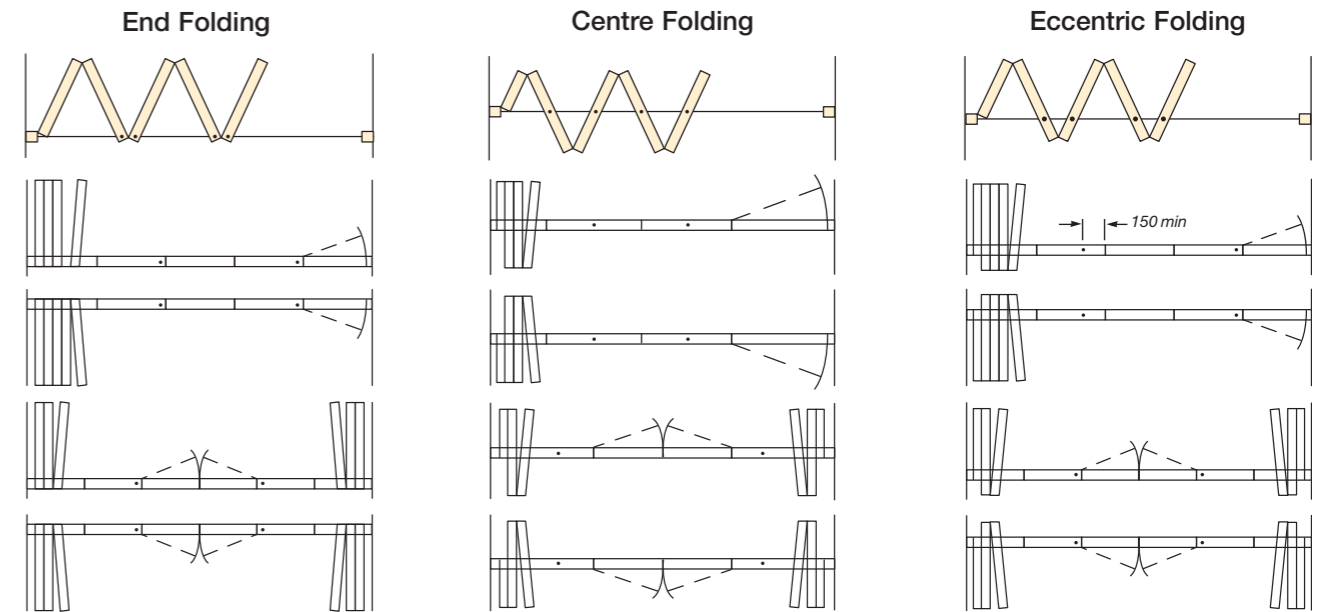

Low profile floor track

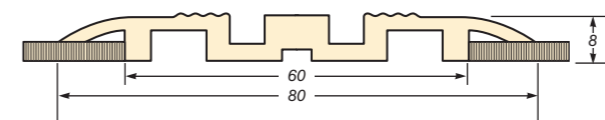

Track options

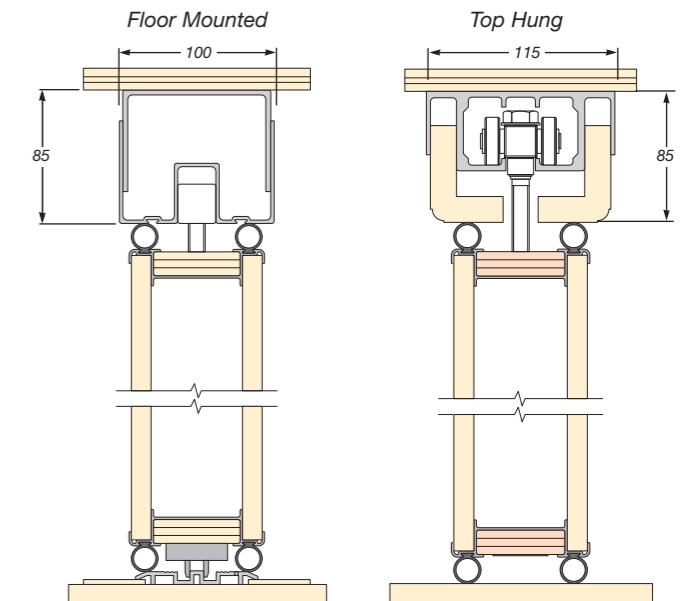

Features and benefits

- Hinged Panels for quick and easy operation
- Robust aluminium frame construction for demanding environments
- Wide range of surface finishes
- Partial and fully glazed panels available
- Pass door incorporated enabling access to adjoining rooms
- Stacks one or both ends
- Top hung or floor supported

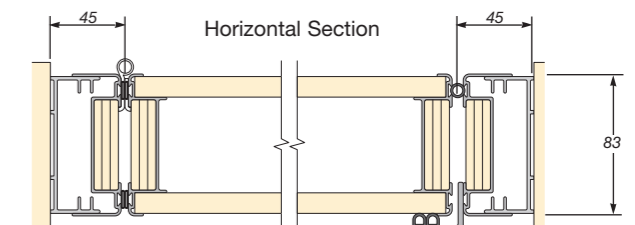

SM

SM Folding walls

Daimler Chrysler,
Milton Keynes

Synter BMW
High Wycombe



Product Selector

Type	Acoustic (RIW)	Weight (kg/m ²)	Thickness (mm)	Max Panel Width (mm)	Max Leaf Width (mm)	Max Height (mm)
SM2	38/41/42/43	24/29/34/41	67	900	7500	3500
SM3	40/46/49	27/40/54	80	900	7500	4000
SM4 30 min fire resisting	43	45	67	900	7500	3000

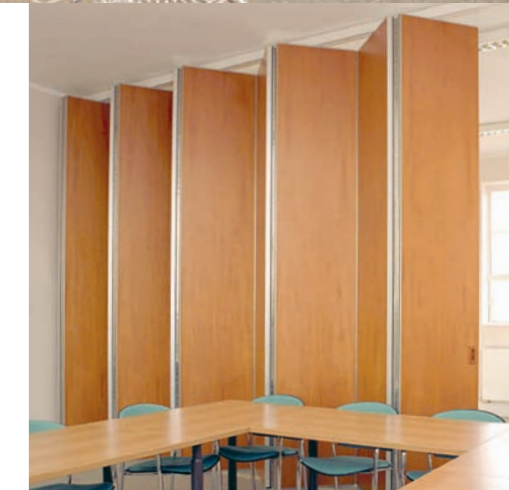

Installation

We offer a full nationwide service which includes working for main contractors or directly for the end user. When installing in an occupied area care is taken to cause minimum disruption to the client.

Design

The Company's technical advisers are on hand to answer any queries and will work with the specifier to achieve the optimum solution to the requirements of each contract.

Appearance

All walls are made to measure and are therefore in complete harmony with any given opening.

The actual panel widths depend on the number of panels. Panel widths generally vary between 600mm and 900mm.

Finishes include: a high quality spray paint to any RAL or BS colour; any commercially available veneer; wall coverings applied in the factory or on site; laminate or melamine.

Different finishes may be applied to either side of the wall. Aluminium profiles and track may be powder-coated to any RAL or BS colour.

Harmonica



Harmonica-in-vinyl

Construction

The Partition comprises an internal steel frame, upholstered with a high quality heavy duty polyvinyl cloth.

The frame consists of a horizontal series of 220mm x 76mm x 1.5mm steel plates, connected vertically with 7mm diameter steel rods. The steel used in manufacture is hot dip galvanized and distortion resistant. The frame is connected to roller assemblies which glide smoothly within a ceiling track. The frame is upholstered with a fabric-backed polyvinyl cloth which is flexible and easily cleaned. The cloth has a weight of 2600gms per square metre. To increase acoustic ratings, layers of sound absorbing materials are introduced within the partition e.g. Sheet metal, felt and dense rubberised acoustic mat. The support track, vertical-closing profiles and door furniture are finished in satin anodised aluminium.

Appearance

The durable vinyl is available in a choice of 12 colours. A carpet finish is also possible with a choice of 11 colours.

Fire performance

The Partition can be finished with a flame-retardant polyvinyl.

Installation

Becker offer a full nationwide installation service.

Guarantee

All products are guaranteed against defects in materials or workmanship, for a period of 12 months from the date of installation.

The Harmonika-in-Vinyl Partition provides the most economical solution to sub-division of areas. Partitions are custom made to your requirements. Room layouts can be altered with utmost speed and ease. The Partitions can be supplied either top hung or floor supported.

- Features and benefits**
- Quick and easy to operate
 - Supplied either top hung or floor supported
 - All installations are made to measure
 - Virtually no maintenance required
 - 4 way meeting, 90° junctions, or T junctions are possible
 - Flexible and easily cleaned
 - 15, 27 & 35 dB acoustic values
 - Pendant pulls for high installations
 - Provides the most economical solution to sub-division

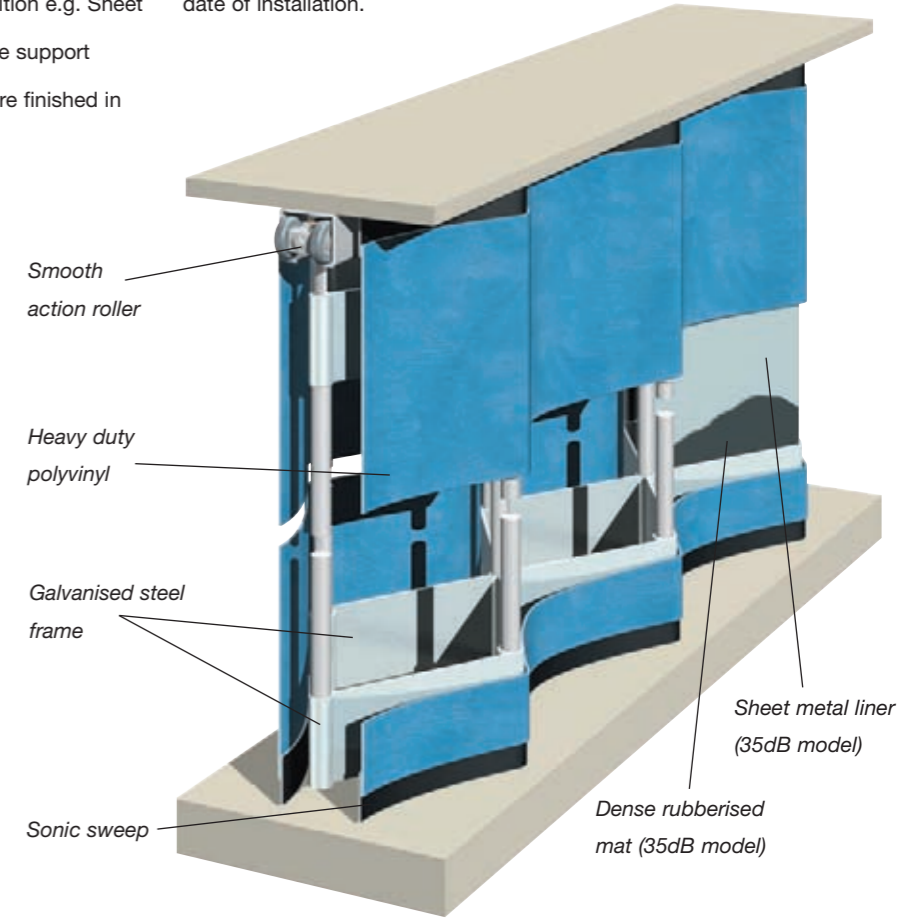
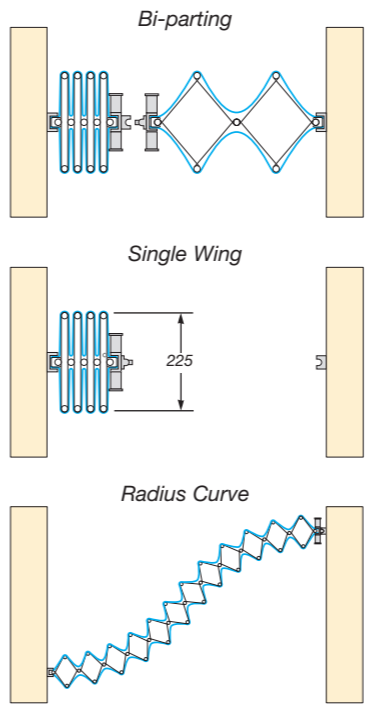

Harmonika

nica

Harmonica-in-wood



Product Selector

Type	Acoustic (RIW)	Max Leaf Width (mm)	Max Height (mm)	Stack Width (max mm)	Stack Depth (approx)	
Harmonika-in-Vinyl	15/27/35	13/18/20	5000	4200	250	15-25% of length
Harmonika-in-Wood	25/29/36/38	18/20/22/35	5000	4200	440	20-25% of length

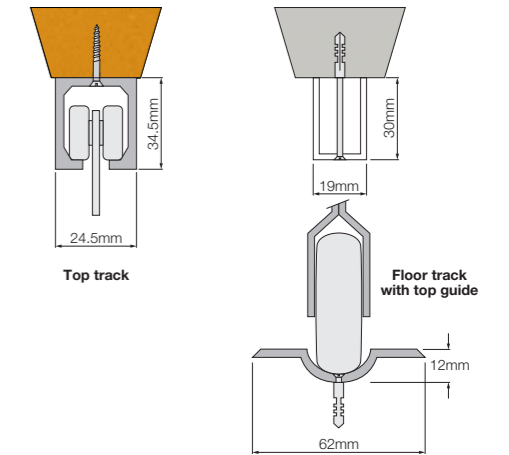

Construction

The Harmonika-in-Wood is a double shell accordion sliding/folding partition comprising an internal steel/timber lattice framework faced with 13mm high density particle board panels. No hinges are visible on the face of the partition. Durable 'sweeps' ensure acoustic sealing at the head and base. Layers of mineral wool and leaded rubber are introduced within the partition to increase the acoustic performance. The standard door furniture comprises a retracting 'claw' lock/latch set to ensure compression when closed.

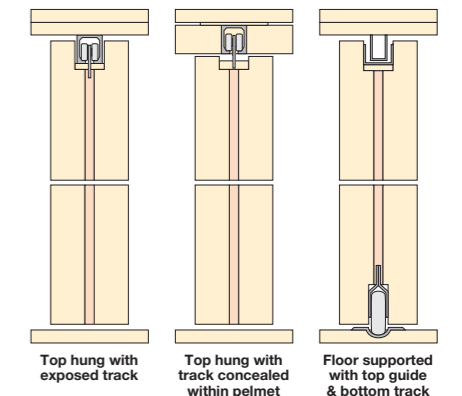

Appearance

The Harmonika-in-Wood offers an extensive variety of finishes including wood veneers, laminates, wallcoverings and paint. Different finishes may be applied to either side. The standard finish to ceiling track, leading edge profiles and door furniture is satin anodised aluminium. These may be anodised/powder coated to customers colour specification.

Fire performance

Class 'O' or Class '1' spread of flame options available.

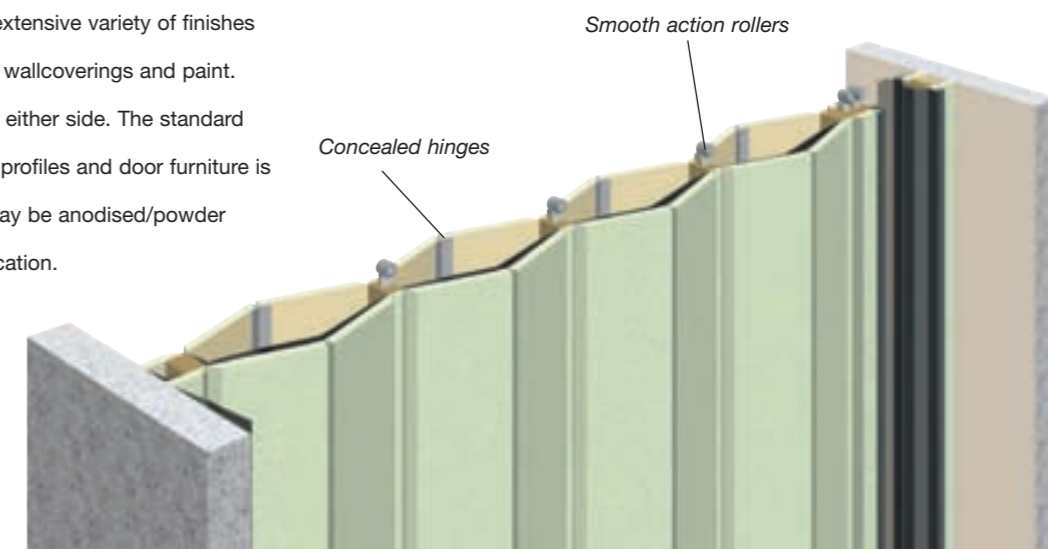

The Harmonika-in-Wood is a well proven flexible divider offering a high degree of sound reduction. The layout of any area can be altered quickly and easily. It can be top hung without the need for floor track or can be floor supported where, for structural or economic reasons, the provision of overhead support is impractical. Harmonika-in-Wood is the result of extensive technical development and is designed for constant use over many years.

Features and benefits

- Quick and simple to operate
- Extensive variety of finishes
- Double shell accordion sliding/folding partition
- Six levels of sound reduction
- Available top hung or floor supported
- No visible hinges
- Durable sweeps ensure acoustic sealing
- A folding sound barrier
- Available single wing, bi-parting or with floating sections



Versiplan



The versiplan is a high quality sliding/folding partition, which in the closed position presents a flat panelled elevation entirely free of visible hinges.

The system is available in four levels of acoustic insulation from 27dB to 36dB.

It can be top hung without the need of floor track or alternatively floor supported where for structural or economic reasons the provision of overhead support is impractical.

Product Selector

Type	Acoustic (RW)	Max Leaf Width (mm)	Max Height (mm)	Stack Width (max mm)	Stack Depth (approx)	Sound Reduction (dB)
Versiplan	27/31/33/36	25/26/27/30	5000	4200	440	20-25%

Features and benefits

- Simple smooth operation
- Available top hung or floor supported
- The system can fold back to one or both sides of the opening
- Available in 4 levels of sound reduction
- A wide selection of finishes
- The system presents a flat elevation when extended.
- Euro cylinder lock is fitted as standard
- Track can be surface mounted or recessed.

Operation

The layout of any area can be altered quickly and easily. The wall will start to fold with a single movement of the pull handle. The wall completely folded presents a shallow stack to one or both sides of the opening.

Construction

The Versiplan is a 110mm thick double shell 'plan style' sliding/folding partition. The construction comprises an internal steel and timber framework faced with 13mm high density particle board panels. Durable 'sweeps' ensure acoustic sealing at the head and base. Internally the introduction of mineral wool and joint seals increase acoustic performance.

Versiplan partitions are custom made. The modular panels are, therefore, of equal size.

Appearance

The Versiplan offers an extensive variety of finishes including wood veneers, melamine, laminates, wallcoverings and paint. Different finishes may be applied to either side of the partition. The standard finish to ceiling track, leading edge profiles and door furniture, is satin anodised aluminium. These may be anodised/powder coated to customer colour specification.

Fire performance

Class 'O' or Class '1' spread of flame options available.

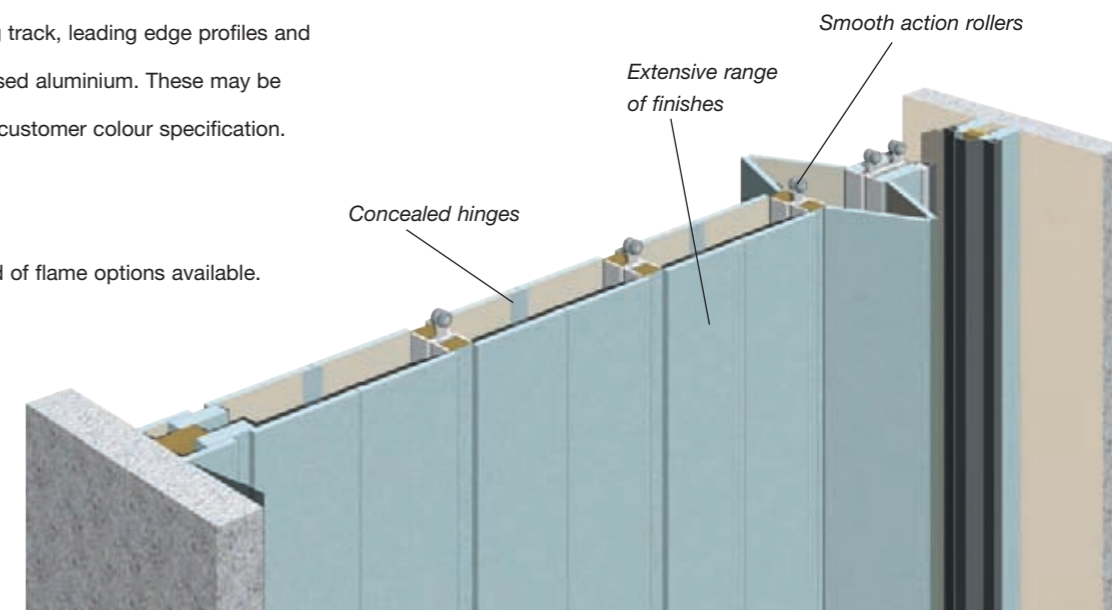
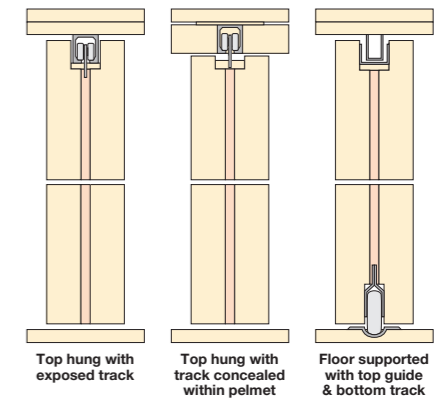
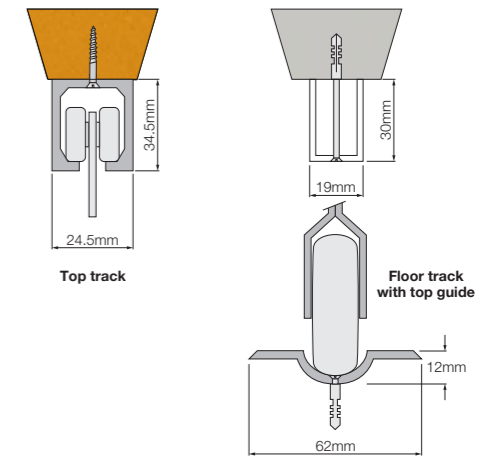



Uno

Duplo

Construction

Uno is single walled. Duplo is double walled. Both are constructed of high quality, dense, ecologically sound chipboard panels finished to suit your requirements. Extruded PVC hinges connect the panels together.

The Uno is available in 3 panel widths: **Uno 6** -150mm; **Uno 8** -200mm; **Uno 12** -300mm. To achieve acoustic performance the Uno 6A, Uno 8A and Uno 12A are fitted with continuous PVC acoustic sweeps to the top and bottom of the hinged panels.

The **Duplo 66**, **Duplo 88**, and **Duplo 122** are constructed from high density particle board panels mutually connected by means of PVC profiled hinges. The system is 'double shell' construction and fitted with acoustic sweeps at the head and base.

As the Duplo and Uno are top hung, there is no need for a break in the floor covering. Both systems are fitted with a euro cylinder lock as standard.



Guarantee

All products and workmanship are covered by a comprehensive 12 month guarantee.

Uno and Duplo partitions are an economic answer to the division of large and small areas. The systems are top hung without the need for floor rails or guides. Both systems are 'tailor-made' to fit thereby avoiding the need to adapt openings to suit standard sizes.

Operation

The systems can be easily moved by one person. Sealed for life roller assemblies which incorporate nylon runners to ensure smooth and silent operation.

Partitions can be single wing, bi-parting or have floating sections.



Duplo

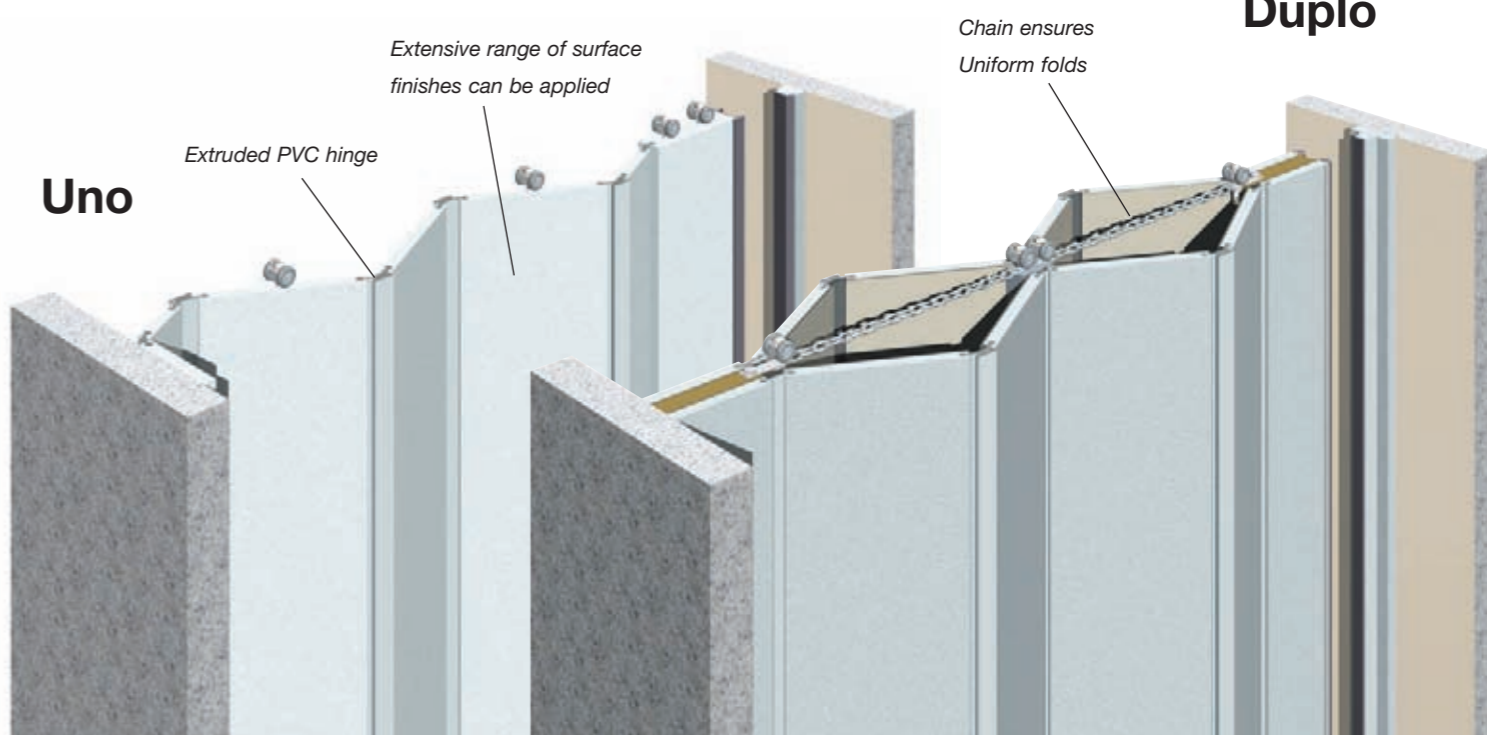



Uno Duplo



Product Selector

Type	Acoustic (RW)	Weight (kg/m ²)	Max Height (mm)	Max Single Wing Width (mm)	Panel Width (mm)	Width when stacked
UNO 6	N/A	15Kg/m ²	3000	5000	150	175
UNO 8	N/A	15Kg/m ²	3000	5000	200	225
UNO 12	N/A	20Kg/m ²	3000	5000	300	325
DUPLO 66	41db	40Kg/m ²	3000	5000	142	344
DUPLO 88	41db	38Kg/m ²	3000	5000	192	444
DUPLO 122	41db	36Kg/m ²	3000	5000	294	648

Appearance

Finishes include: melamine, laminate, wood veneers and vinyl wall covering. The track in standard format is satin anodised aluminium, however, this can be powder coated to any BS or RAL colour. Pelnets in standard format are white. Other colours are available.



- Features and benefits**
- Constructed of high quality dense, ecologically sound chipboard panels
 - Top and bottom acoustic sweeps
 - Various finishes including melamine, laminate, wood veneers and vinyl
 - Economical, quick and easy to use
 - Tailor-made to fit
 - 12 month guarantee
 - Finger safe hinges

Uno horizontal section

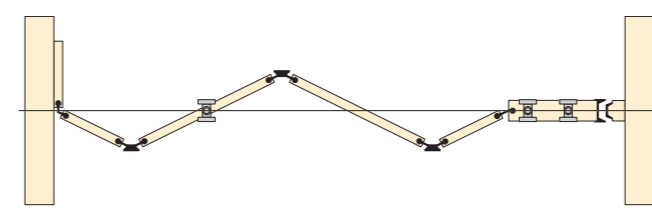

Duplo horizontal section

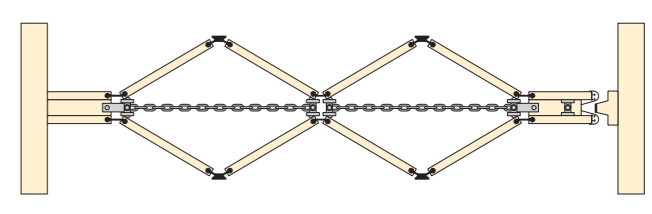

Standard track

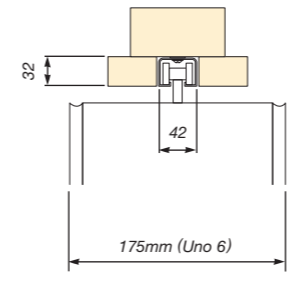

Track with acoustic seal

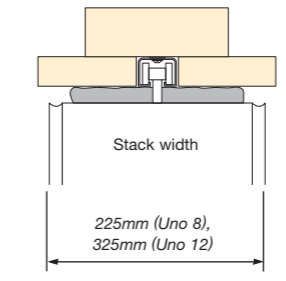

Track detail

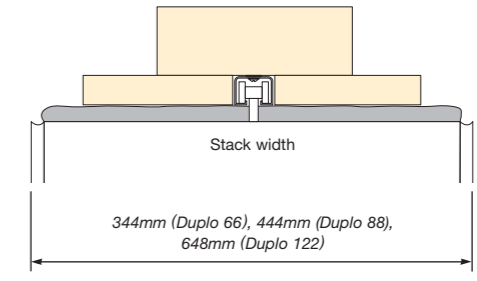

MonoGlass

Becker Glass Walls are the latest addition to the Becker range of products.

The system combines elegance with strength and security making it ideal for the retail industry, office environments and numerous other applications.

L-35 Monoglass wall

70mm x 65mm aluminium head track

Smooth action rollers

100mm x 35mm aluminium profiles to top and bottom

10mm or 12mm toughened glass

Semi-automatic foot bolt

Floor socket with sprung dust seal

L-35-F Monoglass wall

L-35 Monoglass wall

L-35-F Monoglass wall



MonoGlass



MonoGlass

Operation

Panels can be hinged together (L-35-F and L35-FEC options) or they can be moved individually (L35 option) allowing them to be parked wherever wanted. All panels are top hung without the need for a floor track. Fixed panels are also available.

The glass panels require only top and bottom profiles thereby maximising the glass area. The profiles house the rollers and bolts for all the models in the range, also the hinges for the L-35-F and the L-35-FEC models. With the L-35-PHS the profiles are reduced to their minimum size and located at the corners of the glass panels.

The aluminium profiles can be satin anodised, powder coated in RAL colours, or sleeved in stainless steel. The L-35 features a unique security bolt which is set manually and released automatically when the wall is returned to its parked position.



L-35 Monoglass wall

Track detail

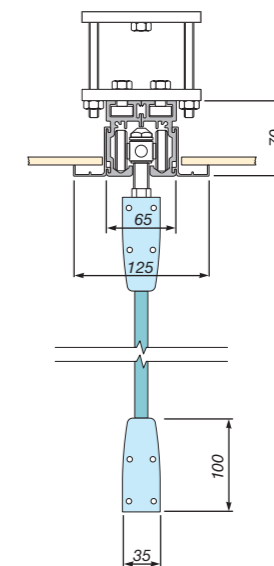

L-35-PHS corner 'patch' profile for maximum glass area

Features and benefits

- Top hung without the need for a floor track
- Smooth and easy operation
- Panels may be hinged together or moved individually
- Panels may be parked away from opening
- Bolts release automatically (L-35)
- Combines elegance with strength and security
- Top and bottom profiles only for maximum glass area

Examples of parking

L - 35

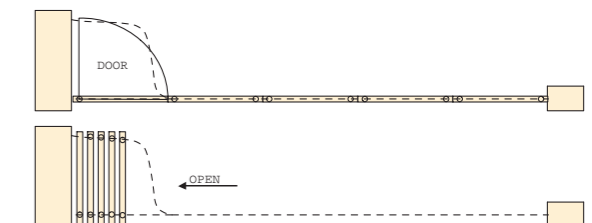

L - 35 - F

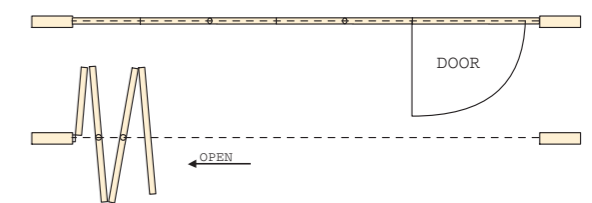

L - 35 - FEC

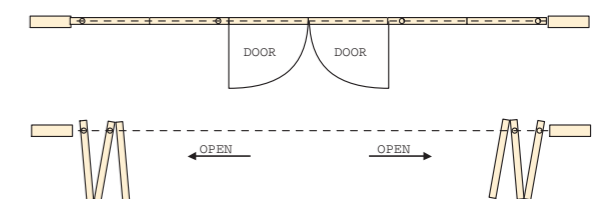

For further parking options please contact our Technical Department

Sunflex



Sunflex is the most technically advanced system on the market, designed and manufactured to the highest standards it allows you to maximise the opening potential of external elevations. This is achieved without compromising weather rating, thermal performance or security.



Designed to perfection

The Sunflex range is recognised for setting the benchmark in both design and quality. It is used throughout the world and meets the challenge of extreme weather conditions. The latest building regulations on thermal efficiency are easily met and surpassed by this superb system.

Features and benefits

- Severe weather rating
- High security locking system
- Finger safe gaskets
- Choice of thresholds including a flush option
- A wide range of opening options
- Full range of colours and finishes
- Corners and radius curves possible
- Available in timber, aluminium, or a combination of both

Systems

SF25 Glass Partition Wall - giving unobstructed panoramic views, ideal for balcony type enclosures and internal partitions.

SF45 Non Thermal Aluminium - for internal or external applications with the strength and ability to be used for commercial purposes.

SF55 Thermally Broken Aluminium - combines slimline looks without compromising thermal performance. Complies with latest building regulations.

SF65 Laminated Timber - laminated sections for strength and stability - available in a choice of timbers.

SF70 Thermally Broken Aluminium - polyamide thermal break combats heat loss and condensation.

SF80 Timber/Aluminium - No compromise! with timber to the interior and aluminium to the exterior.

SF99/155 - Straight sliding panels in thermally broken aluminium for maximum glass area with minimum surround.



Becker offers all their clients a complete and comprehensive service including:

- Detailed initial client consultation
- Bespoke design
- Digital CAD drawings
- Highest quality manufacturing and production
- Professional and efficient Installation service
- 12 month guarantee
- Guaranteed customer satisfaction



Versiplan Production, Becker GmbH

The Burton Group PLC

“ We would like to take this opportunity of thanking you for the excellent service your company provided regarding the installation of the new sliding partition at 1 Welbeck Street. The finished work was of an excellent standard, as was the efficiency and professionalism of the fitters work. We are particularly grateful as the work was carried out at short notice. The quality of the product matched the exceptional service provided and we would not hesitate in recommending your company if asked to future customers. Would you please pass on our comments to all concerned.

Bob Morrison - Support Services Co-ordinator ”



Creating digital AutoCAD drawings at Watford office

Cutting Monoplan Track



Here is a selection of the many clients for whom we have carried out installations. A more comprehensive list can be found on our website at www.becker.uk.com

INDUSTRY and COMMERCE

- IBM
- Bosch
- Sony Europe
- British Aerospace
- Whitbread
- Coca Cola
- St Ivel
- United Biscuits
- Twinings
- Britvic
- J Sainsbury
- Tesco
- Asda
- Morrisons
- Ikea
- Debenhams
- John Lewis
- Marks & Spencer
- Boots
- Texaco
- British Petroleum
- ICI
- Unilever
- GlaxoSmithKline
- Proctor & Gamble
- Pfizer Ltd
- Kodak
- Fuji Film
- Rank Xerox
- Chrysler UK
- Ford
- Tagg McLaren
- Pirelli
- BMW
- Vauxhall Motors
- VW Group UK
- Volvo
- Hertz Europe
- Thompson Publishing, London
- British Airways
- Wallace Arnold
- Thames Water
- Wessex Water
- Eastern Electricity
- Sharpe & Fisher

HEALTH

- The Royal Hospital London
- BUPA
- Kings College Hospital, London
- Royal Manchester Children's Hospital

- Princess Of Wales Hospital, Bridgend
- Glenside Hospital, Bristol
- Watford General Hospital
- Purdysburn Hospital, Belfast
- Mount Alvernia Hospital, Guildford
- Eastbourne District General Hospital
- Glasgow Eye Infirmary
- Norfolk and Norwich Hospital
- Southmead Hospital, Bristol
- Spring Lane Hospice, Rochdale
- St Georges Hospital, Lincoln
- Luton & Dunstable General Hospital
- St Austell Hospital, Cornwall
- Totnes Community Hospital, Devon
- York District Hospital
- De-La-Pole hospital, Hull
- Barnsley District Hospital

HOTELS

- The Rusacks Hotel St. Andrews
- Randolf Hotel, Oxford
- Oakley Court Hotel, Windsor
- Minty's, Bath
- The London International Hotel
- Orion Aparthotel, Cardiff
- Slieve Donard Hotel, Co. Down
- Bolholt Hotel, Bolton
- Drumkeen Hotel, Belfast
- Salmon Leap Hotel, Coleraine
- Bere Hill House Hotel, Hants
- The Foley Lodge Hotel, Newbury
- Saxon Hotels
- Fairfield Manor Hotel, York
- Cumbria Park Hotel, Carlisle
- Three Tuns Hotel, Durham
- St David's Park Hotel, Clwyd
- The Woodville Hotel, Manchester
- Durrant House Hotel, Devon
- Hilton Hotels
- Holiday Inn, Holiday Inn Express
- Swift Hotels

SPORTS and LEISURE

- Brighton Racecourse
- Chepstow Racecourse
- Haydock Park Racecourse
- Aberdeen FC
- Barnsley FC
- Manchester City FC
- Twickenham RFU
- G Mex Centre, Manchester
- Royal County Golf Club, Co. Down
- Aldwickbury Golf Club, Herts

- Dunscar Golf Club, Bolton
- John Nike Leisure, Bracknell
- John Lloyd Tennis Centres
- Island Sailing Club, Isle of Wight
- Acrefair Leisure Centre, Clwyd
- Copthall Sports Centre, London
- Superbowl, Sheffield
- Rickhill Sports Pavilion, Doncaster
- UCI Cinemas Ltd
- Julien Rose Stadium

TELECOMMUNICATIONS

- Vodafone
- Telewest Communications
- British Telecom
- Motorola Communications
- NTL

FINANCIAL INSTITUTIONS

- Price Waterhouse Cooper
- Ernst Young
- KPMG
- London Stock Exchange
- Barclays Bank
- Chase Manhattan Bank
- Credito Italiano
- Direct Line
- Halifax
- Lloyds TSB
- HSBC Bank
- NatWest
- Norwich Union
- Royal & Sun Alliance
- Prudential Assurance
- Standard Life

GOVERNMENT and LOCAL AUTHORITIES

- H.M. Customs & Excise
- Cabinet Offices Whitehall
- Shetland Islands Council
- Durham County Council
- Royal Mail
- Health & Safety Executive
- Civil Aviation Authority
- Ministry of Agriculture, Food/Fisheries
- Department of Trade & Industry
- Highways Agency
- Scottish Executive Office
- DVLA
- British Rail
- BBC

UNIVERSITIES

- Oxford University
- Cambridge University
- University College London
- University of Strathclyde
- University of Essex
- Brunel University
- Swansea University
- Nottingham University
- University of Kent
- Edinburgh University
- University of Plymouth
- University of Liverpool
- Lancaster University
- Coventry University
- Manchester University
- Newcastle University

SCHOOL and COLLEGES

- Royal Ballet School
- St Mary's Cambridge
- Cheltenham & Gloucester College
- Thomas Rotherham College, Rotherham
- Thornclyffe Salesian College, Bolton
- Southville Primary School, Hounslow
- St Cuthberts R.C. School, Rochdale
- Milltimber American School, Aberdeen
- St Michael's R.C. School, Finchley
- Bow School, London
- Blake College, London
- Mary Linwood School, Leicester
- Anglesey Junior School, Birmingham
- Park School, Stranraer
- Lambeth College, Brixton
- Aberdeen College

OTHER

- Which Magazine
- Financial Times
- Reuters
- Sadlers Wells Ballet
- The Eden Project
- The Law Society
- Brighton Dome
- National Motorcycle Museum
- Aberdeen Exhibition and Conference Centre
- Lowry Centre
- The Children's Society
- MENCAP
- MIND
- Barnardo's
- Royal British Legion