

# bimstore.co.uk

---

Noberne Doors Limited  
Fire Door Component User Guide

Version 1.0 | Revit 2013  
Mar 2013

## Loading the Noberne Fire Doors Material Library

The Fire Door components contain manufacturer specific render materials and pre-loaded materials. Revit will try and find these materials on your computer in the following directory:

C:\LocalRVT\Bimstore\Materials\Noberne

The first time you use the components you will need to copy the images contained in the 'Materials' folder included in the download, in to the 'Noberne' file above (you may need to create the folder structure if you have not used bimstore components with custom materials before).

The Fire Door materials will now load the custom render finishes from this location.

## Loading the Noberne Fire Door Components into your project

The Noberne Fire Door components are modelled as generic door families that can be simply loaded in to your project. This can be done using the following method:

1. Open the Revit file containing your 'project', and navigate to a floor plan view.
2. Now open the fire door component that you downloaded from bimstore. The default view that should be open is an isometric 3D view. Use the Revit ribbon at the top of the window to navigate to the family editor and click 'Load into Project'.

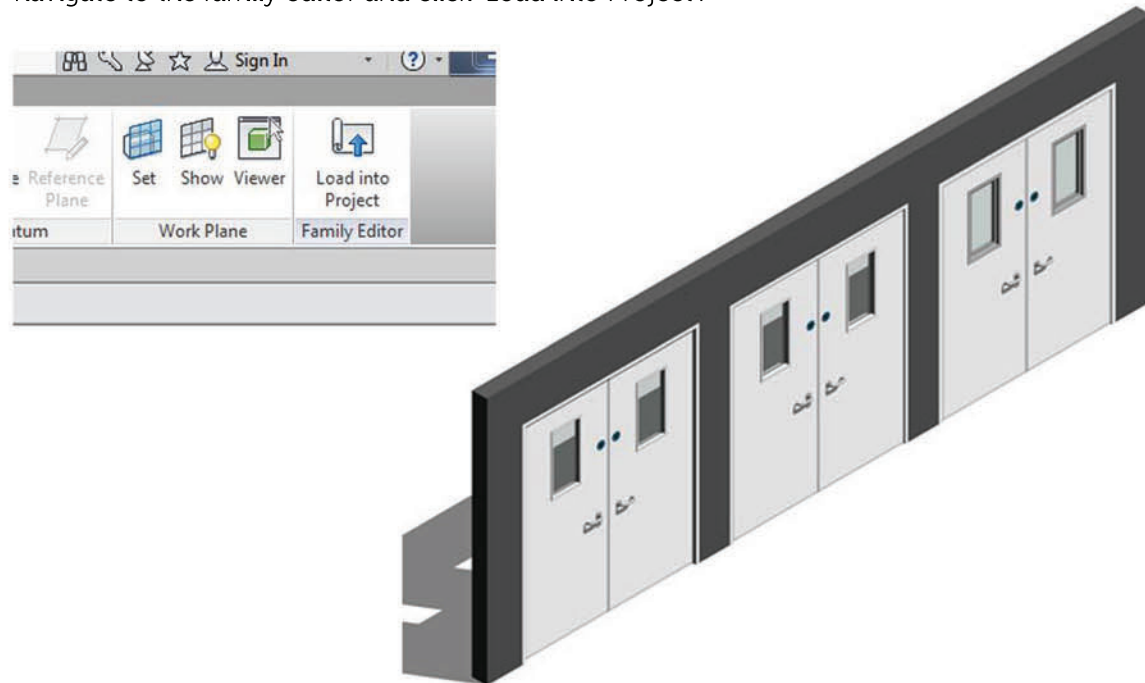

3. The component can now be placed in your project and can also be selected from the 'Door' drop down on the main revit ribbon.

## Amending the Noberne Fire Door size to user requirements

The Noberne Fire Doors come with a few standard sizes pre-built into the components however a wide range of sizes are available upon request. This section illustrates how the user can adjust the components size with regards to width and height.

To assist the Fire Door components have maximum and minimum size limitations built into them as per the manufacturers guidance and if exceeded a warning message will appear to advise you to contact the manufacturer for further details as illustrated below.

The door width and height can be adjusted by following this method;

1. Position a door in your project as usual.
2. Select the door and click 'Edit Type' in the 'Properties' dialogue box.
3. Duplicate the door and provide it with a new type name (e.g Series 2 - FD 30 2100x800mm)
4. Now adjust the parameters in the 'dimensions' section of the dialogue box to suit your requirements. The parameters for Height and Width are clearly identified and will adjust the Structural Opening of your door.

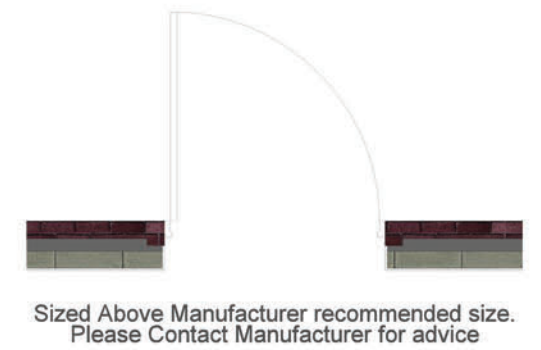

Dimensions	
Thickness	38.0
Side & Top Clearance	3.0
SOP Width	12.0
SOP Depth	32.0
Rough Width	1296.0
Rough Height	2085.0
Handle Offset	100.0
Handle Height	900.0
Height	2085.0
Width	1296.0
Frame Width	32.0
Frame Depth	94.0
Fire Signage Offset	150.0
Fire Signage Height	1500.0
Door Core Width	1226.0
Door Core Thickness	38.0
Door Core Height	2040.0
Base Clearance	10.0

5. Click 'OK' and your new created door size will be available for selection from the 'Door' drop down of the main Revit ribbon.

## Using the Noberne Fire Door additional features

The Noberne Fire Door components have additional features built-in to assist the user when specifying and scheduling the BIM components, these include adjustable vision panel sizes, additional frame trims, fire signage, door locks, 3D visible swing zones and adjustable materials. To use these additional features please follow the steps below:

1. With the component loaded and positioned in your project, select the door. Once selected the 'Properties' dialogue box should appear on the left hand of the screen.
2. Scroll down the 'Properties' dialogue box until you reach the heading 'Construction' in this box you will have tick boxes for a variety of options.

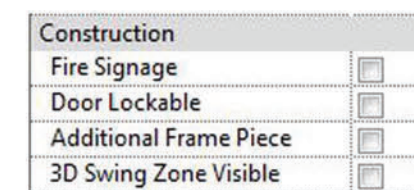
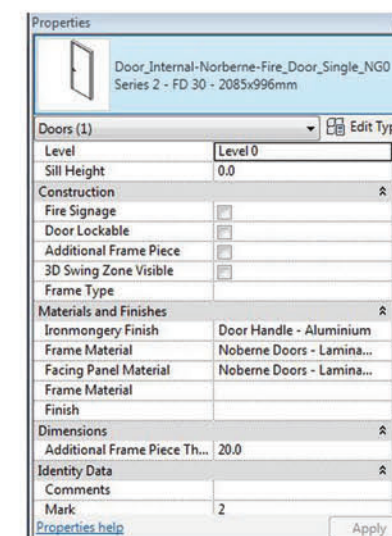

3. Tick the selected option and choose 'Apply' to activate the fire signage, door locks, additional frame piece or 3D swing zone.

## Using the Noberne Fire Door additional features continued .....

Below are illustrations of the additional features in use.

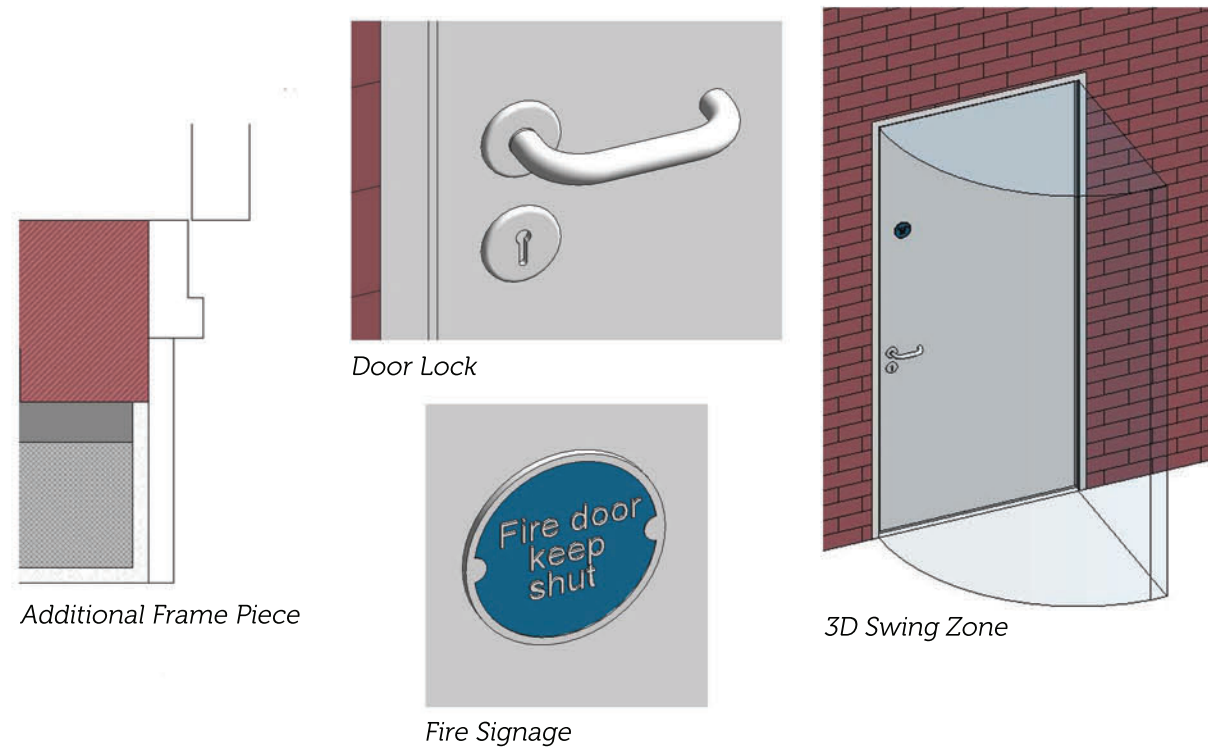

We have also built-in a range of material options for the Noberne Fire Doors. These again are available in the 'Properties' dialogue box under the Materials and Finishes heading. The components come with a wide range of laminate, PVC and veneer materials pre-built in to each component offering a wide range of variations by selecting different options for lippings, frames and facing materials as highlighted below

Materials and Finishes	
Lipping Material	Noberne Doors - Laminate - Formica - Polar White
Ironmongery Finish	Door Handle - Aluminium
Frame Material	Noberne Doors - Laminate - Formica - Polar White
Facing Panel Material	Noberne Doors - Laminate - Formica - Polar White

A number of the Noberne Fire Door components have glazed vision panels in various configurations from NG1 - NG12. To allow the user maximum flexibility we have also made the vision panels adjustable via the 'Properties' dialogue box.

It is recommended that the user select the door with the vision panel that nearest suits the requirements. The you are able to use the parameters under the 'Dimensions' heading of the Properties dialogue box to ammend the position and size of the vision panel as highlighted below.

Dimensions	
Vision Panel Width	188.0
Vision Panel Spacing	122.0
Vision Panel LHS Offset	150.0
Vision Panel Height	188.0
Additional Frame Piece Thickness	20.0

Note the thickness of the additional frame piece is also adjustable in this dimensions section.

## Other Notes

You can add the Noberne Fire Door components to your company template file, they will then be available without loading when starting a new project.

## Revisions

Version 1.0 - First Issue

**bimstore.co.uk**  
content, sorted

North East  
Spaceworks  
Benton Park Road  
Newcastle upon Tyne  
NE7 7LX

T. +44 (0)191 223 6600  
F. +44 (0)191 223 6610