

series 7 fire doorsets

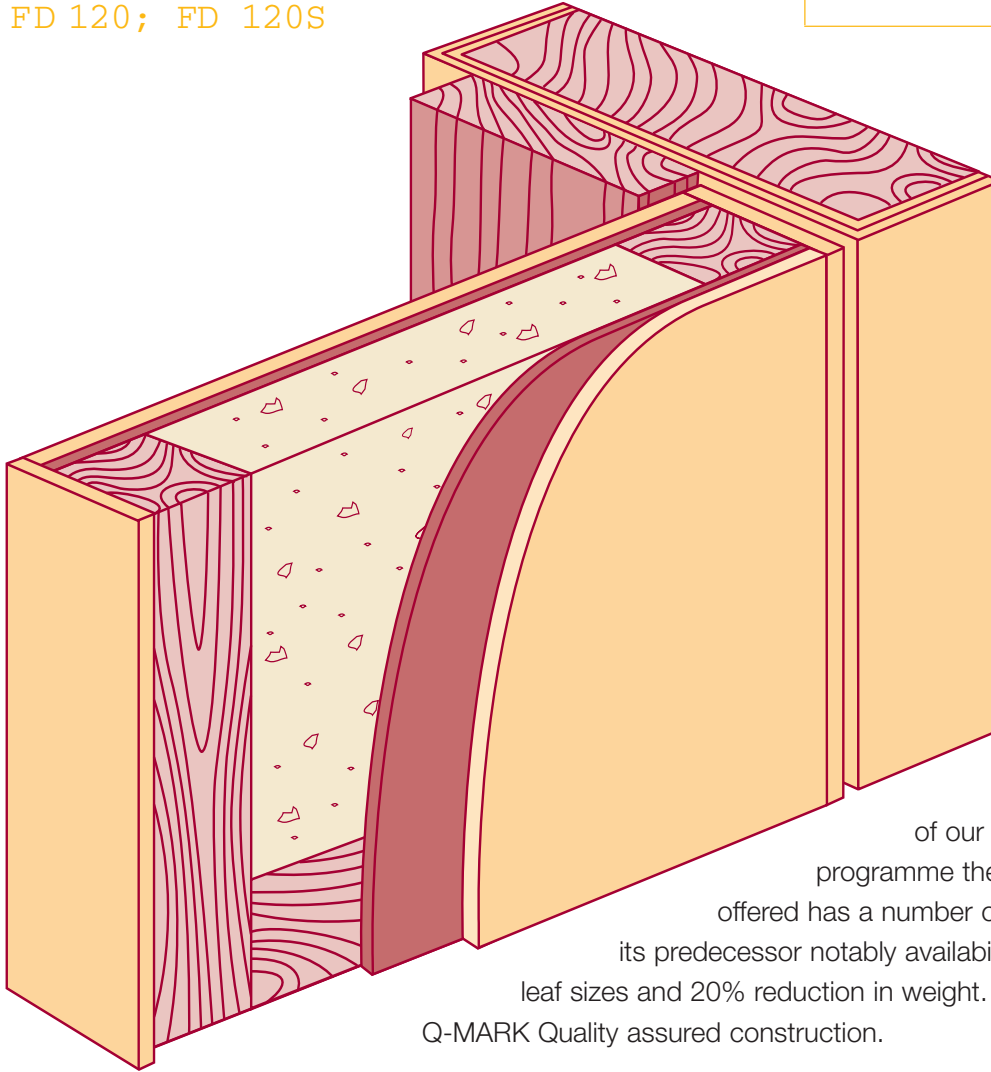

product sheet PDS 7

FD 120; FD 120S



As a result of our ongoing test programme the Series 7 currently offered has a number of advantages over its predecessor notably availability as pairs, larger leaf sizes and 20% reduction in weight. BM TRADA Q-MARK Quality assured construction.



The doors are factory hung on journal supported lift off hinges. A UNION 2648 latch has most recently been tested on our doors but other locks/latches may be used subject to satisfactory test data. Face mounted door closers manufactured by JEBRON Ref. 4200 were satisfactorily tested with this doorset.

"From contractor Laing's point of view, Noberne were excellent throughout the design stages when agreeing details and sizes. They were proactive with requests, provided a detailed and thorough site service and there were no issues with regard to snagging since installation, on the whole the contractor was completely satisfied with Noberne's service."

PETER STEBBINGS, ARCHITECT, FARRELL AND CLARK, ARCHITECTS AND MASTER PLANNERS

Illustrations are not to scale

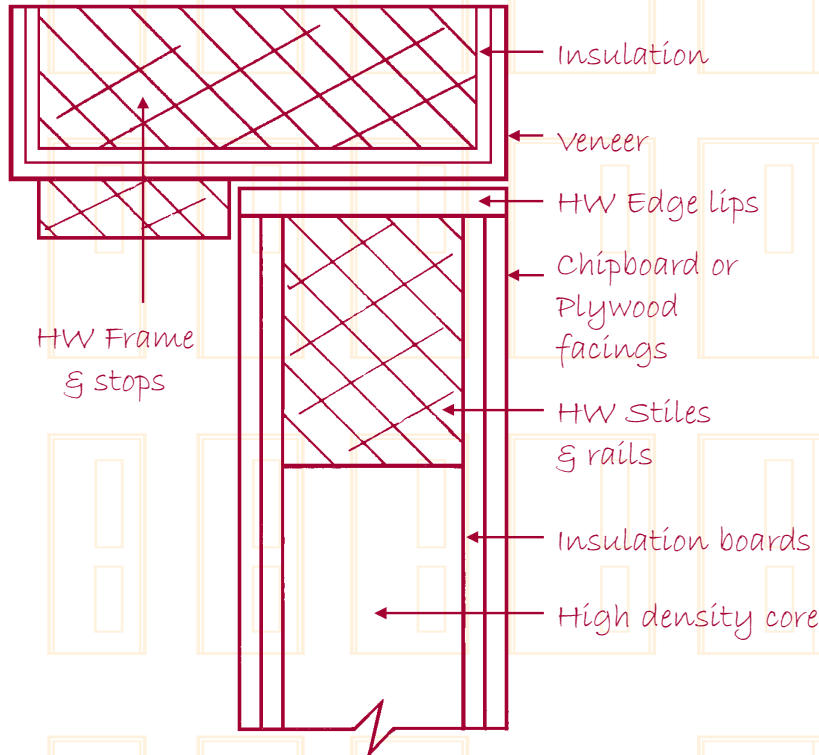

Constructed from materials traditionally used in door and joinery manufacture means that ironmongery is fitted in the normal manner associated with flush doors. Visually these doors can be matched with other doors supplied by ourselves.

The Series 7 has been tested in accordance with methods specified in BS476 PART 22 and the following results obtained:

| | |
|-----------|-------------|
| TEST REF | F.R. 1461 |
| INTEGRITY | 122 MINUTES |

Specification

Stiles, top and bottom rails of kiln dried hardwood 10-12% moisture content, core of a high density timber based board with a non-asbestos insulation board bonded to each face of the core and framing. Doors faced with 4mm veneered/laminated chipboard or MDF as required. Kiln dried hardwood lippings fixed by hot melt gluing to both long edges. Thickness 62mm TOLERANCE ± 2 mm Average weight 44kg/m² Frame 100 x 41mm finished size with 32 x 19mm stop lath.

Acoustics

Assessed to achieve 32dB Rw by SRL (Sound Research Laboratories) for single action, single leaf doorsets in conjunction with appropriate acoustic seals.

Availability

The Series 7 doorset is offered as a single leaf, single action latched doorset or as a double leaf single action latched doorset. Slightly smaller maximum leaf sizes apply to unlatched or double action configurations. Details of sizes on request. A full range of finishes for internal quality doorsets are available. Metal glazing frame factory glazed apertures with clear glazing are offered. Standard vision panel sizes are 300 x 300mm, 750 x 150mm, 1250 x 180mm. Other sizes are available to special order on request. Up to 0.23m² area may be glazed.

Noberne Doors Limited

Lupton Street, Hunslet
Leeds LS10 2QP

T 0113 277 8577
F 0113 277 2049

E nobervedoors@btconnect.com
www.nobervedoors.co.uk

