

# series 6 fire doorsets

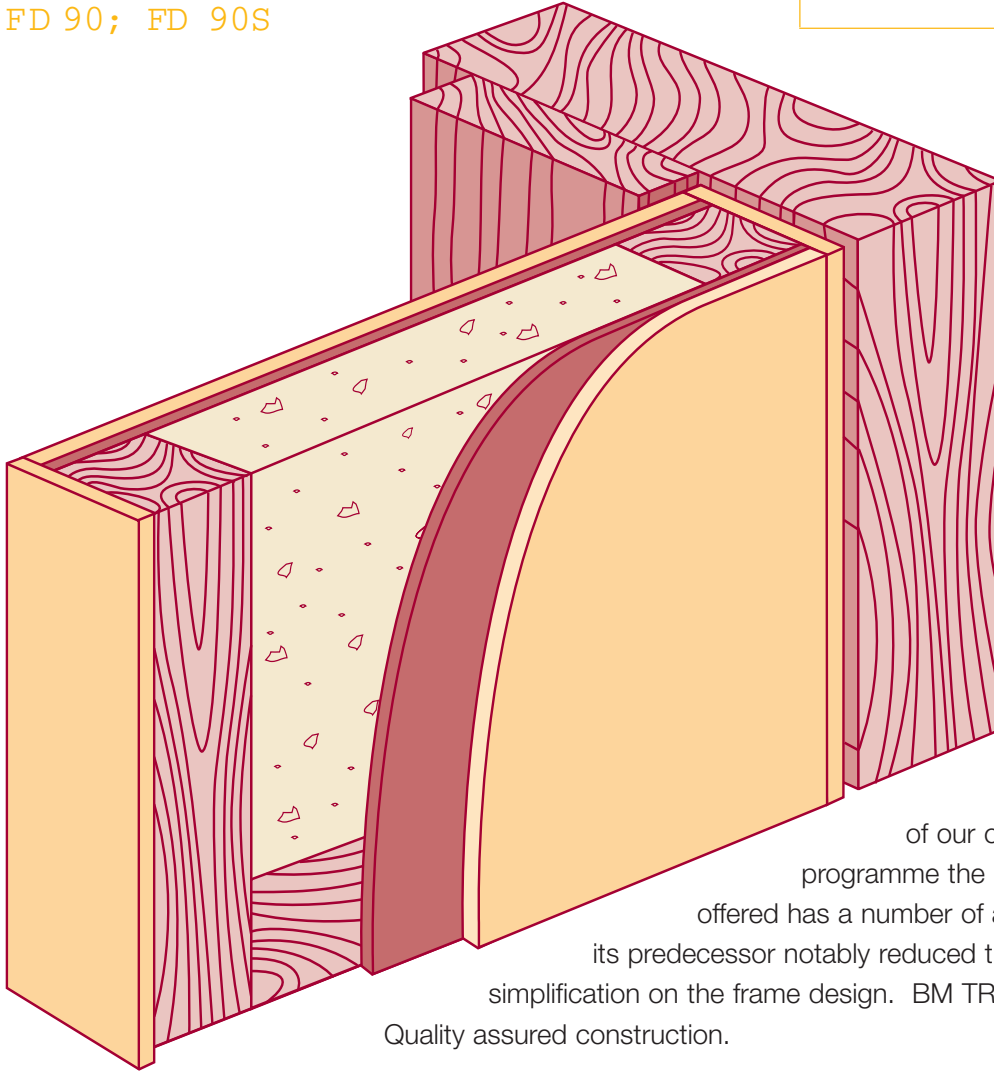

product sheet PDS 6

FD 90; FD 90S



As a result of our ongoing test programme the Series 6 currently offered has a number of advantages over its predecessor notably reduced thickness and a simplification on the frame design. BM TRADA Q-MARK Quality assured construction.



The doors are factory hung on journal supported lift off hinges. A Tubular mortice latch IFM 11.4 has most recently been tested on our doors but other locks/ latches may be used subject to satisfactory test data. Face mounted door closers manufactured Dorma Ref. TS83 were satisfactorily tested with this doorset.

*"The doorsets you recently supplied for the National Science Learning Centre at The University of York reflected the quality to which the whole project was designed and constructed. The service from Noberne Doors was excellent, especially when dealing with late additions and amendments."*

Peter Stebbings, Architect, Farrell and Clark, Architects and Master Planners

Illustrations are not to scale

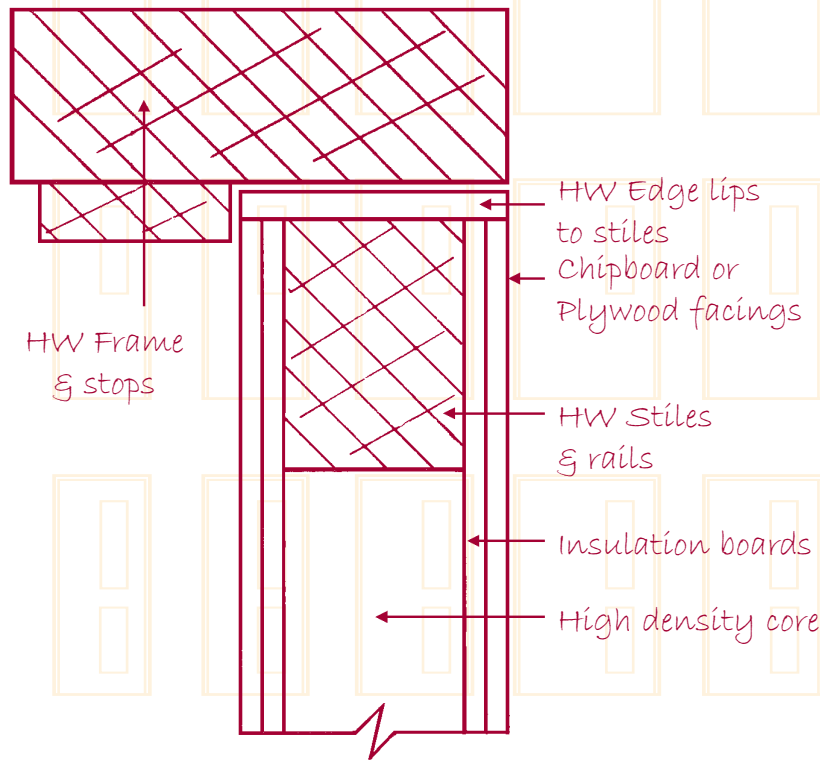

Constructed from materials traditionally used in door and joinery manufacture means that ironmongery is fitted in the normal manner associated with flush doors. Visually these doors can be matched with other doors supplied by ourselves.

The Series 6 has been tested in accordance with methods specified in BS476 PART 22 and the following results obtained:

TEST REF	R.F. 96057
INTEGRITY	105 MINUTES

### Specification

Stiles, top and bottom rails of kiln dried hardwood 10-12% moisture content, core of a high density timber based board with a non-asbestos insulation board bonded to each face of the core and framing. Doors faced with 4mm veneered/laminated chipboard MDF or external grade plywood as required. Kiln dried hardwood lippings fixed by hot melt gluing to edges. Thickness 56mm. TOLERANCE  $\pm 2\text{mm}$ . Average weight  $39\text{kg/m}^2$ . Frame in hardwood  $94 \times 44\text{mm}$  finished size with  $32 \times 19\text{mm}$  stop lath with appropriate intumescent and cold smoke seals.

### Acoustics

Assessed to 32dB Rw by SRL (Sound Research Laboratories) for single action, single leaf doorsets in conjunction with appropriate acoustic seals.

### Availability

The Series 6 doorset is offered as a single leaf, single action latched doorset or as a double leaf single action latched doorset. Slightly smaller maximum leaf sizes apply to unlatched or double action configurations. Details of sizes on request.

A full range of finishes and both internal and external quality doorsets are available. Metal glazing frame factory glazed apertures with clear glazing are offered.

Standard vision panel sizes are  $300 \times 300\text{mm}$ ,  $750 \times 150\text{mm}$ ,  $1250 \times 180\text{mm}$ . Other sizes are available to special order on request. Up to  $0.23\text{m}^2$  area may be glazed.

### Noberne Doors Limited

Lupton Street, Hunslet  
Leeds LS10 2QP

**T** 0113 277 8577  
**F** 0113 277 2049

**E** [nobervedoors@btconnect.com](mailto:nobervedoors@btconnect.com)  
[www.nobervedoors.co.uk](http://www.nobervedoors.co.uk)

