



**BROWNS**

**office & workplace**  
STORAGE SOLUTIONS

 **storage**  
essentials™

S E L House Foster Road Great Totham Essex CM9 8PZ  
Tel 0871 209 1001 Fax 0871 431 0555  
email [info@storageessentials.co.uk](mailto:info@storageessentials.co.uk)

# Our products are **BioCote** protected

You may not want to think about it but every surface in the working environment is a potential breeding ground for bacteria. As personal and workplace storage feature increasingly frequently in Human Resources planning, we can now offer an effective method of reducing this threat with the introduction of BioCote technology.

BioCote is a new, patent-protected powder coating which inhibits the growth of potentially lethal bacteria and fungi. This reduces the risk of cross-contamination from surfaces with high contact frequency. Although this is no substitute for correct cleaning practices, the incorporation of BioCote into the manufacturing process provides users of our products with the peace of mind that every effort is being made to maintain a hygienic working environment.

A particular area of concern is garment dispensers and collectors. The practices behind these are designed to ensure the use of clean protective workwear. But replenishment by third party service providers makes the transfer of infection from one area to another a very real threat – a threat which can be combated with our BioCote protected products.

BioCote provides a valuable contribution to hygiene management in healthcare, food processing and retail as well as other areas where due diligence demands every effort is made to reduce the risk of contamination.

## Colours

All of the cupboards, cabinets and lockers featured in this brochure are available in any of the colours shown below. Body and door colours can be supplied in any combination or as shown above in solid colour.

Colours shown below are an approximate guide only.



# Locking Systems

Locks for **Standard, Slimline, Large Volume and Insight Cupboards**



## **Standard and Slimline**

Standard deadlock with 2 keys. 95/97 series - 2000 differs. Master key available.



## **Large Volume**

Flush fitting handle lock with 2 keys. 64 series - 1000 differs. Master key available.



## **Hasp and Staple**

Hasp and staple fitting for use with padlock (padlock not supplied). Additional security option for standard cupboard range.

## **3 Point Locking System**

secures doors at the top, bottom and middle. Supplied as standard on Large Volume cupboards. 2 Point Locking fitted to all other cupboards.



Lock for **Garment Dispenser/Collector**



## **Standard Deadlock**

with 2 keys. 95/97 series - 2000 differs. Master door 95662 series. Master key available.

Locks for **Storage Lockers and Tool Cabinets**



**Standard Deadlock** with 2 keys. 95/97 series - 2000 differs. Master key available.



## **Butterfly Lock**

Butterfly hasp and staple fitting for use with padlock (padlock not supplied).

An ECONOMICAL and ROBUST range of storage cupboards offering SECURE STORAGE for commercial and industrial environments. Cupboards are 915mm wide x 470mm deep, in half or full heights, and feature concealed hinges, magnetic door catches, door stiffeners for added strength and security, high quality lock operating 2 point locking bars and adjustable shelves in 40mm increments. Cupboards are also available in kit form.

## Half Height Cupboard



<b>Height</b>	1016	
<b>Width</b>	<b>Depth</b>	
915	470	

**Fittings:** 2 adjustable shelves.

# Standard CUPBOARDS

## Full Height Cupboard



All cupboards benefit from shelves adjustable on 40mm increments.



Lateral filing cradles are available as optional extras, offering flexibility in the type of items stored.

<b>Height</b>	1829	
<b>Width</b>	<b>Depth</b>	
915	470	

**Fittings:** 3 adjustable shelves.

ALSO AVAILABLE IN KIT FORM FOR SELF ASSEMBLY

The internal configurations shown on these pages are only a small part of our range. Other Standard cupboard layouts are available as shown here. Ask your supplier for details.

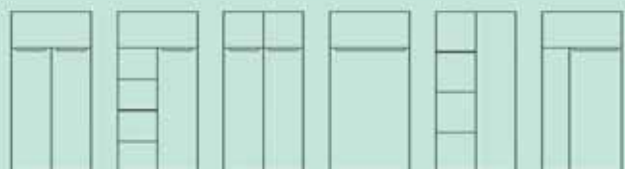

# Divided Cupboards



<b>Height:</b> 1829	
<b>Width</b>	<b>Depth</b>
915	470

**Fittings**  
Cupboard has one vertical divider and 6 adjustable shelves.

Divided into 8 (above) or 12 (below) compartments, these cupboards offer flexible segregated storage space.



<b>Height:</b> 1829	
<b>Width</b>	<b>Depth</b>
915	470

**Fittings** Cupboard has 2 vertical dividers and 9 adjustable shelves.

# Wardrobe



<b>Height:</b> 1829	
<b>Width</b>	<b>Depth</b>
915	470

**Fittings** Wardrobe is divided centrally with 4 adjustable shelves, one with coat rail.

# Security CUPBOARDS

With vulnerable equipment being used in the workplace, the need for more secure storage space has become a priority.

Our security cupboards benefit from an additional hasp and staple fitting for a padlock (not supplied), as well as the barrel lock with 2 point locking. Shelves are adjustable on 40mm increments.



<b>Height:</b> 1016	
<b>Width</b>	<b>Depth</b>
915	470

**Fittings**  
2 adjustable shelves.



<b>Height:</b> 1829	
<b>Width</b>	<b>Depth</b>
915	470

**Fittings**  
3 adjustable shelves.

# Slimline CUPBOARDS

The smart answer for when space is at a premium, the SLIMLINE range of cupboards offers practical secure storage for the workplace. Having all the features and manufactured to the same high standards as our other cupboards, these units make optimum use of minimum space. With a footprint of only 610 x 470mm these cupboards are available in 4 combinations. Adjustable shelves can be moved in increments of 40mm.



**Reinforced Doors**  
For security and strength doors are reinforced with a central vertical section welded to the door.



Slim Cupboard

<b>Height</b>	1829	
<b>Width</b>	<b>Depth</b>	
610	470	

**Fittings:** 3 adjustable shelves.



**2-point locking**  
For extra strength and security all doors feature locks with 3-point locking.

Slim Wardrobe



<b>Height</b>	1829	
<b>Width</b>	<b>Depth</b>	
610	470	

**Fittings:** Adjustable shelf with coat rail.

Clothes Storage



<b>Height</b>	1829	
<b>Width</b>	<b>Depth</b>	
610	470	

**Fittings:** Fixed shelf at 305mm with divider below and 2 coat rails.

Personal Cupboard



<b>Height</b>	1829	
<b>Width</b>	<b>Depth</b>	
610	470	

**Fittings:** Fixed shelf at 305mm with half coat rail. Divider below with 3 adjustable shelves.



**ALSO AVAILABLE IN KIT FORM FOR SELF ASSEMBLY**

As the name suggests these are the giants of our cupboard range, offering SPACIOUS STORAGE for larger items in the workplace.

With a width of 1220mm these cupboards feature semi-concealed hinges; door stiffeners for added STRENGTH AND SECURITY; high quality espagolette lock operating 3-point locking bars and shelves adjustable on clips at 25mm vertical pitch.

Utility



<b>Height</b>	1829	
<b>Width</b>	<b>Depth</b>	
1220	457	

**Fittings:** 3 adjustable half shelves.

Wardrobe



<b>Height</b>	1829	
<b>Width</b>	<b>Depth</b>	
1220	457	

**Fittings:** 2 adjustable half shelves both with coat rails.

Wardrobe & Shelves



<b>Height</b>	1829	
<b>Width</b>	<b>Depth</b>	
1220	457	

**Fittings:** 5 adjustable half shelves, one with coat rail.

# Large Volume CUPBOARDS

Cupboard



Flush fitting handle lock with 3 point locking, 1000 differs mastered series.

<b>Height</b>	1829	
<b>Width</b>	<b>Depth</b>	
1220	457	

**Fittings:** 3 adjustable shelves.

# Insight CUPBOARDS

Full Height Cupboard



<b>Height</b>	1829	
<b>Width</b>	915	470
<b>Depth</b>	470	

**Fittings** Three adjustable shelves.

Secure, lockable cupboards with vision panels for applications where the contents have to be displayed or visually scanned.

Available in 2 sizes the vision windows are manufactured from robust, hard wearing polycarbonate panels. These provide safe and secure storage while allowing clear visual access to the products stored.

Half Height Cupboard



<b>Height</b>	1016	
<b>Width</b>	915	470
<b>Depth</b>	470	

**Fittings** Two adjustable shelves.

# Storage CUPBOARDS

A range of useful SMALL STORAGE CUPBOARDS designed to suit general storage needs. Available in 3 sizes these cupboards offer flexible and secure storage at an economic price. All shelves are adjustable with additional shelves available. Cupboards are fitted with a barrel lock and have a reinforced door. Type DDTL benefits from 3-point locking.

Type D



<b>Height</b>	915	
<b>Width</b>	457	457
<b>Depth</b>	457	

**Fittings** Two adjustable shelves.

Type DDTL



<b>Height</b>	915	
<b>Width</b>	915	457
<b>Depth</b>	457	

**Fittings** Two adjustable shelves.

Type A

<b>Height</b>	762	
<b>Width</b>	457	305
<b>Depth</b>	305	

**Fittings** One adjustable shelf.

Personal Workwear



Top door allows restocking of clean workwear.

<b>Height:</b> 1778	
<b>Width</b>	<b>Depth</b>
381	457

**Compartment height:** (Top) 315mm

**Hanging:** 1410mm

**Fittings:** Hat shelf with vertical central divider, One half width shelf on one side and hanging facility on either side of divider.

Combi Dispenser/Collector



5 Door

<b>Height:</b> 1778	
<b>Width</b>	<b>Depth</b>
381	457

**Compartment height:** 146mm

**Fittings:** Hooks for garment sack (sack not included).

10 Door

<b>Height:</b> 1778	
<b>Width</b>	<b>Depth</b>
381	457

**Compartment height:** 62mm

**Fittings:** Hooks for garment sack (sack not included).

# Garment DISPENSERS



These lockers are used for the CONTROLLED ISSUE of workwear, safety equipment or consumable items.

**Garment Issue Lockers** are available in 5, 10 and 15 door versions, with users having key access to their individual secure compartment to collect clean clothing. One main door gives access to all compartments for re-stocking .

Soiled garments are 'posted' into an adjacent COLLECTOR LOCKER for laundering.

A galvanised steel anti-theft shelf is fitted below the 'post' opening. Hygiene is guaranteed as clean and dirty items are always separated.

These dispensers are also available in Stainless Steel for damp and humid conditions.

Where space is at a premium or the number of users small, the COMBI DISPENSER/COLLECTOR is the answer.

The PERSONAL WORKWEAR LOCKER combines personal storage space with an upper compartment which can be re-stocked. The upper door locks into the main lower door, each door having a separate key. The laundry operative has access to the upper compartment for re-stocking, but cannot open the lower compartment. Both doors open when the lower door is opened, allowing the user to access both compartments.

5 Door Dispenser

<b>Height:</b> 1778	
<b>Width</b>	<b>Depth</b>
381	457

**Compartment height:** 310mm

10 Door Dispenser

<b>Height:</b> 1778	
<b>Width</b>	<b>Depth</b>
381	457

**Compartment height:** 148mm

15 Door Dispenser

<b>Height:</b> 1778	
<b>Width</b>	<b>Depth</b>
381	457

**Compartment height:** 95mm

Garment Collector

<b>Height:</b> 1778	
<b>Width</b>	<b>Depth</b>
381	457

**Fittings:** Hooks for garment sack (sack not included).

# Computer WORKSTATIONS



Pull-out keyboard shelf is fitted with a barrel lock.



Cables are enclosed to avoid safety hazard.

The widespread use of computerised systems for production and stock control purposes has grown in the past years. This has created the need for SECURE shopfloor storage solutions.

The COMPUTER WORKSTATION range offers both security and protection from the working environment for PC's and VDU's and associated equipment and consumables.

All models feature reinforced doors with 3 point locking, security barrel lock with 2 keys and two adjustable shelves. The pull-out keyboard shelf and upper VDU compartment can also be locked. All locks operate from the same key.

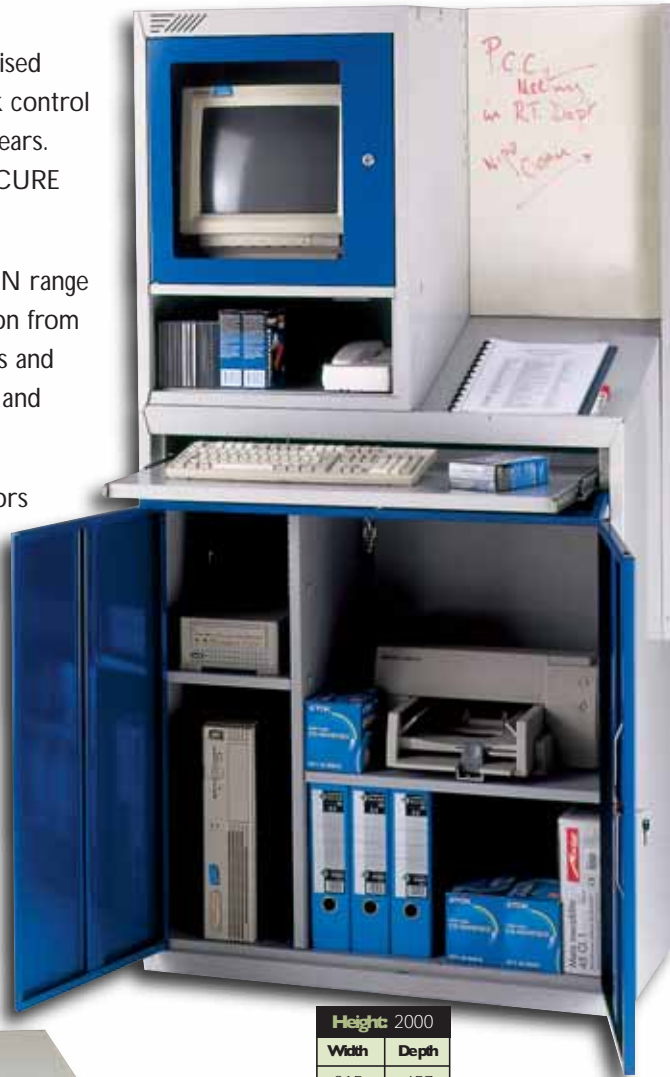

Computer Workstation

<b>Height</b> 2000	
<b>Width</b>	<b>Depth</b>
915	457

Workstation features a lockable VDU enclosure with a white dry wipe/magnetic message board alongside. One adjustable shelf either side of divider.

Low Computer Workstation



<b>Height</b> 1219	
<b>Width</b>	<b>Depth</b>
915	457

VDU sits on top of the workstation. One adjustable shelf either side of divider.

# Work/Quality STATIONS

UTILITY WORKSTATIONS combine a secure storage unit with a sloping work surface for use in stores, laboratories, warehouses, production lines, in fact anywhere.

The range has now been increased, by the addition of three models which focus on the specific needs of quality control departments and continuous improvement initiatives.

All models feature reinforced doors with 3 point locking, security barrel lock with 2 keys and two adjustable shelves.



Drawer (305w x 101h) is fitted with a barrel lock.



4 Castors (2 with brakes) can be fitted to make the units mobile (workstation only).



Work Station

<b>Height:</b>	1219	
<b>Width</b>	<b>Depth</b>	
915	457	

**Fittings:** 2 adjustable shelves.



<b>Height:</b>	2000	
<b>Width</b>	<b>Depth</b>	
915	457	

Quality Station\*

As standard workstation but with panel fitted at the rear of the sloping top. Panel contains file holder for 10 lever arch files, and a white dry wipe/magnetic message board.

Information Station\*



Features dry wipe magnetic message board fitted at the rear of the angled worksurface.

Toolholder Station\*



With mild steel pegboard panel fitted at the rear of the sloping top which accepts universal tool clips and fittings.

ALSO AVAILABLE IN KIT FORM FOR SELF ASSEMBLY

\* Rear panel requires self assembly onto workstation.

# Tool CABINETS

## Reinforced Doors

For security and strength doors are reinforced with a central vertical section welded to the door.



## Paint Finish

All surfaces are epoxy powder coated for longer lasting protection. This hard wearing glossy finish enhances the appearance of the units.



## Drawers

Drawers are 90mm HIGH and can carry up to 25KG EDL\* EACH with a safety stop to prevent them from being pulled out and sliding guides for ease of movement. Drawers have 80% extension for ease of access and are height adjustable in 25mm increments.



## Shelves

Shelves are 20mm high with an all round raised edge and a loading capacity of 50KG EDL\*. Shelves have 80% extension for ease of access and are height adjustable in 25mm increments.



Range of robust and versatile TOOL CABINETS in four sizes. All cabinets feature a secure barrel lock and offer various combinations of drawers and galvanised shelves. Double low cabinets and tall cabinets feature 3-point locking.

The low line cabinets feature a raised edge on three sides to prevent items from rolling off the top.

Accessories available include a lockable sloping top unit for single low units and mobile chassis and ribbed inlay rubber mats for single and double low units.

Single low cabinet fitted with lockable sloping top, mobile chassis and fitted with 4 x 50mm swivel nylon wheels, 2 with brakes.

\* EDL - Evenly distributed load.

Low Single

<b>Height</b>	1000	
<b>Width</b>	<b>Depth</b>	
500	500	



SC10/6D



SC10/1D1S  
1 drawer, 1 shelf



SC10/1D2S  
1 drawer, 2 shelves

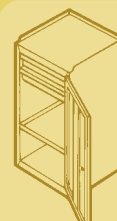

SC10/2D1S  
2 drawers, 1 shelf



SC10/9D  
9 drawers

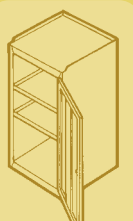

SC10/2S  
2 shelves

# Low Double

<b>Height:</b> 1000	
<b>Width</b>	<b>Depth</b>
1000	500



DC10/4D1S

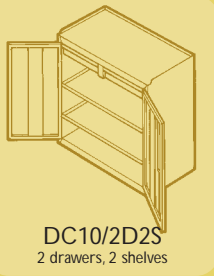

DC10/2D2S  
2 drawers, 2 shelves

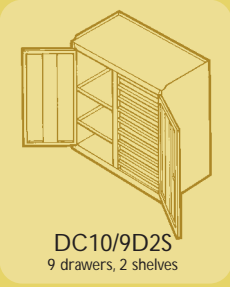

DC10/9D2S  
9 drawers, 2 shelves

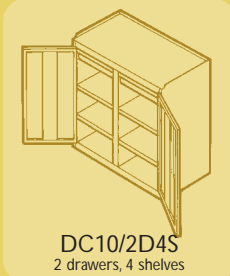

DC10/2D4S  
2 drawers, 4 shelves

<b>Height:</b> 1800	
<b>Width</b>	<b>Depth</b>
1000	500

<b>Height:</b> 1800	
<b>Width</b>	<b>Depth</b>
500	500

# Tall Single



TS18/2D2S

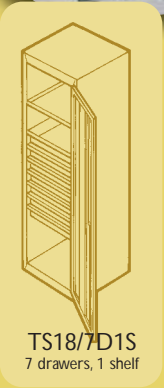

TS18/7D1S  
7 drawers, 1 shelf

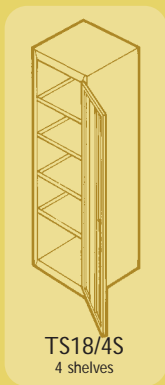

TS18/4S  
4 shelves

# Tall Double

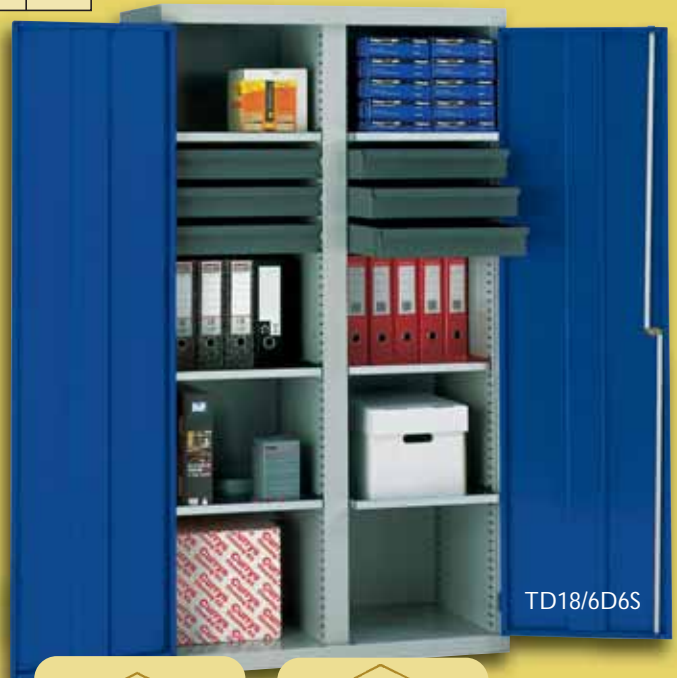

TD18/6D6S

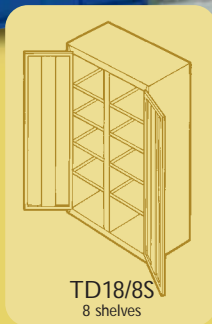

TD18/8S  
8 shelves

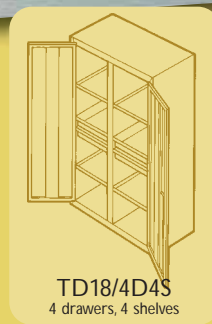

TD18/4D4S  
4 drawers, 4 shelves

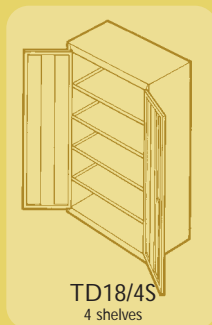

TD18/4S  
4 shelves

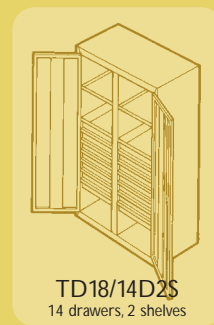

TD18/14D2S  
14 drawers, 2 shelves

# M Series LOCKERS



**Ventilation**  
Vents in the front, top and bottom of the locker frame improve air circulation whilst retaining an unpierced door surface.



**Locking systems**  
Wide range of optional fittings to choose from. Key operated dead locks with cardholder are fitted as standard, supplied with 2 keys. The locking mechanism locates behind the welded metal frame for enhanced security.

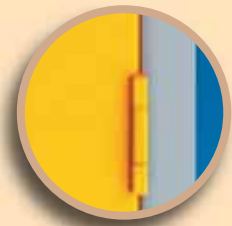

**Strong hinges**  
Semi concealed knuckle hinges are fitted to all our lockers. These are welded to the door for strength but rivetted to the door frame to allow replacement.



**Reinforced Doors**  
Door edges are channel folded and then welded at the corners. Security and strength are further enhanced by a steel channel reinforcer welded to the full height of the door and locating within the channel fold.

The M SERIES range of metric lockers comes with **QUALITY** and **RELIABILITY** as standard. They are manufactured in the UK to ISO 9001:2000, and have been tested and conform to the requirements for Standard Duty Lockers to BS 4680:1996. Standard features include welded, reinforced doors and door frames, ventilated body and robust powder coated finish.

**SECURITY:** Robust, fully reinforced and corner welded doors with semi-concealed hinges provide security and peace of mind. All lockers are supplied as standard with deadlocks and cardholders - pistol grip locks for use with your own padlock are also available on request.

**FINISH:** All surfaces have an epoxy powder coating for a longer lasting finish and include BioCote protection to help reduce the risk of cross-contamination in the workplace. Colours are standard RAL specifications for easier co-ordination with new or existing equipment or environments.



Available from your local distributor:



S E L House Foster Road Great Totham Essex CM9 8PZ  
Tel **0871 209 1001** Fax **0871 431 0555**  
email **info@storageessentials.co.uk**