



**Total Cubicle Solutions**  
Fast-Fit Range  
Cubicles • Vanity Units • IPS Units

## Fast-Fit Range

Pioneering a new dimension in washrooms.

Wear Category: Light  
Range: Budget

For a cubicle solution that offers functionality, durability and ease of use, let us introduce you to Fast-Fit! Suitable for pools or high traffic areas, Fast-Fit offers an attractive, cost effective answer.

Designed and Manufactured in the United Kingdom representing high quality, 20mm compact grade laminate, the system is versatile and is suitable for WC, shower and changing room applications.

To comply with new Building Regulations, part M, Total Cubicle Solutions has added enlarged and ambulant cubicle options to the Fast-Fit range. Together with our service promise, you are now in the position to specify, with confidence, a stunning washroom installation for any market sector, at an economical price.

Total Cubicle Solutions take pride in presenting you with a bespoke, professional and cost effective service. Fast-Fit provides a versatile cubicle solution in various buildings. Application of Fast Fit has previously been used in Hospitals, Health Centres, HM Prisons, Schools and Colleges demonstrating its clean and hygienic qualities, whilst also being used in Sports Stadiums, Night Clubs and Industrial providing a contemporary and streamlined cubicle design.

Total Cubicle Solutions offers a fast turnaround for the tightest of deadlines and having built up a reputation for superb after sales support from our United Kingdom based office. Our goal is to supply your cubicles with the minimum of fuss, ensuring that from the start to finish, your project runs smoothly.

All this, and the added reassurance that you are dealing with people with over 75 years experience in the industry.

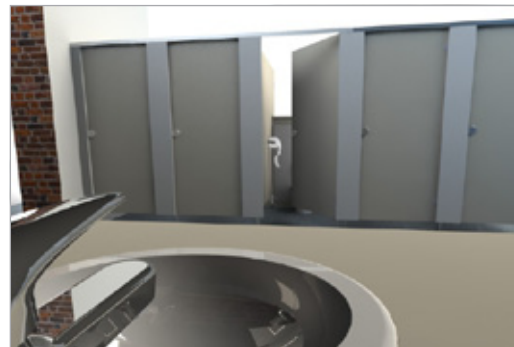

## Toilet Cubicle Layout Options

### Single Cubicle (SI)

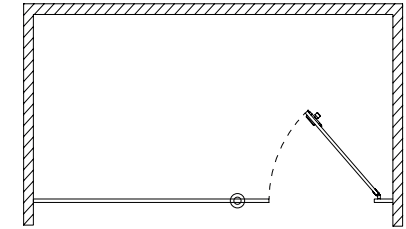

### Free Standing (FS)

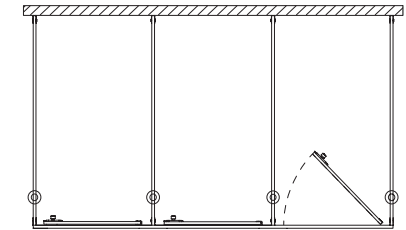

### Open Ended (OE)

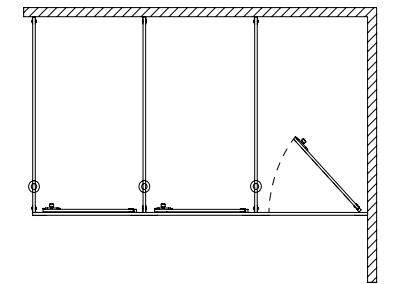

### Between Walls (BW)

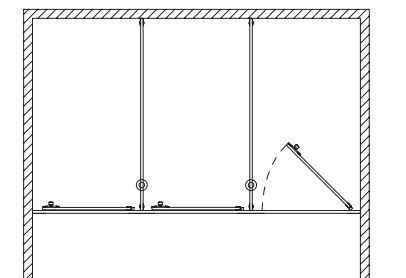

Units 5-7, Luton Street  
Liverpool  
L5 9XR

T: 0844 800 7785  
F: 0844 800 7738  
E: sales@totalcubicles.co.uk

## Fittings and Accessories

Fast-Fits fittings are built to stand the test of time. They come in an attractive satin finish to contrast with the Fast-Fit Range colour options.

TCCHIN13 / TCCHIN19



TCCHA13 / TCCHA19



TCTRHOLD



TCRL13 / TCRL19



TCCHOOK



TCCH2MB / TCCH4MB



TCIDK



TCODK



TCLOCK13 / TCLOCK19

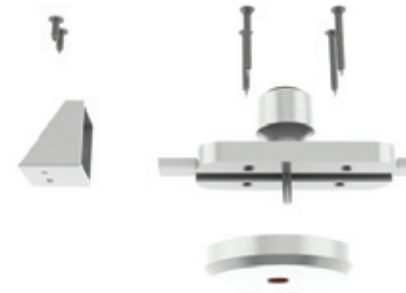

DOOR BUFFER



Units 5-7, Luton Street  
Liverpool  
L5 9XR

T: 0844 800 7785  
F: 0844 800 7738  
E: sales@totalcubicles.co.uk

# Fast-Fit Colour Options



White  
Fast-Fit White



Cream  
Fast-Fit Cream

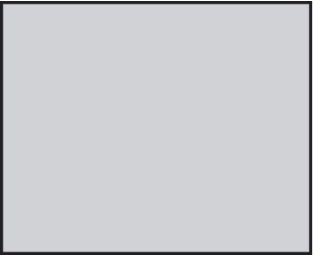

Grey  
Fast-Fit Grey



Units 5-7, Luton Street  
Liverpool  
L5 9XR

T: 0844 800 7785  
F: 0844 800 7738  
E: sales@totalcubicles.co.uk

## Vanity Units

The Fast-Fit Range of vanity units has an exceptional resistance to water and impact. They are available in matching colours to the Fast-Fit range of cubicles.



### Vanity Unit Layout Options

#### Standard Vanity Unit

FFVSTD

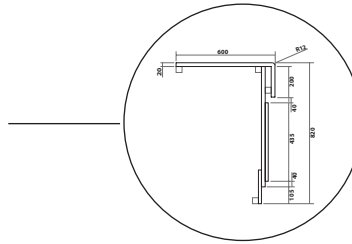

#### Semi-recessed Vanity Unit

FFVSR

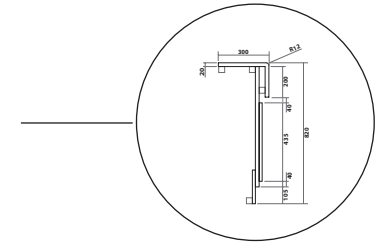
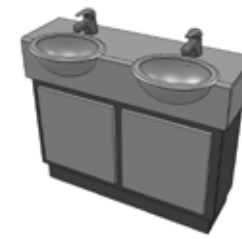

#### Standard Vanity Unit with Loose Upstand

FFVSTDLU

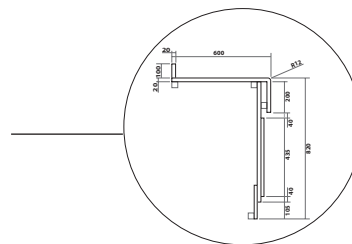

#### Semi-recessed Vanity Unit with Loose Upstand

FFVSRRLU

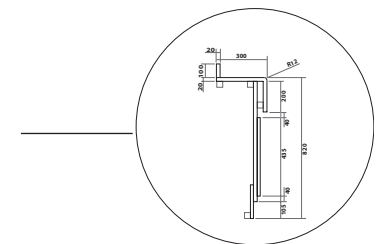

#### Standard Vanity Unit with Coved Integral Upstand

FFVSTDCU

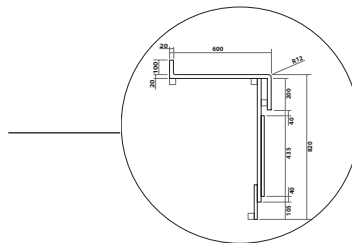

#### Semi-recessed Vanity Unit with Coved Integral Upstand

FFVSRUCU

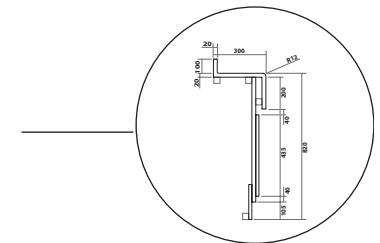
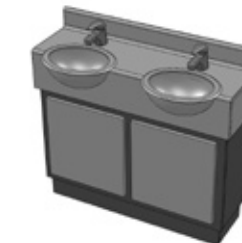

Units 5-7, Luton Street  
Liverpool  
L5 9XR

T: 0844 800 7785  
F: 0844 800 7738

E: sales@totalcubicles.co.uk

## IPS Units

The Fast-Fit range of IPS units has an exceptional resistance to water and impact.

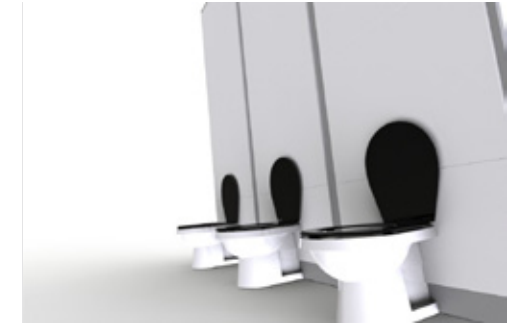

### IPS Layout Options

#### Free Standing

(FS)

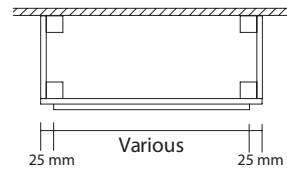

#### Open Ended Left

(OELH)

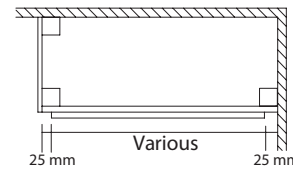

#### Open Ended Right

(OERH)

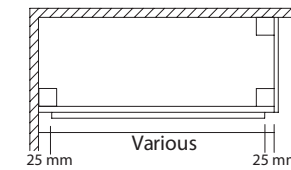

#### Hole In Wall

(HIW)



### Panel Options

**Postformed** - available on parallel edges only

R12

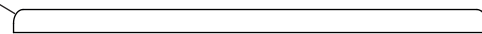

End Elevation

**PVC**

R2

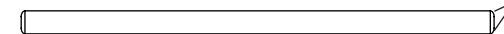

End Elevation

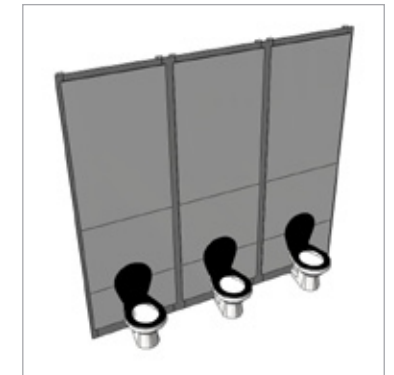

Units 5-7, Luton Street  
Liverpool  
L5 9XR

T: 0844 800 7785  
F: 0844 800 7738  
E: sales@totalcubicles.co.uk

## Installation Instructions

Please look over the enclosed drawings to familiarise yourself with the parts required to construct your cubicle. Check that the sizes you have provided for manufacture are correct and match the sizes on site.

### Installing The Partitions

**Please Note:** We no longer pre-drill the partitions as Soil Stacks and Window Placements can compromise the fitting position. Normally our Cubicles are divided equally along the wallspace except where Ambulant or Disabled Cubicles are to be implemented.

#### Step 1

Fix the partition channel brackets to the rear wall using 35x4mm posi screws and red plugs.

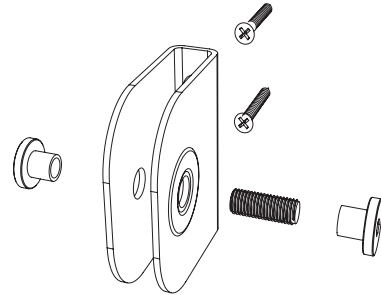

#### Step 2

The partitions should be set up 135mm off the floor on the adjustable leg provided. Tighten the Allen Head Clamp down securely on the partition.

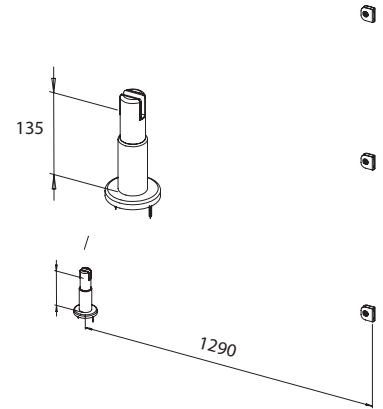

#### Step 3

Next check the squareness of the partition and then fix the height adjustable leg to the floor with 35x4mm posi screws and red plugs, (please ensure before drilling that no under floor heating is present).

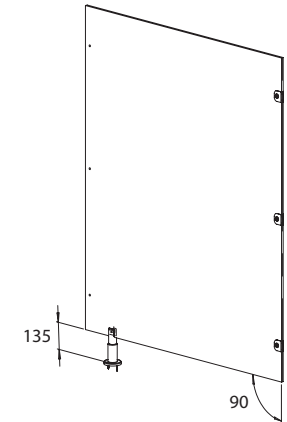

### Installing Pilasters

#### Step 4

Start by installing an end pilasters back to the wall on the brackets provided, using 35x4mm posi screws and red plugs.

Set the pilaster height 135mm up from the floor to match the partition height and tighten the T-Nuts down securely on the pilaster.

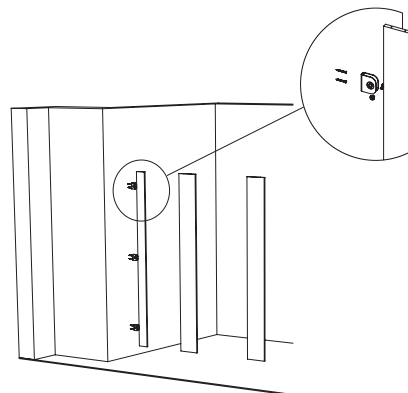

Fit the channel brackets centrally to the back of the centre pilaster, pilot the holes 10mm deep and fix with resistorx 12x4 screws.

Fit the pilaster by bolting through with the T-Nuts provided. Tighten securely with an Allen Key.

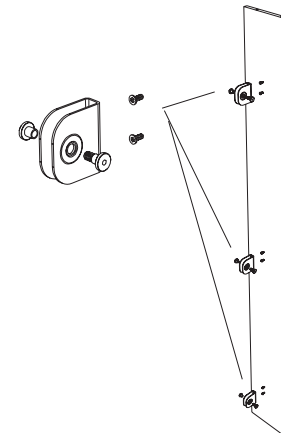

### Check Measurements

Next, measure the door aperture; it should measure 35mm less than the overall width of the door. If this matches, you can continue on, installing the remaining centre pilasters, again checking the aperture and measurements as you go.

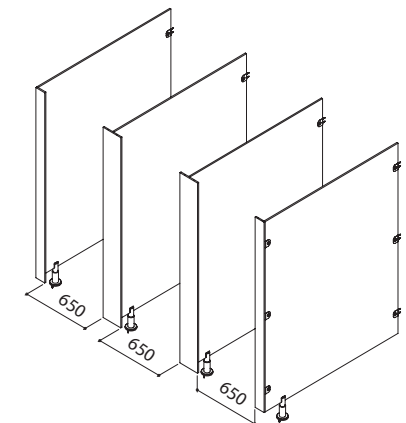

Units 5-7, Luton Street  
Liverpool  
L5 9XR

T: 0844 800 7785  
F: 0844 800 7738  
E: sales@totalcubicles.co.uk

# Installation Instructions

Please look over the enclosed drawings to familiarise yourself with the parts required to construct your cubicle. Check that the sizes you have provided for manufacture are correct and match the sizes on site.

## Fit The Channel Headrail

### Step 7

The Channel headrail is what braces the whole cubicle construction, so correct fitment of this item is essential. Start by cutting the headrail to the correct length. Next, fit the rail over the pilaster.

Pre-drill the pilasters through the top of the headrail and affix 3 12x4mm screws into the top of each pilaster bracing the construction.

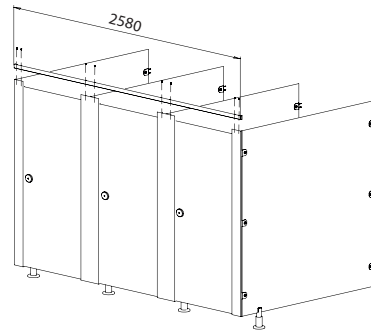

## Fitting The Doors And Lock Keeps

### Step 8

The doors provided should overlap the aperture by 35mm. The door should now be fitted ensuring an equal overlap of 17.5mm on either side of the pilaster/aperture.

Use the 12x4mm Resistorx screws piloted to a depth of 10mm to fit the hinges and 12x4 screws piloted to 10mm deep to fit the lock back plate assembly. Next fit the lock keep on the pilaster with 12x4mm Resistorx screws.

**Please Note:** The nylon cams in the hinges can be adjusted to allow the door to swing open or closed. To change the operation of the closure, remove the nylon cam and turn in through 90 degrees. The locks are also symmetrical and can be used on either side of the door.

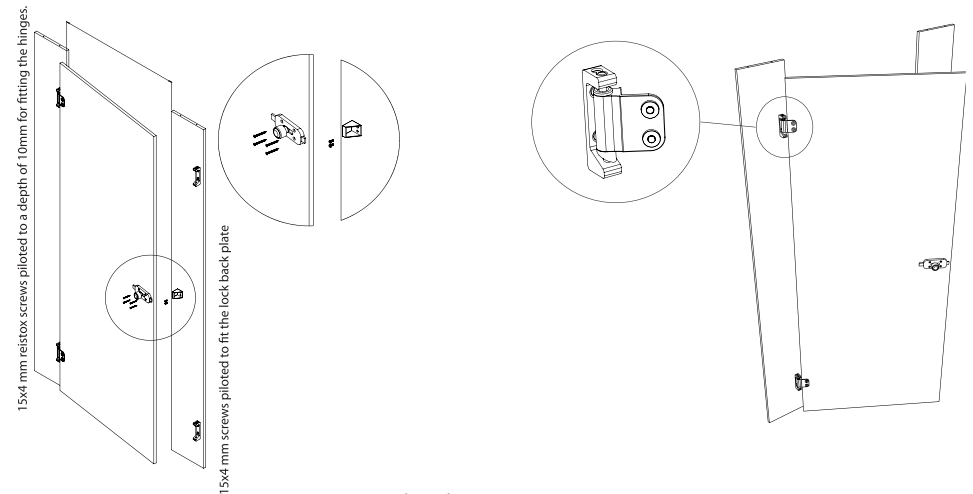

## Accessories

### Step 9

Fit the hat, coat hook and toilet roll holders at the desired height using the 12x4mm Resistorx screws piloted to 10mm depth.

**Please Note:** We do provide T-Nuts so the hinges and pilaster can be bolted through. This is sometimes a more robust solution when vandalism is prevalent, though standard construction is aesthetically more pleasing to look at than the bolt through option.

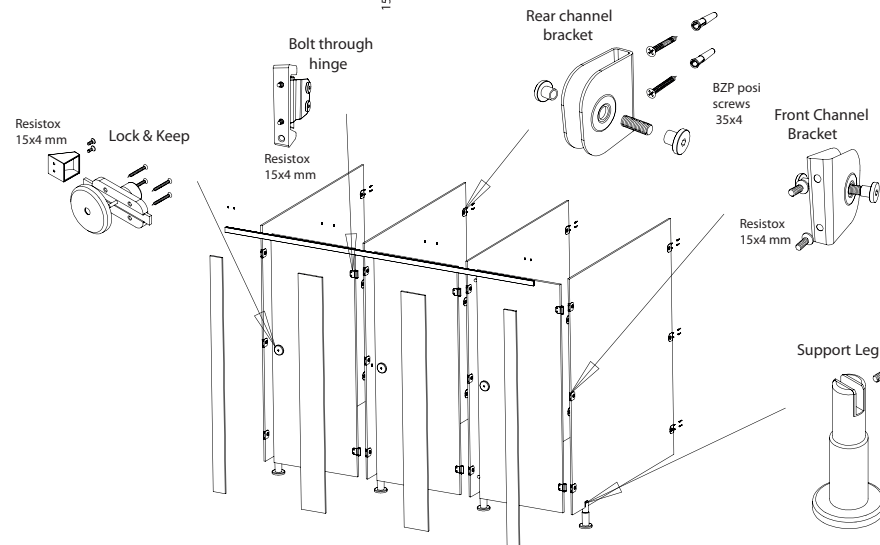

Units 5-7, Luton Street  
Liverpool  
L5 9XR

T: 0844 800 7785  
F: 0844 800 7738  
E: sales@totalcubicles.co.uk