

The **Avon SB970CR Scimitar Security Bollard** provides a high level of security against unauthorised vehicle access. Designed to withstand substantial direct impact forces, the bollard is able to protect sites from extreme aggressive attacks while maintaining a less aggressive appearance.

Designed and manufactured by engineers with a wealth of experience in the fields of High Security and Access Control, the SB970 CR Scimitar Security Bollard is a highly dependable security product.

With an experienced system design capability along with a worldwide installation, service and maintenance capability, we are able to provide a swift and efficient solution to all your high security requirements.

KEY FEATURES

- ▲ Physically crash tested to exceed DoS & British Standards
- ▲ Manufactured from heavy gauge materials
- ▲ Substantial 1000mm raised height
- ▲ Manual operating override facility
- ▲ Unobtrusive aesthetics
- ▲ High quality coating system
- ▲ Minimal foundation requirements

BENEFITS

- ▲ Proven to withstand large vehicle impact and be fully operational after impact
- ▲ Reliability (100% duty cycling)
- ▲ Zero site penetration to DoS K12 Impact
- ▲ Operation in power failure conditions
- ▲ Durability
- ▲ Service spares availability – ease of replacement
- ▲ Ease of installation

Avon SB970CR Scimitar Security Bollard

Avon Barrier Company Ltd
Head Office – Nova House
191-195 South Liberty Lane
Ashton Vale Trading Estate
Bristol BS3 2TN
United Kingdom

Tel: +44 (0)117 953 5252
Fax: +44 (0)117 953 5373
Email: security@avon-barrier.co.uk
www.avon-barrier.co.uk

Avon SB970CR Scimitar Security Bollard

Technical Specification

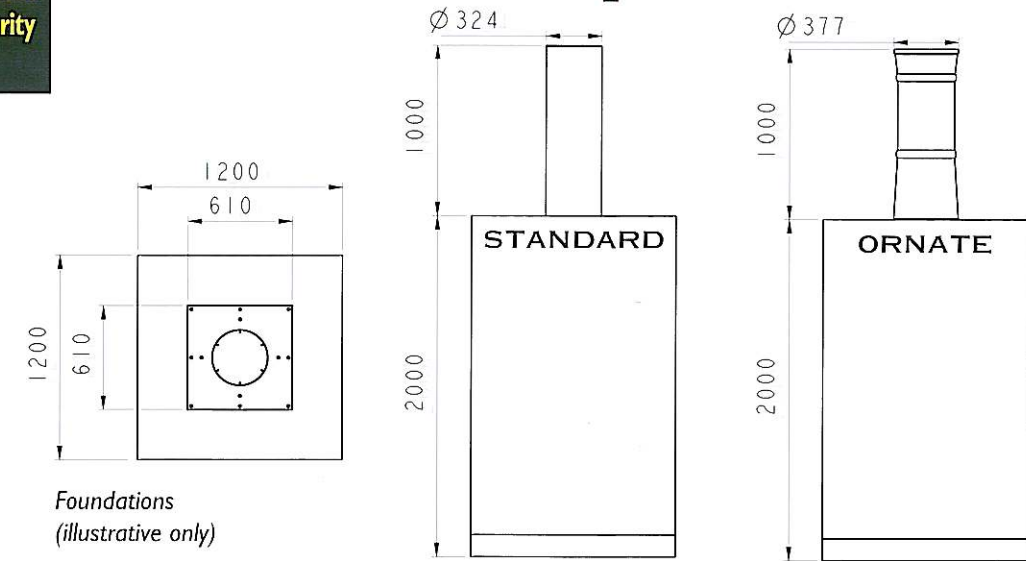

STANDARD CONTROLS – PUSH BUTTON TO RAISE/STOP/LOWER

OPTIONAL EXTRAS

Access Control:	Card/Proximity Reader Keypad/Keyswitch Radio Transmitter Inductive Loops/Infra Red Intercom – audio/visual
Safety Equipment:	Traffic Lights Inset Warning Lights Photo-Electric Cell Inductive Loop
Status:	Back indication
Emergency:	Panic button with key release Power failure backup (UPS/Accumulator) Emergency fast raise circuit Anti-burst valves
Finish:	Ornate sleeving Stainless steel sleeving

IMPACT RATING

Impact absorption 7500 Kg at 80 kph, fully crash tested to exceed DoS Standard K12-L3 with **NO** operational damage after impact (single unit stand-alone formation). Zero site penetration with test vehicle destroyed and bollard fully operational after impact.



Avon Barrier Company Ltd
Head Office – Nova House, 191-195 South Liberty Lane,
Ashton Vale Trading Estate, Bristol BS3 2TN
United Kingdom.
Tel: +44 (0)117 953 5252 Fax: +44 (0)117 953 5373
Email: security@avon-barrier.co.uk
Web site: www.avon-barrier.co.uk

The **Avon SB970CR Scimitar High Security Bollard** has been tested in both stand-alone and multiple configuration enabling single or multi-use installations without compromising security.

Constructed from high strength steel (galvanised and painted black) the Bollard stands 1,000mm above the road surface in the fully raised position with an outside diameter of 324mm (excluding optional outer sleeves).

The SB970CR has been designed to ensure that vehicle penetration during attack is kept well within the DoS/British minimum standard requirements for both U.S. and European manufactured vehicles.

The heavy-duty top plate and Bollard cap are both removable to enable simple and efficient maintenance and serviceability. The Bollard sits in a steel frame which is pre-prepared for ease and speed of installation with reinforcement connection points to tie into the outer foundation and access points for onward connection to ducting for hydraulic hoses and control cables.

The SB970CR has been successfully impact tested with a concrete foundation of just 2.25 cubic metres, it is necessary that the sizes used for testing are adhered to in order to be compliant with the relevant product's impact rating.

A hydraulic actuator is used to raise the Bollard to its full height driven by a hydraulic power unit (HPU) with optional anti-burst valves to protect against system sabotage. The HPU contains the hydraulic and electronic control equipment in an externally rated lockable cabinet to be positioned locally to or remotely from the Bollard.

The Avon Barrier Company reserve the right to change or amend the specification of its products from time to time in furtherance of its policy of continued product improvements.

Agent's Stamp